

**bright**  
by **Joie™**

**boronia™**

**3 in1 pramette stroller**

Instruction manual

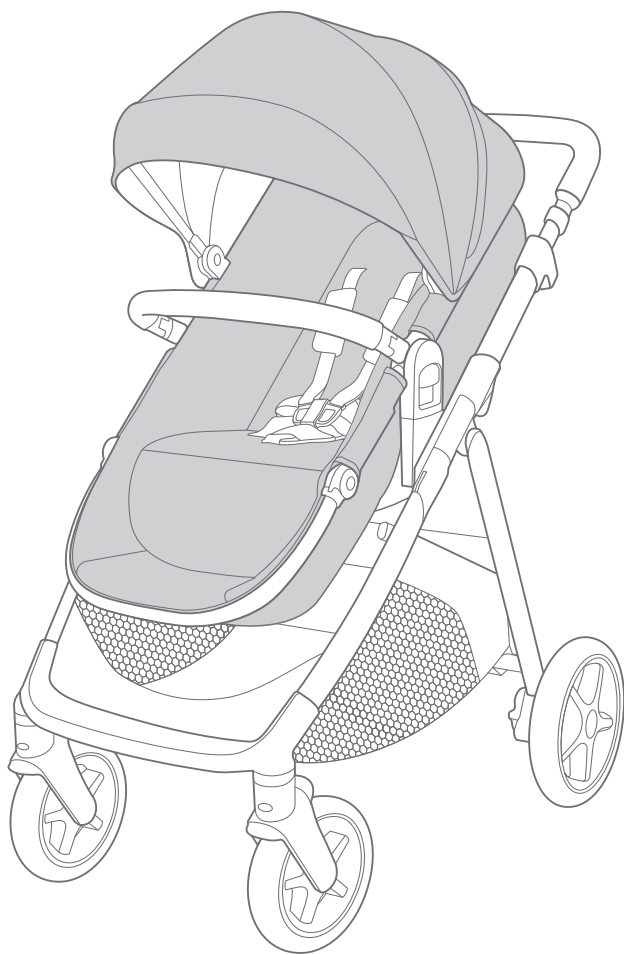

## GB Welcome to Joie™

Congratulations on becoming part of the Joie family! We are so excited to be part of your journey with your little one. While traveling with the bright by Joie boronia™, you are using a high quality, fully certified stroller, complies with Australian Trade Practices Act 1974 Consumer Protection Notice No 8 of 2007. This product is suitable for children up to 22 kg or 4 years whichever comes first. Please carefully read this manual and follow each step to ensure a comfortable ride and best protection for your child.

## IMPORTANT - READ CAREFULLY AND KEEP FOR FUTURE REFERENCE.

Visit us at [joiebaby.com](http://joiebaby.com) to download manuals and see more exciting Joie products!

## Emergency

In case of emergency or accident, it is most important to have your child taken care of with first aid and medical treatment immediately.

## Contents

Emergency	1
Product Information	3
Parts List	4
WARNING	5
<b>Stroller Assembly</b>	<b>9</b>
Open Stroller	9
Assemble & Detach Front Wheel	9
Assemble & Detach Rear Wheel	11
Assemble Canopy	11
Assemble & Detach Cup Holder	13
Assemble & Detach Armbar	15
<b>Stroller Operation</b>	<b>17</b>
Use Buckle	17
Use Shoulder & Waist Harnesses	19
Adjust Backrest	21
Adjust Calf Support	21
Use Pramette	23
Use Front Swivel Lock	27
Use Brake	27
Use Canopy	29
Use Shoulder Harness Cover and Crotch Harness	
Cover	29
Adjust Handle	31
Adjust Seat Height	31
Switch Seat	33
Use Tether Strap	33
Fold Stroller	35
<b>Cleaning and Maintenance</b>	<b>37</b>

## Product Information

Read all the instructions in this manual before using this product. If you have any further questions, please consult the retailer. Some features may vary depending on model.

<b>Product</b>	Boronia Stroller
<b>Suitable for</b>	Child weighing under 22kg (birth - 48 months)
<b>Materials</b>	Plastics, metal, fabrics
<b>Patent No.</b>	Patents pending
<b>Made in</b>	China
<b>Brand Name</b>	Bright by Joie
<b>Website</b>	<a href="http://www.joiebaby.com">www.joiebaby.com</a>
<b>Distributor</b>	Allison AU Pty Ltd.

## Parts List

Make sure all parts are available before assembly. If any part is missing, please contact local retailer. No tools are required for assembly.

1	Stroller Frame	15	Calf Support
2	Front Wheels		Adjustment Button
3	Rear Wheels	16	Seat Height
4	Armbar		Adjustment Button
5	Cup Holder	17	Storage Basket
6	Canopy	18	Swivel Lock
7	Seat Pad	19	Canopy Window
8	Shoulder Harness	20	Pramette Seat Lever
9	Armbar Release Buttons	21	Handlebar Sliding Locks
10	Buckle	22	Fold Release Tabs
11	Calf Support	23	Tether Strap
12	Footrest	24	Recline Adjuster
13	Handle	25	Storage Latch
14	Seat Release Button	26	Brake

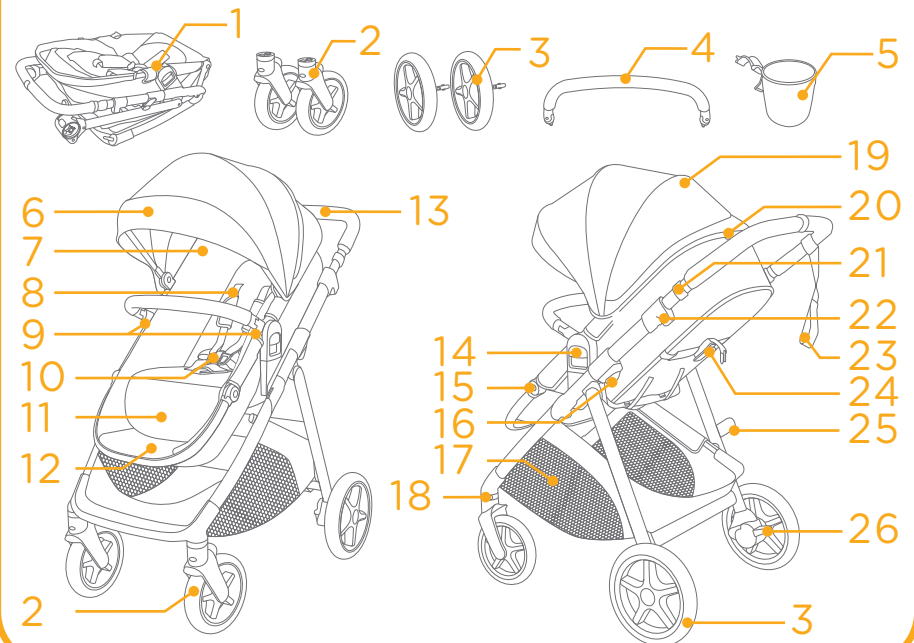

## **WARNING**

- ! FOLLOW THE MANUFACTURER'S INSTRUCTIONS.
- ! PUT ON ALL THE BRAKES WHENEVER YOU PARK THE STROLLER.
- ! DO NOT LEAVE CHILDREN UNATTENDED.
- ! DO NOT CARRY EXTRA CHILDREN OR BAGS ON THIS STROLLER.
- ! MAKE SURE CHILDREN ARE CLEAR OF ANY MOVING PARTS IF YOU ADJUST THE STROLLER, OTHERWISE THEY MAY BE INJURED.
- ! THE STROLLER SEAT IS NOT RECOMMENDED FOR A CHILD UNDER 6 MONTHS OLD.
- ! IN STROLLER MODE USE THE STROLLER HARNESS AT ALL TIMES.
- ! TO AVOID INJURY OR DEATH: ALWAYS APPLY THE BRAKES WHENEVER THE STROLLER IS STATIONARY.
- ! ALWAYS KEEP CHILD IN VIEW WHILE IN STROLLER.
- ! ALWAYS USE THE 5 POINT HARNESS COMBINATION WITH THE WAIST BELT, THE SHOULDER HARNESSES AND CROTCH STRAP.
- ! TO AVOID SERIOUS INJURY FROM FALLING OR SLIDING OUT, ALWAYS USE SEAT BELT.
- ! USE THIS STRAP TO STOP THE STROLLER ROLLING AWAY.
- ! ENSURE THAT ALL THE LOCKING DEVICES ARE ENGAGED BEFORE USE.
- ! DO NOT LET THE CHILD PLAY WITH THIS PRODUCT.
- ! CHECK THAT THE PRAM BODY OR SEAT UNIT ATTACHMENT DEVICES ARE CORRECTLY ENGAGED BEFORE USE.

- ! ADULT ASSEMBLY REQUIRED.
- ! USE THE STROLLER WITH ONLY ONE CHILD AT A TIME IN THE EACH SEAT. THIS PRODUCT IS SUITABLE FOR CHILDREN UP TO 22 KG OR 4 YEARS WHICHEVER COMES FIRST.
- ! NEVER LEAVE THE CHILD UNATTENDED.
- ! TO PREVENT A HAZARDOUS, UNSTABLE CONDITION, DO NOT PLACE MORE THAN 4.5KG IN THE STORAGE BASKET.
- ! NEVER PLACE PURSES, SHOPPING BAGS, PARCELS OR ACCESSORY ITEMS ON THE HANDLE OR CANOPY.
- ! THE USE OF ACCESSORIES NOT APPROVED BY THE VEHICLE MANUFACTURER IS UNSAFE.
- ! ONLY REPLACEMENT PARTS SUPPLIED OR RECOMMENDED BY THE MANUFACTURER SHALL BE USED.
- ! TO AVOID INJURY ENSURE THAT THE CHILD IS KEPT AWAY WHEN UNFOLDING AND FOLDING THIS PRODUCT.
- ! THIS PRODUCT IS NOT SUITABLE FOR RUNNING OR SKATING.
- ! IT IS RECOMMENDED TO USE BASSINET (PRAMETTE MODE) FOR NEWBORN BABIES.
- ! BASSINET (PRAMETTE MODE) SHALL NOT BE USED, AS SOON AS THE CHILD IS ABLE TO SIT BY HIMSELF, ROLL OVER AND CAN PUSH ITSELF UP ON ITS HANDS AND KNEES. MAXIMUM WEIGHT OF THE CHILD: 9KG.
- ! THE PARKING DEVICE SHALL BE ENGAGED WHEN PLACING AND REMOVING THE CHILDREN.
- ! NO ADDITIONAL MATTRESS SHALL BE ADDED UNLESS RECOMMENDED BY THE MANUFACTURER.
- ! ANY LOAD ATTACHED TO THE HANDLE AND/OR ON THE BACK OF THE BACKREST AND/OR ON THE SIDES OF THE VEHICLE WILL AFFECT THE STABILITY OF THE VEHICLE.

- ! TO PREVENT A HAZARDOUS, UNSTABLE CONDITION, DO NOT PLACE MORE THAN 0.5 KG IN THE CUP HOLDER.
- ! TO AVOID BURNS, NEVER PUT HOT LIQUIDS IN THE CUP HOLDER.
- ! NEVER LEAVE THE HARNESS BUCKLED WHEN NOT FITTED TO A CHILD IN THE STROLLER BECAUSE THE HARNESS CAN FORM LOOPS WHICH MAY POSE A STRANGULATION HAZARD.
- ! PLEASE KEEP THE STORAGE LATCH LOCKING CORRECTLY WHEN LIFT AND MOVE THE UNIT. PLEASE TRANSPORT THE FOLDED STROLLER SAFELY.
- ! CARE SHOULD BE TAKEN IF THE PRAM OR STROLLER IS USED ON STAIRS OR ESCALATORS.
- ! THE STROLLER IS NOT BE USED NEAR AN OPEN FIRE OR EXPOSED FLAME.
- ! THE VEHICLE IS DESIGNED FOR USE ON FLAT OR GENTLY SLOPING SURFACES AND MAY BE UNSTABLE ON HIGHER SLOPING AND UNEVEN SURFACES; RESULTING IN THE POSSIBILITY OF THE VEHICLE TIPPING OVER.
- ! THERE IS POTENTIAL FOR FINGERS OR PARTS OF THE BODY TO BE INJURED WHEN THE VEHICLE IS BEING FOLDED OR UNFOLDED AND THAT DUE CARE SHOULD BE EXERCISED.
- ! THE VEHICLE IS NOT TO BE USED AS AN UNSUPERVISED SLEEPING ENVIRONMENT.
- ! DO NOT USE THIS BASSINET ONCE THE CHILD CAN SIT UP UNAIDED.
- ! DO NOT USE FOR UNSUPERVISED SLEEPING.

# Stroller Assembly

Please read all the instructions in this manual before assembling and using this product.

## Open Stroller

see images ① - ③

Separate the storage latch from the storage mount. ①

Lift the handlebar upwards. A “clicking” sound will confirm that the stroller is completely open. ②

For the first use of the stroller, press the footrest down to reset it ③ - 1, then connect the hook and loop fastener under the calf support ③ - 2.

! Check that the stroller is completely open by pushing down on the handlebar.

## Assemble & Detach Front Wheel

see images ④ - ⑤

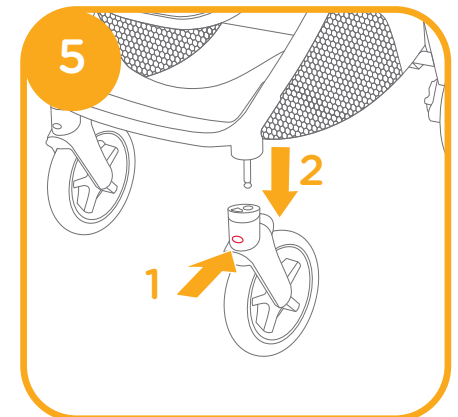
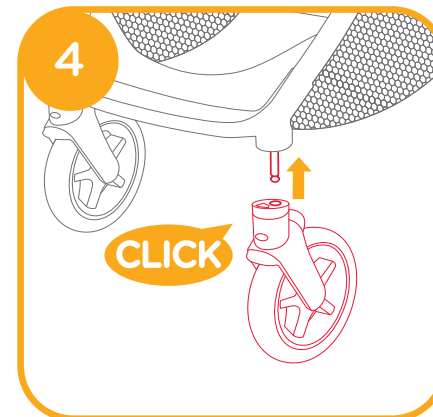
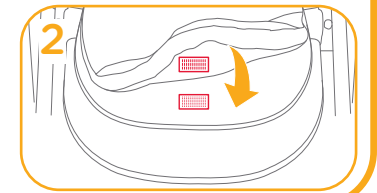
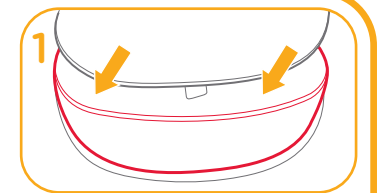
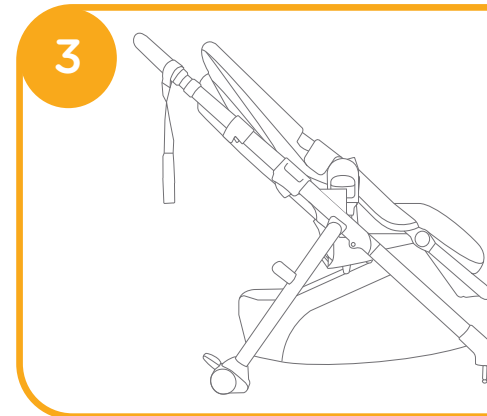
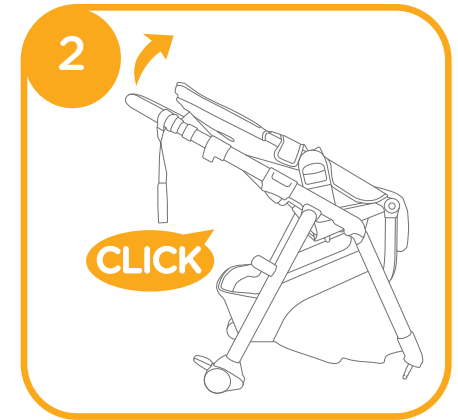
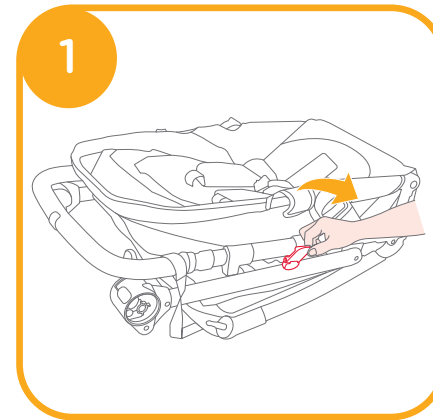

## Assemble & Detach Rear Wheel

see images 6 - 7

## Assemble Canopy

see images 8 - 9

Clip the canopy mounts to both sides of the stroller frame. Ensure that the canopy's elastic loops are attached to the canopy mounts. 8

Attach the hook and loop fasteners on the rear flap of the canopy to the top of the seat. 9

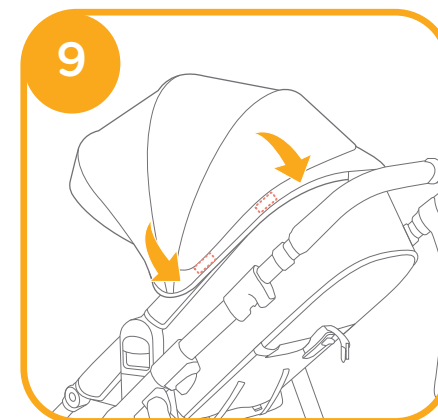
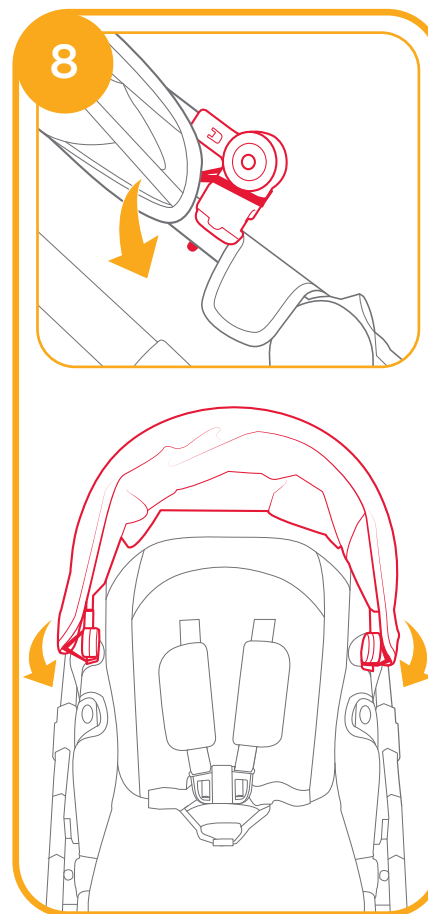
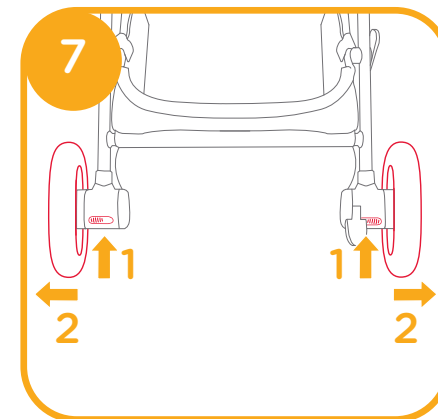
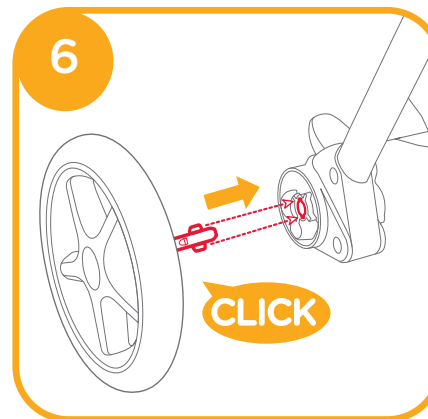

## Assemble & Detach Cup Holder

see images 10 - 12

Wrap the cup holder clasp around the right side of the stroller frame. 10

A “clicking” sound will confirm that the cup holder clasp is properly secured. 11

To remove the cup holder, unhook the cup holder clasp from around the stroller frame and remove. 12

! TO AVOID BURNS, never put hot drinks in the cup holder.

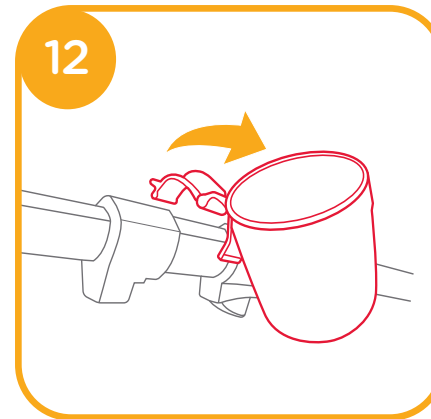
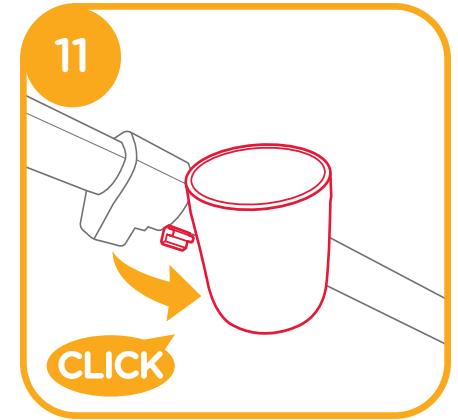
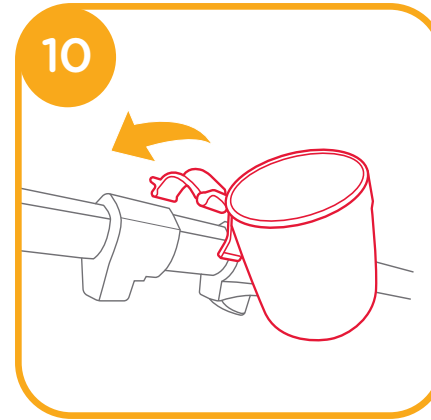

## Assemble & Detach Armbar

see images 13 - 15

### Attaching the Arm Bar:

Insert both ends of the arm bar into the arm bar mounts. A “clicking” sound will confirm that the arm bar is properly locked in place. 13

### Detaching the Arm Bar:

To remove the arm bar, press the arm bar release buttons 14 - 1 and pull the arm bar out. 14 - 2

### Rotating the Arm Bar:

Press and hold one arm bar release button 15 - 1 while lifting up to rotate the arm bar at the arm bar mount on the other side of the stroller 15 - 2.

The completely assembled stroller is shown as 16

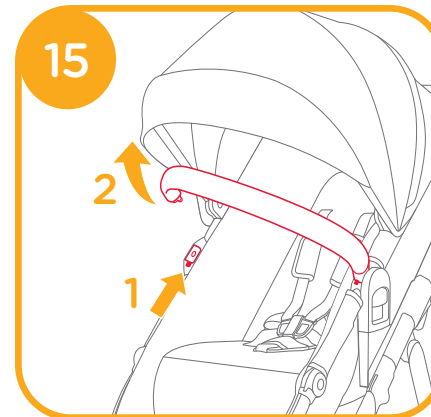
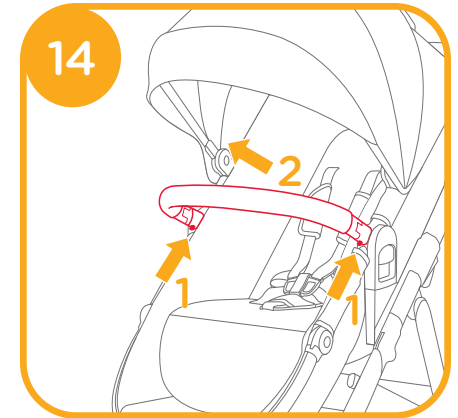
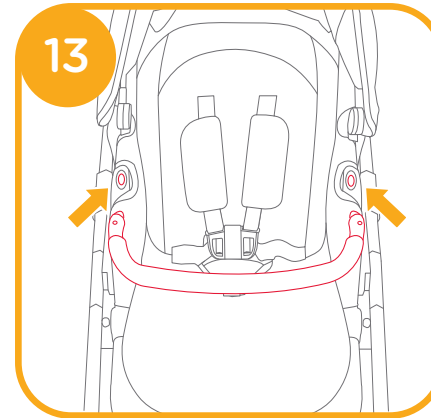

# Stroller Operation

## Use Buckle

see images 17 - 18

### Release Buckle

Press the center button to release the buckle. 17

### Lock Buckle

Match the waist belt buckle with the shoulder buckle 18 - 1, and click into the center buckle 18 - 2. A “click” sound means the buckle is locked completely. 18 - 3

- ! Always secure the child with the harness. The arm bar is not a restraint device.
- ! Make sure your child is snugly secured. The space between the child and the shoulder harness is about the thickness of one hand.
- ! Do not cross the shoulder belts. This will cause pressure on a child’s neck.

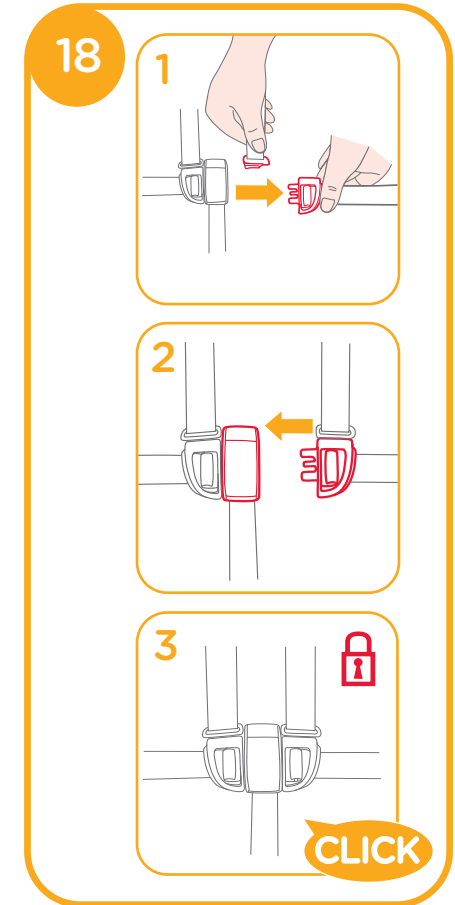
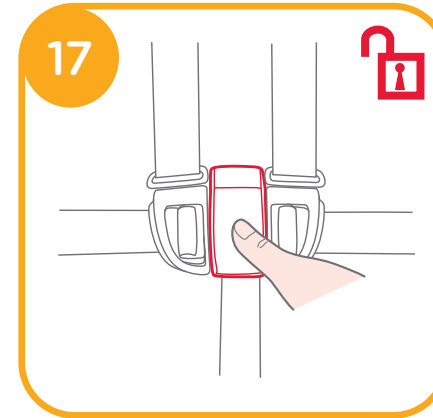

## Use Shoulder & Waist Harnesses

see images 19 - 22

Locate the shoulder harness anchors on the back of the seat. 19

Turn the harness anchor to be in line with the harness strap. Thread it through the shoulder harness slot from back to front. 20

Re-thread the harness anchor through the correct slot from front to back. Ensure that both sides are adjusted to slots at the same height. 21

Use the slide adjuster 22 - 1 to adjust the length of the shoulder harness straps. Pull the waist harness strap 22 - 3 to tighten the waist harness. Press the button 22 - 2 on the waist belt buckle and pull to loosen the waist harness strap 22 - 3.

! If converting from pramette to stroller, don't forget to thread the harnesses from underneath the seat liner to the front side.

! ALWAYS USE THE HARNESS WHEN IN STROLLER MODE.

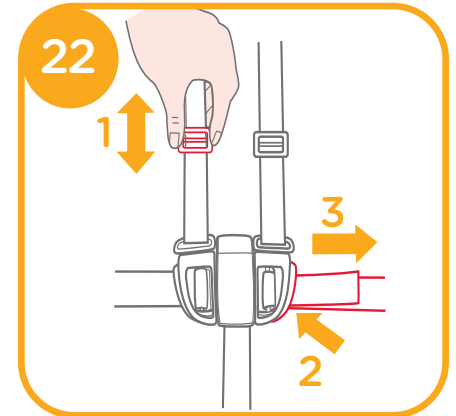
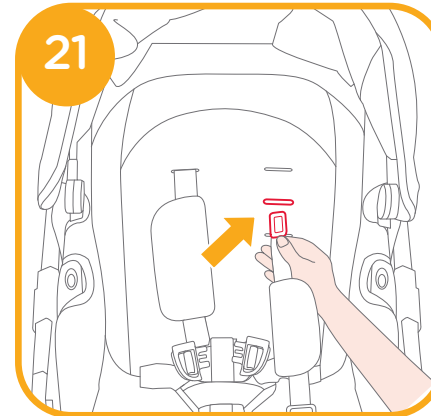
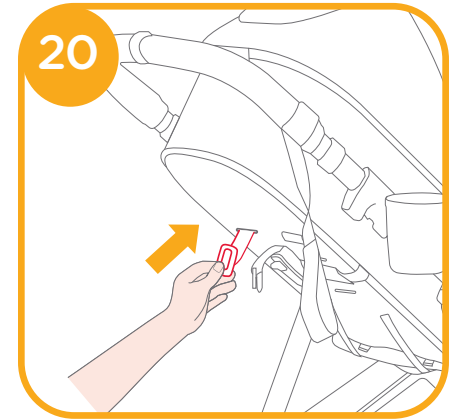
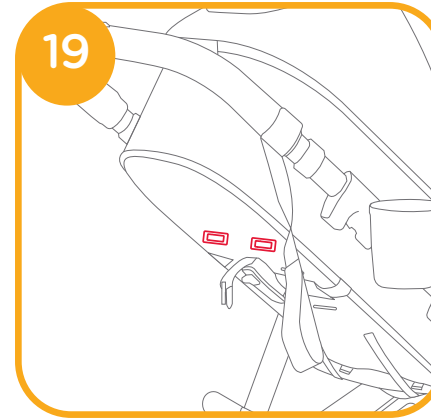

## Adjust Backrest

see images 23 - 24

### Recline Backrest

Press the button in the center of the recline adjuster while pulling the backrest backward.

### Raise Backrest

Push the backrest forward while pulling the webbing at the end of the recline adjuster.

! When making adjustments to the recline, make sure the child's head, arms, and legs are clear of moving seat parts and the stroller frame to prevent injury.

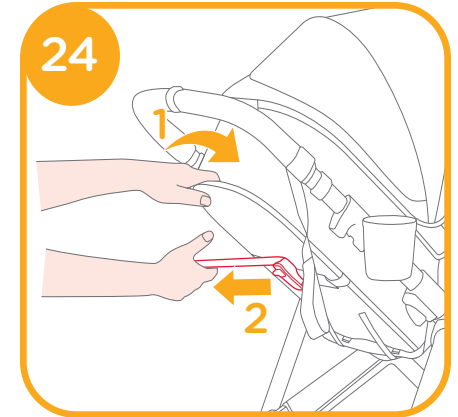
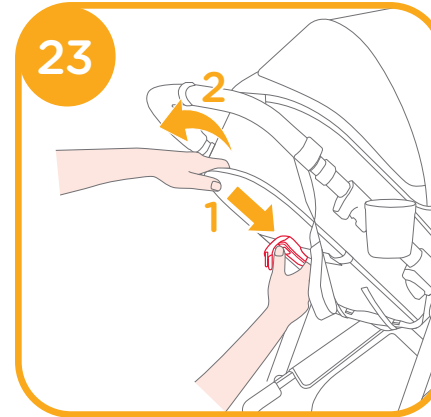

## Adjust Calf Support

see images 25 - 26

### Raising the Calf Support:

Lift the 2-position calf support upwards. A “clicking” sound will indicate that it is properly locked in place. 25

### Lowering the Calf Support:

Press the calf support adjustment buttons on both sides of the calf support 26 - 1 and rotate the calf support downwards 26 - 2.

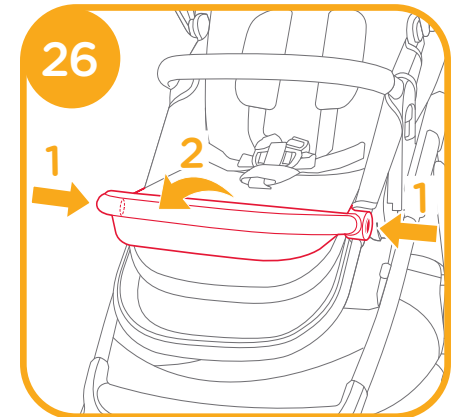
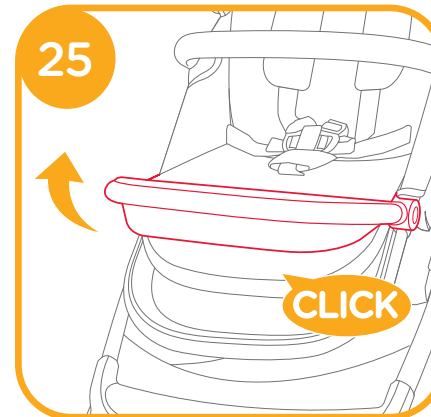

## Use Pramette

see images 27 - 34

For Pramette Mode:

Fully recline the backrest and fully lower the calf support.

On the back of the seat, pull the pramette seat lever 27 - 1 while pulling down on the seat to pivot the seat to the lay-flat position 27 - 2.

To switch the direction of the pramette, squeeze the seat release buttons on both sides 28 - 1 while lifting the pramette up 28 - 2. Turn the pramette to the reverse direction and then reinsert the pramette onto the mounts.

The pramette can be used rear-facing 29 30 31 32. Tuck away harness set underneath seat liner through the slots.

! DO NOT use the arm bar as a carry handle when in pramette mode.

! The pramette has been designed to use from birth.

! STOP using this mode when the child begins trying to push up on their hands and knees.

! DO NOT use an additional mattress in pramette mode.

! DO NOT reverse the seat with a child in the stroller.

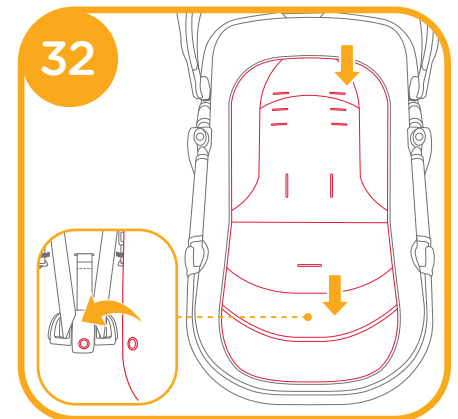
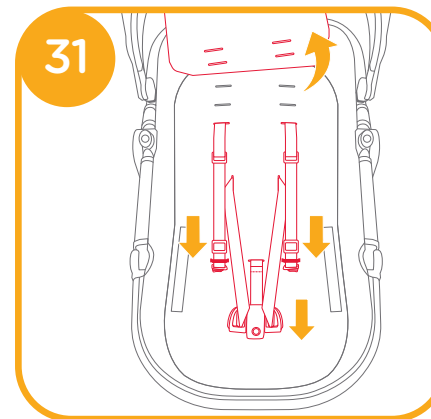
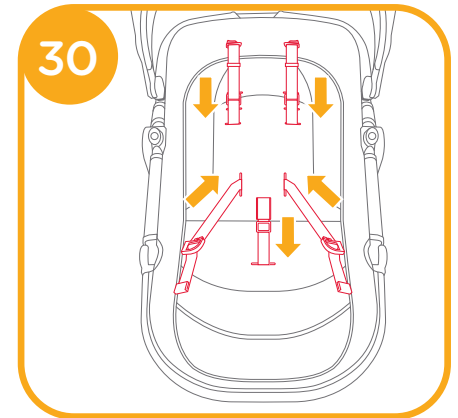
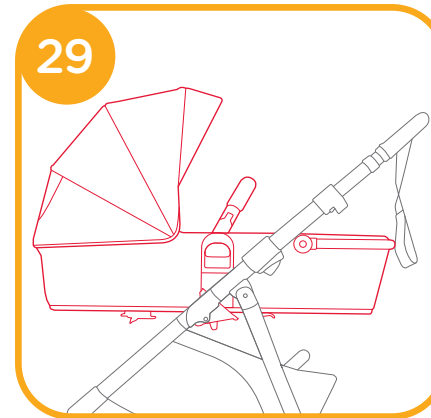
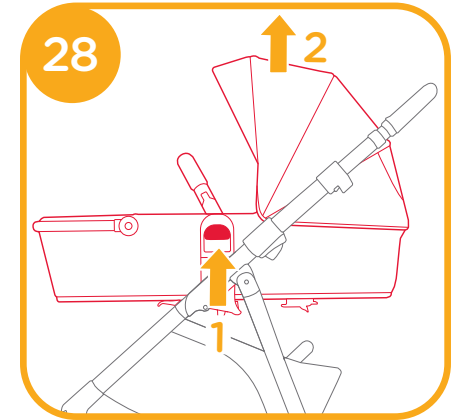
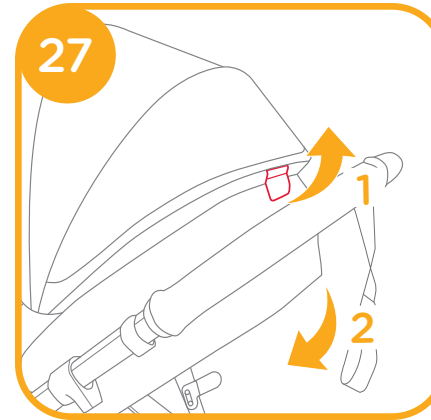

! DO NOT raise the backrest in pramette mode 33.

To return the seat to the upright position, pull the pramette seat lever, while pulling up on the seat 34.

! When converting back to stroller mode, ensure the harness set is threaded back through the seat pad slots, ready to be used again.

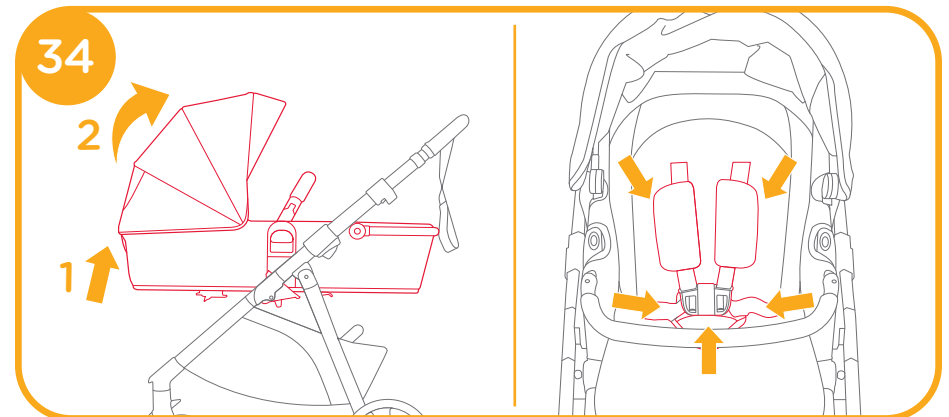
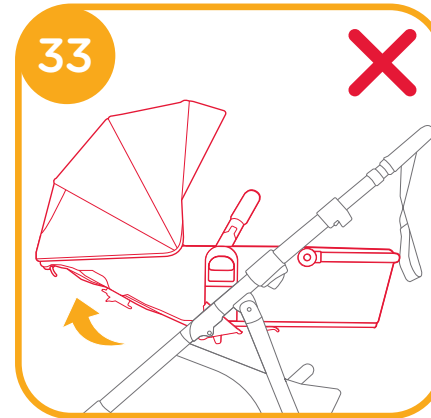

## Use Front Swivel Lock

see image 35

Locking the Wheels:

Ensure that the front wheels are positioned straight ahead, not angled to the side or turned around.

The swivel locks are located on the backside of each wheel.

Rotate each swivel lock clockwise. A “clicking” sound will confirm that the wheels are properly locked in a straight position.

Unlocking the Wheels:

Rotate each swivel lock counter-clockwise. The wheels will swivel freely again.

! It is recommended to use the swivel locks on uneven surfaces.

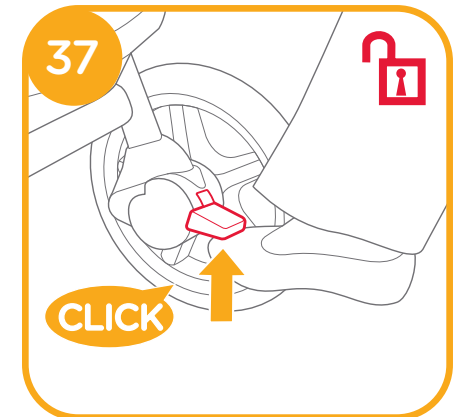
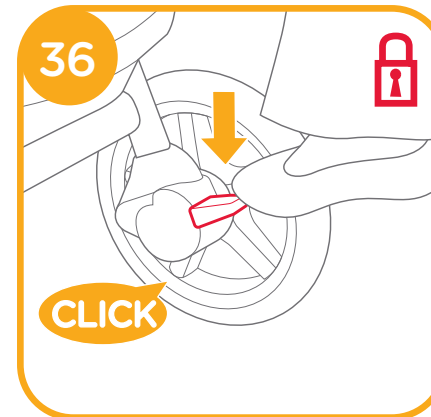
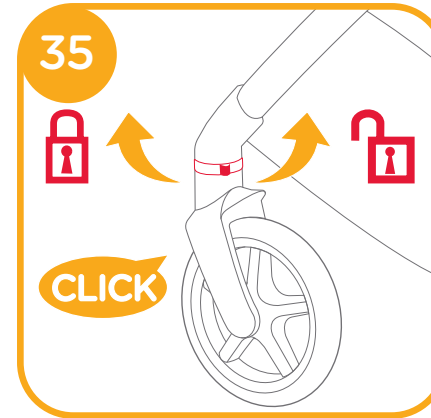

## Use Brake

see images 36 - 37

To lock the rear wheels, step down on the brake lever. 36

To release wheels, just lift the brake lever upwards. 37

! Always apply the brake when the stroller is stopped.

Push the stroller slightly to ensure the brake is engaged.

## Use Canopy

see images 38 - 40

To open, pull the canopy forward toward the front of the seat. To close, push the canopy back. 38

For extended canopy coverage, unzip the canopy zipper and pull the canopy fully forward. 39

For additional airflow, flip the canopy window cover up. 40

## Use Shoulder Harness Cover and Crotch Harness Cover

see images 41 - 42

The shoulder harness cover or crotch harness cover can be removed from the webbing.

To assemble shoulder harness cover and crotch harness cover in reverse steps.

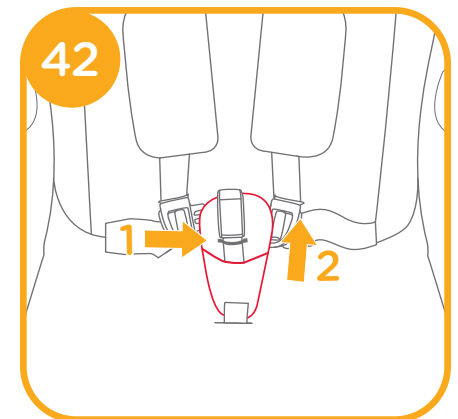
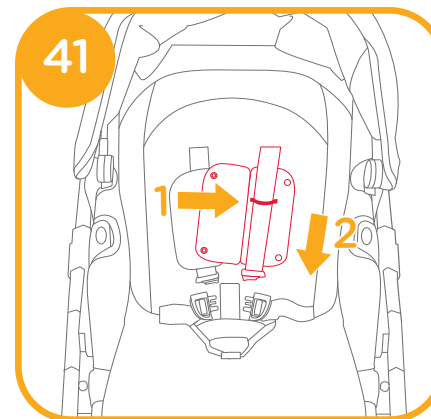
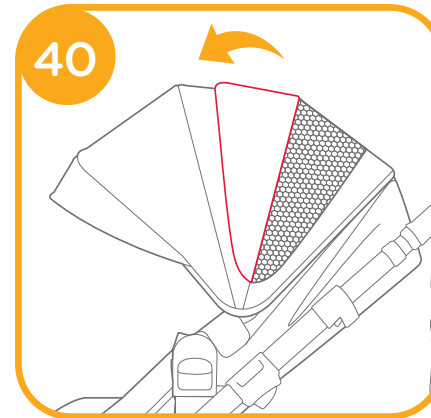
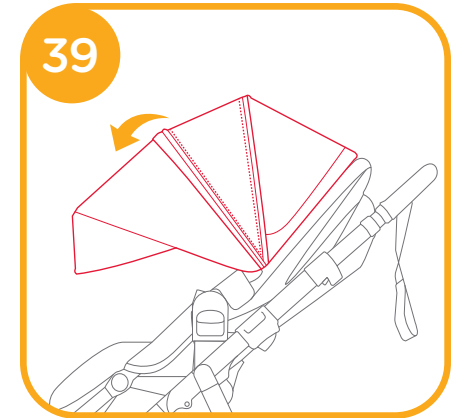
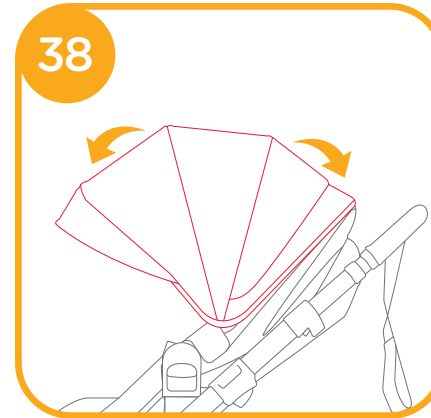

## Adjust Handle

see image 43

The handle has 3 positions.

## Adjust Seat Height

see images 44 - 46

The seat has 3 positions.

To raise the seat height, pull up on the seat. A “clicking” sound will confirm that the seat is properly locked in place.

44

! DO NOT raise the seat by pulling up on the arm bar.

To lower the seat height, squeeze and hold the seat height adjustment buttons and push down on the seat. 45

Lock the seat in position by releasing the height adjustment buttons. A “clicking” sound will confirm that the seat is properly locked in place. 46

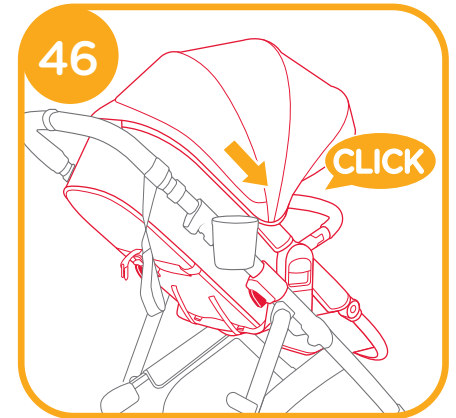
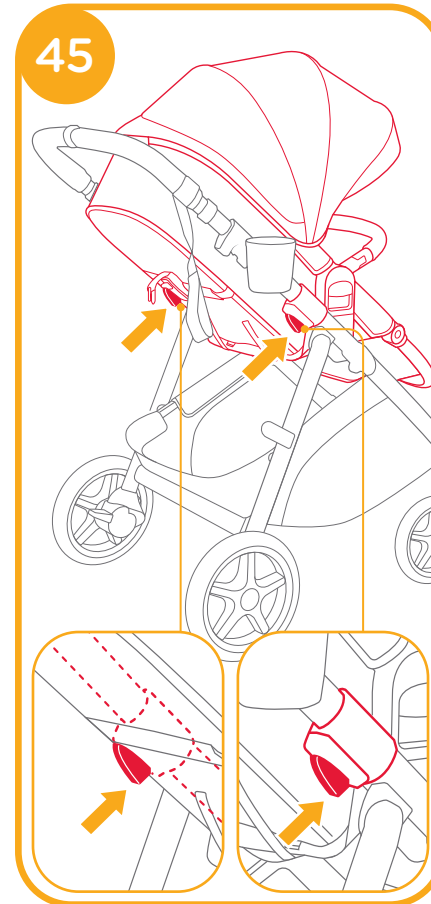
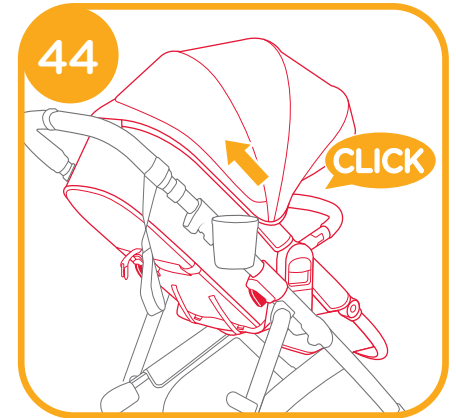
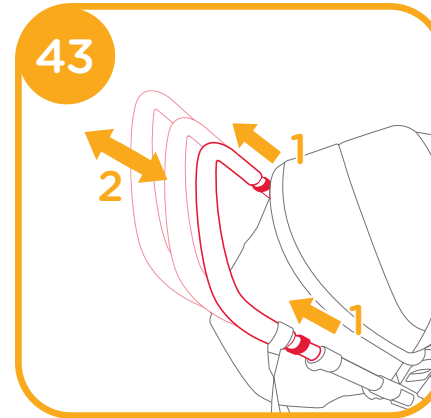

## Switch Seat

see images 47 - 51

The seat is reversible so the child can face rearward or forward.

Squeeze the seat release buttons on both sides of the seat 47 - 1 while lifting the seat up 47 - 2. Turn the seat to the reverse the direction and then reinsert the seat onto the seat mounts. A “clicking” sound will confirm that the seat is properly locked in place.

The seat mounts must be level for the seat to attach to the frame. 48

If the mounts are uneven 49

Squeeze and hold the seat height adjustment buttons to unlock the seat mount. 50

Pull up or push down on the seat mounts to adjust them to the same seat height. Lock the seat mounts into position by releasing the seat height adjustment buttons. 51

! DO NOT reverse the seat with a child in the stroller.

## Use Tether Strap

Use the tether strap to prevent the stroller inadvertently rolling away. Check that when your hand is through the loop, it allows you to easily control the stroller.

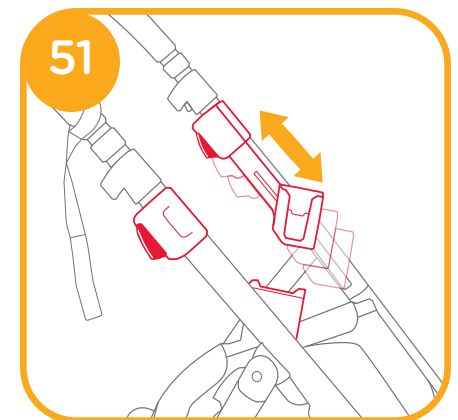
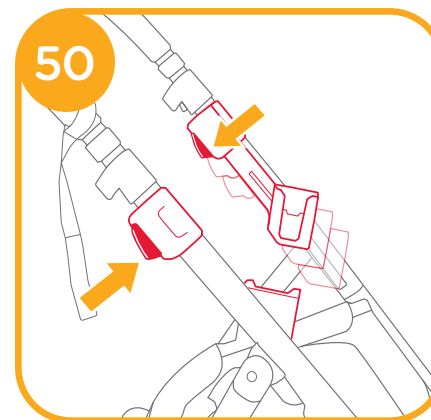
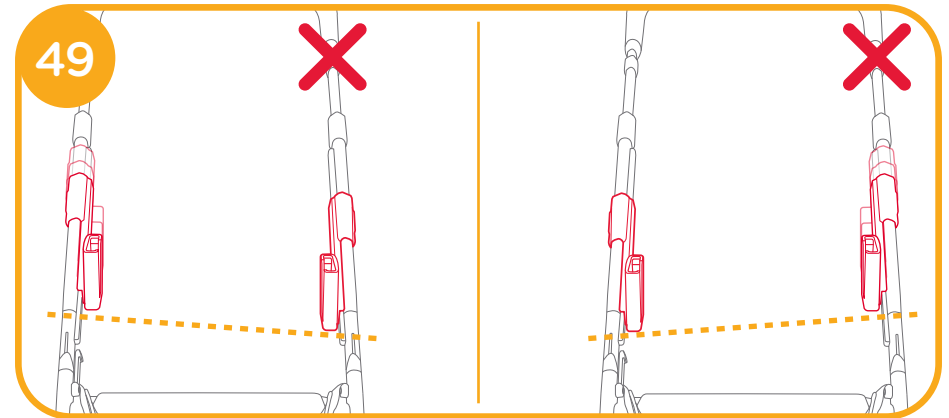
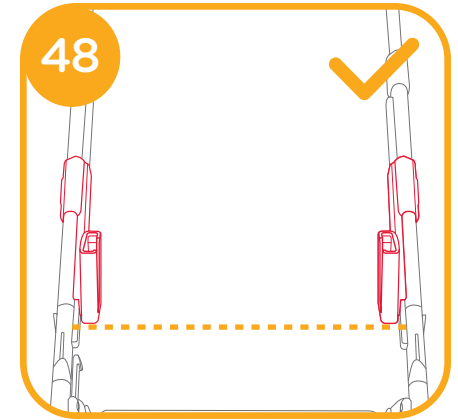
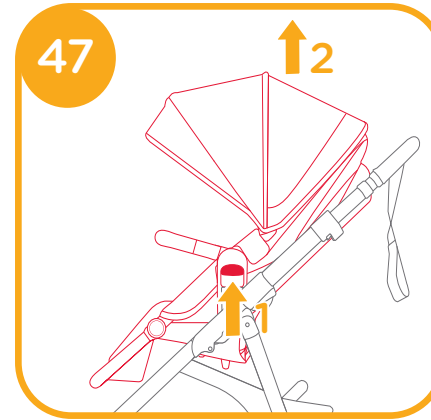

## Fold Stroller

see images 52 - 55

Press in the secondary fold lock button located on the left fold release tab 52 - 1. Pull upwards on both fold release tabs 52 - 2 simultaneously and hold them in position.

Push down on the handlebar to fold the stroller. If the seat is not in the highest position, it will slide upwards. 53

The fold latch will engage automatically when the stroller is fully folded. 54

! DO NOT fold the stroller with the seat rear-facing. 55

! Do not fold the stroller with the front wheels locked.

! Do not fold the stroller while in pramette mode.

! The stroller can stand when folded when the handlebar is in the middle position.

You can lift the rear leg to transport the unit safely after folding the stroller.

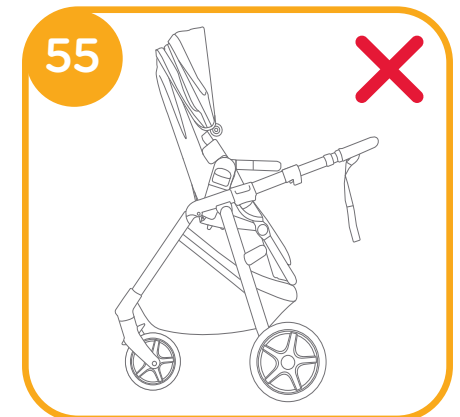
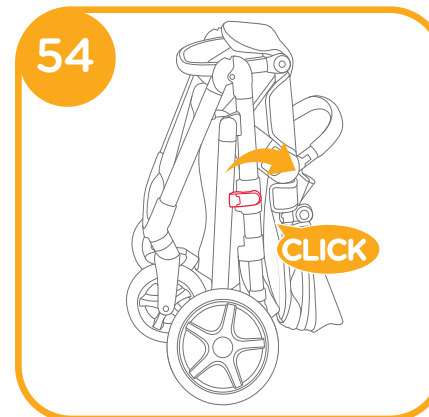
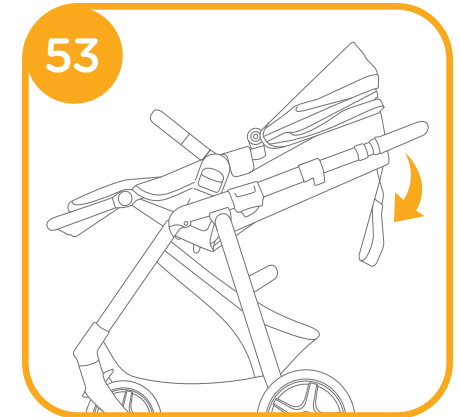
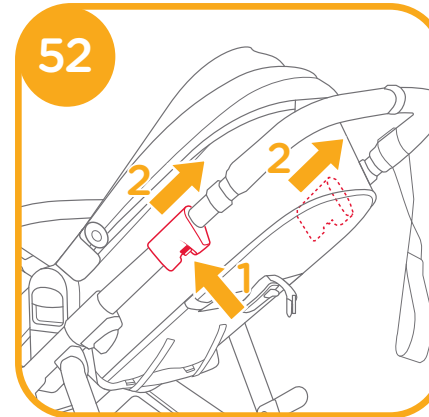

## Cleaning and Maintenance

see image 56

- ! To clean stroller frame, use only household soap and warm water. No bleach or detergent. Please refer to the care label for instructions on cleaning the fabric parts of the stroller.
- ! Removable soft goods can be washed by machine. No bleach. Do not twist the seat cover and inner padding to dry with great force. It may leave the seat cover and inner padding with wrinkles.
- ! From time to time, check your stroller for loose screws, worn parts, torn material or stitching. Replace or repair the parts as needed. Periodically wipe clean plastic parts with a soft damp cloth. Always dry the metal parts to prevent the formation of rust if the stroller has come into contact with water.
- ! Excessive exposure to sun or heat could cause fading or warping of parts.
- ! If stroller becomes wet, open canopy and allow to dry thoroughly before storing.
- ! If wheels squeak, use a light oil (e.g., Silicon Spray, anti-rust oil, or sewing machine oil). It is important to get the oil into the axle and wheel assembly. 56
- ! When using your stroller at the beach or other sandy/dusty environments, completely clean your stroller after use to remove sand and salt from mechanisms and wheel assemblies.

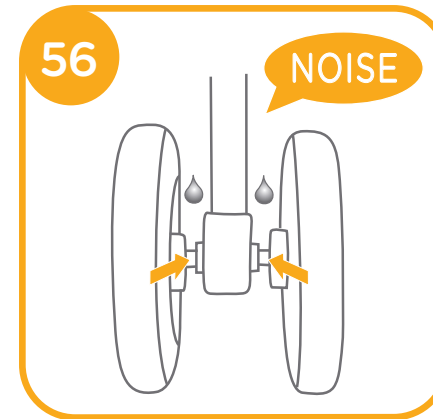



Distributed by Allison AU Pty Ltd

ACN: 642 240 140

Unit 1, 35 Lyn Parade

Prestons

NSW Australia 2170

For after-sales & warranty service, contact:

1800 951 070

[customerservice@allisonau.com.au](mailto:customerservice@allisonau.com.au)