



birth to 15kg

Bunya™

Travel Cot

Instruction Manual

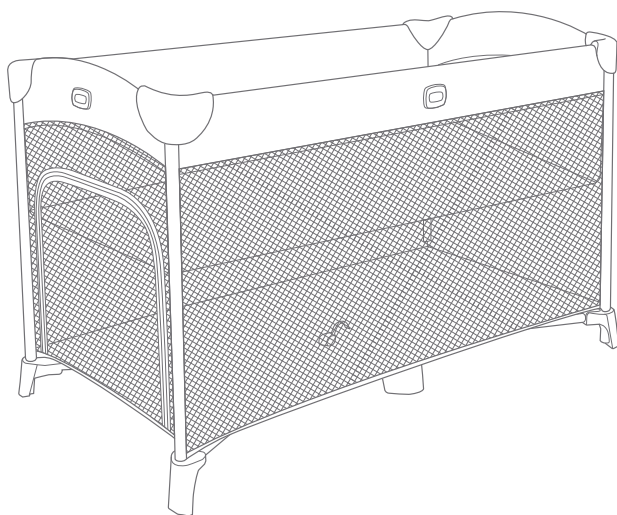

IMPORTANT

BEFORE ASSEMBLING THIS COT READ AND UNDERSTAND THE INSTRUCTIONS.

Do not use mattress other than the one supplied by the manufacturer.

Incorrect mattress can cause death.

Use only accessories as recommended by the manufacturers.

Ensure the top rails and base are fully locked.

Stop using this cot if any part of the cot is broken, torn or missing.

KEEP THESE INSTRUCTIONS IN A SAFE PLACE FOR FUTURE REFERENCE.

Travel Cot Assembly

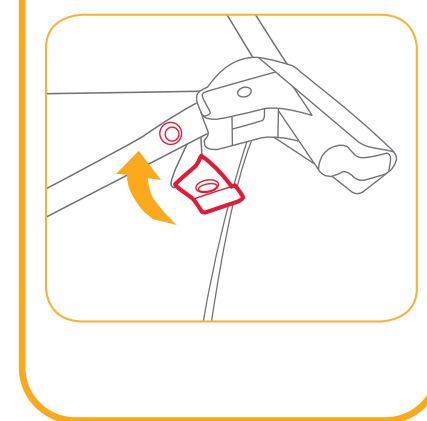
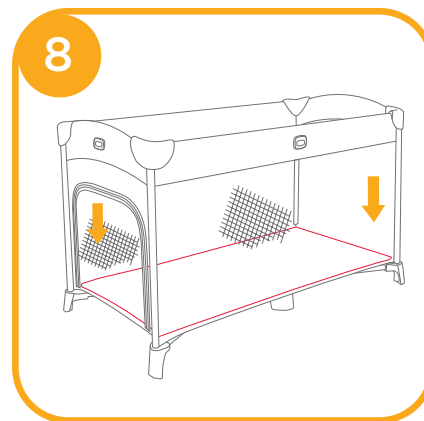
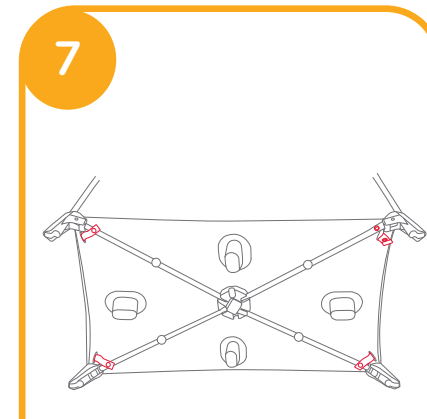
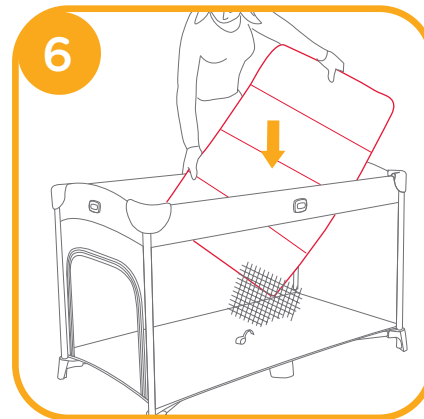
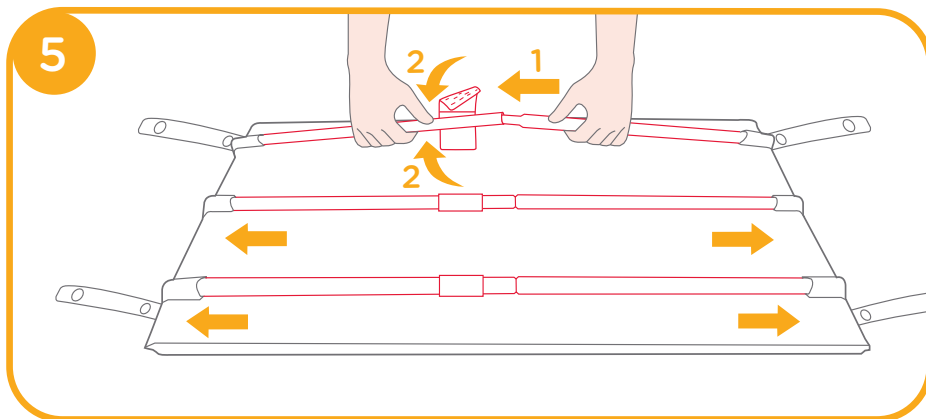
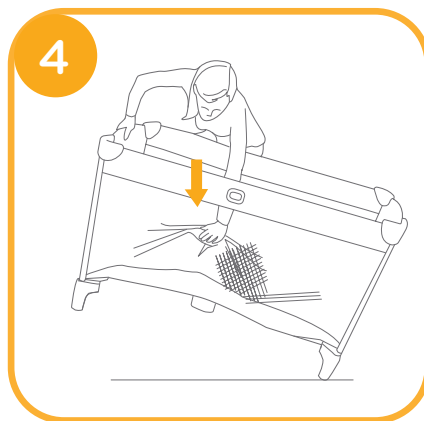
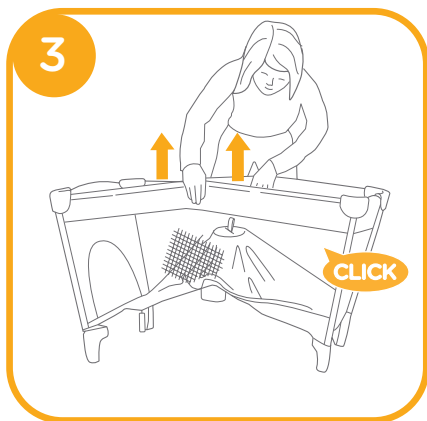
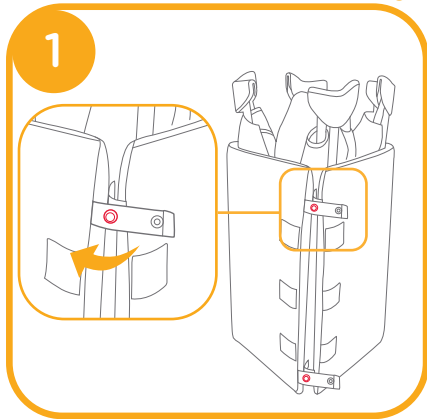

Fold Travel Cot

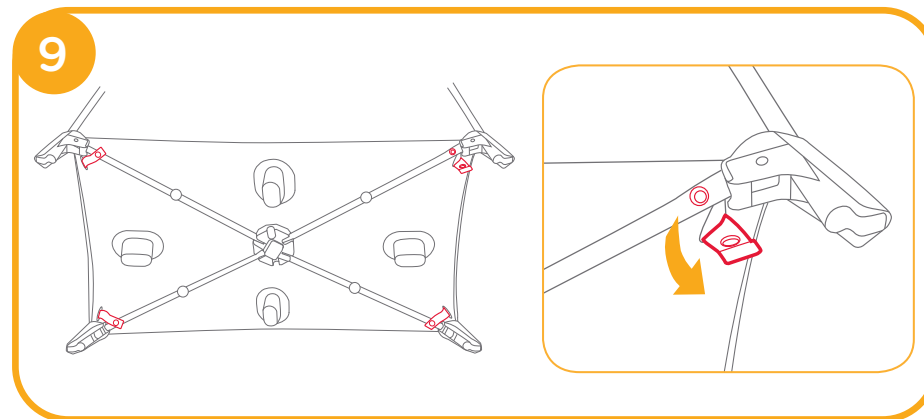

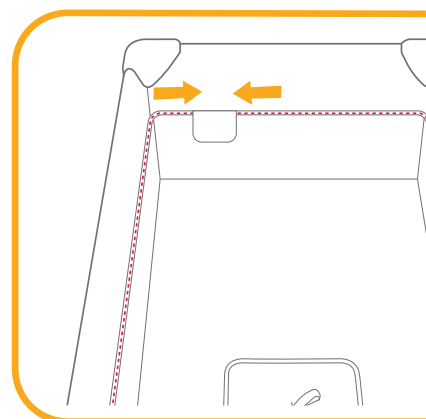
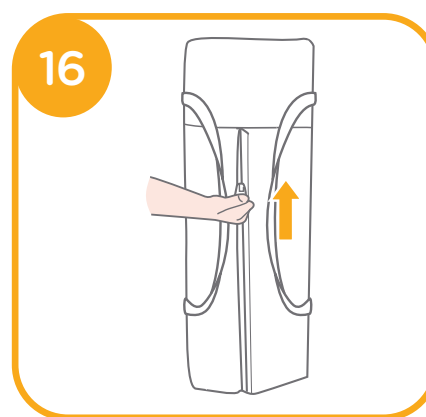
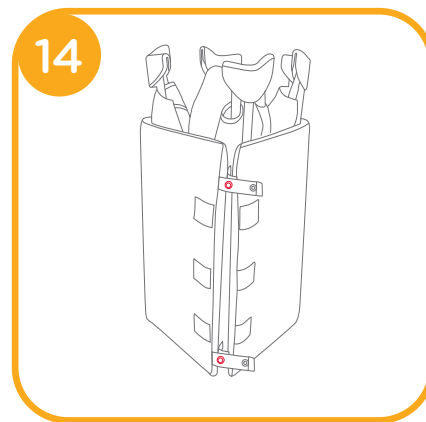
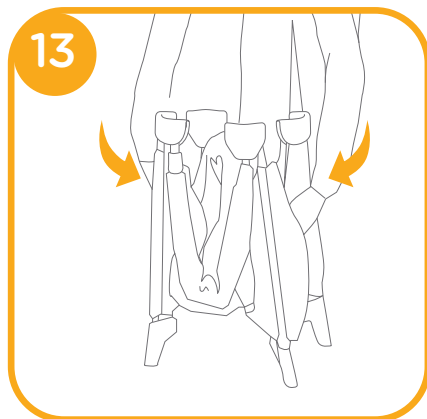
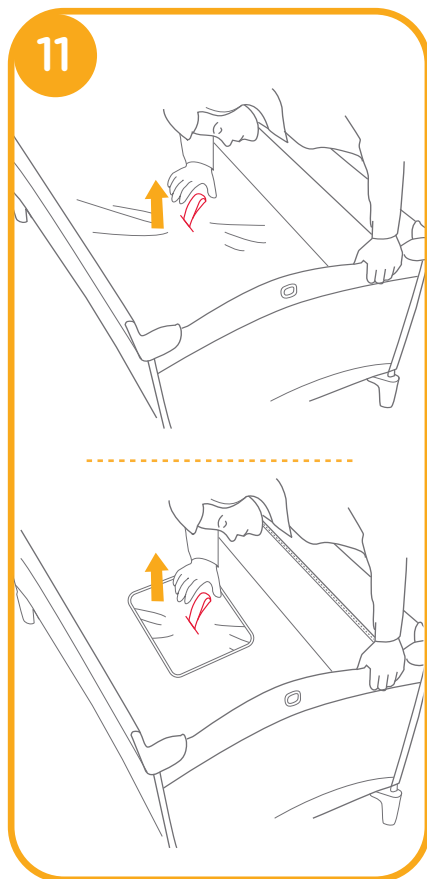
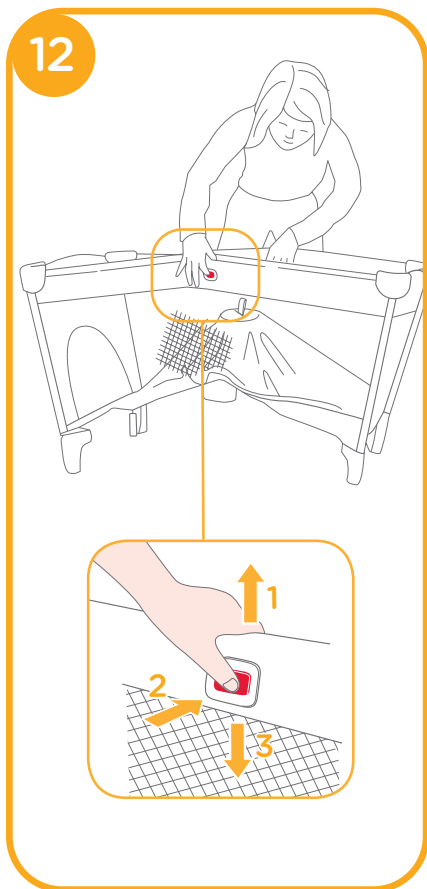
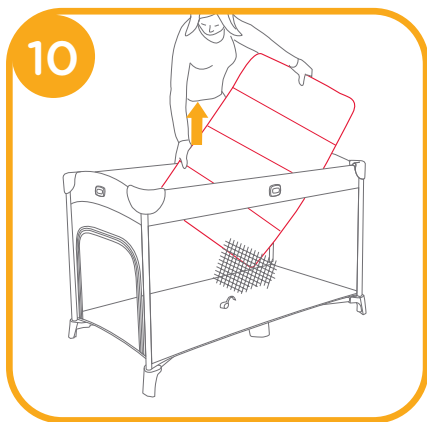

Cover Travel Cot

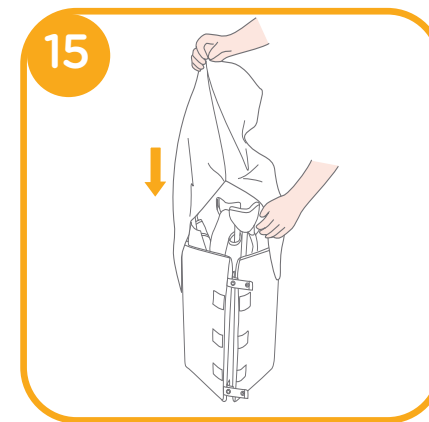

Bassinet Assembly

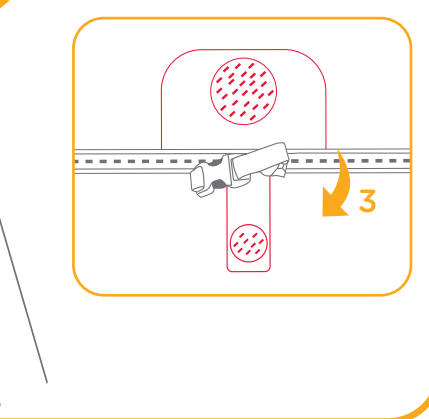
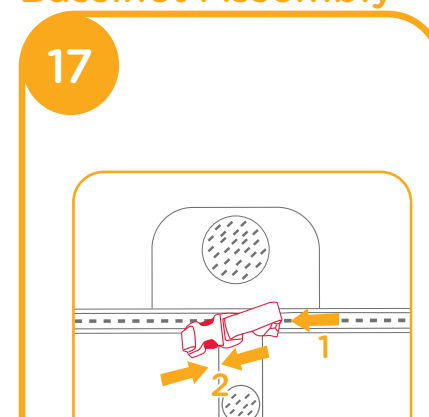

NOTE

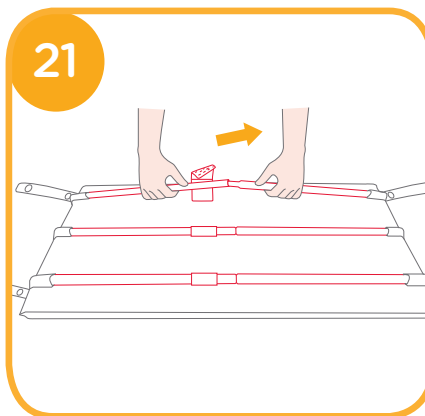
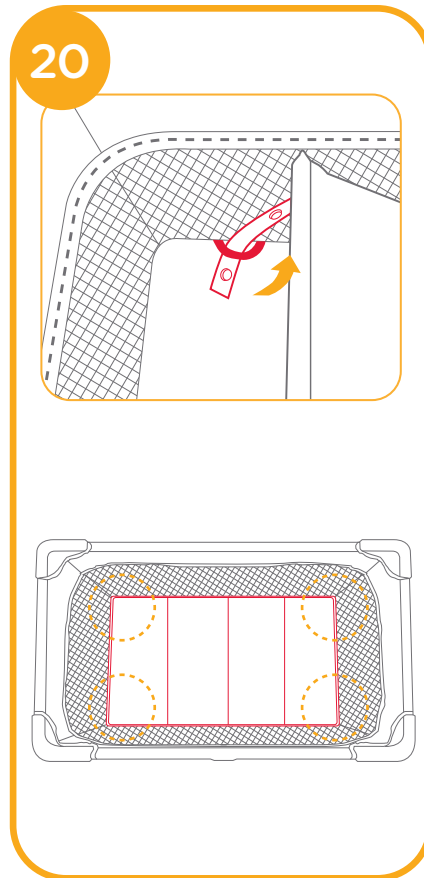
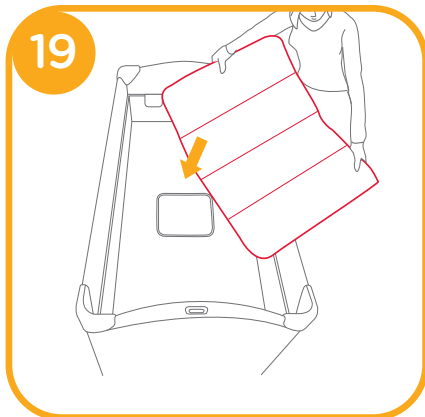
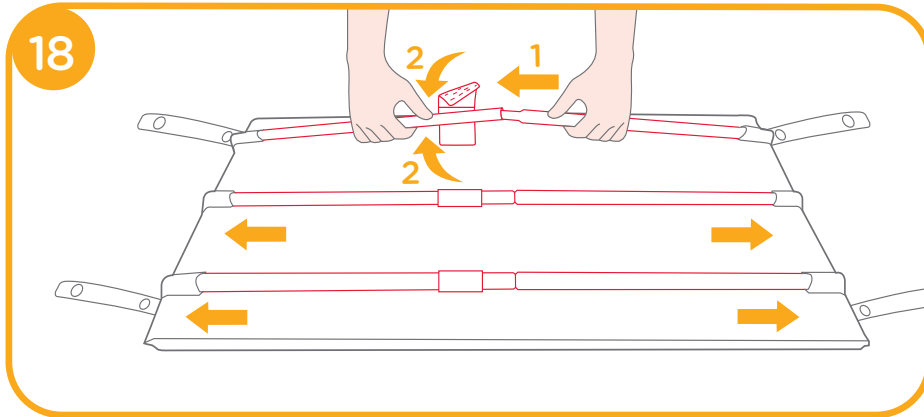

Congratulations on becoming part of the Joie family! We are so excited to be part of your life with your little one. While using the Joie Bunya™, your baby is enjoying a high quality, fully certified travel cot. This product is suitable for use with children weighing under 15kg (approximately 0-36 months). Please carefully read this manual and follow each step to ensure a comfortable sleeping and best protection for your child.

Please keep the Instruction Manual handy for future reference.

Visit us at Joiebaby.com to download manuals and see more exciting Joie products.

For warranty information, please visit our website at joiebaby.com

Emergency

In case of emergency or accident, it is most important to have your child taken care of with first aid and medical treatment immediately.

Product Information

Read all the instructions in this manual before using this product. If you have any further questions, please consult the retailer. Some features may vary depending on model.

Product: Bunya™ Travel Cot
Suitable for: Birth to 15kg (approximately 0-36 months)

Product: Bassinet
Suitable for: Discontinue using bassinet when child can sit, kneel or roll over or pull itself or has reaches 9kg (approximately 0-6 months).

Materials: Plastics, metal, fabrics
Patent No.: Patents pending
Made in: China
Brand Name: Joie
Website: www.joiebaby.com

Parts List

Make sure all parts are available before assembly. Accessories may be sold separately or may not be available depending on region. If any part is missing, please contact local retailer. No tools are required for assembly.

- | | | |
|----------------|--------------|--------------------|
| 1 Travel Cot | 5 Bassinet | 9 Latch Button |
| 2 Mattress | 6 Corner | 10 Foot |
| 3 Carry Bag | 7 Long Rail | 11 Folding Webbing |
| 4 Support Tube | 8 Short Rail | |

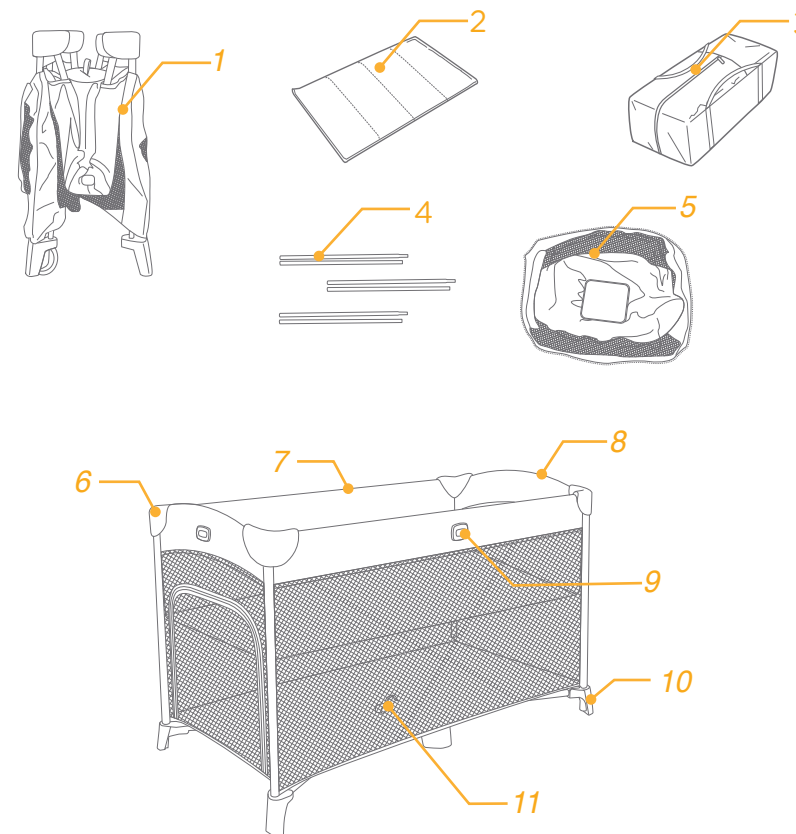

WARNING

Read carefully and keep this manual for future reference. Failure to follow these instructions and warnings could result in serious injury or death.

Be sure the product is completely setup before use.

Keep children away while assembling/disassembling the product.

Check the assembly is correct and safe.

Ensure The Top Rails And Base Are Fully Locked. Check the locking devices are fully engaged. Always use on a flat, level floor.

Do not add a second mattress.

USE ONLY THE MATTRESS SUPPLIED BY THE MANUFACTURER, INCORRECT MATTRESSES CAN CAUSE DEATH.

Use only accessories provided or recommended by Joie.

Check this product regularly before using it, and do not use it if any part is loose or missing or if there are any signs of damage.

Do not substitute parts. Contact the supplier if replacement parts or additional instructions are needed.

Place infant on their back when using this product.

Infants should be placed on a firm, flat surface to sleep.

Do not put objects or accessories in an infant's sleep environment.

Do not place this product near a blind, cord, strap or similar item that could become wrapped around an infant's neck.

Do not use this product near heat sources, bar heaters, open fires or exposed flames.

Do not leave anything on the product (such as toys) that provide a foothold.

Keep this product clear of trailing cables and hanging cords.

Keep medication and small items that a child could choke on, away from the cot.

Folding cots with padded rims should be not be used if the covering material has been bitten through.

To avoid suffocation, remove plastic bag and packaging materials before using this product. The plastic bag and packaging materials should then be kept away from babies and children.

BASSINET: Do not use this product when the infant begins to push up on hand and knees or has reached (9kg), whichever comes first. Use with only one child at a time.

THIS BASSINET SHOULD BE REMOVED BEFORE THE CHILD CAN SIT UP.

TO PREVENT FALLS, THE BASSINET MUST NOT BE USED ONCE A CHILD CAN SIT UP.

COT: Never place a child in the cot when the bassinet is in place. Remove the bassinet before using the cot.

PLAYPEN: Remove the bassinet before using the playpen. Never leave your child unattended in the playpen. Always keep your child in view.

Size of the mattress: 1180mm*570mm*21mm.

Carry out the assembly of the folding cot in a particular order.

Secure, tighten and maintain all fastening devices.

Do Not Use This Cot If Any Part Of The Cot Is Broken, Torn Or Missing.

Travel Cot Assembly

see images ① - ⑧

Please read all the instructions in this manual before setting up and using this product.

1. Undo the four snaps. ①
2. Pull the top rails up until both become rigid. If not rigid, pull up again until they are rigid. ②
 - ! If top rails do not latch, raise the center of floor halfway up, and then pull up again to latch the rails.
3. Latch the low rails. ③
4. Push the base of floor down. ④
 - ! Be sure all rails have locked before lowering base.
4. Assemble the support tubes. ⑤
5. Install mattress. ⑥
6. Pull the strap through the button hole on the bottom of the travel cot. Fasten the snap on the tube. Repeat on the other corners. ⑦
 - ! Push down on all four corners of the mattress to ensure the mattress is secured to the bottom of the travel cot.
7. Install mattress, soft side up. ⑧
 - It can be used when the installation mode is correct.
 - ! Take care and pay attention when assembling the cot to prevent injury.
 - ! When using the cot mode, the playpen zipper buckle can not be opened.

Fold Travel Cot

see images ⑨ - ⑭

1. Remove the mattress. ⑨ ⑩
 - ! Remove support tube as shown in ⑮
2. Pull the folding webbing upward. ⑪ ⑫
 - ! Do not unlock rails yet. Base of floor must be halfway up before rails will unlock.
3. Unlock all four rails by following these steps.
 - 1) Slightly lift the center of the rails. ⑫
 - 2) Squeeze the latch button on the rail to release the two tubes. ⑫
 - ! Do not force fold.
 - ! Both tubes must be released for the rail to fold, if rail does not fold completely, please lift the center of floor higher, and then try again from step 3.
4. Fold the unit, but do not force. ⑬
 - ! If unit will not fold, look for a partially latched rail. Squeeze the latch button to release the rail.
 - ! Take care and pay attention when folding the cot to prevent injury.
5. Wrap the travel cot with the mattress, attach the four snaps. ⑭

Cover Travel Cot

see images ⑮ - ⑯

Cover unit with carry bag ⑮, and then zip together. ⑯

Bassinet Assembly

see images ⑰ - ⑳

Tip Before setting up bassinet, make sure all rails have become rigid.

1. Zip up the bassinet and secure the zipper head with buckle, then cover it with flap. ⑰
 - ! Must zip up the bassinet completely without crevice before using.
2. Assemble the support tubes. ⑱
3. Place the mattress into the bassinet. ⑲
 - ! Place mattress, soft side up.
4. The installed bassinet is shown as ㉑
5. It can be used when the installation mode is correct.
 - ! When using the bassinet, the playpen zipper buckle can not be opened.
6. Remove support tube as shown in ㉒
 - ! Take care and pay attention when assembling and removing the bassinet to prevent injury.

Care and Maintenance

1. The covering material is not removable.
2. Your travel cot can be spot cleaned with a sponge and soapy water.
3. Do not use undiluted neutral detergent, gasoline or other organic solvent to wash the travel cot. It may cause damage to the travel cot.
4. To wash carry bag, machine wash in lukewarm water and drip-dry. Do not use bleach.
5. At the beach or in the garden, clean sand and grit off your travel cot. Sand in the long rail locks may cause damage.
6. From time to time, check your travel cot for worn parts, torn material or stitching. Replace or repair the parts as needed.
7. If the travel cot is not in use for a long period of time, please put it in the shade where your child cannot access it.



Distributed by Allison AU Pty Ltd

ACN: 642 240 140

Unit 1, 35 Lyn Parade

Prestons

NSW Australia 2170

For after-sales & warranty service, contact:

1800 951 070

customerservice@allisonau.com.au