

USE WITH A CHILD

Joie™

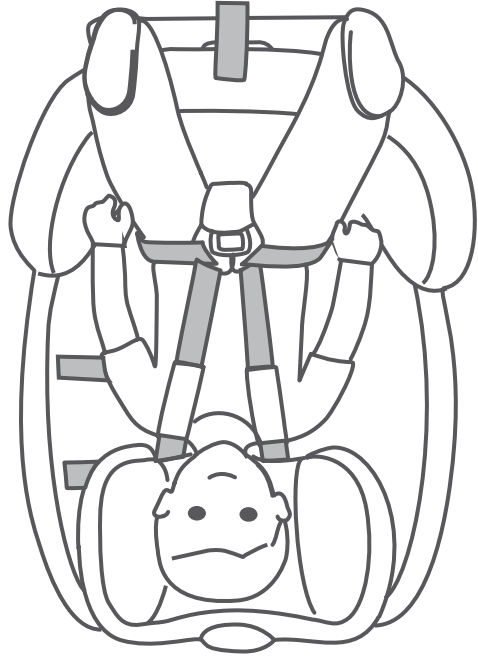

Centra™
MODEL C2109A
instruction manual



IMPORTANT: KEEP THIS INSTRUCTION BOOKLET IN THE PLACE PROVIDED AT THE BACK OF THE CHILD RESTRAINT

IMPORTANT: KEEP THIS INSTRUCTION BOOKLET IN THE PLACE PROVIDED AT THE BACK OF THE CHILD RESTRAINT



Centra™
MODEL C2109A
instruction manual



INSTALLATION
IN A VEHICLE

Joie™

CONTENTS

WARNINGS	3
ADDITIONAL WARNINGS	4 & 5
Features	6 & 7
Installation	8 - 11
CHECKLIST	12
TOP TETHER WARNINGS	13
Top Tether Features	14
Tether Anchorage Installation	15 - 17

IMPORTANT:

Before installation and use of this child restraint use the shoulder height labels to check that it is suitable for the size of your child.

Refer to the shoulder height label information on page 7 of the USE Instructions.

Read the whole of these instructions carefully and if there is any doubt about the method of installation, consult the child restraint manufacturer or agent, or a child restraint fitter, or in New Zealand an agent for the vehicle.

Distributed by Nuna Baby Australia Pty Ltd

ACN: 642 240 140

Unit 1, 35 Lyn Parade Prestons, NSW Australia 2170

For after-sales & warranty service, contact: 1800 951 070

customerservice@nunababy.com.au

WARNINGS

- Use the restraint exactly as shown in the instructions.
- Do not alter or modify this restraint.
- Repairs must only be done by the manufacturer or agent.
- Do not allow the restraint to come into contact with polishes, oils, bleach and other chemicals.
- Destroy the restraint if it has been in a severe crash, even if no damage is visible.
- A loose harness or restraint is dangerous.
- Fit the restraint firmly to the car seat.
- Supervision of children is needed because they may be able to undo the buckles.
- **DO NOT ATTACH THIS CHILD RESTRAINT TO ANY ISOFIX LOW ANCHORAGE.**

ISOFIX low anchorages in cars are designed to withstand only those loads imposed by children aged up to approximately 4 years of age in a correctly fitted and approved ISOFIX compatible child restraint. This child restraint is not approved for use with the car's ISOFIX low anchorages

- **DO NOT LEAVE CHILDREN UNATTENDED IN THE CAR**

NOTE: The warnings on this page are required by the Australian and New Zealand Standard AS/NZS 1754 for this type of child restraint. Other warnings specific to this child restraint will be found on the following pages and throughout these instructions.

ADDITIONAL WARNINGS

TO BE USED WITH A LAP-SASH/LAP ONLY SEAT BELT IN THE BACK OF MOST CARS WITH FORWARD FACING SEATS.

- When installed this restraint is 580 mm long, 490 mm wide and 860 mm high. If being installed in a small car, or a third row seating position, check to ensure the space available is sufficient.

Note: some third row seating positions have limited space.

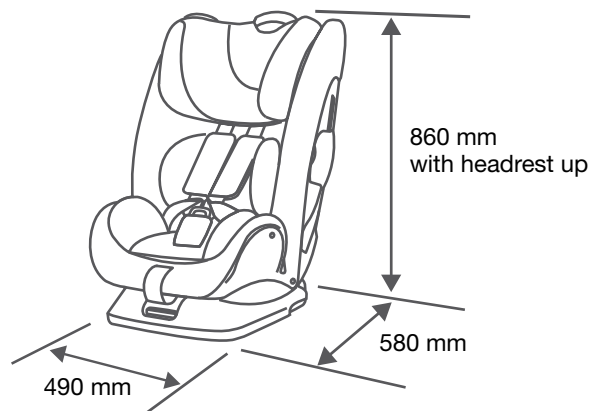

- Do not use seat belt extenders if the vehicle seat belt is not long enough to secure the child restraint. If the vehicle seat belt is not long enough to secure the restraint seek advice from a child restraint fitter.
- Aftermarket accessories (i.e. items not provided in the box with the child restraint), may not have been tested for use with this child restraint and if used, may lower the level of protection offered possibly leading to injury or death.
- Any aftermarket accessory used should be compliant with AS/NZS 8005 (Accessories for child restraints for use in motor vehicles) and stated as suitable for use with this child restraint.

ADDITIONAL WARNINGS

Only install this restraint on a forward facing vehicle seat. Never install in a seat that faces the rear or the side of the vehicle.

The safest position for this restraint is in the centre rear of the back seat provided it is fitted with a tether anchorage.

Do not use the front seating position unless there is no rear seat and there is a tether strap mounting position available behind the front seat.

Airbags

Front Seat Airbags - if using the front seating position and the vehicle is fitted with a front airbag in this position move the front seat back as far as possible.

Side or Seatbelt Airbags - if your vehicle has side or seatbelt airbags consult the Vehicle Owners Handbook for information regarding suitable child restraint installation positions. If in doubt refer to an approved child restraint fitter for advice.

Sash Belt Airbags - some vehicles have airbags attached to the sash belt. Before installing the restraint with this type of seatbelt refer to the vehicle owners manual or an approved child restraint installer.

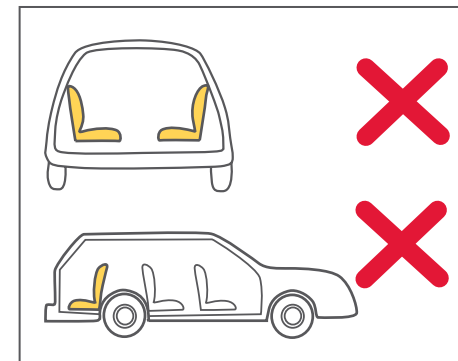

Features

- | | | | |
|---|--------------------------------|----|------------------------|
| 1 | Headrest height Adjuster | 6 | Positioning Bar Latch |
| 2 | Seat Cover | 7 | Crotch Pad |
| 3 | Harness QR Buckle | 8 | Shoulder Harness Strap |
| 4 | Harness Adjuster (under cover) | 9 | Shoulder Pads |
| 5 | Harness Adjuster Webbing | 10 | Infant Body Support |

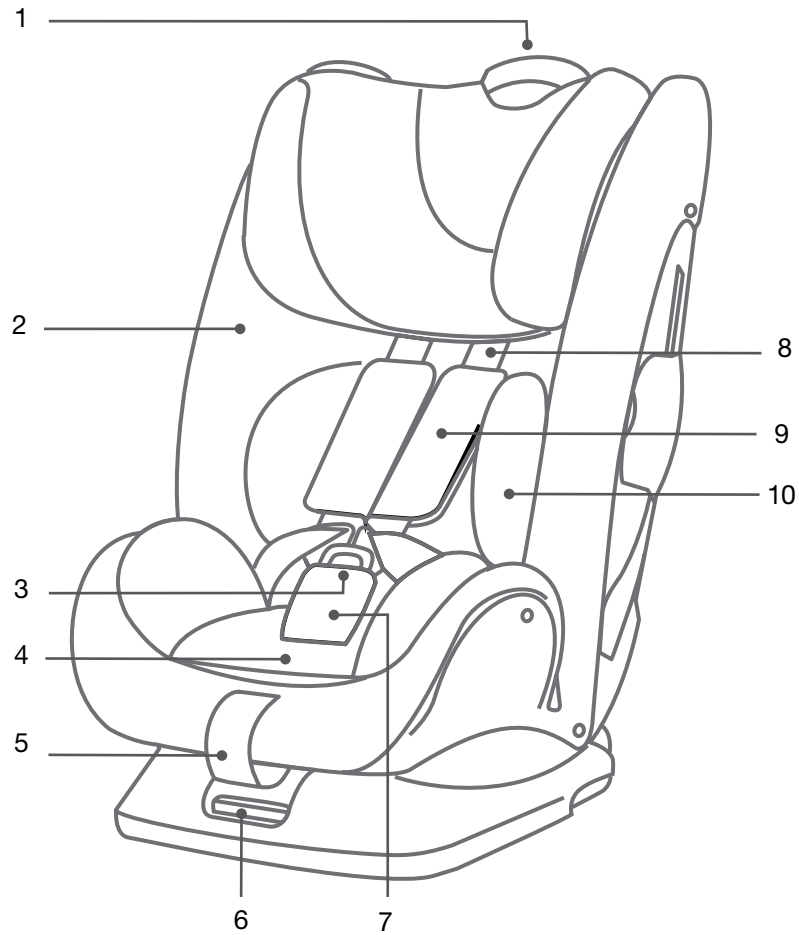

Features

- | | | | |
|----|--------------------------|----|----------------------------------|
| 11 | Top Tether Anchorage | 17 | Extra side impact protection |
| 12 | Top Tether Snap Hook | 18 | Instructions Storage |
| 13 | Top Tether | 19 | Positioning Bar |
| 14 | Headrest Height Adjuster | 20 | Base |
| 15 | Tether End Storage Bag | 21 | Forward-Facing Vehicle Belt Slot |
| 16 | Sash Belt Lock-off | 22 | Storage Pocket |

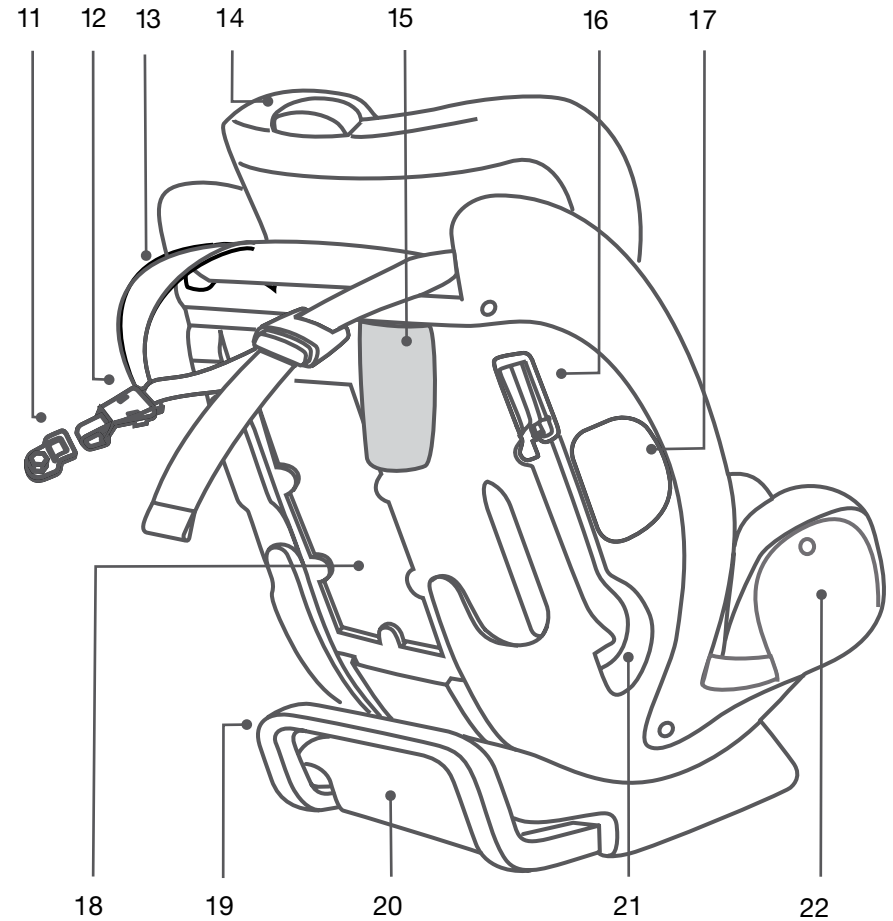

Installation

See page 5 for recommended positions in the vehicle.

1. Place the restraint on the vehicle seat forward facing.

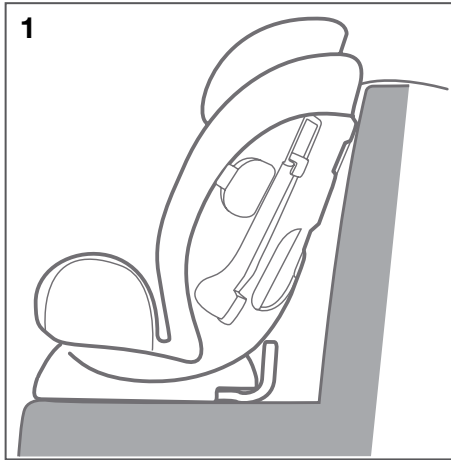

2. Connect the top tether strap. Apply light tension to the tether.

Do not fully tension yet.

NOTE: many vehicles have built-in top tether connection points. If your vehicle does not have these refer to page 17 for information on fitting the anchorage supplied.

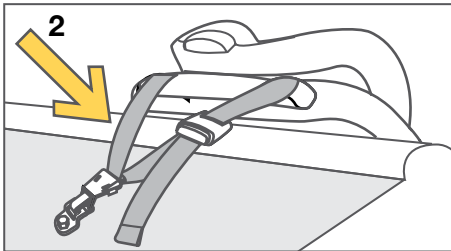

3. The top of the restraint should lightly touch the vehicle seat back **A**.

Pull the release lever **B** at the front of the restraint.

Pull the positioning bar fully out and adjust until the bar touches the bottom of the seat **C** and the top of the restraint firmly touches the seat back **A**.

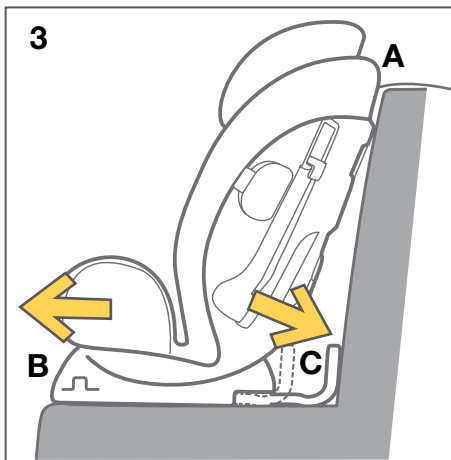

Installation

4. Pull the vehicle lap/sash belt out of the retractor.

Thread it through the vehicle belt slots at the back of the restraint.



5. Engage the vehicle belt buckle.



FORWARD FACING BELT PATH LABELS

Look for these labels showing the correct path for the vehicle belts

FORWARD FACING BELT PATH



FORWARD FACING BELT PATH



Installation

6. Press the restraint down firmly into the vehicle seat.
Pull the vehicle sash belt until both lap and sash belts are tight.

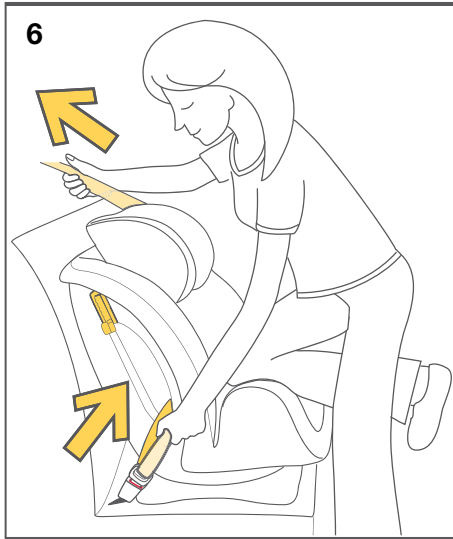

7. Pull the vehicle belts tight.

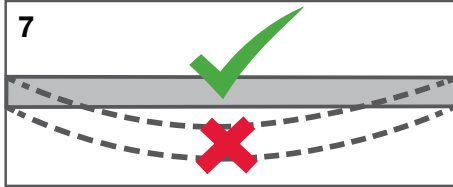

8. Ensure there are no twists in the belts.

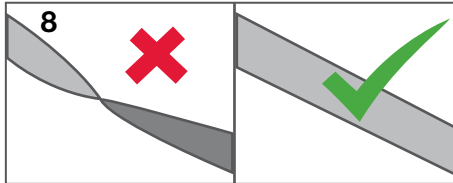

9. Secure the sash belt in the belt lock off.

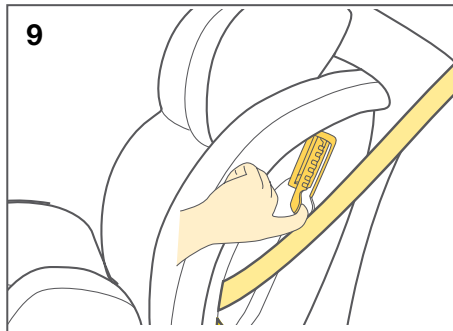

Installation

10. Pull the top tether strap tight.

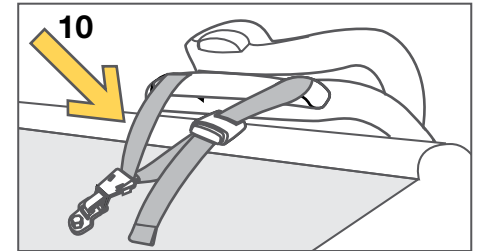

11. Store end of web in bag on back of cover.

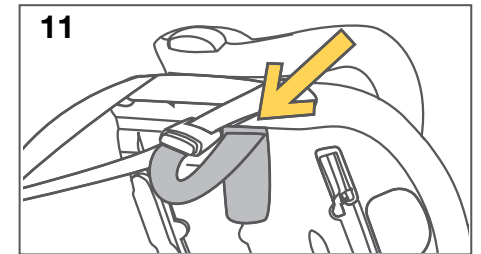

TETHER ADJUSTER OPERATION

Increase tether tension by pulling upper web out. If the web is stiff to pull through the adjuster also press the release button.

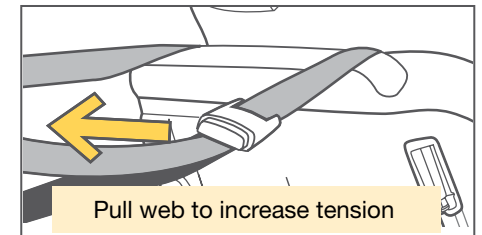

Reduce tension by pressing release button and pulling lower web out.

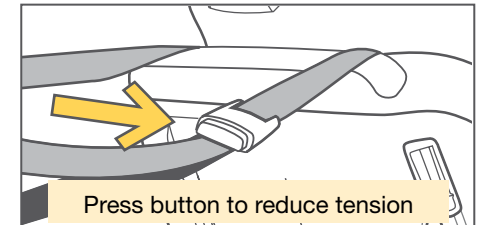

CHECKLIST

Tether Strap:

- securely attached to anchorage
- pulled tight.
- no twists in the webbing.
- end of tether in storage bag

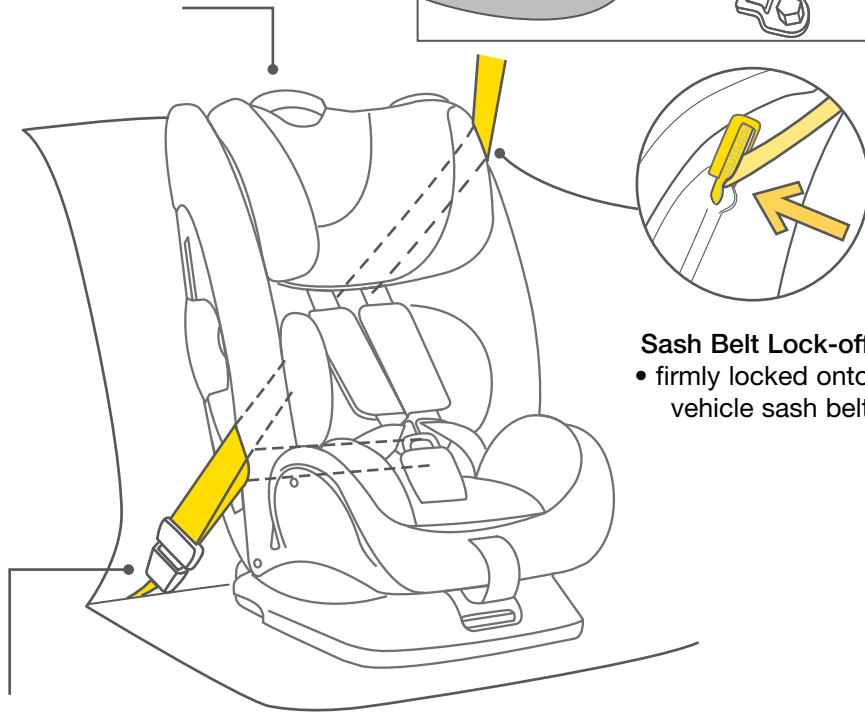
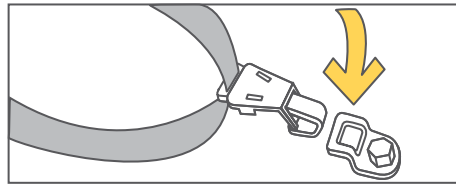

Sash Belt Lock-off

- firmly locked onto vehicle sash belt

Vehicle Belts

- securely engaged
- no twists in webbing
- pulled tight.

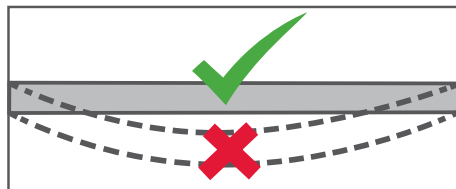

⚠ WARNINGS

TOP TETHER

THIS RESTRAINT MUST BE ATTACHED TO A CHILD RESTRAINT UPPER ANCHORAGE POINT IN THE CAR.

REFER TO CAR OWNERS HANDBOOK FOR LOCATION OF UPPER ANCHORAGE POINTS.

REFER TO A CHILD RESTRAINT FITTING STATION IF NO ANCHORAGE POINTS ARE IN THE MOTOR CAR.

THIS RESTRAINT IS NOT SUITABLE FOR USE WHERE THE TOP TETHER STRAP MAY FALL INTO A SPLIT IN THE SEAT BACK OR OFF THE SIDE OF THE SEAT.

Always secure the loose end of the top tether strap to prevent it hanging out of the car or being accessible by the child. Store it in the bag attached to the back of the cover.

Do not use the child restraint where this strap may fall into a split in the seat back or off the side of the seat.

ALWAYS ATTACH HOOK AND REMOVE SLACK.

CAUTION: CHILDREN CAN BE INJURED OR RESTRAINTS AND TOP TETHER STRAP DAMAGED BY UNSECURED CARGO IN A COLLISION. SECURE OR REMOVE HAZARDOUS CARGO BEFORE USING THIS CHILD RESTRAINT.

IMPORTANT In some vehicles (mostly utes or pickups), the tether strap mounting position is behind the vehicle seat backrest and is so close to the back of the restraint that the tether cannot be tensioned. In this case refer to an approved child restraint fitter for advice.

Top Tether - Features

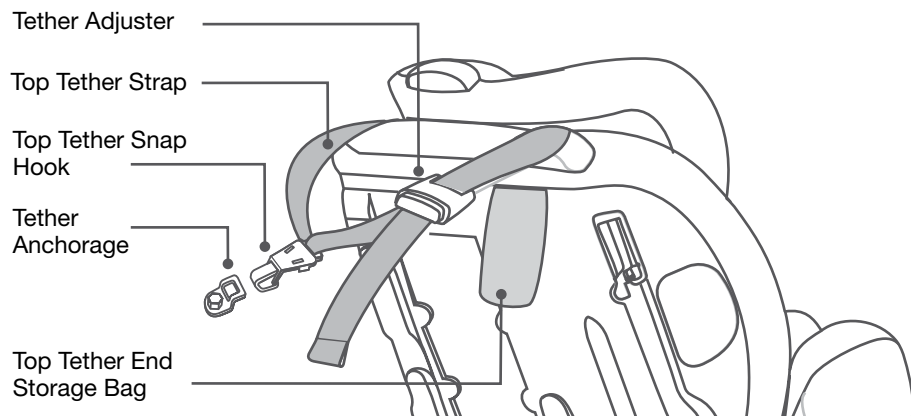

This child restraint has a tether strap permanently attached to the back of the restraint.

Always use this tether strap.

Connect the tether strap to the built-in anchorage fitting in the vehicle.

If there is not a built-in anchorage install the anchor fitting supplied with this restraint by following the instructions on the next pages.

In some vehicles without a fixed parcel shelf an extension tether strap may be required. These are available in several different lengths and can be obtained from child restraint retail outlets.

Most cars have built-in anchorage points, often in the back of the seat.

Always connect the snap hook securely to this point.

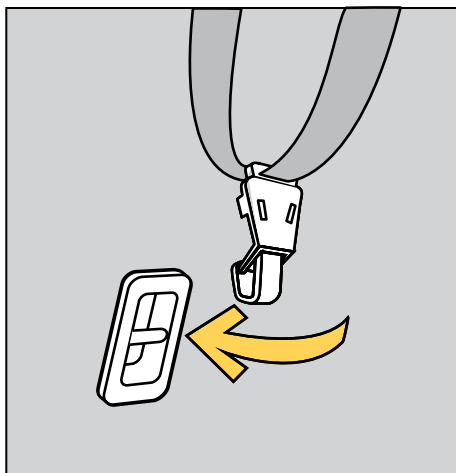

Tether Anchorage Installation

Most cars without built-in anchorages have several threaded holes to fit the tether anchorage to.

Refer to the vehicle owners handbook for information on the location of these points.

Using the bolt provided attach the anchor fitting to the mounting point behind where the child restraint is to be installed.

See more detailed information on the next page.

The anchor fitting must be aligned as shown unless stated otherwise in the vehicle owners handbook.

The threaded hole for the anchorage bolt may have a plastic cover over it

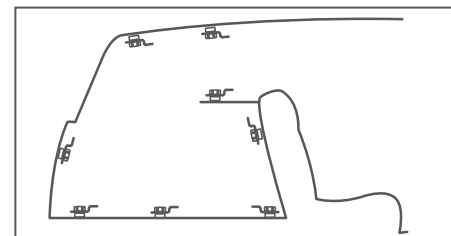
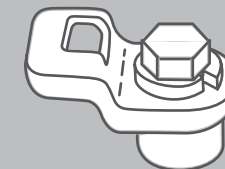

IMPORTANT

Some older vehicles may not have built-in anchorages or threaded holes. A new hole may need to be drilled for the anchorage components supplied. Joie recommend this is done by child restraint fitting station or licenced motor mechanic.

If a fitting station or mechanic is not available follow the instructions on page 17.

Tether Anchorage Installation

If the car is fitted with a child restraint anchorage point:

Locate the upper anchorage point behind the rear seating position (consult the vehicle owners handbook for location of the upper anchorage point). Remove the thread plug from the parcel shelf/floor/roof and install the attachment bolt as shown opposite.

CAUTION:
DO NOT OVERTIGHTEN THE ATTACHMENT BOLT. MAXIMUM TORQUE 20Nm.

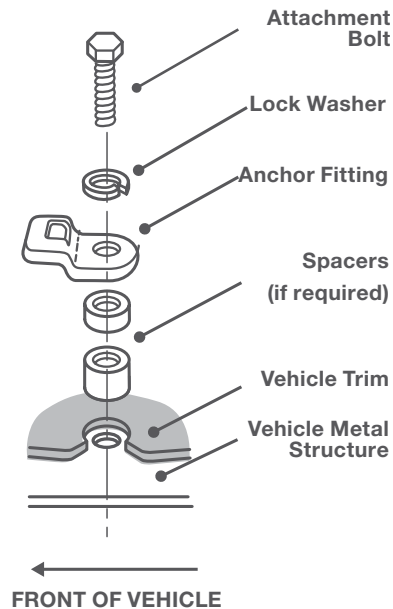

Tether Anchorage Installation

If the car is not fitted with a child restraint upper anchorage point:

For sedans only - drill a 9 mm hole in the parcel shelf on the centre line of the seating position as shown below. Install the anchor bolt as shown opposite.

It is recommended that this installation be carried out by a child restraint fitting station or licenced motor mechanic.

For vehicles other than sedans:

In Australia, consult your nearest child restraint fitting station or traffic authority for vehicle inspection to find the best, correct position for the placement of the upper anchorage point, and for the correct attachment bolt length and use of spacers.

In New Zealand, consult the agent for the vehicle.

If drilling a new hole, select a position on the centre line of the seating position, and no closer than 100 mm from the front edge of the parcel shelf.

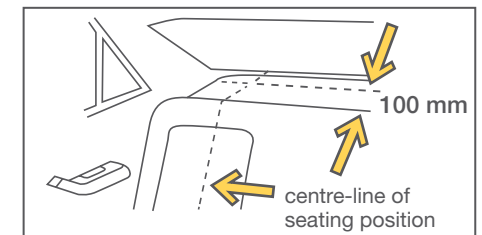
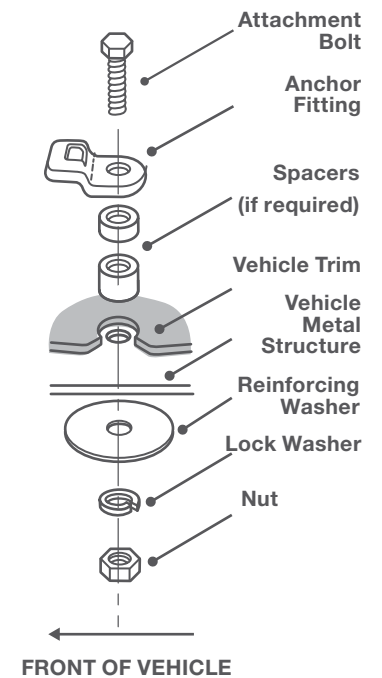

WARNING

CHILD RESTRAINTS MUST NOT BE ATTACHED TO UNSOUND METAL OR WOOD OR SYNTHETIC STRUCTURES. WHEN DRILLING THE 9 MM HOLE DO NOT DRILL THROUGH FUEL LINES, FUEL TANKS, ELECTRICAL WIRING, OR RADIO SPEAKERS. WEBBING STRAPS MUST BE PROTECTED FROM SHARP CORNERS AND EDGES.

THE ANCHOR FITTING MUST BE USED ONLY AS DESCRIBED ABOVE. IT MUST NOT BE HOOKED ONTO ANY OTHER OBJECT.

SEAT COVER

Wash with cold water at less than 30 degrees C.
Do not iron.
Do not bleach or dry clean.
Do not twist the soft goods to dry with great force. It may leave the seat cover with wrinkles.

Hang dry the seat cover in the shade. Do not tumble dry.

PLASTIC AND METAL PARTS

Use only mild detergent, water and a soft cloth to clean the car seat shell, handle and harness straps. Air dry.

Do not use undiluted detergent, or other solvents to clean - these may cause damage.

HARNESSTRAPS

Shoulder harness straps are not removable.
Clean with mild detergent, water and a soft cloth only.

HARNESSBUCKLE

To clean the buckle: rinse using warm water. DO NOT use any soaps, solvents or lubricants. Using anything other than water can cause the buckle to malfunction. Air dry.

When the buckle is operating correctly the tongues will push in easily and the tongues will CLICK when they latch into place.

If the buckle does not appear to be

working correctly get it checked or replaced by contacting the retailer from where it was purchased, or by contacting Nuna Baby Australia.

STORAGE

Remove the child restraint from the vehicle seat if not in use for a long period of time. Put the child restraint in a cool, dry place where your child cannot access it.

divider between installation and use, can be removed

To Refit

Seat Cover

1. Place the cover into the seat.

2. Thread the QR buckle through the slot in the cover,

3. Place the harness lap straps into the slots at each side of the cover.

4. Secure the press studs inside and outside the shell.

5. Replace the liner and crotch pad if using these items.

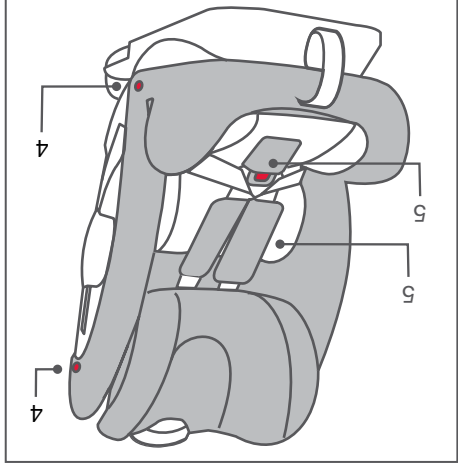
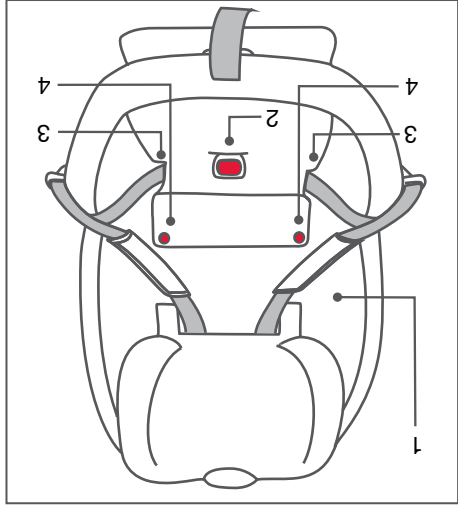

Headrest Cover

6. Carefully pull the headrest cover over the headrest from the front.
Caution: be careful not to damage the foam liner.

7. Locate the elastic loops and reattach to the lugs at the back of the headrest.

VERY IMPORTANT: Only replace the cover with a Joie supplied replacement cover with identical shoulder height markers or a replacement cover meeting AS/NZS 8005.

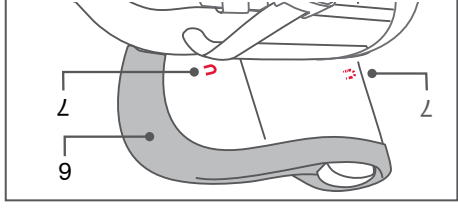

When the child's shoulders reach the upper shoulder height marker line they have outgrown this restraint.

SHOULDERS BELOW THIS LINE WHEN HEADREST AT HIGHEST POSITION

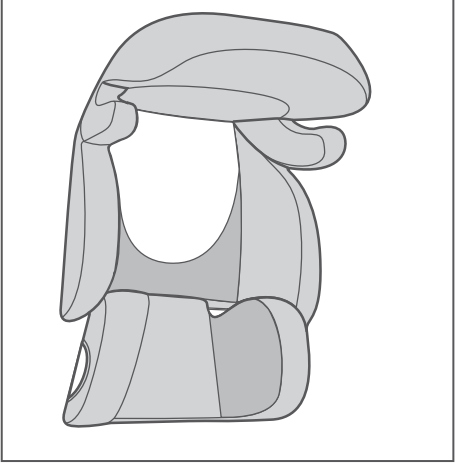
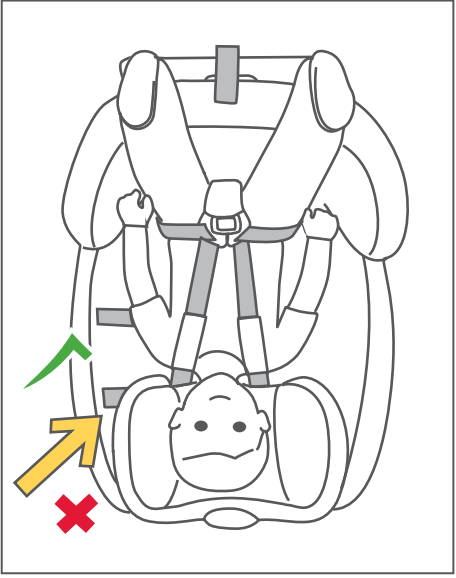

The next suitable type of restraint is a bigger booster seat.

Booster seats are available for children up to approximately 10 years of age.

IMPORTANT: Children are at risk of serious injury if they move to booster or vehicle seats too early.

If when sitting correctly on either seat their lower legs are not able to bend at the knee they may move forward.

This can result in the vehicle lap belt running over their stomach area leading to the risk of injury in an accident.

Checklist

Shoulder Straps - must always be at correct height and pulled tight.

Shoulder Height - shoulders must not be above the upper marker line with headrest fully up

Harness Straps - must not be twisted.

Shoulder Height - shoulders must not be below the lower marker line

Child position - child must be in full contact with back of restraint.

Quick Release Buckle - must always be securely fastened.

Height should be lower for smaller children, higher for bigger children.

Harness Tension - pull harness tight.

Crotch Strap - adjust to raise or lower Quick Release Buckle

Suitable clothing - child's clothing must allow the harness to securely grip the child.

USE

Cover Removal

To Remove

1. Press the red button down to disengage the QR buckle and remove the liner and crotch pad (if fitted).

Headrest cover and lower back padding

2. Detach elastic loop fasteners at back of headrest

3. Carefully remove the head support cover by pulling forward over the headrest.

Cautions: be careful not to damage the foam liner.

Seat Cover

4. Remove webbing and spread outwards,

5. Detach the press studs outside the seat pad.

6. Detach the press studs inside the cover.

7. Pull the QR buckle through the slot in the seat pad and then remove seat pad from seat shell.

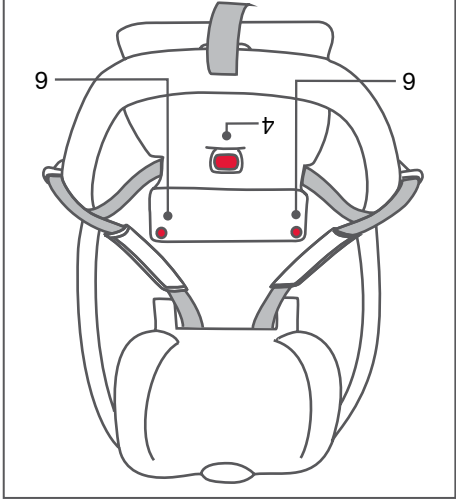
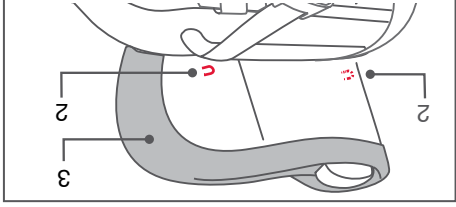
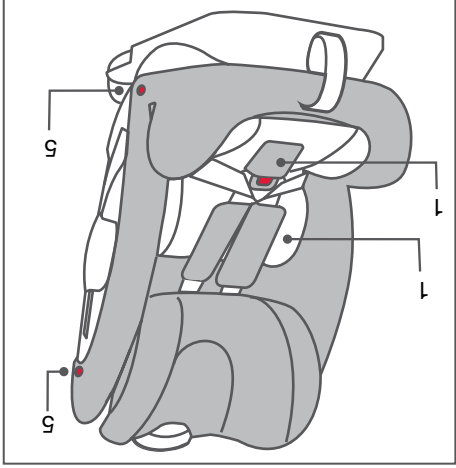

USE

Securing a Child in the Restraint - Adjusting the Harness

- Correct strap tension. Put a finger under each strap and pull gently outwards. There should be no gap between your finger and the child.

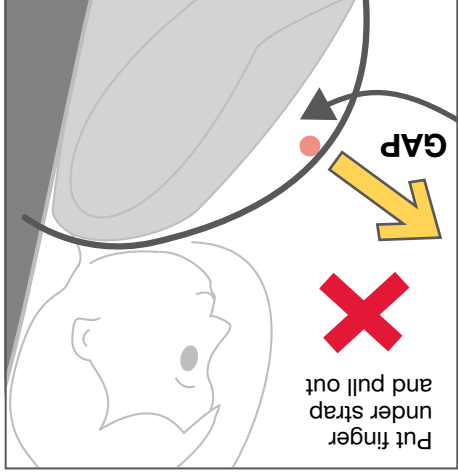
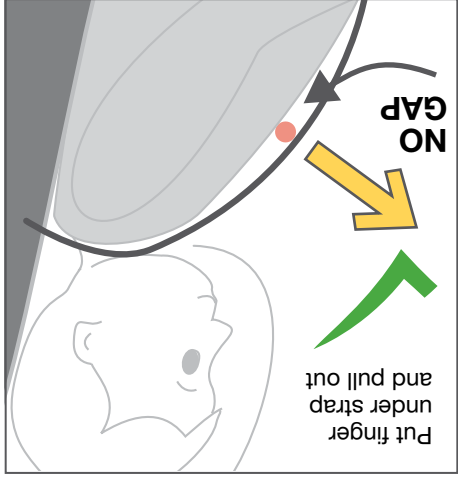

- Make sure there are no twists in the straps.

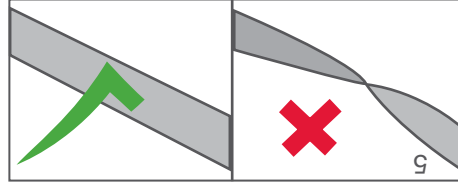

- Recheck shoulder strap height.

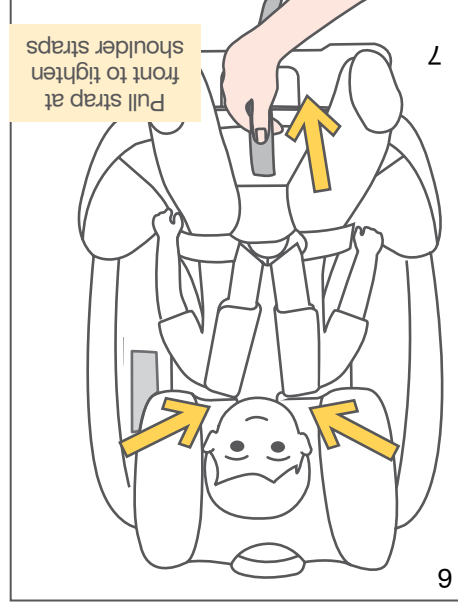

- Tighten harness by pulling on the adjuster strap at the front of the restraint. Note: the lower harness webbing may not pull freely through the harness buckle tongues. You may need to pull the webbing through the buckle tongues up towards the child's shoulders then pull on the adjuster strap again. This may need to be repeated several times to get the webbing fitting snugly.

DO NOT LEAVE CHILDREN UNATTENDED IN THE CAR

WARNING



Securing a Child in the Restraint - Adjusting the Harness

USE

USE

Securing a Child in the Restraint - Securing the Harness

FIRST CHECK SHOULDER STRAP HEIGHT AND ADJUST IF NECESSARY. See previous page.

1 Loosen harness by pressing on adjuster button A while pulling on the harness straps B.

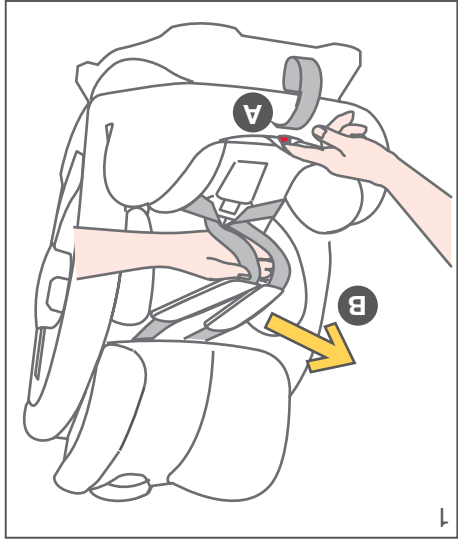

2 Press button to open the quick release buckle.

Spread harness straps apart.

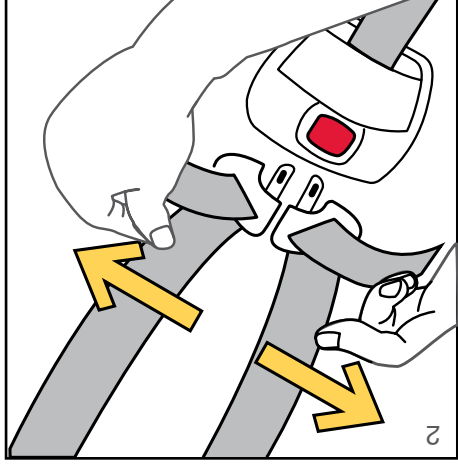

3 Place child in restraint in seated position firmly against both the back and bottom of the restraint.

IMPORTANT

Children need to be securely held by the harness. Children must be dressed in clothing that allows the harness to firmly grip them. Do not wrap the child in a blanket or similar. Only place such covering over the child after they are strapped in.

4 Place buckle tongues into the quick release buckle.

IMPORTANT:

The buckle tongues should "CLICK" when pushed into place. If you do not hear a click, try again or try cleaning the buckle.

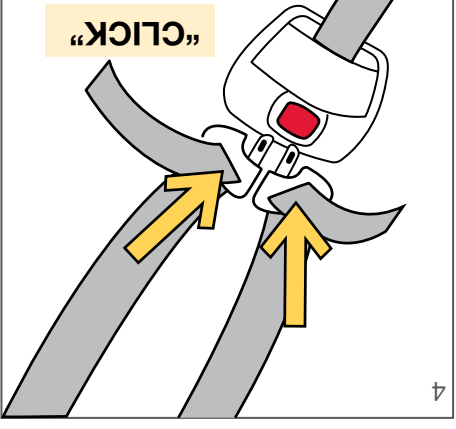
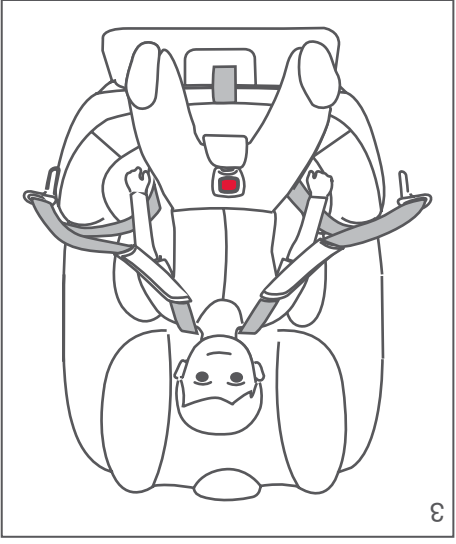

Securing a Child in the Restraint - Securing the Harness

See previous page.

1 Loosen harness by pressing on adjuster button A while pulling on the harness straps B.

2 Press button to open the quick release buckle.

Spread harness straps apart.

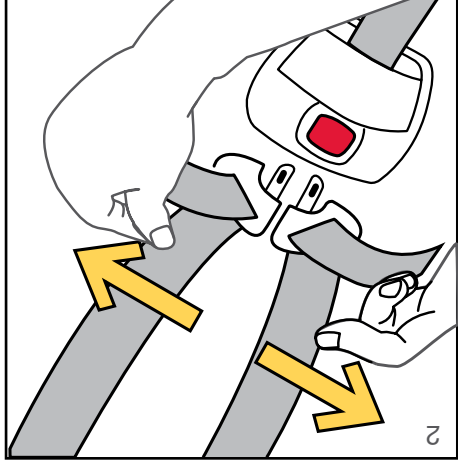

4 Place buckle tongues into the quick release buckle.

IMPORTANT:

The buckle tongues should "CLICK" when pushed into place. If you do not hear a click, try again or try cleaning the buckle.

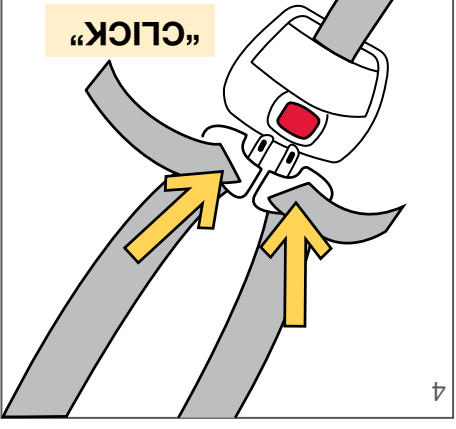
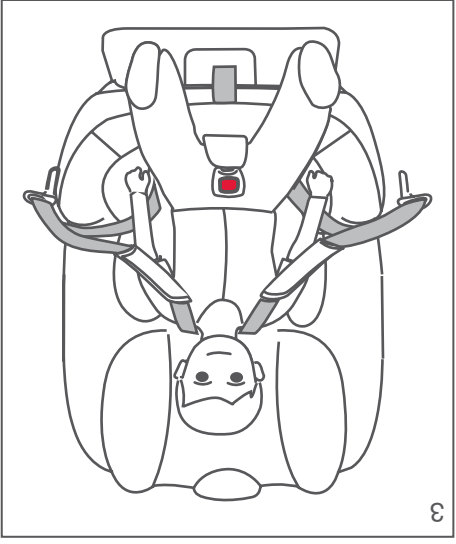

Securing a Child in the Restraint - Shoulder Strap height labels

This restraint has shoulder height level labels.
Use these labels to check if the restraint is the correct size for your child.

If your child's shoulders are above the upper dotted line with the headrest fully up they are too big for this restraint and need to move to a big Booster Seat.
See page 16

SHOULDERS BELOW THIS LINE WHEN HEADREST AT HIGHEST POSITION

SHOULDERS MUST BE ABOVE THIS LINE

If your child's shoulders are below the lower dotted line when the headrest is fully down they are too small for this restraint.

IMPORTANT: Joie recommends that children remain rear facing until they are at least 12 months of age.

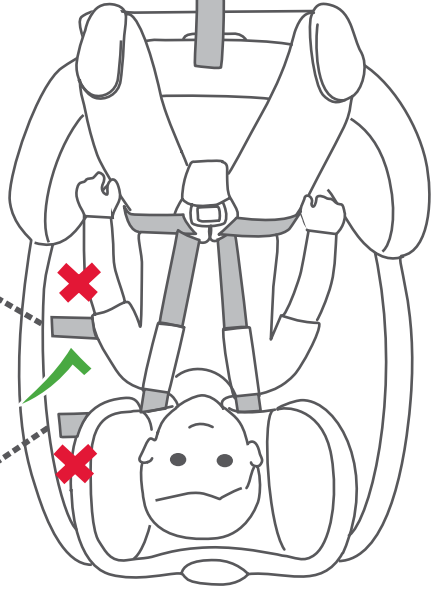

USE

Securing a Child in the Restraint - Shoulder Strap height

Correct positioning of the shoulder straps is essential for your child's safety.

Requirement: The shoulder straps must be positioned near to the child's shoulders, but not more than 25 mm below the child's shoulders.

To Check:

With child placed in the restraint, note where the shoulder straps are positioned relative to the shoulders **A**.
Adjust up or down if necessary.

To Adjust: Squeeze the headrest adjuster handle and raise or lower the headrest and shoulder straps as required.

IMPORTANT: Always adjust the height of the shoulder straps as the child grows

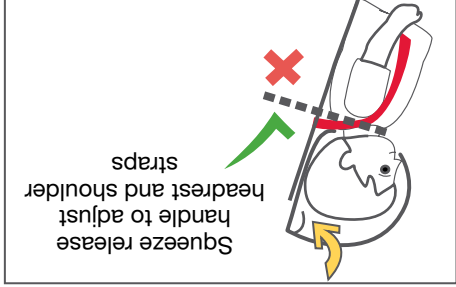

Squeeze release handle to adjust headrest and shoulder straps

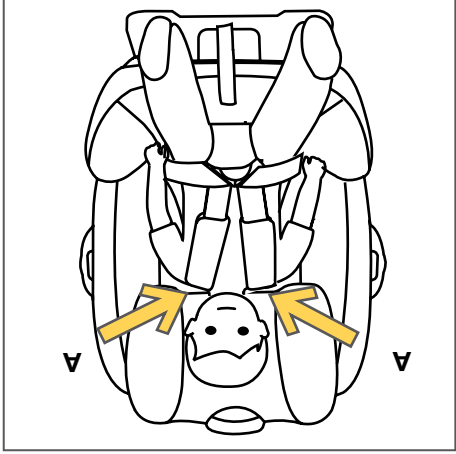

Adjustable height harness buckle.

The harness buckle has two height options - lower for smaller children or higher for bigger children. Adjust height by lifting the cover at the front of the restraint, lifting the anchor plate **1**, rotating with the strap and sliding sideways.
Check anchor plate is securely positioned.

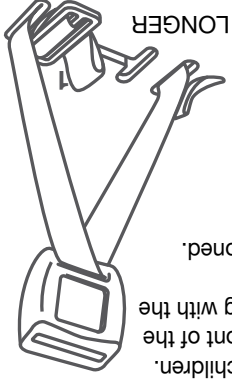
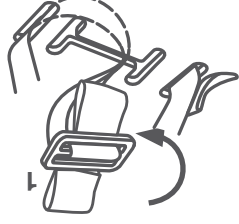

USE

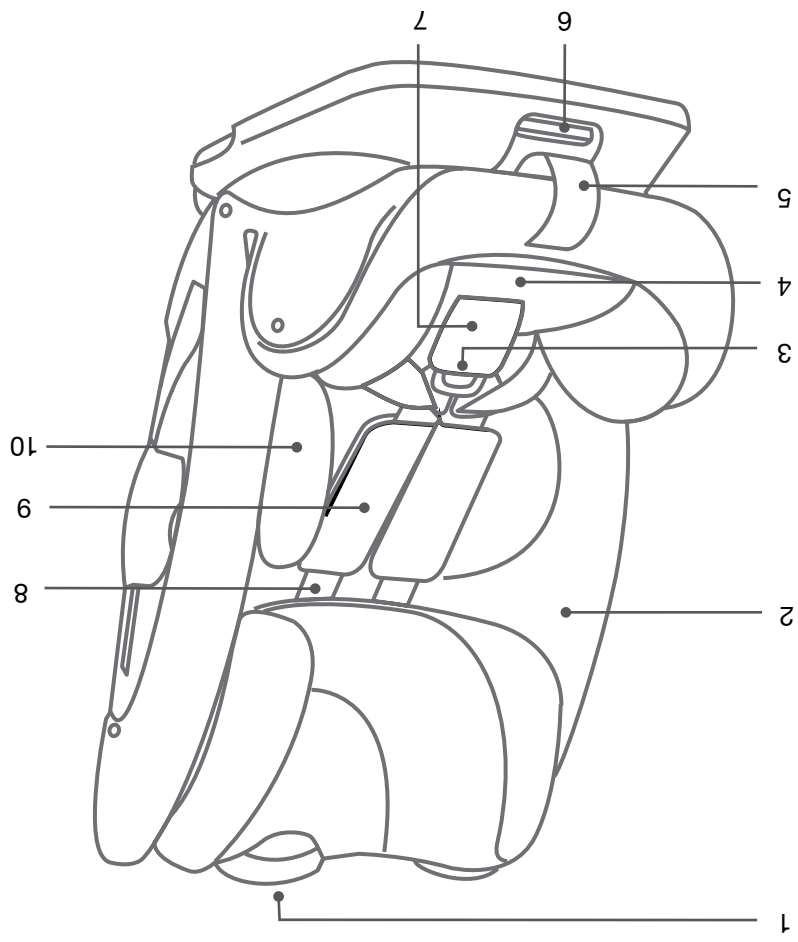

- | | |
|----|--------------------------------|
| 1 | Headrest height Adjuster |
| 2 | Seat Cover |
| 3 | Harness QR Buckle |
| 4 | Harness Adjuster (under cover) |
| 5 | Harness Adjuster Webbing |
| 6 | Positioning Bar Latch |
| 7 | Crotch Pad |
| 8 | Shoulder Harness Strap |
| 9 | Shoulder Pads |
| 10 | Infant Body Support |

Features

USE

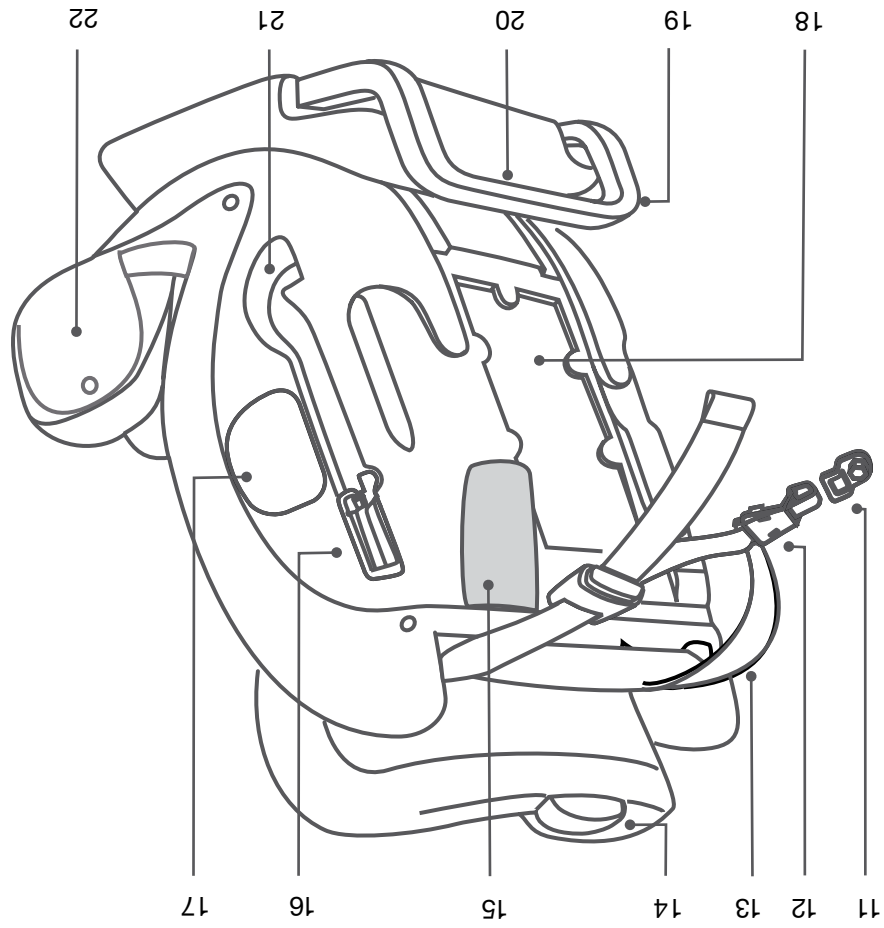

- | | |
|----|----------------------------------|
| 11 | Top Tether Anchorage |
| 12 | Top Tether Snap Hook |
| 13 | Top Tether |
| 14 | Headrest Height Adjuster |
| 15 | Tether End Storage Bag |
| 16 | Sash Belt Lock-off |
| 17 | Extra side impact protection |
| 18 | Instructions Storage |
| 19 | Positioning Bar |
| 20 | Base |
| 21 | Forward-Facing Vehicle Belt Slot |
| 22 | Storage Pocket |

Features

USE

⚠️ WARNINGS

- Use the restraint exactly as shown in the instructions.
- Supervision of children is needed because they may be able to undo buckles.
- A loose harness or restraint is dangerous.
- Fit the harness firmly to the child.
- DO NOT USE THIS RESTRAINT WITHOUT THE COVER
- **DO NOT LEAVE CHILDREN UNATTENDED IN THE CAR**

NOTE: These warnings are required by the Australian and New Zealand Standard AS/NZS 1754 for this type of child restraint. Other warnings specific to this particular child restraint will be found throughout these instructions.

ADDITIONAL WARNINGS

This Child Restraint is: **To be used only in a forward-facing position by a child whose shoulders are above the lower shoulder height marker (approximately 6 months of age) until the child's shoulders reach the upper shoulder height marker (approximately 8 years of age).**

Continue to use this child restraint until the child reaches this limit.

Do not use forward facing until child's shoulders are above the lower shoulder height marker.

Infants are at risk of serious injury if they face forward too early.

Children are at risk of serious injury if they move to booster seats too early.

Just using a seatbelt is not recommended for children that have outgrown this restraint. Children are safest in a booster seat until their shoulders reach the upper shoulder height marker of the booster seat.

Ensure that children have adequate ventilation and shade when in the vehicle.

Strangulation hazard: Child can strangle in loose restraint straps. Always use harness. Never leave child in restraint when straps are loose or undone.

Aftermarket accessories (i.e. items not provided in the box with the child restraint), may not have been tested for use with this child restraint and if used, may lower the level of protection offered possibly leading to injury or death.

Any aftermarket accessory used should be compliant with AS/NZS 8005 (Accessories for child restraints for use in motor vehicles) and stated as suitable for use with this child restraint.

CONTENTS

WARNINGS	3
ADDITIONAL WARNINGS	4
Features.....	5 & 6
Shoulder Strap Height Labels	7
Shoulder Strap Height	8
Securing the Harness	9 & 10
Adjusting the Harness	11 & 12
CHECKLIST	13
Cover Removal & Refit	14 & 15
The Next Restraint	16
Care and Maintenance	17

USE

DO NOT USE THIS CHILD RESTRAINT UNTIL YOU HAVE READ AND UNDERSTOOD THE INSTRUCTIONS IN THIS USER GUIDE AND IN YOUR VEHICLE OWNERS MANUAL

IMPORTANT:
Before installation and use of this child restraint check that it is suitable for the size of your child.

Refer to the shoulder height label information on page 7

Suitable for children from approximately 6 months to approximately 8 years.
Joie recommends that children remain rear-facing until at least 12 months

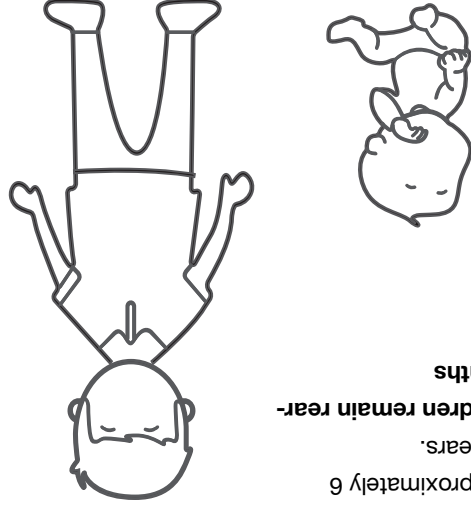

FORWARD FACING ONLY

Child's shoulders must be between the top and bottom lines on the shoulder height labels

