

Joie™

birth to 15kg/(birth - 36 months)

# litetrax™ 4

## stroller

GB Instruction Manual

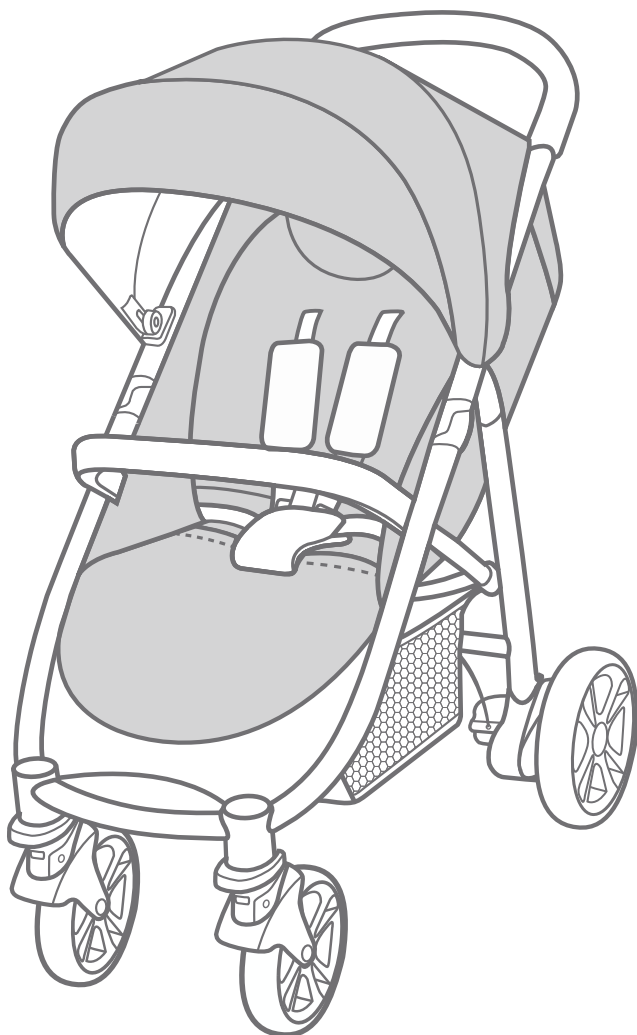

# Stroller Assembly

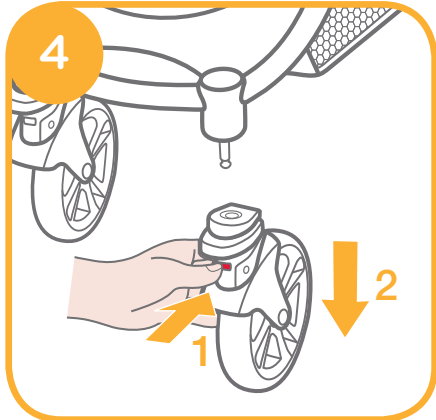
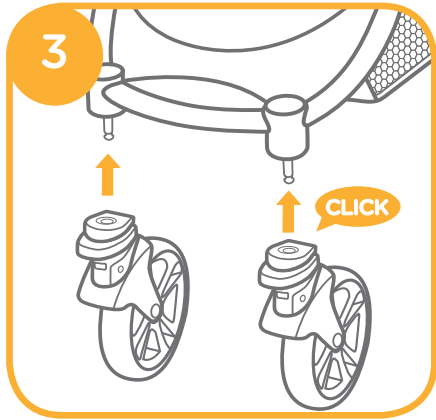
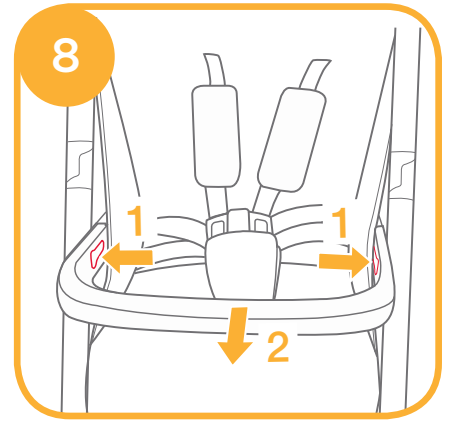
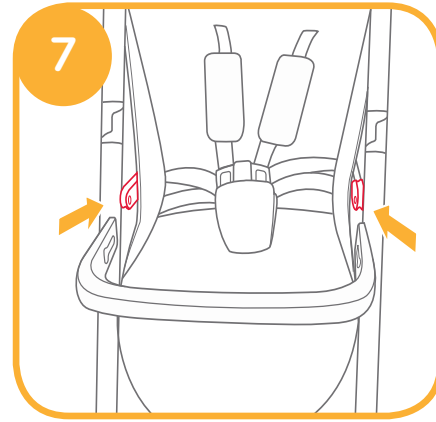
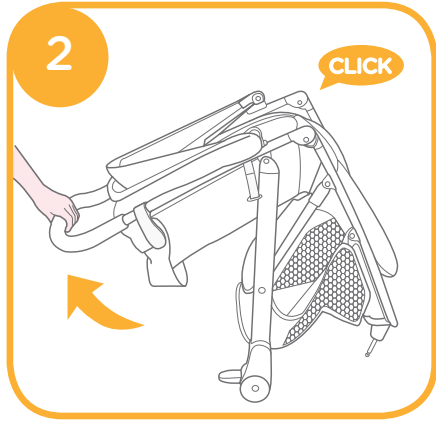
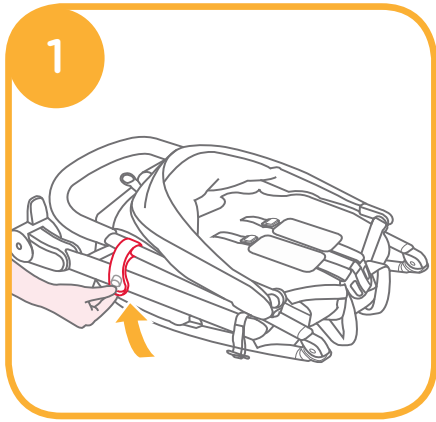

# Stroller Operation

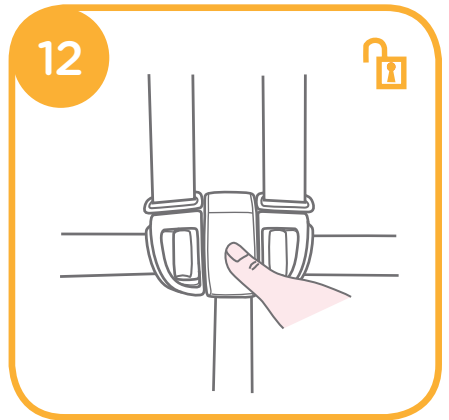
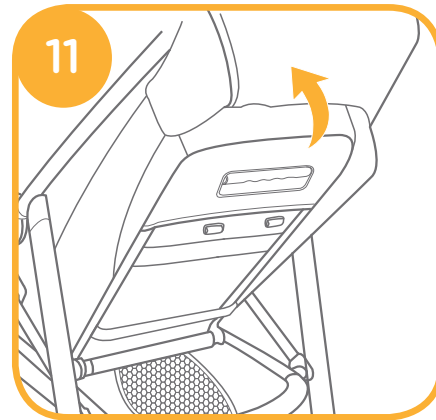
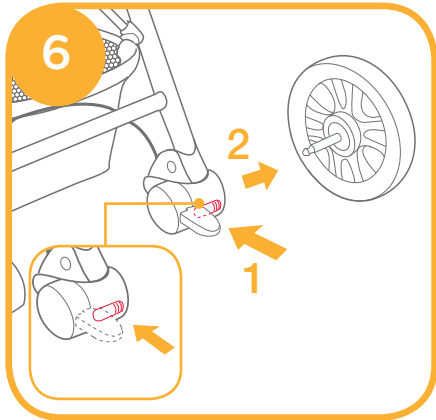
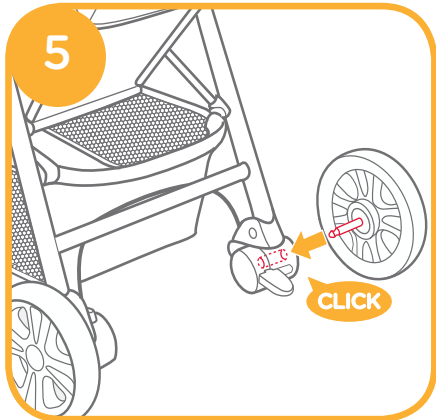

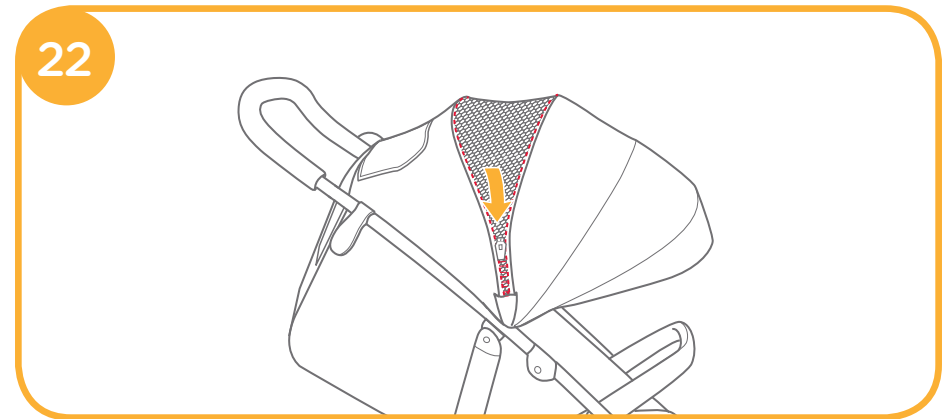
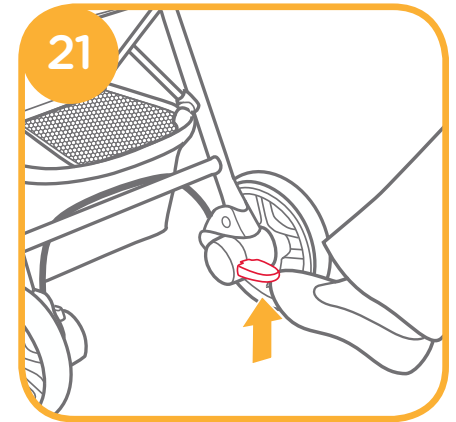
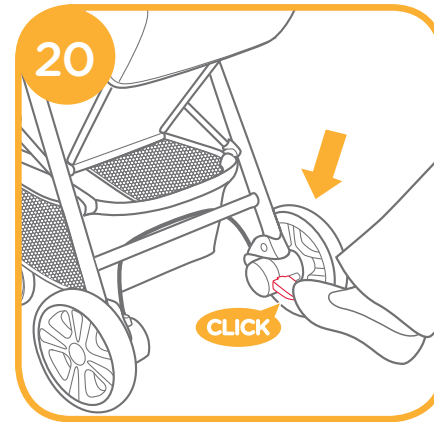
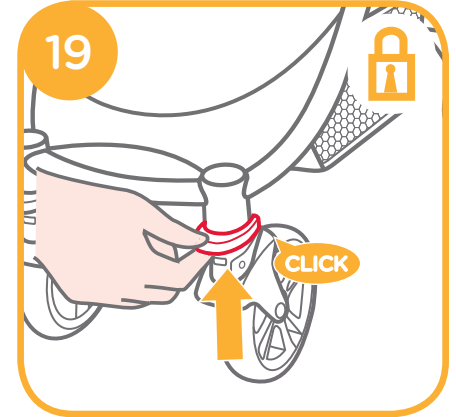
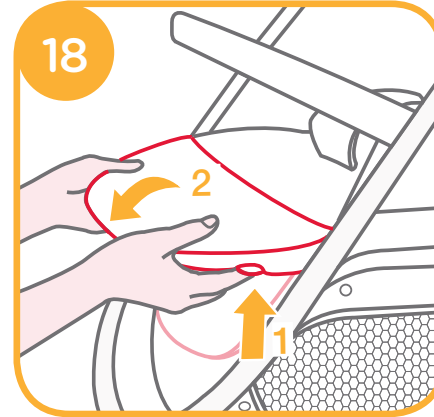
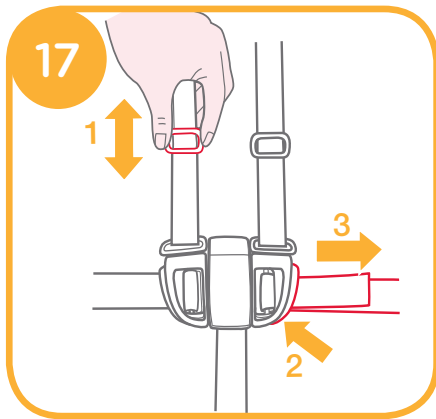
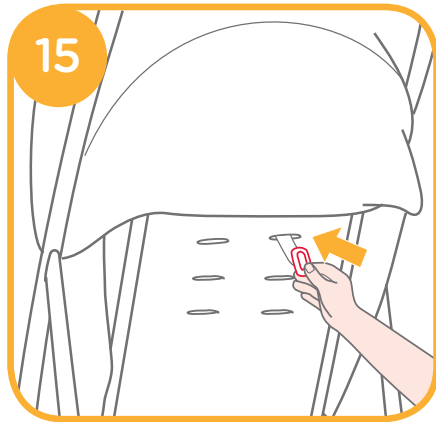
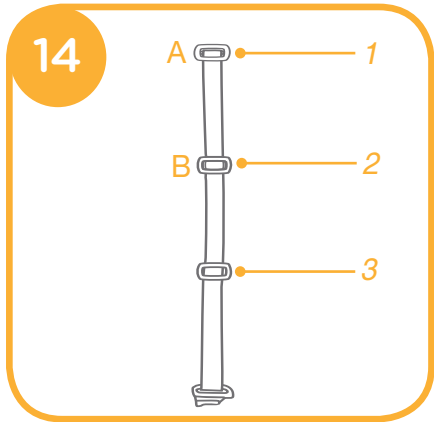
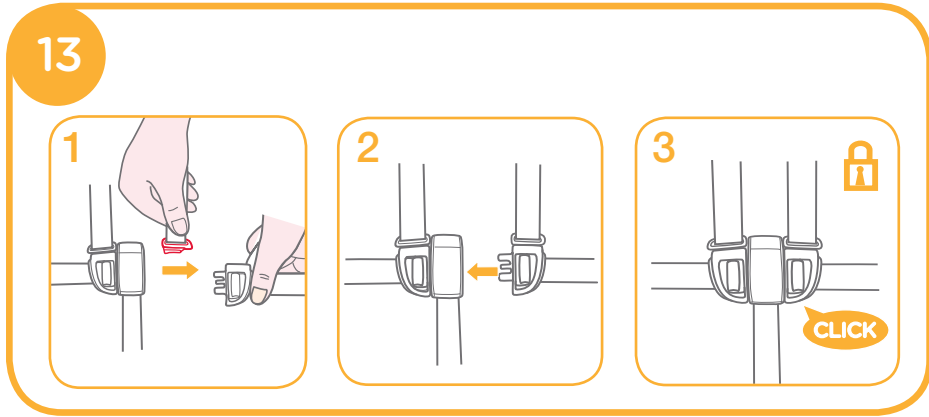

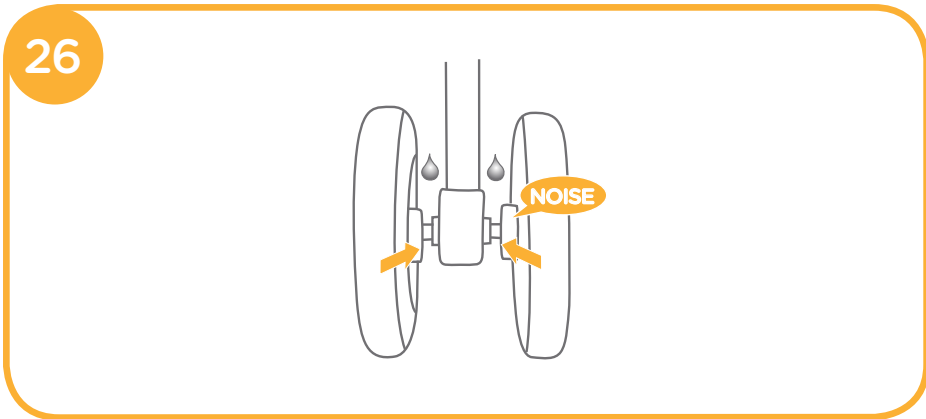
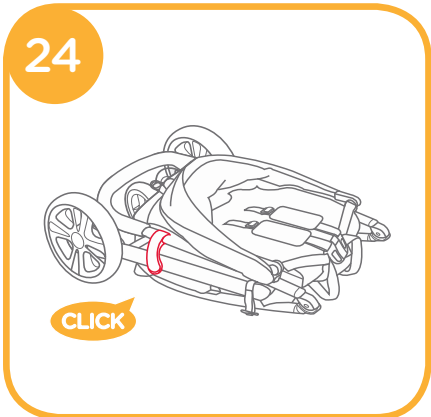
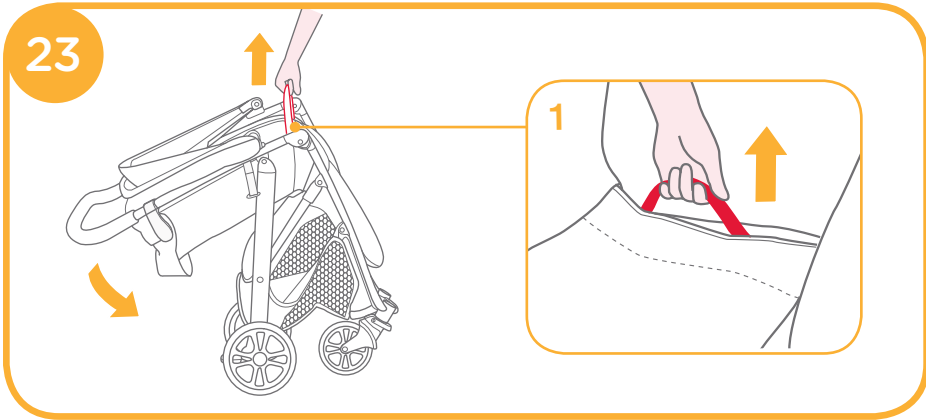

### Accessories (May not be included in purchase)

Accessories may be sold separately or may not be available depending on region.

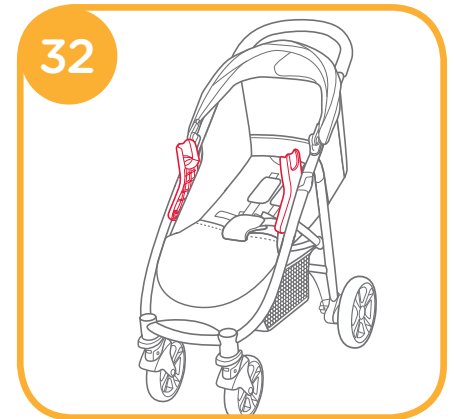
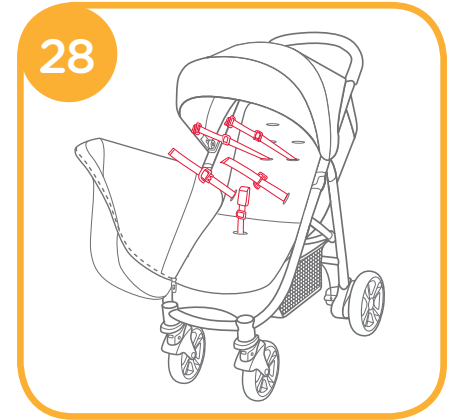
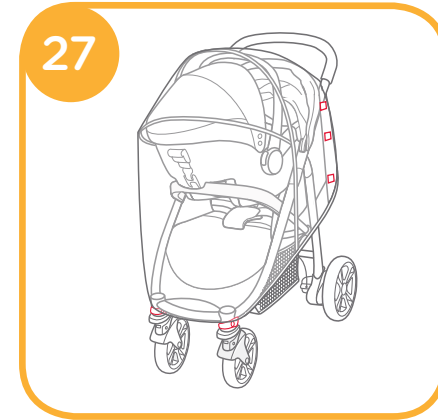

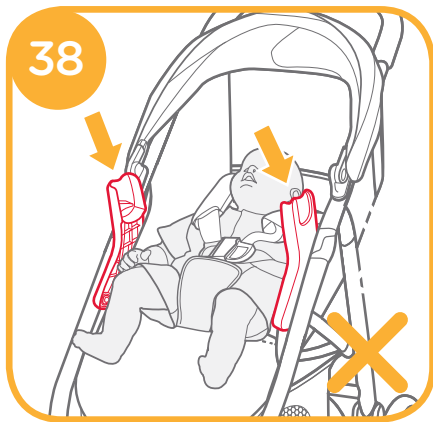
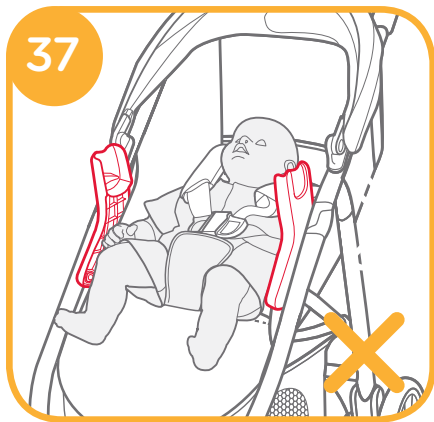
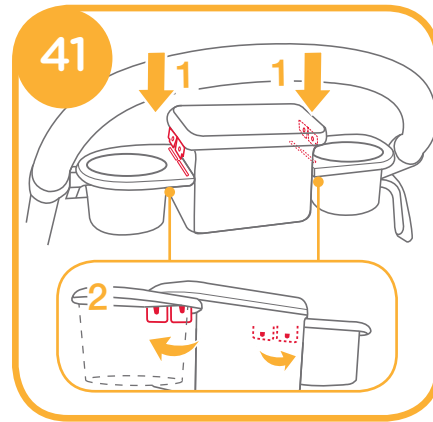
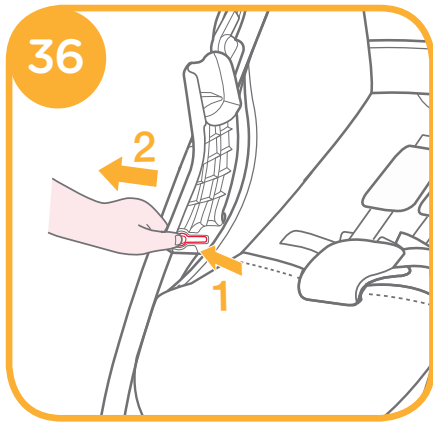
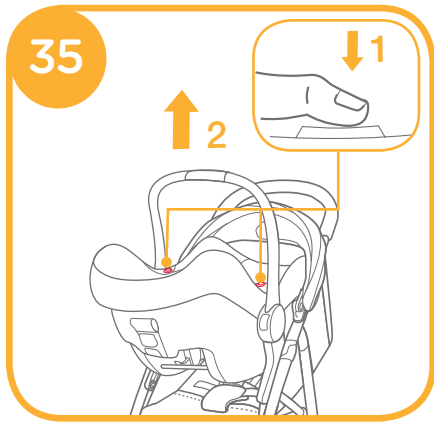
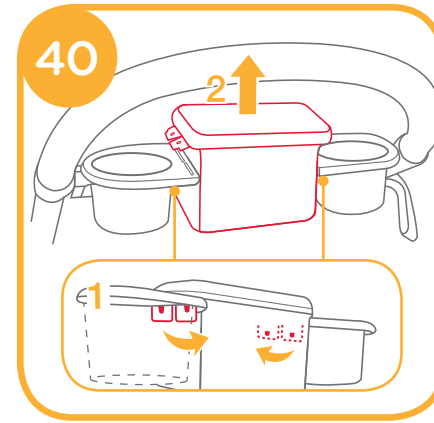
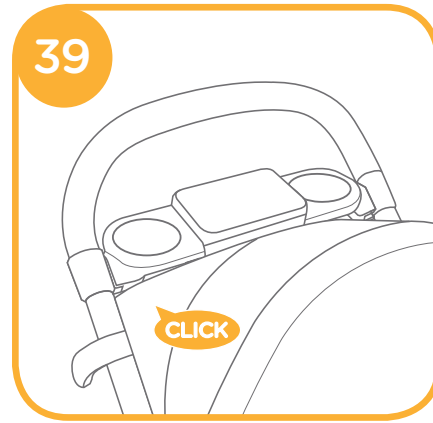
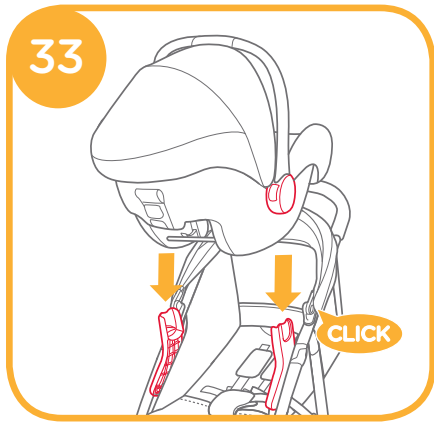

Congratulations on becoming part of the Joie family! We are so excited to be part of your journey with your little one. While traveling with the Joie LITETRAX™4, you are using a high quality, fully certified stroller, approved to European safety standards EN 1888:2012. This product is suitable for use with children weighing under 15kg. Please carefully read this manual and follow each step to ensure a comfortable ride and best protection for your child.

**IMPORTANT** - Keep these instructions for future reference.

Visit us at [joiebaby.com](http://joiebaby.com) to download manuals and see more exciting Joie products!

## Contents

Figures	1-8
WARNING	11
<b>Stroller Assembly</b>	<b>12</b>
Open Stroller	12
Assemble Front Wheel	12
Assemble Rear Wheels	12
Assemble Armbar	13
<b>Stroller Operation</b>	<b>13</b>
Adjust Backrest	13
Use Buckle	13
Use Shoulder & Waist Harnesses	13
Adjust Calf Support	14
Use Front Swivel Lock	14
Use Brake	14
Use Hood	14
Fold Stroller	14
Use Accessories	15
<b>Care and Maintenance</b>	<b>16</b>

## Emergency

In case of emergency or accident, it is most important to have your child taken care of with first aid and medical treatment immediately.

## Product Information

Read all the instructions in this manual before using this product. If you have any further questions, please consult the retailer. Some features may vary depending on model.

Product	Litetrax™4 Stroller
Suitable for	Child weighing under 15kg (birth - 36 months)
Materials	Plastics, metal, fabrics
Patent No.	Patents pending
Made in	China
Brand Name	Joie
Website	<a href="http://www.joiebaby.com">www.joiebaby.com</a>
Manufacturer	Joie Childrens Products (UK) Limited

## Parts List

Make sure all parts are available before assembly. If any part is missing, please contact local retailer. No tools are required for assembly.

1 Stroller Frame	6 Armbar	11 Shoulder Harness	16 Storage Mount
2 Front Wheel	7 Calf Support	12 Handle	17 Storage Latch
3 Rear Wheels	8 Front Wheel	13 Window	
4 Hood	9 Swivel Lock	14 Rear Wheel	
5 Seat Pad	10 Storage Basket	15 Brake Lever	

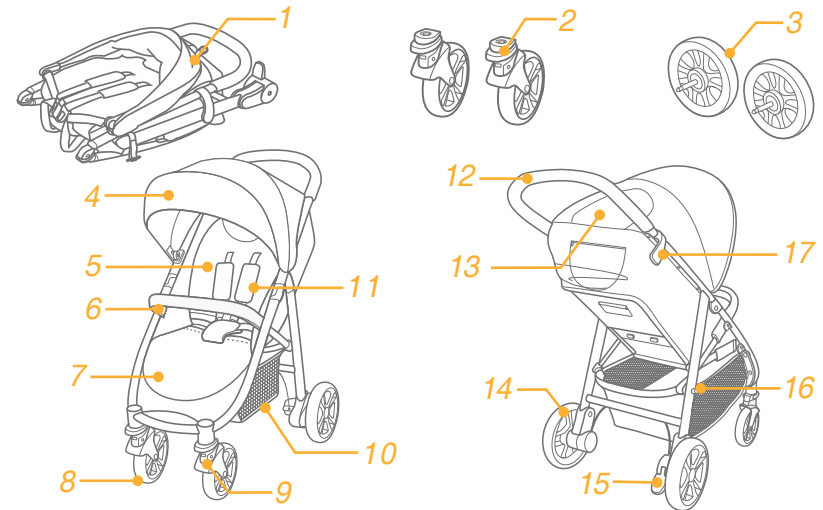

## Accessories (May not be included)

- 1 Rain cover (on certain models)
- 2 Footmuff (on certain models)
- 3 Adapter (on certain models)
- 4 Armbar Cover (on certain models)
- 5 Parent Tray (on certain models)

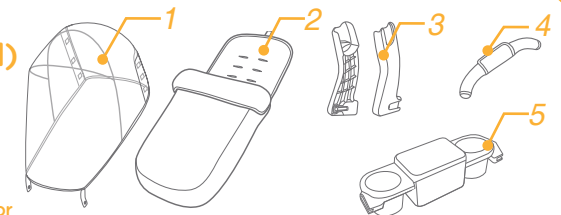

Accessories may be sold separately or may not be available depending on region.

# WARNING

- ! WARNING Always use the crotch combination with the waist belt. It is suggested that the shoulder harnesses be used as well.
- ! WARNING Ensure that all the locking devices are engaged before use.
- ! WARNING Do not let your child play with this product.
- ! WARNING Check that the pram body or seat unit attachment devices are correctly engaged before use.
- ! Adult assembly required.
- ! Use the stroller with a child weighing less than 15kg. It will cause damage to the stroller with an unfitted child.
- ! To prevent a hazardous, unstable condition, do not place more than 4.5kg in the storage basket.
- ! The maximum recommended weight of the parent tray is 3lbs (1.36kg).
- ! Never leave child unattended. Always keep child in view while in stroller.
- ! Use the stroller with only one child at a time. Never place purses, shopping bags, parcels or accessory items on the handle or hood.
- ! Overloading, folding incorrectly, or using component parts from other manufacturers may cause the stroller to be damaged, broken or unsafe. Please read the instruction manual carefully.
- ! Never use it along with component parts from other manufacturers.
- ! Please read all the instructions in the manual before using the product. Please save instruction manual for future use. Failure to follow these warnings and instructions may result in serious injury or death.
- ! Safety belts and restraint systems must be used correctly.
- ! To avoid serious injury from falling or sliding out, always use seat belt.
- ! Make sure your child's body is clear from the moving parts when adjusting the stroller.
- ! Child may slip into leg openings and be strangled if the harness is not used.
- ! Never use stroller on stairs or escalators.
- ! Keep away from high temperature objects, liquids, and electronics.
- ! Never allow your child to stand on the stroller or sit in the stroller with head toward front of stroller.
- ! Never place the stroller on roads, slopes or dangerous areas.
- ! Do make sure all mechanisms are fixed before using the stroller.
- ! To avoid strangulation, DO NOT place items with a string around your child's neck, suspend strings from this product, or attach strings to toys.
- ! To prevent tipping DO NOT put anything on the handle.
- ! DO NOT lift stroller while child is in stroller.
- ! DO NOT use storage basket as a child carrier.
- ! To prevent tipping, never let child climb the stroller. Always lift the child

in and out of the stroller.

- ! To avoid finger entrapment, use care when folding and unfolding the stroller.
- ! To avoid injury ensure that your child is kept away when unfolding and folding this product.
- ! To ensure your child's safety, please make sure all parts are assembled and fastened properly before using the stroller.
- ! To avoid strangulation, do make sure your child is clear from the hood.
- ! Always engage the brakes when parking the stroller.
- ! Discontinue using stroller if it is damaged or broken.
- ! Stroller to be used only at walking speed. This product is not intended for use while jogging.
- ! Do not place any item that may do harm to the baby and stroller in the parent tray.
- ! To avoid suffocation, remove plastic bag and packaging materials before using this product. The plastic bag and packaging materials should then be kept away from babies and children.
- ! This product is not suitable for running or skating.
- ! Pushchair designed to be used from birth shall recommend the use of the most reclined position for new born babies.
- ! The parking device shall be engaged when placing and removing children.
- ! For car seats used in conjunction with a chassis, this vehicle does not replace a cot or a bed. Should your child need to sleep, then it should be placed in a suitable pram body, cot or bed.

## Stroller Assembly

Please read all the instructions in this manual before assembling and using this product.

### Open Stroller see images ① - ②

Separate storage latch from storage mount ①, and then lift the handle upwards ②, a click sound means the stroller is open completely.

- ! Check that the stroller is completely latched before continuing to use.

### Assemble Front Wheel see images ③ - ④

### Assemble Rear Wheels

see images 5 - 6  
Assemble Armbar

see images 7 - 8

The completely assembled stroller is shown as 9

## Stroller Operation

Adjust Backrest  
see images 10 - 11

There are 4 recline angles for the backrest.

Recline Backrest

To recline the backrest, squeeze the recline handle on the back of the seat, pull down on the backrest. 10

Raise Backrest

To raise the backrest, push up. 11

! Make sure the recline is set properly for use.

Use Buckle  
see images 12 - 13

Release Buckle

Press the center button to release the buckle. 12

Lock Buckle

Match the waist belt buckle with the shoulder buckle 13 - 1, and click into the center buckle. 13 - 2

A "click" sound means the buckle is locked completely. 13 - 3

! To avoid serious injury from falling or sliding out, always secure your child with harness.

! Make sure your child is snugly secured. The space between the child and the shoulder harness is about the thickness of one hand.

! Do not cross the shoulder belts. This will cause pressure on a child's neck.

Use Shoulder & Waist Harnesses  
see images 14 - 17

! In order to protect your child from falling out, after your child is placed into the seat, check whether the shoulder and waist harnesses are at proper height and length.

14 - 1 Shoulder harness anchor A

14 - 2 Shoulder harness anchor B

14 - 3 Slide adjuster

For larger child, use shoulder harness anchor A and the highest shoulder slots. For smaller child, use shoulder harness anchor B and the lowest shoulder slots.

To adjust the position of the shoulder harness anchor, turn the anchor to be level with the side facing forward. Thread it through the shoulder harness slot from back to front. 15 Rethread it through the slot that is closest to child's shoulder height. 16

Use slide adjuster to change the harness length. 17 - 1

Press the button 17 - 2, while pulling the waist harness to proper length. 17 - 3

Adjust Calf Support

see images 18

The calf support has 2 positions.

To raise the calf support, push it upwards. A "click" sound means the calf is locked completely.

To lower calf support, press the adjustment buttons on both sides of the calf support 18 - 1, and rotate the calf support downwards. 18 - 2

Use Front Swivel Lock

see images 19

Push up the front swivel locks to maintain the moving direction. 19

**Tip** It is recommended to use swivel locks on uneven surfaces.

Use Brake

see images 20 - 21

To lock wheels, step the brake lever downwards. 20

To release wheels, just lift the brake lever upwards. 21

**Tip** Always set the parking brake when stroller is not moving.

Use Hood

see images 22

The hood can be opened or folded, pull it toward front or back.

The hood can be opened completely to protect your child from the sun uttermostly, just unzip the hook 22, and then pull the hood toward front.

There is a window on the hood, through which you can view your baby.

! Total maximum weight of hood pocket MUST not exceed 0.5kg.

Fold Stroller

see images 23 - 25

! Please fold the hood before folding the stroller.

1. Pull the folding webbing upward, the frame will automatically fold backward. 23 - 1

2. The storage latch will automatically hook onto the storage mount, then the stroller is folded and locked completely. 24

3. The stroller can stand when folded. 25



## Use Accessories

Accessories may be sold separately or may not be available depending on region.

### Use Rain Cover

see images 27

To assemble the rain cover, place it over the stroller, and then attach the 8 pairs of hook and loop fasteners on the rain cover. 27

- ! Before using the rain cover, please make sure the backrest has been adjusted to the lowest position and the infant car seat has been fastened.
- ! When using the rain cover, please always check its ventilation.
- ! When not in use, please check that the rain cover has been cleaned and dried before folding.
- ! Do not fold the stroller after assembling the rain cover.
- ! Do not place your child into the stroller assembled with rain cover during hot weather.

### Use Footmuff

see images 28 - 30

### Use with Car Seat

see images 31 - 33

Use this car seat adapter only with the Litetrax™4 Stroller and approved Joie Gemm, Nuna Pipa car seats.

- ! If you have any problems about using the car seat, please refer to their own instruction manuals.
- ! Please don't fold stroller when attaching the car seat.

### Use Parent Tray

see images 39 - 41

- ! Do not place any item that may do harm to the baby and stroller in the parent tray.

## Care and Maintenance

- ! Removable seat pad may be washed in cold water and drip-dried. No bleach.
- ! To clean stroller frame, use only household soap and warm water. No bleach or detergent.
- ! From time to time, check your stroller for loose screws, worn parts, torn material or stitching. Replace or repair the parts as needed.
- ! Excessive exposure to sun or heat could cause fading or warping of parts.
- ! If stroller becomes wet, open hood and allow to dry thoroughly before storing.
- ! If wheels squeak, use a light oil (e.g., Silicon Spray, antirust oil, or sewing machine oil). It is important to get the oil into the axle and wheel assembly. 26
- ! When using your stroller at the beach, completely clean your stroller after use to remove sand and salt from mechanisms and wheel assemblies.