

**bright**  
by Joie™

**myrtle™**

**stroller**

Instruction Manual

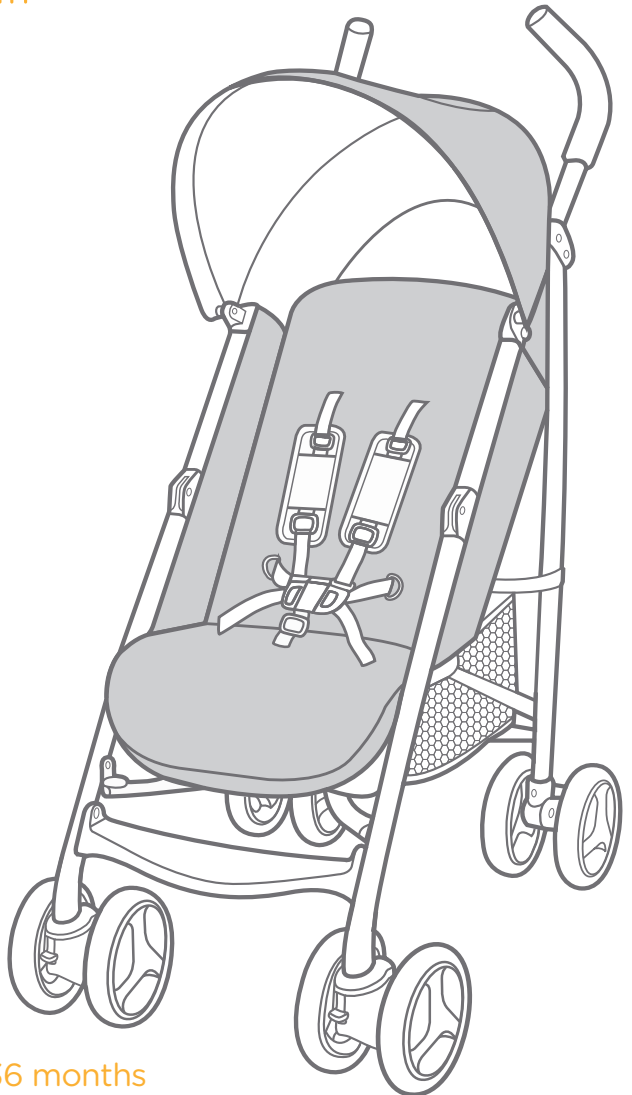

birth to 15kg/birth - 36 months

# IMPORTANT - KEEP THESE INSTRUCTIONS FOR FUTURE REFERENCE.

FIGURE 1 - 5

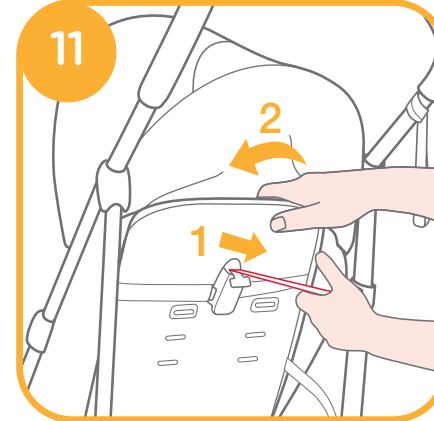
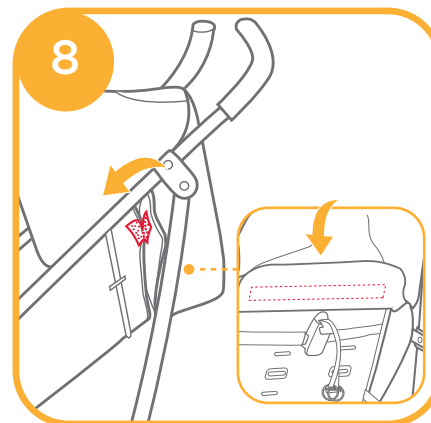
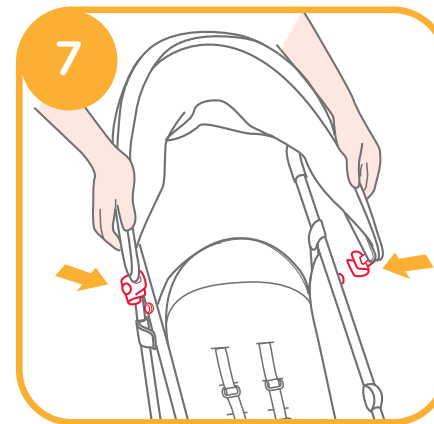
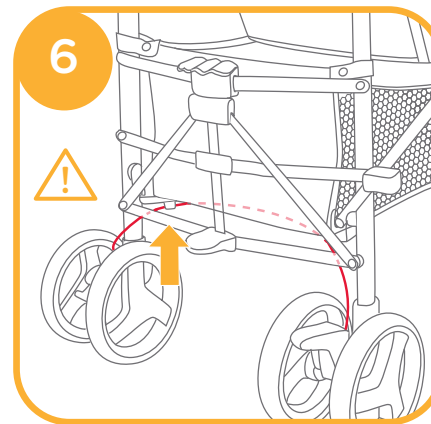
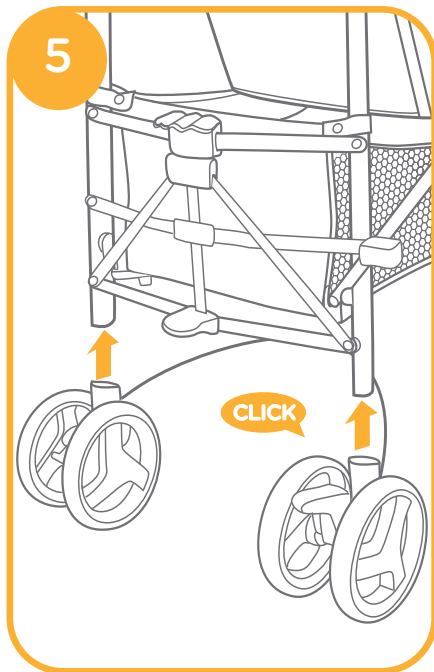
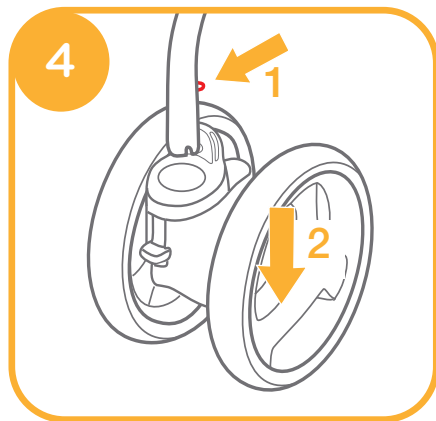
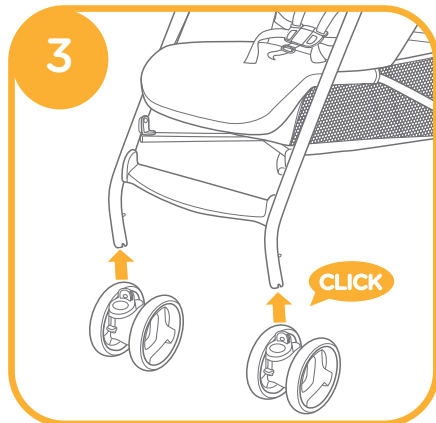
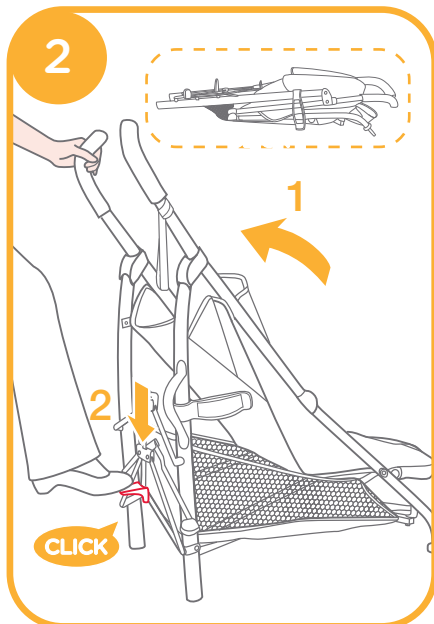
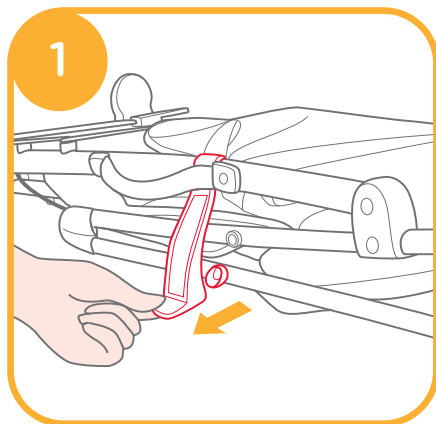
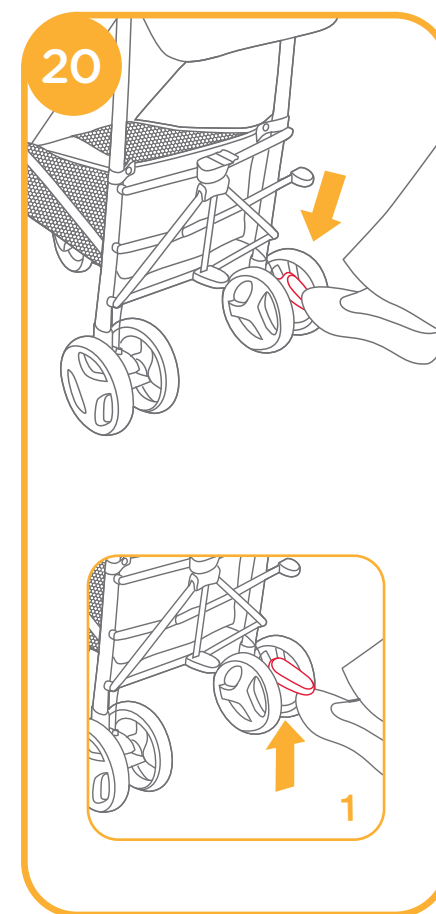
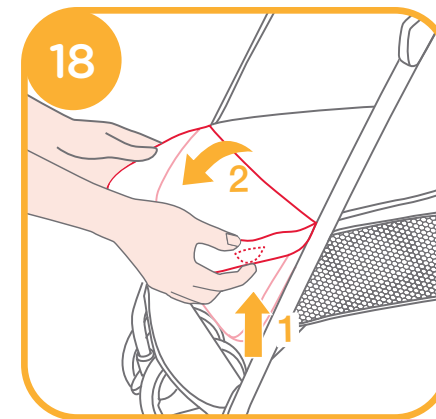
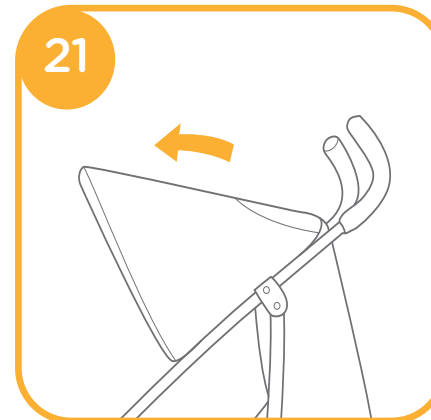
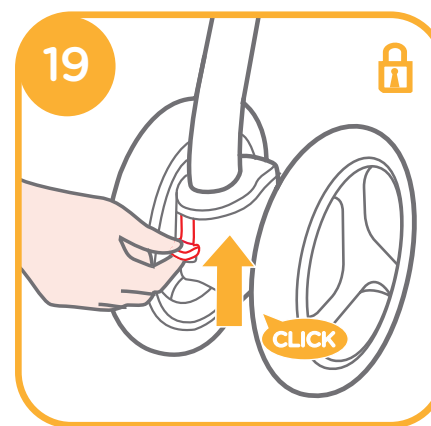
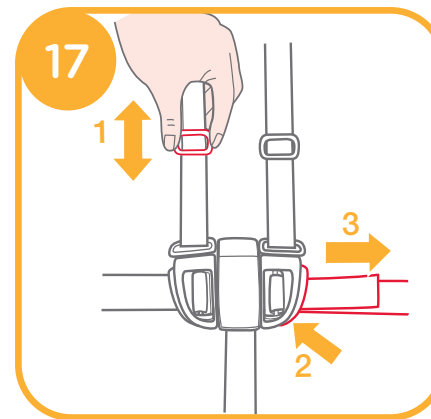
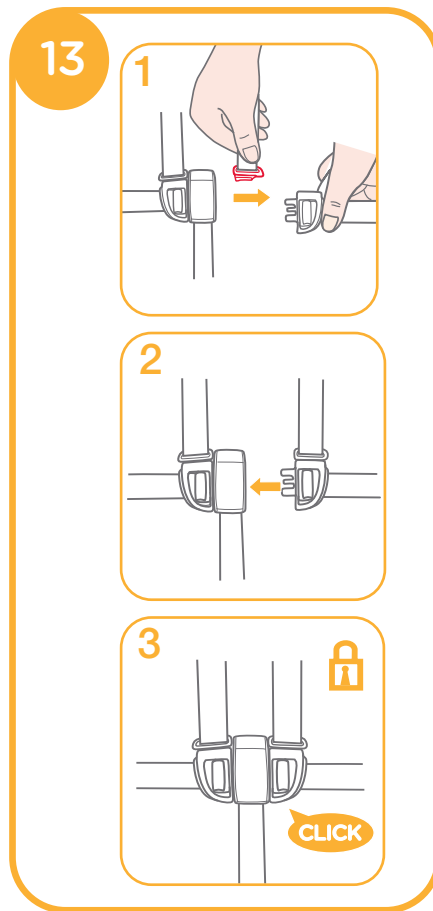
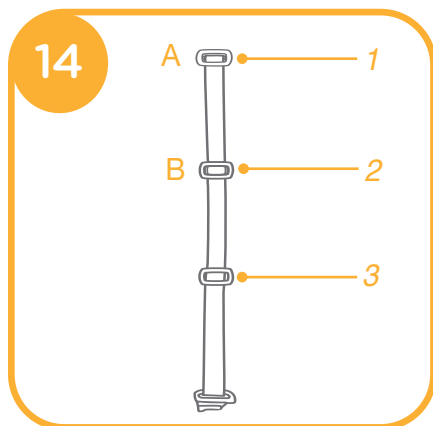
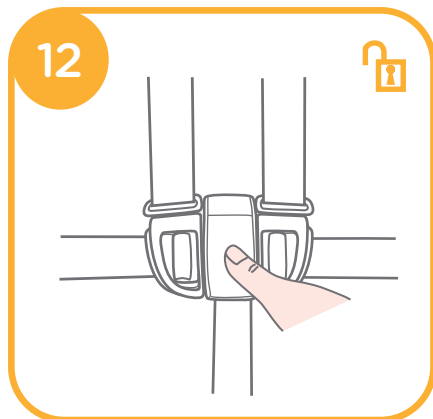
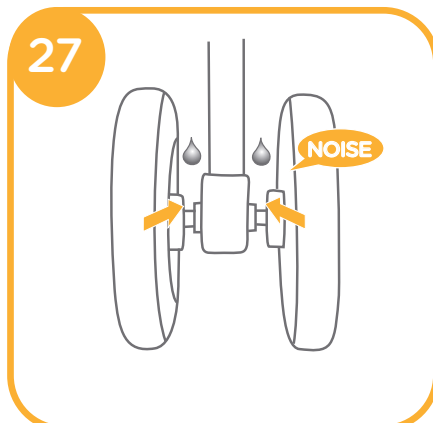
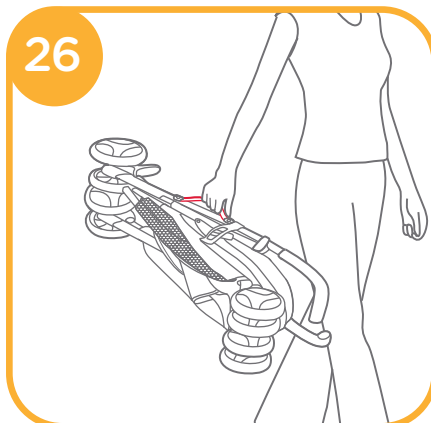
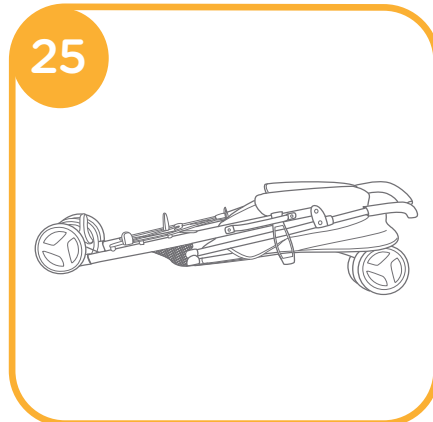
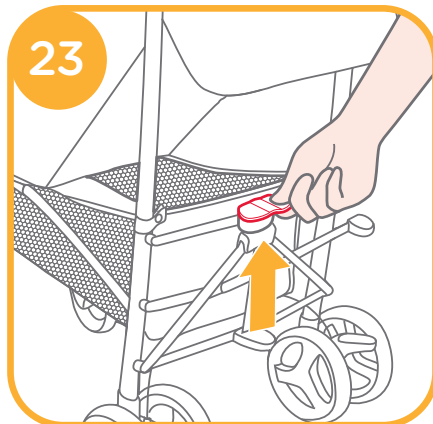
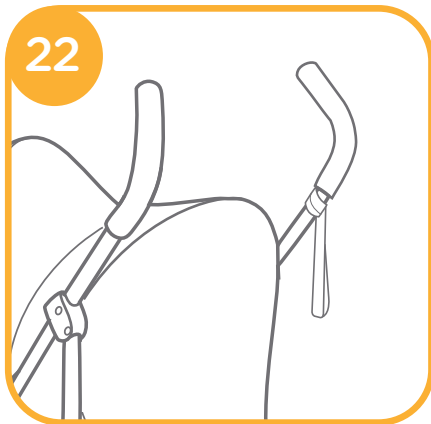
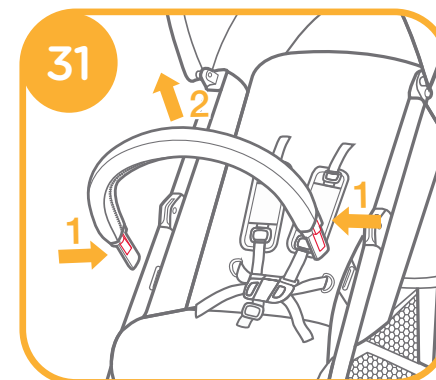
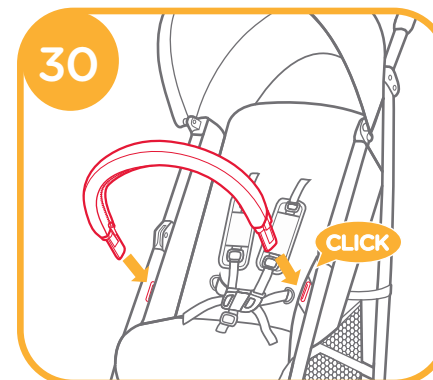
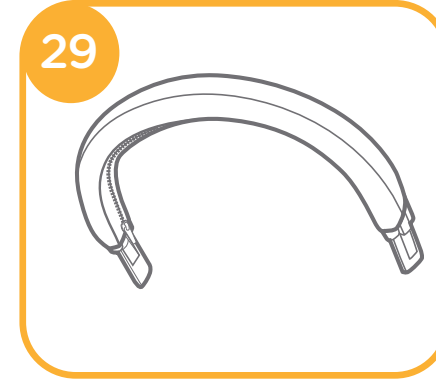

FIGURE 6 - 11





## Accessories (not included in purchase)



Congratulations on becoming part of the Joie family! We are so excited to be part of your journey with your little one. While traveling with the Joie Myrtle™, you are using a high quality, fully certified stroller, complies with Australian Trade Practices Act 1974 Consumer Protection Notice No 8 of 2007. This product is suitable for use with children weighing under 15kg. Please carefully read this manual and follow each step to ensure a comfortable ride and best protection for your child.

**IMPORTANT - Keep these instructions for future reference.**

Visit us at [joiebaby.com](http://joiebaby.com) to download manuals and see more exciting Joie products!

For warranty information, please visit our website at [joiebaby.com](http://joiebaby.com)

## Contents

Figures	1-6
Product Information	8
Parts List	9
WARNING	10-12
<b>Stroller Assembly</b>	<b>13</b>
Open Stroller	13
Assemble Front Wheels	13
Assemble Rear Wheels	13
Assemble Canopy	13
<b>Stroller Operation</b>	<b>14</b>
Adjust Backrest Angle	14
Use Buckle	14
Use Shoulder & Waist Harnesses	14
Adjust Calf Support	15
Use Front Swivel Lock	15
Use Brake	15
Use Canopy	16
Use Tether Strap	16
Fold Stroller	16
Use Carry Strap	16
Accessories	16
Care and Maintenance	17

## Emergency

In case of emergency or accident, it is most important to have your child taken care of with first aid and medical treatment immediately.

## Product Information

Read all the instructions in this manual before using this product. If you have any further questions, please consult the retailer. Some features may vary depending on model.

<b>Product</b>	<b>Myrtle Stroller</b>
<b>Suitable for</b>	<b>Child weighing under 15kg (birth - 36 months)</b>
<b>Materials</b>	<b>Plastics, metal, fabrics</b>
<b>Patent No.</b>	<b>Patents pending</b>
<b>Made in</b>	<b>China</b>
<b>Brand Name</b>	<b>Bright by Joie</b>
<b>Website</b>	<b><a href="http://www.joiebaby.com">www.joiebaby.com</a></b>
<b>Distributor</b>	<b>Allison AU Pty Ltd</b>

## Parts List

Make sure all parts are available before assembly. If any part is missing, please contact local retailer. No tools are required for assembly.

- |                    |                   |
|--------------------|-------------------|
| 1 Stroller Frame   | 11 Calf Support   |
| 2 Front Wheel (x2) | 12 Buckle         |
| 3 Rear Wheels      | 13 Safety Harness |
| 4 Hood             | 14 Storage Basket |
| 5 Handle           | 15 Foot Plate     |
| 6 Carry Strap      | 16 Brake Lever    |
| 7 Storage Latch    | 17 Folding Pedal  |
| 8 Rear Wheel       | 18 Folding Plate  |
| 9 Front Wheel      | 19 Tether Strap   |
| 10 Footrest        |                   |

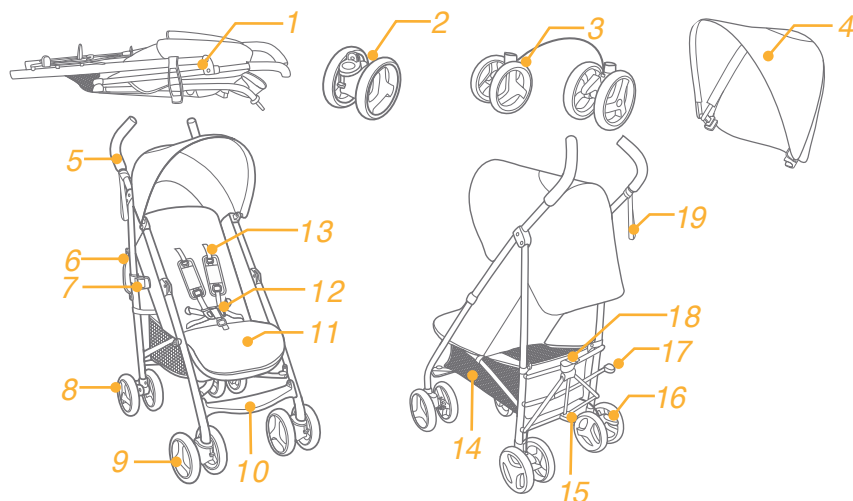

## Accessories (May not be included)

- 1 Rain Cover (on certain models)
- 2 Armbar Cover (on certain models)

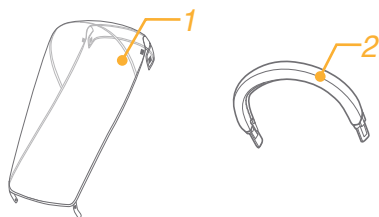

## ! WARNING

- ! FOLLOW THE MANUFACTURER'S INSTRUCTIONS.
- ! PUT ON ALL THE BRAKES WHENEVER YOU PARK THE STROLLER.
- ! DO NOT LEAVE CHILDREN UNATTENDED.
- ! DO NOT CARRY EXTRA CHILDREN OR BAGS ON THIS STROLLER.
- ! **MAKE SURE CHILDREN ARE CLEAR OF ANY MOVING PARTS IF YOU ADJUST THE STROLLER, OTHERWISE THEY MAY BE INJURED.**
- ! TO AVOID INJURY OR DEATH: ALWAYS APPLY THE BRAKES WHENEVER THE STROLLER IS STATIONARY.
- ! ALWAYS KEEP CHILD IN VIEW WHILE IN STROLLER.
- ! ALWAYS USE THE CROTCH COMBINATION WITH THE WAIST BELT. IT IS SUGGESTED THAT THE SHOULDER HARNESSES BE USED AS WELL.
- ! TO AVOID SERIOUS INJURY FROM FALLING OR SLIDING OUT, ALWAYS USE SEAT BELT.
- ! USE THIS TETHER STRAP TO STOP THE STROLLER ROLLING AWAY.
- ! ENSURE THAT ALL THE LOCKING DEVICES ARE ENGAGED BEFORE USE.
- ! DO NOT LET YOUR CHILD PLAY WITH THIS PRODUCT.
- ! NEVER LEAVE THE HARNESS BUCKLED WHEN NOT FITTED TO A CHILD IN THE STROLLER BECAUSE THE HARNESS CAN FORM LOOPS WHICH MAY POSE A STRANGULATION HAZARD.
- ! THE USE OF ACCESSORIES NOT APPROVED BY THE VEHICLE MANUFACTURER IS UNSAFE.
- ! ADULT ASSEMBLY REQUIRED.
- ! USE THE STROLLER WITH A CHILD WEIGHING LESS THAN 22KG. IT WILL CAUSE DAMAGE TO THE STROLLER WITH AN UNFITTED CHILD.
- ! TO PREVENT A HAZARDOUS, UNSTABLE CONDITION, DO NOT PLACE MORE THAN 4.5KG IN THE STORAGE BASKET.
- ! THE STROLLER IS NOT BE USED NEAR AN OPEN FIRE OR EXPOSED FLAME.
- ! USE THE STROLLER WITH ONLY ONE CHILD AT A TIME. NEVER PLACE PURSES, SHOPPING BAGS, PARCELS OR ACCESSORY ITEMS ON THE HANDLE OR HOOD.



- ! OVERLOADING, FOLDING INCORRECTLY, OR USING COMPONENT PARTS FROM OTHER MANUFACTURERS MAY CAUSE THE STROLLER TO BE DAMAGED, BROKEN OR UNSAFE. PLEASE READ THE INSTRUCTION MANUAL CAREFULLY.
- ! PLEASE READ ALL THE INSTRUCTIONS IN THE MANUAL BEFORE USING THE PRODUCT. PLEASE SAVE INSTRUCTION MANUAL FOR FUTURE USE. FAILURE TO FOLLOW THESE WARNINGS AND INSTRUCTIONS MAY RESULT IN SERIOUS INJURY OR DEATH.
- ! SAFETY BELTS AND RESTRAINT SYSTEMS MUST BE USED CORRECTLY.
- ! CHILD MAY SLIP INTO LEG OPENINGS AND BE STRANGLED IF THE HARNESS IS NOT USED.
- ! NEVER USE STROLLER ON STAIRS OR ESCALATORS.
- ! KEEP AWAY FROM HIGH TEMPERATURE OBJECTS, LIQUIDS, AND ELECTRONICS.
- ! NEVER ALLOW YOUR CHILD TO STAND ON THE STROLLER OR SIT IN THE STROLLER WITH HEAD TOWARD FRONT OF STROLLER.
- ! NEVER PLACE THE STROLLER ON ROADS, SLOPES OR DANGEROUS AREAS.
- ! DO MAKE SURE ALL MECHANISMS ARE FIXED BEFORE USING THE STROLLER.
- ! TO AVOID STRANGULATION, DO NOT PLACE ITEMS WITH A STRING AROUND YOUR CHILD'S NECK, SUSPEND STRINGS FROM THIS PRODUCT, OR ATTACH STRINGS TO TOYS.
- ! DO NOT LIFT STROLLER WHILE CHILD IS IN STROLLER.
- ! DO NOT USE STORAGE BASKET AS A CHILD CARRIER.
- ! TO PREVENT TIPPING, NEVER LET CHILD CLIMB THE STROLLER. ALWAYS LIFT THE CHILD IN AND OUT OF THE STROLLER.
- ! TO AVOID FINGER ENTRAPMENT, USE CARE WHEN FOLDING AND UNFOLDING THE STROLLER.
- ! PLEASE KEEP THE STORAGE LATCH LOCKING CORRECTLY WHEN LIFT AND MOVE THE UNIT.
- ! PLEASE TRANSPORT THE FOLDED STROLLER SAFELY.
- ! TO AVOID STRANGULATION, DO MAKE SURE YOUR CHILD IS CLEAR FROM THE HOOD.

- ! THE VEHICLE IS DESIGNED FOR USE ON FLAT OR GENTLY SLOPING SURFACES AND MAY BE UNSTABLE ON HIGHER SLOPING AND UNEVEN SURFACES; RESULTING IN THE POSSIBILITY OF THE VEHICLE TIPPING OVER.
- ! DISCONTINUE USING STROLLER IF IT IS DAMAGED OR BROKEN.
- ! THIS PRODUCT IS NOT SUITABLE FOR RUNNING OR SKATING. STROLLER TO BE USED ONLY AT WALKING SPEED. THIS PRODUCT IS NOT INTENDED FOR USE WHILE JOGGING.
- ! TO AVOID SUFFOCATION, REMOVE PLASTIC BAG AND PACKAGING MATERIALS BEFORE USING THIS PRODUCT. THE PLASTIC BAG AND PACKAGING MATERIALS SHOULD THEN BE KEPT AWAY FROM BABIES AND CHILDREN.
- ! STROLLER DESIGNED TO BE USED FROM BIRTH SHALL RECOMMEND THE USE OF THE MOST RECLINED POSITION FOR NEW BORN BABIES.
- ! ALWAYS APPLY THE BRAKES WHENEVER THE STROLLER IS STATIONARY.
- ! EXTRA CARE IS NEEDED IF USED ON MOVING VEHICLES AND CHILD SHOULD NOT BE LEFT UNATTENDED, EVEN WITH BRAKES ENGAGED.
- ! USE THIS HARNESS AT ALL TIMES.
- ! SECURE THE CHILD IN THE HARNESS AT ALL TIMES.
- ! THE VEHICLE IS NOT TO BE USED AS AN UNSUPERVISED SLEEPING ENVIRONMENT.

# Stroller Assembly

Please read all the instructions in this manual before assembling and using this product.

## Open Stroller

Separate storage latch from storage mount ❶, and then lift the handle upwards ❷ - ❶, push the foot plate downwards with foot ❷ - ❷, a click sound means the stroller is open completely.

! Check that the stroller is completely open before continuing.

## Assemble Front Wheels

Assemble front wheels to front legs. Check that wheels are securely attached by pulling on wheel assemblies. ❸

To disassemble front wheel, the front wheels can be disassembled by pressing the snap buttons. ❹

## Assemble Rear Wheels

Assemble rear wheels to rear legs ❺. Check that wheels are securely attached by pulling on wheel assemblies.

Snap the brake cable into the fixing tabs under square tubes to fix it. ❻

! Regularly check the cable is secured to avoid damage and brake failure.

## Assemble Canopy

Align the holes of the hood mounts with the posts on the tubes, and then insert to assemble the hood ❼, stick the hook and loop fasteners, snap the buttons to attach the rear hood to backrest. ❽

The completely assembled stroller is shown as ❾

# Stroller Operation

## Adjust Backrest Angle

### Recline Backrest

Pull the backrest backwards, while pressing the button in the center of the angle adjuster. ❿

### Raise Backrest

Push the backrest forwards, while pulling the webbing at the end of the angle adjuster. ⓫

! Make sure the recline is set properly for use.

## Use Buckle

### Release Buckle

Press the center button to release the buckle. ⓬

### Lock Buckle

Match the waist belt buckle with the shoulder buckle ⓭ - ❶, and click into the center buckle. ⓭ - ❷ A “click” sound means the buckle is locked completely. ⓭ - ❸

! To avoid serious injury from falling or sliding out, always secure your child with harness.

! Make sure your child is snugly secured. The space between the child and the shoulder harness is about the thickness of one hand.

! Do not cross the shoulder belts. This will cause pressure on child's neck.

## Use Shoulder & Waist Harnesses

! In order to protect your child from falling out, after your child is placed into the seat, check whether the shoulder and waist harnesses are at proper height and length.

⓬ - ❶ Shoulder harness anchor A

⓬ - ❷ Shoulder harness anchor B

⓬ - ❸ Slide adjuster



For larger child, use shoulder harness anchor A and the highest shoulder slots. For smaller child, use shoulder harness anchor B and the lowest shoulder slots.

To adjust the position of the shoulder harness anchor, turn the anchor to be level with the side facing forward. Thread it through the shoulder harness slot from back to front **15**. Rethread it through the slot that is closest to child's shoulder height. **16**

Use slide adjuster to change the harness length. **17 - 1**

Press the button **17 - 2**, while pulling the waist harness to proper length. **17 - 3**

## Adjust Calf Support

The calf support has 2 positions.

Raise Calf Support

To raise the calf support, just push it upwards.

Lower Calf Support

Press the adjustment buttons on both sides of the calf support **18 - 1**, and rotate the calf support downwards. **18 - 2**

## Use Front Swivel Lock

Push up the front swivel locks to maintain the moving direction. **19**

**Tip** It is recommended to use swivel locks on uneven surfaces.

## Use Brake

To lock wheels, step the brake lever downwards. **20**

To release wheels, just lift the brake lever upwards. **20 - 1**

**Tip** Always apply brake when stroller is in stopped position.

**Tip** Clean brake system regularly to ensure fully functional. See care and maintenance section.

**Tip** To ensure brake is fully on, gently rock the stroller backwards and forwards before releasing the handle.

## Use Canopy

To open the canopy, pull canopy toward front. **21**

To fold the canopy, pull canopy toward back.

## Use Tether Strap

Use the tether strap to prevent the stroller inadvertently rolling away. Check that when your hand is through the loop, it allows you to easily control the stroller. **22**

## Fold Stroller

! Please fold the canopy before folding the stroller.

Lift the folding plate **23**, step the folding pedal downwards **24 - 1**, push the stroller forward to fold **24 - 2**. The storage latch will automatically hook onto the storage mount, then the stroller is folded and locked completely. **25**

## Use Carry Strap

You can carry the stroller with ease by lifting the carry strap. **26**

## Accessories

Accessories may be sold separately or may not be available depending on region.

## Use Rain Cover

To assemble the rain cover, place it over the stroller, and then attach the hook and loop fasteners on the rain cover. **28**

! When using the rain cover, please always check its ventilation.

! When not in use, please check that the rain cover has been cleaned and dried before folding.

! Do not fold the stroller after assembling the rain cover.

! Do not place your child into the stroller assembled with rain cover during hot weather.

Use Armbar  
see images 29 - 32

## Care and Maintenance

- ! Removable seat pad may be washed in cold water and drip-dried. No bleach.
- ! To clean stroller frame, use only household soap and warm water. No bleach or detergent.
- ! From time to time, check your stroller for loose screws, worn parts, torn material or stitching. Replace or repair the parts as needed.
- ! Excessive exposure to sun or heat could cause fading or warping of parts.
- ! If stroller becomes wet, open canopy and allow to dry thoroughly before storing.
- ! If wheels squeak, use a light oil (e.g., Silicon Spray, antirust oil, or sewing machine oil). It is important to get the oil into the axle and wheel assembly. 27
- ! If brake pedal stiff/hard to fully engage, flush any debris from brake system with clean water first before lubricating.
- ! When using your stroller at the beach or areas of high dust/sand, completely clean your stroller after use to remove sand and salt from brake mechanisms and wheel assemblies.



**Distributed by Allison AU Pty Ltd**

**ACN: 642 240 140**

**Unit 1, 35 Lyn Parade**

**Prestons**

**NSW Australia 2170**

**For after-sales & warranty service, contact:**

**1800 951 070**

**[customerservice@allisonau.com.au](mailto:customerservice@allisonau.com.au)**