

bright ^{by Joie™} **narra™**

Type E
Booster Seat

MODEL BC1220G

Instruction Manual

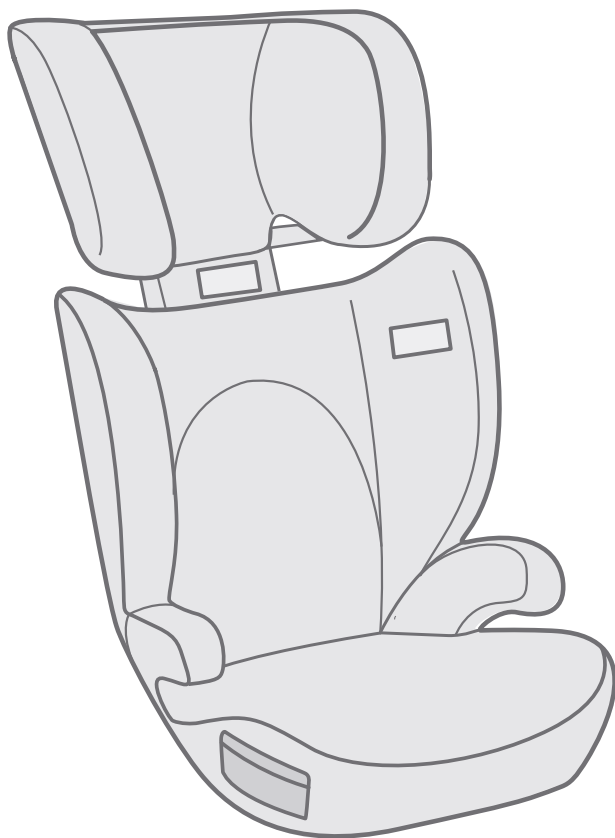

IMPORTANT: KEEP THIS BOOKLET IN THE PLACE PROVIDED ON THE CHILD RESTRAINT. THIS RESTRAINT IS NOT SUITABLE FOR USE WHERE THE TOP TETHER STRAP MAY FALL INTO A SPLIT IN THE SEAT BACK OR OFF THE SIDE OF THE SEAT.

Welcome to Joie™

Please carefully read this manual and follow each step to ensure a comfortable ride and best protection for your child.

CONTENTS

Features 2

QUICK REFERENCE

Installation..... 3 - 5

Use 6 - 8

WARNINGS 9

IMPORTANT INFORMATION 10

Shoulder Height Labels 11 - 12

INSTALLATION

After this booster seat 13

Correct seat belt 14

Airbags 14

Select a stable position 15

Reclining backrest 16

TETHER STRAP WARNINGS 16

Tether Strap 17 - 18

Tether Strap Anchorage 19 - 20

Installation checklist 21

USE

Headrest adjustment 22

Correct vehicle belt positioning 23 - 24

Use checklist 25

Cover removing and refitting 26

GENERAL

Care, Maintenance and Storage 27

Accessories and Spare Parts 27

Store these instructions under the cover for future reference.

DO NOT USE THIS CHILD RESTRAINT UNTIL YOU HAVE READ
AND UNDERSTOOD THE INSTRUCTIONS IN THIS USER
GUIDE AND IN YOUR VEHICLE OWNERS MANUAL

Features

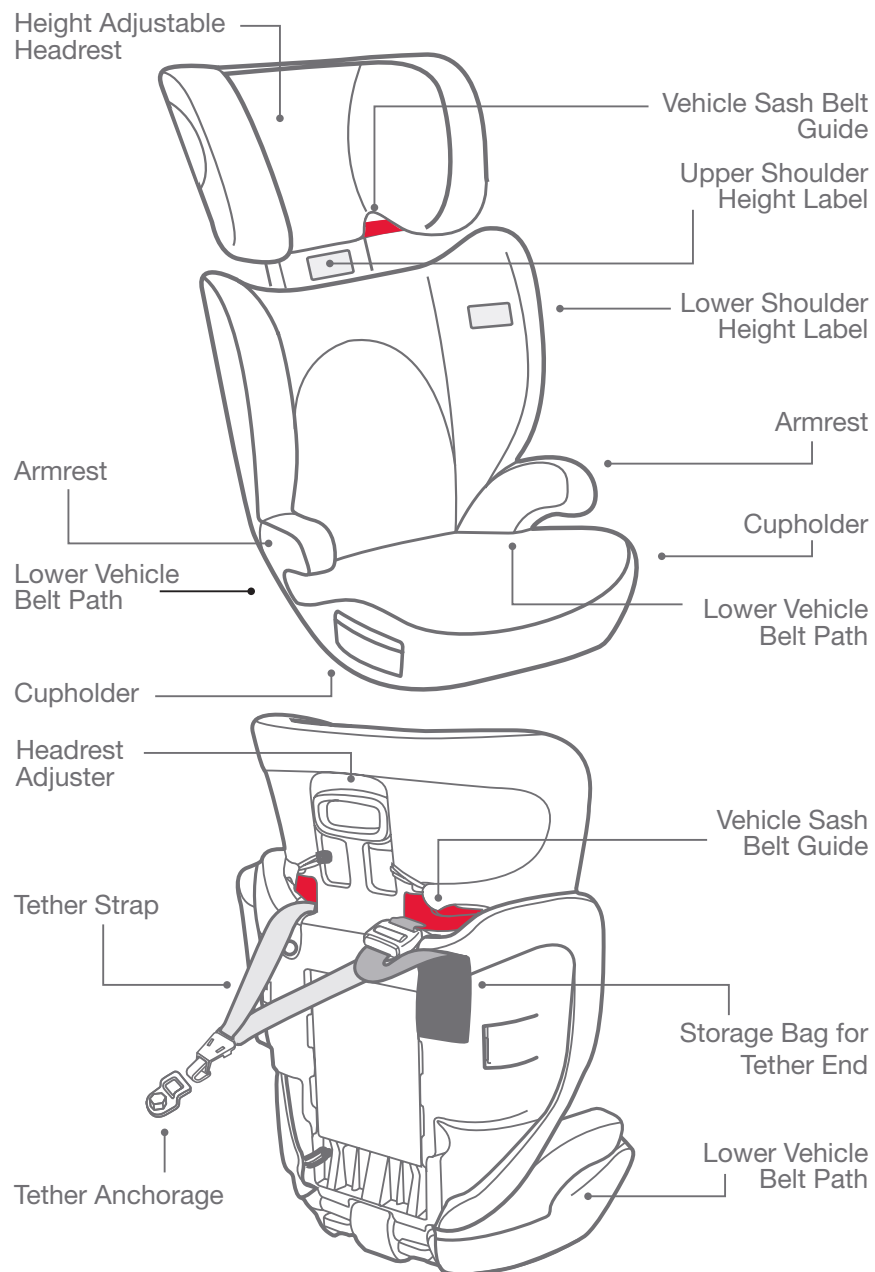

NOTE: some features may vary between models

Quick Reference - Installation

Scan to see
the video.

QR CODE

Task 1

Check this booster is the correct
child restraint for your child.
Refer to the shoulder height
markers.

1a

SHOULDERS
ABOVE LOWER
LINE

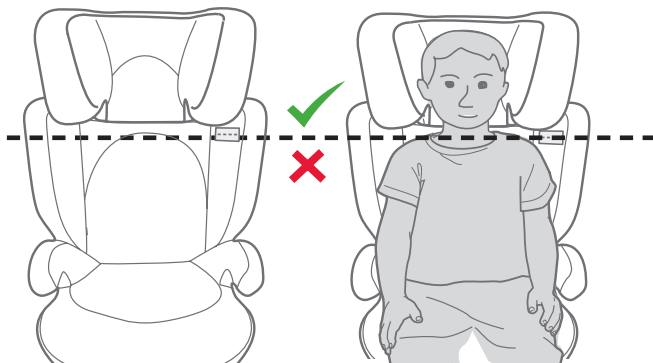

1b

SHOULDERS
BELOW UPPER
LINE WHEN
HEADREST
RAISED

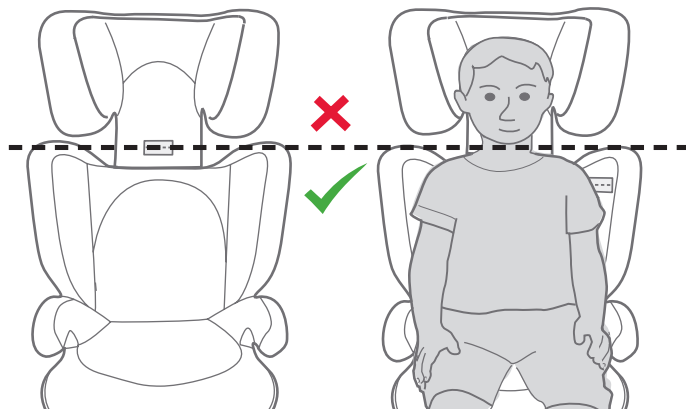

See more
information on
pages 11 & 12

Task 2

Place the booster seat in the car

**SELECT A STABLE
POSITION**

See more
information on
page 15

Quick Reference - Installation

Task 3

Attach the
top tether strap

See more
information
on pages
17 - 18

Step 1



**READ VEHICLE
MANUAL**

Step 2

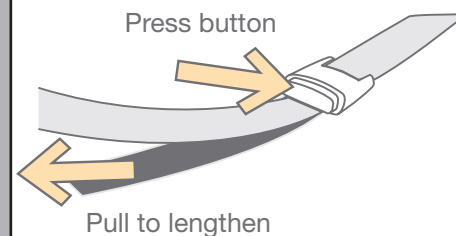

ADJUST TETHER LONGER

Step 3

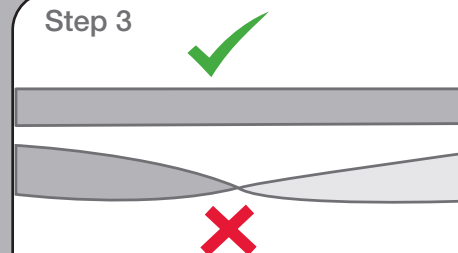

REMOVE TWISTS

Step 4

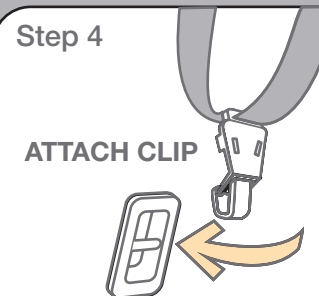

ATTACH CLIP

Step 5

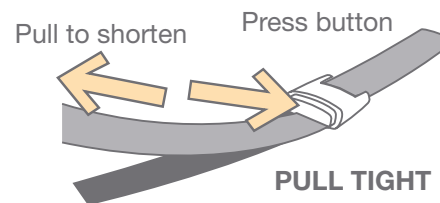

PULL TIGHT

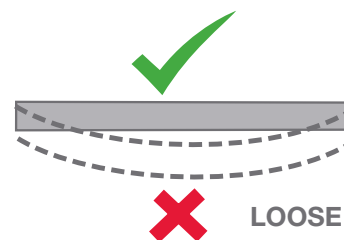

LOOSE

Step 6

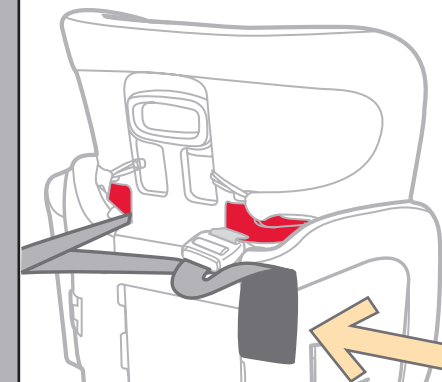

STORE TETHER END IN BAG

Quick Reference - Installation

Checklist

CHECK: NO TWISTS



CHECK: PULLED TIGHT

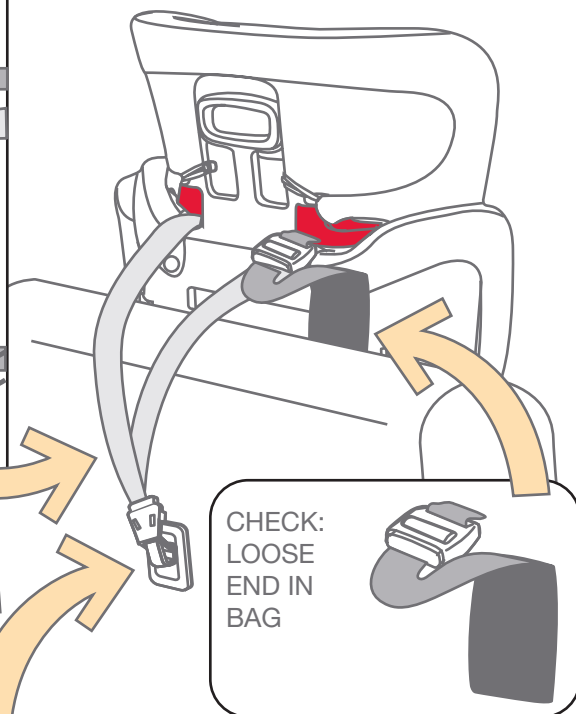

CHECK: LOOSE
END IN
BAG



CHECK: attachment clip connected
securely to correct anchor fitting

Back of
seat



Parcel
shelf

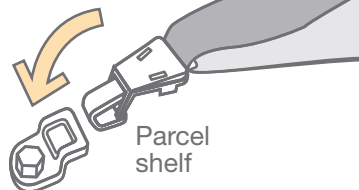

Quick Reference - Use

Use

You will have now installed the
booster seat.

**Place the child into the booster
seat.**

*See more information on
pages 22 - 26*

Task 4

ADJUST HEADREST HEIGHT

*See more information on
page 22*

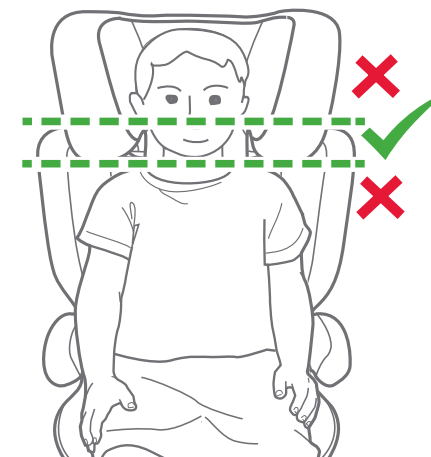
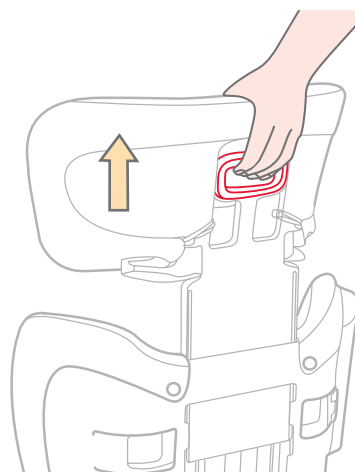

Quick Reference - Use

Task 5
Fit and engage the seat belt.

Step 1 — SASH BELT THROUGH GUIDE

Step 2 — LAP BELT OVER THIGHS

Step 3 — BELTS UNDER ARMRESTS

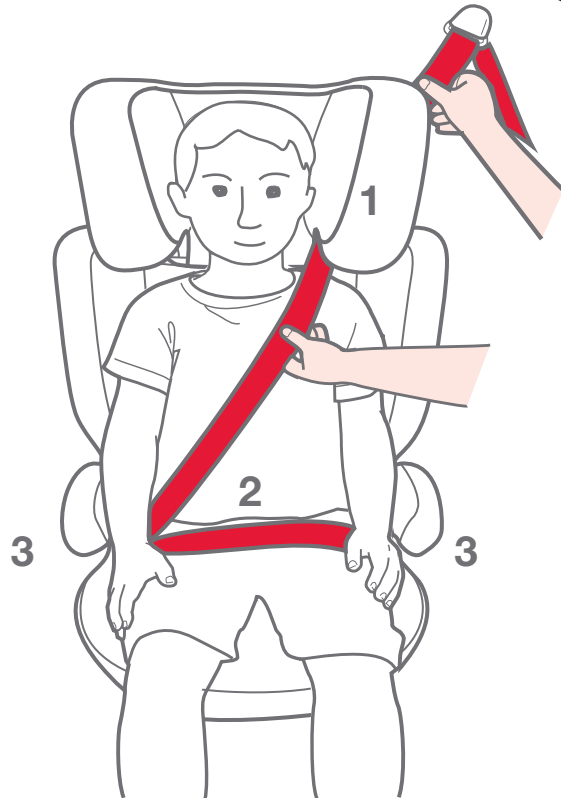

Step 4 — NO TWISTS IN BELTS

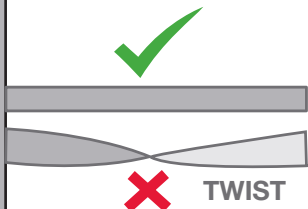

Step 5 — ENGAGE BUCKLE

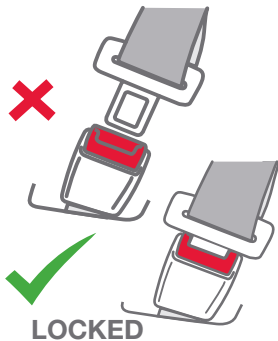

Step 6 — PULL BELT FIRM

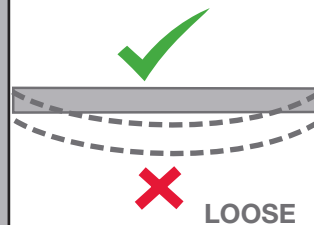

Quick Reference - Use checklist

1
SASH BELT THROUGH GUIDE

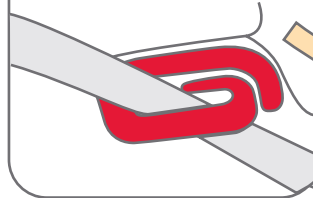

2
LAP BELT THROUGH CLIP



3
BELTS UNDER ARMREST

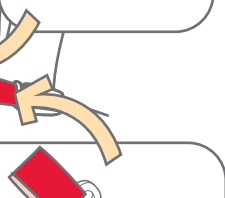

4
VEHICLE BELT ENGAGED



5 NO TWISTS

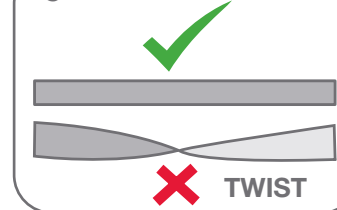

6 BELT PULLED FIRM

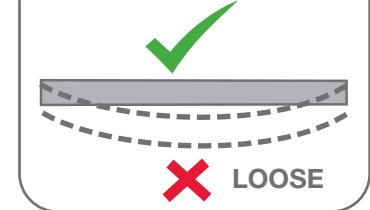

WARNING

DO NOT LEAVE CHILDREN UNATTENDED IN THE CAR

A SASH BELT UNDER THE ARM OR BEHIND THE BACK IS DANGEROUS

WARNINGS

- DO NOT LEAVE CHILDREN UNATTENDED IN THE CAR
- Use the restraint exactly as shown in the Instructions.
- Supervision of children is needed because they may be able to undo buckles.
- DO NOT USE WITH JUST A LAP BELT. You must use with a lap-sash seat belt.
- The lap part of the seatbelt must be firmly across the thighs and the sash strap fitted diagonally across the chest and shoulder.
- Do not allow the restraint to come into contact with polishes, oils, bleach and other chemicals.
- Destroy the restraint if it has been in a severe crash, even if no damage is visible.
- Do not alter or modify this restraint.
- Repairs must only be done by the manufacturer or agent.
- Always store the loose end of the top tether strap.
- **Ensure that the top tether strap doesn't fall into a split in the seat back or off the end of the seat.**
- ALWAYS ATTACH HOOK AND REMOVE SLACK.
- DO NOT USE THIS RESTRAINT WITHOUT THE COVER.
- **This child restraint is not approved for use with any connectors that connect to the car's ISOFIX low anchorages.**

NOTE: These warnings are those required by the Australian and New Zealand Standard AS/NZS 1754 for this type of child restraint. Other warnings specific to this particular child restraint will be found throughout these instructions.

IMPORTANT INFORMATION

THIS RESTRAINT MUST BE USED IN CARS WITH FORWARD-FACING SEATS WITH A LAP-SASH SEATBELT. THIS BOOSTER SEAT IS NOT SUITABLE FOR USE WITH A CHILD HARNESS.

This Child Restraint is: **To be used with a lap-sash seatbelt by a child whose shoulders are above the lower shoulder height marker with head restraint in the lowest position (approximately 4 years of age) until the child's shoulders reach the upper shoulder height marker with the head restraint in highest position (approximately 6 to 8 years of age).**

- Continue to use this booster seat until the child reaches this limit. Children are safest in a booster seat until their shoulders reach the upper shoulder height marker of the booster seat.
- Do not use this booster seat until child's shoulders are above the lower shoulder height marker.
- If the knees do not bend in front of the vehicle seat cushion continue to use a booster seat.
- Ensure that children have adequate ventilation and shade when in the vehicle.

- Seat Belt extenders are not recommended. If the vehicle seat belt is not long enough to secure the restraint seek advice from a child restraint fitter.
- An unsecured booster seat can be thrown around and may injure occupants in a sharp turn, sudden stop or crash. Remove it or make sure that it is securely belted in the vehicle.
- **Do not use any accessory with this child restraint that directly restrains or stops the forward movement of the child's head or neck.**
- Read carefully the whole of the instructions for the installation, and in the event of doubt about the method of installation, consult the child restraint manufacturer or agent, or a child restraint fitting station authorized by the relevant transport authority, or in New Zealand, consult the agent for the vehicle.

Just using a seatbelt is not recommended for children that have outgrown this booster seat. Use a larger booster seat.

CHILD RESTRAINT INSTALLATION LAW (AUSTRALIA)

For Booster Seats: A passenger who is 4 years old or older, but is less than 7 years old, must not be in the front row of a motor vehicle that has 2 or more rows of seats unless all of the other seats in the row or rows behind the front row are occupied by passengers who are also under 7 years old.

Shoulder height Labels



Shoulder Height Labels: while this booster seat is rated as suitable for children from approximately 4 years to 8 years, the exact sizing is determined by the shoulder height labels.

**SHOULDERS ABOVE THIS LINE WHEN
HEADREST AT LOWEST POSITION**

Check smaller children's shoulders are above the dotted line on the lower label

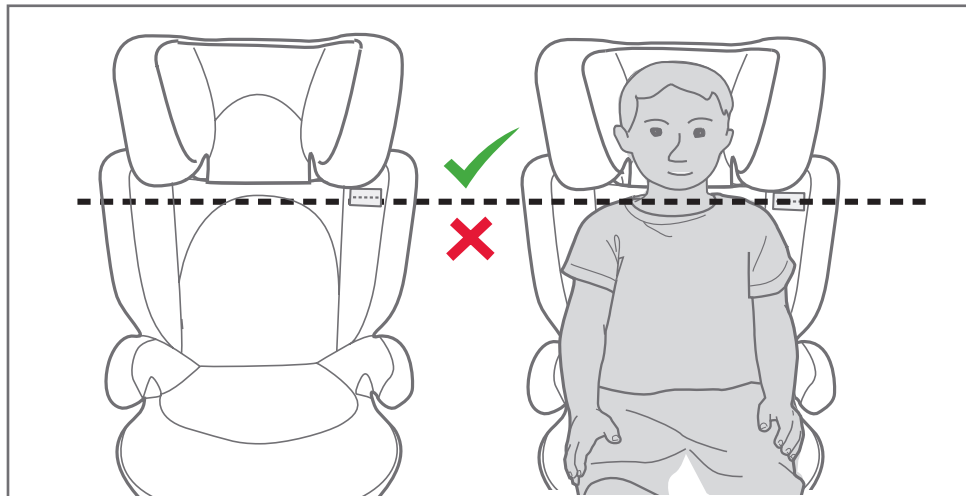

Shoulder height Labels



Place the child on the booster seat with their back firmly up against backrest.
For big children the headrest can be raised up.
See page 22 for information on adjusting the headrest height.

**SHOULDERS BELOW THIS LINE WHEN
HEADREST AT HIGHEST POSITION**

Check bigger children's shoulders are below the dotted line on the upper label.

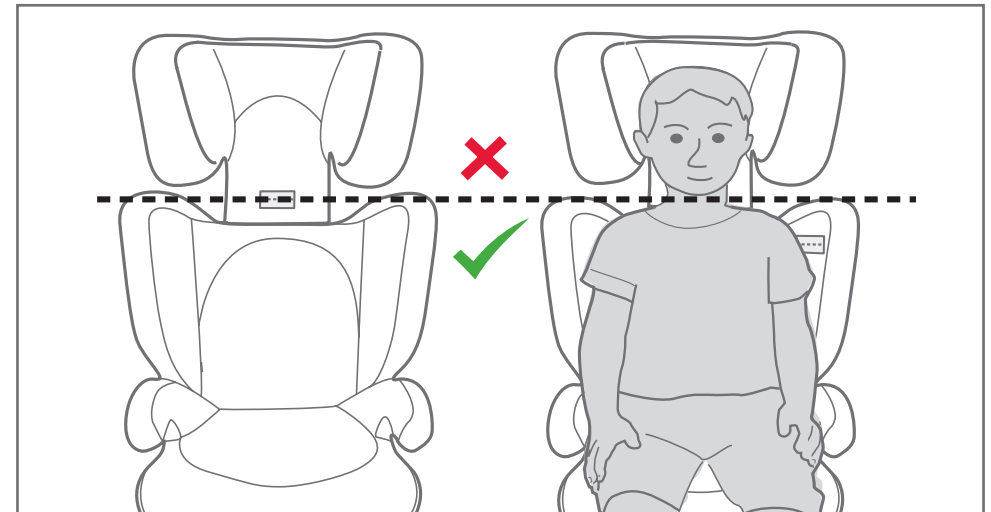

After this Booster Seat

After your child has outgrown this booster seat they should move to a bigger booster seat. Type E10 and Type F booster seats are suitable for children up to approximately 10 years of age.

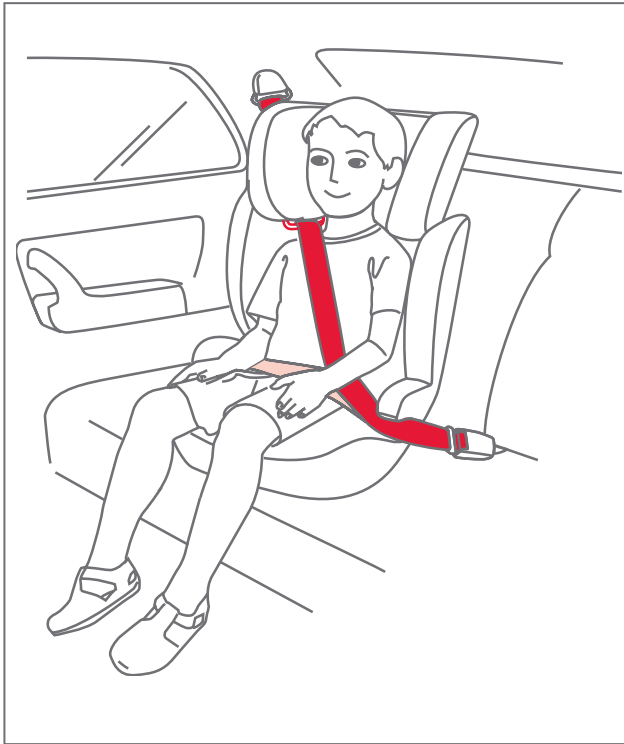

IMPORTANT: If the knees do not bend in front of the vehicle seat cushion, continue to use a booster seat.

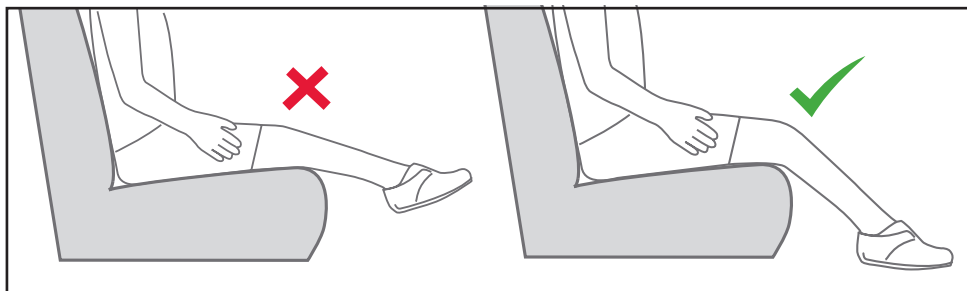

Installation - seating location

The safest position for this booster seat is in the centre rear of the back seat provided it is fitted with a lap/sash seat belt and a tether anchorage.

DO NOT use the front seating position unless there is no rear seat and there is a tether strap mounting position available behind the front seat.

NOTE: In some vehicles (mostly utes or pickups), the tether strap mounting position is behind the vehicle seat backrest and is so close to the back of the booster seat that the tether cannot be tensioned. In this case refer to a licenced child restraint fitter for advice.

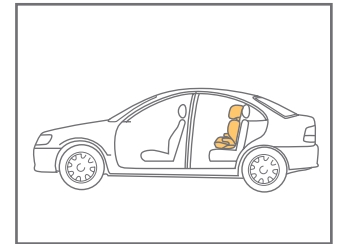
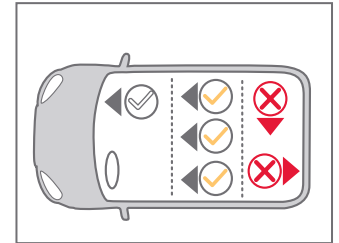

Installation - correct seat belt

Use only the vehicle's lap and shoulder belt when restraining a child in this booster seat.

DO NOT use a lap belt only. The center rear seating position can be used ONLY if there is a lap and shoulder belt seat belt in that seating position.

DO NOT use the center rear position if there is a lap belt only.

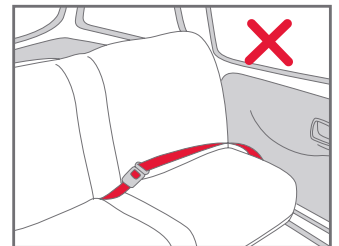
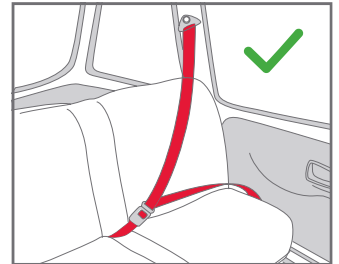

Installation - airbags

Front Seat Airbags - if using the front seating position and the vehicle is fitted with a front airbag in this position move the front seat back as far as possible.

Side or Seatbelt Airbags - if your vehicle has side or seatbelt airbags consult the Vehicle Owners Handbook for information regarding suitable child restraint installation positions. If in doubt refer to a licenced child restraint fitter for advice.

Installation - select a stable position

Before using the Booster Seat check the suitability of the seating position.

Place the Booster Seat on the vehicle seat. Push it firmly into place.

Check that it is stable and if not try another position in the vehicle.

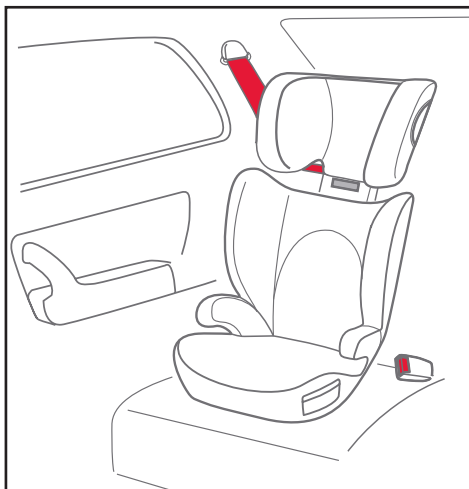

NOTE: in some vehicles the recommended centre rear position is raised and the booster will not sit securely on it. In this case use an outboard position.

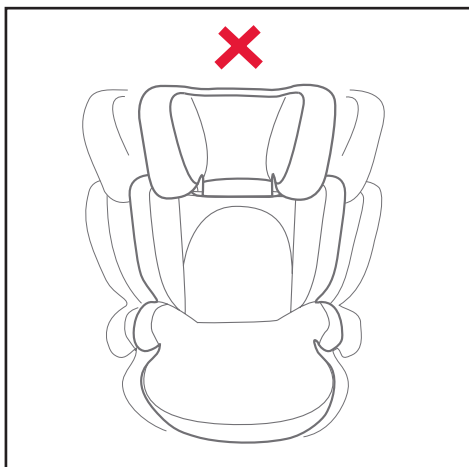

If the Booster Seat is stable connect the Tether Strap.

This child restraint is not approved for use with any connectors that connect to the car's ISOFIX low anchorages.

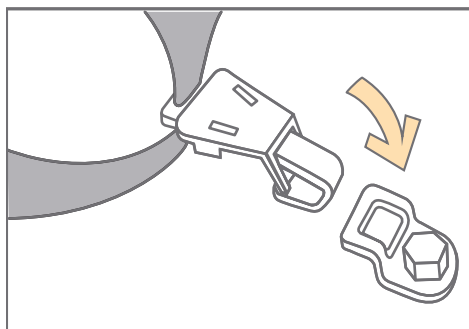

Installation - reclining backrest

Vehicle seats have different shapes and some have a greater backrest angle than others.

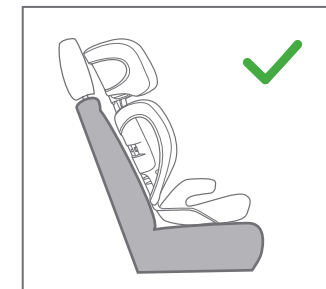
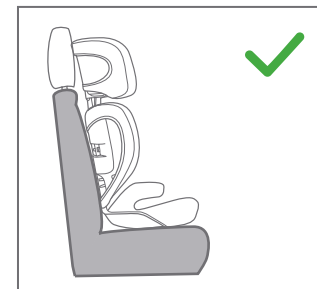

The backrest of the booster can be pushed back to better fit a more reclined vehicle seat. Always have the backrest a close fit to the back of the vehicle seat backrest.

DO NOT try to recline the backrest more than shown in the pictures with green arrows.

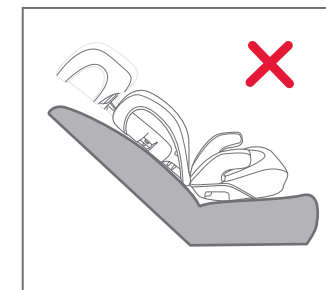

WARNINGS - TETHER STRAP

This restraint must be attached to a child restraint upper anchorage fitting in the vehicle. Refer to vehicle owner's handbook for location of upper anchorage fitting or an approved child restraint installer if the vehicle has no upper anchorage fitting.

Ensure that the top tether strap doesn't fall into a split in the seat back or off the top of the seat.

Always secure the loose end of the top tether strap to prevent it hanging out of the car or being accessible by the child.

It should be stored in the bag attached to the back of the cover.

ALWAYS ATTACH HOOK AND REMOVE SLACK.

In some vehicles without a fixed parcel shelf an extension tether strap may be required. These are available in several different lengths and can be obtained from child restraint retail outlets.

CAUTION: CHILDREN CAN BE INJURED OR RESTRAINTS AND TOP TETHER STRAP DAMAGED BY UNSECURED CARGO IN A COLLISION. SECURE OR REMOVE HAZARDOUS CARGO BEFORE USING THIS CHILD RESTRAINT.

Installation - tether strap

This booster seat has a tether strap permanently attached to the backrest. This is an essential part of the booster seats safety system and must always be used.

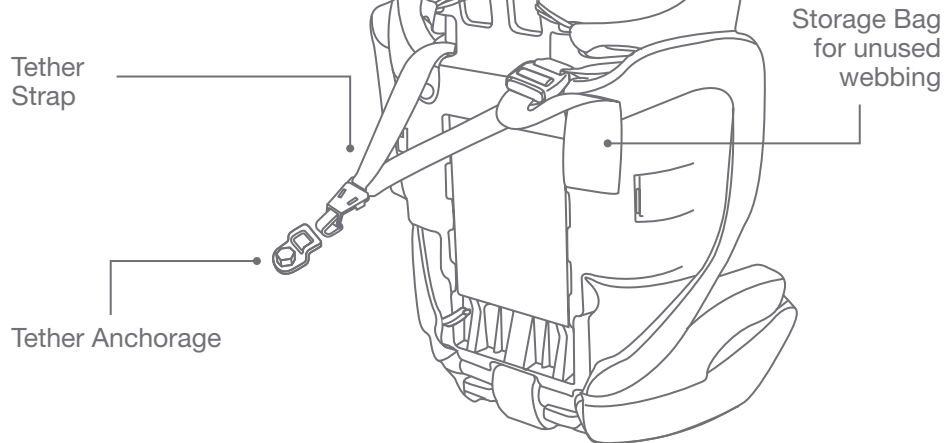

IMPORTANT

Even when the booster seat is not occupied ensure the tether strap is connected . In the event of a sudden stop or accident the booster seat may move about and possibly cause injury.

TETHER ANCHORAGE FITTINGS: most vehicles have in-built top tether anchorage fittings. Consult the vehicle owners handbook for their location.

If the vehicle does not have an in-built upper anchorage fitting or upper anchorage mounting point, contact a retail outlet to obtain an upper anchorage kit.

AUSTRALIA: a vehicle without built-in anchorage fittings should have threaded holes for an after-market fitting to be installed into. See page 19.

NEW ZEALAND: imported vehicles often do not have anchorage fittings and anchorage points. If this is the case an after-market anchorage fitting will need to be purchased and a hole drilled for its installation. See page 20.



Installation - tether strap

Always connect the snap hook securely to the anchorage fitting.

NOTE: many built-in anchor fittings are on the back of the seat.

Adjust the tether to a firm fit.

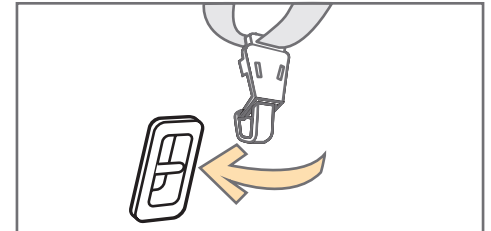
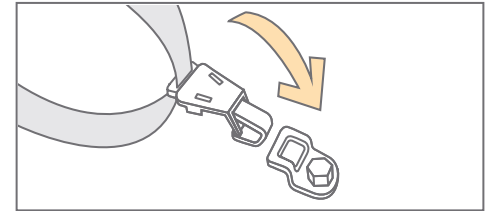

Press button and pull lower web to reduce tension

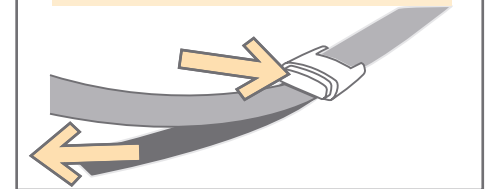

Press button and pull upper web to increase tension

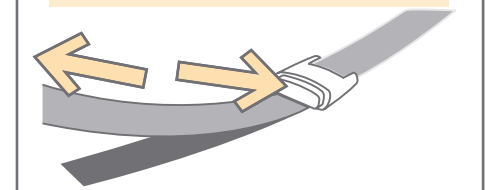

Store end of web in bag on back of cover.



Installation - anchorage fitting

If the car is fitted with a child restraint anchorage point:

Locate the anchorage point behind the rear seating position (consult the vehicle owners handbook for location of the anchorage point). Remove the thread plug from the parcel shelf/floor/roof and install the attachment bolt as shown opposite.

CAUTION:
DO NOT OVERTIGHTEN THE ATTACHMENT BOLT.
MAXIMUM TORQUE 20Nm.

The anchor fitting must be aligned as shown unless stated otherwise in the vehicle owners handbook.

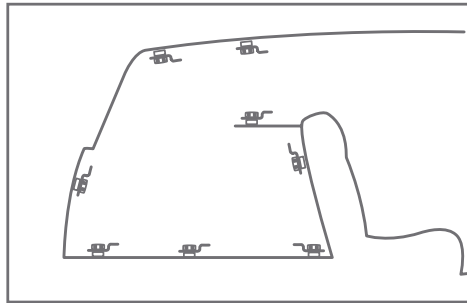
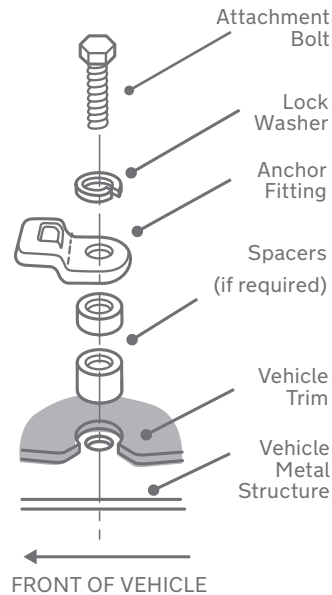

WARNING

CHILD RESTRAINTS MUST NOT BE ATTACHED TO UNSOUND METAL OR WOOD OR SYNTHETIC STRUCTURES. WHEN DRILLING THE 9 MM HOLE DO NOT DRILL THROUGH FUEL LINES, FUEL TANKS, ELECTRICAL WIRING, OR RADIO SPEAKERS. WEBBING STRAPS MUST BE PROTECTED FROM SHARP CORNERS AND EDGES.

THE ANCHOR FITTING MUST BE USED ONLY AS DESCRIBED ABOVE. IT MUST NOT BE HOOKED ONTO ANY OTHER OBJECT.

Installation - anchorage fitting

If the car is not fitted with a child restraint anchorage point:

For sedans only - drill a 9 mm hole in the parcel shelf on the centre line of the seating position as shown below. Install the anchor bolt as shown.

For vehicles other than sedans - in Australia, consult your nearest child restraint fitting station or traffic authority for vehicle inspection to find the best, correct position for the placement of the anchorage point, and for the correct attachment bolt length and use of spacers.

In New Zealand, consult the agent for the vehicle.

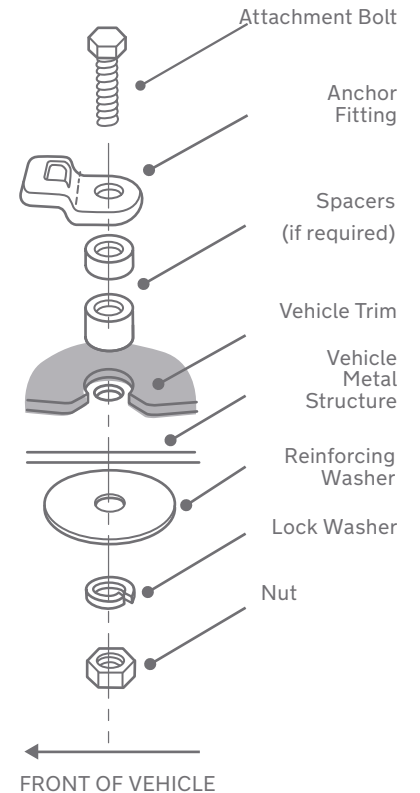

If drilling a new hole, select a position on the centre line of the seating position, and no closer than 100 mm from the front edge of the parcel shelf.

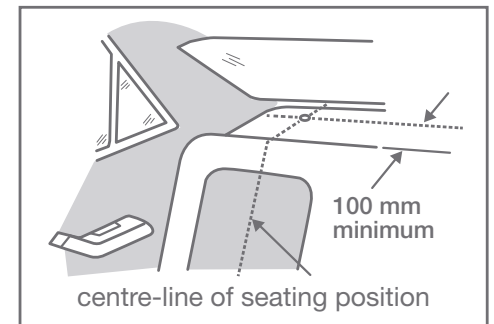

Installation - checklist

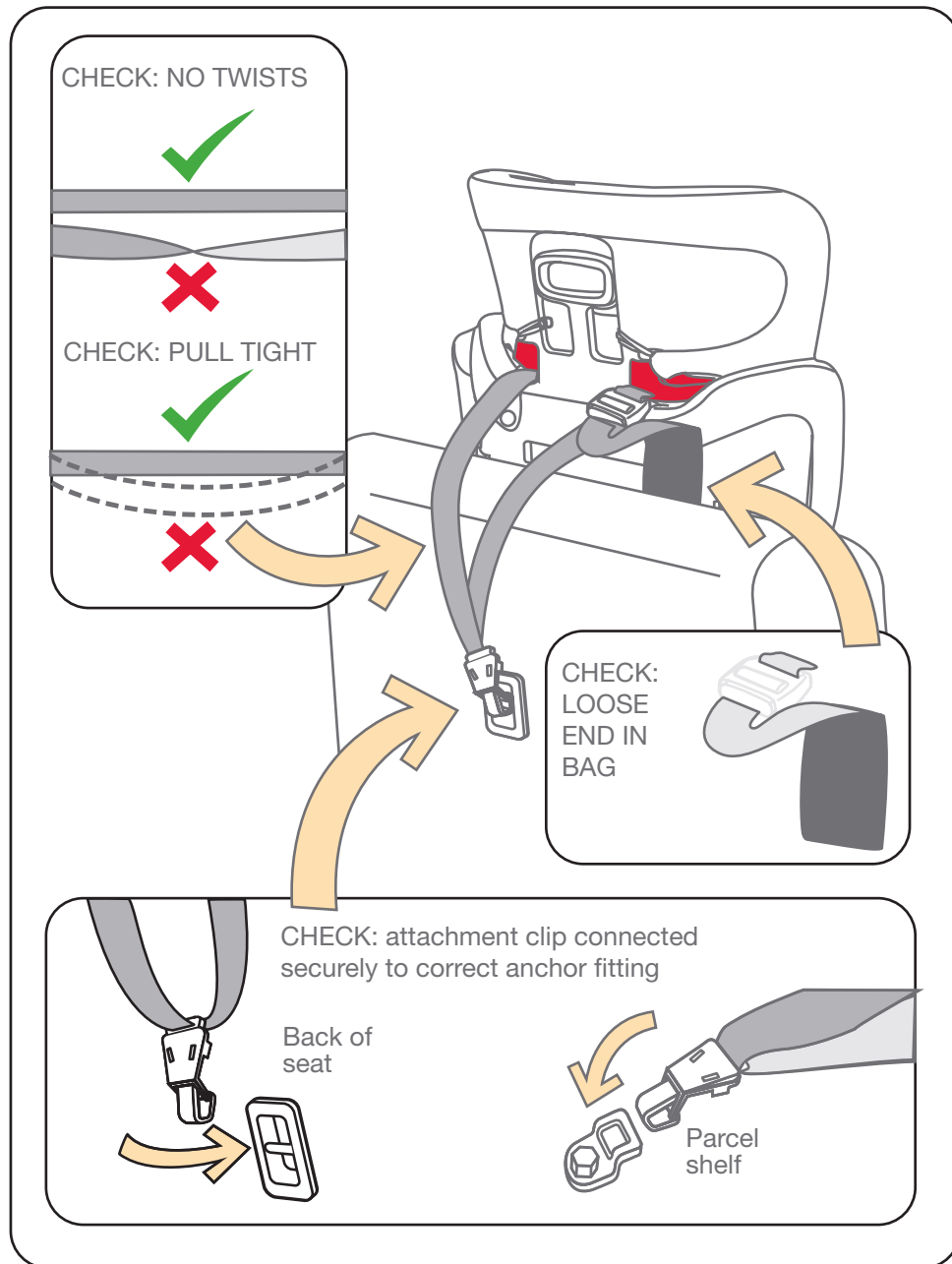

Use - headrest adjustment

See information on correct use of shoulder height labels on pages 11 & 12.

Headrest Adjustment

Squeeze headrest release lever until locking mechanism disengages, raise or lower headrest as required.

Release lever.

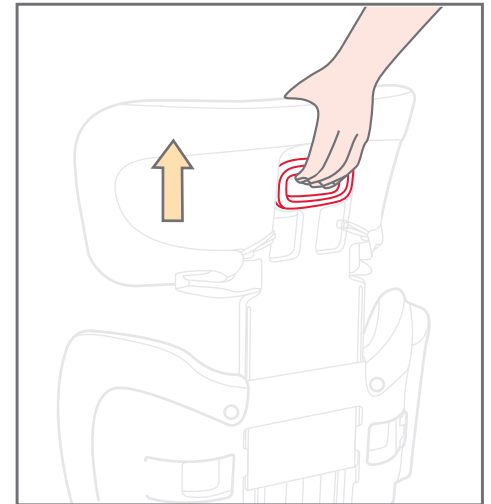

Bottom edge of headrest should be just above the shoulders.

DO NOT have headrest too low or too high.

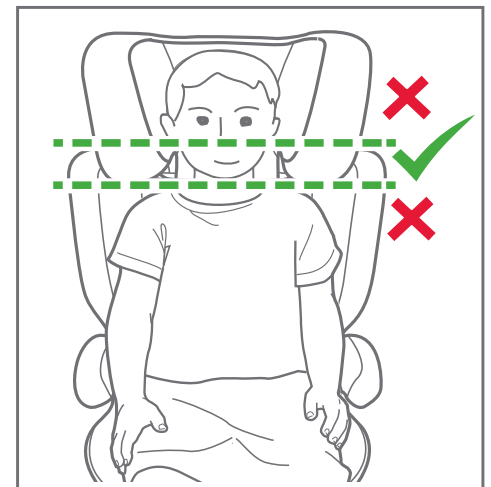

Use - correct vehicle belt positioning

Place child on seat. Check headrest height and adjust if necessary. See page 22.

Pass sash belt through the guide under the headrest and across the child's chest.

Always use the sash guide

Connect the vehicle belt. Check that it is securely engaged.

Ensure the belt is not putting pressure on the child's neck and can slide freely through the guide.

Ensure the sash belt has good contact against the child's chest.



NOTE: the belts must pass under the armrests and across the child's upper thighs.
The lap belt must not be in contact with the child's stomach.
In the event of a crash or sudden stop a lap belt moving into a child's stomach can cause serious injury.

CORRECT VEHICLE BELT PATH
The cover has labels marking the correct vehicle belt path.

**BOOSTER SEAT
BELT PATH
ALWAYS USE
THIS SASH GUIDE**

**BOOSTER
SEATBELT PATH**



Use - correct vehicle belt positioning

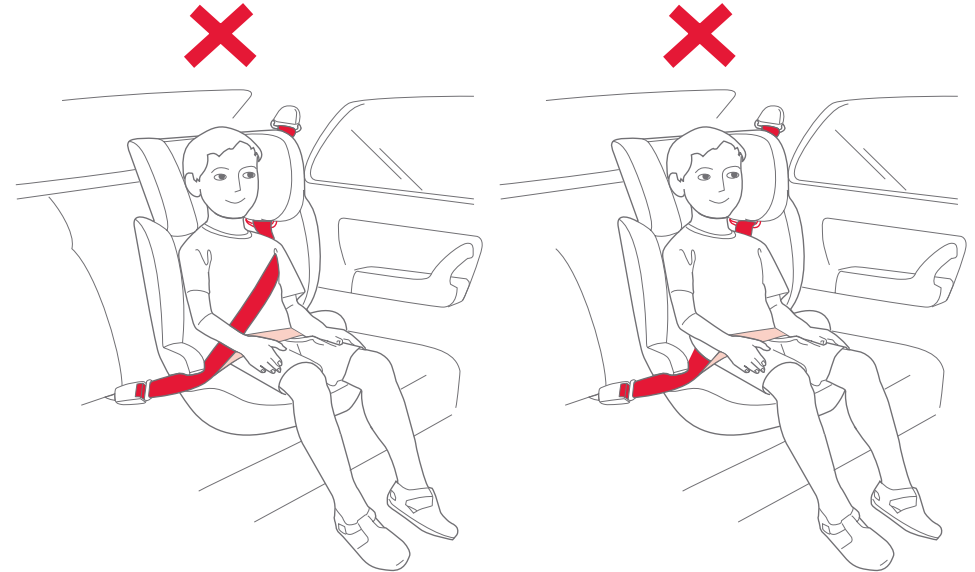

WARNING

A SASH BELT UNDER THE ARM OR BEHIND THE BACK IS DANGEROUS

Use - checklist

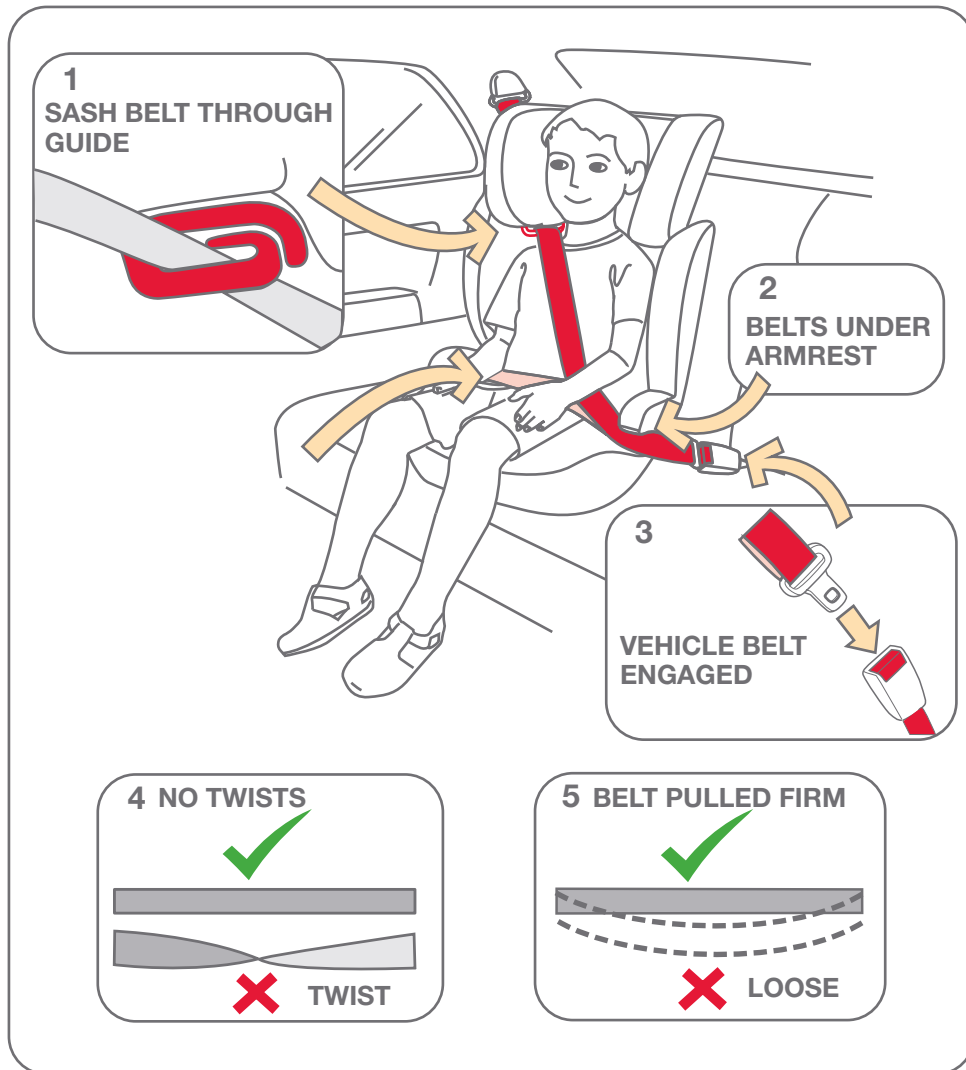

⚠ WARNING

DO NOT LEAVE CHILDREN UNATTENDED IN THE CAR

Cover - removing and refitting

Headrest Cover

Release elastic straps at back of the headrest and pull the cover firmly forward starting at the top.

Backrest Cover

Release the two sliding fixings at the top back and the two elastics from the bottom and pull cover forward.
Note: the top fastenings slide out of engagement. They are not press studs.

Seat Pad

Release the two elastics at the back and pull the cover forward.

To replace reverse the procedure above.

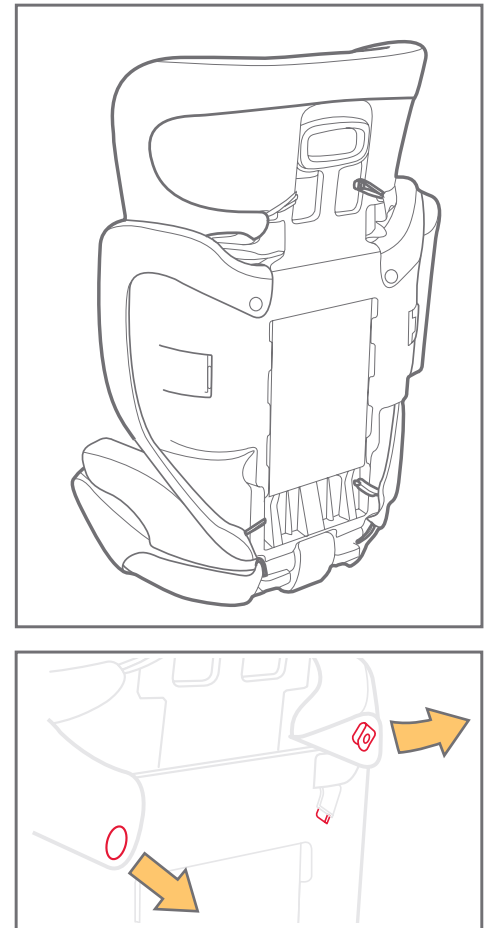

VERY IMPORTANT: Only replace the cover with a manufacturer's supplied replacement cover with identical shoulder height markers or a replacement cover meeting AS/NZS 8005.

Care, Maintenance and Storage

Seat Cover

Wash with warm water (under 30°C) and mild detergent.

Do not iron.

Do not bleach or dry clean.

Do not twist the soft goods to dry with great force. It may leave the seat cover with wrinkles.

Hang dry the seat cover in the shade.

Plastic and Metal Parts

Use only mild detergent, water and a soft cloth to clean the car seat shell, handle and harness straps. Air dry.

Do not use undiluted detergent, or other solvents to clean - these may cause damage.

Top Tether Strap

Either spot clean or replace.

DO NOT IMMERSE THE TETHER STRAP IN WATER.

Storage

Remove the booster seat from the vehicle seat if not in use for a long period of time.

Store the booster seat in a cool, dry place where your child cannot access it.

Accessories and Spare Parts

Accessories

DO NOT add accessories, toys, padding or other items to the child restraint unless provided by Joie.

Use of aftermarket accessories (i.e. items not provided in the box with the child restraint), can reduce the safety provided by the child restraint and may cause injury or death.

Any aftermarket accessory used should be compliant with AS/NZS 8005 (Accessories for child restraints for use in motor vehicles) and stated as suitable for use with this child restraint.

IMPORTANT: Do not use any accessory with this child restraint that directly restrains or stops the forward movement of the child's head or neck.

Spares

If spare parts are required contact the retail outlet from where the restraint was purchased or contact the Australian distributor for the location of your nearest repair agent.

Repairs must only be done by an approved repair agent.



Distributed by Allison AU Pty Ltd

ACN: 642 240 140

Unit 1, 35 Lyn Parade

Prestons

NSW Australia 2170

For after-sales & warranty service, contact:

1800 951 070

customerservice@allisonau.com.au