

Joie™

birth to 22kg/birth - 48
months (approx)

nitro™

stroller

GB Instruction Manual

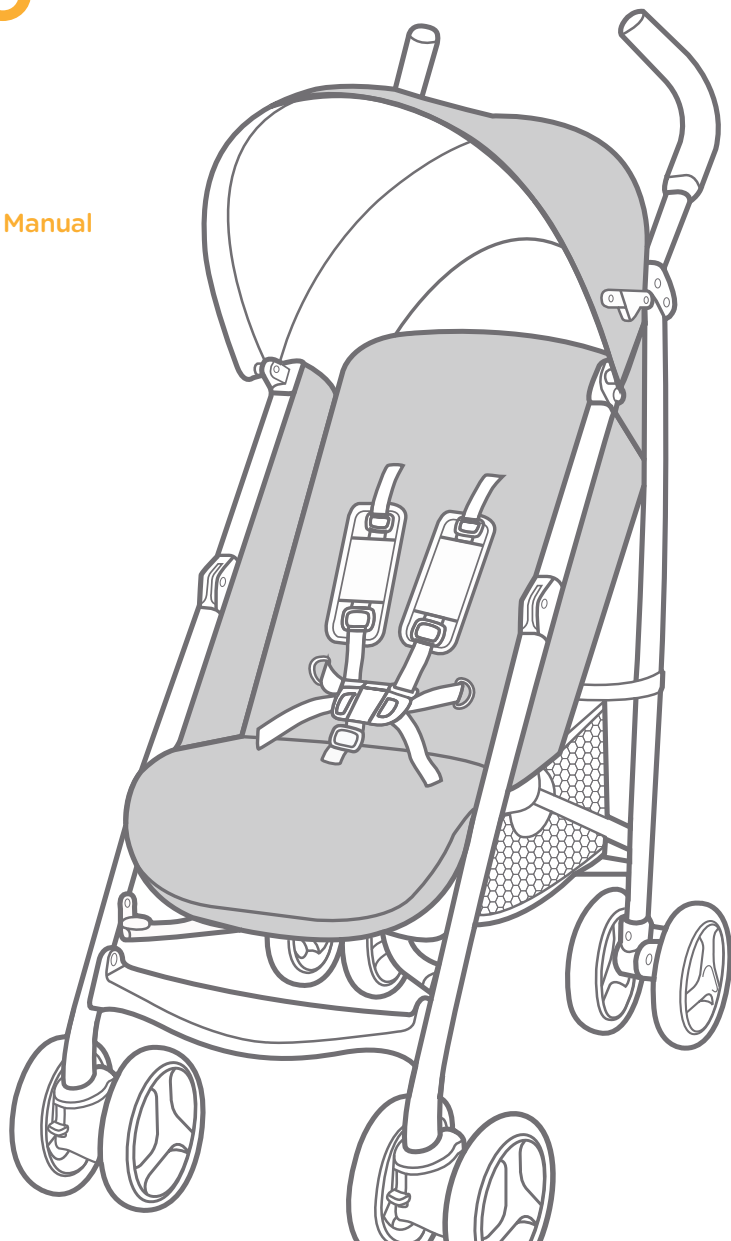

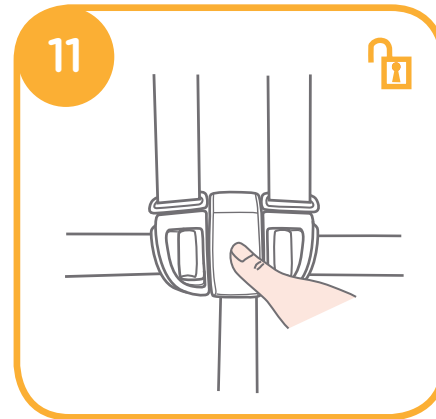
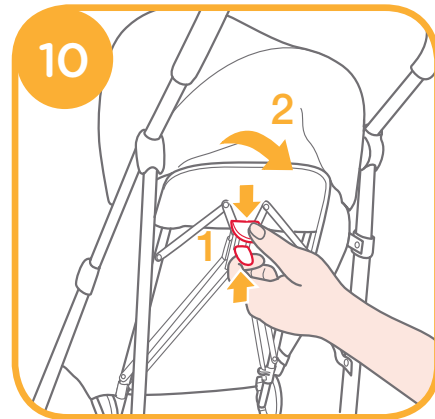
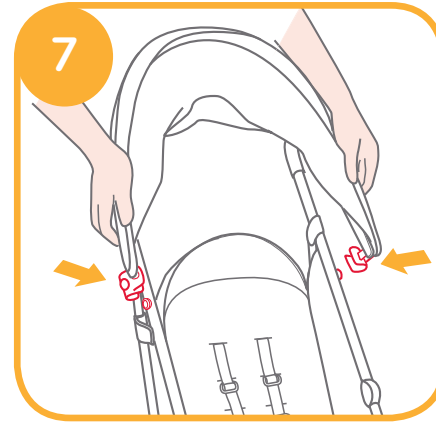
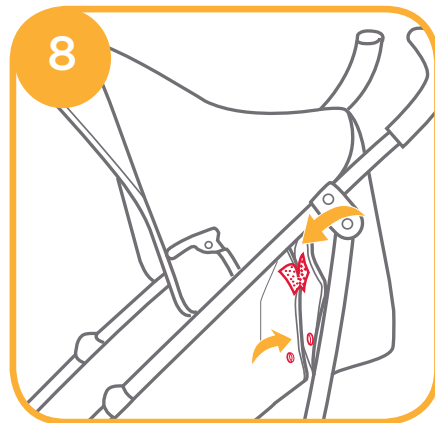
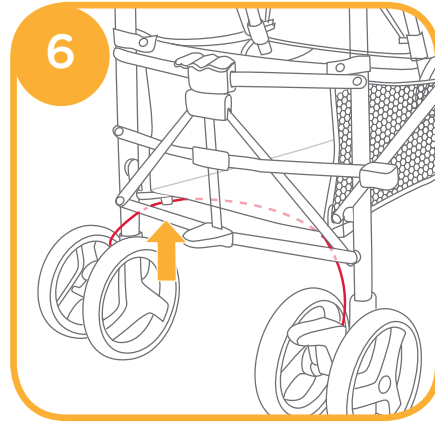
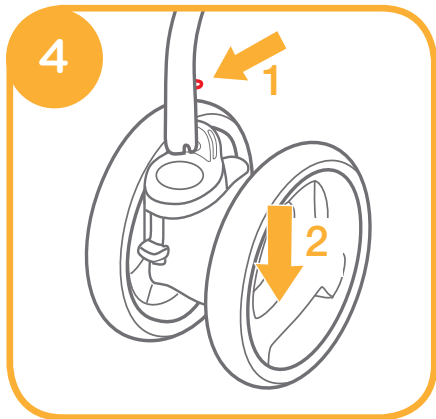
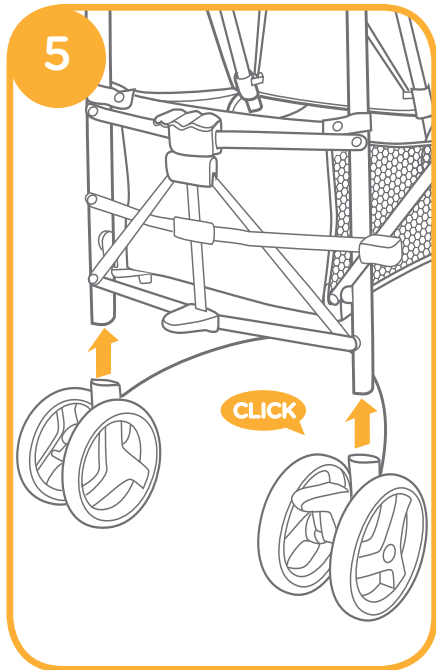
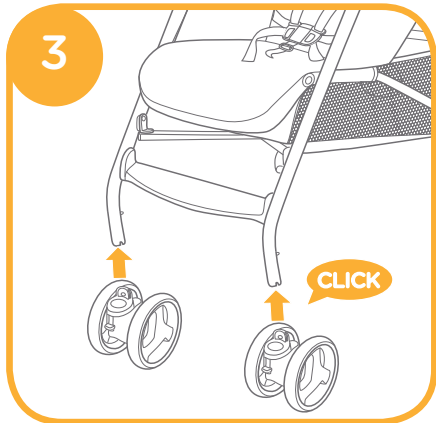
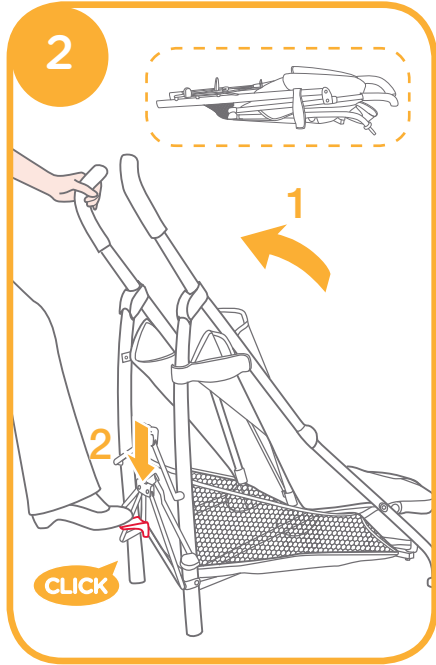
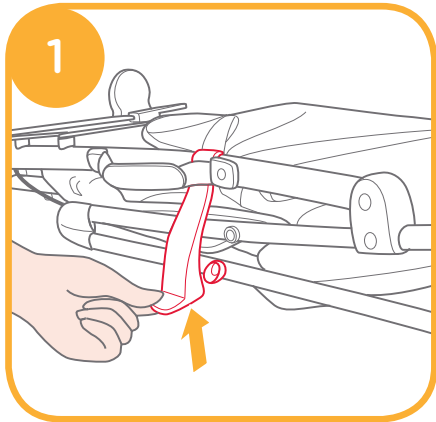

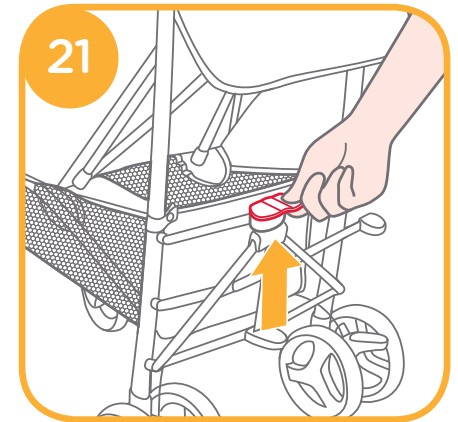
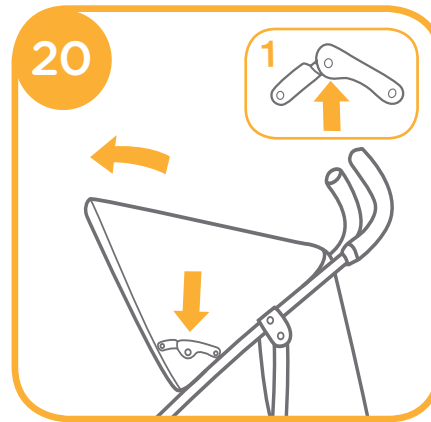
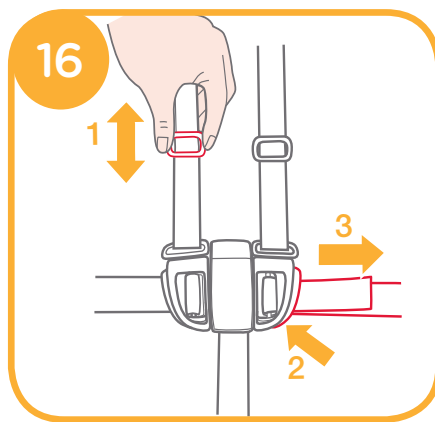
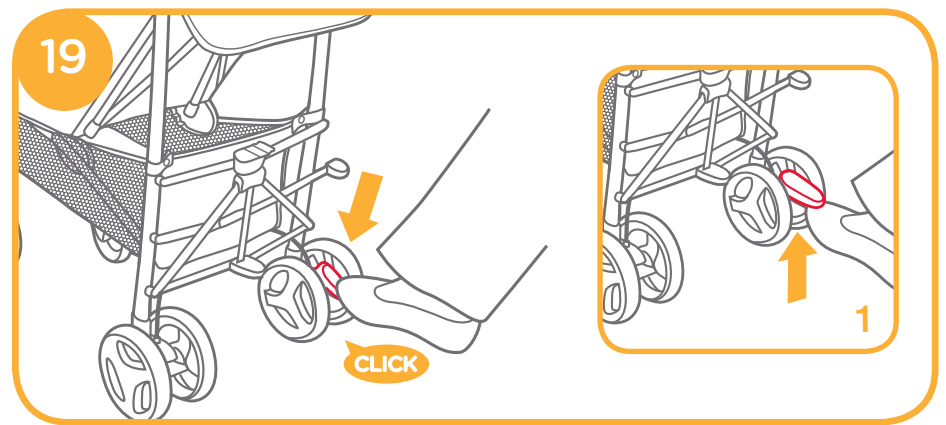
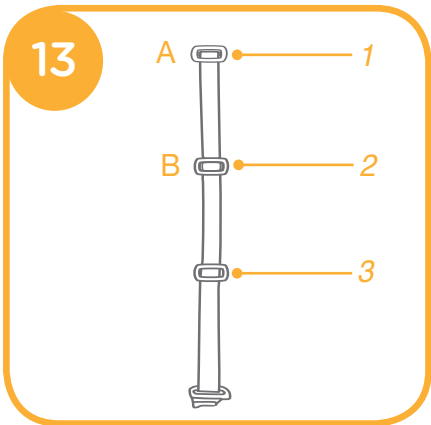
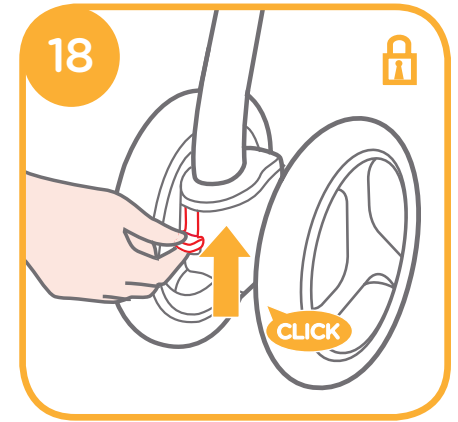
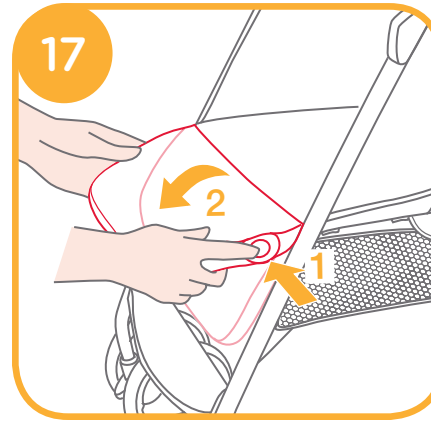
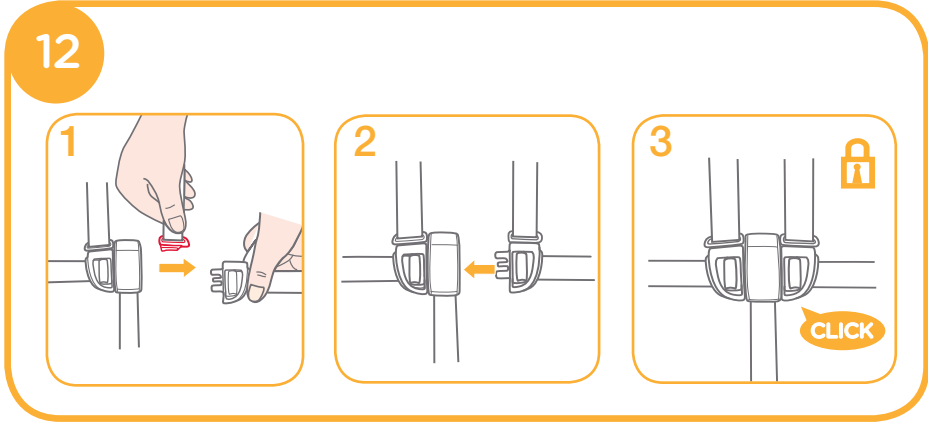

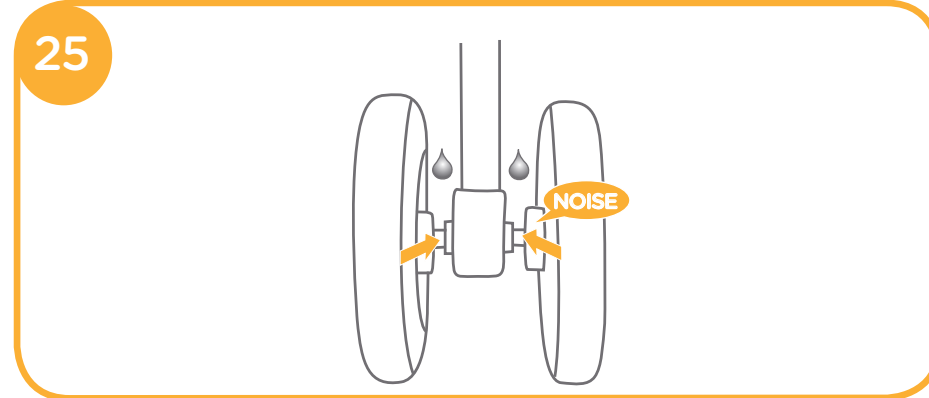
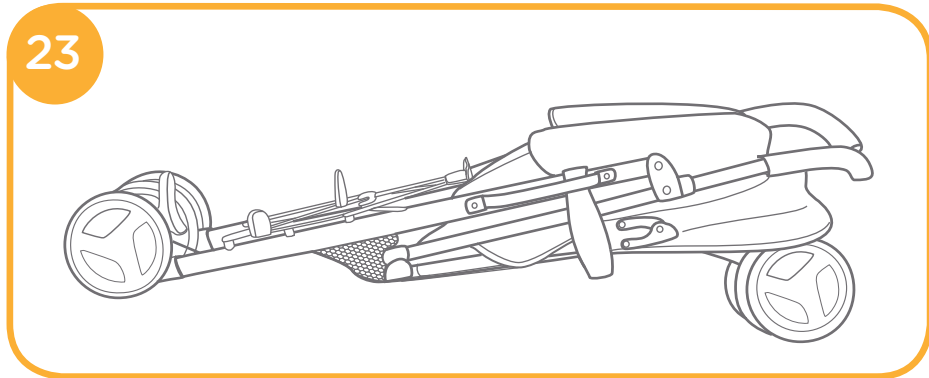

Accessories (not included in purchase)



Congratulations on becoming part of the Joie family! We are so excited to be part of your journey with your little one. While traveling with the Joie Nitro™, you are using a high quality, fully certified stroller, approved to Australia, New Zealand safety standards AS/NZS 2088:2013. This product is suitable for use with children weighing under 22kg. Please carefully read this manual and follow each step to ensure a comfortable ride and best protection for your child.

IMPORTANT - Keep these instructions for future reference.

Visit us at au.joiebaby.com to download manuals and see more exciting Joie products!

Contents

Figures	1-6
Product Information	8
Parts List	8
WARNING	9-10
Stroller Assembly	10
Open Stroller	10
Assemble Front Wheels	10
Assemble Rear Wheels	10
Assemble Hood	10
Stroller Operation	11
Adjust Recline	11
Use Buckle	11
Use Shoulder & Waist Harnesses	11
Adjust Calf Support	11
Use Front Swivel Lock	12
Use Brake	12
Use Hood	12
Fold Stroller	12
Use Carry Strap	12
Accessories	12
Care and Maintenance	12

Emergency

In case of emergency or accident, it is most important to have your child taken care of with first aid and medical treatment immediately.

Product Information

Read all the instructions in this manual before using this product. If you have any further questions, please consult the retailer. Some features may vary depending on model.

Product	Nitro Stroller
Suitable for	Child weighing under 22kg (birth - 48 months approx.)
Materials	Plastics, metal, fabrics
Patent No.	Patents pending
Made in	China
Brand Name	Joie
Website	www.au.joiebaby.com
Manufacturer	Joie Children's Products (UK) Limited

Parts List

Make sure all parts are available before assembly. If any part is missing, please contact local retailer. No tools are required for assembly.

1 Stroller Frame	6 Storage Latch	11 Calf Support	16 Foot Plate
2 Front Wheel (X2)	7 Carry Strap	12 Buckle	17 Brake Lever
3 Rear Wheels	8 Rear Wheel	13 Safety Harness	18 Folding Pedal
4 Hood	9 Front Wheel	14 Hood Stretcher	19 Folding Plate
5 Handle	10 Footrest	15 Storage Basket	

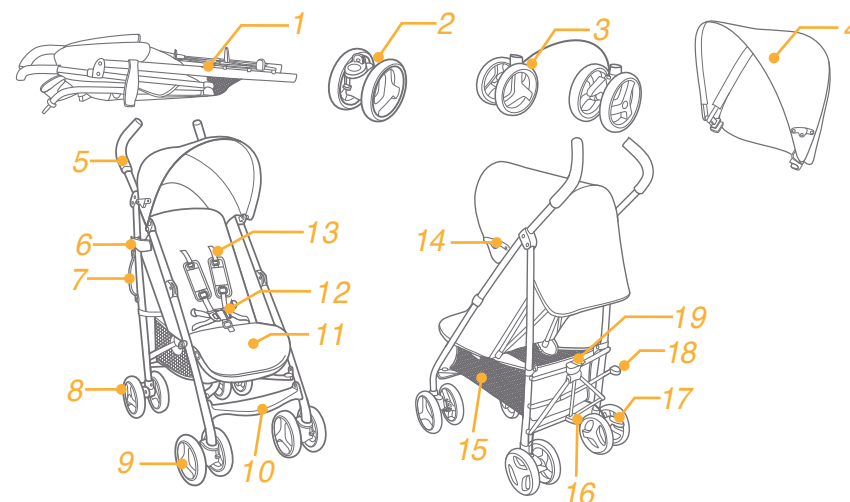

Accessories (Non-included)

Rain Cover (on certain models)



WARNING

- ! WARNING Always use the crotch combination with the waist belt. The shoulder harnesses should be used as well.
- ! WARNING Ensure that all the locking devices are engaged before use.
- ! WARNING Do not let your child play with this product.
- ! WARNING Check that the pram body or seat unit attachment devices are correctly engaged before use.
- ! Adult assembly required.
- ! Use the stroller with a child weighing less than 22kg. It will cause damage to the stroller with an unfitted child.
- ! To prevent a hazardous, unstable condition, do not place more than 4.5kg in the storage basket.
- ! Never leave child unattended. Always keep child in view while in stroller.
- ! Use the stroller with only one child at a time. Never place purses, shopping bags, parcels or accessory items on the handle or hood.
- ! Overloading, folding incorrectly, or using component parts from other manufacturers may cause the stroller to be damaged, broken or unsafe. Please read the instruction manual carefully.
- ! Never use it along with component parts from other manufacturers.
- ! Please read all the instructions in the manual before using the product. Please save instruction manual for future use. Failure to follow these warnings and instructions may result in serious injury or death.
- ! Safety belts and restraint systems must be used correctly.
- ! To avoid serious injury from falling or sliding out, always use seat belt.
- ! Make sure your child's body is clear from the moving parts when adjusting the stroller.
- ! Child may slip into leg openings and be strangled if the harness is not used.
- ! Never use stroller on stairs or escalators.
- ! Keep away from high temperature objects, liquids, and electronics.
- ! Never allow your child to stand on the stroller or sit in the stroller with head toward front of stroller.
- ! Never place the stroller on roads, slopes or dangerous areas.
- ! Do make sure all mechanisms are fixed before using the stroller.
- ! To avoid strangulation, DO NOT place items with a string around your child's neck, suspend strings from this product, or attach strings to toys.
- ! To prevent tipping DO NOT put anything on the handle.
- ! DO NOT lift stroller while child is in stroller.
- ! DO NOT use storage basket as a child carrier.
- ! To prevent tipping, never let child climb the stroller. Always lift the child in and out of the stroller.

- ! To avoid finger entrapment, use care when folding and unfolding the stroller.
- ! Be sure the stroller is fully open or folded before allowing child near the stroller.
- ! To ensure your child's safety, please make sure all parts are assembled and fastened properly before using the stroller.
- ! To avoid strangulation, do make sure your child is clear from the hood.
- ! Always engage the brakes when parking the stroller.
- ! Discontinue using stroller if it is damaged or broken.
- ! Stroller to be used only at walking speed. This product is not intended for use while jogging.
- ! To avoid suffocation, remove plastic bag and packaging materials before using this product. The plastic bag and packaging materials should then be kept away from babies and children.
- ! This product is not suitable for running or skating.
- ! Pushchair designed to be used from birth shall recommend the use of the most reclined position for new born babies.
- ! The parking device shall be engaged when placing and removing children.

Stroller Assembly

Please read all the instructions in this manual before assembling and using this product.

Open Stroller

Separate storage latch from storage mount **1**, and then lift the handle upwards **2 - 1**, push the foot plate downwards with foot **2 - 2**, a click sound means the stroller is open completely.

- ! Check that the stroller is completely open before continuing.

Assemble Front Wheels

Assemble front wheels to front legs. Check that wheels are securely attached by pulling on wheel assemblies. **3**

To disassemble front wheel, detach front wheel from front leg **4 - 2** while pressing the release tabs outwards. **4 - 1**

Assemble Rear Wheels

Assemble rear wheels to rear legs **5**. Check that wheels are securely attached by pulling on wheel assemblies.

Snap the brake cable into the fixing tabs under square tubes to fix it. **6**

Assemble Hood

Align the holes of the hood mounts with the posts on the tubes, and then insert to assemble the hood **7**, stick

the hook and loop fasteners, snap the buttons to attach the rear hood to backrest. 8

The completely assembled stroller is shown as 9

Stroller Operation

Adjust Recline

There are 5 angles for the backrest.

Squeeze the adjust button 10 - 1, and then adjust the backrest to a desired angle. 10 - 2

To raise the backrest, push up.

! Make sure the recline is set properly for use.

Use Buckle

Release Buckle

Press the center button to release the buckle. 11

Lock Buckle

Match the waist belt buckle with the shoulder buckle 12 - 1, and click into the center buckle. 12 - 2

A "click" sound means the buckle is locked completely. 12 - 3

! To avoid serious injury from falling or sliding out, always secure your child with harness.

! Make sure your child is snugly secured. The space between the child and the shoulder harness is about the thickness of one hand.

! Do not cross the shoulder belts. This will cause pressure on child's neck.

Use Shoulder & Waist Harnesses

! In order to protect your child from falling out, after your child is placed into the seat, check whether the shoulder and waist harnesses are at proper height and length.

- 13 - 1 Shoulder harness anchor A
- 13 - 2 Shoulder harness anchor B
- 13 - 3 Slide adjuster

For larger child, use shoulder harness anchor A and the highest shoulder slots. For smaller child, use shoulder harness anchor B and the lowest shoulder slots.

To adjust the position of the shoulder harness anchor, turn the anchor to be level with the side facing forward. Thread it through the shoulder harness slot from back to front. 14 Rethread it through the slot that is closest to child's shoulder height. 15

Use slide adjuster to change the harness length. 16 - 1

Press the button 16 - 2, while pulling the waist harness to proper length. 16 - 3

Adjust Calf Support

The calf support has 2 positions.

Raise Calf Support

To raise the calf support, just push it upwards.

Lower Calf Support

Press the adjustment buttons on both sides of the calf support 17 - 1, and rotate the calf support downwards.

17 - 2

Use Front Swivel Lock

Push up the front swivel locks to maintain the moving direction. 18

Tip It is recommended to use swivel locks on uneven surfaces.

Use Brake

To lock wheels, step the brake lever downwards. 19

To release wheels, just lift the brake lever upwards. 19 - 1

Tip Always apply brake when stroller is in stopped position.

Use Hood

To open the hood, pull hood forwards and press stretchers down on both sides. 20

To fold the hood, pull up the stretchers on both sides 20 - 1 and pull hood toward back.

Fold Stroller

! Please fold the hood before folding the stroller.

Lift the folding plate 21, step the folding pedal downwards 22 - 1, push the stroller forward to fold 22 - 2. The storage latch will automatically hook onto the storage mount, then the stroller is folded and locked completely. 23

Use Carry Strap

You can carry the stroller with ease by lifting the carry strap. 24

Accessories

Accessories may be sold separately or may not be available depending on region.

Use Rain Cover

To assemble the rain cover, place it over the stroller, and then attach the 2 pairs of hook and loop fasteners and 2 pairs of snaps on the rain cover. 26

! When using the rain cover, please always check its ventilation.

! When not in use, please check that the rain cover has been cleaned and dried before folding.

! Do not fold the stroller after assembling the rain cover.

! Do not place your child into the stroller assembled with rain cover during hot weather.

Care and Maintenance

! Removable seat pad may be washed in cold water and drip-dried. No bleach.

! To clean stroller frame, use only household soap and warm water. No bleach or detergent.

! From time to time, check your stroller for loose screws, worn parts, torn material or stitching. Replace or repair the parts as needed.

! Excessive exposure to sun or heat could cause fading or warping of parts.

! If stroller becomes wet, open hood and allow to dry thoroughly before storing.

! If wheels squeak, use a light oil (e.g., Silicon Spray, antirust oil, or sewing machine oil). It is important to get the oil into the axle and wheel assembly. 25

! When using your stroller at the beach, completely clean your stroller after use to remove sand and salt from mechanisms and wheel assemblies.



Joie Children's Products (UK) Ltd,
Venture Point, Towers Business Park
Rugeley, Staffordshire, WS15 1UZ

bring the kids™

Share the joy at joiebaby.com

P-IM0060C