



birth to 9kg

# roomie™ glide

## Bedside Crib/Bassinet

GB Instruction Manual

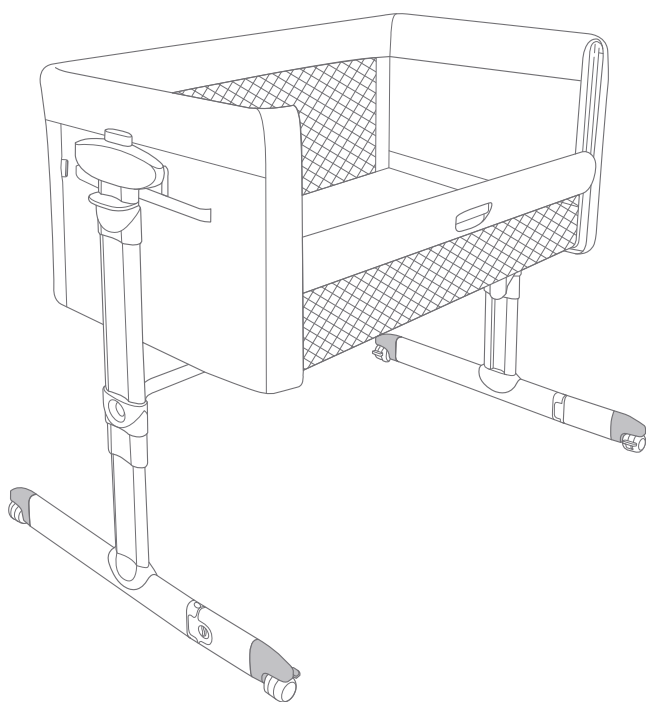

### IMPORTANT

KEEP THESE INSTRUCTIONS IN A SAFE PLACE FOR FUTURE REFERENCE.

# IMPORTANT, RETAIN FOR FUTURE REFERENCE. READ CAREFULLY

## Bedside Crib/Bassinet Assembly

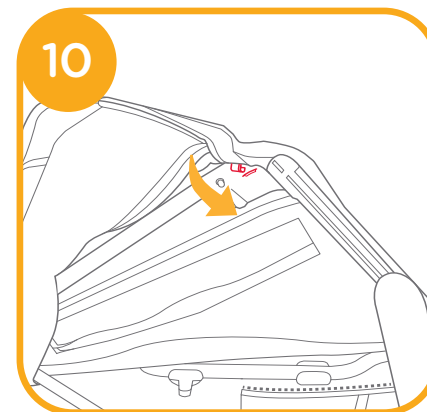
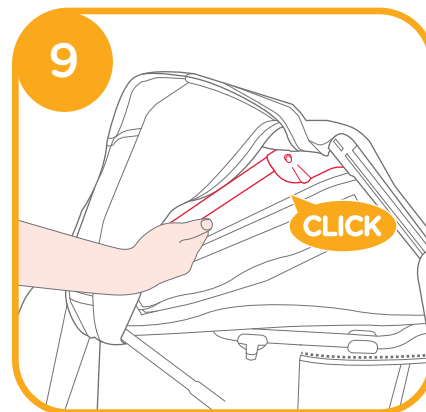
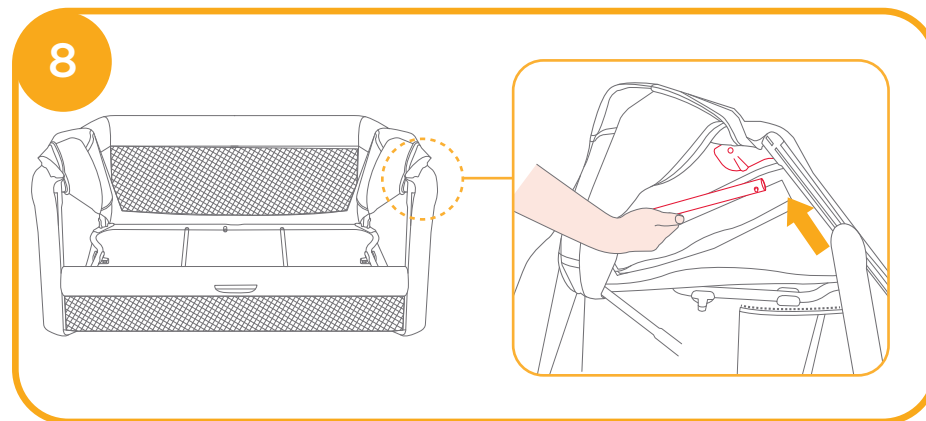
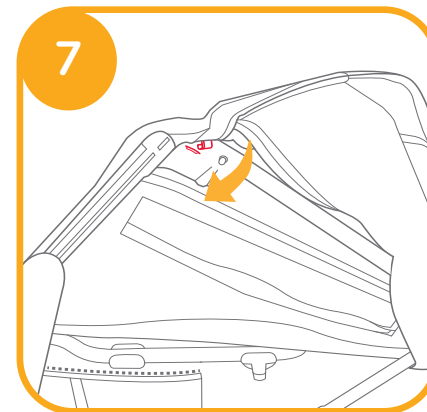
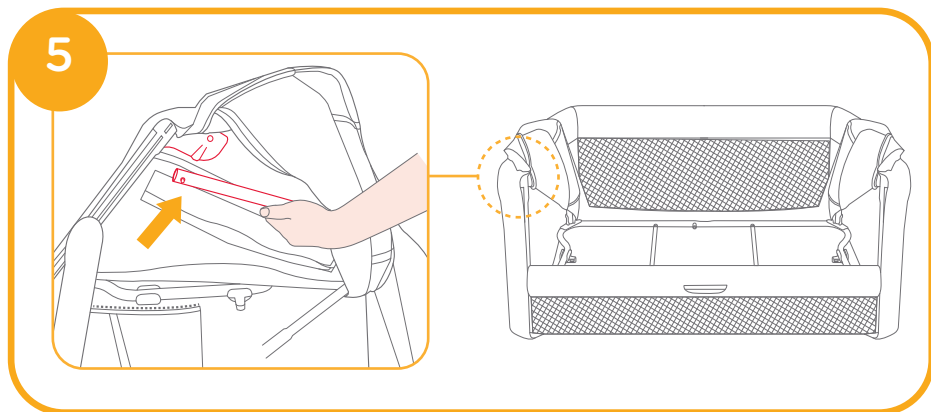
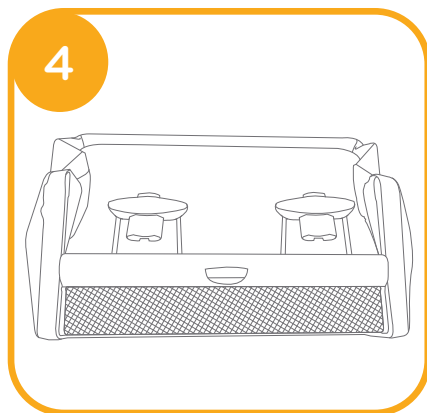
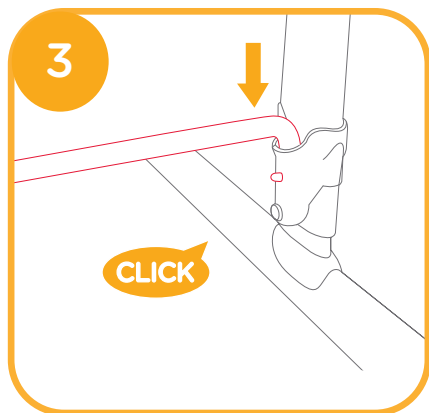
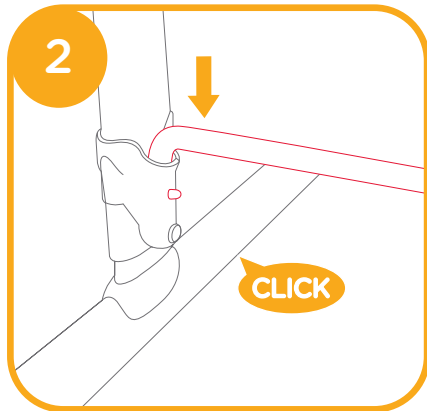
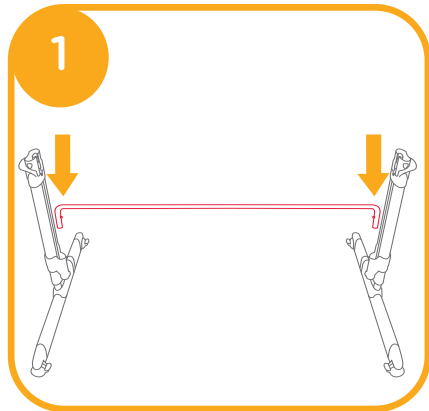

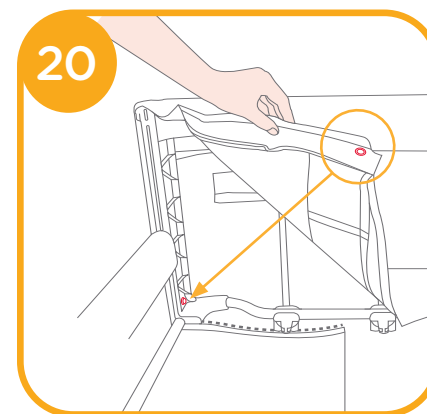
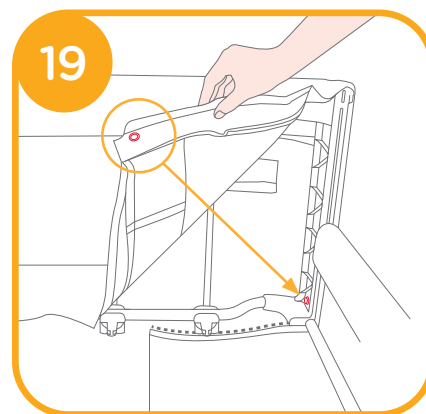
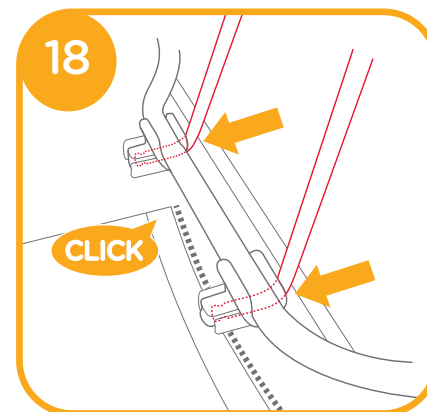
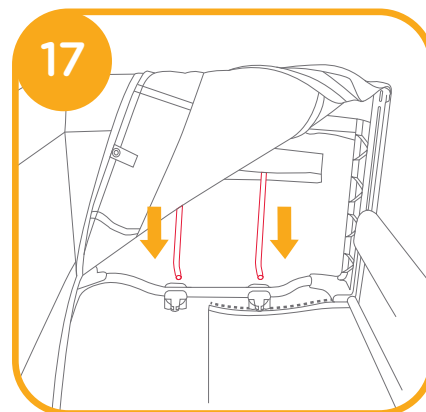
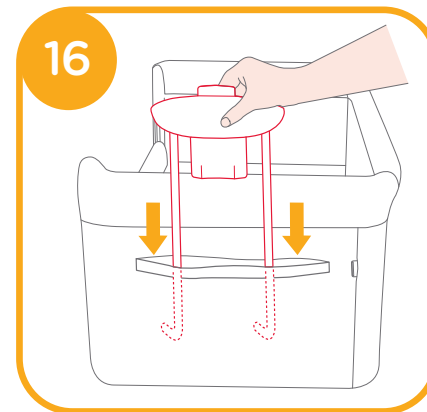
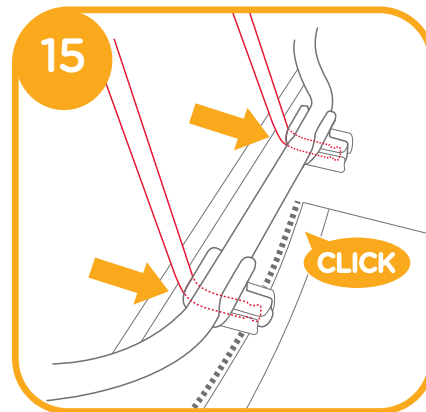
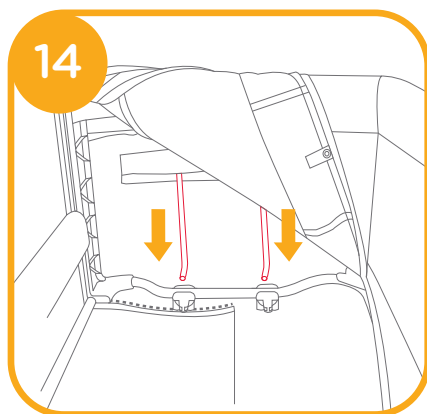
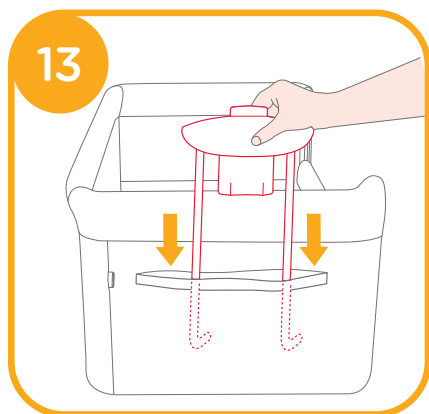
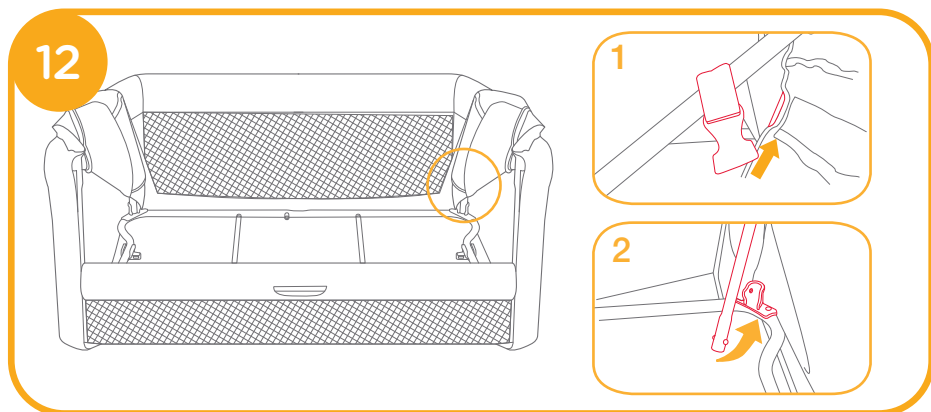
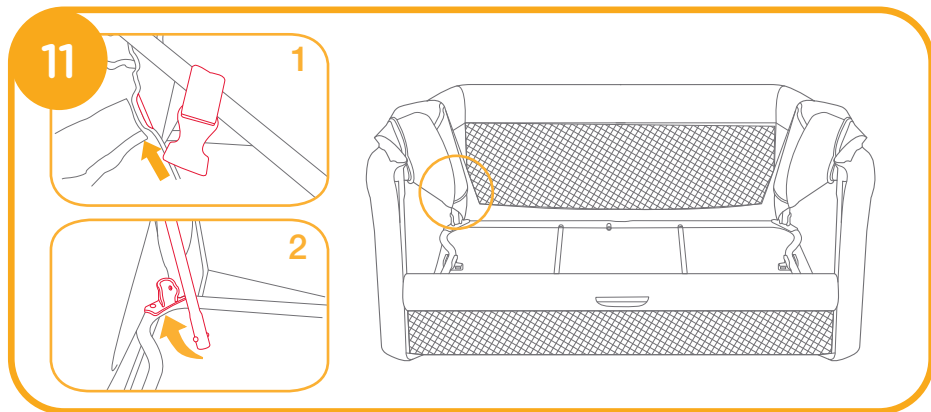

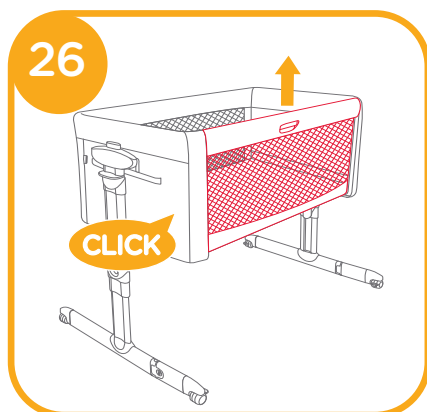
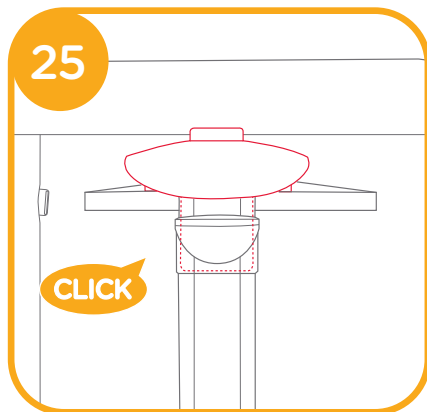
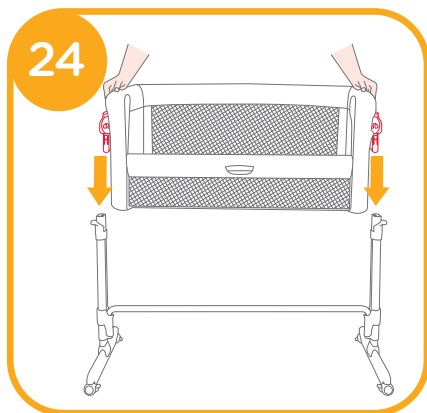
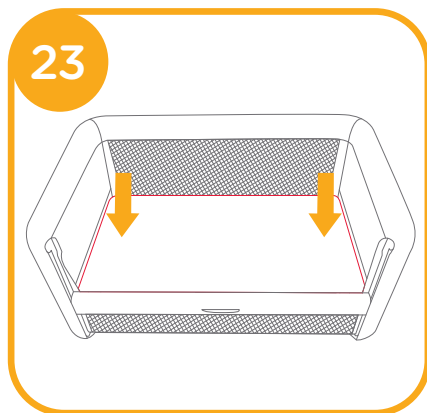
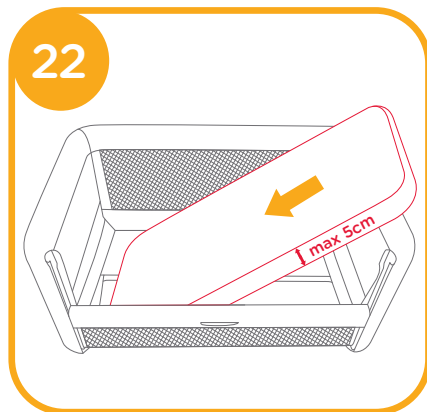
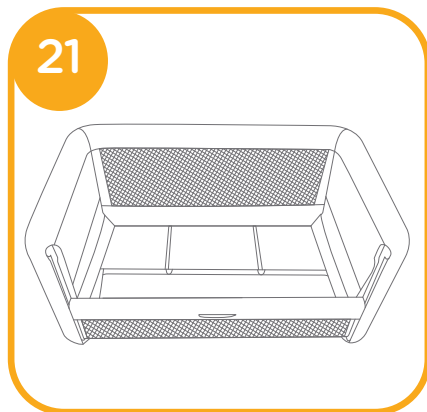

## Rocking Function Activation

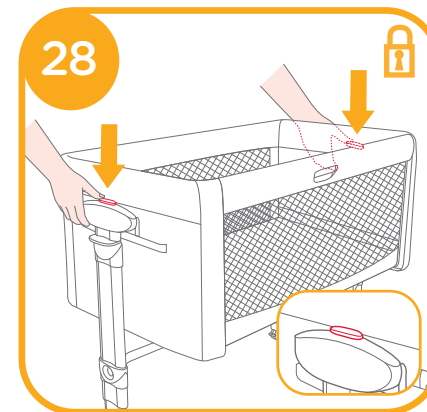
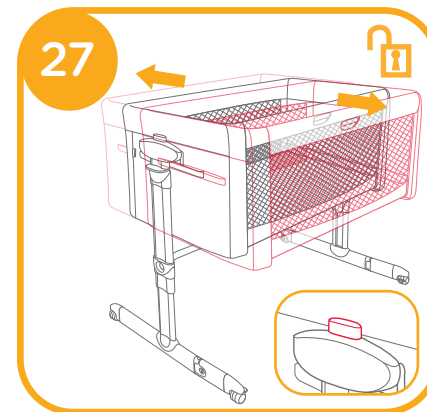

## Height Adjustment/Bassinet Mode

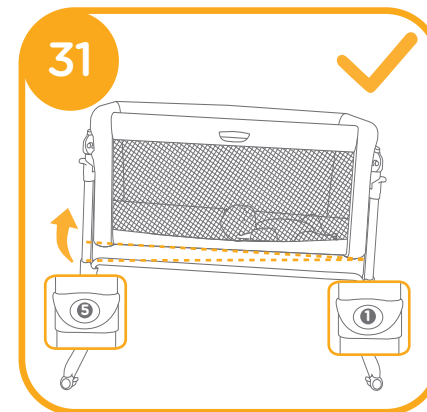
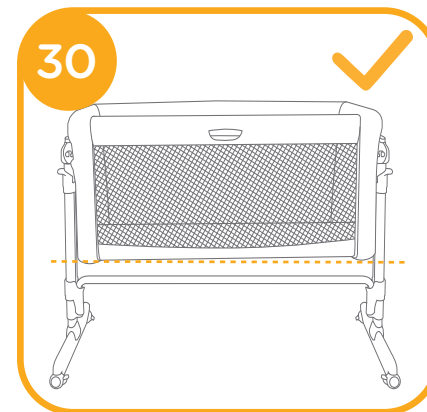
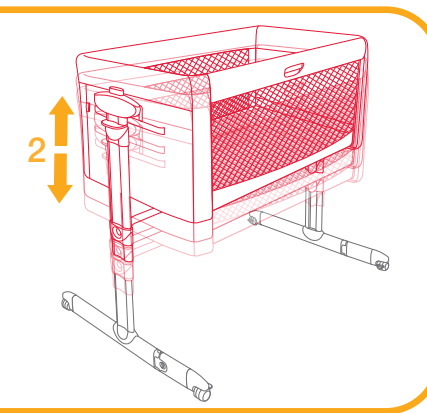
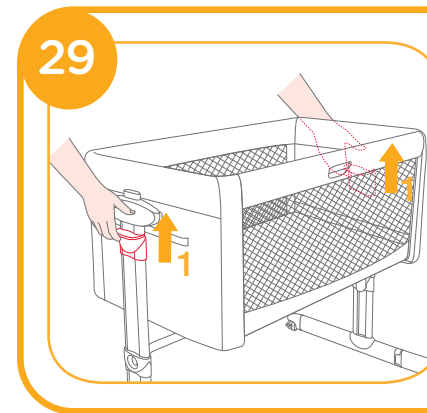

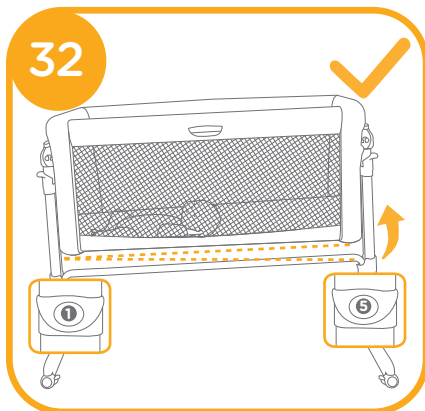

### Use Wheels

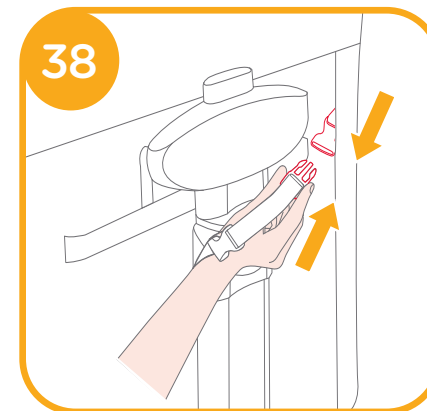
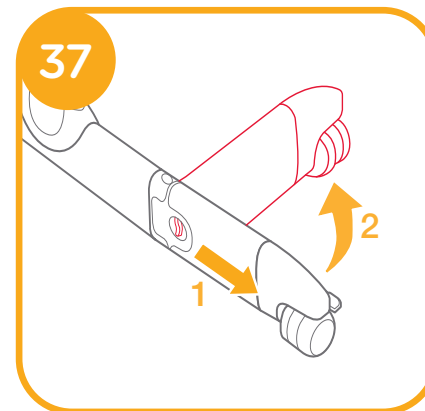
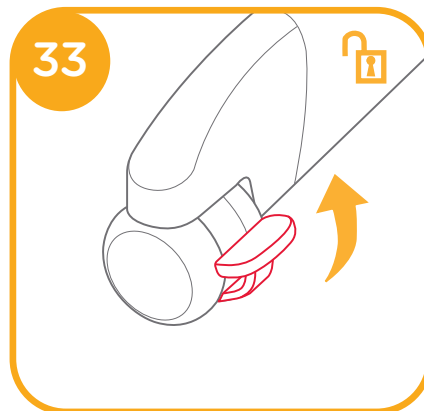

### Use Bedside Sleeper

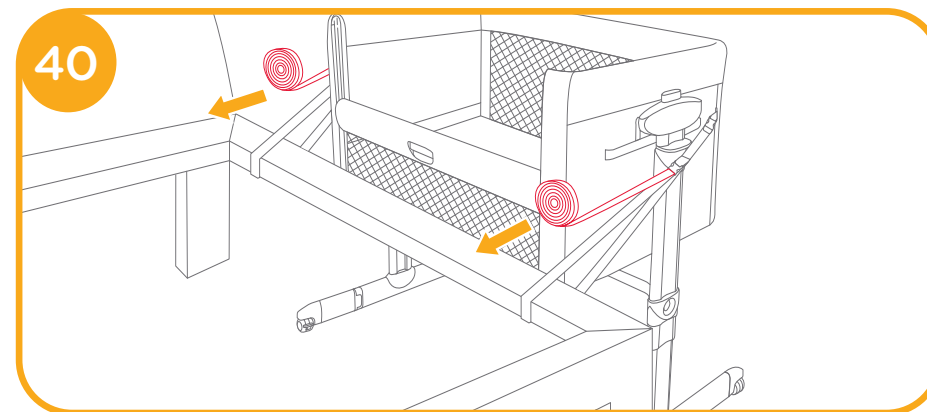
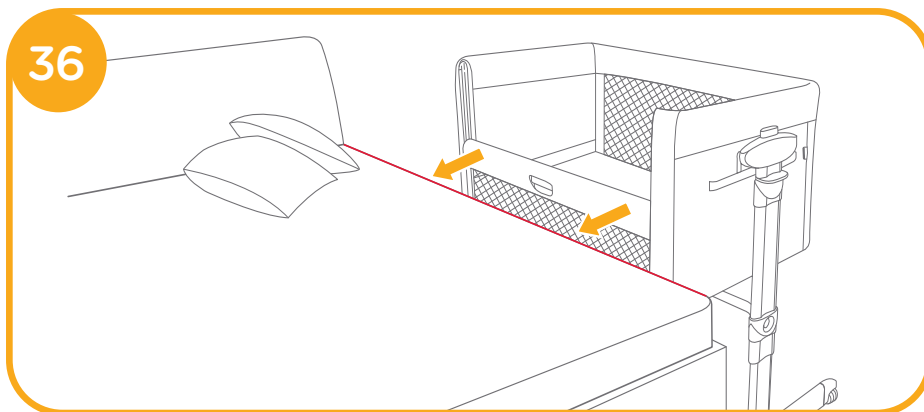
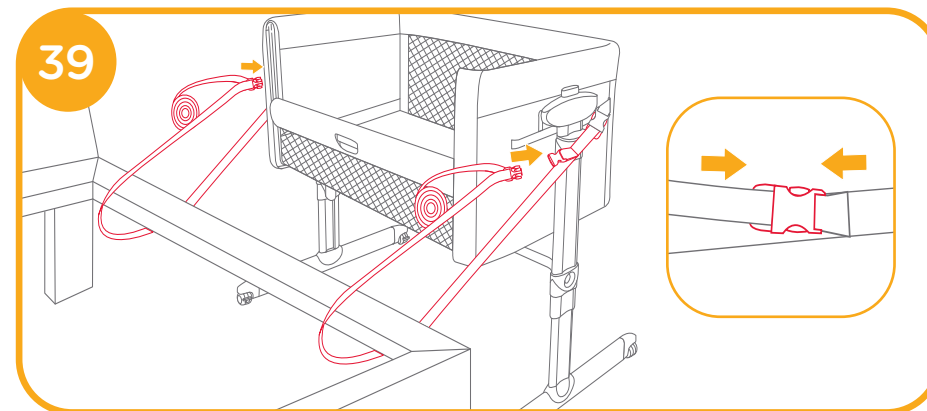
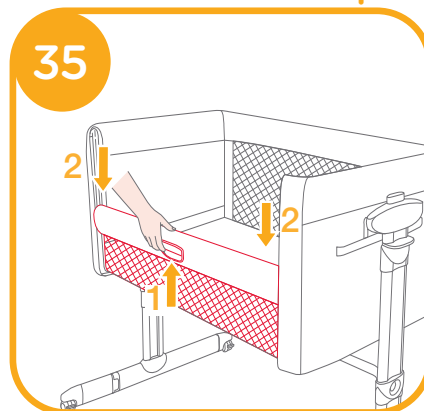
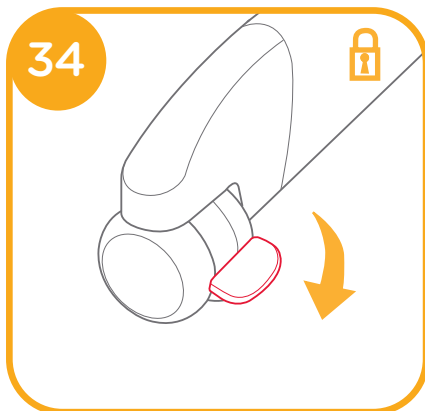



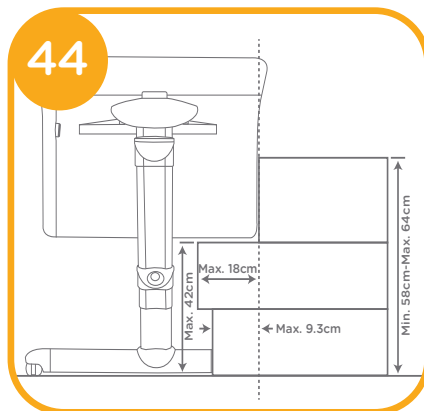
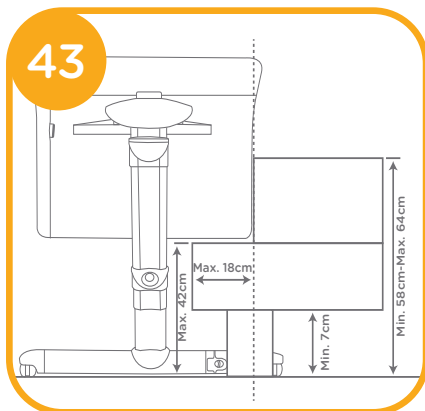
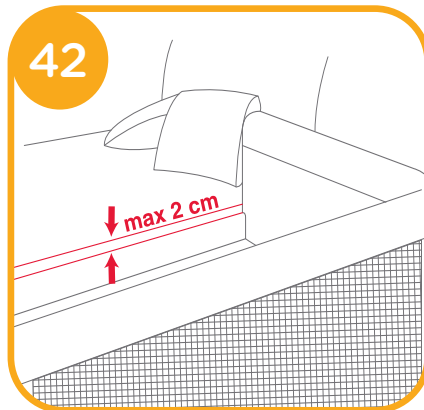
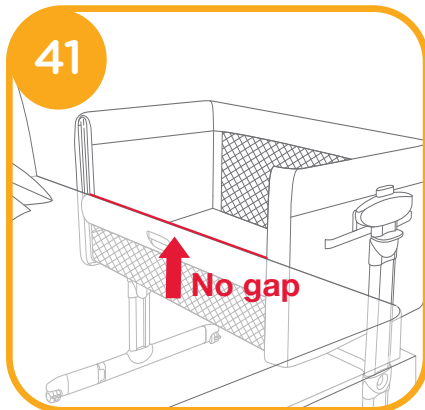

## Use Storage Bag

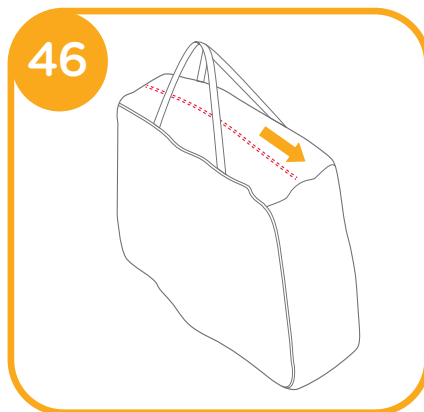
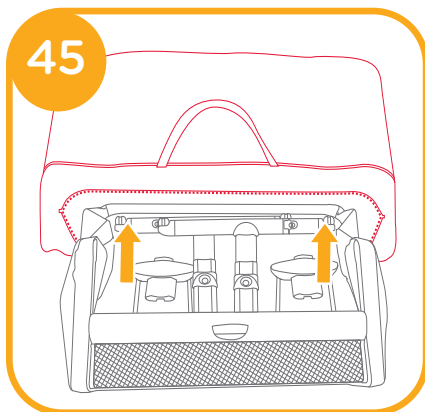

## Accessories (May not be included)

Accessories may be sold separately or may not be available depending on region.

## Sheet Assembly

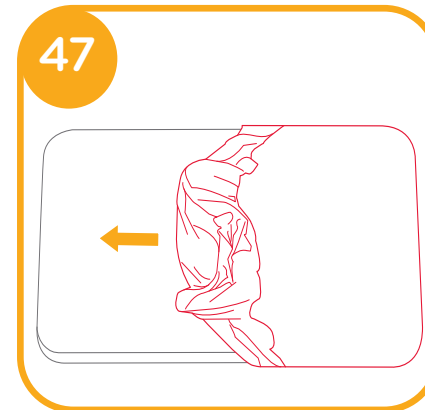

## Care and Maintenance

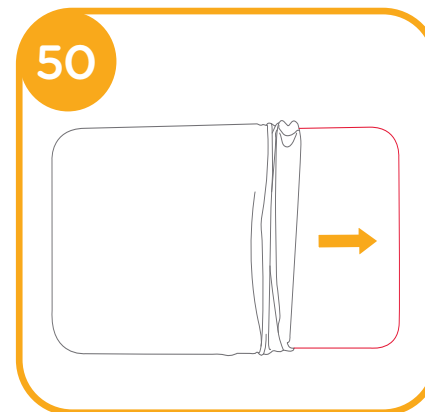
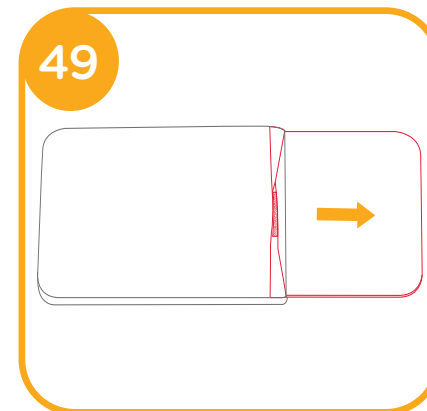
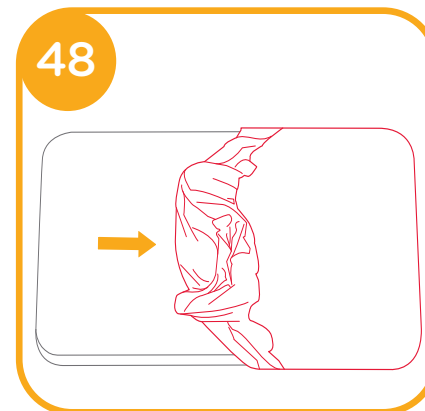

Congratulations on becoming part of the Joie family! We are so excited to be part of your life with your little one. While using the Joie roomie™ glide, your baby is enjoying a high quality, fully certified product, approved to European safety standards EN 16890:2017+A1:2021. This product is suitable for use with children weighing under 9kg (approximately 0-6 months). Please carefully read this manual and follow each step to ensure a comfortable sleeping and best protection for your child.

Please keep the Instruction Manual handy for future reference.

Visit us at [Joiebaby.com](http://Joiebaby.com) to download manuals and see more exciting Joie products.

For warranty information, please visit our website at [joiebaby.com](http://joiebaby.com)

## Emergency

In case of emergency or accident, it is most important to have your child taken care of with first aid and medical treatment immediately.

## Product Information

Read all the instructions in this manual before using this product. If you have any further questions, please consult the retailer. Some features may vary depending on model.

Product	roomie™ glide
Suitable for	Birth to 9kg (approximately 0-6 months)
Materials	Plastics, metal, fabrics
Patent No.	Patents pending
Made in	China
Brand Name	Joie
Website	<a href="http://www.joiebaby.com">www.joiebaby.com</a>

## Parts List

Make sure all parts are available before assembly. If any part is missing, please contact local retailer. No tools are required for assembly.

- |                            |                                |                       |
|----------------------------|--------------------------------|-----------------------|
| 1 Height Adjuster Button   | 6 Wheel                        | 11 Storage Bag        |
| 2 Height indicator         | 7 Feet rotation release button | 12 Connecting webbing |
| 3 Mattress                 | 8 Support Tube                 | 13 Buckle C           |
| 4 Support Plastic Assembly | 9 Buckle A                     |                       |
| 5 Adjuster Button Rail     | 10 Buckle B                    |                       |

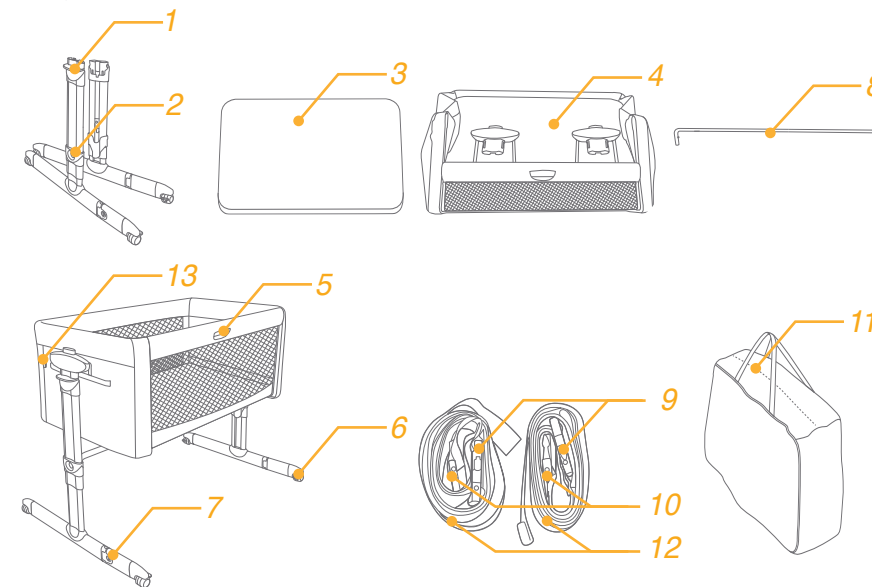

## Accessories (May not be included)

Sheet



Accessories may be sold separately or may not be available depending on region.

## **WARNING**

Read carefully and keep this manual for future reference. Failure to follow these instructions and warnings could result in serious injury or death.

Adult assembly required.

Check this product regularly before using it, and do not use it if any part is loose or missing or if there are any signs of damage.

DO NOT substitute parts. Contact the manufacturer if replacement parts or additional instructions are needed.

Infants should be placed to sleep on a firm, flat surface.

Place infant on their back when using this product.

DO NOT put objects or accessories in an infant's sleep environment.

DO NOT place this product near a blind, cord, strap or similar item that could become wrapped around an infant's neck.

DO NOT use this product when the infant begins to push up on hands and knees or has reached 9kg (approximately 0-6 months), whichever comes first.

DO NOT place additional items (e.g. toys, pillows ...) in the product.

DO NOT use more than one mattress in the cot. Only use the mattress that comes with the product.

Only use the mattress sold with this crib, do not add a second mattress on this one, suffocation hazards.

DO NOT USE the product in "Crib Configuration" and/or "Bedside sleeper Configuration" if any part is missing, damaged or broken. Contact joie for spare parts and user instructions if needed. DO NOT substitute parts.

When the product is being used, and above all in "Crib Configuration", the wheels must always be locked.

DO NOT use the product without the frame.

Keep the fixing straps out of reach of children.

When not attached to the bed, the crib can be inclined by a maximum of 4 positions between one leg support and the other.

DO NOT leave anything inside the product that might reduce its depth.

Infants can suffocate on soft bedding. Avoid placing pillows or similar items under newborn babies for additional comfort during sleep.

Use the crib in the "Bedside sleeper Configuration" (fastened to the bed) only with beds of the size indicated in the reference figure at the beginning of the manual.

To prevent the child from being trapped, do not place the crib close to walls or obstacles.

DO NOT leave any small objects inside the product that might be swallowed.

DO NOT attach any accessories to the product that have not been supplied by the manufacturer.

DO NOT make adjustments to the product when the child is in it.

When in the "Bedside sleeper Configuration" (fastened to the bed), the crib must never be inclined.

DO NOT move the product when the child is inside.

DO NOT use the product with more than one child at a time.

DO NOT place the product close to another product, which could present a danger of suffocation or strangulation, e.g. strings, blind/curtain cords, etc. To avoid strangulation hazards, never give children objects with strings attached, or leave these objects within their reach.

Prolonged exposure to direct sunlight may cause the product's colour to fade. After prolonged exposure of the product to high temperatures, wait a few minutes prior to putting your child in it.

All assembly fittings should always be tightened properly and that care should be taken that no screws are loose, because a child could trap parts of the body or clothing (e.g., strings, necklaces, ribbons for babies' dummies, etc), which would pose a risk of strangulation.

Keep the product out of reach of children when it is not in use.

Be careful when the child is in the crib, that objects or bedding items do not fall into the crib.

The mattress of the adult's bed shall be aligned to or above the height of the drop side in the lowest position.

Size of the mattress: 840mm\*510mm\*50mm.

To prevent a suffocation hazard from entrapment, the bedside sleeper shall be properly secured to the adult bed using the attachment system.



Do not use this product without reading the instructions for use first.

Stop using the product as soon as the child can sit or kneel or pull itself up.

Do not use the product if any part is broken; torn or missing and use only spare parts approved by manufacturer.

Placing additional items in the product may cause suffocation.

The product should be placed on a horizontal floor.

Young children should not be allowed to play unsupervised in the vicinity of the crib.

The crib should be locked in the fixed position when the child is left unattended.

Be aware of the risk of burning cigarettes, open fires and other sources of strong heat, such as electric bar fires, gas fires, etc. in the near vicinity of the crib.

The fixing straps are included in the packaging. Other fastening systems should not be used.

There shall never be a gap between the lower side of the bedside sleeper and the mattress of the adult bed.

Check the tightness of the attachment system before each use by pulling the bedside sleeper in a direction away from adult bed.

If there is any gap between the bedside sleeper and the adult bed DO NOT use product.

Gaps should not be filled with pillows, blankets or other items.

**DANGER!** Always completely raise the drop side when not attached to the adult's bed.

To avoid hazards from the child's neck being caught on the top rail on the side that is next to the adult bed, the top rail must not be higher than the adult bed mattress.

To avoid the risk of your child being strangled the attachment system to the adult's bed shall always be kept away from and out of the crib.

Be aware of the risk of open fire and other sources of strong heat, such as electric bar fires, gas fires, etc. in the near vicinity of the cot (crib and suspended bed).

## Bedside Crib/Bassinet Assembly

see images 1 - 26

Please read all the instructions in this manual before setting up and using this product.

! Please make sure that the adjustable side rail faces in the same direction with adjustable feet.

## Rocking Function Activation

see images 27 - 28

! Please lock the rocking function during using the unit as bedside sleeper. 28

## Height Adjustment/Bassinet Mode

see images 29 - 32

! The crib can be adjusted to different height positions.

! Press the height adjuster buttons on both sides to adjust the height of the crib. 29

! The crib can be inclined with a maximum variance of 4 positions between one leg and the other (for example: the right leg in position 5 and the left leg in position 1, see fig. 31 32).

! It only be applicable to cradle state, but not to bedside sleeper state. 31 32

! The head of the child should always be positioned on the highest side. 31 32

## Use Wheels

see images 33 - 34

At this point the crib is ready to be used.

! Do not use the crib with adjustable feet partially or totally rotated and unlocked. The correct position for use is illustrated in figure 26. In the case of accidental knocks against adjustable feet, return them to the correct position by lifting the crib slightly.

## Use Bedside Sleeper

see images 35 - 44

1. Press the button 35 - 1 to drop the side down 35 - 2.

2. Position next to bed 36, Connect Buckle to roomie glide 38 then loop strap around bed frame and connect to adjuster buckle 39, then pull straps tight 40.

! During fixing the crib to the parent's bed, If it is not possible to slide the feet of the crib under the parent's bed, you can rotate the adjustable feet. 37

3. Ensure no gap between parent's mattress and roomie glide 41. The maximum height difference between the parents' mattress and the drop side at the lowest position is 2cm 42

4. The type of adult bed which can be used with bedside sleeper is slatted bed frame and box / divan bed frame, the dimensions of adult bed shown on fig. 43 & 44

! Check to make sure that the crib in the bedside sleeper mode does not interfere with the parent's bed.

! During use, make sure that the parents bed sheets, blankets etc. Do not enter and cover the interior of the crib.

! In the bedside sleeper mode the 2 legs of the crib should always be adjusted to the same height.

! Before every use always check to make sure that there is no space between the parent's mattress and the side of the crib. If there is, pull the belts firmly to tighten until there's no space and the permitted condition of use has been restored.

! Use of the product is only permitted with beds and/or mattresses with straight sides. Use of the product with round beds and/or mattresses or water beds is not permitted.

! When the product is used in the “bedside sleeper mode” (fixing to the bed, it should always be fitted to the long side of access to the bed. Do not fix the product to the head or bottom of the bed.

## Use Storage Bag

see images 45 - 46

! Refer to Bedside Sleeper Assembly and perform reverse operation to fold the unit, and use the bag for convenient transportation.

## Accessories (May not be included)

### Sheet Assembly

see images 47

! Prevent possible suffocation or entanglement. NEVER use product sheet unless it fits securely on product mattress.

! Wrap the sheet around the mattress on all four corners. MAKE SURE the sheet is securely attached to the four corners.

## Care and Maintenance

see images 48 - 50

1. The fabric cover of crib is not removable.
2. Your product can be spot cleaned with a sponge and soapy water.
3. Do not use undiluted neutral detergent, gasoline or other organic solvent to wash the product. It may cause damage to the product.
4. To wash carry bag, machine wash in lukewarm water and drip-dry. Do not use bleach.
5. At the beach or in the garden, clean sand and grit off your product. Sand in the long rail locks may cause damage.
6. From time to time, check your product for worn parts, torn material or stitching. Replace or repair the parts as needed.
7. If the product is not in use for a long period of time, please put it in the shade where your child cannot access it.



Allison AU Pty Ltd.  
Unit 1, 35 Lyn Parade Prestons,  
NSW Australia 2170

bring the kids™

Share the joy at [joiebaby.com](http://joiebaby.com)

IM-001827C