

INSTRUCTIONS

Joie™

trove lx trove

MODEL I1404D

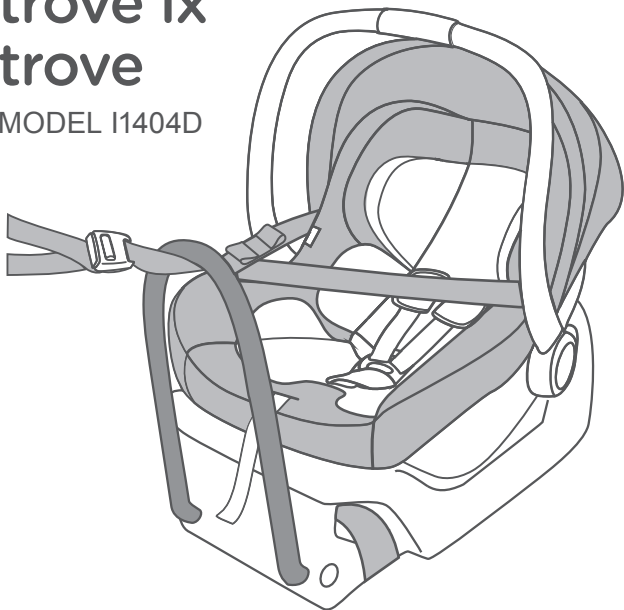

Illustrations may vary from actual product.

**IMPORTANT: KEEP THIS INSTRUCTION BOOKLET IN
THE PLACE PROVIDED ON THE CHILD RESTRAINT**

This Child Restraint is suitable for children up to approximately 12 months of age.



Before installation and use of this child restraint check that it is suitable for the size of your child.
See page 32 of the USE Instructions for more information.

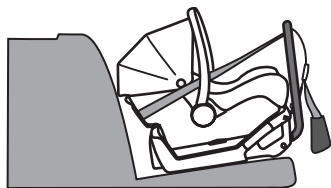

This is a rear facing child restraint. Do not face forward.

Keep these Instructions for future reference.

DO NOT USE THIS CHILD RESTRAINT UNTIL YOU HAVE READ AND UNDERSTOOD THE INSTRUCTIONS IN THIS USER GUIDE AND IN YOUR VEHICLE OWNERS MANUAL

NOTE: some features may vary between models

Contents

Overview	4
WARNINGS	5
Additional Warnings	6 - 9
Base Features	10
INSTALLATION	
General	11
Recline angle	12
Vehicle Belts	13 - 15
Checklist - Vehicle Belt Installation	15
ISOFIX Compatible Connectors	16 - 19
Checklist - ISOFIX Installation	20
Fitting Restraint to Base.....	21
WARNINGS – Tether Strap	22
How to use the Tether Strap	23 - 25
Checklist - Tether Strap	26
Installation – Tether Anchorage.....	27 - 29
USE	
Overview	30
Capsule features	31
Correct Child Size	32
Correct Shoulder Strap Height	33
Crotch Strap Position	34
Securing Child in the Restraint	35 - 36
Checklist - securing child in the restraint	37
Extra Padding	38
Seat Cover Removal	39
Infant Liner	39
Canopy Removal	40
Carry Handle Use	41
Accessories	42
Use with Strollers	42
The Next Restraint	43
Cleaning and Maintenance	44

Overview

IMPORTANT: Also read the following instructions carefully

Tether Strap

must always be used when the restraint is installed in a vehicle.
Store end of tether in bag.
See page 23 - 25

Carry Handle

must always be locked into position.

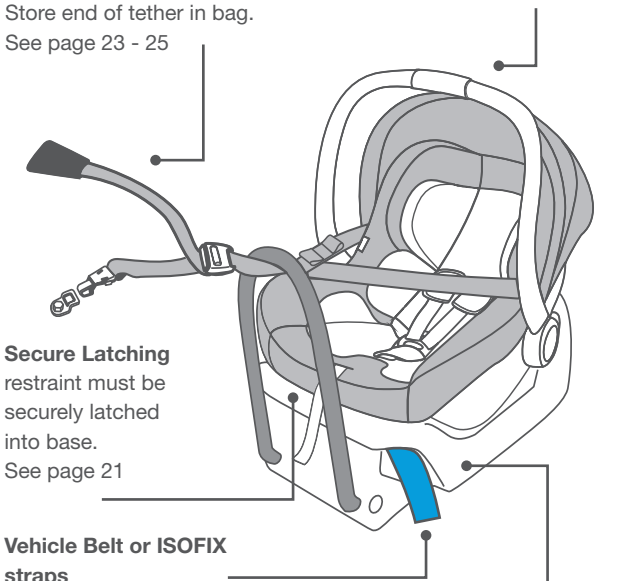

Secure Latching

restraint must be securely latched into base.
See page 21

Vehicle Belt or ISOFIX straps

must always be secure and pulled tight.
See pages 14 & 19

Base Recline Adjustment

base must be reclined correctly
See page 12

Read the whole of these instructions carefully and if there is any doubt about the method of installation, consult the child restraint manufacturer or agent, or a child restraint fitting station authorized by the relevant transport authority, or in New Zealand an agent for the vehicle.

WARNING

- Use the restraint exactly as shown in the instructions.
- Fit the harness firmly to the child.
- **Fit the restraint firmly to the car seat.**
- **A loose harness or restraint is dangerous.**
- Supervision of children is needed because they may be able to undo buckles.
- To ensure that baby's back is evenly supported, do not put more than one nappy on the baby and make sure the nappy is not folded thickly at the back.
- Do not harness an infant wrapped in a blanket or swaddled. Any blanket or wrap must only be placed over the harness and infant.
- Destroy the restraint if it has been in a severe crash, even if no damage is visible.
- Do not alter or modify this restraint.
- Repairs must only be done by the manufacturer or agent.
- **DO NOT USE A REAR FACING CHILD RESTRAINT WHERE AN AIRBAG IS FITTED IN FRONT OF THE SEATING POSITION.**
- **DO NOT USE THIS RESTRAINT WITHOUT THE COVER.**
- Do not allow the restraint to come into contact with polishes, oils, bleach and other chemicals.
- **Only use this restraint with the base it was supplied with. If a second or replacement base is required it must be a matching model number.**

WARNING

DO NOT LEAVE CHILDREN UNATTENDED IN THE CAR

! ADDITIONAL WARNINGS

This Child Restraint is:

To be used only in a rearward-facing position until the infant's shoulders reach the shoulder height marker (approximately 12 months of age).

Continue to use this infant restraint until the child reaches this limit.

Infants are at risk of serious injury if they face forward too early.

Ensure that children have adequate ventilation and shade when in the vehicle.

Aftermarket accessories (i.e. items not provided in the box with the child restraint), may not have been tested for use with this child restraint and if used, may lower the level of protection offered possibly leading to injury or death.

Any aftermarket accessory used should be compliant with AS/NZS 8005 (Accessories for child restraints for use in motor vehicles) and stated as suitable for use with this child restraint.

Always check child restraint to base connection.

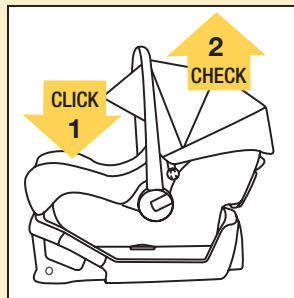

! ADDITIONAL WARNINGS

TO BE USED WITH A LAP-SASH/LAP ONLY SEATBELT OR ISOFIX LOW ANCHORAGES IN THE BACK OF MOST CARS WITH FORWARD FACING SEATS.

When baby is in the restraint, ALWAYS secure the harness and adjust to a firm fit.

Always check buckle and other parts for hot surfaces. A child restraint left uncovered in the sun could burn a child. Cover with blanket if leaving in car.

Fall hazard: Child's movement can slide carrier. NEVER place child restraint near edges of countertops, tables or other high surfaces. Always stay within arms reach whenever child restraint is not on floor/ground.

Suffocation hazard: child restraint can roll over on soft surfaces and suffocate child. Never place child restraint on beds, sofas, or other soft surfaces.

Strangulation hazard: Child can strangle in loose child restraint straps. Always use harness. Never leave child in the child restraint when straps are loose or undone.

Never place the child restraint on top of a shopping cart. The child restraint will not be properly secured and could fall.

Do not use the child restraint if it is damaged or broken.

Only use with Joie strollers or appropriate Joie adapters designed for use with other strollers.

⚠️ ADDITIONAL WARNINGS

Only install child restraint in a forward facing vehicle seat. Never install in a seat that faces the rear or the side of the vehicle.

This is a rearward facing child restraint. Do not install facing the side or forwards.

Never install the Child Restraint in a seat with a front airbag. DEATH or SERIOUS INJURY may occur. Refer to your vehicle Owners Manual for airbag warnings and information.

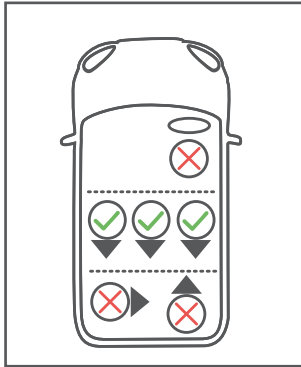

⚠️ ADDITIONAL WARNINGS

This restraint is 700 mm long, 440 mm wide and 480 mm high (with the handle down). Check the measurement between the front of the seat back of the rear seat and all front seats in the car in which the restraint is intended to be used to ensure the space available is sufficient.

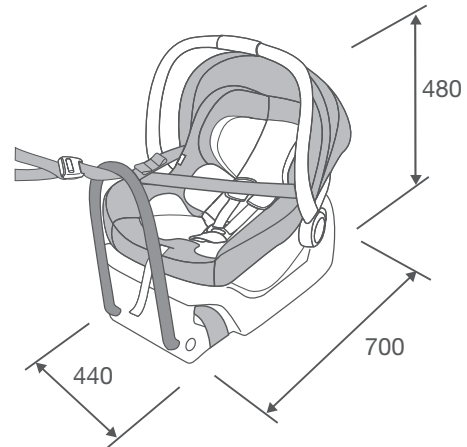

Seat belt extenders are not recommended if the car seat belt is too short to secure the child restraint. If the car seat belt is too short get advice from a child restraint fitter regarding use of these.

NOTE: The warnings on these pages are those required by the Australian and New Zealand Standard AS/NZS 1754 for this type of child restraint. Other warnings specific to this particular child restraint will be found throughout these instructions.

Base Features

- 1 Tether Strap
- 2 Child Restraint Release Lever
- 3 Snap Hook
- 4 Tether Strap Anchorage
- 5 Tether end storage
- 6 Rebound Bar
- 7 Vehicle Belt Lock-Off
- 8 Bubble Level Indicator
- 9 Recline Foot Fold Latch
- 10 Recline Foot
- 11 ISOFIX compatible connectors
- 12 Instruction manual storage

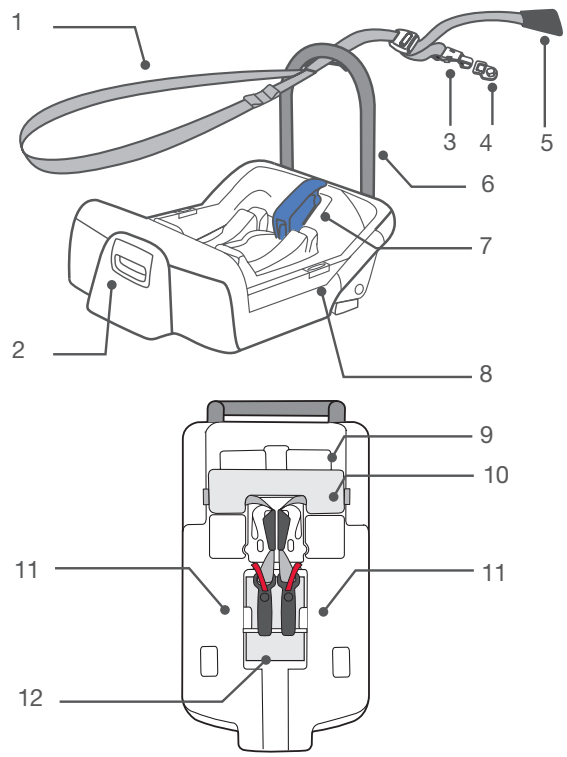

Installation - General

Where to install the child restraint?

Only install the child restraint in a forward facing vehicle seat.

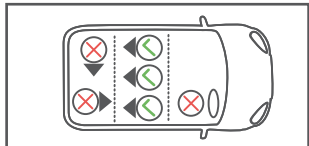

Do not install in a seat that faces the rear or the side of the vehicle.

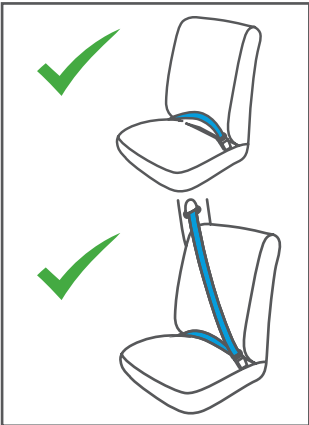

Install in the rear seat, the safest place is normally the centre.

The base can be installed on vehicles seats fitted with either a lap/sash belt or ISOFIX anchorages.

To install correctly the vehicle must be on a level surface.

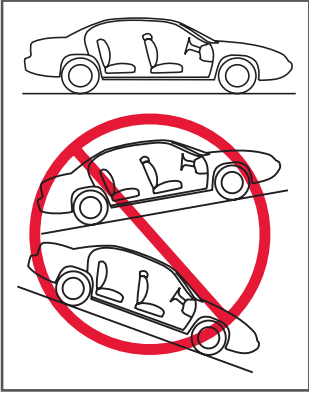

IMPORTANT:
 Correct position and installation is essential for your child's safety.

Installation - Set recline angle

1 Position base on a forward facing vehicle seat.

Adjust base so bubble is between the black patches.

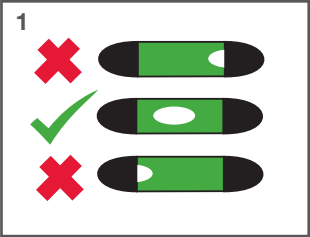

2 Use recline adjustment, if needed, to achieve correct angle for installation.

Recline adjustment foot snaps into position.

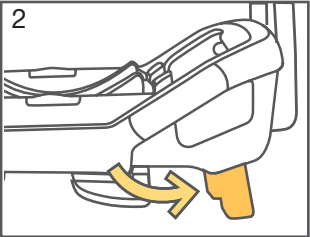

3 If the recline adjustment foot does not give sufficient recline, add a folded towel or similar firm padding.

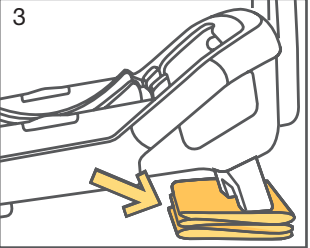

IMPORTANT:

Any extra padding placed under the base must be firmly folded so that when the vehicle belts are pulled up tight, the base is secure.

Always secure the base with a vehicle belt, even when the restraint is not fitted to it. An unsecured base may be dangerous in an accident or sudden stop.

Installation — Vehicle Belts

Use the Belt Path labels as a guide for correct belt placement.



REARWARD-FACING BELT PATH

Top Tether Anchorage

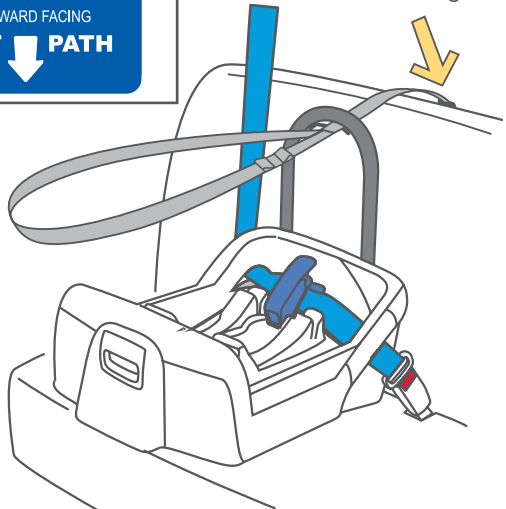

INSTALLED BASE

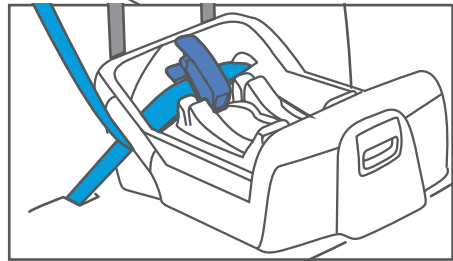

Installation — Vehicle Belts

Place the base on the vehicle seat in line with a top tether anchorage point.

1. Open the belt lockoff.

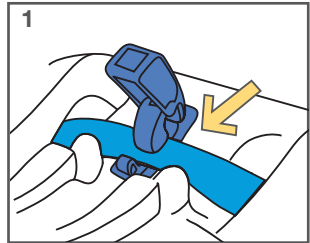

2. Pass the vehicle belt through the openings in the base labeled 'BELT PATH'

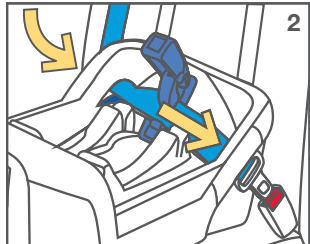

3. Buckle the vehicle belt.

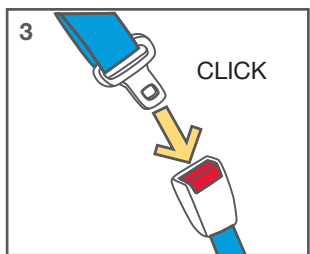

IMPORTANT
Belts must not be twisted.

4. Push the base into the vehicle seat firmly **A** and pull the vehicle belts tight **B**.

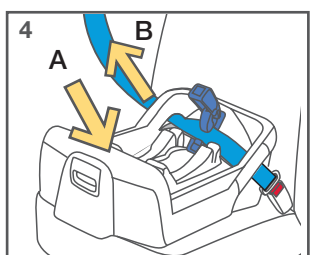

5. Hold vehicle belts tight and engage the belt lockoff.

IMPORTANT
Pull belts tight.
Loose belts are dangerous.

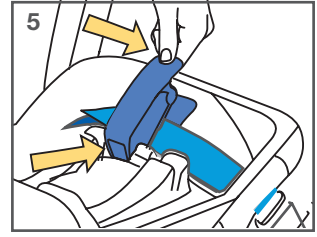

Checklist — Vehicle Belt Installation

1. Vehicle Buckle engaged.



2. Vehicle belt is tight.

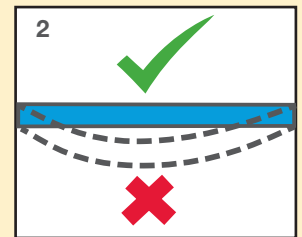

3. Vehicle belt is not twisted.

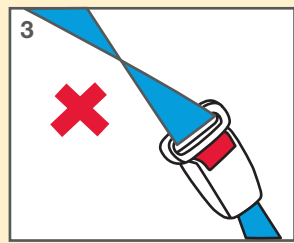

4. Level indicator bubble is fully in the clear area.

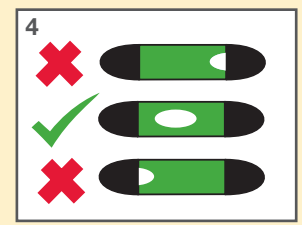

Installation — ISOFIX Compatible Connectors

Some vehicles are fitted with ISOFIX low anchorage points.

These are found at the bottom of the back seat backrest.

This child restraint has connectors to attach to them.

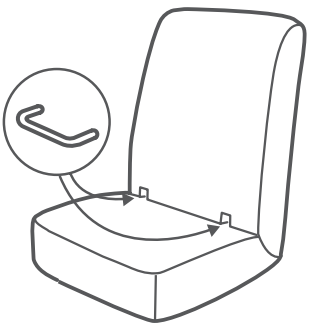

If the ISOFIX low anchorage points are not clearly visible the vehicle seat will be marked with labels to show their location.

If in doubt that the vehicle is fitted with such points check the Vehicle Owners Manual.

Some vehicles sourced from the USA may be marked LATCH.

ISOFIX and LATCH low anchorage points are the same.



ISOFIX

Typical marking showing location of ISOFIX low anchorage points.

LATCH

Installation — ISOFIX Compatible Connectors

The ISOFIX straps pass through the same openings in the base as used for the vehicle belts.
Use the Belt Path labels as a guide for correct belt placement.



Top Tether Anchorage

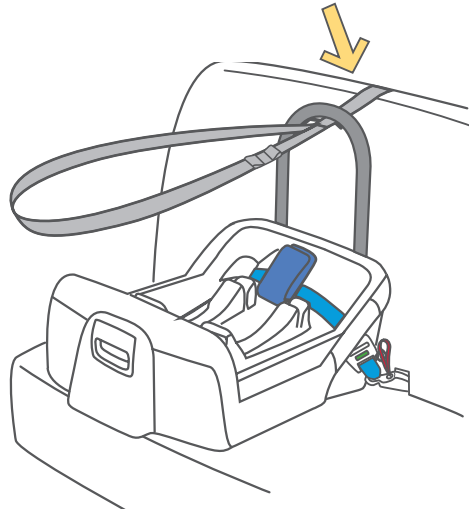

IMPORTANT
Always secure the base even when the restraint is not fitted to it.
An unsecured base may be dangerous in an accident or sudden stop.

Installation — ISOFIX Compatible Connectors

See general installation instructions on pages 16 & 17.

1 Turn base over. Bring the recline foot to the open position. Release each ISOFIX compatible connectors from the steel rod.

Position the ISOFIX compatible connectors at either side of the base.

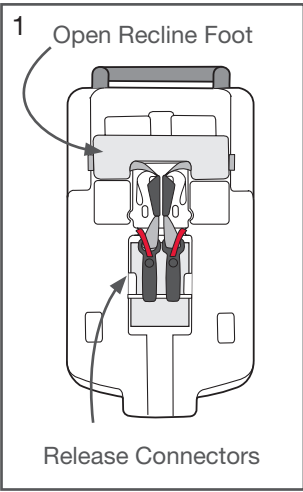

2. Place base in position on the vehicle seat. Check the bubble level indicator to see if recline foot needs to be out. Fold away if not required.

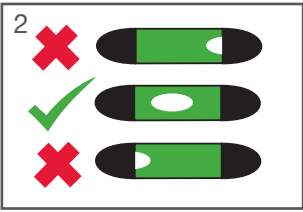

3. Attach each connector to the vehicle ISOFIX anchorages.

IMPORTANT
Straps must not be twisted.

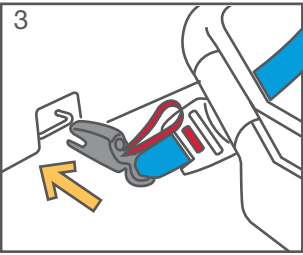

4. Pull each adjustment strap equally until the tension indicators show green.

IMPORTANT
Straps must be pulled tight

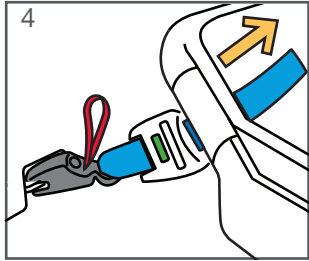

5. Reposition the spare web to outside the base.

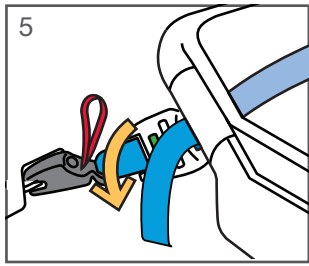

NOTE: in some vehicles the shape or softness of the vehicle seat cushion may prevent the indicators from showing fully green. Usually in these vehicles the strap tension is adequate. If in doubt check with a licensed child restraint fitter.

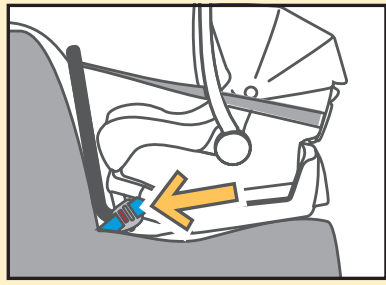

Checklist — ISOFIX Installation

1. Level indicator bubble is fully in the clear area.

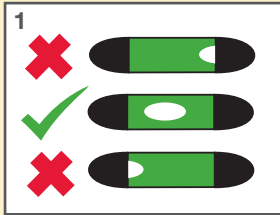

2. Belt is tight.

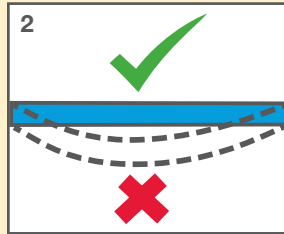

3. No twists in belts.

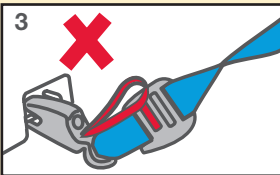

4 Belts tensioned, indicator shows green.

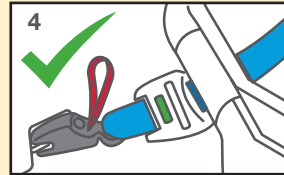

WARNING

IMPORTANT Do not attach the lower attachment connectors of two separate child restraints to the same ISOFIX low anchorage in your car.

Always attach the top tether strap to the child restraint upper anchorage in your car.

Child restraint lower attachment connectors and the ISOFIX low anchorages in your car are designed to withstand only those loads imposed by a correctly fitted child restraint.

Fitting Restraint to Base

To Install

First make sure there is nothing in or on the base (blankets, toys etc).

These may stop the restraint from latching securely.

Lower the restraint down into the base. Listen for a "CLICK" from the latches in the base.

Pull up on the restraint to ensure it is securely latched.

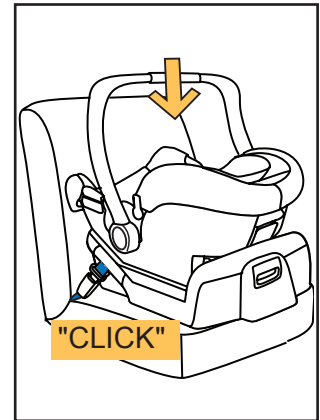

To Release

Lift the restraint with one hand while pulling up on the release latch at the back of the base.

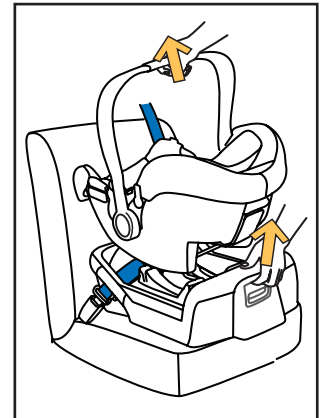

WARNING

TETHER STRAP

THIS RESTRAINT MUST BE ATTACHED TO A CHILD RESTRAINT UPPER ANCHORAGE POINT IN THE CAR.

REFER TO CAR OWNERS HANDBOOK FOR LOCATION OF ANCHORAGE POINTS.

REFER TO A CHILD RESTRAINT FITTING STATION IF NO ANCHORAGE POINTS ARE IN THE MOTOR CAR.

THIS RESTRAINT IS NOT SUITABLE FOR USE WHERE THE TOP TETHER STRAP MAY FALL INTO A SPLIT IN THE SEAT BACK OR OFF THE SIDE OF THE SEAT.

Always secure the loose end of the top tether strap to prevent it hanging out of the car or being accessible by the child. It should be stored in the bag provided on the end of the strap.

Do not use the child restraint where this strap may fall into a split in the seat back or off the side of the seat.

ALWAYS ATTACH HOOK AND REMOVE SLACK.

CAUTION: CHILDREN CAN BE INJURED OR RESTRAINTS AND TOP TETHER STRAP DAMAGED BY UNSECURED CARGO IN A COLLISION. SECURE OR REMOVE HAZARDOUS CARGO BEFORE USING THIS CHILD RESTRAINT.

How to use the Tether Strap

Always use the tether strap.

Connect the tether strap to the built-in anchorage fitting in the vehicle, or if there is not one available, install the anchor fitting supplied with this restraint.

Store the extra webbing in the bag attached to the end of the tether.

NOTE: the tether strap wraps around the sides of the restraint, not over the top. If the canopy is fitted the tether passes outside it.

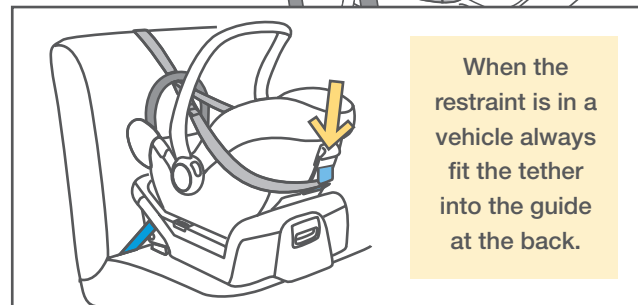
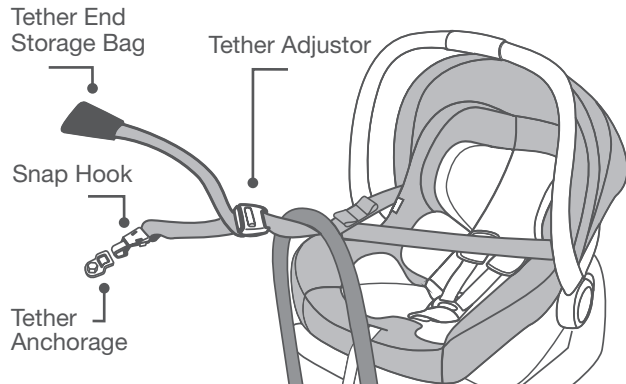

How to use the Tether Strap

1. Connect the snap hook securely to the anchorage fitting.

Note: there are several different looking types of anchorage, yours may not look like this.

Check the vehicle owners manual.

DO NOT attach the hook to a parcel tie down point.

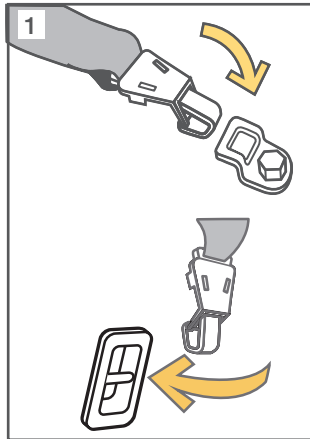

2. To increase webbing tension pull upper strap through adjuster.

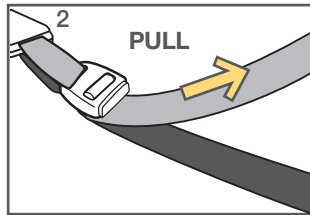

3. To release webbing tension press adjuster button and pull lower strap.

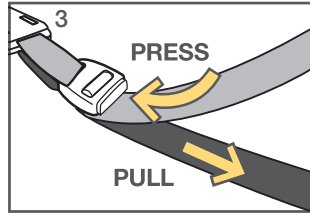

How to use the Tether Strap

Do not adjust so tight that it lifts the child restraint off the vehicle seat.

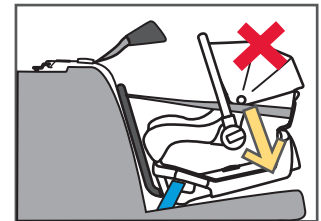

Store unused web in bag on end of tether.

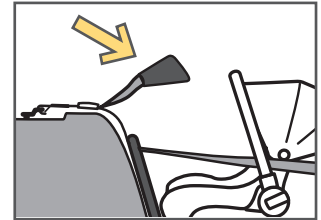

Straps must not be twisted

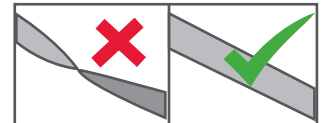

In some vehicles without a fixed parcel shelf an extension tether strap may be required. These are available in several different lengths and can be obtained from child restraint retail outlets.

Checklist — Tether Strap

1. Is snap hook securely attached to tether anchorage?

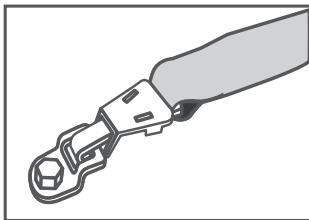

2. Is tether strap correctly tensioned?

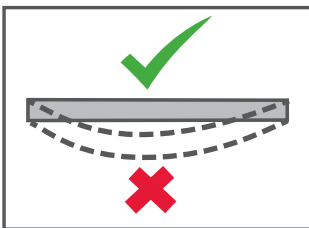

3. Is tether strap twisted?

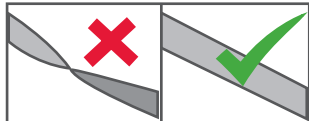

4. Is loose end of tether stored in bag?

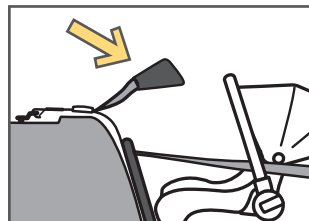

Installation — Tether Anchorage

Most cars have several threaded holes to fit the tether anchorage to. Refer to the vehicle owners handbook for information on the location of these points.

Using the bolt provided attach the anchor fitting to the mounting point behind where the child restraint is to be installed.

See more detailed information on the next page.

The anchor fitting must be aligned as shown unless stated otherwise in the vehicle owners handbook.

If drilling a new hole, select a position on the centre line of the seating position, and no closer than 100 mm from the front edge of the parcel shelf.

The threaded hole for the anchorage bolt may have a plastic cover over it

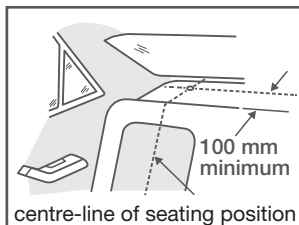
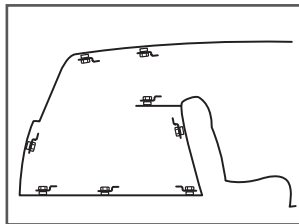
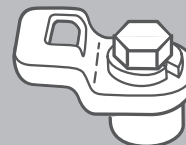

Installation – Tether Anchorage

If the car is fitted with a child restraint anchorage point:

Locate the anchorage point behind the rear seating position (consult the vehicle owners handbook for location of the anchorage point). Remove the thread plug from the parcel shelf/floor/roof and install the attachment bolt as shown opposite.

CAUTION:
DO NOT OVERTIGHTEN THE ATTACHMENT BOLT.
MAXIMUM TORQUE 20Nm.

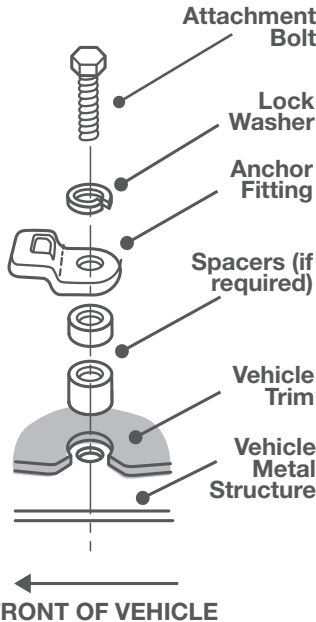

! WARNING

CHILD RESTRAINTS MUST NOT BE ATTACHED TO UNSOUND METAL OR WOOD OR SYNTHETIC STRUCTURES. WHEN DRILLING THE 9 MM HOLE DO NOT DRILL THROUGH FUEL LINES, FUEL TANKS, ELECTRICAL WIRING, OR RADIO SPEAKERS. WEBBING STRAPS MUST BE PROTECTED FROM SHARP CORNERS AND EDGES.

THE ANCHOR FITTING MUST BE USED ONLY AS DESCRIBED ABOVE. IT MUST NOT BE HOOKED ONTO ANY OTHER OBJECT.

Installation – Tether Anchorage

If the car is not fitted with a child restraint anchorage point:

For sedans only - drill a 9 mm hole in the parcel shelf on the centre line of the seating position as shown on page 22. Install the anchor bolt as shown opposite.

It is recommended that this installation be carried out by a child restraint fitting station or licenced motor mechanic.

For vehicles other than sedans - In Australia, consult your nearest child restraint fitting station or traffic authority for vehicle inspection to find the best, correct position for the placement of the anchorage point, and for the correct attachment bolt length and use of spacers. In New Zealand, consult the agent for the vehicle.

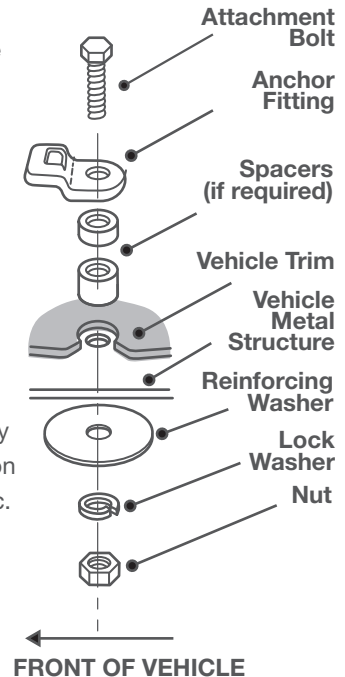

Overview

IMPORTANT: After reading this Quick Reference read the following instructions carefully.

Shoulder Straps

must always be at correct height and pulled tight. See pages 33

Infant Liner

only use for smaller children who require more support. See page 40

Shoulder Height

shoulders must not be above the marker line See page 32

Harness Straps

must not be twisted. See page 37

Harness Buckle

must always be securely fastened. See page 36

Harness Tension

pull harness tight. See page 37

Suitable Clothing

child's clothing must not interfere with the harness See page 38

Child Position

child must be in full contact with back of restraint. See page 35

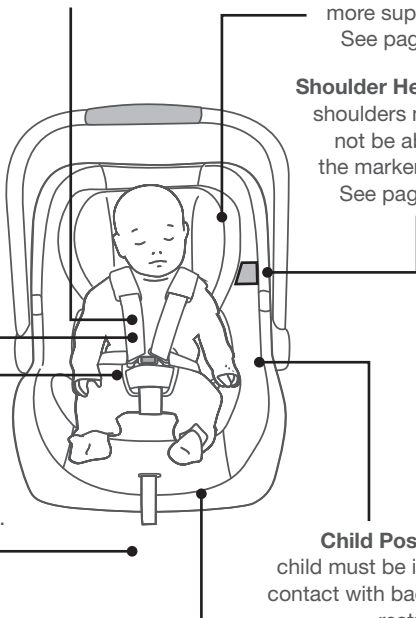

Features

- | | |
|---|----------------------------|
| 1 Carry Handle | 8 Shoulder Pads |
| 2 Headrest | 9 Carry Handle Lock |
| 3 Infant Insert | 10 Harness Straps |
| 4 Buckle and Crotch Belt | 11 Seat Cover |
| 5 Harness Adjuster Button (under cover) | 12 Stroller Release Handle |
| 6 Harness Adjuster Strap | 13 Base Attachment Bars |
| 7 Canopy | 14 Removable Cover |

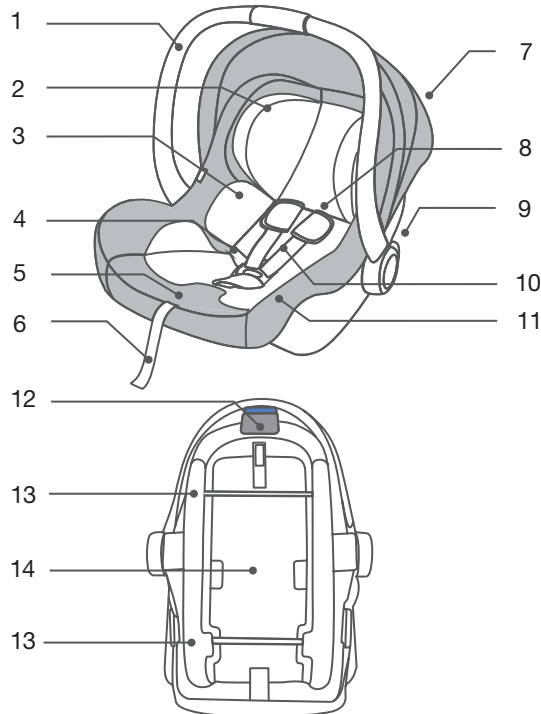

This Child Restraint is suitable for children up to approximately 12 months of age. See page 4 for more detailed information.

Correct Child Size

This restraint has a shoulder height level label. Use this to know when your child is too big for the restraint.

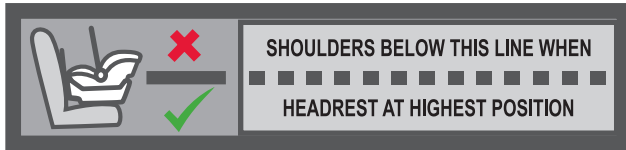

Once your child's shoulders reach the dotted line, it is time to move to a bigger restraint. See page 43.

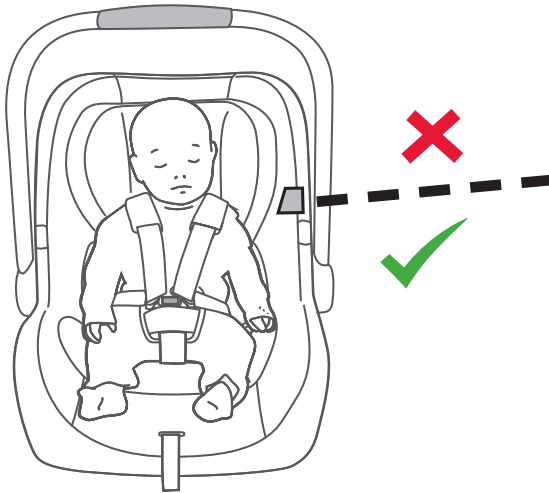

Correct Shoulder Strap Height

Correct positioning of the shoulder straps is essential for your baby's safety.

Requirement:

The shoulder strap slots must be in the first adjustment position above the child's shoulders, and not lower than the child's shoulders.

TO CHECK:

- 1 With child placed in the restraint, note where the shoulder straps are relative to the child's shoulders.
- 2 Refer to the requirements above.

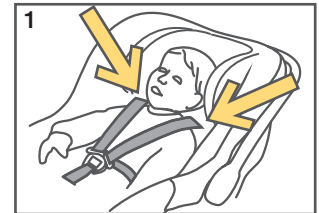

TO ADJUST:

- 3 The shoulder straps move with the headrest. Adjust the headrest height by squeezing the release lever at the back of the headrest and raising or lowering it as required.

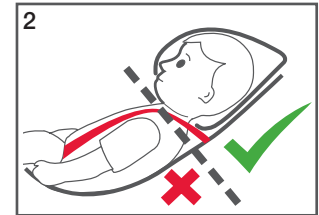

IMPORTANT: Always adjust the height of the shoulder straps as the child grows

Crotch Strap Position

There are two positions available for the crotch strap. The rear position is recommended for normal use and the front position with a bigger child.

To Adjust:

Turn the seat over, turn and slide the crotch strap steel buckle through the slot to release it. Reposition the steel buckle in the other slot. The steel buckle must be fully through the slot.

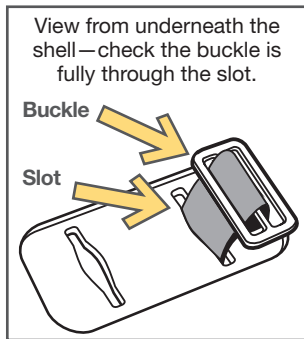
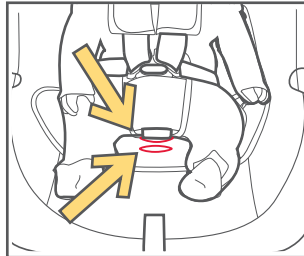

View from underneath the shell—check the buckle is fully through the slot.

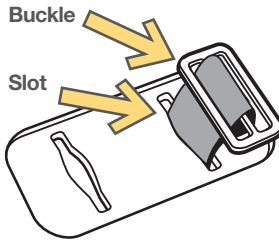

IMPORTANT: After changing the strap position pull firmly upward on the crotch strap to check the buckle is securely fitted.

Securing Child in the Restraint

First check shoulder strap height and adjust if necessary. See pages 33

1 Loosen harness by pressing on adjuster button while pulling on the harness straps.

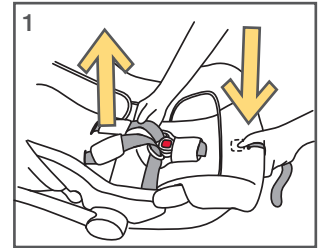

2 Press button to open the quick release buckle (A). Spread harness straps apart (B).

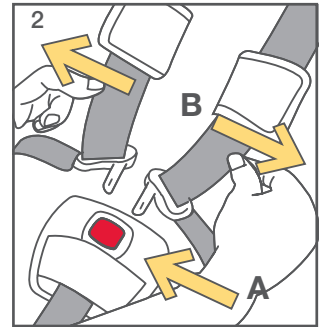

3 Place child in restraint in seated position.

Child's back must be firmly against both the back and bottom of the restraint. See note on page 38 about suitable clothing for a child in a restraint.

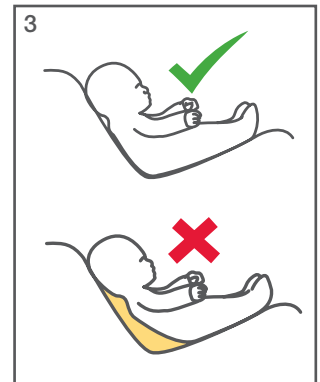

- 4 Place buckle tongues into the quick release buckle.
IMPORTANT: Both buckle tongues should "CLICK" into place. If they do not click, try again or try cleaning the buckle. See page 44.

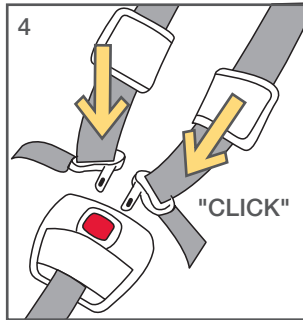

- 5 Tighten harness by pulling on the adjuster strap at the front of the restraint.

Note: you may need to pull excess shoulder strap webbing through the Quick Release Buckle Tongues upward towards the child's shoulder and then pull on the adjuster strap. This may need to be repeated several times to get the webbing fitting snugly.



Checklist

- Strap tension: put finger under strap and pull out.

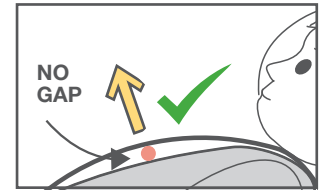

- Is buckle securely fastened?

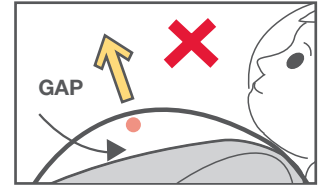

- Shoulder Straps must not be twisted.

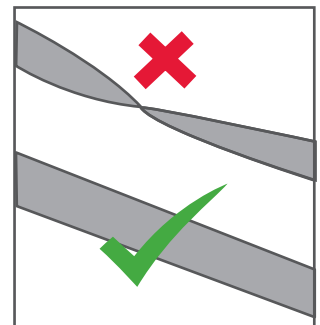
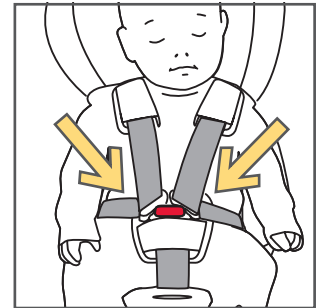

⚠ WARNING

DO NOT LEAVE CHILDREN UNATTENDED IN THE CAR

Extra Padding

Shoulder pads and the crotch strap pad are removable and are not necessary for safety.

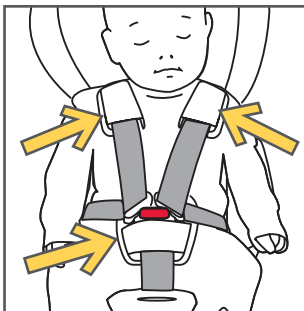

IMPORTANT

Child must be dressed in clothing that allows the harness to firmly secure them.

Blankets

Never use blankets or clothing that interfere with the harness as a poorly secured child can come out of the restraint during a crash. Only place blankets over child AFTER harness has been properly tightened.

Swaddling

Infants need to be securely held by the harness. An infant wrapped in a blanket or swaddled will not be securely held and may be ejected and killed in an accident
Do not bind or wrap the infants arms or legs together.

Seat Cover Removal

- 1 Lift the headrest cover off the headrest.

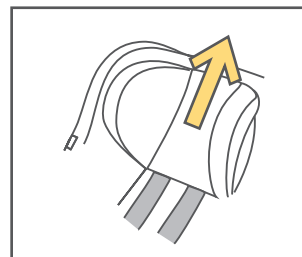

- 2 Pull the fastening pieces underneath the edge of the seat out.

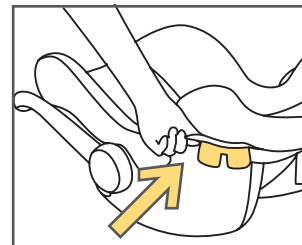

- 3 Remove the seat cover from the stroller release buttons.

Lift cover off seat starting from the back.

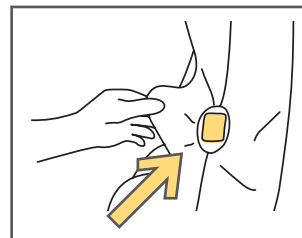

VERY IMPORTANT: Only replace the cover with a Joie supplied replacement cover with identical shoulder height markers or a replacement cover meeting AS/NZS 8005.

Infant Liner

The infant liner can be used to provide a snug fit for smaller babies.

Remove it when the baby is bigger.

Do not use the infant liner once the baby is bigger and the liner is restricting movement.



Canopy Removal

To remove the canopy, release the press studs, and press the buttons in the canopy mounts. Then pull the canopy bow out.

To replace simply plug the canopy bows in until they click. Then fasten the press studs.

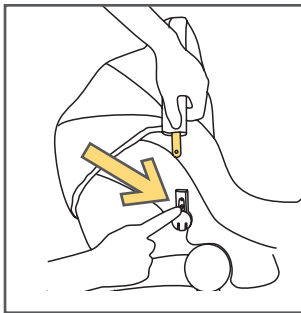

Carry Handle

Carry Handle Use:

The carry handle can be adjusted to 3 positions.

- 1 To adjust the handle position, squeeze handle buttons, on both sides and rotate.
- 2 Rotate handle until it clicks into any of the 3 positions.

The carry handle can be used in a vehicle in any locked position.

IMPORTANT

Be sure handle is locked in the carry position before lifting carrier by handle.

An unlocked handle could move unexpectedly, causing injury to the child.

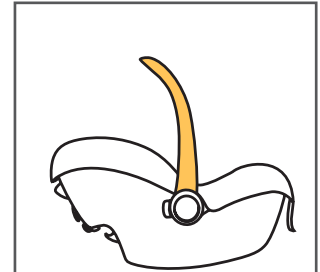
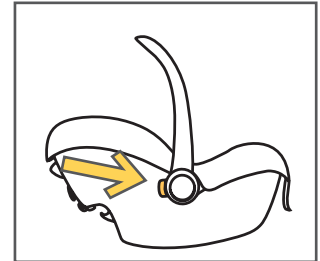

Accessories

DO NOT add accessories, toys, padding or other items to the child restraint unless provided by Joie.

Aftermarket accessories (i.e. items not provided in the box with the child restraint), may not have been tested for use with this child restraint and if used, may lower the level of protection offered possibly leading to injury or death.

Any aftermarket accessory used should be compliant with AS/NZS 8005 (Accessories for child restraints for use in motor vehicles) and stated as suitable for use with this child restraint.

Use with Strollers

This Joie™ child restraint can attach to Joie strollers using adapters. Instructions are included with the adapters, which are sold separately.

The Next Restraint

This restraint is suitable for a baby up to approximately 12 months of age.

When the baby's shoulders are level with the shoulder height marker (see page 33) they should move to a bigger restraint.

The next category of restraint is forward facing and has a six point harness and will be suitable for the child until they are approximately 4 or 8 years of age depending on the model.



IMPORTANT

If the baby's neck muscles are unable to support their head, they should remain rear facing.

Cleaning and Maintenance

Seat Cover

Wash with cold water and mild detergent.

Do not iron.

Do not bleach or dry clean.

Do not twist the soft goods to dry with great force. It may leave the seat cover with wrinkles.

Hang dry the seat cover in the shade.

Plastic and Metal Parts

Use only mild detergent, water and a soft cloth to clean the car seat shell, handle and harness straps. Air dry.

Do not use undiluted detergent, or other solvents to clean - these may cause damage.

Harness Buckle

To clean the buckle: rinse using warm water. DO NOT use any soaps, solvents or lubricants. Using anything other than water can cause the buckle to malfunction. Air dry.

When the buckle is operating correctly the tongues will push in easily and will CLICK when they latch into place.

If the buckle does not appear to be working correctly get it checked or replaced by contacting the retailer from where it was purchased.

Harness Straps

Shoulder harness straps are not removeable.

Clean with mild detergent, water and a soft cloth only.

Storage

Remove the child restraint from the vehicle seat if not in use for a long period of time. Put the child restraint in a cool, dry place and somewhere your child cannot access it.



Distributed by Allison AU Pty Ltd

ACN: 642 240 140

Unit 1, 35 Lyn Parade Prestons,

NSW Australia 2170

For after-sales & warranty service, contact:

1800 951 070

customerservice@allisonau.com.au