

# bright<sup>™</sup>

by Joie<sup>™</sup>

## wandi<sup>™</sup>

### stroller

Instruction Manual

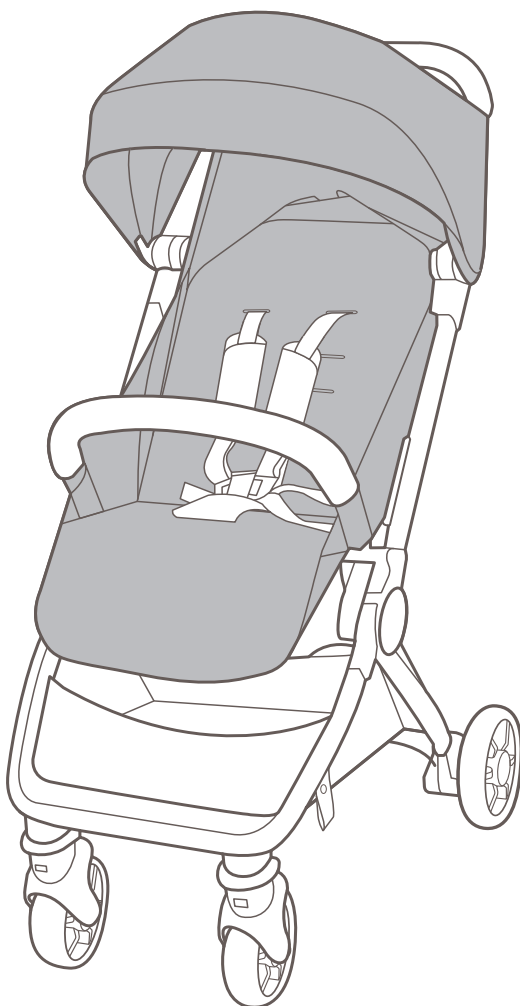

IMPORTANT - KEEP THESE INSTRUCTIONS FOR FUTURE REFERENCE.

STROLLER ASSEMBLY

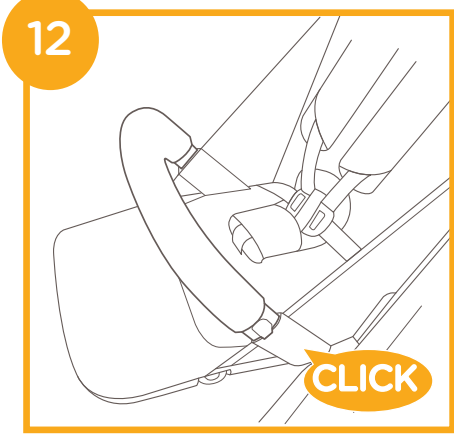
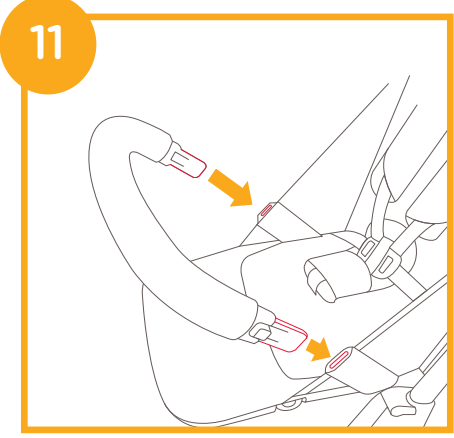
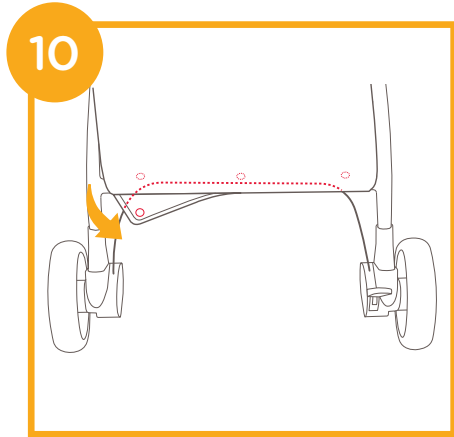
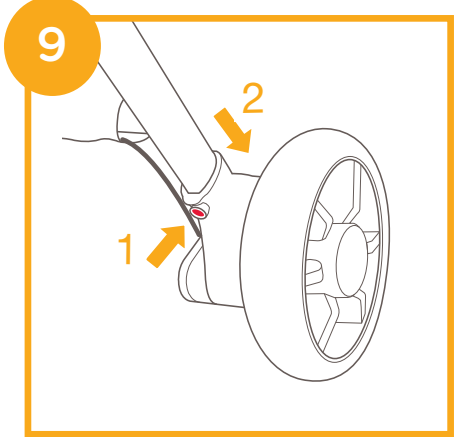
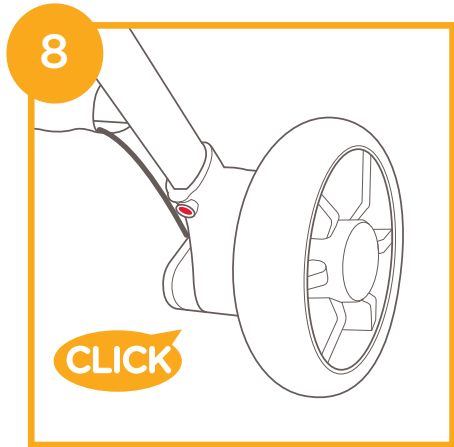
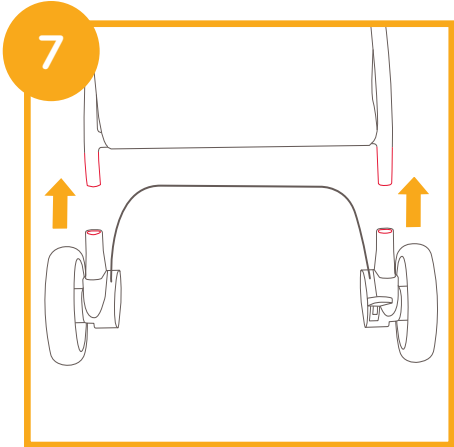
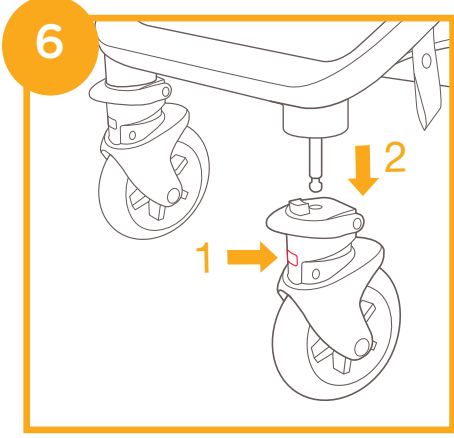
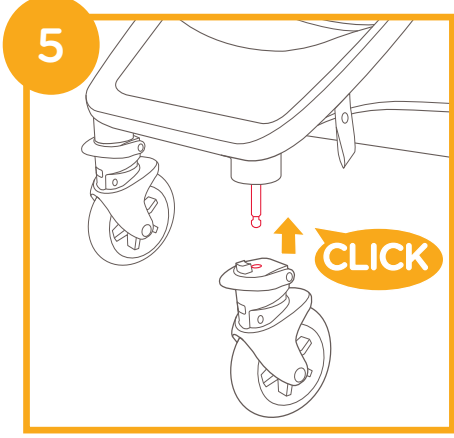
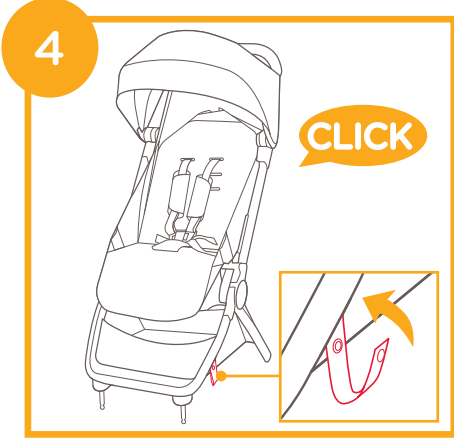
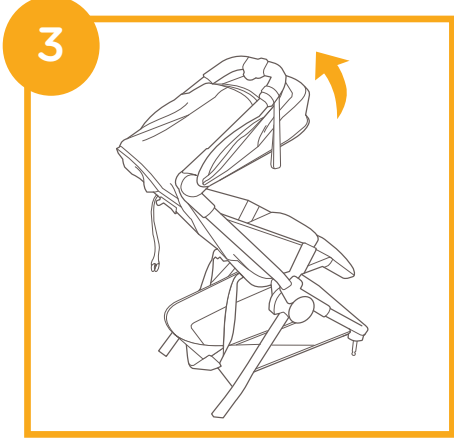
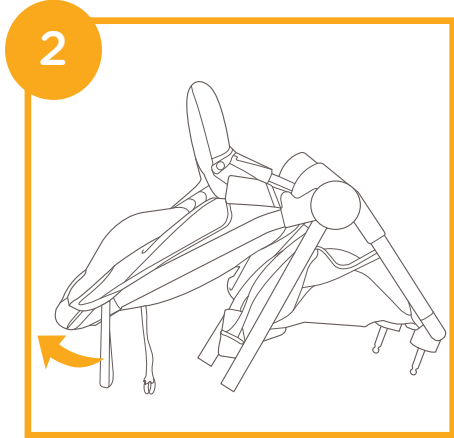
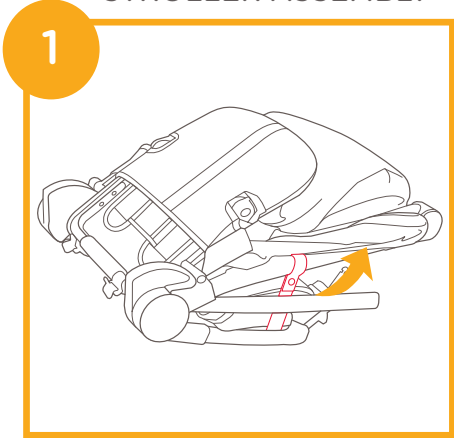

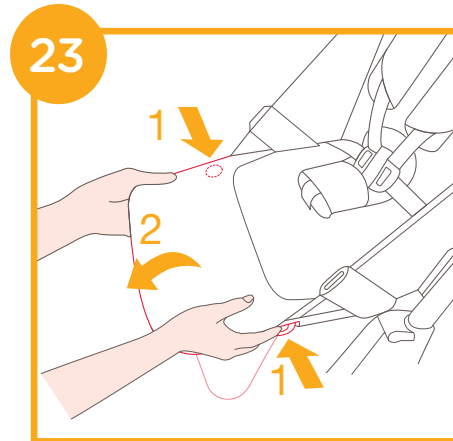
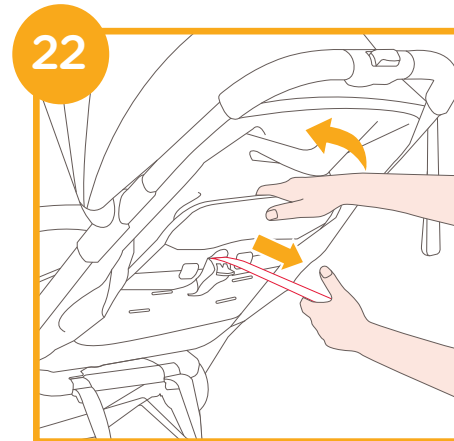
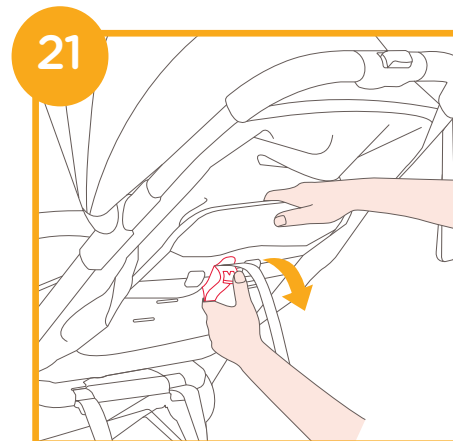
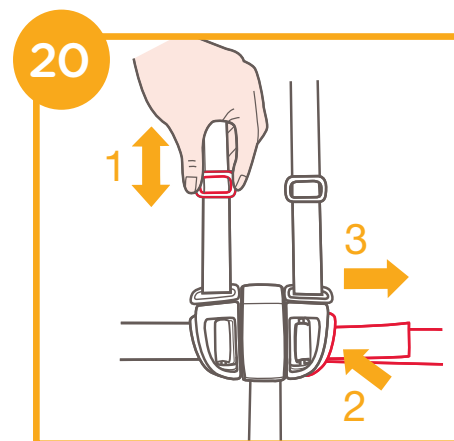
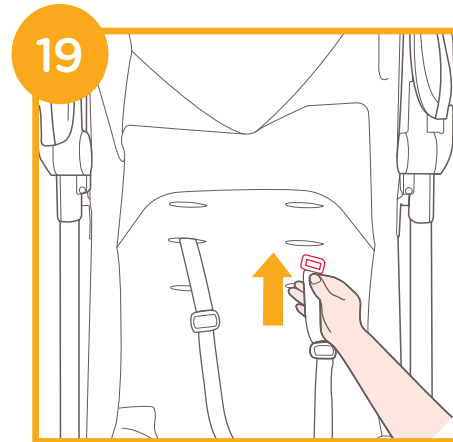
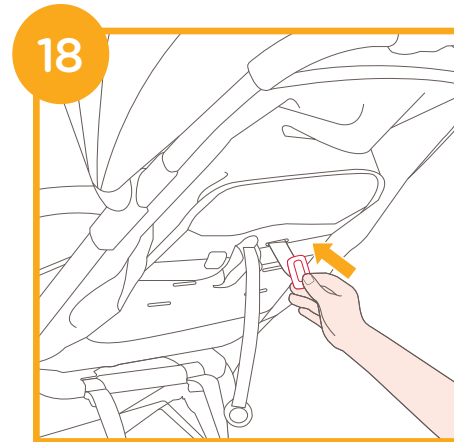
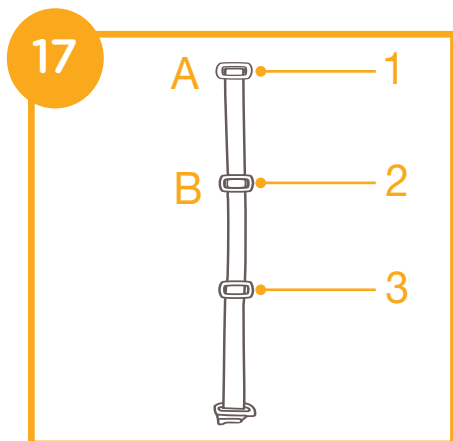
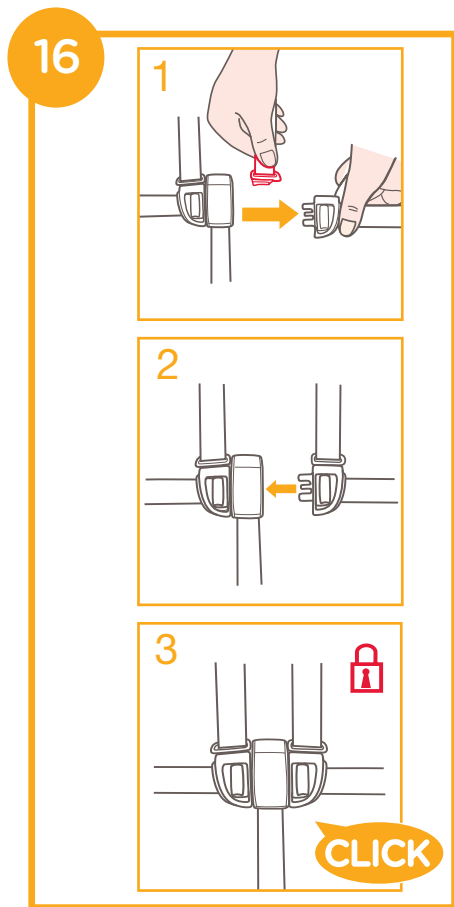
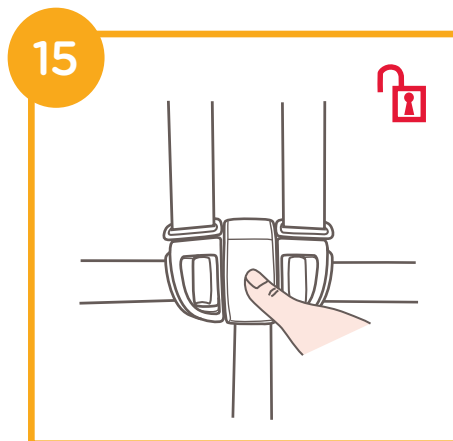
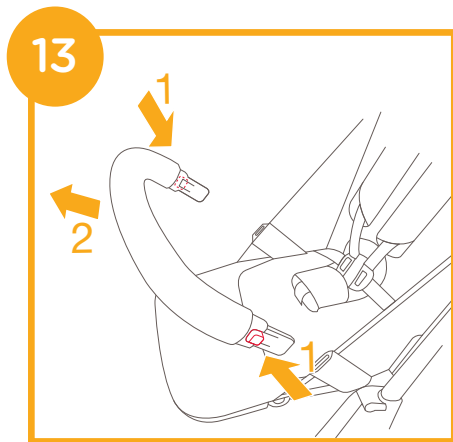

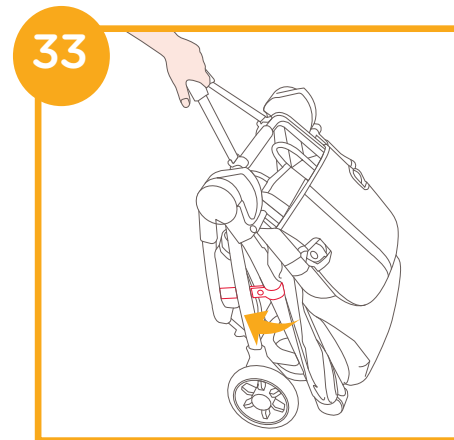
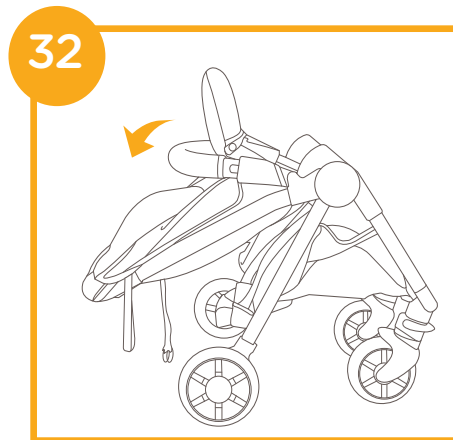
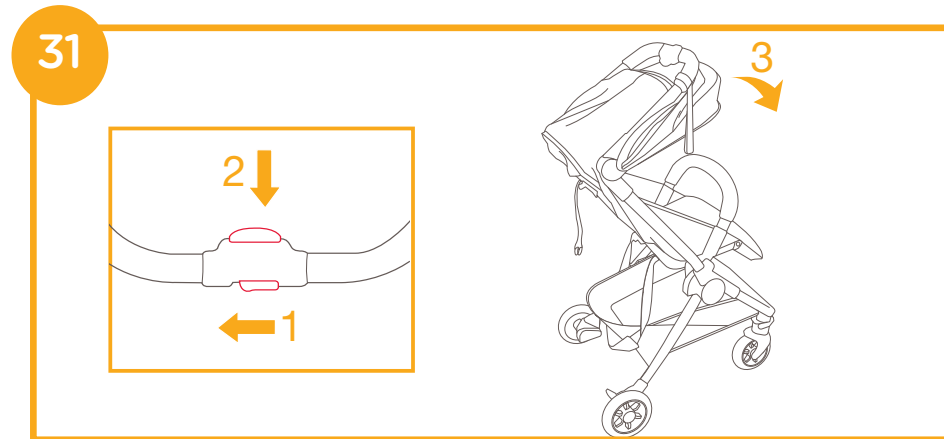
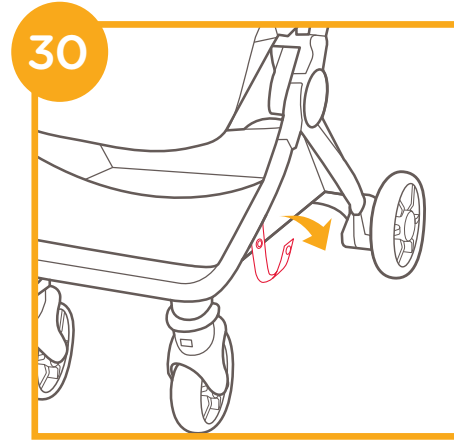
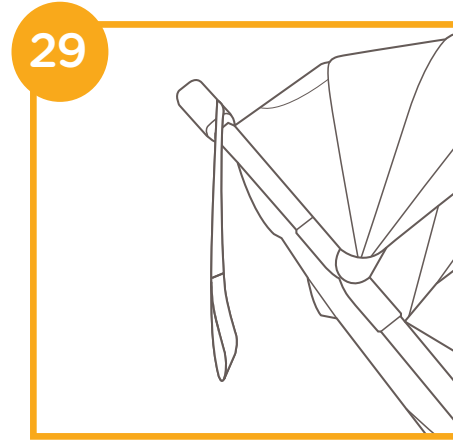
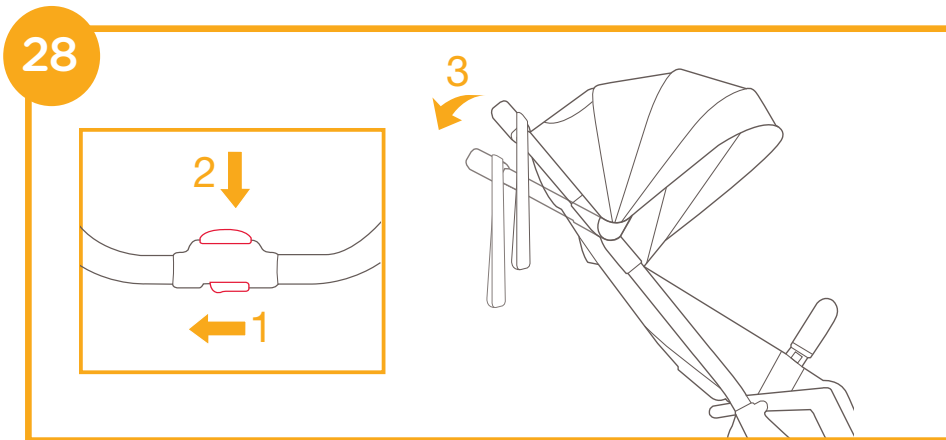
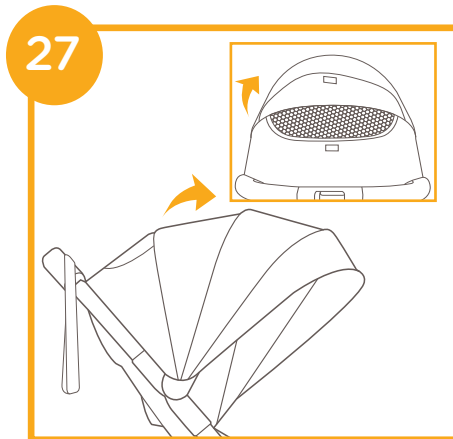
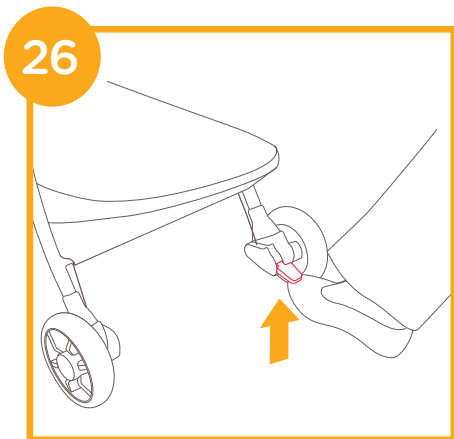
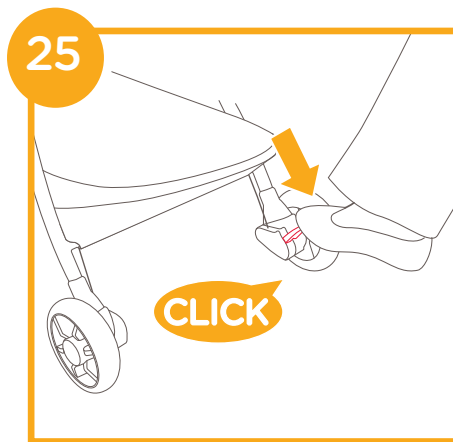
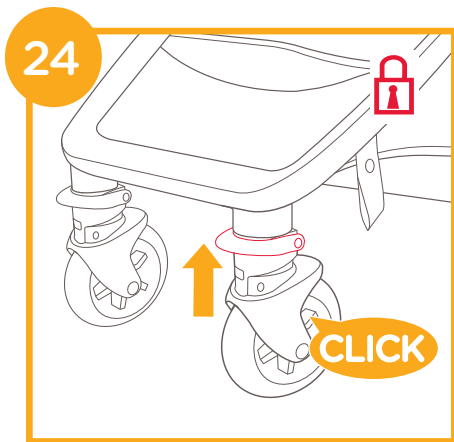

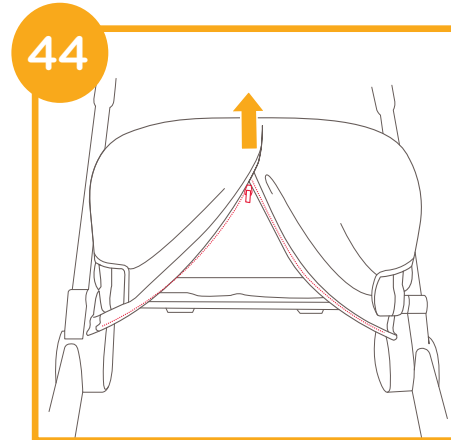
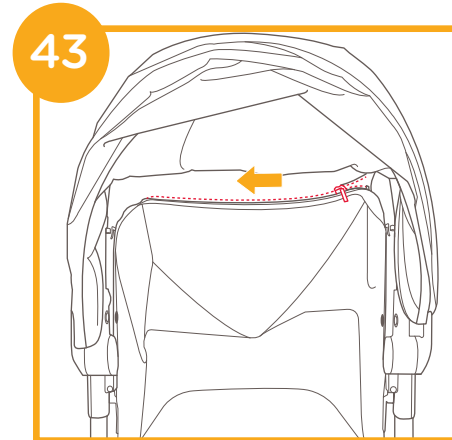
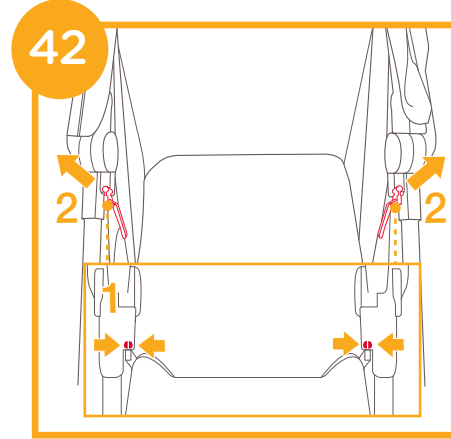
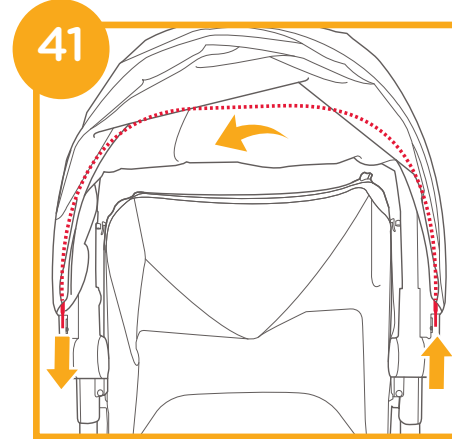
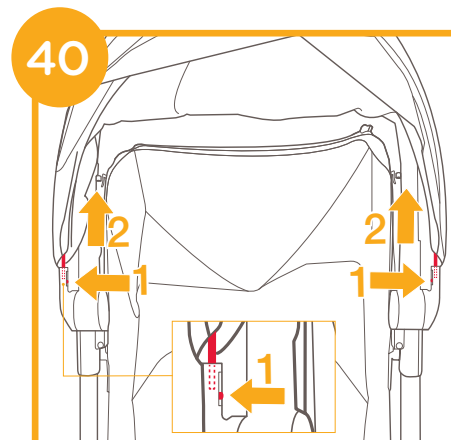
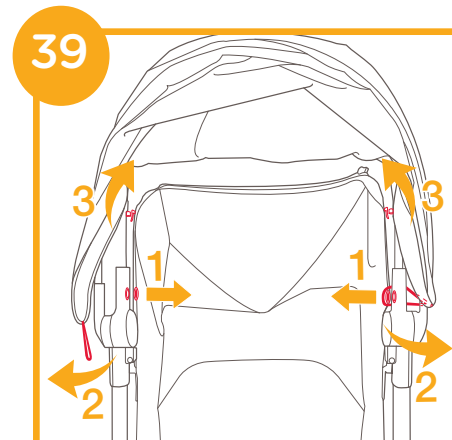
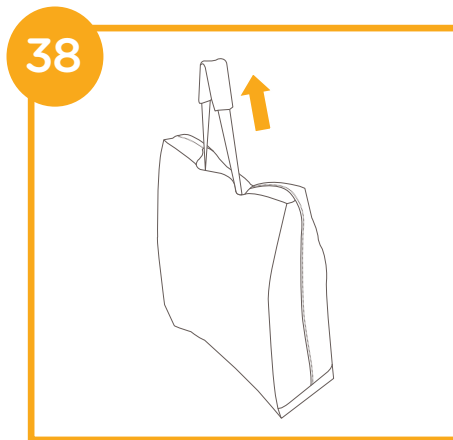
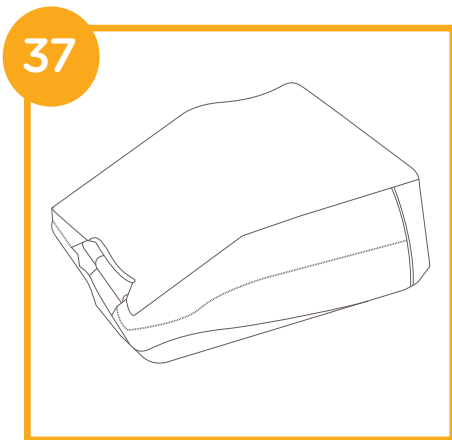
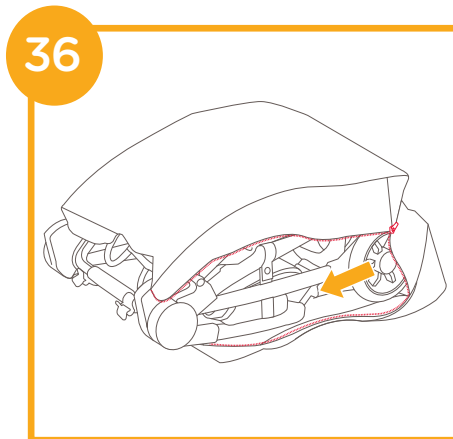
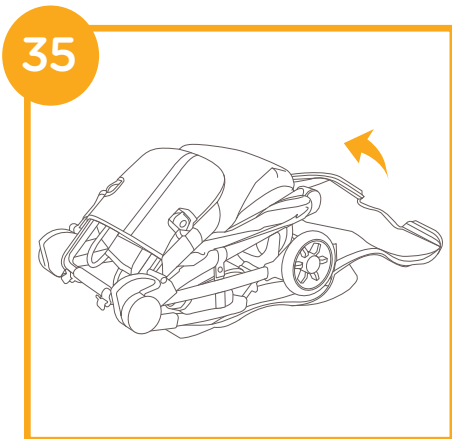
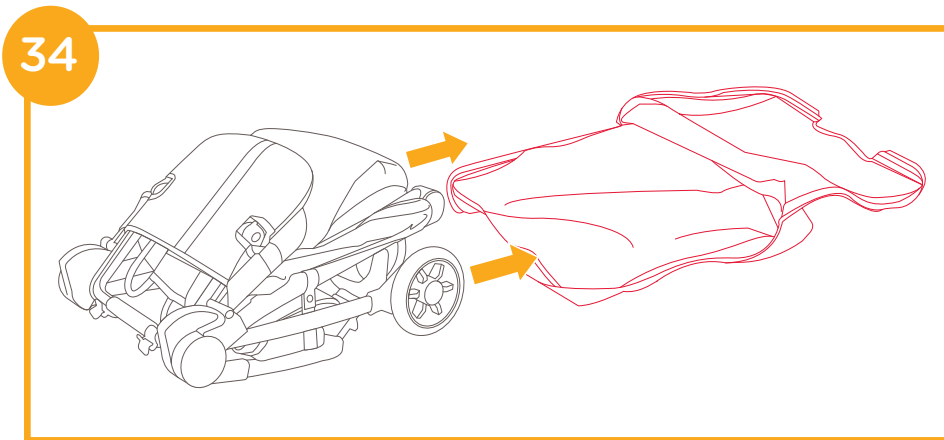

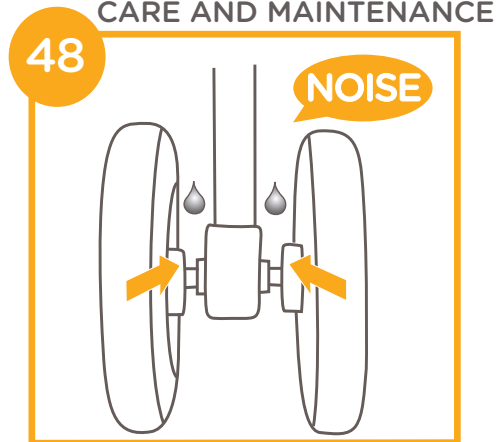
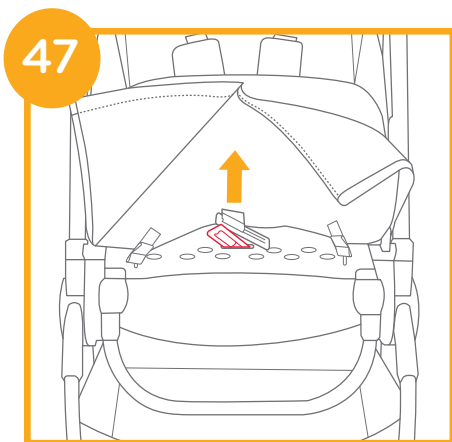
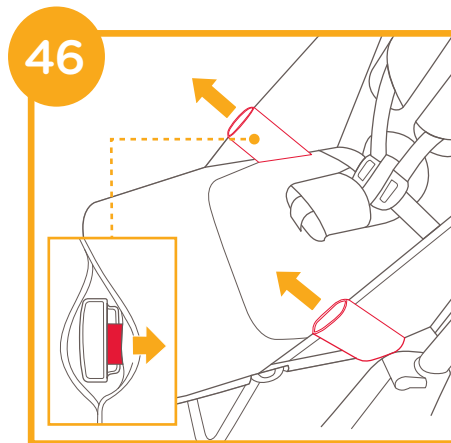
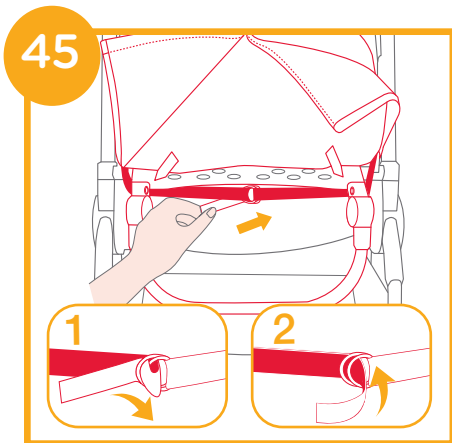

NOTE

## Welcome to Joie™

Congratulations on becoming part of the Joie family! We are so excited to be part of your journey with your little one. While traveling with the Bright by Joie Wandī™, you are using a high quality, fully certified stroller, complies with Australian Trade Practices Act 1974 Consumer Protection Notice No 8 of 2007. This product is suitable for use with children weighing under 15kg. Please carefully read this manual and follow each step to ensure a comfortable ride and best protection for your child.

**IMPORTANT - READ CAREFULLY AND KEEP FOR FUTURE REFERENCE.**

Visit us at [joiebaby.com](http://joiebaby.com) to download manuals and see more exciting Joie products!

## Emergency

In case of emergency or accident, it is most important to have your child taken care of with first aid and medical treatment immediately.

## Product Information

Read all the instructions in this manual before using this product. If you have any further questions, please consult the retailer. Some features may vary depending on model.

Product	Wandi Stroller
Suitable for	Child weighing under 15kg (birth - 36 months)
Materials	Plastics, metal, fabrics
Patent No.	Patents pending
Made in	China
Brand Name	Bright by Joie
Website	<a href="http://www.joiebaby.com">www.joiebaby.com</a>
Distributor	Allison AU Pty Ltd

## Parts List

Make sure all parts are available before assembly. If any part is missing, please contact local retailer. No tools are required for assembly.

- |                    |                         |                      |
|--------------------|-------------------------|----------------------|
| 1 Stroller Frame   | 8 Swivel Lock           | 13 Tether Strap      |
| 2 Front Wheel      | 9 Storage Latch         | 14 Backrest Adjuster |
| 3 Rear Wheel       | 10 Buckle               | 15 Carry Strap       |
| 4 Armbar           | 11 Secondary Lock       | 16 Storage Basket    |
| 5 Canopy           | 12 One-Hand-Fold Handle | 17 Brake Lever       |
| 6 Shoulder Harness |                         | 18 Carry Bag         |
| 7 Calf Support     |                         |                      |

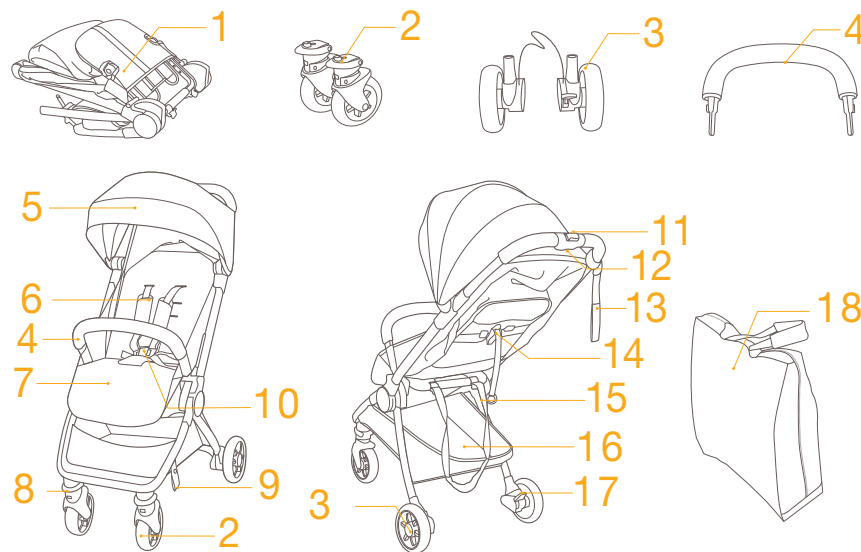



## WARNING

- ! FOLLOW THE MANUFACTURER'S INSTRUCTIONS.
- ! PUT ON ALL THE BRAKES WHENEVER YOU PARK THE STROLLER.
- ! DO NOT LEAVE CHILDREN UNATTENDED.
- ! DO NOT CARRY EXTRA CHILDREN OR BAGS ON THIS STROLLER.
- ! MAKE SURE CHILDREN ARE CLEAR OF ANY MOVING PARTS IF YOU ADJUST THE STROLLER, OTHERWISE THEY MAY BE INJURED.
- ! USE THIS HARNESS AT ALL TIMES.
- ! TO AVOID INJURY OR DEATH: ALWAYS APPLY THE BRAKES WHENEVER THE STROLLER IS STATIONARY.
- ! ALWAYS KEEP CHILD IN VIEW WHILE IN STROLLER.
- ! ALWAYS USE THE CROTCH COMBINATION WITH THE WAIST BELT AND THE SHOULDER HARNESSES.
- ! TO AVOID SERIOUS INJURY FROM FALLING OR SLIDING OUT, ALWAYS USE SEAT BELT.
- ! USE THIS STRAP TO STOP THE STROLLER ROLLING AWAY.
- ! ENSURE THAT ALL THE LOCKING DEVICES ARE ENGAGED BEFORE USE.
- ! DO NOT LET YOUR CHILD PLAY WITH THIS PRODUCT.
- ! NEVER LEAVE THE HARNESS BUCKLED WHEN NOT FITTED TO A CHILD IN THE STROLLER BECAUSE THE HARNESS CAN FORM LOOPS WHICH MAY POSE A STRANGULATION HAZARD.
- ! THE USE OF ACCESSORIES NOT APPROVED BY THE VEHICLE MANUFACTURER IS UNSAFE.
- ! ADULT ASSEMBLY REQUIRED.
- ! USE THE STROLLER WITH A CHILD WEIGHING LESS THAN 15KG. OVERLOADING THE STROLLER CAN BE UNSAFE AND MAY DAMAGE THE STROLLER.

- ! TO PREVENT A HAZARDOUS, UNSTABLE CONDITION, DO NOT PLACE MORE THAN 4.5KG IN THE STORAGE BASKET.
- ! THE STROLLER IS NOT BE USED NEAR AN OPEN FIRE OR EXPOSED FLAME.
- ! USE THE STROLLER WITH ONLY ONE CHILD AT A TIME. NEVER PLACE PURSES, SHOPPING BAGS, PARCELS OR ACCESSORY ITEMS ON THE HANDLE OR HOOD.
- ! OVERLOADING, FOLDING INCORRECTLY, OR USING COMPONENT PARTS FROM OTHER MANUFACTURERS MAY CAUSE THE STROLLER TO BE DAMAGED, BROKEN OR UNSAFE.
- ! PLEASE READ ALL THE INSTRUCTIONS IN THE MANUAL BEFORE USING THE PRODUCT. PLEASE SAVE INSTRUCTION MANUAL FOR FUTURE USE. FAILURE TO FOLLOW THESE WARNINGS AND INSTRUCTIONS MAY RESULT IN SERIOUS INJURY OR DEATH.
- ! CHILD MAY SLIP INTO LEG OPENINGS AND BE STRANGLED IF THE HARNESS IS NOT USED.
- ! CARE SHOULD BE TAKEN IF THE STROLLER IS USED ON STAIRS OR ESCALATORS.
- ! KEEP AWAY FROM HIGH TEMPERATURE OBJECTS, LIQUIDS, AND ELECTRONICS.
- ! NEVER ALLOW YOUR CHILD TO STAND ON THE STROLLER OR SIT IN THE STROLLER WITH HEAD TOWARD FRONT OF STROLLER.
- ! WARNING TO AVOID SERIOUS INJURY, MAKE SURE THE CANOPY IS ASSEMBLED WHEN BACKREST IS IN THE MOST RECLINED POSITION.

- ! NEVER PLACE THE STROLLER ON ROADS, SLOPES OR DANGEROUS AREAS.
- ! DO MAKE SURE ALL MECHANISMS ARE FIXED BEFORE USING THE STROLLER.
- ! TO AVOID STRANGULATION, DO NOT PLACE ITEMS WITH A STRING AROUND YOUR CHILD'S NECK, SUSPEND STRINGS FROM THIS PRODUCT, OR ATTACH STRINGS TO TOYS.
- ! DO NOT LIFT STROLLER WHILE CHILD IS IN STROLLER.
- ! DO NOT USE STORAGE BASKET AS A CHILD CARRIER.
- ! TO PREVENT TIPPING, NEVER LET CHILD CLIMB THE STROLLER. ALWAYS LIFT THE CHILD IN AND OUT OF THE STROLLER.
- ! TO AVOID FINGER ENTRAPMENT, USE CARE WHEN FOLDING AND UNFOLDING THE STROLLER.
- ! PLEASE KEEP THE STORAGE LATCH LOCKING CORRECTLY WHEN LIFT AND MOVE THE UNIT. PLEASE TRANSPORT THE FOLDED STROLLER SAFELY.
- ! TO ENSURE YOUR CHILD'S SAFETY, PLEASE MAKE SURE ALL PARTS ARE ASSEMBLED AND FASTENED PROPERLY BEFORE USING THE STROLLER.
- ! TO AVOID STRANGULATION, DO MAKE SURE YOUR CHILD IS CLEAR FROM THE CANOPY.
- ! THE VEHICLE IS DESIGNED FOR USE ON FLAT OR GENTLY SLOPING SURFACES AND MAY BE UNSTABLE ON HIGHER SLOPING AND UNEVEN SURFACES; RESULTING IN THE POSSIBILITY OF THE VEHICLE TIPPING OVER.
- ! DISCONTINUE USING STROLLER IF IT IS DAMAGED OR BROKEN.
- ! THIS PRODUCT IS NOT SUITABLE FOR RUNNING OR SKATING. STROLLER TO BE USED ONLY AT WALKING SPEED. THIS PRODUCT IS NOT INTENDED FOR USE WHILE JOGGING.

- ! TO AVOID SUFFOCATION, REMOVE PLASTIC BAG AND PACKAGING MATERIALS BEFORE USING THIS PRODUCT. THE PLASTIC BAG AND PACKAGING MATERIALS SHOULD THEN BE KEPT AWAY FROM BABIES AND CHILDREN.
- ! THIS STROLLER IS SUITABLE FOR USE WITH NEWBORN BABIES WHEN THE BACKREST IS SET TO THE MOST RECLINED POSTION.
- ! THE BRAKES MUST ALWAYS BE APPLIED WHEN THE STROLLER IS NOT MOVING.
- ! EXTRA CARE IS NEEDED IF USED ON MOVING VEHICLES AND CHILD SHOULD NOT BE LEFT UNATTENDED, EVEN WITH BRAKES ENGAGED.
- ! SECURE THE CHILD IN THE HARNESS AT ALL TIMES.
- ! DO NOT ATTACH ITEMS TO THE HANDLE, SEAT BACK OR SIDES OF THE STROLLER. ANY ADDITIONAL LOAD WILL AFFECT THE STABILITY OF THE STROLLER AND COULD CAUSE THE STROLLER TO TIP.
- ! TO AVOID SERIOUS INJURY, MAKE SURE THE CANOPY IS ASSEMBLED WHEN BACKREST IS IN THE MOST RECLINED POSITION.
- ! DO NOT USE FOR UNSUPERVISED SLEEPING.
- ! THE VEHICLE IS NOT TO BE USED AS AN UNSUPERVISED SLEEPING ENVIRONMENT.
- ! THE MAXIMUM RECOMMENDED WEIGHT IN THE CUPHOLDER IS 1LBS (0.5KG).
- ! TO AVOID BURNS, NEVER PUT HOT LIQUIDS IN YOUR CUPHOLDER.

## Stroller Assembly

(Please refer to figures on page 1-11)

Please read all the instructions in this manual before assembling and using this product.

### Open Stroller

see images ① - ④

Open the storage latch first, then open the stroller. ①

! Check that the stroller is completely latched before continuing to use.

### Assemble & Detach Front Wheel

see images ⑤ - ⑥

### Assemble & Detach Rear Wheel

see images ⑦ - ⑩

! The rear wheels can be disassembled by pressing the snap buttons. ⑨

! Wrap the storage basket around frame and brake axle and then snap into place. ⑩

### Assemble & Detach Armbar

see images ⑪ - ⑬

The completely assembled stroller is shown as ⑭

## Stroller Operation

### Use Buckle

see images ⑮ - ⑯

Release Buckle

Press the center button to release the buckle. ⑮

Lock Buckle

Match the waist belt buckle with the shoulder buckle ⑯ - 1, and click into the center buckle. ⑯ - 2 A “click” sound means the buckle is locked completely. ⑯ - 3

! To avoid serious injury from falling or sliding out, always secure your child with harness.

! Make sure your child is snugly secured. The space between the child and the shoulder harness is about the thickness of one hand.

! Do not cross the shoulder belts. This will cause pressure on a child's neck.

### Use Shoulder & Waist Harnesses

see images ⑰ - ⑳

! In order to protect your child from falling out, after your child is placed into the seat, check whether the shoulder and waist harnesses are at proper height and length.

⑰ - 1 Shoulder harness anchor A

⑰ - 2 Shoulder harness anchor B

⑰ - 3 Slide adjuster

For larger child, use shoulder harness anchor A and the highest shoulder slots. For smaller child, use shoulder harness anchor B and the lowest shoulder slots.

To adjust the position of the shoulder harness anchor, turn the anchor to be level with the side facing forward. Thread it through the shoulder harness slot from back to front ⑰. Rethread it through the slot that is closest to child's shoulder height. ⑰

Use slide adjuster to change the harness length. 17 - 1

Press the button 17 - 2, while pulling the waist harness to proper length. 17 - 3

## Adjust Backrest

see images 21 - 22

Recline Backrest

Pull the backrest backwards, while pressing the button in the center of the angle adjuster. 21

Raise Backrest

Push the backrest forwards, while pulling the webbing at the end of the angle adjuster. 22

! For newborn babies use the most reclined position, until they are able to sit upright unassisted.

## Adjust Calf Support

see images 23

The calf support has 2 positions.

Raise Calf Support

To raise the calf support, just push it upwards.

Lower Calf Support

Press the adjustment buttons on both sides of the calf support 23 - 1, and rotate the calf support downwards. 23 - 2

## Use Front Swivel Lock

see images 24

Push up the front swivel locks to maintain the moving direction. 24

**Tip** It is recommended to use swivel locks on uneven surfaces.

## Use Brake

see images 25 - 26

To lock wheels, step the brake lever downwards. 25

To release wheels, just lift the brake lever upwards. 26

**Tip** Always set the parking brake when stroller is not moving.

## Use Canopy

see images 27

The canopy can be opened or folded, pull it toward front or back. 27

## Use Shoulder Harness Cover and Crotch Harness Cover

The shoulder harness cover or crotch harness cover can be removed from the webbing. To assemble shoulder harness cover and crotch harness cover in reverse steps.

## Adjust Handle

see images 28

! Handle can be adjusted to 2 positions.

## Use Tether Strap

see images 29

Use the tether strap to prevent the stroller inadvertently rolling away. Check that when your hand is through the loop, it allows you to easily control the stroller.

## Fold Stroller

see images 30 - 38

! Please fold the canopy before folding the stroller.

Open the storage latch. 30

Push secondary lock 31 - 1 and squeeze one-hand-fold button 31 - 2. Push the stroller forward to fold.

Wrap the storage latch across the front leg and bottom handle, then lock the buckle. 33

! You can lift the strap to transport the unit safely after folding the stroller. 33

! The carry strap is usable and accessible. 38

## Detach Soft Goods

see images 39 - 47

1. Follow steps 39 - 47 to detach soft goods.

! Please keep the canopy wire well after removing it, and must assemble the canopy wire while assembling the canopy.

2. To re-attach the soft goods please repeat the above steps in the reverse step.

## Care and Maintenance

see images 48

! Removable seat pad may be washed in cold water and drip-dried. No bleach. Please refer to the care label for instructions on cleaning the fabric parts of the stroller.

! To clean stroller frame, use only household soap and warm water. No bleach or detergent. Periodically wipe clean plastic parts with a soft damp cloth. Always dry the metal parts to prevent the formation of rust if the stroller has come into contact with water.

! From time to time, check your stroller for loose screws, worn parts, torn material or stitching. Replace or repair the parts as needed.

! Excessive exposure to sun or heat could cause fading or warping of parts.

! If stroller becomes wet, open hood and allow to dry thoroughly before storing.

! If wheels squeak, use a light oil (e.g., Silicon Spray, antirust oil, or sewing machine oil). It is important to get the oil into the axle and wheel assembly. 48

! When using your stroller at the beach, completely clean your stroller after use to remove sand and salt from mechanisms and wheel assemblies.





**Distributed by Allison AU Pty Ltd**

**ACN: 642 240 140**

**Unit 1, 35 Lyn Parade**

**Prestons**

**NSW Australia 2170**

**For after-sales & warranty service, contact:**

**1800 951 070**

**[customerservice@allisonau.com.au](mailto:customerservice@allisonau.com.au)**