

**Joie™**

1-36 MONTHS/UP TO 15KG

# sma baggi™ 4WD

stroller

## Instruction Manual

Read these instructions carefully before use and keep them for future reference. Your child's safety may be affected if you do not follow these instructions.



**READ MANUAL CAREFULLY BEFORE USING  
AND KEEP FOR FUTURE REFERENCE.**

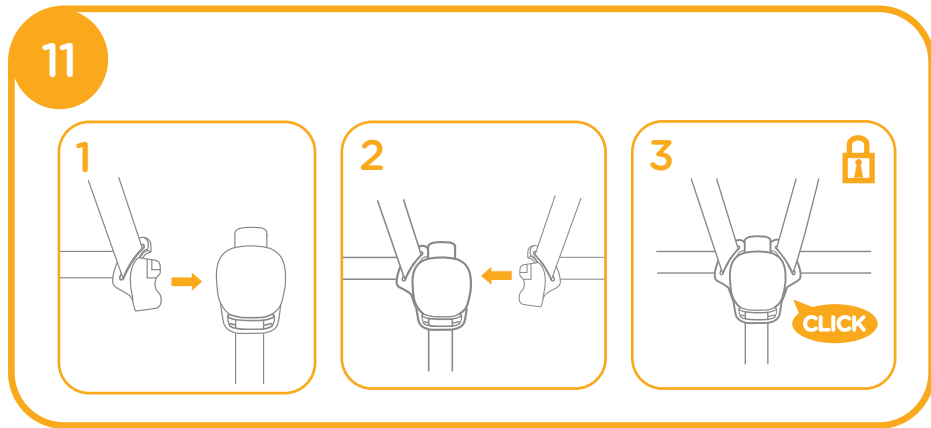
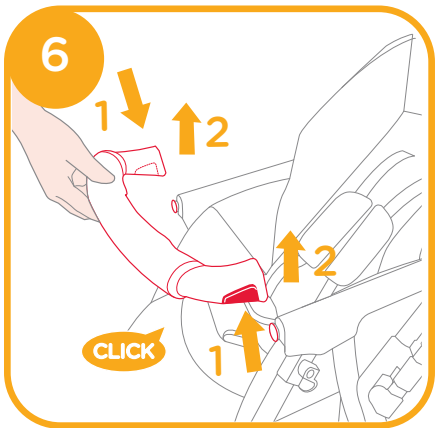
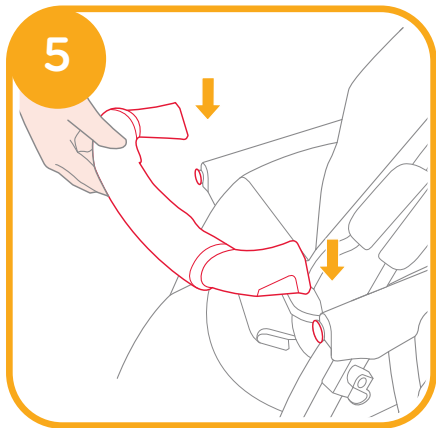
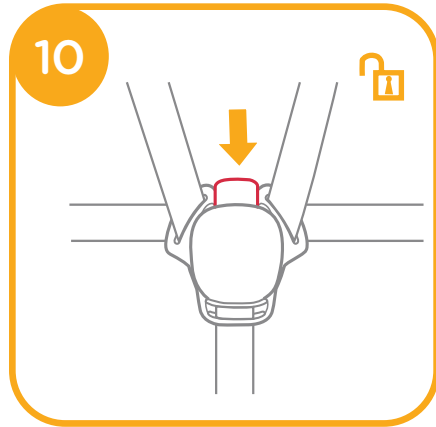
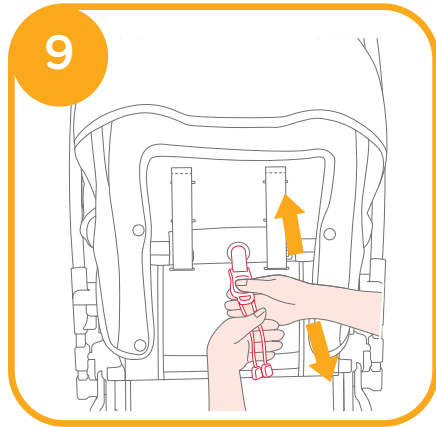
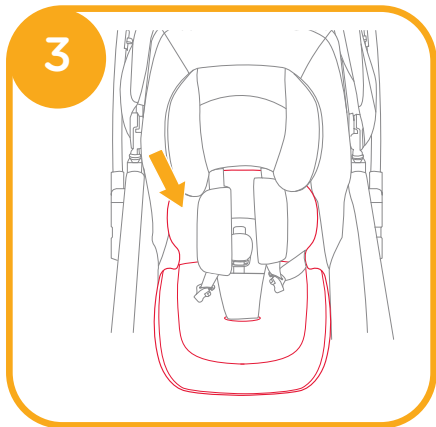
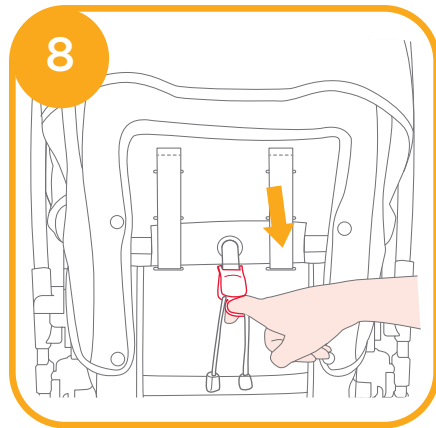
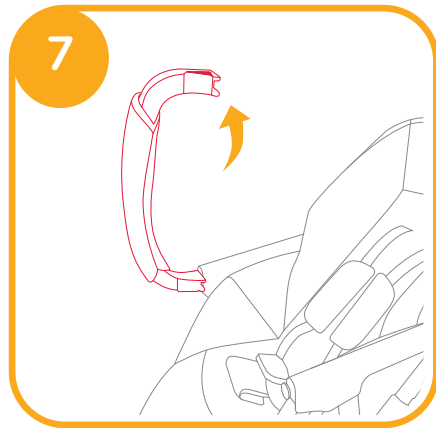
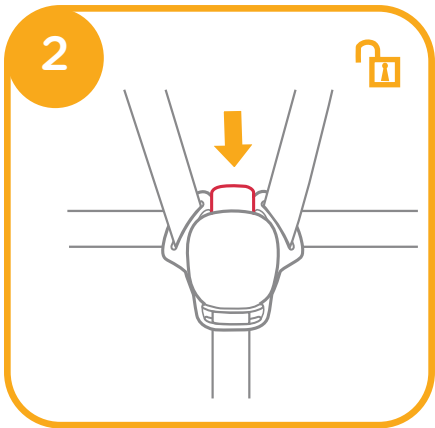
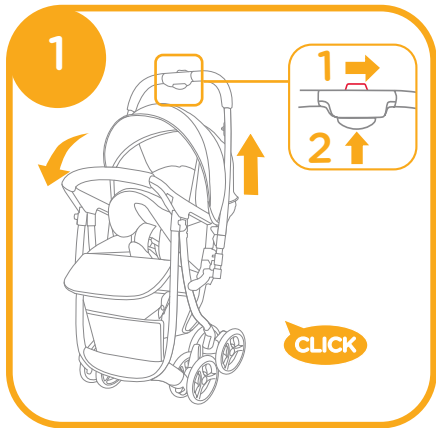

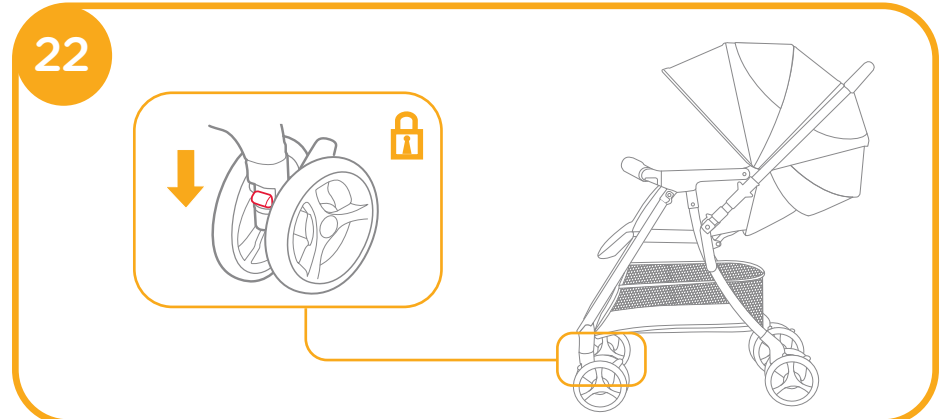
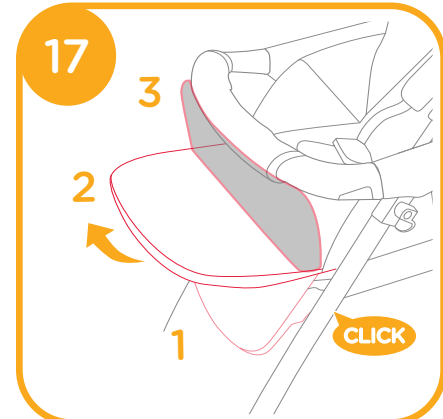
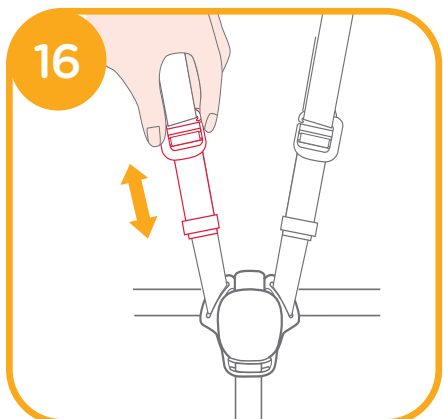
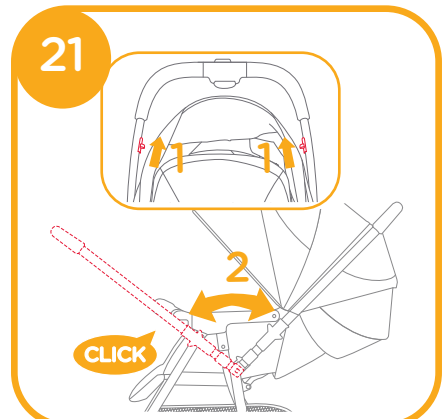
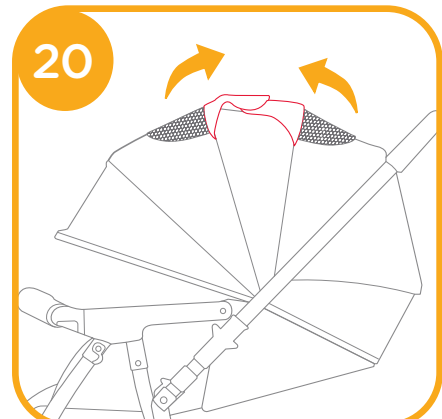
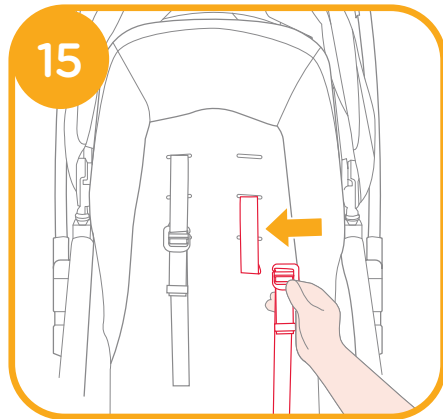
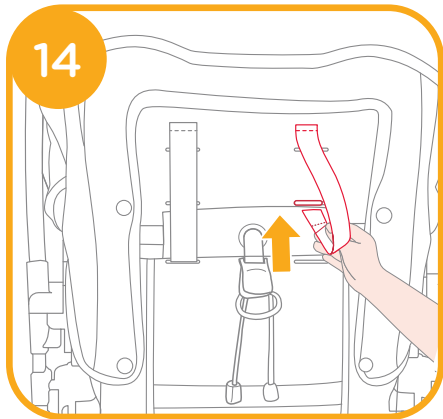
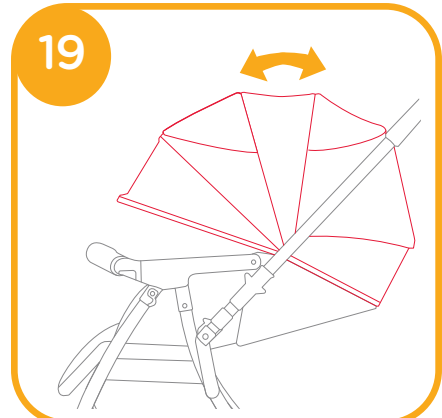
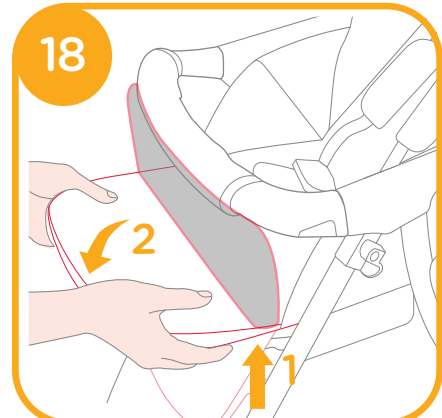
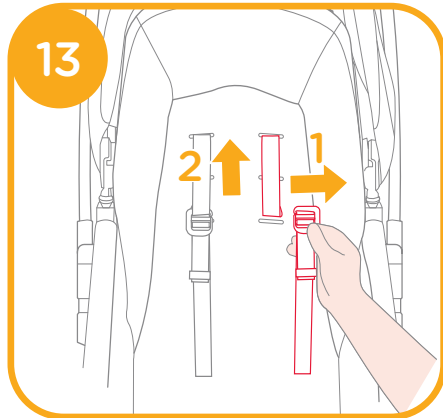
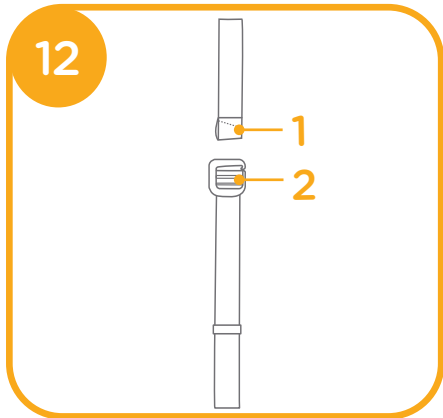

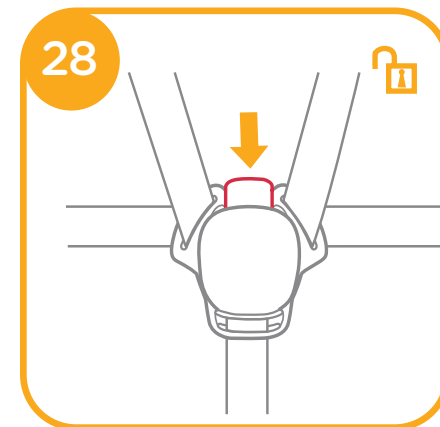
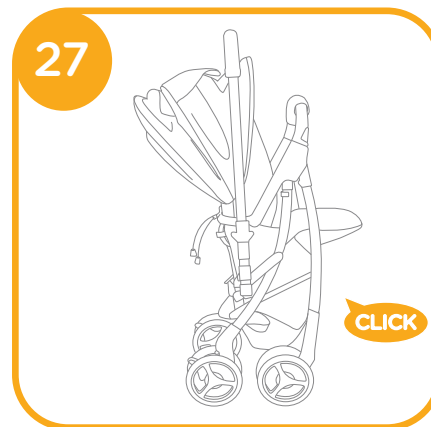
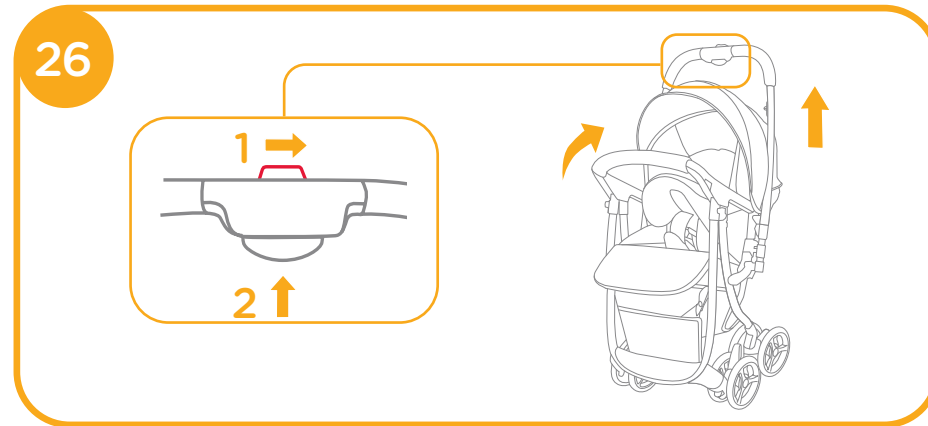
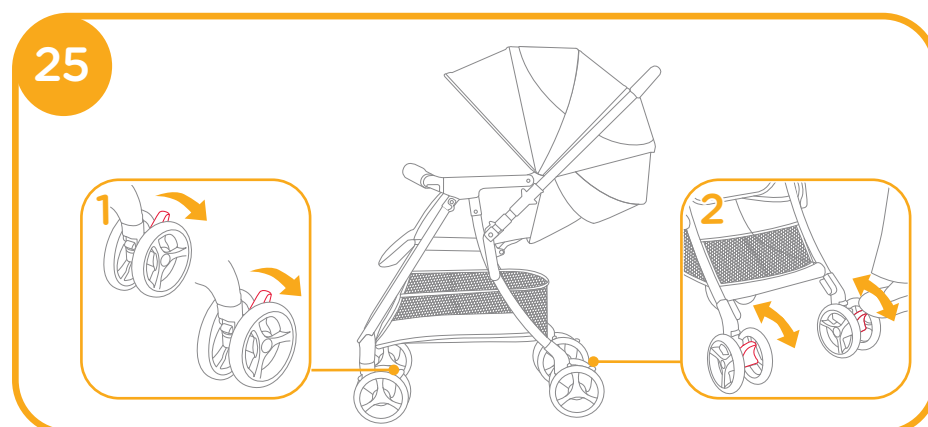
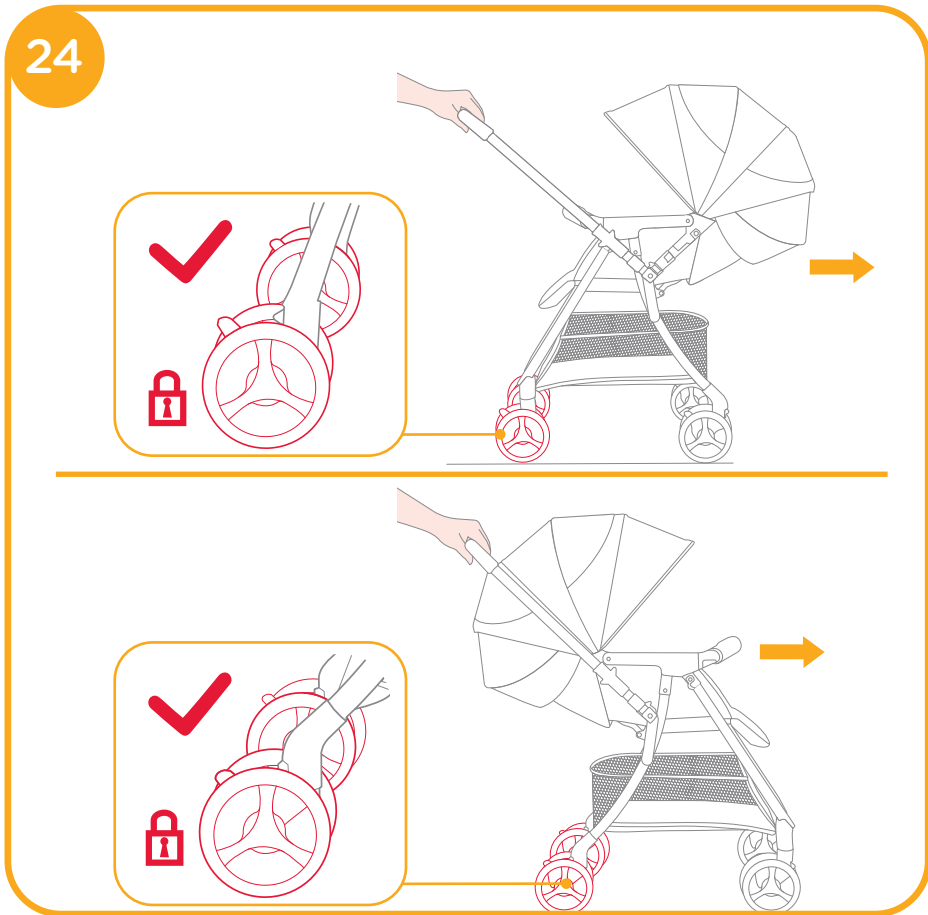
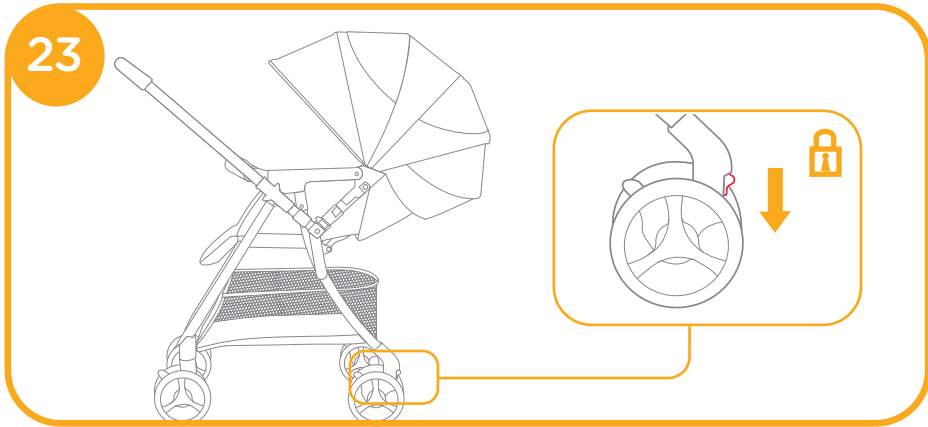

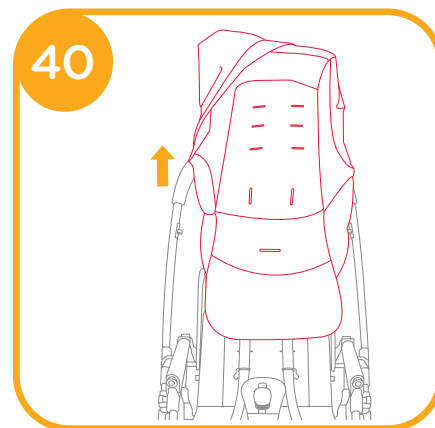
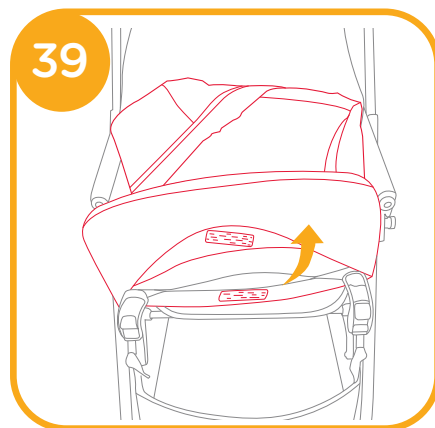
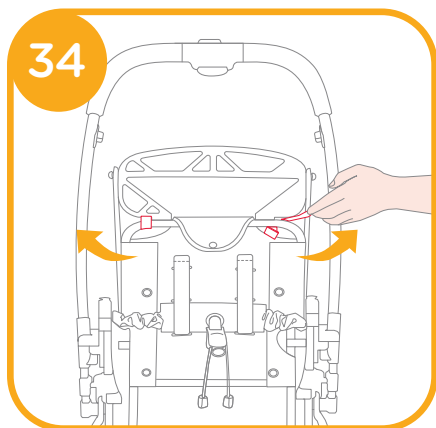
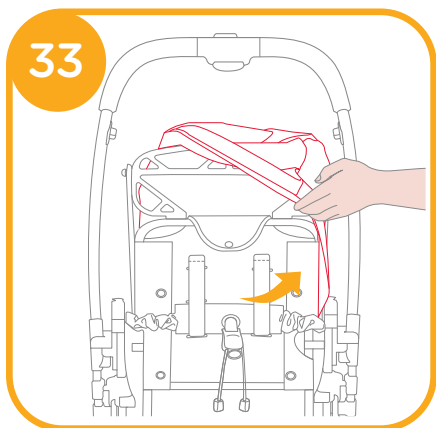
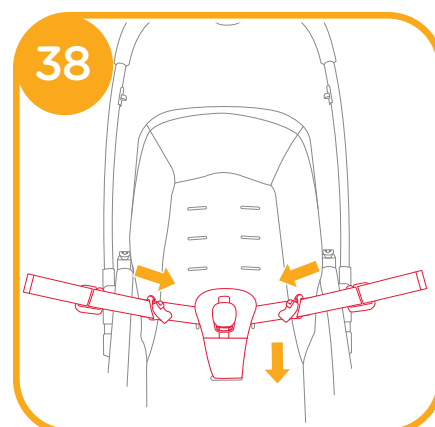
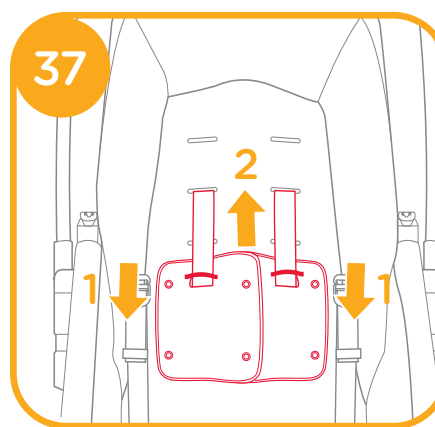
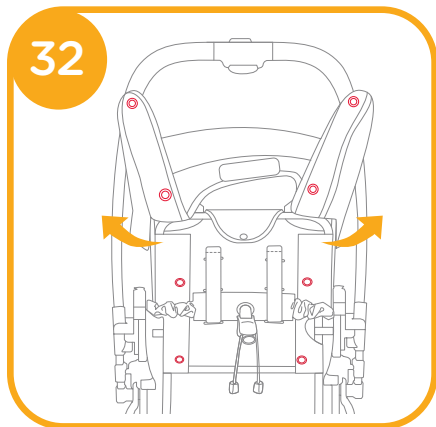
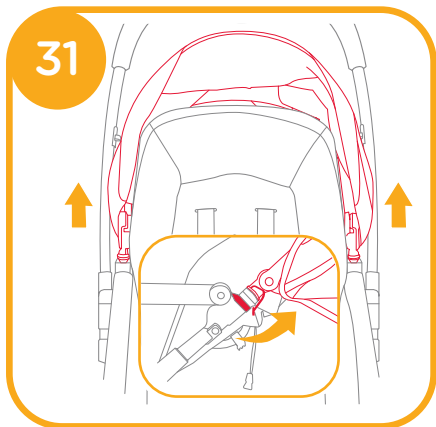
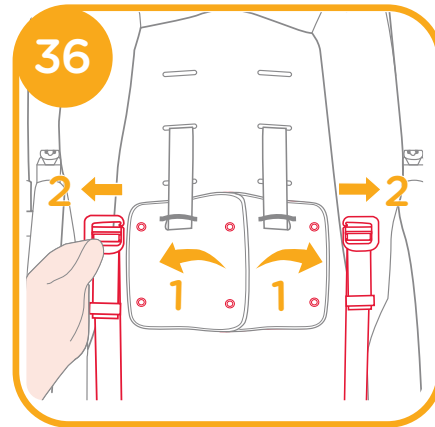
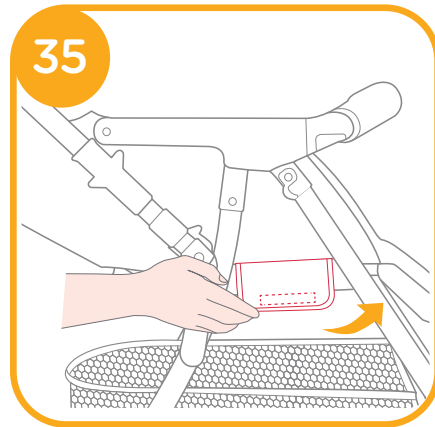
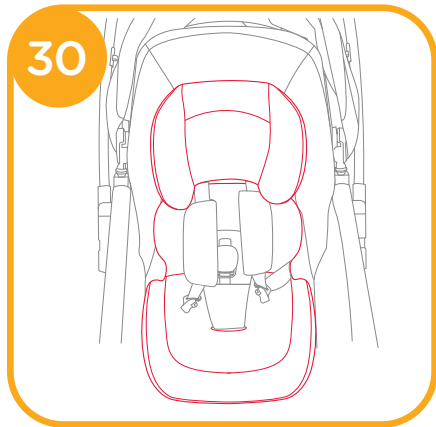
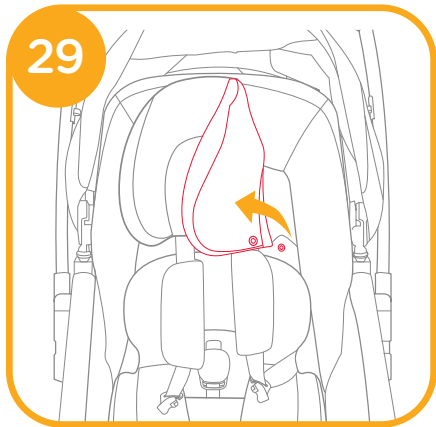

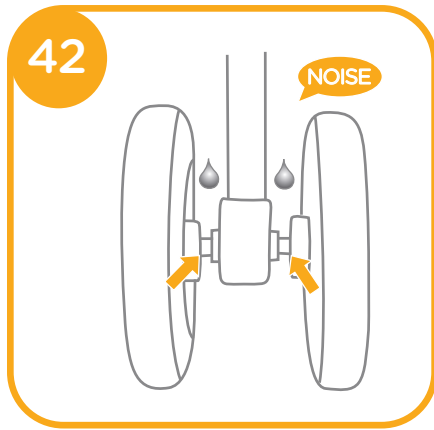

Congratulations on becoming part of the Joie family! We are so excited to be part of your journey with your little one. This stroller is suitable for a new born from 1 months to 36 months old weights below 15kg. Please carefully read this manual and follow each step to ensure a comfortable ride and best protection for your child.

Visit us at [joiebaby.com](http://joiebaby.com) to download manuals and see more exciting Joie products!

For warranty information, please visit our website at [joiebaby.com](http://joiebaby.com)

## Contents

Figures	1-9
Emergency	11
Product Information	12
Parts List	12
Accessories	12
WARNING	13
<b>Stroller Assembly</b>	<b>15</b>
Open Stroller	15
Assemble Infant Insert	15
<b>Stroller Operation</b>	<b>15</b>
Use Armbar	15
Adjust Backrest	15
Use Buckle	15
Use Shoulder & Waist Harnesses	15
Adjust Calf Support	16
Use Canopy	16
Switch Handle Direction	16
Use Front Swivel Lock	16
Use Brake	16
Fold Stroller	16
Use Accessory	17
<b>Care and Maintenance</b>	<b>17</b>
About disposal	18
About After sales service	18
Precautions for Reparation	18

## Emergency

In case of emergency or accident, it is most important to have your child taken care of with first aid and medical treatment immediately.

## Product Information

Read all the instructions in this manual before using this product. If you have any further questions, please consult the retailer. Some features may vary depending on model.

Product	XXXX™
Type	A
Suitable for	1-36 MONTHS/UP TO 15KG
Materials	Plastics, metal, fabrics
Patent No.	Patents pending
Made in	China
Brand Name	Joie
Website	<a href="http://www.joiebaby.com">www.joiebaby.com</a>
Manufacturer	Allison GmbH

## Parts List

Make sure all parts are available before assembly. If any part is missing, please contact local retailer. No tools are required for assembly.

1 Secondary Lock	5 Shoulder Harness Cover	9 Front Swivel Lock	14 Handle
2 One-Hand-Fold Handle	6 Armbar	10 Front Wheel	15 Storage Basket
3 Canopy	7 Calf Support	11 Rear Wheel	16 Rear Brake Lever
4 Head Support	8 Footrest	12 Buckle	17 Front Brake Lever
		13 Reversible Slider	

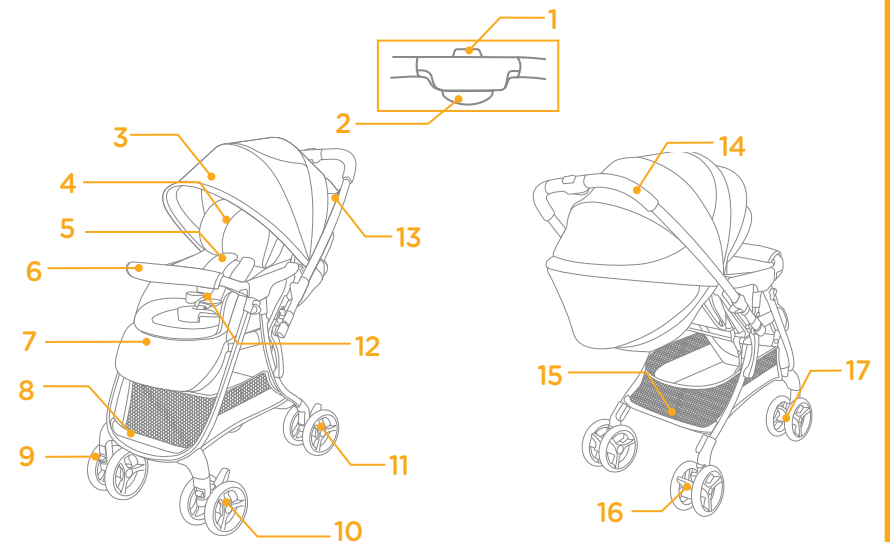

## Accessories

(May not be included)

- 1 Shoulder Harness Cover
- 2 Infant Insert
- 3 Head Support
- 4 Rain Cover
- 5 Armbar Cover

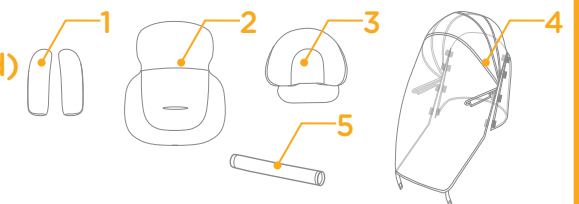

Accessories may be sold separately or may not be available depending on region.

## WARNING

- ! Adult assembly required.
- ! This stroller is suitable for a new born from 1 month to 36 months old weights below 15kg. It will cause damage to the stroller with an unfitted child.
- ! Do not recommended uses continuously for more than 2 hours in recline position.
- ! When the baby was born seven months later use this stroller, the continuous use of the best in one hour or less.
- ! Always use the crotch combination with the waist belt. It is suggested that the shoulder harnesses be used as well. Please lock the buckle on the harness before using.
- ! Although the seat belt fastened, sometimes the baby will still stand up, please be careful.
- ! Please adjust shoulder strap according infants physique, there is the risk of neck entangled if shoulder strap left too long (drooping state).
- ! To prevent a hazardous, unstable condition, do not place more than 4.5kg in the storage basket.
- ! Never leave child unattended. Always keep child in view while in stroller.
- ! Use the stroller with only one child at a time, and prohibit the child seating on the area out the seat. Never place purses, shopping bags, parcels or accessory items on the handle or canopy.
- ! Overload, fold incorrectly or use it along with component parts from other manufacturers may cause the stroller to be damaged, broken or unsafe. Do read the instruction manual carefully.
- ! Please read all the instructions in this manual before using the product, Please save instruction manual for future use. Failure to follow these warnings and instructions may result in serious injury or death.
- ! Safety belts and restraint system must be used correctly.
- ! Make sure your child's body is clear from the moving parts when adjusting the stroller.
- ! Child may slip into leg openings and be strangled.
- ! Never use stroller on stairs or escalators.
- ! Keep away from fire source, high temperature objects, liquids, and electronics.
- ! Never allow your child stand on the stroller or sit in the stroller with head toward front of stroller.

- ! Never place the stroller on roads, slopes or dangerous area. Never place the stroller with baby in it on roads. Do not leave the stroller aside even when it is empty.
- ! Do make sure all mechanisms are fixed before using the stroller.
- ! Avoid strangulation, do not place items with a string around your child's neck, suspend strings from this product, or attach strings to toys.
- ! To prevent tipping, do not put anything on the handle, back of the backrest or side of the stroller, which can cause unit to tip rearward easily.
- ! Do not lift stroller whilst child is in it as tumble would happen if stroller is unbalance or unable to see the road clearly.
- ! Do not use storage basket as a child carrier.
- ! To prevent tipping, never let child climb the stroller.
- ! To avoid finger entrapment ensure that your child is kept away when unfolding and folding this product.
- ! Be sure the stroller is fully opened or folded before allowing child near the stroller.
- ! To ensure your child's safety, please make sure all parts are assembled and fastened properly before using the stroller.
- ! Avoid strangulation, do make sure your child is clear from the canopy.
- ! Always engage the brakes when parking the stroller.
- ! If the stroller parts, structural elements appear loose and crunching sound, or lack of parts, not smooth for wheels running and other abnormal condition, please do not use, be sure to promptly contact the distributor for repair and negotiation.
- ! This product is not suitable for running or skating. It is intended to be used only at walking speed.
- ! To avoid suffocation, remove plastic bag and packaging materials before using this product. The plastic bag and packaging materials should then be destroyed or kept away from babies and children.
- ! Do not let your child play with this product.
- ! The parking device should be engaged when placing and removing your child.
- ! Do not over rely on the stoppers after the child is sat, Subject to the road condition, the stroller may be not stopped even the stoppers are engaged.
- ! Pay attention to not getting caught in the door when getting on and off the streetcar.

## Stroller Assembly (Please refer to figures on page 1-9)

Please read all the instructions in this manual before assembling and using this product.

### Open Stroller

Push secondary lock **1** -1 and squeeze one-hand-fold handle. **1** -2 Meanwhile, pull the stroller backward to open. Latches should click into place.

! Check that the stroller is completely open before continuing.

### Assemble Infant Insert

Press the center button to release the buckle. **2**

The completely assembled stroller is shown as **4**

## Stroller Operation

### Use Armbar

Press armbar release button **6** -1, and then pull up the armbar. **6** -2

Armbar can be pulled up on both left and right sides for easy seating and unseating of child. **7**

### Adjust Backrest

#### Recline Backrest

Pull tab to recline backrest. **8**

! Hold the backrest with the other hand if a child is already seated in the stroller.

#### Raise Backrest

Hold both left and right strings and push up the angle adjuster to raise backrest. **9**

! Before adjusting the backrest to the upright position, to ensure the detachable seat liner will not be caught into the stroller frame please fold in both sides of the seat liner.

! Make sure the backrest angle is set properly for use.

### Use Buckle

#### Release Buckle

Press the center button to release the buckle. **10**

#### Lock Buckle

Align the shoulder belt buckle with the center buckle, the buckle can lock automatically. **11** -1 **11** -2. A click sound means the buckle is locked completely. **11** -3

! To avoid serious injury from falling or sliding out, always secure your child with harness.

! Make sure your child is snugly secured, the space between the child and the shoulder harness is about the thickness of one hand.

! Do not cross the shoulder belts. This will cause pressure on child's neck.

### Use Shoulder & Waist Harnesses

! In order to protect your child from falling out, after your child is placed into the seat, check whether the shoulder and waist harnesses are at proper height and length.

**12** -1 Shoulder harness anchor

**12** -2 Slide adjuster

For larger child, use shoulder harness anchor and the highest shoulder slots.

For smaller child, use shoulder harness anchor and the lowest shoulder slots.

To adjust the position of the shoulder harness, thread the slide adjuster out from shoulder harness anchor. **13** Rethread shoulder harness anchor through the slot that is closest to child's shoulder height from the back of backrest **14**, then thread the slide adjuster into shoulder harness anchor. **15** Use the same steps to adjust the other side.

Use slide adjuster to change the harness length. **16**

### Adjust Calf Support

There are three angles for adjustment.

To raise calf support, push the calf support from position 1 to position 3. **17**

To lower calf support, press the adjustment buttons on both sides of the calf support **18** -1, and rotate the calf support downwards. **18** -2

### Use Canopy

To open the canopy, pull canopy toward front, to fold the canopy, pull canopy toward back. **19**

Through the window on the canopy, you can view your baby. **20**

### Switch Handle Direction

! Make sure child's hands and legs are clear from the armrest when switching the handle. **21**

! Front swiveling wheels or rear swiveling wheels can be locked automatically when you use the handle in rear facing position or front facing position.

### Use Front Swivel Lock

Press the front swivel locks to maintain the moving direction. **22** **23**

! It is recommended to use swivel lock on uneven surfaces.

! After switching the handle position, push the stroller forward to ensure that the wheels nearest to you are locked and do not swivel. **24**

### Use Brake

To lock wheels, step on the brake lever. Front wheel is shown as **25** -1, rear wheel is shown as **25** -2

Lift the brake lever to release wheel.

! The brake must be engaged when placing and removing children.

! Always apply brake when stroller is in stopped position.

! To ensure brake is fully on, gently rock the stroller backwards and forwards before releasing the handle.

! **WARNING** To prevent potential hazard, always make sure the parking device for all swiveling wheels are engaged when you reverse the handle.

### Fold Stroller

Please fold the canopy before folding the stroller. **19**

Push secondary lock **26** -1 and squeeze one-hand-fold handle **26** -2. Push the stroller forward to fold. A click sound means the stroller is folded completely. **27**

## Use Accessory

Accessories may be sold separately or may not be available depending on region.

### Use Shoulder Harness Cover

The shoulder harness cover can be removed from the webbing. Simply reverse these steps to re-assemble shoulder harness cover.

### Use Armbar Cover

The armbar cover can be removed from the armbar. Simply reverse these steps to re-assemble armbar cover.

### Use Head Support & Infant Insert

The head support can be removed by opening the buttons on both sides, 29  
the infant insert can be removed by unfastening the buckle. 30

### Detach & Assemble Soft Goods

See images 31 - 40

To re-assemble seat soft goods, follow the steps above in reverse. 40 - 31

### Use Rain Cover

To assemble the rain cover, place it over the stroller, and then attach the hook and loop fasteners on the rain cover. 41

! When using the rain cover, please always check its ventilation.

! When not in use, please check that the rain cover has been cleaned and dried before folding.

! Do not fold the stroller after assembling the rain cover.

! Do not place your child into the stroller assembled with rain cover during hot weather.

## Care and Maintenance

1. Removable seat pad may be washed in cold water and drip-dried. No bleach.
2. To clean stroller frame, use only household soap and warm water. No bleach or detergent.
3. From time to time check your stroller for loose screws, worn parts, torn material or stitching. Replace or repair the parts as needed.
4. Excessive exposure to sun or heat could cause fading or warping of parts.
5. If stroller becomes wet, open canopy and allow to dry thoroughly before storing.
6. If wheels squeak, use a light oil (e.g., WD-40, antirust oil, or sewing machine oil). It is important to get the oil into the axle and wheel assembly. 42
7. When using your stroller at the beach, completely clean your stroller afterward to remove sand and salt from mechanisms and wheel assemblies.

## About disposal

1. Follow the instruction of relevant municipal authority to dispose.
2. Do not dispose it in a place other than that instructed, in order to protect the environment.

## About After sales service

When the product malfunctions in use, a problem is found during check-up, replacement of parts or repair is required, fixed part is loosened or squeaking, missing parts or wheel rotation is abnormal, or user finds any other abnormal condition, stop using the product and check the product name, item number and lot number, an contact our customer support center.

## Precautions for Reparation

1. SG identification Reparation system was identified as SG product defects caused to physical injury (personal injury) compensation system. This system does not compensate the loss or damage of product itself with SG identification or other loss by the same cause,
2. When an accident occurred caused by product defect:  
Please immediately contact the Product Safety Association.  
After contacting, submit the notice of the accident issued by Product Safety Association (normally within 60 days after the accident)  
Product Safety Association : xxxxxx (Address)
3. Information required for Accident Compensation
  - A. An accident caused by the product with SG identification
    - a) the product name, SG identification number
    - b) product purchase place and date
  - B. The accident situation
    - a) the date of the accident occurred
    - b) where
    - c) how the accident occurred
  - C. The injured personal information
    - a) name, age, sex, occupation, residential address
    - b) the status and extent of the injury



Joie™

Allison GmbH  
Adam-Opel-Straße 21 67227  
Frankenthal

bring the kids™

Share the joy at [joiebaby.com](http://joiebaby.com)

IM-002033A