

Joie™

0 - 72 months

chestnut™

兒童餐椅 (含椅上架高座、兒童椅、斜躺搖籃)

使用說明書

本產品符合安全標準

CNS 15017:2013

CNS 16007:2017

CNS 16045:2018

CNS 15982:2017

和歐洲標準

EN 14988:2017+A2:2024

EN 12790-1:2023

EN 16120:2012+A2:2016

NF-D60-300-1:2019

NF-D60-300-2:2008

組裝及使用本產品前

請先閱讀說明書全文

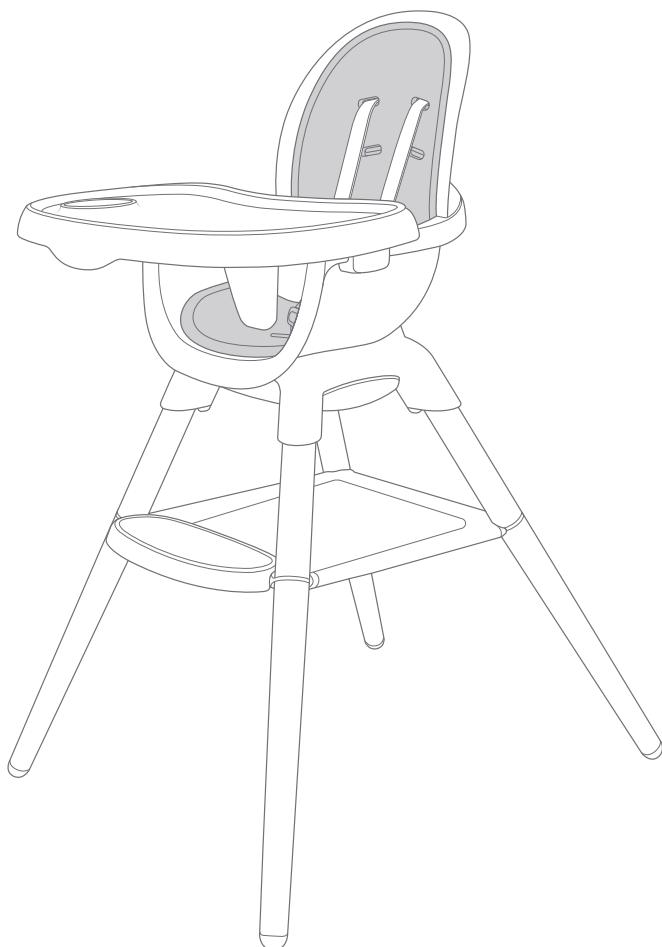

重要! 保留以備參照: 請詳細閱讀

謝謝您使用本產品

祝賀您加入巧兒宜大家庭！您剛買了一台符合安全標準 CNS 15017:2013 和 CNS 16007:2017 和 CNS 16045:2018 和 CNS 15982:2017 和歐洲安全標準 EN 14988:2017+A2:2024 和 EN 12790-1:2023 和 EN 16120:2012+A2:2016 和 NF-D60-300-1:2019 和 NF-D60-300-2:2008 的高品質 chestnut™ 兒童餐椅（含椅上架高座、兒童椅、斜躺搖籃）。這台高腳椅適用於 0-72 個月（新生兒-6 歲），體重 27.3kg 以下的兒童使用。

請仔細閱讀本說明書並依照指示操作，這樣才能保障並提供您的兒童一個安全又舒適的使用環境。

本說明書中採用的插圖是為了說明產品的操作方法和產品結構，當插圖與實物存在差異時，請以實物為準。

如需要了解更多信息，請您訪問 joiebaby.com 網站下載說明書或查看更多令人激動的 Joie 產品！

功能介紹

- 讓寶寶出生即可舒適安穩的與家人在同一高度享受親密時光。
- 可拆卸式餐盤，方便兒童與父母同時用餐
- 4 段式背靠角度調整，滿足兒童的不同需求
- 5 點式柔軟安全織帶，不傷兒童肌膚，兒童使用更安全
- 拆卸方便，在狹小空間方便儲存
- 可拆卸水洗的座墊
- 通過歐洲防火標準
- 不含重金屬，雙酚 A 等有毒物質

重要！請保留，便於未來參考用。

目錄

參照圖示	1-16
中文	
警告	17
緊急情況處理	18
產品資訊	19
產品組件及各部件名稱	20
安裝模式選擇	21
高腳椅組裝	22
組裝座椅	22
組裝餐盤	22
高腳椅操作	22
使用餐盤	22
背靠角度調整	22
肩帶高度調整	22
安全扣使用	23
安全帶長度調整	23
增高座椅操作	23
兒童增高座椅操作	24
安全扣使用	24
兒童座椅操作	24
使用配件	24
拆卸座墊和靠墊	24
保養維護與保固	25

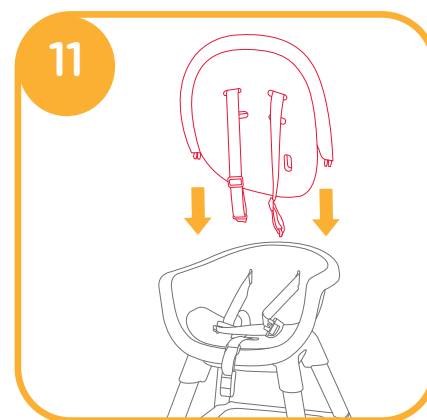
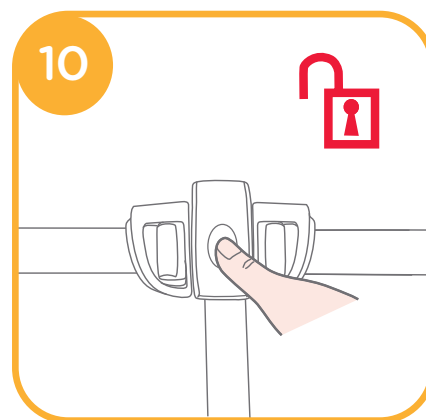
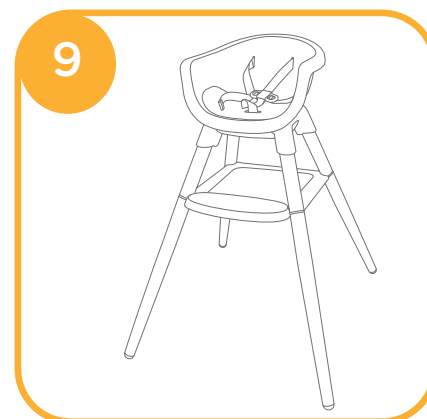
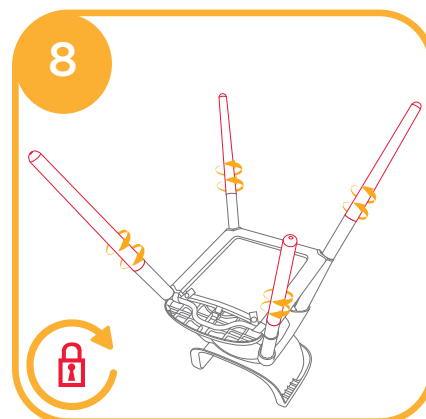
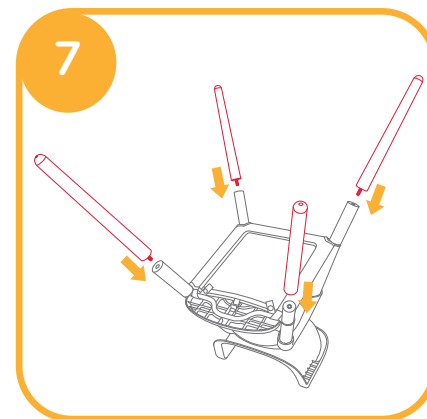
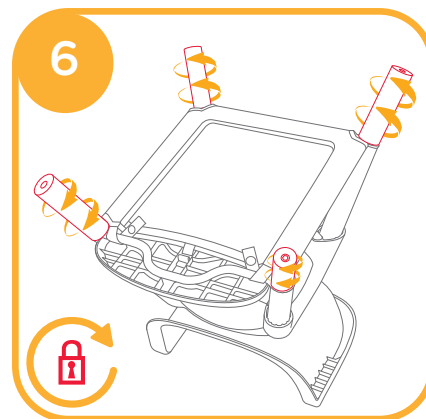
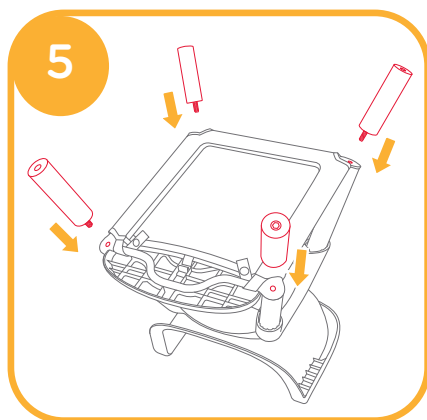
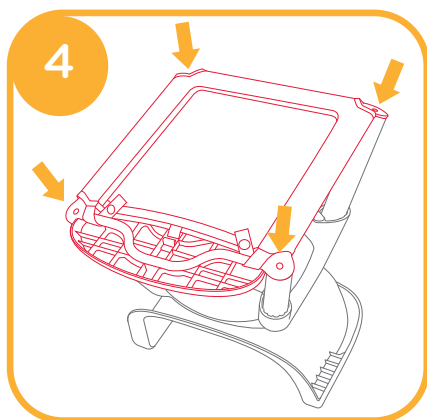
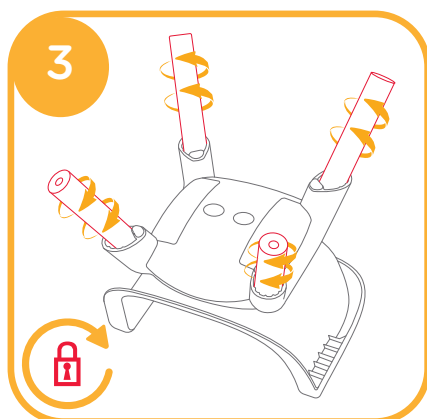
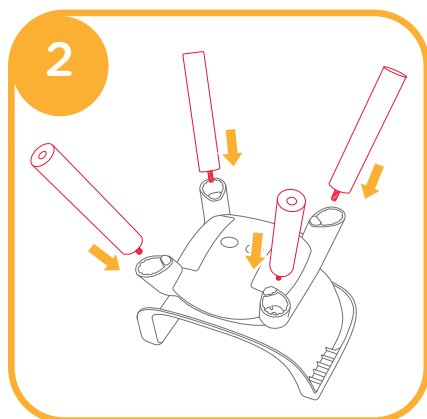
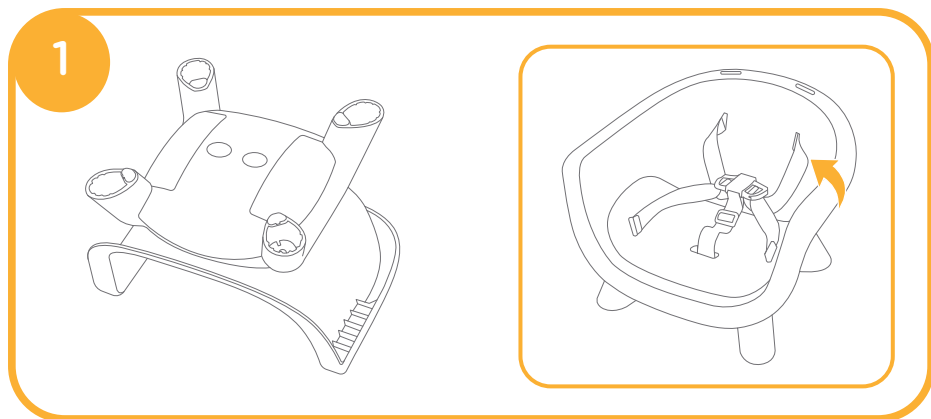

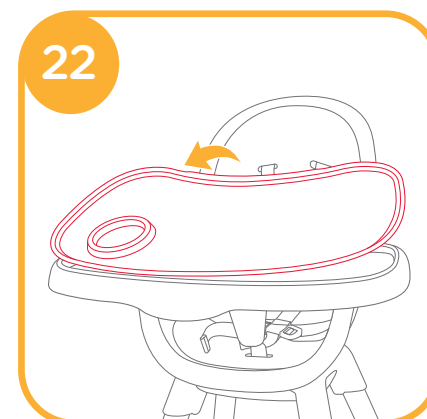
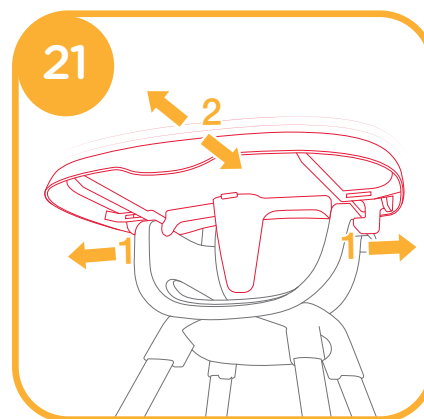
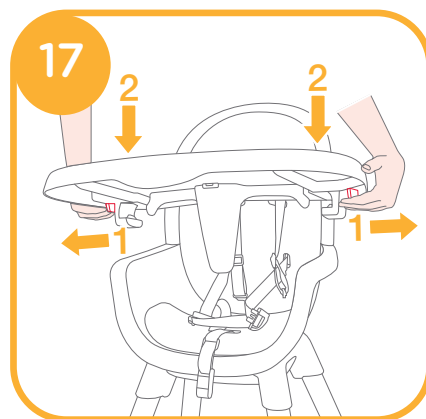
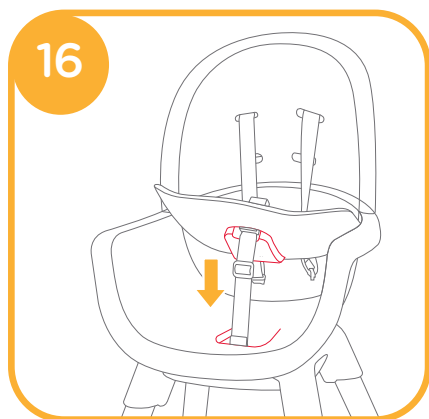
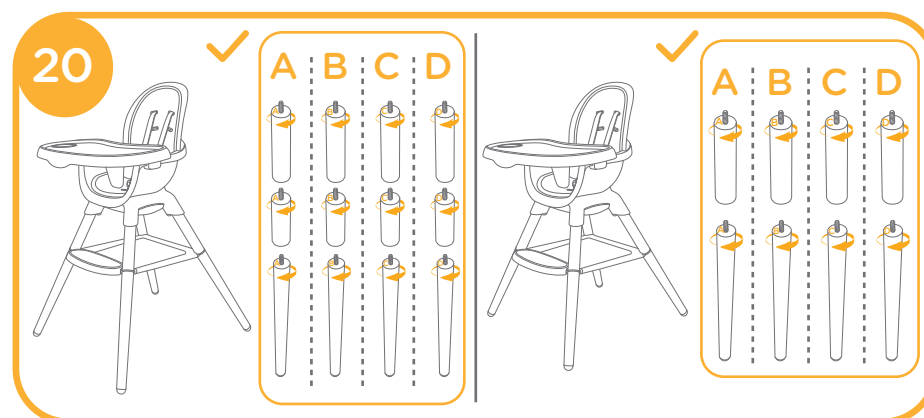
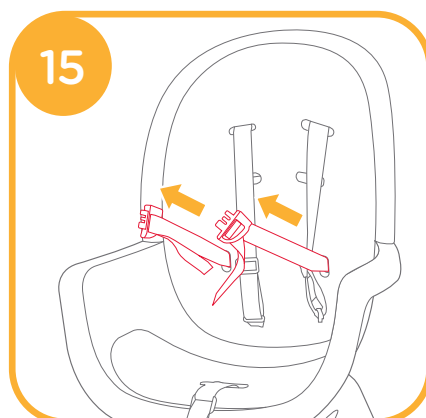
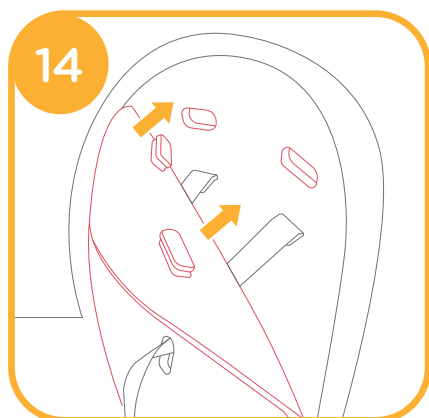
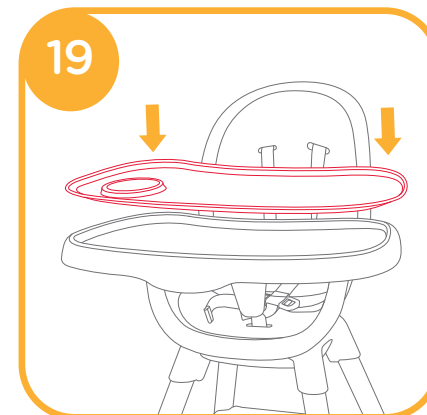
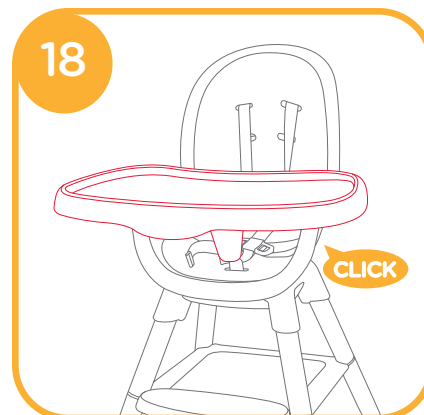
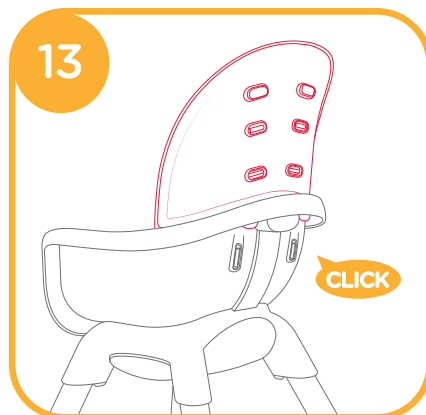
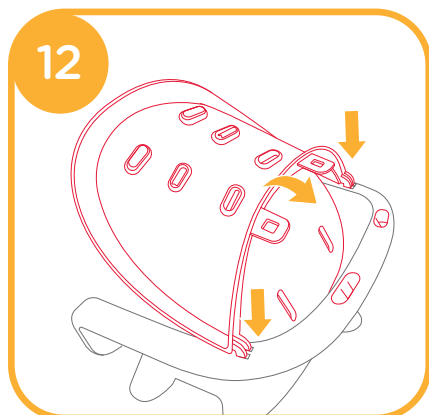

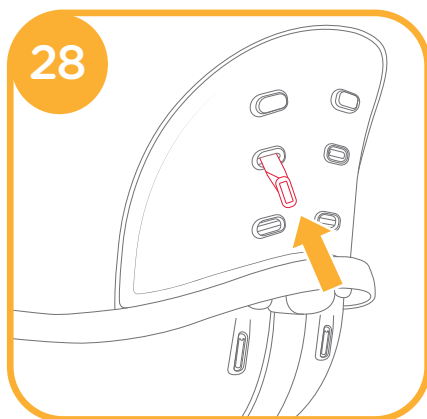
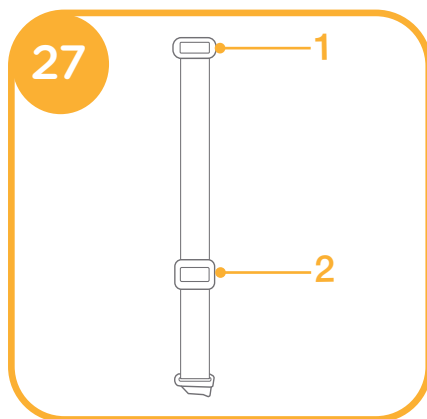
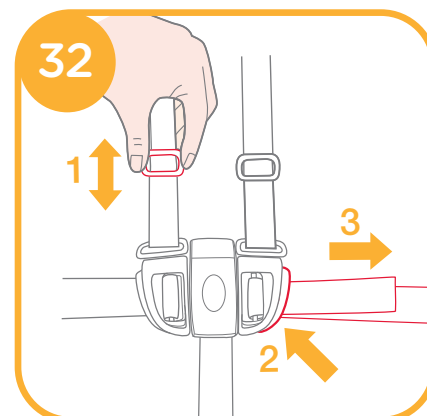
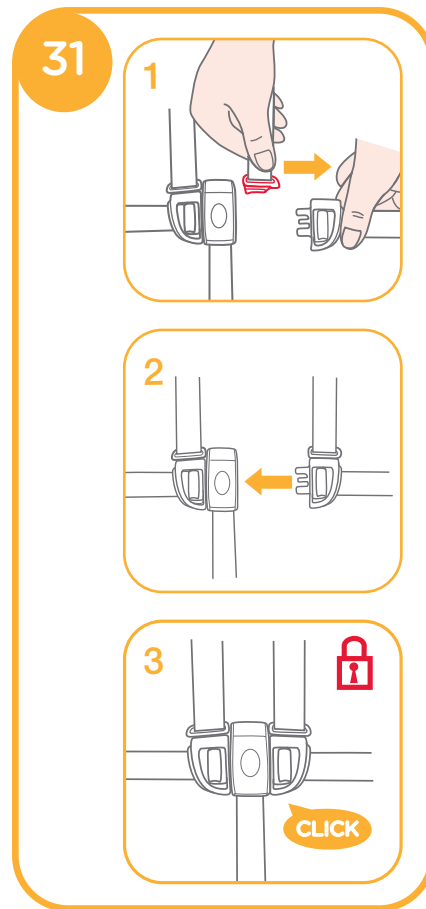
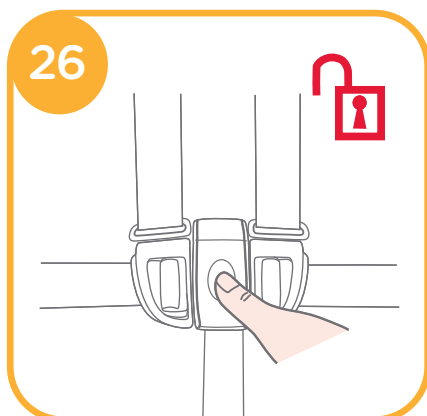
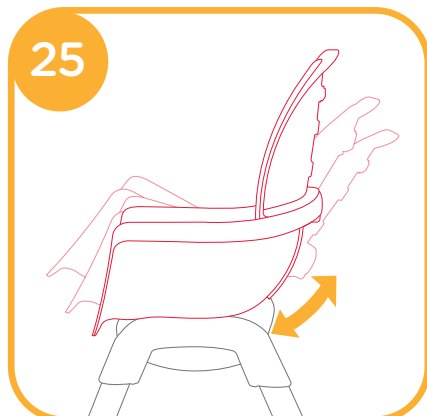
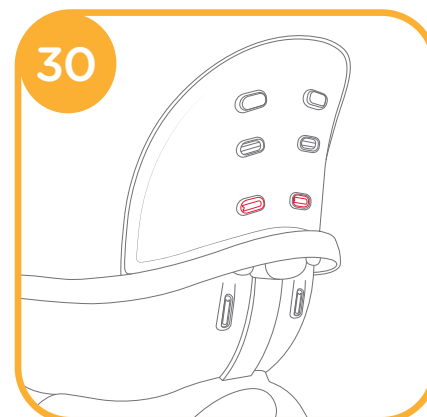
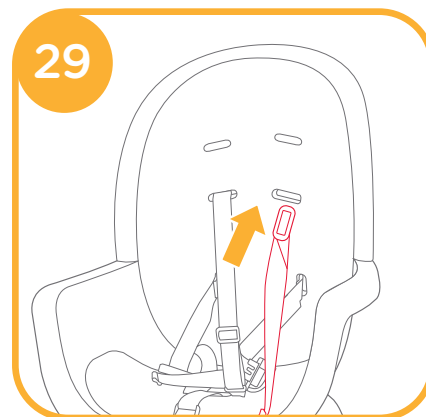
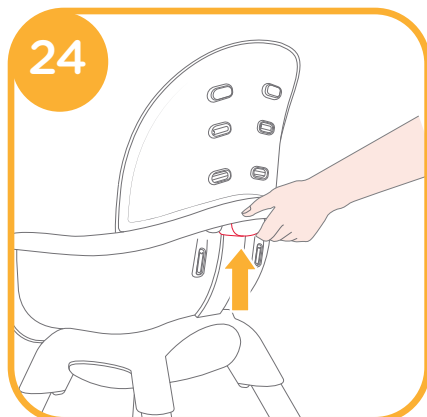
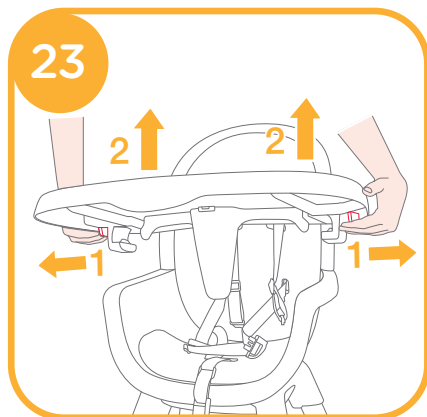

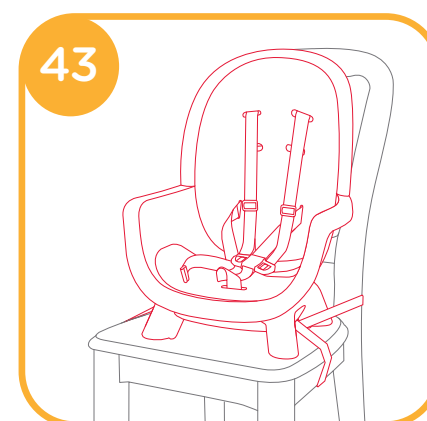
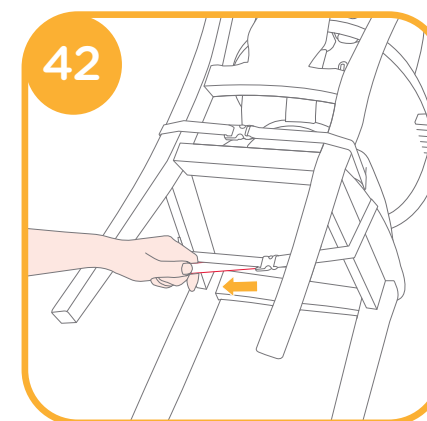
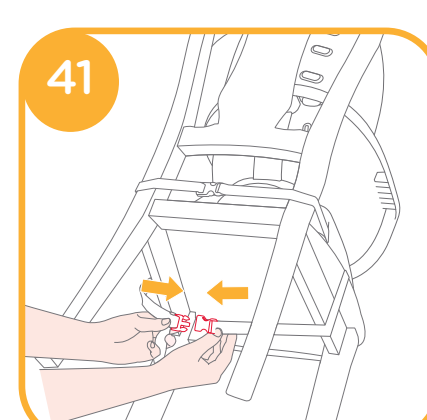
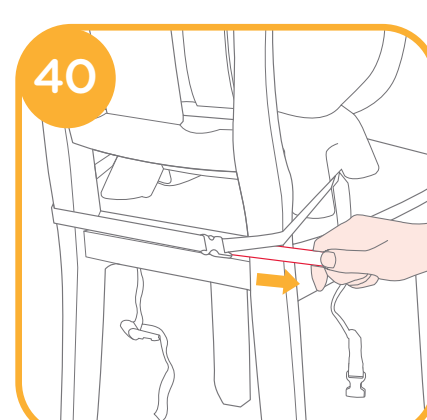
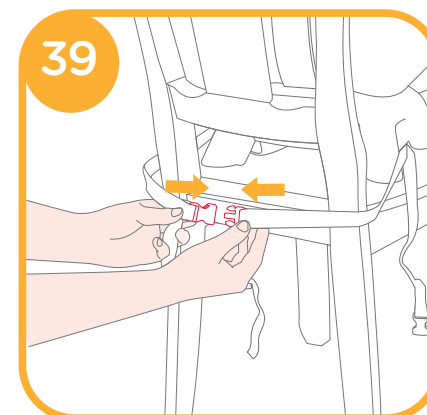
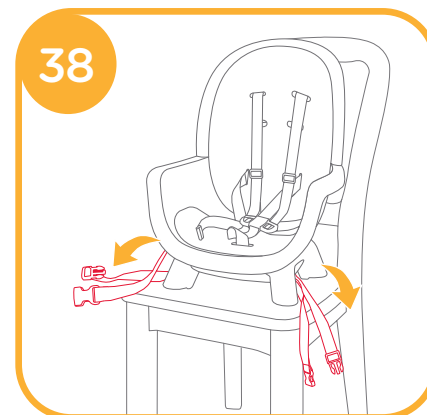
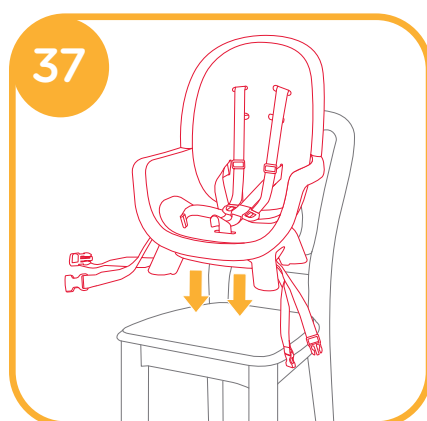
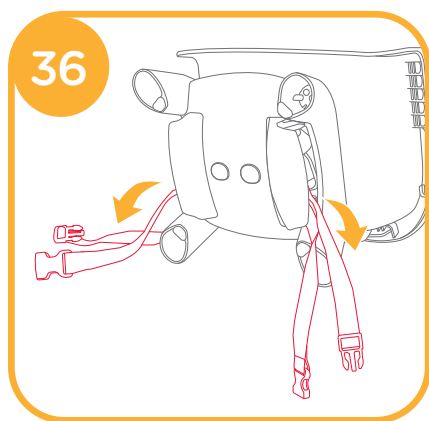
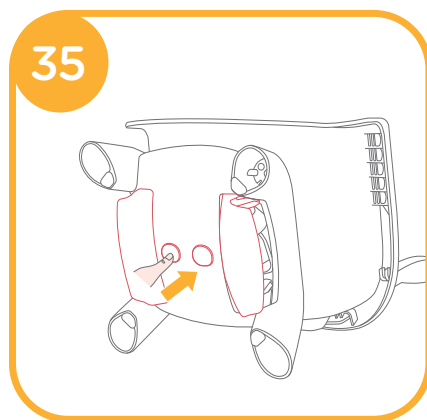
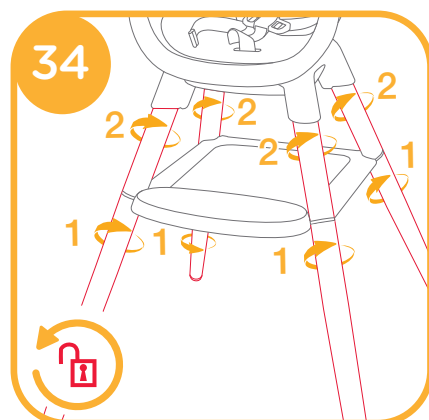
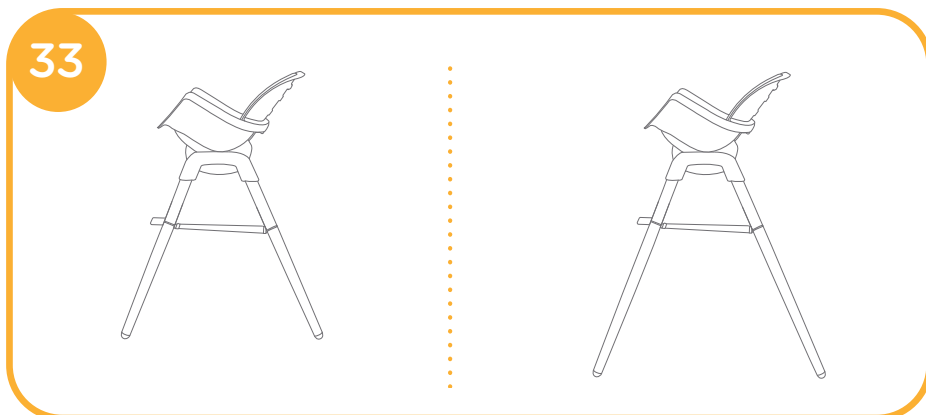

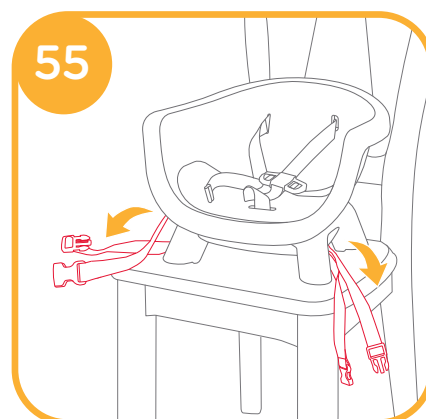
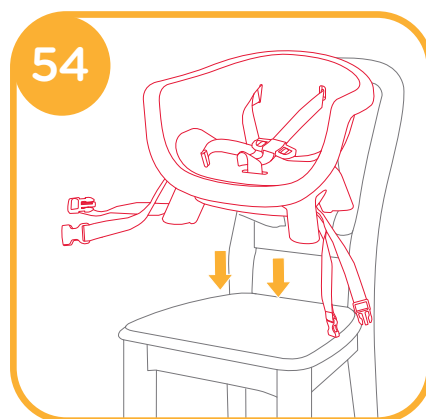
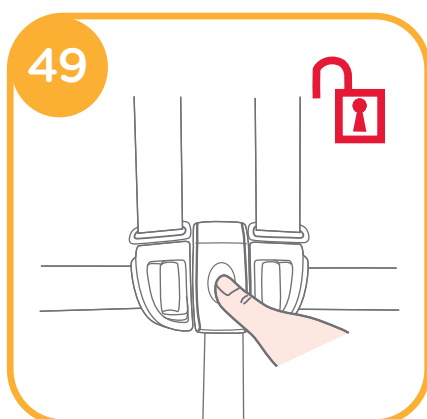
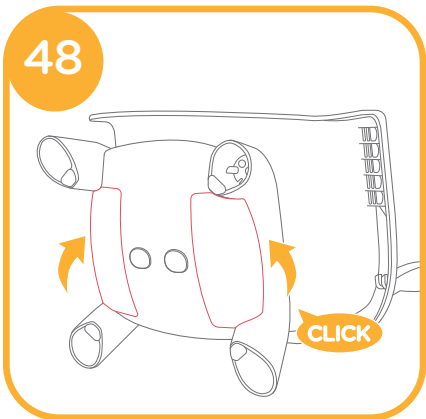
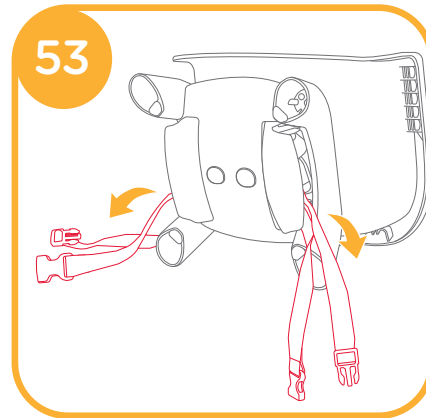
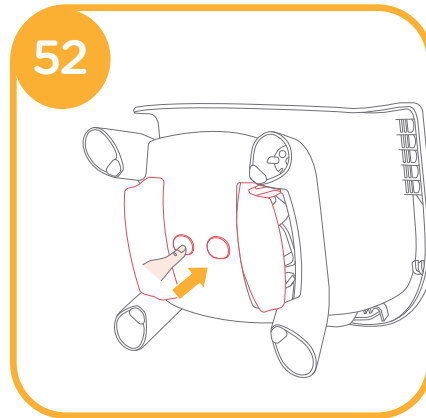
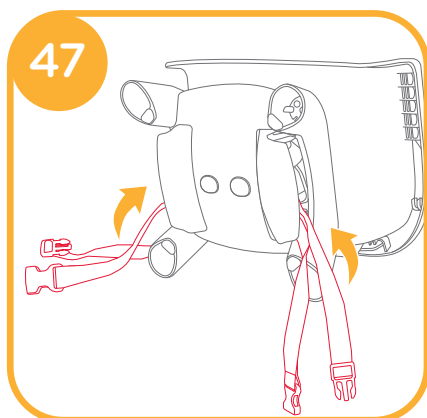
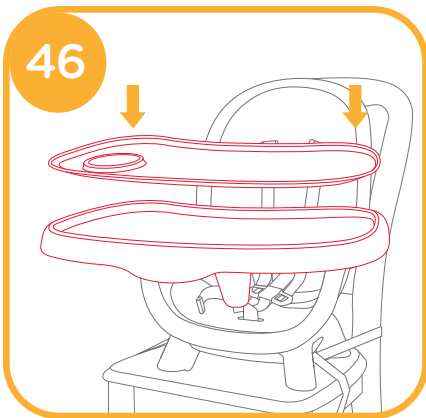
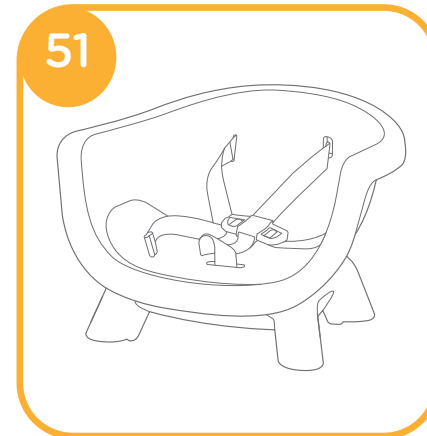
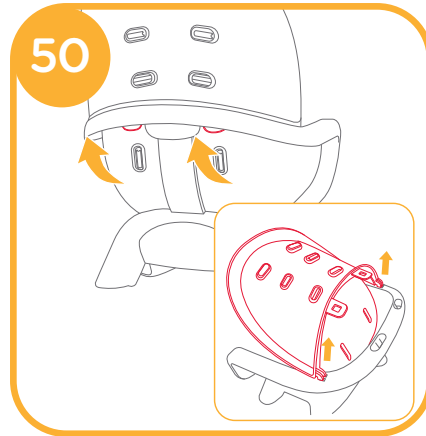
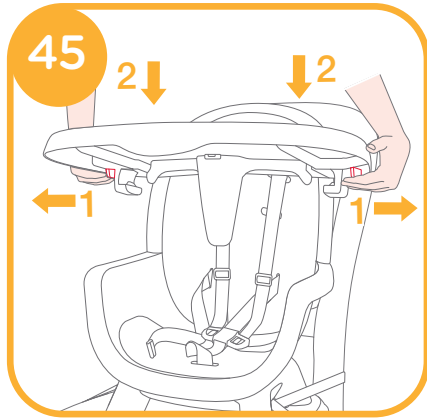

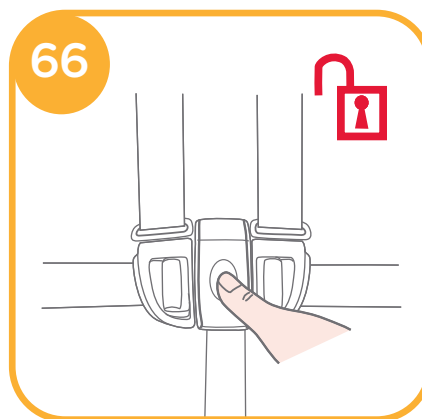
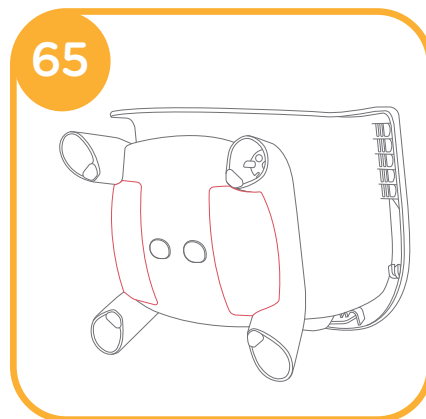
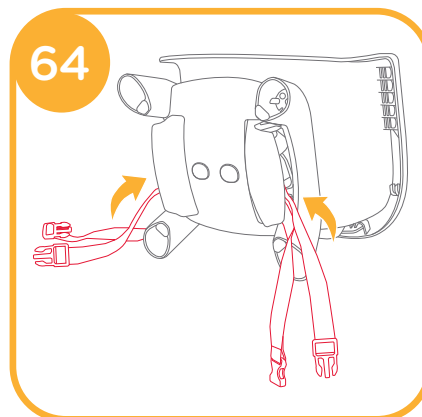
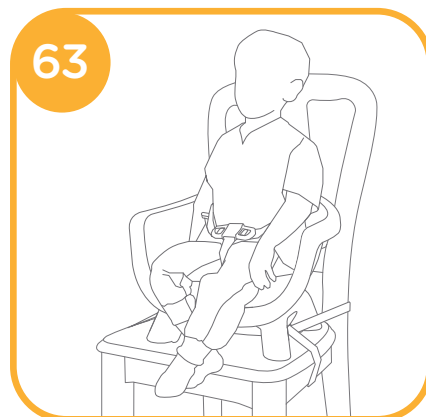
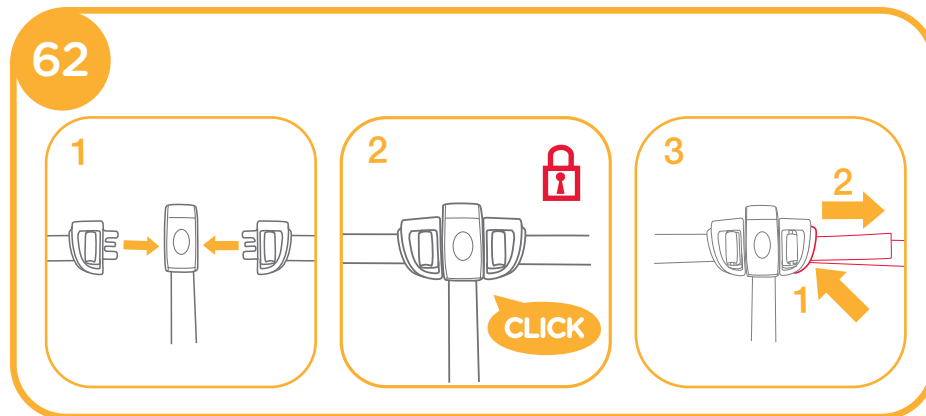
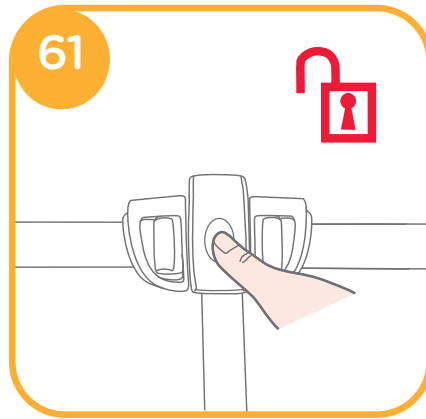
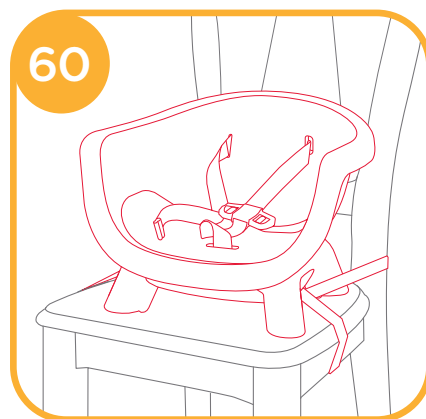
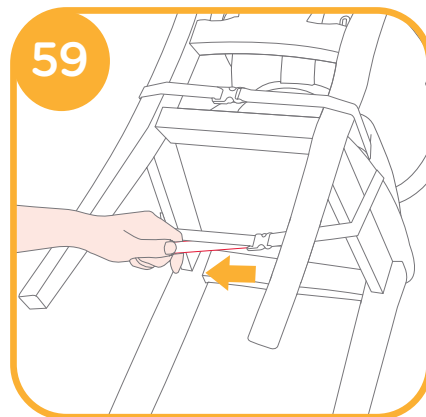
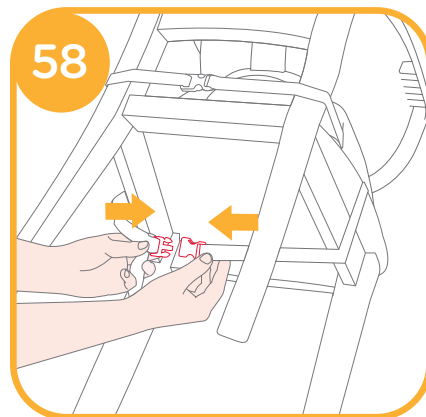
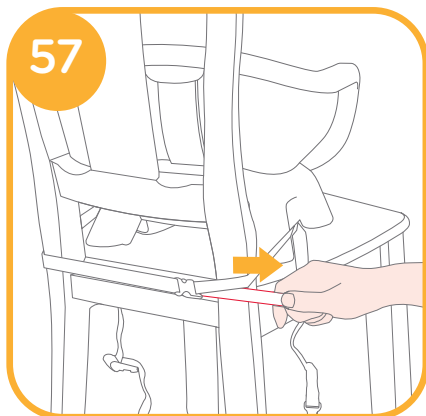
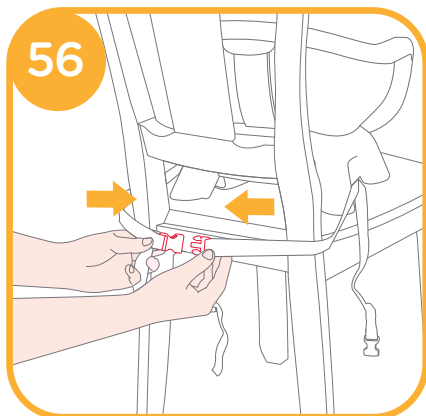

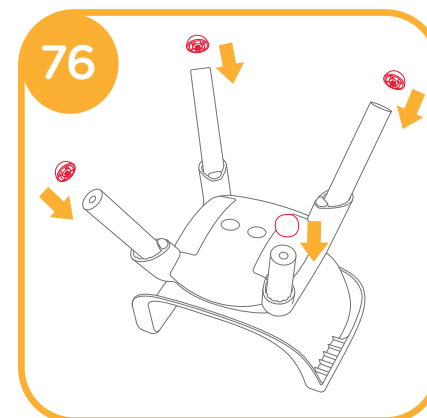
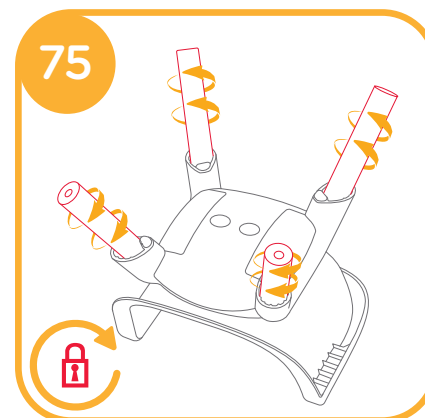
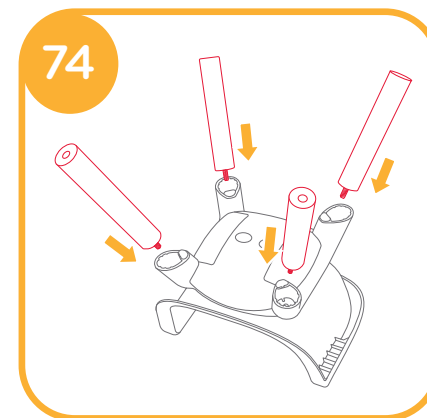
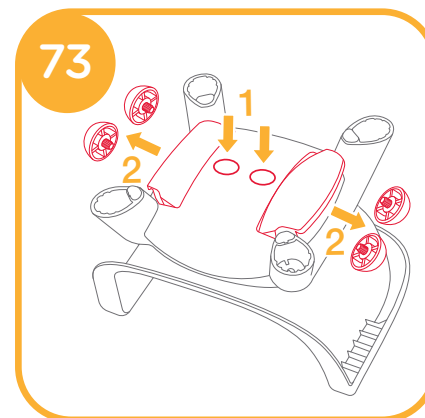
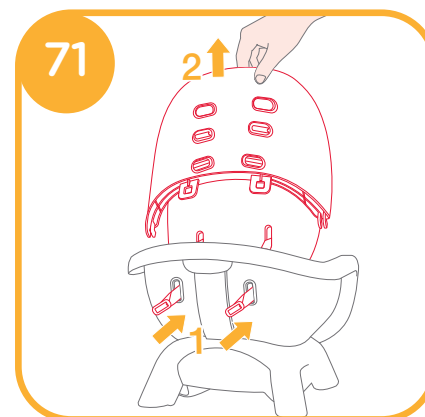
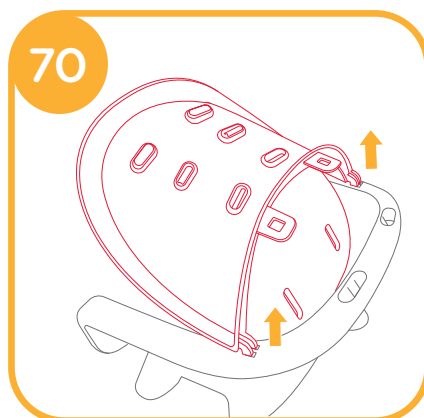
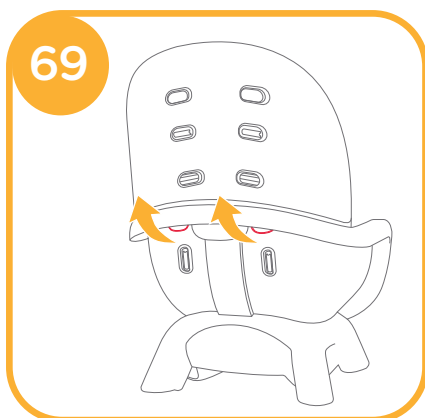
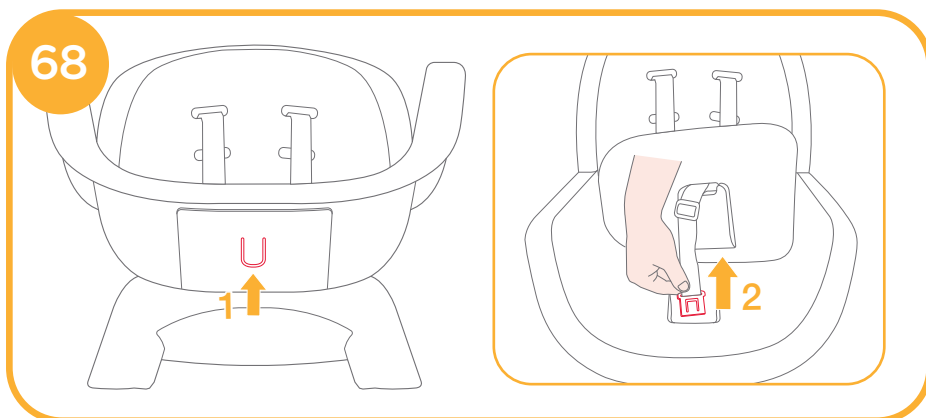
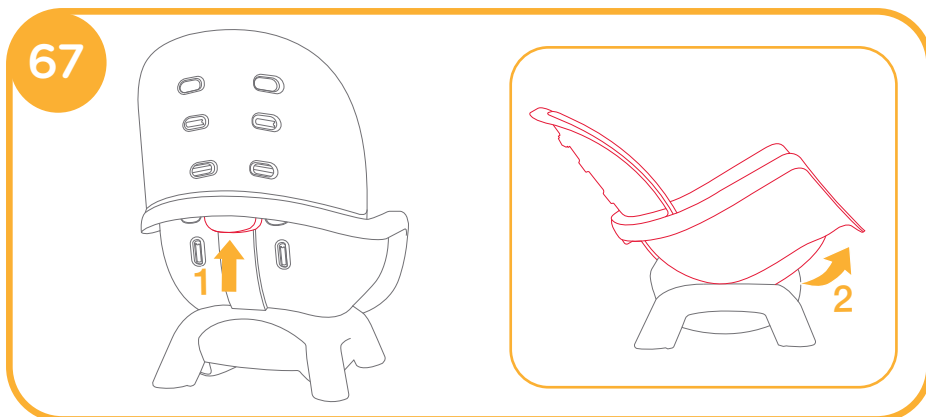

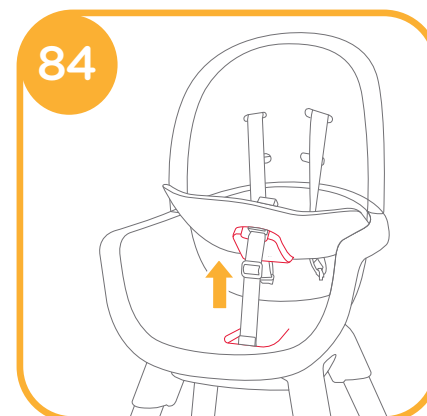
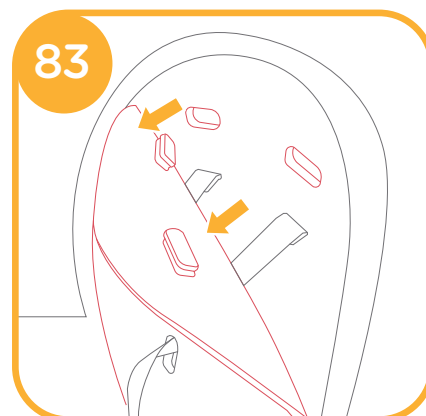
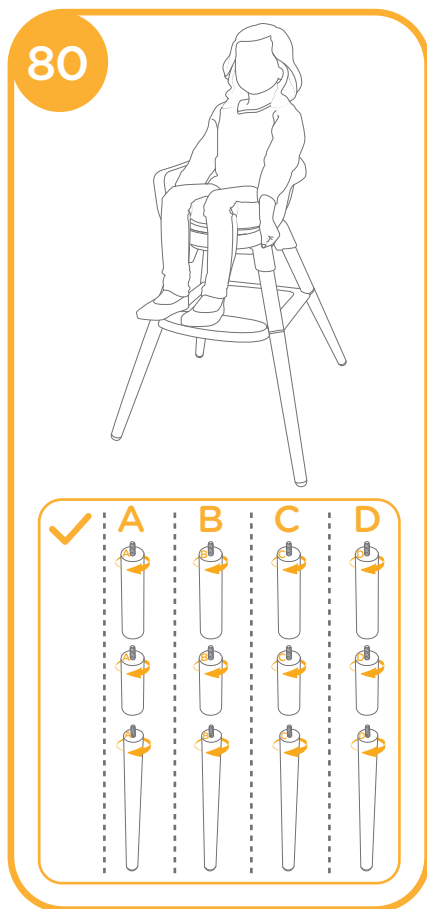
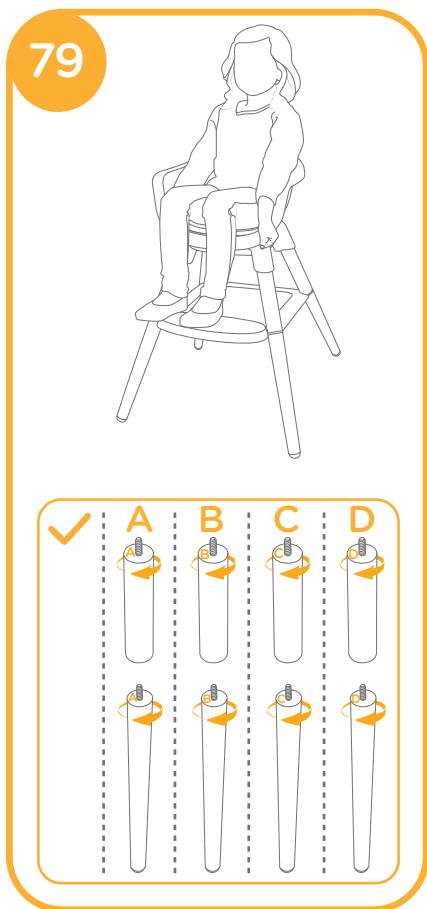
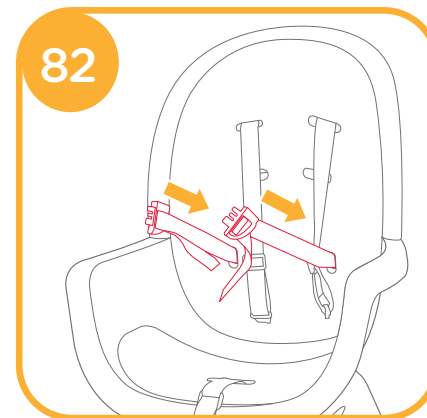
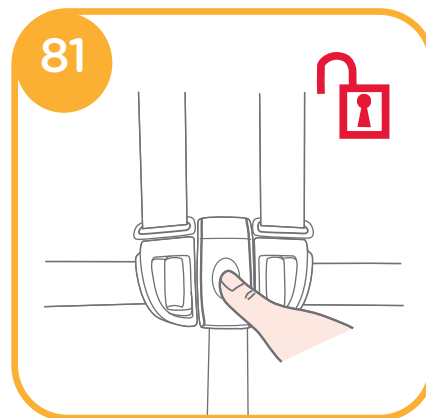
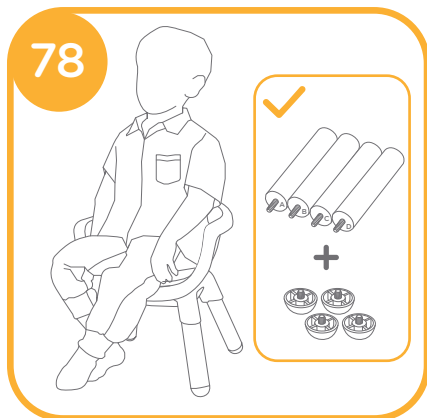
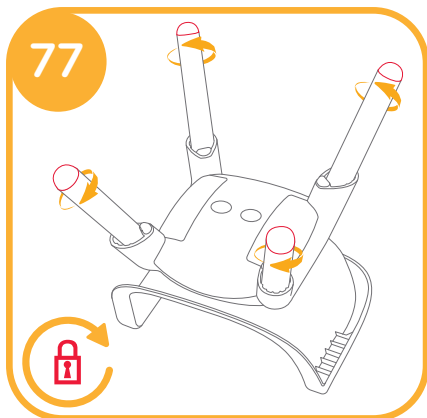

警告

- ！ 本產品需由成人組裝。
- ！ 切勿單獨留置嬰兒、兒童無人照顧。
- ！ 兒童乘坐於高腳椅時，任何期間內安全帶必須正確調整而且繫好兒童。
- ！ 跌落危險：防止兒童爬上產品。
- ！ 除非正確安裝及調整所有組件，否則切勿使用產品。
- ！ 請注意火源及其他熱源，使用時請遠離瓦斯、高溫、水池或電源
- ！ 當兒童可伸出雙腳靠在桌子或任何其他結構上時，注意傾倒之風險。
- ！ 嬰兒可自行坐立者，不得使用本嬰兒斜躺搖籃模式。
- ！ 只有在兒童能自己坐穩時才可使用高腳椅。
- ！ 如果任何零件斷裂(破損)、扯裂或遺失，切勿使用產品。
- ！ 產品展開及調整時候，使兒童遠離，以避免受傷。
- ！ 當斜躺搖籃模式使用時，適合體重9kg以下(大約0-6個月)的寶寶使用。
- ！ 本產品適用於體重27.3kg以下(0-72個月)的兒童使用。
- ！ 確實使用束縛系統。務必使用束縛系統並確保正確安裝。
- ！ 務必使用座椅固定系統且使用前確保正確安裝。
- ！ 椅上架高座使用於成人椅之前，務必檢查安全性及穩定性。
- ！ 椅上架高座不得使用於椅凳或板凳上。
- ！ 確使裝有椅上架高座的成人椅放置於兒童無法以其雙腳推抵桌子或任何其他結構體之位置，因為可能造成支撐椅上架高座的成人椅翻倒。
- ！ 不得使用製造廠商未認可之附屬件或替換零件。
- ！ 請確認安全裝置已經安裝妥當。
- ！ 請勿在未閱讀或了解本產品說明書之前，使用或裝置本產品。
- ！ 沒有按照警告和安裝指示操作，可能會影響乘坐兒童的安全。
- ！ 請勿擅自改造本產品，或使用其他廠商的零件來配合本產品使用。
- ！ 本嬰兒斜躺搖籃模式非供睡眠使用。
- ！ 切勿在架高之表面(如桌子)上使用嬰兒斜躺搖籃模式。

- ！ 斜躺搖籃模式無法取代嬰兒床或小床，如嬰兒需要睡眠，則應將嬰兒放置在合適的嬰兒床或小床內。
- ！ 為避免兒童從座椅內摔落或滑下而造成傷害。用束縛系統時，使用前確認其正確安裝。
- ！ 兒童坐在高腳椅內時，必須使用安全帶，無論是坐着還是躺着。餐盤沒有保護兒童的作用。
- ！ 切勿讓兒童站立在高腳椅上。
- ！ 當兒童在高腳椅內時，請勿提起高腳椅移動。
- ！ 當有兒童乘坐時，不要讓其他兒童在高腳椅周圍玩耍。
- ！ 不要讓其他兒童斜靠在高腳椅邊上，以免不穩定而傾倒。
- ！ 請勿在餐盤上放置任何重的袋子，包裹或其他可能導致本產品翻覆的物品。
- ！ 請將餐椅放置於平坦地面。
- ！ 為避免勒斃危險，請勿將本產品置於任何有繩索的地方，比如窗簾，電話線等物體附近。
- ！ 使用本產品前，請確保本產品已完全打開且所有的鎖定機構均已鎖定。
- ！ 請定期檢查所有鎖定和固定裝置，以確保安全。
- ！ 使用本產品前，請取掉PE袋和包裝材料，並放到兒童觸摸不到的地方。
- ！ 請定期檢查本產品是否有破損的組件，松動的連接，丟失的零件或尖銳的邊緣。
- ！ 兒童接近餐椅前，請確認餐椅已完全打開。
- ！ 有關零件更換或維修問題，請向銷售商諮詢。
- ！ 請勿放置會燙傷兒童的熱食於餐盤上。

緊急情況處理

遇緊急事件或事故時，需迅速急救或送醫治療照顧您的兒童是非常重要的。

產品資訊

Allison Baby UK Ltd.

Venture Point, Towers Business Park,

Rugeley, Staffordshire, WS15 1UZ

www.joiebaby.com

產品名稱 chestnut兒童餐椅(含椅上架高座、兒童椅、斜躺搖籃)

產品型號 H2324

適用年齡 27.3公斤以下, (斜躺搖籃模式: 0-6個月新生兒使用/
兒童餐椅: 6-72個月的兒童使用)

淨重 7.38公斤

產品尺寸 780mmx653mmx1128mm

製造日期 詳見產品上貼紙日期(年/月/日)

主要材質 塑膠、五金、布、木材

原產地 中國

委製商 巧兒宜國際股份有限公司

進口商 巧兒宜國際股份有限公司

地址 台北市內湖區瑞光路431號2樓

電話 02-27973000

統一編號 52603333

代理商 奇哥股份有限公司 Chickabiddy Co., Ltd

地址 台北市南京東路四段186號5樓

服務專線 0800-001-256 / 02-25781188

統一編號 04222671

網址 www.chick.com.tw

使用本產品前請先閱讀說明書全文, 如果您對於使用本產品還有任何疑問, 請撥打服務熱線 0800-001-256 / 02-25781188







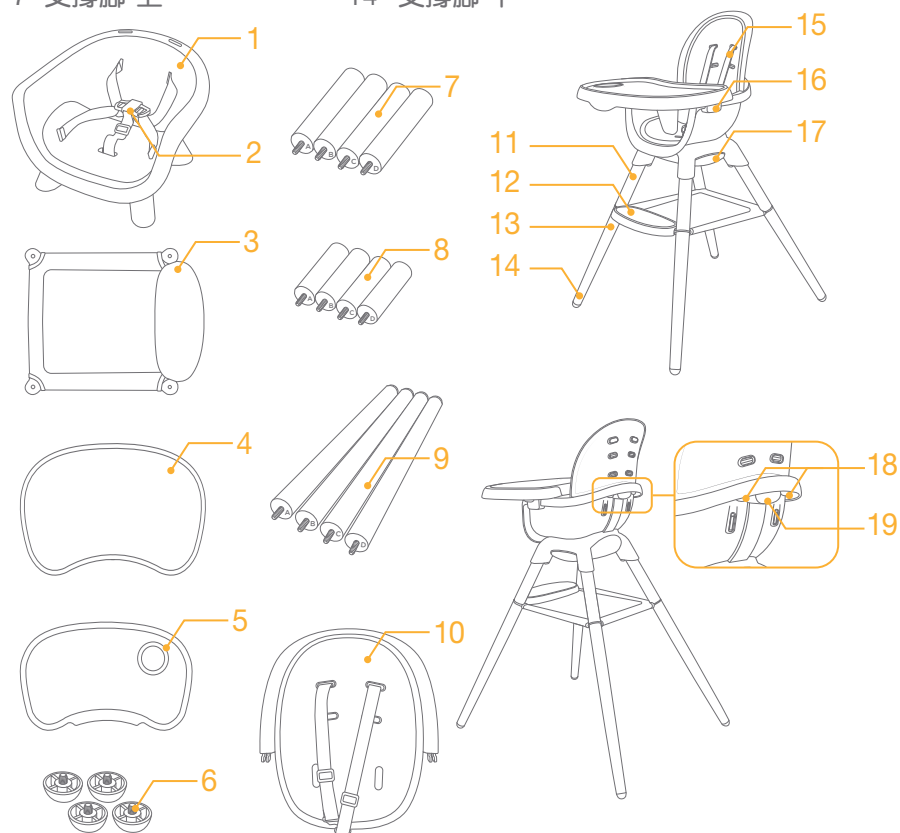

產品組件及各部件名稱

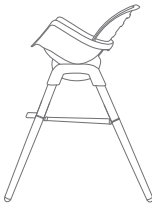
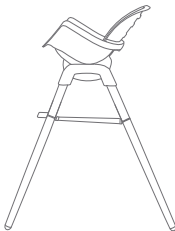
組裝前請確認所有部件已經齊全, 如有遺漏, 請與銷售商聯繫。本產品無需工具進行組裝。

- | | | |
|----------|----------|-----------|
| 1 座椅 | 8 支撐腳-中 | 15 肩帶 |
| 2 五方向安全扣 | 9 支撐腳-下 | 16 餐盤調整按鈕 |
| 3 置物籃 | 10 背靠 | 17 織帶儲存盒 |
| 4 餐盤 | 11 支撐腳-上 | 18 背靠釋鎖按鈕 |
| 5 餐盤蓋 | 12 腳踏板 | 19 座椅調整按鈕 |
| 6 底腳 | 13 支撐腳-中 | |
| 7 支撐腳-上 | 14 支撐腳-下 | |



安裝模式選擇

兒童體重	安裝模式		
新生兒至自行坐立 (6個月以下)或 體重9kg以下嬰兒	 斜躺搖籃模式(標準高度)	 斜躺搖籃模式(加高高度)	
自行坐立 (最小6個月) 及36個月以下或 體重15kg以下兒童	 高腳椅(標準高度)	 高腳椅(加高高度)	
自行坐立 (最小6個月) 及36個月以下或 體重15kg以下兒童	 兒童增高座椅	 兒童增高座椅	
27.3kg以下 (3 - 6歲) 36個月以下兒童 請勿使用	 兒童座椅	 兒童座椅 (標準高度)	 兒童座椅 (加高高度)

組裝

組裝和使用本產品前，請先閱讀說明書全文。

組裝座椅

見圖1 - 圖16

組裝餐盤

見圖17 - 圖19

組裝完成如圖20所示。

請根據支撐腳上的相應字母進行匹配和安裝。

操作

高腳椅模式

使用餐盤

見圖21 - 圖23

背靠角度調整

見圖24 - 圖25

座椅背靠有4個段位可供調整。

肩帶高度調整

見圖26 - 圖30

提示

1. 肩帶孔須與兒童肩膀高度相同，或略高於兒童肩膀。
2. 兒童坐進座椅後，請確認肩帶孔高度是否合適，以免兒童於使用時意外跌出。

圖27.1 肩帶固定栓

圖27.2 調整扣

選擇一對高度合適的肩帶孔，將肩帶依次穿入靠墊孔和背靠孔中(圖28)(圖29)(圖30)

！轉換肩帶孔時，請確認肩帶同時穿入靠墊和背靠中。

安全扣使用

見圖31

提示

1. 為防止兒童摔跌，兒童乘坐時必須繫上安全帶。
2. 請牢牢地繫上安全帶，並注意兒童與安全帶之間須可以放進一個手掌的厚度。
3. 請勿交叉肩帶，以免對兒童頸部造成壓迫。

扣合安全扣

將肩帶扣依次插入腰帶扣(圖31.1)和母扣內(圖31.2)，聽到“咔嚓”聲表示扣合到位(圖31.3)

松開安全扣

按下母扣中央的按鈕，松開安全扣。

安全帶長度調整

見圖32

1. 將日字扣上下滑動，可調節肩帶長度(圖32.1)
2. 按壓按鈕(圖32.2)，同時往外拉安全扣內側或外側的腰帶，可調節腰帶長度(圖32.3)

斜躺搖籃模式

圖33

- ！請將背靠調整至最平躺檔位。
- ！適合體重9kg以下(大約新生兒-6個月)的寶寶使用。
- ！請勿安裝餐盤。
- ！可自行坐立者，不得使用本嬰兒斜躺搖籃。

兒童增高座椅模式(有背靠)

見圖34 - 圖48

！兒童增高座椅與成人椅組裝使用時，兒童增高座椅背靠不可平躺(圖37)

請參考表格數據使用本產品，避免本產品掉落使兒童受傷

成人椅最小尺寸為29.5公分(寬度)×32.0公分(深度)

成人椅背靠高度最小尺寸為24.5公分



兒童增高座椅模式(無背靠)

見圖49 - 圖65

！向外拉背靠釋鎖按鈕，移除背靠(圖50)

請參考表格數據使用本產品，避免本產品掉落使兒童受傷

成人椅最小尺寸為29.5公分(寬度)×32.0公分(深度)

成人椅背靠高度最小尺寸為24.5公分



安全扣使用

見圖61 - 圖63

兒童座椅模式

見圖66 - 圖80

- ！使用兒童座椅模式時，支撐腳-上可與底腳結合使用(圖78)或支撐腳-上可與支撐腳-下結合使用(圖79)或支撐腳-上可與支撐腳-中和支撐腳-下結合使用(圖80)
- ！不使用底腳時可收納到座椅儲物盒中(圖73)，避免遺失。

使用配件

因產品型號的不同，規格會有所不同。並非所有高腳椅均附以下配件。

拆卸座墊和靠墊

見圖81 - 圖84

反向操作即可組裝座布。

保養維護與保固

- ！可洗餐盤蓋可用洗碗機清洗。
- ！座墊可以用海綿和肥皂水擦洗，不可使用漂白劑。
- ！將洗好的座墊晾乾，不可烘乾。
- ！去除座椅架組上的灰塵和污漬時，可先用濕布擦洗，然後用乾布擦淨濕布留下的痕跡。
- ！請勿使用未經稀釋的中性清潔劑、汽油或其他有機溶劑清洗本產品，否則可能對本產品造成損壞。
- ！請定期檢查您的產品是否有破損的組件、撕裂的材料或車縫線，如有必要請隨時進行更換或修理。
- ！請在室內使用當長時間不使用本產品時，請將產品存放於陰涼處及兒童不易接觸的地方。



保固服務

請於購買起一個月內至奇哥官網進行登錄，登錄成功後即享有商品一年保固服務。

Joie™

Child weighing under 27.3kg / 0 - 72 months

chestnut™

highchair

Instruction Manual

This highchair is approved to CNS 15017:2013 and CNS 16007:2017 and CNS 16045:2018 and CNS 15982:2017 and European safety standards EN 14988:2017+A2:2024 and EN 16120:2012+A2:2016

Please read all the instructions in this manual before installing and using the product

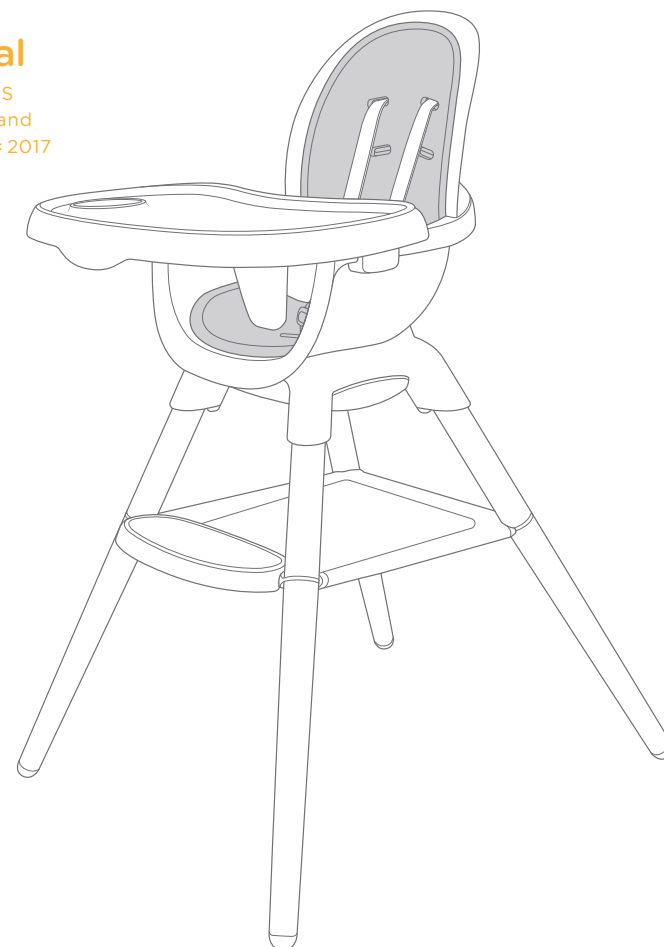

**IMPORTANT! READ CAREFULLY AND
KEEP FOR FUTURE REFERENCE**

Thank you for purchasing a Joie Highchair

Congratulations on becoming part of the Joie family! We are so excited to be part of your life with your little one. While using with the Joie chestnut™, you are using a high quality, fully certified high chair, approved to European safety standards EN 14988:2017+A2:2024 and EN 12790-1:2023 and EN 16120:2012+A2:2016 and NF-D60-300-1:2019 and NF-D60-300-2:2008. When using as reclined cradle, the maximum weight is 9kg (6 months approximately). This product is suitable for use with children between 0-72 months. Please carefully read this manual and follow each step to ensure a pleasant experience and best protection for your child.

Carefully read this instruction manual and follow the installation steps as this is the ONLY way to protect your child from serious injury or death in the case of an accident, and to provide comfort to your child while using this product.

The figures in this manual are to illustrate the methods of operation and main features of product. This model may have differences between features shown. The figures are only for reference.

Visit us at joiebaby.com to download manuals and see more exciting Joie products!

For warranty information, please visit our website at joiebaby.com

Highchair Features

Allows your baby to enjoy close, cozy moments with the family at the same height from day one.

Removable tray for use at adult table

4-position reclining seat for smaller children and after-meal naps

Convenient disassembly for easy storage in small spaces

Removable, easy-to-clean seat pad

5-point harness for additional child security

Contents

Reference Figures	1 - 16
English	
Warning	31
Product Information	33
Parts List	34
Choose the Installation Mode	35
Highchair Assembly	36
Assemble Seat	36
Assemble Tray	36
Highchair Operation	36
Use Tray	36
Adjust Recline	36
Adjust Height for Shoulder Harnesses	36
Use Buckle	37
Adjust Length for Harnesses	37
Infant Booster Operation	37
Toddler Booster Operation	38
Use Buckle	38
Toddler Chair Operation	38
Accessories	39
Remove Seat Pad And Backrest Pad	39
Care and Maintenance	39

WARNING

- ! Adult assembly required.
- ! Please read all the instructions in this manual before assembling and using this product.
- ! Please keep instruction manual for future reference.
- ! When using as reclined cradle, the maximum weight is 9kg (6 months approximately).
- ! This product is suitable for children between 0-72 months of age (under 27.3kg).
- ! Failure to follow these warnings and the assembly instructions could result in serious injury or death.
- ! DO NOT make any modification to this product or use it along with component parts from other manufacturers.
- ! Not to use accessories or replacement parts other than those approved by the manufacturer.
- ! DO NOT use the product if any parts are broken, torn or missing.
- ! DO NOT leave the child unattended. Always keep your child in view.
- ! To prevent serious injury or death from falling or sliding out, always use the restraint system and ensure it is correctly fitted.
- ! Always use the restraint system and ensure it is correctly fitted.
- ! Always use the chair attachment system and ensure it is correctly fitted before use.
- ! Always check the security and the stability of the product on the adult chair before use.
- ! Do NOT use this product on stools or benches.
- ! Make sure that any harness is correctly fitted.
- ! Secure your child at all times using the restraint harness provided in both the reclining or upright positions. The tray is not designed to hold your child in the product.
- ! DO NOT use the highchair until the child can sit up unaided.
- ! It is recommended that the product be used in the upright position only by children capable of sitting upright unaided.
- ! DO NOT allow your child to stand in or on the highchair.
- ! DO NOT lift and carry highchair while occupied.
- ! DO NOT allow children to play with or around highchair while occupied.
- ! DO NOT allow children to lean over sides of highchair. It may become unbalanced and tip over.
- ! DO NOT place any heavy bags, packages, or other items on the highchair tray. They may cause the chair to tip over.
- ! Do not move or lift this product with the baby inside it.

- ! Falling hazard: Prevent your child from climbing on the highchair.
- ! To ensure that the adult chair with the chair mounted seat is placed in a position where the child is not able to use its feet to push against the table or any other structure as this can cause the tip over of the adult chair supporting the chair mounted seat.
- ! Always use on a flat and level floor.
- ! Be aware of the risk of open fire and other sources of strong heat in the vicinity of the product.
- ! To avoid strangulation hazard, DO NOT place product in any location where there are cords, such as window blind cords, drapes, phone cords, etc.
- ! All assembly fittings should be unfolded completely, tightened and latched properly before using the product.
- ! DO NOT use the product unless all components are correctly fitted and adjusted.
- ! Regularly check the locks and fittings for security.
- ! To avoid suffocation, remove plastic bag and packaging materials before using this product. The plastic bag and packaging materials should then be kept away from babies and children.
- ! Regularly inspect the product for damaged hardware, loose joints, missing parts or sharp edges.
- ! Remove your child from product before adjusting the highchair.
- ! Make sure the product has been folded or unfolded completely before letting your child approach the highchair.
- ! Consult your local distributor for issues concerning maintenance, repair and part replacement.
- ! To avoid burns, DO NOT place hot food on tray.
- ! Never leave the child unattended.
- ! Be aware of the risk of tilting when your child can push its feet against a table or any other structure.
- ! Never let the child sleep in this product. This reclined cradle does not replace a cot or a crib. Should your child need to sleep, then it should be placed in a suitable cot or crib.
- ! Stop using the reclined cradle when the child starts trying to sit up.
- ! Always use the restraint system.
- ! Removed accessories (including basket and wooden foot) are not toys and should be placed out of reach of children.

Emergency

In case of emergency or accident, it is most important to have your child taken care of with first aid and medical treatment immediately.

Product Information

Allison Baby UK Ltd.

Venture Point, Towers Business Park,
Rugeley, Staffordshire, WS15 1UZ
www.joiebaby.com

Product	Chestnut™
Model	H2324
Suitable for	Children up to 27.3 kg (Reclined cradle mode: for newborns aged 0–6 months / Toddler chair: for children aged 6–72 months)
Net Weight	7.38kg
Product Size	780mmx653mmx1128mm
Date	Please see detailed date on label (year / month / day)
Materials	Plastics metal fabrics wood
Patent No.	Patents pending
Made in	China
Distributor	Chickabiddy Co., Ltd
Address	5 th FL, 186, Nanking E. Rd, Sec. 4, Taipei, Taiwan 10595
Tel.	0800-001-256 / 02-25781188
Website	www.chick.com.tw

Read all the instructions in this manual before using this product. If you have any further questions, please call 0800-001-256 / 02-25781188 directly.







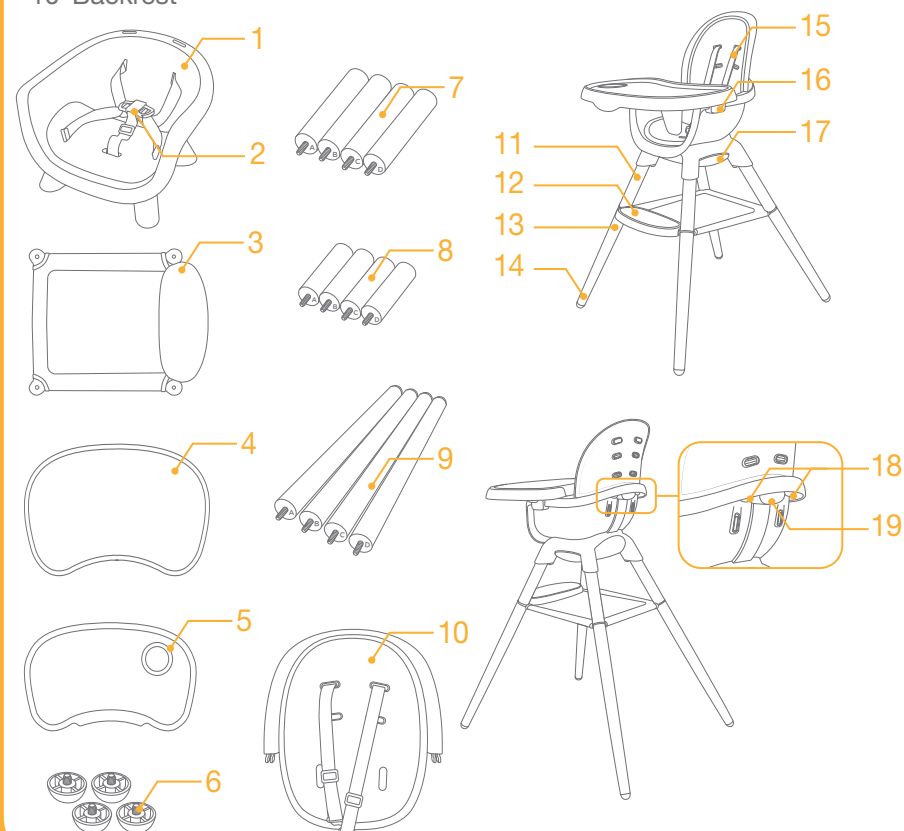

Parts List

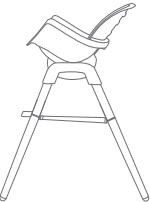
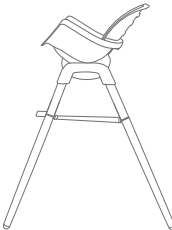
Make sure all parts are available before assembly. If any part is missing please contact your local distributor. No tools are required for assembly.

- | | |
|----------------------|------------------------------|
| 1 Seat | 11 Support Leg-Upper |
| 2 Buckle | 12 Footrest |
| 3 Basket | 13 Support Leg-Middle |
| 4 Tray | 14 Support Leg-Lower |
| 5 Tray Cover | 15 Backrest |
| 6 Feet | 16 Tray Adjustment Button |
| 7 Support Leg-Upper | 17 Webbing Storage Box |
| 8 Support Leg-Middle | 18 Backrest release Button |
| 9 Support Leg-Lower | 19 Recline Adjustment Button |
| 10 Backrest | |



Choose the Installation Mode

Child's Weight	Figure for Installation		
The product is intended for newborn up to children start trying to sit up and up to 6 months or a maximum weight of 9 kg			
	Newborn Highchair (Standard Height)	Newborn Highchair (Counter Height)	
The product is intended for children able to sit up unaided and up to 3 years or a maximum weight of 15 kg			
	Highchair (Standard Height)	Highchair (Counter Height)	
This product is intended for children able to sit unaided (minimum 6 months) and up to 36 months or a maximum weight of 15kg.			
	Infant Booster	Toddler Booster	
Child weighing under 27.3kg (3 - 6 years) The children below 36 months do not use this product			
	Youth Chair	Youth Stool (Standard Height)	Youth Stool (Counter Height)

Assembly

Please read all the instructions in this manual before assembling and using this product.

Assemble Seat

see images Fig. 1 - Fig. 16

Assemble Tray

see images Fig. 17 - Fig. 19

Assembly completed as shown in Fig. 20.

Please match and install according to the corresponding letters on the wooden legs.

Operation

Highchair Mode

Use Tray

see images Fig. 21 - Fig. 23

Adjust Recline

see images Fig. 24 - Fig. 25

The recline can be adjusted to 4 positions.

Adjust Height for Shoulder Harnesses

see images Fig. 26 - Fig. 30

Note

1. The shoulder harness must go into the slot that is even with or slightly above the shoulders.
2. In order to protect your child from falling out, after your child is placed into the seat, check whether the shoulder harnesses are at proper height.

Fig. 27.1 Shoulder harness anchor

Fig. 27.2 Slide adjuster

Choose a pair of proper shoulder slots. Insert the shoulder harnesses into slots in seat pad and seat back. (Fig. 28)(Fig. 29)(Fig. 30)

! When changing shoulder harness slots, make sure shoulder harnesses are going through same slots in seat pad and seat back.

Use Buckle

see image Fig. 31

Note

1. To prevent serious injury or death from falling or sliding out, always secure child in the restraint.
2. Make sure the restraint harness is fitted correctly and the space between the harness and the child does not exceed the thickness of an adult hand.
3. DO NOT cross the shoulder belts. This will cause pressure on child's neck.

Lock Buckle

Match the waist belt buckle up with the shoulder buckle and slide together (Fig. 31.1). Insert buckles into the center buckle (Fig. 31.2). A "click" means the buckle is locked completely (Fig. 31.3).

Release Buckle

Press the center button to release the buckles.

Adjust Length for Harnesses

see image Fig. 32

1. Use slide adjuster to change the harness length. (Fig. 32.1)
2. Pull waist harness to tighten to proper length (Fig. 32.2). Press the button to loosen the waist harness. (Fig. 32.3)

Reclined Cradle Mode

see images Fig. 33

- ! Adjust the backrest to the fully reclined position.
- ! Suitable for babies under 9 kg (approximately newborn to 6 months).
- ! Do not use the tray.
- ! Stop using the reclined cradle once the child can sit up

Infant Booster Mode(with backrest)

see images Fig. 34 - Fig. 48

- ! The backrest of infant booster can not be reclined when using infant booster with chair. (Fig. 37)

Please refer to the form data to use the product to avoid it falling and cause hurting child

Recommended adult chair seat dimensions to be minimum 29.5cm (width)X32.0cm (depth).

Minimum height of the adult chair's backrest should be 24.5cm.

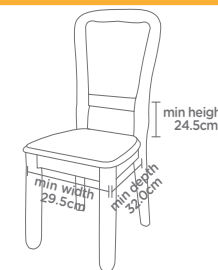

Toddler Booster Mode(no backrest)

see images Fig. 49 - Fig. 65

- ! Please adjust the backrest to the most reclined position before removing it. (Fig. 50)

Please refer to the form data to use the product to avoid it falling and cause hurting child

Recommended adult chair seat dimensions to be minimum 29.5cm (width)X32.0cm (depth).

Minimum height of the adult chair's backrest should be 24.5cm.

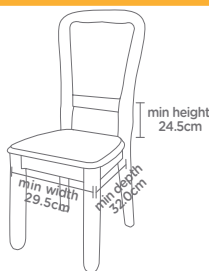

Use Buckle

see images Fig. 61 - Fig. 63

Toddler Chair Mode

see images Fig. 66 - Fig. 80

- ! When using the product in toddler chair mode, can be used in conjunction with support leg-upper and feet (Fig. 78) or in conjunction with support leg-upper and support leg-lower (Fig. 79) or in conjunction with support leg-upper, support leg-middle and support leg-lower. (Fig. 80)
- ! When not in use, the footrest can be stored in the seat storage compartment(Fig. 73) to prevent loss.

Accessories

Accessories may be sold separately or may not be available depending on region.

Remove Seat Pad And Backrest Pad

see images Fig. 81 - Fig. 84

To assemble seat pad, reverse the steps above.

Care and Maintenance

- ! The tray cover is dishwasher safe.
- ! Your seat pad can be spot cleaned with a sponge and soapy water. DO NOT use bleach.
- ! Drip dry the washed seat pad. DO NOT put in dryer.
- ! To clean the frame, wipe with a damp cloth and mild detergent then wipe out any traces of moisture on the frame with a dry cloth.
- ! DO NOT use undiluted neutral detergent, gasoline or other organic solvent to wash the product. It may cause damage to the product.
- ! From time to time, check your product for worn parts, torn material or stitching. Replace the parts as needed.
- ! If the product is not in use for a long period of time, please put it somewhere your child cannot access it.



Allison Baby UK Ltd.
Venture Point, Towers Business Park
Rugeley, Staffordshire, WS15 1UZ

bring the kids™

Share the joy at joiebaby.com

IM-001785F