

Joie™ signature

i-Level™ enhanced child restraint

使用說明書

本產品符合安全標準CNS 11497
及歐盟標準ECE R129/01測試和認證
組裝及使用本產品前
請先閱讀說明書全文



13kg (約1.5歲) 以下的寶寶

恭喜您

恭喜您成為Joie家族的一員！很高興能與您的寶寶共度行車旅程。乘坐本產品時，您的寶寶享受的是一台高品質和通過安全標準及歐盟安全標準檢測的0+級兒童保護裝置，這台嬰兒提籃適用於體重13kg(約1.5歲)以下的寶寶。

請仔細研讀並依照本說明書的指示操作，如此才能保障並提供您的寶寶一個安全又舒適的行車旅程。

本嬰兒提籃適用於有ISOFIX固定裝置的汽車，因本嬰兒提籃是依安全標準CNS 11497和歐盟安全標準ECE R129/01去做測試和認證的。台灣區域使用請依照CNS標準規範。

車用兒童保護裝置

！重要：請仔細閱讀並妥善保存本說明書，以便日後參考。
請將本說明書存放在嬰兒提籃上(如圖)。安裝和使用本產品前，請先閱讀說明書全文。



產品組件 及各部件名稱

請確認產品組件是否有遺漏，如有遺漏，請聯繫代理商。

- | | |
|-----------|---------------|
| 1 把手 | 11 背靠調整按鈕 |
| 2 遮陽篷 | 12 提籃指示器 |
| 3 座墊 | 13 ISOFIX連接器 |
| 4 織帶調整按鈕 | 14 ISOFIX釋鎖按鈕 |
| 5 調整織帶 | 15 ISOFIX導向器 |
| 6 安全扣 | 16 支撐腳調整按鈕A |
| 7 肩帶 | 17 支撐腳調整按鈕B |
| 8 安全扣-插扣 | 18 支撐腳 |
| 9 安全扣-母扣 | 19 提籃釋鎖手把 |
| 10 把手調整按鈕 | 20 卡合鉤 |

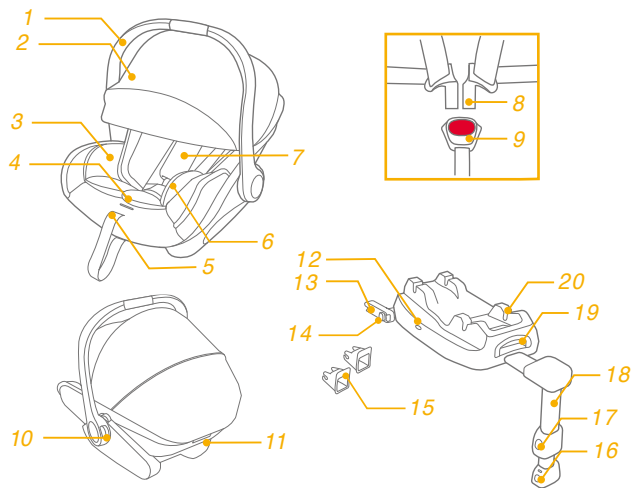

警告

- ! 沒有任何嬰兒提籃可以保證100%遠離傷亡，然而正確的使用本嬰兒提籃可以降低寶寶傷亡的機率。
- ! 本嬰兒提籃適用於體重13kg以下的寶寶。
- ! 任何束縛兒童保護裝置至車輛之織帶應束緊，任何束縛兒童之織帶應根據兒童身體進行調節，且此織帶不應扭曲。
- ! 將您的寶寶放入嬰兒提籃後，必須正確的扣合及使用嬰兒提籃安全帶。並確保腰部織帶能有效束縛骨盆部位。
- ! 本兒童保護裝置若於意外中遭受劇烈撞擊後，不可繼續使用，應立即更換兒童保護裝置。意外可能導致兒童保護裝置產生潛在危險。
- ! 請勿在兒童保護裝置上進行未經驗證許可之改裝或增加其他裝置以及未依兒童保護裝置製造商提供之安裝說明使用，以免造成受傷或死亡。
- ! 請讓座椅遠離日光，以免產品溫度過高對兒童的皮膚造成傷害。
- ! 在無人照料下，不得讓兒童留在兒童保護裝置內。
- ! 任何行李或其他可能在碰撞中造成傷害之物品應適當牢固。
- ! 當本兒童保護裝置沒有座布時，請勿使用，因座布為兒童保護裝置束縛性能之整體構成要件。
- ! 請勿使用非本製造商推薦的座布，否則會影響兒童安全座椅的總體性能。
- ! 不要使用非說明書中所述以及兒童約束系統中所標示的其他受力點。
- ! 請勿在未閱讀或了解本嬰兒提籃說明書及汽車說明書之前，使用或安裝本嬰兒提籃。
- ! 本嬰兒提籃如有任何損壞或零件缺失時，請勿繼續使用。
- ! 請勿讓您的寶寶穿着過大的衣物，所穿的衣物必須能讓嬰兒提籃的安全帶適當而安全地扣在寶寶兩腿之間。
- ! 請勿將未使用汽車安全帶固定住的嬰兒提籃留在車內，以免緊急剎車時，傷害到其他乘客。若不經常使用嬰兒提籃時，請將其搬離汽車座椅。

警告

- ! 嚴禁將本嬰兒提籃裝置於有空氣囊的座位上使用。
- ! 請勿使用二手嬰兒提籃或來歷不明的嬰兒提籃，因為它們可能存在危害寶寶安全的潛在危險。
- ! 不可使用繩子等其他物件代替汽車安全帶，以避免兒童被粗細繩索意外勒住。
- ! 本兒童保護裝置僅能安裝到有固定背靠的汽車座椅上，不能安裝到背靠無法固定，以致背靠向前折疊或自由轉動的汽車座椅上。
- ! 請勿使用其他廠商的小座墊或底座來配合本嬰兒提籃使用。如需更換配件時，請與代理商聯繫。
- ! 請勿放置任何物品在兒童保護裝置下方。發生撞擊時，此物品會飛出，導致織帶變鬆，並影響其他乘客的安全。
- ! 請勿讓汽車車門卡住嬰兒提籃的任何組件。
- ! 使用本產品前，請取掉PE袋和包裝材料，並放到嬰兒觸摸不到的地方。
- ! 長期不使用嬰兒提籃時，請將其搬離汽車座椅。
- ! 有關零件更換或維修問題，請向代理商查詢。
- ! 不管在哪種狀況下使用，把寶寶放入提籃後，請一直為寶寶繫好安全帶，以免寶寶從提籃內跌出。
- ! 手提嬰兒提籃前，請確認寶寶已繫好安全帶，且把手固定於直立段位。
- ! 請勿將嬰兒提籃置於桌子、椅子等高於地面的平台上。
- ! 兒童保護裝置不能安裝於前座之位置。
- ! 請勿將任何物品置於支撐腳附近。
- ! 請時常查看ISOFIX導向器是否有髒汙，必要時請清洗導向器。髒汙、灰塵、食物殘渣等會影響產品安裝的穩定性。
- ! 以下汽車座椅不能安裝本兒童保護裝置：
 1. 不具備ISOFIX固定裝置的汽車座椅。
 2. 相對於汽車的行駛方向，橫向或後向的汽車座椅。
 3. 安裝時不穩定的汽車座椅。

緊急情況處理

遇緊急事件或事故時，需迅速急救或送醫治療照顧您的寶實是非常重要的。

產品資訊

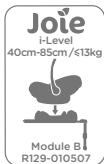

1. 此兒童安全座椅與底座組合構成“半通用型”兒童保護裝置，符合安全標準CNS 11497。用於裝有ISOFIX固定器系統之車輛座椅。
2. 其他車輛型式亦有可能適用此兒童保護裝置。若有疑問，請洽兒童保護裝置代理商或撥0800-001-256/02-25781188

用ISOFIX固定器系統安裝

1. 此為ISOFIX兒童保護裝置，符合安全標準CNS 11497及歐盟標準ECE R129/01。適用於裝有ISOFIX固定器系統之車輛座椅。
2. 本兒童保護裝置安裝適用於車輛配有經認可之ISOFIX安裝位置。（請參照車輛使用手冊）請依此兒童保護裝置之種類及ISOFIX尺度等級，安裝於附有ISOFIX固定器系統之車輛座椅上。
3. 此兒童保護裝置使用之ISOFIX尺度等級為：C和D級。
4. 若有疑問，請洽兒童保護裝置製造商或車輛使用手冊。

Allison Baby UK Ltd.

Venture Point, Towers Business Park,
Rugeley, Staffordshire, WS15 1UZ

www.joiebaby.com

產品名稱	汽車用兒童保護裝置
產品型號	I1510G
適用範圍	13kg (約1.5歲) 以下的寶實
主要材質	塑膠、五金、布
質量等級	0+
淨重	10.61kg
產品尺寸	750mmx440mmx1080mm
製造日期	詳見產品上貼紙日期(年/月/日)
專利號碼	專利申請中
原產地	中國

委製商	巧兒宜國際股份有限公司
進口商	巧兒宜國際股份有限公司
地址	台北市內湖區瑞光路431號2樓
電話	02-27973000
統一編號	52603333

代理商	奇哥股份有限公司 Chickabiddy Co., Ltd
地址	台北市南京東路四段186號5樓
服務專線	0800-001-256 / 02-25781188
統一編號	04222671
網址	www.chick.com.tw

安裝注意事項

見圖 ① - ②

- ! 此產品只適合安裝在設置有ISOFIX固定裝置的汽車座椅上①
- ! 請勿將此產品安裝在相對於汽車的行駛方向橫向或後向② -1 或有空氣囊② -2 的汽車座椅上。
- ! 請勿將此產品安裝在前座上，防止意外發生時造成實質傷亡② -3
- ! 請勿將此產品安裝於可移動的汽車座椅上。

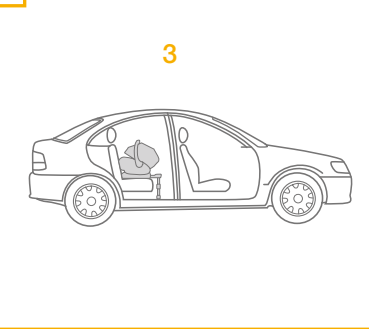
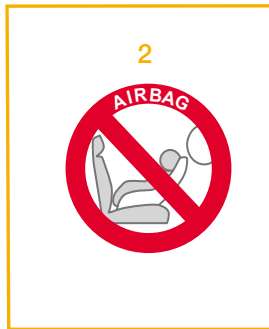
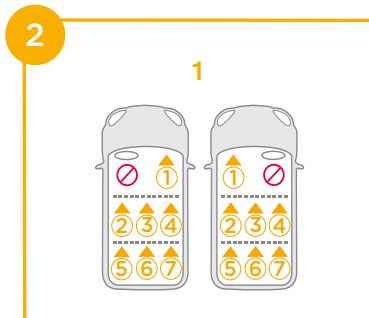
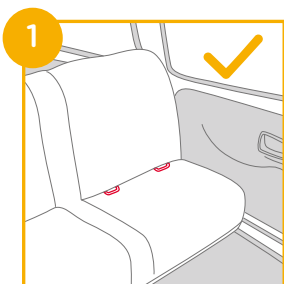

調整把手

見圖 ③ - ④

把手有2個段位可供調整③

- 1) 手提或置於汽車內時，請用段位1③ -1
- 2) 當作嬰兒椅使用時，請用段位2③ -2

調整把手位置時，先按壓兩邊的把手調整按鈕④ -1，將把手旋轉到適合段位後再鬆開把手調整按鈕④ -2

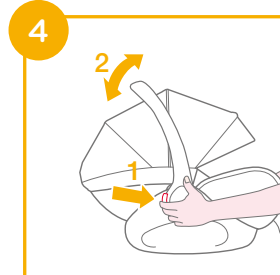
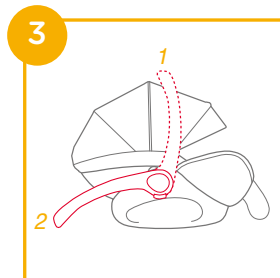

安裝底座

見圖 5 - 14

1. 將 ISOFIX 導向器固定到 ISOFIX 固定點上，ISOFIX 導向器既可防止汽車座椅表面被刮破，又可為 ISOFIX 連接器安裝導向⁵

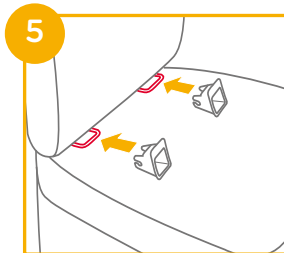

2. 展開底座支撐腳⁶

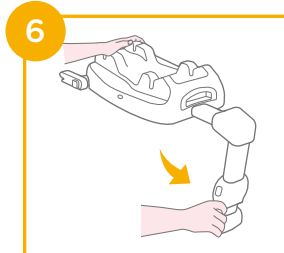

3. 將 ISOFIX 連接器與 ISOFIX 導向器對齊後，將 ISOFIX 連接器插到 ISOFIX 固定點上⁷

! 請確定左右兩邊的 ISOFIX 連接器都已牢固固定到 ISOFIX 固定點上。且兩個 ISOFIX 連接器上的指示器應顯示綠色⁷-1

! 同時往外拉兩邊的 ISOFIX 連接器，以確保 ISOFIX 連接器牢固固定。

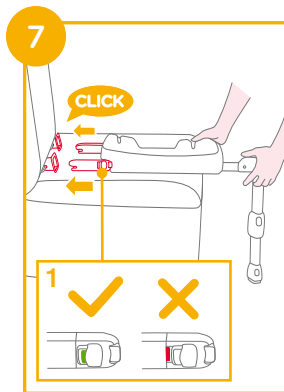

4. 將底座置於合適的汽車座椅，將支撐腳延伸到地面⁸。支撐腳正確安裝時，支撐腳指示器顯示綠色，否則顯示紅色⁸-3

! 支撐腳有 24 個調整段位，支撐腳指示器顯示紅色時，表示支撐腳處於錯誤段位，請重新操作至正確位置為止。

! 請確保支撐腳與汽車地面完全接觸。

! 按壓支撐腳調整按鈕可將支撐腳向上調整。

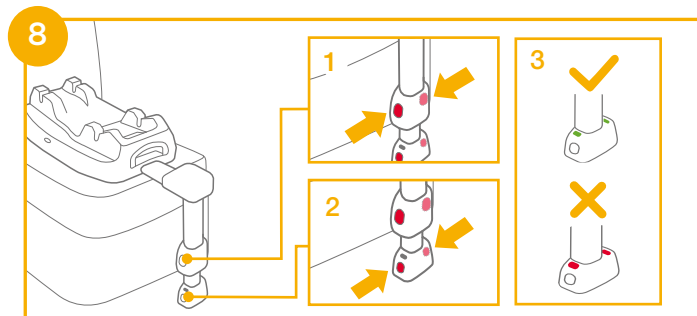

5. 底座安裝好後如圖⁹所示。

! ISOFIX 連接器須鎖定在 ISOFIX 固定點上⁹-1

! 底座支撐腳須正確固定，並以綠色顯示⁹-2

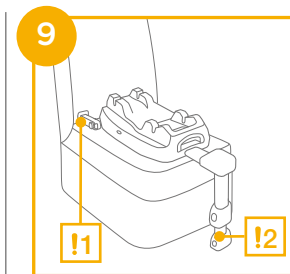

6. 將嬰兒提籃卡入底座內¹⁰，如果提籃固定正確，提籃指示器將顯示綠色，否則顯示紅色¹¹

! 將嬰兒提籃向上提，以確保提籃已正確固定於底座內。

7. 按壓底座釋鎖按鈕同時將底座緊貼汽車座椅背靠¹²

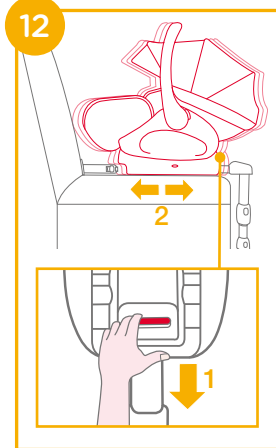
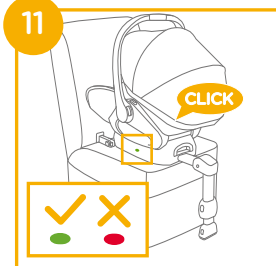
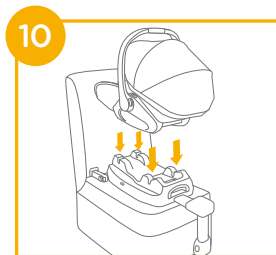

8. 釋鎖嬰兒提籃時，向外拉提籃釋鎖手把¹³-1，同時將提籃往上提即可¹³-2

9. 移除底座時，按壓兩側ISOFIX連接器上的第二道安全鎖¹⁴-1與釋鎖按鈕¹⁴-2，然後將底座向外拉即可¹⁴

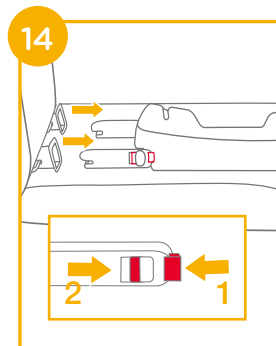
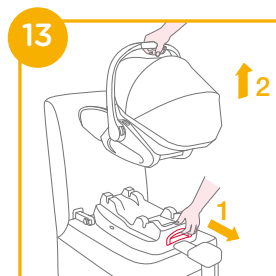

頭靠及肩帶高度調整

見圖 15 - 18

請依照寶寶的身高，選擇一對高度合適的肩帶孔。

！肩帶須穿過最接近寶寶肩膀位置的肩帶孔¹⁵，肩帶位置太高是不正確的¹⁶

！若肩帶位置不合適，意外發生時可能造成寶寶被拋出嬰兒提籃的危險。

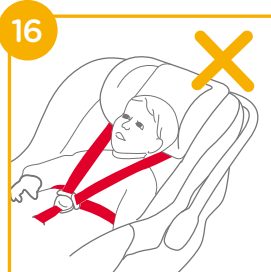
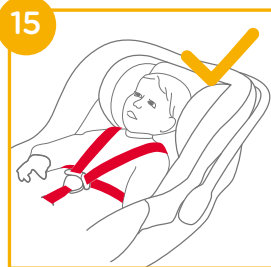

按壓頭靠調整手把¹⁷，同時上下滑動頭靠到合適高度，頭靠高度共有7個段位，調整如¹⁸所示。

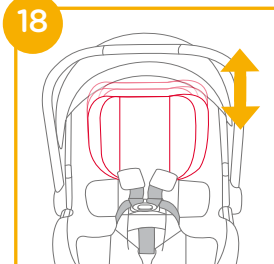

背靠角度調整

見圖 19 - 20

背靠有3個段位可供調整。

按壓背靠調整按鈕¹⁹，即可將嬰兒提籃背靠角度調至適當位置，角度調整後如圖²⁰所示。

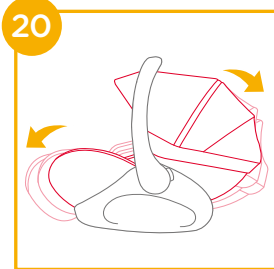
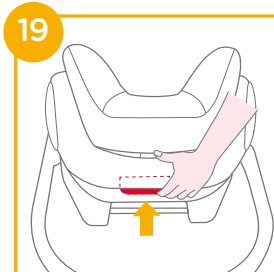

寶寶乘坐

見圖 21 - 25

注意

將寶寶放入提籃後，請確認肩帶高度是否合適。

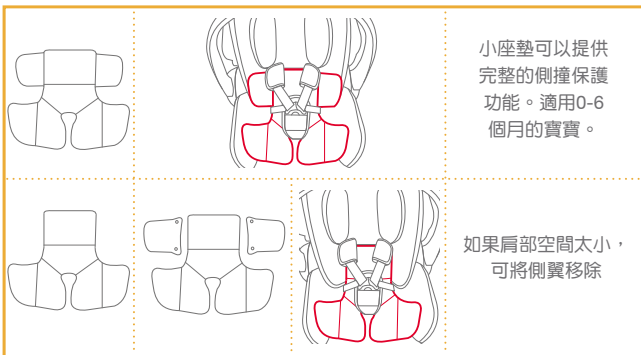

1. 按壓織帶調整按鈕，同時將肩帶拉出至適當長度²¹
2. 按壓紅色按鈕，鬆開安全扣²²

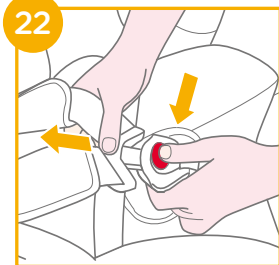
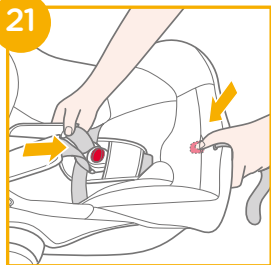

3. 將寶寶放入座椅，並扣合安全扣²³ & ²⁴

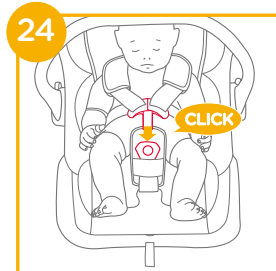
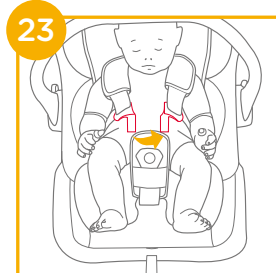

4. 下拉調整器織帶，調整肩帶至適當長度，以配合寶寶身形²⁵

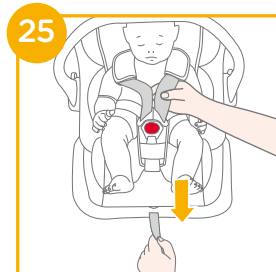

使用遮陽篷

見圖 26 - 27

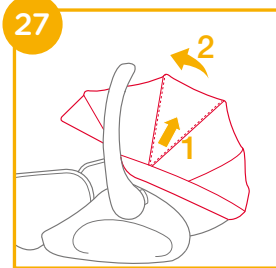
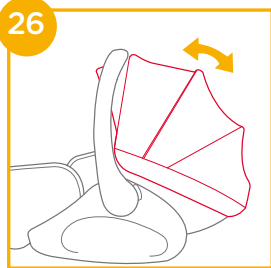

拆卸嬰兒提籃遮陽篷和座墊

見圖 28 - 40

1. 拆卸遮陽篷時，按壓遮陽篷卡座內的凸點，同時拔出遮陽篷條²⁸

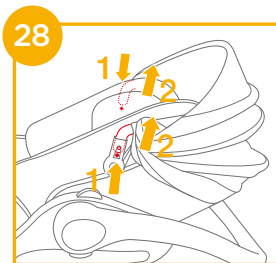

2. 解開遮陽篷兩側的鬆緊帶²⁹

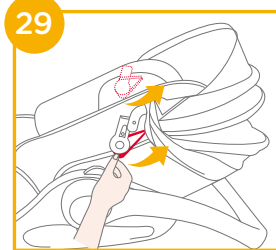

3. 然後解開遮陽篷後與座椅頭靠扣合的黏扣帶，移除遮陽篷³⁰

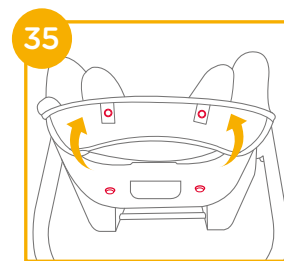
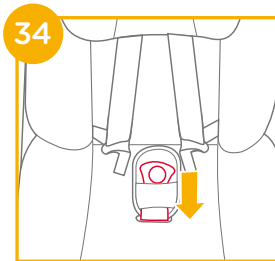
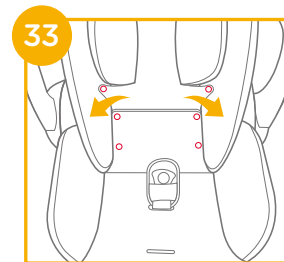
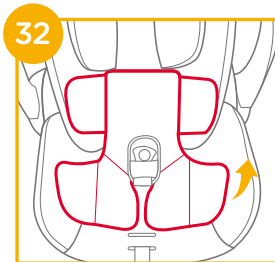
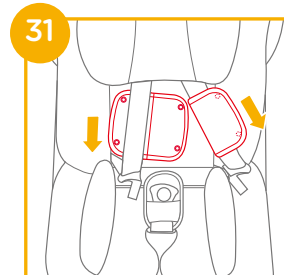
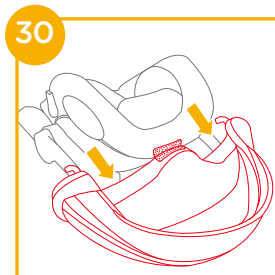

36

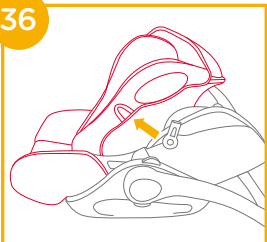

4. 將肩帶從肩帶孔穿出³⁹

5. 解開頭靠上的鬆緊帶，然後移除頭靠座布⁴⁰

反向操作即可組裝座布。

37

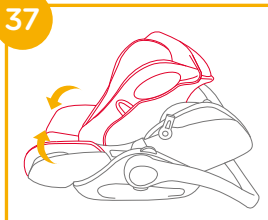

38

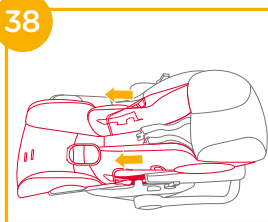

39

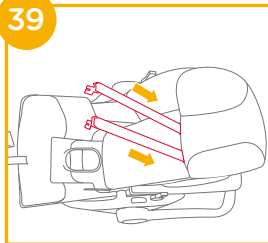

40

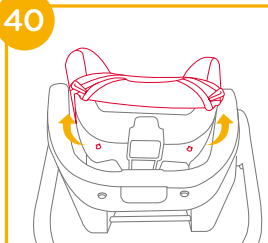

保養維護與保固

- ! 請以30度以下水溫清洗。
- ! 請勿使用熨斗熨燙。
- ! 請勿使用漂白劑及乾洗。
- ! 請勿使用未經稀釋的中性清潔劑、汽油或其他有機溶劑清洗本嬰兒提籃，否則可能對嬰兒提籃造成損壞。
- ! 請勿大力扭乾，過分大力扭乾可能留下皺褶。
- ! 請於陰涼處鋪平晾乾。
- ! 當長時間不使用本嬰兒提籃時，請將本嬰兒提籃從汽車座椅上拆除，並存放於陰涼處及寶貴不易接觸的地方。



延長保固服務

請於購買起一個月內至奇哥官網進行登錄，登錄成功後即享有商品延長一年保固服務。

汽車安裝資訊

1. 此兒童安全座椅與底座組合構成“半通用型”兒童保護裝置，符合安全標準CNS 11497。用於裝有ISOFIX固定器系統之車輛座椅。
2. 其他車輛型式亦有可能適用此兒童保護裝置，以下車型主要為歐洲銷售車款安裝適配性資料。如有疑問，請洽兒童保護裝置製造商或代理商。
3. 兒童保護裝置不能安裝於前座之位置。
4. 嚴禁將本兒童安全座椅裝置於有空氣囊的座位上使用。
5. • 表示汽車座椅可安裝本兒童保護裝置。
6. x 表示汽車座椅不可安裝本兒童保護裝置。
7. ⚡ 表示用電或其它混合驅動的車輛。
8. SBI 表示汽車地板下有儲存盒。消費者要參考汽車使用手冊在儲存盒內使用支撐腳。
9. 如果您的汽車品牌未被列入本說明書或未用“•”或“x”進行標示，請查閱您的汽車手冊或聯絡兒童約束系統製造商，以進一步了解相關資訊。

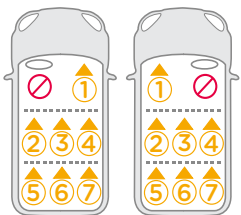

NOTE

Joie™ signature

i-Level™ enhanced child restraint

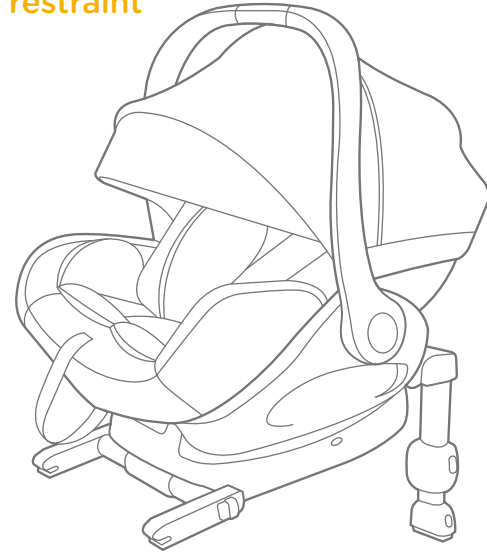

Welcome to Joie™

Congratulations on becoming part of the Joie family. We are so excited to be part of your journey with your little one. While traveling with the Joie i-Level™ enhanced child restraint you are using a high quality, fully certified safety i-Size enhanced child restraint. Please carefully read this manual and follow each step to ensure a comfortable ride and best protection for your child.

To use this Joie enhanced child restraint with the i-Size ISOFIX connections according to the CNS 11497 and ECE R129/01 Regulation, your child must meet the following requirements.

Child height 40cm-85cm/ Child weight≤13kg; (approximately 1.5 years old or under).

Base

These instructions show the use of the infant carrier and the base. Please read all the instructions in this manual before installing and using the product.

**IMPORTANT: KEEP FOR FUTURE REFERENCE.
PLEASE READ CAREFULLY.**

Please keep the instruction manual at the bottom of the soft goods.



Parts List

Please make sure there are no missing parts. Please contact the retailer if anything is missing.

- | | | | |
|----|----------------------------|----|------------------------------|
| 1 | Handle | 12 | Shell Indicator |
| 2 | Hood | 13 | ISOFIX Connector |
| 3 | Soft Goods | 14 | ISOFIX Releasing Button |
| 4 | Harness Adjustment Button | 15 | ISOFIX Guides |
| 5 | Webbing Adjuster | 16 | Load Leg Adjustment Button A |
| 6 | Buckle | 17 | Load Leg Adjustment Button B |
| 7 | Shoulder Harness | 18 | Load Leg |
| 8 | Harness Connectors | 19 | Attachment Releasing Handle |
| 9 | Harness Buckle | 20 | Attachment Hook |
| 10 | Handle Adjuster Button | | |
| 11 | Backrest Adjustment Button | | |

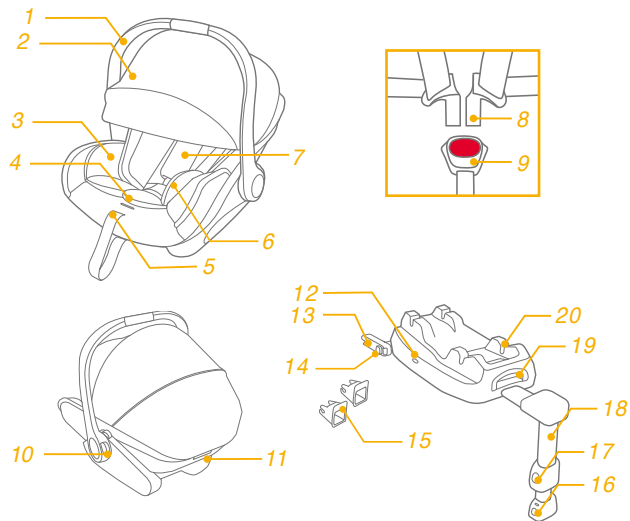

WARNING

- ! To use this enhanced child restraint with the ISOFIX connections according to the ECE R129/01 Regulation, your child must meet the following requirements.
Child height 40cm-85cm/ Child weight \leq 13kg (approximately 1.5 years old or under).
- ! Any straps holding the enhanced child restraint to the vehicle should be tight, that any straps restraining the child should be adjusted to the child's body, and that straps should not be twisted.
- ! After your child is placed in this Enhanced child restraint, the safety belt must be used correctly, and ensure that any lap strap is worn low down, so that the pelvis is firmly engaged.
- ! This Enhanced child restraint or base should be changed when they have been subject to violent stresses in an accident. An accident can cause damage to them that you cannot see.
- ! Concern the danger of making any alterations or additions to the device without the approval of the Type Approval Authority, and a danger of not following closely the installation instructions provided by the child restraint manufacturer.
- ! Please keep this enhanced child restraint away from sunlight, because it may be too hot for child's skin. Always touch the enhanced child restraint before placing child in it.
- ! Child is not left in the enhanced child restraint system unattended.
- ! Any luggage or other objects liable to cause injuries in the event of a collision shall be properly secured.
- ! The Enhanced child restraint shall not be used without the soft goods.
- ! The soft goods should not be replaced with any other than the one recommended by the manufacturer, because the soft goods constitutes an integral part of the restraint performance.
- ! DO NOT use any load bearing contact points other than those described in the instructions and marked on the enhanced child restraint.
- ! Please check before you purchase this enhanced child restraint to make sure it can be installed properly in your vehicle.

WARNING

- ! NO enhanced child restraint can guarantee full protection from injury in an accident. However, proper use of this enhanced child restraint will reduce the risk of serious injury or death to your child.
- ! DO NOT install this enhanced child restraint without following the instructions in this manual or you may put your child at serious risk of injury or death.
- ! DO NOT use this enhanced child restraint if it has damaged or missing parts.
- ! DO NOT have your child in large/oversized clothes because this may prevent your child from being properly and securely fastened by the shoulder harness straps and the crotch strap between the legs.
- ! DO NOT leave this enhanced child restraint or other items unbelted or unsecured in your vehicle because an unsecured enhanced child restraint can be thrown around and may injure occupants in a sharp turn, sudden stop, or collision.
- ! Do not place this enhanced child restraint in seating positions where an active frontal airbag is installed. Death or serious injury may occur. Please reference vehicle owner's manual for more information.
- ! NEVER use a second-hand enhanced child restraint or an enhanced child restraint whose history you do not know because it may have structural damage that compromises your child's safety.
- ! NEVER use ropes or any other substitutes to secure enhanced child restraint in vehicle or to secure child into enhanced child restraint.
- ! DO NOT put anything other than the recommended inner cushions in this enhanced child restraint.
- ! Be sure that the enhanced child restraint is installed in such a way that no part of it interferes with movable seats or in the operation of vehicle doors.
- ! Remove this infant carrier and base from the vehicle seat when it is not in regular use.
- ! Consult the distributor for issues concerning maintenance, repair and part replacement.
- ! To avoid the risk of falling out, always secure the child using the child harness when the child is placed in infant carrier, even when the enhanced child restraint is not in the vehicle.

WARNING

- ! Before carrying the infant carrier by hand, ensure that the child is fastened with the child harness, and that the handle is correctly locked in a vertical position.
- ! To avoid serious injury or death, NEVER place infant carrier on elevated surface seat with child in it.
- ! The parts of this enhanced child restraint should not be lubricated in any way.
- ! Always secure child in enhanced child restraint, even on short trips, as this is when most accidents occur.
- ! DO NOT use this enhanced child restraint for more than 5 years after the purchase date as parts may degrade over time, or from exposure to sunlight, and may not perform adequately in a crash.
- ! Frequently check the ISOFIX guides for dirt and clean them if necessary. Reliability can be effected by ingress of dirt, dust, food particles etc.
- ! DO NOT place any objects in the load leg area in front of your base.

Emergency

In case of emergency or accidents, it is most important to have your child taken care of with first aid and medical treatment immediately.

Product Information



"i-Size" (Integral Universal ISOFIX Enhanced Child Restraint Systems) is a category of Enhanced child restraint System for use in all i-Size seating position of a vehicle.

1. According to the ECE R129/01 Regulation, the infant carrier with Base is a Universal ISOFIX Class C, D enhanced child restraint and should be fitted using the ISOFIX connections.
2. This is an "i-Size" enhanced child restraint System. It is approved to Regulation ECE R129/01, for use in, "i-Size compatible" vehicle seating positions as indicated by vehicle manufacturers in the vehicle users' manual.
3. If in doubt please consult the enhanced child restraint manufacturer or the retailer. This is an i-Size ISOFIX ENHANCED CHILD RESTRAINT SYSTEM.

It is approved to ECE R129/01 series of amendments, not all vehicle manufacture's handbooks list i-Size compatibility yet. This seat and base is also approved for use in ISOFIX compatible vehicles. Please refer to the vehicle manufacturer's website or consult your dealer.

It will fit vehicles with positions approved as i-Size ISOFIX positions (as detailed in the vehicle handbook), depending on the category of the enhanced child restraint and of the fixture.

Allison Baby UK Ltd.

Venture Point, Towers Business Park,
Rugeley, Staffordshire, WS15 1UZ

Product Enhanced Child Restraint
Model I1510G
Suitable for Child height 40cm-85cm/ Child weight≤13kg
(approximately 1.5 years old or under)
Materials Plastics, metal, fabrics
Net Weight 10.61kg
Product Size 750mmx440mmx1080mm
Date Please see detailed date on label (year / month / day)
Patent No. Patents pending
Made in China

Distributor Chickabiddy Co., Ltd
Address 5th FL, 186, Nanking E. Rd, Sec. 4, Taipei
Taiwan 10595
Tel. 0800-001-256 / 02-25781188
Website www.chick.com.tw

Concerns on Installation

see images ① - ②

! This infant carrier is suitable for vehicle seats with i-Size ISOFIX anchor points with the Base. ①

! DO NOT install this enhanced child restraint on vehicle seats that face sideways or rearward with respect to the moving direction of the vehicle. ② -1

! DO NOT place rear-facing enhanced child restraint on front seat with air bag ② -2, because death or serious injury may occur. Please reference vehicle owner's manual for more information.

! It is recommended to install this enhanced child restraint on the rear vehicle seat. ② -3

! DO NOT install this enhanced child restraint on vehicle seats movable during installation.

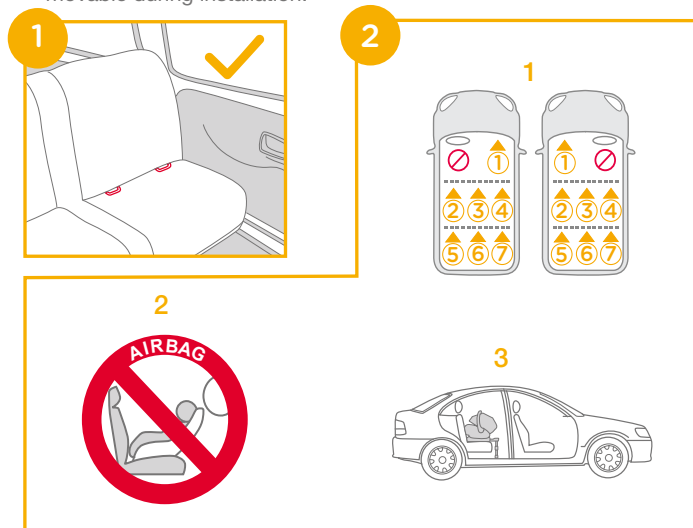

Handle Adjustment

see images 3 - 4

The handle of the infant carrier can be adjusted to 2 positions. 3

Position 1 Position for car, hand transportation.

Position 2 Baby chair position.

To adjust the handle, squeeze the handle buttons on both sides to release it 4 -1, and then rotate the handle until it clicks into any of the 2 positions. 4 -2

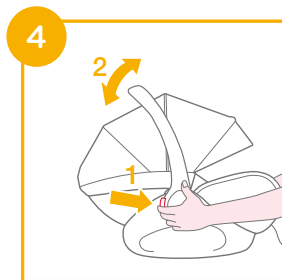
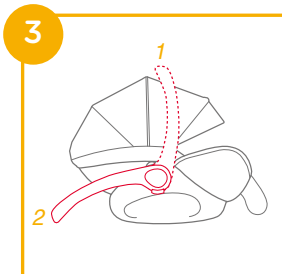

Installation with base

see images 5 - 14

1. Fit the ISOFIX guides with the ISOFIX anchor points. 5
The ISOFIX guides can protect the surface of the vehicle seat from being torn. They can also guide the ISOFIX connectors.

2. Unfold the load leg from storage compartment. 6

3. Line up the ISOFIX connectors with the ISOFIX guides, and then click both ISOFIX connectors into the ISOFIX anchor points. 7

! Make sure that both ISOFIX connectors are securely attached to their ISOFIX anchor points. There should be two audible clicks and the colors of the indicators on the both ISOFIX connectors should be completely green. 7 -1

! Check to make sure the base is securely installed by pulling on the both ISOFIX connectors.

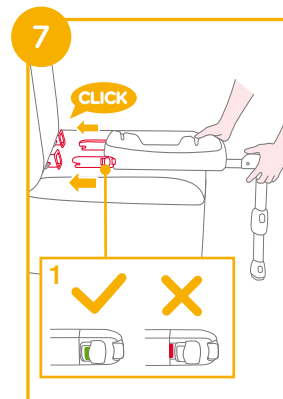
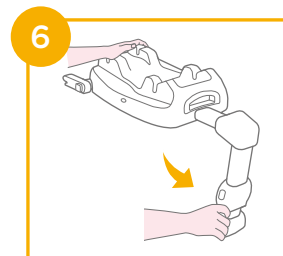
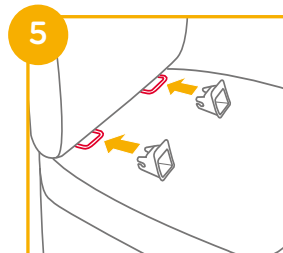

4. After placing the base on the vehicle seat, extend the load leg to floor **8**, When the load leg indicator shows green means it is installed correctly, red means it is installed incorrectly. **8 -3**

! The load leg has 24 positions. When the load leg indicator shows red this means the load leg is in the wrong position.

! Make sure the load leg is in full contact with the vehicle floor pan.

! Squeeze the load leg releasing button, then shorten the load leg upwards.

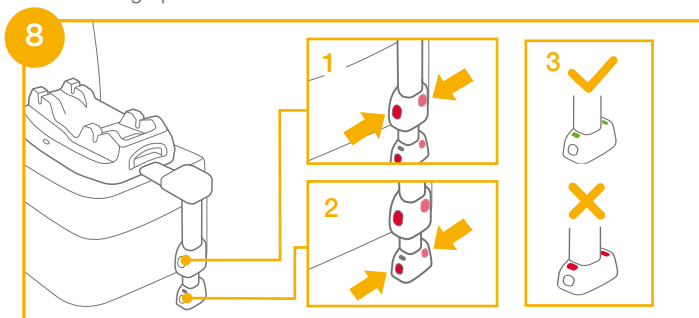

5. The completely assembled base is shown as **9**

! The ISOFIX connectors must be attached and locked onto the ISOFIX anchor points. **9 -1**

! The load leg must be installed correctly with green indicator. **9 -2**

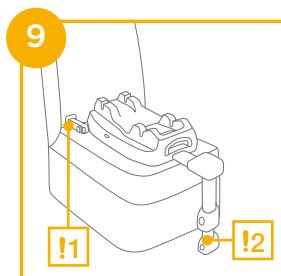

6. Push the infant carrier down into the base **10**, if the enhanced child restraint is secure, the enhanced child restraint indicator shows green. **11**

! Pull up on the infant carrier to be sure it is securely latched into the base.

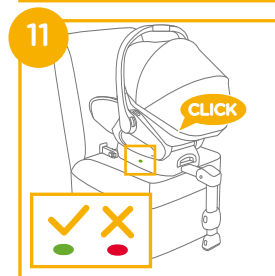
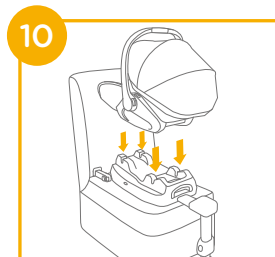

7. Press the base release button and push the base back against the vehicle seat until tight. **12**

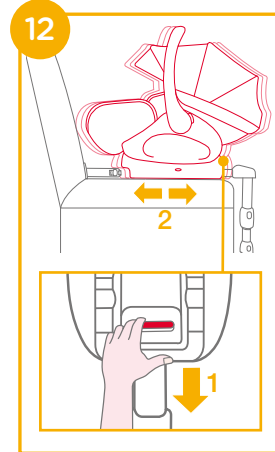

8. To release the infant carrier, pull the infant carrier up 13 -2 while pull out the attachment releasing handle. 13 -1

9. To remove the base, press the secondary lock button 14 -1 first and then the ISOFIX releasing button 14 -2 on the ISOFIX connectors before removing the base from the vehicle seat. 14

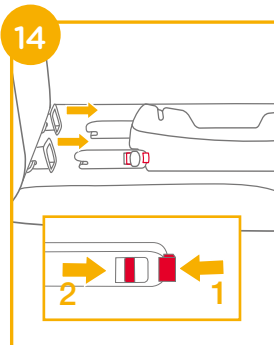

Height Adjustment for Head Support and Shoulder Harnesses

see images 15 - 18

Check that shoulder harness straps are set at the proper height. please choose the proper pair of shoulder harness slots according to the child's height.

! The bottom of headrest must be level with the highest point of child's shoulder, it is shown as 15, but not above the shoulder line. 16

! If the shoulder harness straps are not at proper height, the child might be ejected from the enhanced child restraint if there is a crash.

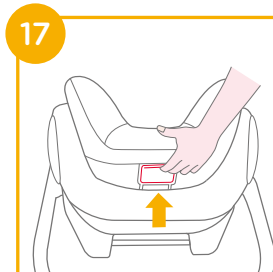

Squeeze the head support adjustment lever ¹⁷, meanwhile pull up or push down the head support until it snaps into one of the 7 positions. The head support positions are shown as ¹⁸

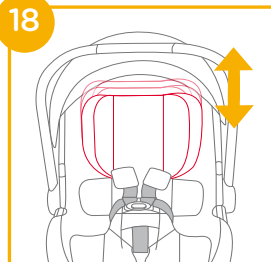

Adjust Backrest

see images ¹⁹ - ²⁰

There are 3 angles for the backrest.

Please press backrest adjustment button to heighten or lower the backrest.

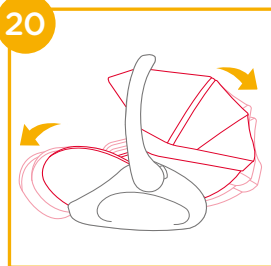

Securing Child in the Enhanced child restraint

see images ²¹ - ²⁵

Note

After the child is placed in the seat, check if the shoulder harnesses are set to the correct height.

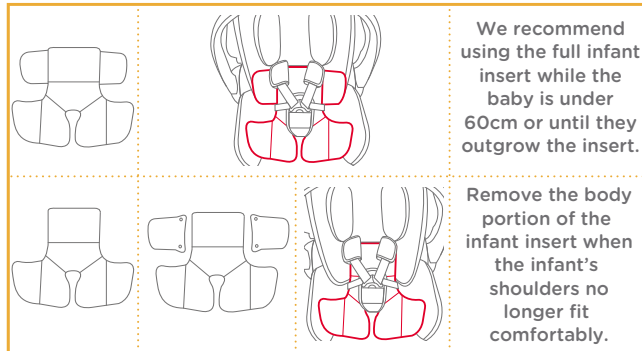

1. While pressing the harness adjustment button, pull completely the two shoulder harnesses of the infant carrier. ²¹
2. Unlock the buckle of the harnesses by pressing the red button. ²²

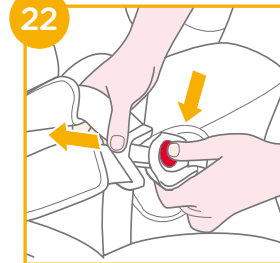
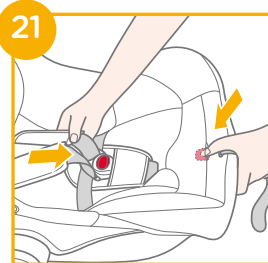

3. Place child into the infant carrier and lock the buckle. 23 & 24

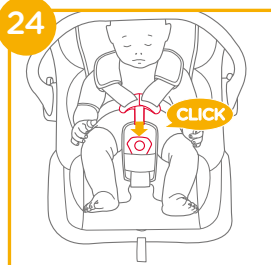

4. Tighten the shoulder harnesses by pulling adjustment webbing. 25

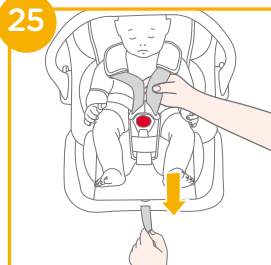

Use Canopy

see images 26 - 27

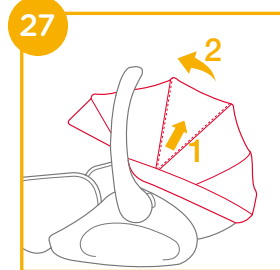
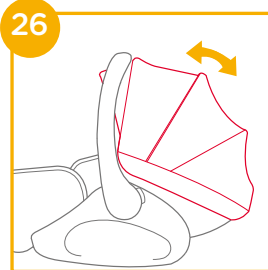

Detaching Hood and Seat Pad

see images 28 - 40

1. To detach the hood, simultaneously press the button in the hood mount to pull the hood bow out 28

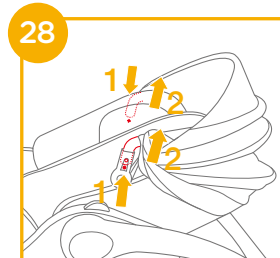

2. Detach the elastic bands on the hood mount. 29

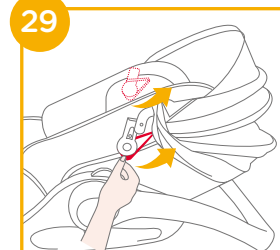

3. Then detach the hook and loop fasteners on the head support soft goods to remove the hood. ³⁰

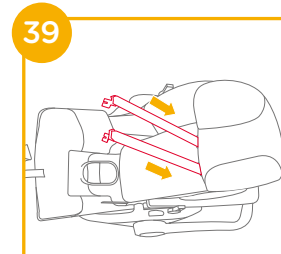
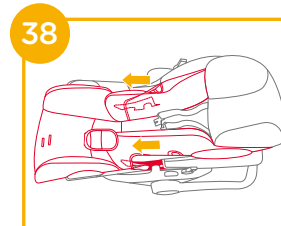
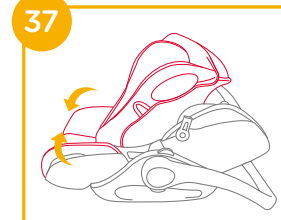
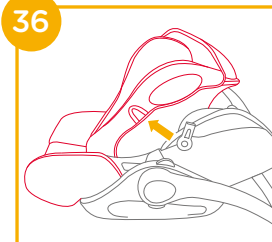
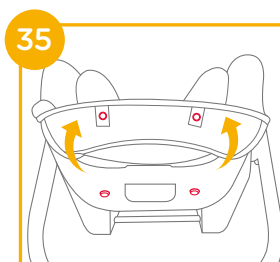
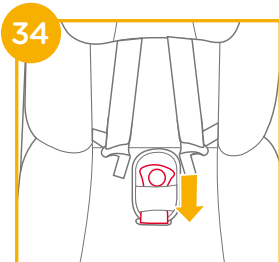
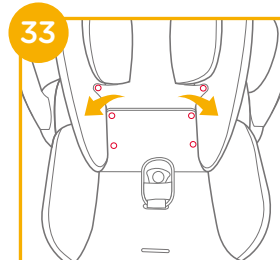
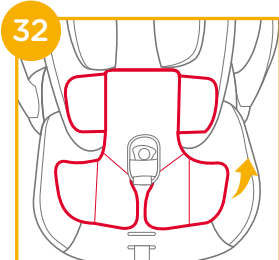
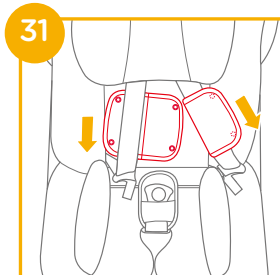
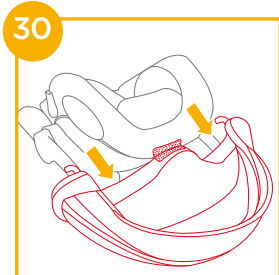

4. Thread the shoulder harness through the shoulder harness slot. ³⁹

5. Detach the elastic bands on the back of head support to remove the head support soft goods. ⁴⁰

To re-assemble the soft goods, reverse the aforementioned steps.

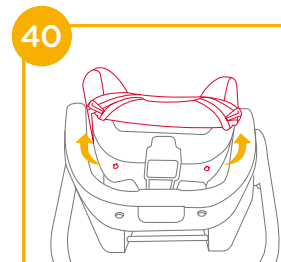

Care and Maintenance

- ! Please wash the seat cover and inner padding with cold water under 30°C.
- ! Do not iron the soft goods.
- ! Do not bleach or dry clean the soft goods.
- ! Do not use undiluted detergents gasoline or other organic solvent to wash the infant carrier or base. It may cause damage to the enhanced child restraint.
- ! Do not twist the seat cover and inner padding in an attempt to dry. It may leave the seat cover and inner padding with wrinkles.
- ! Please hang dry the seat cover and inner padding in the shade.
- ! Please remove the infant carrier and base from the vehicle seat if not in use for a long period of time. Put the enhanced child restraint in a cool, dry place and somewhere your child cannot access it.



Vehicle Fitting Information

This Joie enhanced child restraint is approved to Regulation No.129. It is suitable to fix into seat positions in most cars. The numbers on the diagram below correspond with the vehicle fitting positions listed in the following pages.

Seat positions in other cars may also be suitable to accept the base. If in doubt, consult either the enhanced child restraint manufacturer or the retailer.

ALWAYS give priority to the rear seats of your vehicle.

Don't use it on front seat with active airbag when installed in rear facing mode.

Don't use the vehicle belt to fix this enhanced child restraint system.

If your enhanced child restraint can be fitted, it is marked with •

If your enhanced child restraint cannot be fitted, it is marked with x

Electric or hybrid vehicles are marked with ⚡

Vehicles with under-floor storage boxes are marked with ! SB

-Please consult your vehicle user manual or dealer when fitting this seat in a vehicle with under-floor storage boxes.

If your vehicle is not listed in this manual or it is not marked with either a • or x then please refer to your vehicle's handbook or contact the manufacturer for further information.

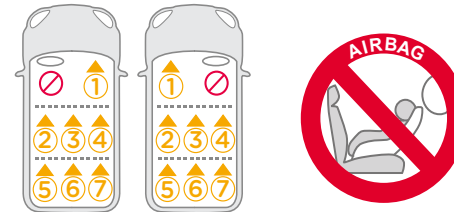

Alfa Romeo

① ② ③ ④ ⑤ ⑥ ⑦

4C Coupe (2013>)	X	-	-	-	-	-	-
Giulia (2017>)	X	•	X	•	-	-	-
Giulietta (2010 - 2016)	X	•	X	•	-	-	-
Giulietta (2016>)	X	•	X	•	-	-	-
GT Sportcoupe (2004)	X	•	X	•	-	-	-
MiTo (2009 - 2016)	X	•	-	-	-	-	-
MiTo (2016>)	X	•	-	-	-	-	-
Stelvio (2017>)	X	•	X	•	-	-	-
156 Sportswagon (1997 - 2005)	X	•	X	•	-	-	-
159 (2005 - 2011)	X	•	X	•	-	-	-

Audi

A1 (2010 - 2012)	X	•	X	•	-	-	-
A1 Sportback (2012 - 2014)	X	•	X	•	-	-	-
A1 Sportback (2014>)	X	•	X	•	-	-	-
A3 (1996 - 2003)	X	•	X	•	-	-	-
A3 (2004 - 2011)	X	•	X	•	-	-	-
A3 Hatch (2012 - 2016)	X	•	X	•	-	-	-
AS/S3 (2012 - 2016)	X	•	X	•	-	-	-
⚡ A3 e-Tron Sportback (2013 - 2016)	X	•	X	•	-	-	-
A3/S3 Saloon (2014>)	X	•	X	•	-	-	-
A3 Saloon (2016>)	X	•	X	•	-	-	-
A4 (2005 - 2009)	X	•	X	•	-	-	-
A4/S4 (2009 - 2014)	X	•	X	•	-	-	-
A4 (2012 - 2016)	X	•	X	•	-	-	-
A4/S4 (2015>)	X	•	X	•	-	-	-
A4 Allroad (2008 - 2016)	X	•	X	•	-	-	-
A4/S4 Avant (2008 - 2016)	X	•	X	•	-	-	-
A4 Avant (2015>)	X	•	X	•	-	-	-
A4/S4 Saloon (2008 - 2016)	X	•	X	•	-	-	-
A4 Saloon (2015>)	X	•	X	•	-	-	-
A5 (2007 - 2011)	X	•	X	•	-	-	-
A5 (2016>)	X	•	-	-	-	-	-
A5 Coupe (2006 - 2016)	X	•	-	-	-	-	-
A5 Coupe (2016>)	X	•	-	-	-	-	-
A5/S5 Coupe (2016>)	X	•	-	-	-	-	-
A5/S5 Sportback (2007 - 2016)	X	•	-	-	-	-	-
A5/S5 Sportback (2017>)	X	•	X	•	-	-	-

① ② ③ ④ ⑤ ⑥ ⑦

A6 (2011>)	X	•	X	•	-	-	-
A6/S6 (2011 - 2014)	X	•	X	•	-	-	-
A6/S6 (2014 - 2018)	X	•	X	•	-	-	-
A6 Allroad (2011 - 2016)	X	•	X	•	-	-	-
A6 Allroad (2016>)	X	•	X	•	-	-	-
A6 Avant (2011 - 2014)	X	•	X	•	-	-	-
A7 Sportback (2010 - 2014)	X	•	X	•	-	-	-
A7/S7 Sportback (2014 - 2017)	X	•	X	•	-	-	-
A7 Sportback (2017>)	X	•	X	•	-	-	-
A8 (2011 - 2013)	X	•	X	•	-	-	-
A8/S8 (2011 - 2013)	X	•	X	•	-	-	-
A8 (2017>)	X	•	X	•	-	-	-
Q2 (2016>)	X	•	X	•	-	-	-
Q3 (2011 - 2017)	X	•	X	•	-	-	-
Q3 (2017>)	X	•	X	•	-	-	-
Q5 (2008 - 2012)	X	•	X	•	-	-	-
Q5/SQ5 (2012 - 2016)	X	•	X	•	-	-	-
Q5 (2016>)	X	•	X	•	-	-	-
Q7 (2006 - 2015)	X	•	X	•	-	-	-
Q7/SQ7 (2015>)	X	•	X	•	X	-	X
S1 (2014>)	X	•	X	•	-	-	-
TT Coupe (2006 - 2014)	X	X	-	X	-	-	-
TT Coupe Sport (2014>)	X	•	X	•	-	-	-

Bentley

Continental Flying Spur (2005 - 2008)	X	•	X	•	-	-	-
Continental GT (2003 - 2012)	X	X	-	X	-	-	-
Continental GTC (2006 - 2012)	X	X	-	X	-	-	-
Mulsanne (2009 - 2016)	X	•	X	•	-	-	-

BMW

1-Series 5dr (2004 - 2011)	X	•	X	•	-	-	-
1 Series F20 (2011 - 2015)	X	•	X	•	-	-	-
1-Series Convertible (2008 - 2015)	X	•	-	-	-	-	-
1-Series Coupe (2008 - 2015)	X	•	-	-	-	-	-
2-Series AC-T (2015 - 2018)	X	•	X	•	-	-	-
2-Series Coupe (2014>)	X	•	-	-	-	-	-

2-Series Gran Tourer (2018>)	X	•	X	•	-	-	-
3-GT (2013>)	X	•	X	•	-	-	-
3-Series (2005 - 2011)	X	•	-	•	-	-	-
3 Series F30 (2012>)	X	•	X	•	-	-	-
3-Series Coupe (2007 - 2014)	X	•	-	•	-	-	-
4-Series Gran Coupe (2014 - 2018)	X	•	X	•	-	-	-
5-GT (2009 - 2013)	X	•	X	•	-	-	-
5-Series (2008 - 2010)	X	•	X	•	-	-	-
5-Series (2010 - 2016)	X	•	X	•	-	-	-
5-Series Saloon (2003 - 2010)	X	•	X	•	-	-	-
5-Series Saloon (2011 - 2016)	X	•	X	•	-	-	-
5-Series Touring (2003 - 2010)	X	•	X	•	-	-	-
5-Series Touring (2010 - 2017)	X	•	X	•	-	-	-
6-Series Convertible (2012 - 2015)	X	•	-	•	-	-	-
6-Series Coupe (2dr) (2011 - 2015)	X	•	-	•	-	-	-
6-Series Gran Coupe (4dr) (2011 - 2015)	X	•	X	•	-	-	-
7-Series (2008 - 2012)	X	•	X	•	-	-	-
7-Series (2016>)	X	•	X	•	-	-	-
⚡ i3 (2013 - 2017)	X	•	-	•	-	-	-
⚡ i8 (2014 - 2018)	X	X	X	X	•	-	-
M5 (2011 - 2016)	X	•	X	•	-	-	-
M Sport Saloon (2015>)	X	•	X	•	-	-	-
X1 (2009 - 2016)	X	•	X	•	-	-	-
X1 (2016>)	X	•	X	•	-	-	-
X2 (2018>)	X	•	X	•	-	-	-
X3 F25 (2010 - 2013)	X	•	X	•	-	-	-
X4 (2014 - 2018)	X	•	X	•	-	-	-
X5 (2007- 2014)	X	•	X	•	X	-	X
X5 (2014>)	X	•	X	•	X	-	X
X5 M (2014>)	X	•	X	•	X	-	X
X6 (2008 - 2009)	X	•	X	•	-	-	-
X6 (2014>)	X	•	-	•	-	-	-

Cadillac

BLS Saloon (2006 - 2011)	X	•	X	•	-	-	-
CTS (2003 - 2007)	X	•	X	•	-	-	-

Chevrolet

Aveo 5dr (2011 - 2015)	X	•	X	•	-	-	-
Camaro (2011 - 2015)	X	•	X	•	-	-	-
Captiva (2007 - 2015)	X	•	X	•	-	-	-
Cruze (2009 - 2014)	X	•	X	•	-	-	-
Epica (2006 - 2011)	X	•	X	•	-	-	-
HRV (2007 - 2011)	X	•	X	•	-	-	-
Kalos (2002 - 2007)	X	•	X	•	-	-	-
Lacetti (2002 - 2009)	X	•	X	•	-	-	-
Malibu (2012 - 2016)	X	•	X	•	-	-	-
Matiz (2005 - 2009)	X	•	X	•	-	-	-
Nubira (2004 - 2009)	X	•	X	•	-	-	-
Orlando (2011>)	X	•	X	•	-	-	-
Spark (2010 - 2015)	X	•	X	•	-	-	-
Traxx (2013 - 2017)	X	•	X	•	-	-	-
Volt (2011 - 2016)	X	•	-	•	-	-	-

Chrysler

300C (2012 - 2015)	X	•	X	•	-	-	-
Delta (2007 - 2014)	X	•	X	•	-	-	-
Delta (2008 - 2013)	X	•	X	•	-	-	-
Dodge Avenger (2007 - 2014)	X	•	X	•	-	-	-
Dodge Caliber (2006 - 2012)	X	•	X	•	-	-	-
Dodge Journey (2008 - 2011)	X	•	•	•	-	-	-
Dodge Nitro (2006 - 2011)	X	•	X	•	-	-	-
Dodge Ram (2002 - 2008)	X	•	•	•	-	-	-
Grand Voyager (2001 - 2007)	X	•	X	•	-	-	-
Pacifica (2003 - 2008)	X	•	X	•	-	-	-
PT Cruiser (2001 - 2010)	X	•	X	•	-	-	-
Sebring (2007 - 2010)	X	•	-	•	X	X	X
Voyager (2001 - 2007)	X	•	X	•	-	-	-
Ypsilon (2011 - 2015)	X	•	X	•	-	-	-

Citroen

Berlingo II (2008 - 2012)	X	!	SB	X	!	SB	-	-
Berlingo Multispace (2007 - 2018)	X	!	SB	X	!	SB	X	-
C1 (2006 - 2015)	X	•	-	•	-	-	-	-
C1 (2014>)	X	•	-	•	-	-	-	-

C2 (2003 - 2009)	✗	•	✗	•	•	-	-	-	-
C3 5dr (2005 - 2009)	✗	•	✗	•	•	-	-	-	-
C3 5dr (2009 - 2016)	✗	•	✗	•	•	-	-	-	-
C3 5dr (2016>)	✗	!	SB	✗	!	SB	-	-	-
C3 Picasso (2008 - 2012)	✗	!	SB	✗	!	SB	-	-	-
C4 (2010 - 2018)	✗	•	✗	•	•	-	-	-	-
C4 G-Picasso (2006 - 2013)	✗	!	SB	•	!	SB	✗	-	✗
C4 G-Picasso (2013 - 2016)	✗	!	SB	•	!	SB	✗	-	✗
C4 Picasso (2007 - 2010)	✗	!	SB	✗	!	SB	✗	✗	✗
C4 Picasso (2013 - 2018)	✗	!	SB	•	!	SB	-	-	-
C4-Cactus (2014 - 2018)	✗	•	✗	•	•	-	-	-	-
C5 (2005 - 2008)	✗	•	✗	•	•	-	-	-	-
C5 Saloon (2008 - 2016)	✗	•	✗	•	•	-	-	-	-
C5 Tourer (2008 - 2018)	✗	•	✗	•	•	-	-	-	-
C-Crosser (2007 - 2013)	✗	•	✗	•	•	-	-	-	-
DS3 (2009 - 2014)	✗	•	✗	•	•	-	-	-	-
DS3 Cabrio (2016>)	✗	•	✗	•	•	-	-	-	-
DS4 (2011 - 2015)	✗	•	✗	•	•	-	-	-	-
DS5 (2012 - 2015)	✗	•	✗	•	•	-	-	-	-
Evasion (1998 - 2002)	✗	•	✗	•	•	✗	•	•	•
Jumpy (2007 - 2012)	✗	•	✗	•	•	✗	✗	✗	✗
Nemo (2008 - 2015)	✗	•	✗	•	•	-	-	-	-
Saxo (1996 - 2003)	✗	•	✗	•	•	-	-	-	-
Xsara (2000 - 2006)	✗	✗	✗	✗	✗	-	-	-	-
Xsara Picasso (2000 - 2008)	✗	•	✗	•	•	-	-	-	-

Dacia

Dokker (2012>)	✗	•	•	•	•	-	-	-	-
Duster (2012 - 2017)	✗	•	✗	•	•	-	-	-	-
Duster (2017>)	✗	•	✗	•	•	-	-	-	-
Lodgy (2012>)	✗	•	•	•	•	-	-	-	-
Logan MCV (2012 - 2016)	✗	•	✗	•	•	-	-	-	-
Logan MCV (2016>)	✗	•	✗	•	•	-	-	-	-
Sandero (2012 - 2016)	✗	•	✗	•	•	-	-	-	-
Sandero (2016>)	✗	•	✗	•	•	-	-	-	-

Daihatsu

Cuore (2007 - 2011)	✗	•	✗	•	•	-	-	-	-
Materia (2006 - 2011)	✗	•	✗	•	•	-	-	-	-
Sirion (2001 - 2005)	✗	•	✗	•	•	-	-	-	-
Terios (2005>)	✗	•	✗	•	•	-	-	-	-
Trevis (2004 - 2009)	✗	•	✗	•	•	-	-	-	-

FIAT

124 Spider (2016>)	✗	-	-	-	-	-	-	-	-
500 (2008>)	✗	•	-	•	-	-	-	-	-
500 C (2009>)	✗	•	-	•	-	-	-	-	-
500L (2012>)	✗	•	✗	•	•	-	-	-	-
500X (2015 - 2018)	✗	•	✗	•	•	-	-	-	-
Abarth 500 (2009 - 2015)	✗	•	-	•	-	-	-	-	-
Abarth 595 (2018>)	✗	•	-	•	-	-	-	-	-
Abarth Grande Punto (2008 - 2011)	✗	•	✗	•	•	-	-	-	-
GBT Punto (2014>)	✗	•	✗	•	•	-	-	-	-
Bravo (2007 - 2010)	✗	•	✗	•	•	-	-	-	-
Croma (2005 - 2011)	✗	•	✗	•	•	-	-	-	-
Doblo (2005 - 2010)	✗	•	✗	•	•	-	-	-	-
Doblo (2010>)	✗	•	✗	•	•	-	-	-	-
Grande Punto (2006 - 2009)	✗	•	✗	•	•	-	-	-	-
Idea (2003 - 2007)	✗	•	✗	•	•	-	-	-	-
Linea (2006 - 2015)	✗	•	✗	•	•	-	-	-	-
Multipla (2004 - 2007)	✗	•	✗	•	•	-	-	-	-
Panda (2011>)	✗	•	✗	•	•	-	-	-	-
Qubo (2008>)	✗	•	✗	•	•	-	-	-	-
Scudo II (2007 - 2016)	✗	•	✗	•	•	•	•	✗	•
Sedici (2006 - 2011)	✗	•	✗	•	•	-	-	-	-
Stilo (2001 - 2007)	✗	•	✗	•	•	-	-	-	-
Tipo (2015>)	✗	•	✗	•	•	-	-	-	-
Ulysse (2002 - 2007)	✗	•	•	•	•	•	✗	•	•

Ford

B-Max (2012>)	✗	•	✗	•	•	-	-	-	-
C-Max (2003 - 2010)	✗	✗	✗	✗	✗	-	-	-	-
C-Max (2010 - 2012)	✗	•	✗	•	•	-	-	-	-
C-Max (2011>)	✗	•	✗	•	•	-	-	-	-

Grand C-Max (2010 - 2014)	X	•	X	•	-	-	-
Grand C-Max (2015>)	X	•	X	•	-	-	-
EcoSport (2013 - 2017)	X	•	X	•	-	-	-
EcoSport (2017>)	X	•	X	•	-	-	-
Edge (2015 - 2018)	X	•	X	•	X	•	X
Edge Sport (2018>)	X	•	X	•	-	-	-
Fiesta (2004 - 2008)	X	X	X	X	-	-	-
Fiesta (2008 - 2017)	X	•	X	•	-	-	-
Fiesta 3dr (2017>)	X	•	X	•	-	-	-
Fiesta 5dr (2017>)	X	•	X	•	-	-	-
Fiesta Active (2018>)	X	•	X	•	-	-	-
Focus (1998 - 2005)	X	X	X	X	-	-	-
Focus (2005 - 2009)	X	•	X	•	-	-	-
Focus (2010 - 2015)	X	•	X	•	-	-	-
Focus (2014 - 2018)	X	•	X	•	-	-	-
Focus (2018>)	X	•	X	•	-	-	-
Focus Estate (2011 - 2018)	X	•	X	•	-	-	-
⚡ Focus EV (2014 - 2018)	X	•	X	•	-	-	-
Focus ST Estate (2017>)	X	•	X	•	-	-	-
Focus RS (2018>)	X	•	X	•	-	-	-
Galaxy (2006 - 2015)	X	!	SB	X	!	SB	X
Galaxy (2016>)	X	!	SB	•	!	SB	X
Ka (2009 - 2016)	X	•	-	-	-	-	-
Ka+ (2016 - 2018)	X	•	X	•	-	-	-
Ka+ (2018>)	X	•	X	•	-	-	-
Kuga (2008 - 2012)	X	•	X	•	-	-	-
Kuga (2012 - 2016)	X	•	X	•	-	-	-
Kuga (2016>)	X	•	X	•	-	-	-
Maverick (2000 - 2007)	X	•	X	•	-	-	-
Mondeo (2002 - 2007)	X	X	X	X	-	-	-
Mondeo (2007 - 2010)	X	•	X	•	-	-	-
Mondeo (2014>)	X	•	X	•	-	-	-
Mondeo Estate (2007 - 2015)	X	•	X	•	-	-	-
Mondeo Estate (2015>)	X	•	X	•	-	-	-
Mondeo Hatchback (2007 - 2015)	X	•	X	•	-	-	-
Mondeo Hatchback (2014>)	X	•	X	•	-	-	-
Mondeo Ranger (2011 - 2015)	X	•	X	•	-	-	-
Mondeo Turnier (2007 - 2014)	X	•	X	•	-	-	-
Mondeo Vignale (2018>)	X	•	X	•	-	-	-

Honda

Mustang Coupe (2015>)	X	X	-	X	-	-	-
Mustang Cabrio (2014 - 2017)	X	X	-	X	-	-	-
S-Max (2006 - 2014)	X	!	SB	X	!	SB	X
S-Max (2014>)	X	•	•	!	SB	X	-
Tourneo Connect (2009 - 2013)	X	•	X	•	-	-	-
Tourneo Custom (2012>)	X	•	•	X	-	-	-
Transit Connect (2003 - 2007)	X	•	•	X	-	-	-
Transit Kombi (2006 - 2013)	X	•	•	X	-	-	-
Transit Custom (2012>)	X	•	•	X	-	-	-
Vignale (2018>)	X	•	X	•	-	-	-
Accord Saloon (2008 - 2012)	X	•	X	•	-	-	-
Accord Tourer (2008 - 2015)	X	•	X	•	-	-	-
City (2008 - 2014)	X	•	X	•	-	-	-
Civic (2006 - 2011)	X	•	X	•	-	-	-
Civic (2012 - 2015)	X	•	X	•	-	-	-
Civic (2016>)	X	•	X	•	-	-	-
Civic Hybrid Saloon (2006 - 2010)	X	•	X	•	-	-	-
Civic Prestige (2006 - 2010)	X	•	X	•	-	-	-
Civic Tourer (2013>)	X	•	X	•	-	-	-
Civic Type R (2007 - 2010)	X	•	X	•	-	-	-
CR-V (2007 - 2011)	X	•	X	•	-	-	-
CR-V (2011 - 2016)	X	•	X	•	-	-	-
CR-V (2016>)	X	•	X	•	-	-	-
CR-Z (2010 - 2016)	X	•	X	•	-	-	-
Elysion (2004 - 2013)	X	•	-	•	X	-	X
FRV (2005 - 2011)	X	•	X	•	-	-	-
HR-V (2014 - 2018)	X	•	X	•	-	-	-
HR-V (2018>)	X	•	X	•	-	-	-
Insight (2009 - 2012)	X	X	X	X	-	-	-
Jazz (2001 - 2008)	X	X	X	X	-	-	-
Jazz (2008 - 2015)	X	•	X	•	-	-	-
Jazz (2013 - 2017)	X	•	X	•	-	-	-
Jazz (2017>)	X	•	X	•	-	-	-
Jazz Sport (2017>)	X	•	X	•	-	-	-
Legend (2006 - 2010)	X	•	X	•	-	-	-
Odyssey (2008 - 2011)	X	X	-	X	-	-	-

Hyundai

① ② ③ ④ ⑤ ⑥ ⑦

Accent (1999 - 2003)	X	•	X	•	-	-	-	-
Coupe (1996 - 2002)	X	•	X	•	-	-	-	-
Elantra (2000 - 2003)	X	•	X	•	-	-	-	-
Excel (2002 - 2006)	X	•	X	•	-	-	-	-
Getz (2002 - 2005)	X	•	X	•	-	-	-	-
Getz (2005 - 2011)	X	•	X	•	-	-	-	-
Grandeur (2005 - 2011)	X	•	X	•	-	-	-	-
i10 (2008 - 2013)	X	•	X	•	-	-	-	-
i10 Hatch (2008 - 2013)	X	•	X	•	-	-	-	-
i20 Hatch (2009 - 2014)	X	•	X	•	-	-	-	-
i20 (2014 - 2018)	X	•	X	•	-	-	-	-
i30 (2012 - 2015)	X	•	X	•	-	-	-	-
i30 (2016>)	X	•	X	•	-	-	-	-
i40 (2011 - 2018)	X	•	X	•	-	-	-	-
Genesis Sedan (2016>)	X	•	X	•	-	-	-	-
i800/H1 (2008>)	X	•	X	•	X	X	X	X
Ioniq (2016>)	X	•	X	•	-	-	-	-
iX20 (2010>)	X	•	X	•	-	-	-	-
iX35 (2009 - 2013)	X	•	X	•	-	-	-	-
iX55 (2009>)	X	•	X	•	-	-	-	-
Kona (2017>)	X	•	X	•	-	-	-	-
Matrix (2001 - 2010)	X	•	X	•	-	-	-	-
Pony (2002 - 2006)	X	•	X	•	-	-	-	-
Santa Fe (2000 - 2004)	X	•	X	•	-	-	-	-
Santa Fe (2007 - 2012)	X	•	X	•	X	-	X	X
Santa Fe (2012 - 2016)	X	•	X	•	X	-	X	X
Santa Fe (2016>)	X	•	X	•	-	-	-	-
Tucson (2004 - 2009)	X	•	X	•	-	-	-	-
Tucson (2009 - 2013)	X	•	X	•	-	-	-	-
Tucson (2013 - 2016)	X	•	X	•	-	-	-	-
Tucson (2018>)	X	•	X	•	-	-	-	-
Veloster (2011 - 2018)	X	•	-	•	-	-	-	-
Verna (1999 - 2005)	X	•	X	•	-	-	-	-

Infiniti

EX SUV (2009 - 2015)	X	•	X	•	-	-	-	-
FX SUV (2008 - 2013)	X	•	X	•	-	-	-	-
G 70 (2016>)	X	•	X	•	-	-	-	-

① ② ③ ④ ⑤ ⑥ ⑦

Isuzu

G Coupe (2009 - 2013)	X	•	-	•	-	-	-	-
G Saloon (2009 - 2013)	X	•	X	•	-	-	-	-
M Saloon (2010 - 2014)	X	•	X	•	-	-	-	-

D-Max (2004 - 2014)	X	•	X	•	-	-	-	-
---------------------	---	---	---	---	---	---	---	---

Jaguar

E-Pace (2017>)	X	•	X	•	-	-	-	-
F-Pace (2015>)	X	•	X	•	-	-	-	-
F-Type Coupe (2014 - 2017)	X	-	-	-	-	-	-	-
S-Type (1999 - 2002)	X	•	X	•	-	-	-	-
X-Type (2001 - 2010)	X	•	X	•	X	-	-	-
X-Type Estate (2004 - 2010)	X	•	X	•	X	-	-	-
XE (2015 - 2018)	X	•	X	•	-	-	-	-
XF (2008 - 2012)	X	•	X	•	-	-	-	-
XF (2015>)	X	•	X	•	-	-	-	-
XF R (2009>)	X	•	X	•	-	-	-	-
XF Sportbrake (2012 - 2015)	X	•	X	•	-	-	-	-
XF Sportbrake (2017>)	X	•	X	•	-	-	-	-
XJ (1997 - 2003)	X	•	X	•	-	-	-	-
XJ (2009 - 2012)	X	•	X	•	-	-	-	-
XJ (2012>)	X	•	X	•	-	-	-	-
XK Coupe (2006 - 2009)	X	•	X	•	-	X	-	-
XK Convertible (2006 - 2009)	X	•	X	•	-	X	-	-
XK R (2006 - 2008)	X	•	-	•	-	-	-	-

Jeep

Cherokee (2013 - 2018)	X	•	X	•	-	-	-	-
Commander (2005 - 2007)	X	•	X	•	-	-	-	-
Compass (2011 - 2016)	X	•	X	•	-	-	-	-
Grand Cherokee (2010 - 2013)	X	•	X	•	-	-	-	-
Grand Patriot (2007 - 2014)	X	•	X	•	-	-	-	-
Renegade (2014 - 2018)	X	•	X	•	-	-	-	-
Wrangler 5dr (2006 - 2018)	X	•	X	•	X	-	-	-

Kia

① ② ③ ④ ⑤ ⑥ ⑦

Carens (2002 - 2006)	X	•	X	•	-	-	-
Carens (2013>)	X	•	X	•	X	-	X
Carnival (2002 - 2006)	X	•	X	•	-	-	•
Cee'D (2005 - 2015)	X	•	X	•	-	-	-
Cee'D Hatch (2012 - 2015)	X	•	X	•	-	-	-
Cee'D Hatch (2018>)	X	•	X	•	-	-	-
Magentis (2002 - 2005)	X	•	X	•	-	-	-
Mentor (1992 - 2003)	X	•	X	•	-	-	-
Niro (2018>)	X	•	X	•	-	-	-
Opirus (2003 - 2010)	X	•	X	•	-	-	-
Optima (2011 - 2015)	X	•	X	•	-	-	-
Optima (2016>)	X	•	X	•	-	-	-
Picanto (2004 - 2007)	X	•	X	•	-	-	-
Picanto (2011 - 2015)	X	•	X	•	-	-	-
Picanto (2017>)	X	•	X	•	-	-	-
Rio (2012 - 2016)	X	•	X	•	-	-	-
Rio (2016>)	X	•	X	•	-	-	-
Sephia (1997 - 2003)	X	•	X	•	-	-	-
Shuma (2001 - 2004)	X	•	X	•	-	-	-
Sorento (2010 - 2014)	X	•	X	•	-	-	-
Sorento (2014 - 2017)	X	•	X	•	X	-	X
Soul (2008 - 2013)	X	•	X	•	-	-	-
⚡ Soul EV (2013 - 2018)	X	•	X	•	-	-	-
⚡ Soul (2018>)	X	•	X	•	-	-	-
Spectra (2000 - 2009)	X	•	X	•	-	-	-
Sportage (2011 - 2015)	X	•	X	•	-	-	-
Sportage (2015 - 2018)	X	•	X	•	-	-	-
Sportage (2018>)	X	•	X	•	-	-	-
Stonic (2017>)	X	•	X	•	-	-	-
Venga (2009 - 2014)	X	•	X	•	-	-	-

Lancia

Delta (2008 - 2013)	X	•	X	•	-	-	-
Flavia Convertible (2012 - 2015)	X	•	X	•	-	-	-
Musa (2003 - 2012)	X	•	X	•	-	-	-
Phedra (2002 - 2010)	X	•	X	•	-	-	-
Thema (2011 - 2014)	X	•	X	•	-	-	-
Voyager (2010 - 2015)	X	•	-	-	X	X	X

① ② ③ ④ ⑤ ⑥ ⑦

Land Rover

Ypsilon (2003 - 2006)	X	•	X	•	-	-	-
Ypsilon (2011 - 2015)	X	•	X	•	-	-	-
Discovery 4 (2009 - 2013)	X	•	X	•	-	-	-
Discovery 5 (2013 - 2017)	X	•	X	•	-	-	•
Discovery 5 (2017>)	X	•	X	•	X	-	X
Discovery Sport (2014>)	X	•	X	•	X	-	X
Freelander 2 (2006 - 2009)	X	•	X	•	-	-	-
Range Rover (2002 - 2012)	X	•	X	•	-	-	-
Range Rover (2013 - 2017)	X	•	X	•	-	-	-
Range Rover Evoque 3dr (2011 - 2015)	X	•	X	•	-	-	-
Range Rover Evoque 5dr (2011 - 2015)	X	•	X	•	-	-	-
Range Rover Evoque 3dr (2018>)	X	•	X	•	-	-	-
Range Rover Evoque 5dr (2018>)	X	•	X	•	-	-	-
Range Rover Sport (2005 - 2012)	X	•	X	•	-	-	-
Range Rover Sport (2013 - 2017)	X	•	X	•	-	-	-
⚡ Range Rover Sport (2017>)	X	•	X	•	-	-	-
Range Rover Velar (2017>)	X	•	X	•	-	-	-
Range Rover Vogue (2018>)	X	•	X	•	-	-	-

Lexus

CT (2011 - 2014)	X	•	X	•	-	-	-
CT (2017>)	X	•	X	•	-	-	-
GS (2000 - 2011)	X	•	X	•	-	-	-
GS (2013>)	X	•	X	•	-	-	-
⚡ GSh (2013>)	X	•	X	•	-	-	-
IS Saloon (2005 - 2012)	X	•	X	•	-	-	-
IS Saloon (2016>)	X	•	X	•	-	-	-
LS430 (1997 - 2000)	X	•	X	•	-	-	-
⚡ LS500h (2017>)	X	•	X	•	-	-	-
NX (2014 - 2017)	X	•	X	•	-	-	-
NX (2017>)	X	•	X	•	-	-	-
RC 3dr (2018>)	X	•	X	•	-	-	-
RX300/RX400 (2004 - 2008)	X	•	X	•	-	-	-
RX450h (2008 - 2012)	X	•	X	•	-	-	-
RX (2012 - 2016)	X	•	X	•	-	-	-

Maserati

RX (2016>)	X	•	X	•	-	-	-
RXL (2016>)	X	•	X	•	X	-	X

Ghibli 4dr (2013 - 2017)	X	•	X	•	-	-	-
Gran Turismo (2007>)	X	•	X	•	-	-	-
Levante (2016>)	X	•	X	•	-	-	-
Quattroporte (2003 - 2012)	X	•	X	•	-	-	-
Quattroporte (2016>)	X	•	X	•	-	-	-

Maybach

W240/V240 (2002 - 2012)	X	•	X	•	-	-	-
-------------------------	---	---	---	---	---	---	---

Mazda

2 (2007 - 2014)	X	•	X	•	-	-	-
2 (2014>)	X	•	X	•	-	-	-
3 Hatchback (2009 - 2013)	X	•	X	•	-	-	-
3 Hatchback (2013 - 2016)	X	•	X	•	-	-	-
3 Saloon (2009 - 2013)	X	•	X	•	-	-	-
323 (1998 - 2003)	X	•	X	•	-	-	-
5 (2005 - 2010)	X	•	X	•	-	-	-
6 (2002 - 2008)	X	•	X	•	-	-	-
6 Estate (2007 - 2013)	X	•	X	•	-	-	-
6 Estate (2012 - 2017)	X	•	X	•	-	-	-
6 Estate (2018>)	X	•	X	•	-	-	-
6 Hatch (2007 - 2012)	X	•	X	•	-	-	-
6 Saloon (2007 - 2009)	X	•	X	•	-	-	-
6 Saloon (2009 - 2013)	X	•	X	•	-	-	-
CX-3 (2015 - 2018)	X	•	X	•	-	-	-
CX-5 (2012 - 2016)	X	•	X	•	-	-	-
CX-5 (2016>)	X	•	X	•	-	-	-
CX-7 (2007 - 2011)	X	•	X	•	-	-	-
Demio (2002 - 2007)	X	•	X	•	-	-	-
MPV (1999 - 2004)	X	•	X	•	-	-	-
MX-5 (1998 - 2005)	X	•	-	-	-	-	-
MX-5 (2015>)	X	•	-	-	-	-	-

Mercedes-Benz

Premacy (1999 - 2005)	X	•	X	•	-	-	-
RX-8 (2003 - 2010)	X	•	X	•	-	-	-
Tribute (2001 - 2004)	X	•	X	•	-	-	-
Verisa (2004>)	X	•	X	•	-	-	-

A Class (2001 - 2005)	X	•	X	•	-	-	-
A Class (2005 - 2012)	X	•	X	•	-	-	-
A-Class (2012 - 2018)	X	•	X	•	-	-	-
B-Class (2011 - 2014)	X	•	X	•	-	-	-
⚡ B-Class EV (2014 - 2018)	X	•	X	•	-	-	-
C-Class (2000 - 2007)	X	•	X	•	-	-	-
C-Class (2007 - 2014)	X	•	X	•	-	-	-
C-Class Cabriolet (2016>)	X	•	-	-	-	-	-
C-Class Coupe (2011 - 2013)	X	•	-	-	-	-	-
C-Class Coupe (2016>)	X	•	-	-	-	-	-
C-Class Estate (2007 - 2011)	X	•	X	•	-	-	-
C-Class Estate (2014>)	X	•	X	•	-	-	-
Citan (2012>)	X	•	X	•	-	-	-
GLA (2013 - 2016)	X	•	X	•	-	-	-
CLA Shooting Brake (2015>)	X	•	X	•	-	-	-
CLC (2008 - 2012)	X	•	X	•	-	-	-
CLK (2002 - 2010)	X	•	X	•	-	-	-
CLS Coupe (2004 - 2010)	X	•	X	•	-	-	-
CLS Coupe (2011 - 2016)	X	•	X	•	-	-	-
CLS Coupe (2016>)	X	•	X	•	-	-	-
CLS Shooting Brake (2012 - 2017)	X	•	X	•	-	-	-
E-Class (2002 - 2009)	X	•	X	•	-	-	-
E-Class (2006 - 2009)	X	•	X	•	-	-	-
E-Class (2016>)	X	•	X	•	-	-	-
E-Class Coupe (2009 - 2012)	X	•	-	-	-	-	-
E-Class Coupe (2016>)	X	•	-	-	-	-	-
E-Class Estate (2013 - 2016)	X	•	X	•	-	-	-
E-Class Estate (2016>)	X	•	X	•	-	-	-
E-Class Saloon (2009 - 2012)	X	•	X	•	-	-	-
E-Class Saloon (2013 - 2016)	X	•	X	•	-	-	-
E-Class Saloon (2016>)	X	•	X	•	-	-	-
GL Class (2006 - 2012)	X	•	X	•	X	-	X

GL Class (2012 - 2016)	X	•	X	•	X	-	X
GLA (2013 - 2017)	X	•	X	•	•	-	-
GLC Coupe (2016>)	X	•	X	•	-	-	-
GLC SUV (2015>)	X	•	X	•	-	-	-
GLE (2015 - 2019)	X	•	X	•	-	-	-
GLK (2008 - 2015)	X	•	X	•	-	-	-
GLS (2016>)	X	•	X	•	•	-	•
M (2011 - 2015)	X	•	X	•	-	-	-
M-Klasse (1997 - 2005)	X	•	X	•	-	-	-
ML-Class (2005 - 2012)	X	•	X	•	-	-	-
ML-Class (2012 - 2015)	X	•	X	•	-	-	-
R-Class (2005 - 2012)	X	•	X	•	-	-	-
S Class (2005 - 2015)	X	•	X	•	-	-	-
S-Class (2015 - 2018)	X	•	X	•	-	-	-
SL Class (2011 - 2016)	X	•	-	-	-	-	-
SLK (2011 - 2016)	X	•	-	-	-	-	-
Sprinter (2006 - 2013)	X	•	X	•	-	-	-
V-Class (2014 - 2019)	X	•	•	•	X	•	•
Vaneo (2001 - 2005)	X	•	•	•	-	-	-
Viano (2003 - 2010)	X	•	X	•	•	-	•
Vito (2003 - 2014)	X	•	•	X	•	•	-

MG

25 (1999 - 2005)	X	X	X	X	-	-	-
GS (2016>)	X	•	X	•	-	-	-
MG3 (2013>)	X	•	X	•	-	-	-
Streetwise (1999 - 2005)	X	X	X	X	-	-	-
ZR (2001 - 2005)	X	X	X	X	-	-	-
ZT (2003 - 2006)	X	X	X	X	-	-	-

MINI

Countryman (2010 - 2014)	X	•	X	•	-	-	-
Countryman 4 (2010 - 2014)	X	•	X	•	-	-	-
Countryman 5 (2010 - 2014)	X	•	X	•	-	-	-
Coupe (2009 - 2015)	X	•	-	-	-	-	-
Hatchback (2006 - 2014)	X	•	-	-	-	-	-
Hatchback (2014 - 2018)	X	•	-	-	-	-	-

Hatchback 3dr (2014 - 2018)	X	•	-	•	-	-	-
Hatchback 5dr (2014 - 2018)	X	•	X	•	-	-	-
Paceman (2013 - 2016)	X	•	-	•	-	-	-
R56 (2010 - 2015)	X	•	X	•	-	-	-
R57 (2007 - 2014)	X	•	X	•	-	-	-

Mitsubishi

ASX (2010 - 2012)	X	•	X	•	-	-	-
Colt (2004 - 2008)	X	•	X	•	-	-	-
Colt (2007 - 2013)	X	•	X	•	-	-	-
Grandis (2004 - 2011)	X	•	X	•	-	-	-
Lancer (2007 - 2011)	X	•	-	•	-	-	-
Lancer Evo (2003 - 2007)	X	•	-	•	-	-	-
Lancer Ralliart (2009 - 2011)	X	•	-	•	-	-	-
Lancer Sportback (2008 - 2012)	X	•	-	•	-	-	-
Mirage (2012>)	X	•	X	•	-	-	-
Outlander (2003 - 2007)	X	•	X	•	-	-	-
Outlander (2006 - 2013)	X	•	X	•	-	-	-
Outlander (2012 - 2016)	X	•	X	•	-	-	-
⚡ Outlander PHEV (2016>)	X	•	X	•	-	-	-
Pajero (2006>)	X	•	X	•	-	-	-
Shogun (2007 - 2009)	X	•	X	•	-	-	-

Nissan

Almera (2000 - 2002)	X	•	X	•	-	-	-
Juke (2010>)	X	•	X	•	-	-	-
⚡ Leaf EV (2010 - 2017)	X	•	X	•	-	-	-
⚡ Leaf EV (2017>)	X	•	X	•	-	-	-
Maxima (1995 - 2000)	X	•	X	•	-	-	-
Micra (1998 - 2000)	X	•	X	•	-	-	-
Micra (2010 - 2013)	X	•	X	•	-	-	-
Micra (2017>)	X	•	X	•	-	-	-
Murano (2003 - 2007)	X	•	X	•	-	-	-
Murano (2016>)	X	•	X	•	-	-	-
Navara (2001 - 2005)	X	•	X	•	-	-	-
Note (2004 - 2013)	X	•	X	•	-	-	-
Note (2013 - 2017)	X	•	X	•	-	-	-

Pathfinder (2005 - 2007)	X	•	X	•	-	-	-
Pixo (2009 - 2013)	X	•	X	•	-	-	-
Primer (1996 - 2002)	X	•	X	•	-	-	-
Pulsar (2014>)	X	•	X	•	-	-	-
Qashqai +2 (2008 - 2015)	X	•	X	•	-	-	-
Qashqai (2007 - 2013)	X	•	X	•	-	-	-
Qashqai (2013 - 2018)	X	•	X	•	-	-	-
Qashqai (2018>)	X	•	X	•	-	-	-
Quest MPV (2011>)	X	•	-	•	X	-	X
Tiida (2004>)	X	•	X	•	-	-	-
2008 X-Trail (2001 - 2007)	X	•	X	•	-	-	-
2008 X-Trail (2007 - 2015)	X	•	X	•	-	-	-
X-Trail (2014 - 2017)	X	•	X	•	X	-	X
X-Trail (2017>)	X	•	X	•	X	-	X

Opel

Adam (2013>)	X	•	-	-	-	-	-
Agila (2000 - 2007)	X	•	X	•	-	-	-
Agila (2008 - 2015)	X	•	X	•	-	-	-
⚡ Ampera (2011 - 2015)	X	•	-	-	-	-	-
Antara (2006 - 2015)	X	•	X	•	-	-	-
Astra (2004 - 2010)	X	•	X	•	-	-	-
Astra 5dr (2009 - 2015)	X	•	X	•	-	-	-
Astra (2015>)	X	•	X	•	-	-	-
Astra Estate (2010 - 2015)	X	•	X	•	-	-	-
Astra GTC (2011>)	X	•	X	•	-	-	-
Caravan (1998 - 2005)	X	•	X	•	-	-	-
Combo (2001 - 2011)	X	•	X	•	-	-	-
Corsa 3dr Hatch (2006 - 2015)	X	•	X	•	-	-	-
Corsa 5dr Hatch (2006 - 2015)	X	•	X	•	-	-	-
Corsa 3dr (2014>)	X	•	X	•	-	-	-
Corsa 5dr (2014>)	X	•	X	•	-	-	-
Corsa C (2000 - 2006)	X	•	X	•	-	-	-
Corsa D (2006 - 2014)	X	•	X	•	-	-	-
Corsa VXR (2007 - 2014)	X	•	X	•	-	-	-
Insignia Hatch (2008 - 2013)	X	•	X	•	-	-	-
Insignia Saloon (2008 - 2013)	X	•	X	•	-	-	-
Insignia Sports Tourer (2009 - 2013)	X	•	X	•	-	-	-

Karl (2015>)	X	•	X	•	-	-	-
Meriva (2002 - 2010)	X	•	X	•	-	-	-
Meriva (2010 - 2014)	X	•	X	•	-	-	-
Mokka (2012 - 2016)	X	•	X	•	-	-	-
Signum (2003 - 2008)	X	•	X	•	-	-	-
Vectra (2002 - 2008)	X	•	X	•	-	-	-
Vivaro (2001 - 2014)	X	•	X	•	-	-	-
Zafira (2005 - 2014)	X	•	X	•	-	-	-
Zafira Tourer (2011 - 2016)	X	•	X	•	X	-	X

Peugeot

107 (2005 - 2014)	X	•	-	-	-	-	-
108 3dr (2014>)	X	•	-	-	-	-	-
108 5dr (2014>)	X	•	-	-	-	-	-
206 (1998 - 2009)	X	•	X	•	-	-	-
206 3dr (2004 - 2009)	X	•	X	•	-	-	-
207 3dr (2006 - 2012)	X	•	X	•	-	-	-
207 5dr (2006 - 2012)	X	•	X	•	-	-	-
207 SW (2007 - 2012)	X	•	X	•	-	-	-
208 3dr (2012>)	X	•	X	•	-	-	-
208 5dr (2012>)	X	•	X	•	-	-	-
307 (2001 - 2008)	X	•	X	•	-	-	-
307 Estate (2002 - 2007)	X	•	X	•	-	-	-
308 (2014 - 2017)	X	•	X	•	-	-	-
308 Hatch (2007 - 2014)	X	•	X	•	-	-	-
308 SW (2008 - 2015)	X	•	X	•	-	-	-
308 SW (2014 - 2017)	X	•	X	•	-	-	-
406 (1999 - 2004)	X	•	X	•	-	-	-
407 (2004 - 2011)	X	•	X	•	-	-	-
407 SW (2004 - 2011)	X	•	X	•	-	-	-
508 (2011 - 2014)	X	•	X	•	-	-	-
508 RXH (2011 - 2014)	X	•	X	•	-	-	-
508 SW (2010 - 2014)	X	•	X	•	-	-	-
607 (2000 - 2009)	X	•	X	•	-	-	-
807 (2002 - 2010)	X	! SB	X	! SB	•	-	•
1007 (2005 - 2009)	X	•	X	•	-	-	-
2008 (2013>)	X	•	X	•	-	-	-
3008 (2009 - 2016)	X	! SB	X	! SB	-	-	-

3008 (2016>)	X	•	X	•	-	-	-
4007 (2007 - 2012)	X	•	X	•	-	-	-
4008 (2012>)	X	•	X	•	-	-	-
5008 (2009 - 2013)	X	•	•	•	X	-	X
5008 (2013>)	X	!SB	X	!SB	X	X	X
Bipper (2008 - 2017)	X	•	X	•	-	-	-
Expert Tepee (2007 - 2016)	X	•	X	•	X	X	X
Partner Combi (2004 - 2010)	X	•	X	•	-	-	-
Partner Teepee (2008>)	X	X	X	X	-	-	-
RCZ (2009 - 2013)	X	X	-	X	-	-	-
Traveller (2016>)	X	•	•	•	X	X	X

Pontiac

Grand AM (1998 - 2004)	X	•	X	•	-	-	-
------------------------	---	---	---	---	---	---	---

Porsche

Cayenne (2002 - 2006)	X	•	X	•	-	-	-
Cayenne (2010 - 2015)	X	•	X	•	-	-	-
⚡ Cayenne E-Hybrid (2015 - 2017)	X	•	X	•	-	-	-
⚡ Cayenne E-Hybrid (2017>)	X	•	X	•	-	-	-
Macan (2014 - 2018)	X	•	X	•	-	-	-
Macan Turbo (2018>)	X	•	X	•	-	-	-
Panamera (2009 - 2013)	X	•	-	-	-	-	-
⚡ Panamera E-Hybrid (2016>)	X	•	-	-	-	-	-
Panamera Estate (2017>)	X	•	X	•	-	-	-

Renault

Avantime (2001 - 2003)	X	•	X	•	-	-	-
Captur (2013 - 2017)	X	•	X	•	-	-	-
Captur (2017>)	X	•	X	•	-	-	-
Clio (1998 - 2003)	X	•	X	•	-	-	-
Clio (2005 - 2012)	X	•	X	•	-	-	-
Clio (2013 - 2016)	X	•	X	•	-	-	-
Clio (2016>)	X	•	X	•	-	-	-
Clio Sport (2006 - 2012)	X	•	X	•	-	-	-
Clio Sport (2013>)	X	•	X	•	-	-	-

Clio Sport Tourer (2007 - 2012)	X	•	X	•	-	-	-
Clio Sport Tourer (2013 - 2016)	X	•	X	•	-	-	-
Espace (2003 - 2012)	X	•	•	•	-	-	-
Fluence (2009 - 2014)	X	•	X	•	-	-	-
Grand Espace (1998 - 2002)	X	•	•	•	-	-	-
Grand Espace (2002 - 2012)	X	•	•	•	-	-	-
Grand Modus (2008 - 2012)	X	•	X	•	-	-	-
Grand Scenic (2006 - 2009)	X	X	•	X	-	-	-
Kangoo (1997 - 2003)	X	X	•	X	-	-	-
Kangoo (2008 - 2013)	X	•	X	•	-	-	-
Kadjar (2015 - 2018)	X	•	X	•	-	-	-
Kadjar (2018>)	X	•	X	•	-	-	-
Koleos (2016>)	X	•	X	•	-	-	-
Laguna (2001 - 2007)	X	•	X	•	-	-	-
Laguna (2008>)	X	•	X	•	-	-	-
Laguna Grand Tour (2007 - 2010)	X	•	X	•	-	-	-
Laguna Sport Tourer (2008 - 2012)	X	•	X	•	-	-	-
Megane (1996 - 1999)	X	•	X	•	-	-	-
Megane (2006 - 2009)	X	•	X	•	-	-	-
Megane (2017>)	X	•	X	•	-	-	-
Megane Coupe (2002 - 2006)	X	•	X	•	-	-	-
Megane Grand Tour (1999 - 2003)	X	•	X	•	-	-	-
Megane Grand Tour (2008 - 2016)	X	•	X	•	-	-	-
Megane Hatch (2002 - 2009)	X	•	X	•	-	-	-
Megane Hatch (2008 - 2016)	X	!SB	X	!SB	-	-	-
Megane Hatch (2016>)	X	•	X	•	-	-	-
Megane Scenic (2003 - 2009)	X	•	X	•	-	-	-
Megane Sport Tourer (2009 - 2016)	X	•	X	•	-	-	-
Megane Sport Tourer (2016>)	X	•	X	•	-	-	-
Modus (2004 - 2012)	X	•	X	•	-	-	-
Grand Modus (2008 - 2012)	X	•	X	•	-	-	-
Sandero (2012>)	X	•	X	•	-	-	-
Scenic/Grand Scenic (1995 - 1999)	X	•	X	•	-	-	-
Scenic (2003 - 2009)	X	!SB	X	!SB	-	-	-
Scenic (2009 - 2016)	X	!SB	X	!SB	-	-	-
Scenic (2016>)	X	!SB	X	!SB	-	-	-
Trafic (2001 - 2007)	X	•	X	•	X	-	-
Trafic (2007 - 2010)	X	•	•	X	-	-	-
Twingo (1998 - 2007)	X	•	X	•	-	-	-

Twingo (2007 - 2014)	X	•	•	•	•	•	•
Twingo (2014 - 2018)	X	•	•	•	•	•	•
Twingo (2018>)	X	•	•	•	•	•	•
Vel Satis (2002 - 2005)	X	•	X	•	•	•	•
⚡ Zoe (2012>)	X	•	X	•	•	•	•

SAAB

9-3 (2002 - 2012)	X	•	X	•	•	•	•
9-3 Sport Wagon (2005 - 2012)	X	•	X	•	•	•	•
9-3 X (2009 - 2012)	X	•	X	•	•	•	•
9-5 (2011 - 2012)	X	•	X	•	•	•	•
9-5 Estate (2005 - 2010)	X	•	X	•	•	•	•

SEAT

Alhambra (1995 - 2010)	X	•	•	•	•	•	•
Alhambra (2010>)	X	!	SB	•	!	SB	•
Altea (2004 - 2011)	X	•	X	•	•	•	•
Altea Freetrack4 (2007 - 2009)	X	•	X	•	•	•	•
Altea XL (2006 - 2011)	X	•	X	•	•	•	•
Arona (2017>)	X	•	X	•	•	•	•
Arosa (1997 - 2004)	X	•	X	•	•	•	•
Ateca Estate (2016>)	X	•	X	•	•	•	•
Cordoba Vario (1996 - 2002)	X	•	•	•	•	•	•
Exeo (2008 - 2014)	X	•	X	•	•	•	•
Exeo ST Estate (2008 - 2014)	X	•	X	•	•	•	•
Ibiza (1993 - 2002)	X	•	X	•	•	•	•
Ibiza (2002 - 2008)	X	•	X	•	•	•	•
Ibiza Cupra (2009 - 2012)	X	•	X	•	•	•	•
Ibiza Hatch (2008 - 2013)	X	•	X	•	•	•	•
Ibiza (2017>)	X	•	X	•	•	•	•
Ibiza FR (2009 - 2017)	X	•	X	•	•	•	•
Inca (1995 - 2003)	X	•	X	•	•	•	•
Leon (1998 - 2005)	X	•	X	•	•	•	•
Leon Cupra (2007 - 2011)	X	•	X	•	•	•	•
Leon Hatch (2005 - 2012)	X	•	X	•	•	•	•
Leon (2012>)	X	•	X	•	•	•	•
Leon FR (2006 - 2012)	X	•	X	•	•	•	•

Leon Sport Tourer (2013>)	X	•	X	•	•	•	•
Mii 3dr (2012>)	X	•	X	•	•	•	•
Mii 5dr (2012>)	X	•	X	•	•	•	•
Toledo (1994 - 2004)	X	•	X	•	•	•	•
Toledo (2012>)	X	•	X	•	•	•	•

Skoda

Citigo 3dr (2011 - 2017)	X	•	X	•	•	•	•
Citigo 5dr (2012 - 2017)	X	•	X	•	•	•	•
Citigo 3dr (2017>)	X	•	X	•	•	•	•
Citigo 5dr (2017>)	X	•	X	•	•	•	•
Fabia (1999 - 2007)	X	•	X	•	•	•	•
Fabia Hatch (2007 - 2014)	X	•	X	•	•	•	•
Fabia (2014 - 2018)	X	•	X	•	•	•	•
Fabia (2018>)	X	•	X	•	•	•	•
Fabia Estate Combi (2008 - 2014)	X	•	X	•	•	•	•
Karoq (2017>)	X	•	X	•	•	•	•
Kodiaq (2018>)	X	•	X	•	•	•	•
Octavia (1996 - 2004)	X	•	X	•	•	•	•
Octavia Hatch (2004 - 2012)	X	•	X	•	•	•	•
Octavia Hatch (2013 - 2017)	X	•	X	•	•	•	•
Octavia Estate Combi (2005 - 2013)	X	•	X	•	•	•	•
Octavia Estate (2017>)	X	•	X	•	•	•	•
Octavia Scout (2007 - 2013)	X	•	X	•	•	•	•
Rapid (2013>)	X	•	X	•	•	•	•
Roomster (2006 - 2015)	X	•	X	•	•	•	•
Superb (2001 - 2008)	X	•	X	•	•	•	•
Superb (2008 - 2014)	X	•	X	•	•	•	•
Superb Estate (2015>)	X	•	X	•	•	•	•
Superb Hatch (2015>)	X	•	X	•	•	•	•
Superb Combi/Estate (2008 - 2013)	X	•	X	•	•	•	•
Yeti (2009 - 2013)	X	•	X	•	•	•	•

Smart

For Two Coupe (2007 - 2011)	X	•	•	•	•	•	•
For Two Coupe (2014>)	X	•	•	•	•	•	•
FourFour (2004 - 2006)	X	•	X	•	•	•	•

Ssangyong

FourFour (2014>) X • X • - - - -

Actyon (2006 - 2011) X • X • - - - -
 Korando (2011 - 2017) X • X • - - - -
 Musso Pickup (2016>) X • X • - - - -
 Rexton (2014 - 2016) X • X • - - - -
 Tivoli (2015>) X • X • - - - -
 Turismo (2013>) X • X • X X X

Subaru

BRZ (2012>) X • - • - - - -
 Forester (2003 - 2008) X • X • - - - -
 Forester (2013 - 2018) X • X • - - - -
 Impreza 5dr (2007 - 2012) X • X • - - - -
 Impreza 5dr (2012 - 2016) X • X • - - - -
 Justy (2004 - 2007) X • X • - - - -
 Legacy (2003 - 2006) X • X • - - - -
 Legacy (2009 - 2014) X • X • - - - -
 Outback (2009 - 2014) X • X • - - - -
 Sedan (2002 - 2004) X • X • - - - -
 Wagon (2002 - 2004) X • X • - - - -
 XV Hatchback (2011 - 2015) X • X • - - - -

Suzuki

Alto (2009>) X • - • - - - -
 Baleno (2016>) X • X • - - - -
 Grand Vitara (2002 - 2008) X • X • - - - -
 Grand Vitara (2008>) X • X • - - - -
 Ignis (2003 - 2006) X • X • - - - -
 Kizashi (2009>) X • X • - - - -
 Liana (2001 - 2007) X • X • - - - -
 Splash (2007>) X • X • - - - -
 Swift (2004 - 2010) X • X • - - - -
 Swift Sport (2011 - 2016) X • X • - - - -
 SX-4 (2006 - 2013) X • X • - - - -

TATA

SX-4 Saloon (2006>) X • X • - - - -
 Vitara (2014>) X • X • - - - -
 Wagon R+ (2000 - 2003) X • X • - - - -

Tesla

Indica Vista (2008 - 2013) X • X • - - - -

⚡ Model S (2014>) X • X • - - - -
 ⚡ Model X (2016>) X • X • • X •

Toyota

Auris (2007 - 2012) X • X • - - - -
 Auris (2013 - 2015) X • X • - - - -
 Avensis Hatch (2003 - 2011) X • X • - - - -
 Avensis Tourer (2009 - 2011) X • X • - - - -
 Aygo 3dr (2005 - 2014) X • - • - - - -
 Aygo (2014 - 2018) X • - • - - - -
 Aygo (2018>) X • - • - - - -
 Aygo Explorer (2018>) X • - • - - - -
 Camry (1997 - 2001) X • X • - - - -
 Corolla (2002 - 2007) X • X • - - - -
 C-HR (2016>) X • X • - - - -
 EZ MPV (Verso) (2013>) X • X • - - - -
 GT86 (2012 - 2016) X • - • - - - -
 GT86 (2016>) X • - • - - - -
 Highlander (2013 - 2016) X • X • - - - -
 IQ (2008 - 2015) X • X • - - - -
 Landcruiser (2002 - 2009) X • X • - - - -
 Landcruiser (2009 - 2013) X • X • - - - -
 Landcruiser (2017>) X • X • - - - -
 Previa (2000 - 2009) X • X • - - - -
 ⚡ Prius (2009 - 2011) X • X • - - - -
 ⚡ Prius 2 (2004 - 2010) X • X • - - - -
 ⚡ Prius 3 (2010 - 2016) X • X • - - - -
 ⚡ Prius 4 (2016>) X • X • - - - -

⚡ Prius Plus+ (2011 - 2015)	X	•	X	•	-	-	-	-
⚡ Prius PHEV 3 (2015>)	X	•	X	•	-	-	-	-
RAV4 (2000 - 2006)	X	•	X	•	-	-	-	-
RAV4 (2013 - 2015)	X	•	X	•	-	-	-	-
RAV4 (2018>)	X	•	X	•	-	-	-	-
RAV4 MK3 (2006 - 2011)	X	•	X	•	-	-	-	-
Urban Cruiser (2009 - 2012)	X	•	X	•	-	-	-	-
Verso (2009 - 2012)	X	I	SB	X	I	SB	-	-
Verso (2013>)	X	I	SB	X	I	SB	-	-
Yaris (1999 - 2005)	X	•	X	•	-	-	-	-
Yaris (2008 - 2011)	X	•	X	•	-	-	-	-
Yaris Hatch (2011 - 2014)	X	•	X	•	-	-	-	-
Yaris Hatch (2017>)	X	•	X	•	-	-	-	-

Vauxhall

Adam (2012>)	X	•	-	•	-	-	-	-
Agila (2000 - 2007)	X	•	X	•	-	-	-	-
Agila (2008 - 2013)	X	•	X	•	-	-	-	-
⚡ Ampera (2011 - 2015)	X	•	-	•	-	-	-	-
Antara (2006 - 2015)	X	•	X	•	-	-	-	-
Astra (2004 - 2010)	X	•	X	•	-	-	-	-
Astra (2015>)	X	•	X	•	-	-	-	-
Astra 5dr (2009 - 2015)	X	•	X	•	-	-	-	-
Astra Estate (2010 - 2012)	X	•	X	•	-	-	-	-
Astra GTC (2011>)	X	•	X	•	-	-	-	-
Astra Sport Tourer (2012>)	X	•	X	•	-	-	-	-
Caravan (1998 - 2005)	X	•	X	•	-	-	-	-
Combo (2001 - 2011)	X	•	X	•	-	-	-	-
Corsa 3dr Hatch (2006 - 2015)	X	•	X	•	-	-	-	-
Corsa 5dr Hatch (2006 - 2015)	X	•	X	•	-	-	-	-
Corsa 3dr (2014>)	X	•	X	•	-	-	-	-
Corsa 5dr (2014>)	X	•	X	•	-	-	-	-
Corsa C (2000 - 2006)	X	•	X	•	-	-	-	-
Corsa D (2006 - 2014)	X	•	X	•	-	-	-	-
Corsa VXR (2007 - 2014)	X	•	X	•	-	-	-	-
Crossland X (2017>)	X	•	X	•	-	-	-	-
Grandland X (2017>)	X	•	X	•	-	-	-	-
Insignia Hatch (2008 - 2013)	X	•	X	•	-	-	-	-

Insignia Saloon (2008 - 2013)	X	•	X	•	-	-	-	-
Insignia Sports Tourer (2009 - 2013)	X	•	X	•	-	-	-	-
Karl (2015>)	X	•	X	•	-	-	-	-
Meriva (2002 - 2010)	X	•	X	•	-	-	-	-
Meriva (2010 - 2014)	X	•	X	•	-	-	-	-
Mokka (2012 - 2016)	X	•	X	•	-	-	-	-
Mokka X (2012>)	X	•	X	•	-	-	-	-
Signum (2003 - 2008)	X	•	X	•	-	-	-	-
Vectra (2002 - 2008)	X	•	X	•	-	-	-	-
Vivaro (2001 - 2014)	X	•	X	•	-	-	-	-
Viva (2015>)	X	•	X	•	-	-	-	-
Zafira (2005 - 2014)	X	•	X	•	-	-	-	-
Zafira Tourer (2011 - 2016)	X	•	X	•	X	-	X	-

Volvo

C30 (2006 - 2013)	X	•	-	•	-	-	-	-
C70 (2005 - 2013)	X	•	X	•	-	-	-	-
S40 (2003 - 2012)	X	•	X	•	-	-	-	-
S60 (2010 - 2013)	X	•	X	•	-	-	-	-
S80 (2006 - 2008)	X	•	X	•	-	-	-	-
S90 (2016>)	X	•	X	•	-	-	-	-
V40 (1996 - 2004)	X	•	X	•	-	-	-	-
V40 (2012 - 2016)	X	•	X	•	-	-	-	-
V40 (2016>)	X	•	X	•	-	-	-	-
V40 Cross Country (2012 - 2016)	X	•	X	•	-	-	-	-
V40 Cross Country (2016>)	X	•	X	•	-	-	-	-
V50 (2004 - 2012)	X	•	X	•	-	-	-	-
V60 (2010 - 2013)	X	•	X	•	-	-	-	-
⚡ V60 PHEV (2014 - 2018)	X	•	X	•	-	-	-	-
V70 (2007 - 2016)	X	•	X	•	-	-	-	-
V90 (2016>)	X	•	X	•	-	-	-	-
V90 Cross Country (2016>)	X	•	X	•	-	-	-	-
XC40 (2017>)	X	•	X	•	-	-	-	-
XC60 (2008 - 2013)	X	•	X	•	-	-	-	-
XC60 (2013 - 2017)	X	•	X	•	-	-	-	-
XC60 (2017>)	X	•	X	•	-	-	-	-
XC70 (2000 - 2007)	X	•	X	•	-	-	-	-
XC70 (2007 - 2016)	X	•	X	•	-	-	-	-

VW

XC90 (2003 - 2015)	X	•	X	•	-	-	-
XC90 (2014>)	X	•	X	•	-	-	-
Amarok (2009 - 2016)	X	•	X	•	-	-	-
Beetle (2011>)	X	•	-	-	-	-	-
Bora (1998 - 2005)	X	•	X	•	-	-	-
Caddy (2000 - 2010)	X	•	X	•	-	-	-
Caddy (2010 - 2013)	X	•	X	•	X	-	X
Caddy Maxlife (2010 - 2015)	X	•	X	•	X	-	X
⚡ E-Golf Hatch Mk7 (2014 - 2016)	X	•	X	•	-	-	-
EOS (2006 - 2011)	X	•	X	•	-	-	-
Fox (2005>)	X	•	X	•	-	-	-
⚡ Golf E (2014>)	X	•	X	•	-	-	-
Golf 4 (1997 - 2003)	X	•	X	•	-	-	-
Golf 4 Variant (1996 - 2006)	X	•	X	•	-	-	-
Golf Hatch Mk5 (2004 - 2008)	X	•	X	•	-	-	-
Golf Mk5 (2006 - 2009)	X	•	X	•	-	-	-
Golf Hatch (2008 - 2012)	X	•	X	•	-	-	-
Golf Hatch MK7 (2012>)	X	•	X	•	-	-	-
Golf Cabriolet (2009 - 2012)	X	•	-	-	-	-	-
⚡ Golf GTE Hatch Mk7 (2014 - 2017)	X	•	X	•	-	-	-
Golf Plus (2009 - 2011)	X	•	X	•	-	-	-
Golf (2017>)	X	•	X	•	-	-	-
Golf Sportsvan (2017>)	X	•	X	•	-	-	-
Jetta (2010 - 2014)	X	•	X	•	-	-	-
Lupo (1999 - 2005)	X	•	-	-	-	-	-
LT (1999 - 2006)	X	•	X	•	-	-	-
Multivan (1999 - 2003)	X	•	X	•	-	-	-
Multivan (2003>)	X	•	X	•	-	-	-
Multivan Caravelle (2008>)	X	•	-	-	-	-	X
New Beetle (1998 - 2002)	X	•	X	•	-	-	-
Passat (1996 - 2005)	X	•	X	•	-	-	-
Passat (2005 - 2010)	X	•	X	•	-	-	-
Passat (2010 - 2015)	X	•	X	•	-	-	-
Passat Estate (2005 - 2011)	X	•	X	•	-	-	-
Passat Estate (2011 - 2015)	X	•	X	•	-	-	-
Passat Estate (2015>)	X	•	X	•	-	-	-

Passat Saloon (2015>)	X	•	X	•	-	-	-
Passat Alltrack (2012 - 2015)	X	•	X	•	-	-	-
Passat CC (2008 - 2011)	X	•	X	•	-	-	-
Phaeton (2002 - 2015)	X	•	X	•	-	-	-
Polo 3 (1994 - 2001)	X	•	X	•	-	-	-
Polo 4 (2005 - 2009)	X	•	X	•	-	-	-
Polo 5 (2009 - 2014)	X	•	X	•	-	-	-
Polo 3dr (2009 - 2014)	X	•	X	•	-	-	-
Polo 5dr (2009 - 2014)	X	•	X	•	-	-	-
Polo 5dr (2014 - 2017)	X	•	X	•	-	-	-
Scirocco (2008 - 2014)	X	•	-	-	-	-	-
Sharan (1996 - 2000)	X	•	-	-	-	-	-
Sharan (2000 - 2010)	X	!SB	•	!SB	-	-	-
Sharan (2010>)	X	!SB	•	!SB	•	X	•
T4 Caravelle (1995 - 2003)	X	•	-	X	X	X	X
T5 Kombi (2003 - 2010)	X	•	-	X	-	-	-
Tiguan (2007 - 2016)	X	•	X	•	-	-	-
Tiguan (2016>)	X	•	X	•	-	-	-
Touareg (2002 - 2010)	X	•	X	•	-	-	-
Touareg (2010 - 2014)	X	•	X	•	-	-	-
Touareg MK 1 (2003 - 2010)	X	•	X	•	-	-	-
Touran (2003 - 2010)	X	•	X	•	-	-	-
Touran (2010 - 2015)	X	!SB	X	!SB	X	-	X
Touran (2015>)	X	•	-	-	X	-	X
Transporter LT3 (1996 - 2006)	X	•	X	•	-	-	-
T-ROC (2017>)	X	•	X	•	-	-	-
UP! (2011 - 2016)	X	•	X	•	-	-	-
⚡ E - UP! (2014 - 2016)	X	•	X	•	-	-	-
⚡ E - UP! 3dr (2016>)	X	•	X	•	-	-	-
⚡ E - UP! 5dr (2016>)	X	•	X	•	-	-	-



Allison Baby UK Ltd.
Venture Point, Towers Business Park
Rugeley, Staffordshire, WS15 1UZ

view all fine signature selections at
joiebaby.com/signature

IM-000508F