

Joie™

Group 0+/1

i-Spin 360

enhanced child restraint

使用說明書

本產品符合安全標準CNS 11497及
歐盟標準ECE R129測試和認證
組裝及使用本產品前
請先閱讀說明書全文

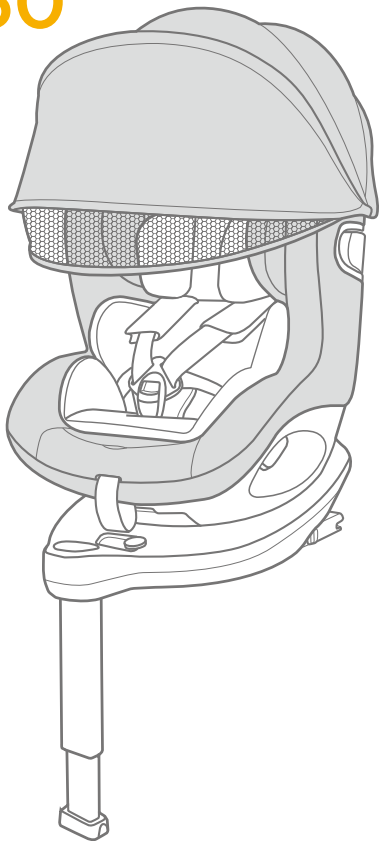

ECE R129: i-Size

恭喜您

恭喜您成為 Joie 家族的一員！很高興能與您的寶寶共度行車旅程。乘坐本產品時，您的寶寶享受的是一台高品質和通過歐盟安全標準檢測的 O+ 級 II 級的兒童安全座椅。請仔細研讀並依照本說明書的指示操作，如此才能保障並提供您的寶寶一個安全又舒適的行車旅程。台灣區域使用請依照 CNS 標準規範。

請保存好本說明書，以利正確使用本產品。

底座

安裝和使用本產品前，請先閱讀說明書全文。

！重要：請仔細閱讀並妥善保存本說明書，以便日後參考。

請依圖示將說明書存放在底座背面的說明書儲存槽內。



產品組件及各部件名稱

請確認產品組件是否有遺漏，如有遺漏，請聯繫代理商。本產品無需工具進行組裝。

- | | |
|-------------|----------------|
| 1 頭靠 | 11 旋轉按鈕 |
| 2 背靠 | 12 肩帶護片 |
| 3 安全扣 | 13 小座墊 |
| 4 調整織帶按鈕 | 14 調整拉桿 |
| 5 調整織帶 | 15 側向保護塑膠 |
| 6 前向乘坐防誤用按鈕 | 16 說明書存放處 |
| 7 支撐腳 | 17 ISOFIX 連接器 |
| 8 支撐腳調整按鈕 | 18 ISOFIX 調整按鈕 |
| 9 支撐腳指示器 | 19 ISOFIX 導向器 |
| 10 背靠調整按鈕 | 20 遮陽篷 |

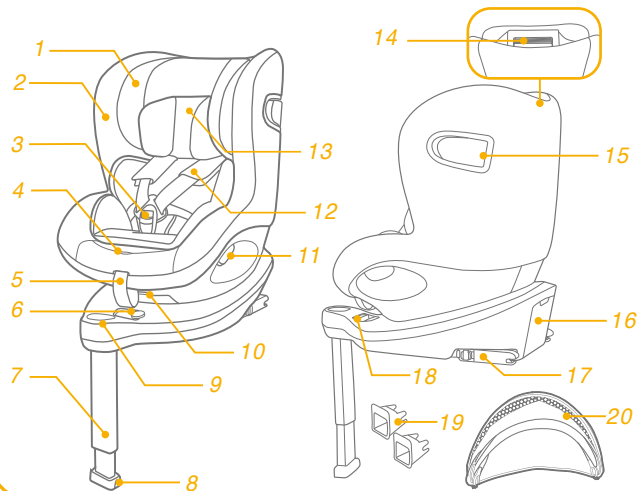

警告

- ! 沒有任何兒童保護裝置可以保證100%遠離傷亡，然而正確的使用本兒童保護裝置可以降低寶寶傷亡的機率。
- ! 本兒童保護裝置適用於體重18kg(約4歲)以下的兒童。
- ! 任何束縛兒童之織帶應根據兒童身體進行調節，且此織帶不應扭曲。
- ! 將您的寶寶放入兒童保護裝置後，必須正確的扣合及使用兒童保護裝置安全帶，並確保腰部織帶能有效束縛骨盆部位。
- ! 本兒童保護裝置若於意外中遭受劇烈撞擊後，不可繼續使用，應立即更換兒童保護裝置。意外可能導致兒童保護裝置產生潛在危險。
- ! 請勿在兒童保護裝置上進行未經驗證許可之改裝或增加其他裝置以及未依兒童保護裝置製造商提供之安裝說明使用，以免造成受傷或死亡。
- ! 請讓座椅遠離日光，以免產品溫度過高對兒童的皮膚造成傷害。
- ! 在無人照料下，不得讓兒童留在兒童保護裝置內。
- ! 任何行李或其他可能在碰撞中造成傷害之物品應適當牢固。
- ! 當本兒童保護裝置沒有座布時，請勿使用，因座布為兒童保護裝置束縛性能之整體構要件。
- ! 請勿使用非本製造商推薦的座布，否則會影響兒童保護裝置的總體性能。
- ! 不要使用非說明書中所述以及兒童保護裝置中所標示的其他受力點。
- ! 前向安裝勿提供2歲以下兒童乘坐，超過2歲兒童，仍宜儘量使用後向安裝。
- ! 請勿在未閱讀或了解本兒童保護裝置說明書及汽車說明書之前，使用或安裝本兒童保護裝置。
- ! 本兒童保護裝置如有任何損壞或零件缺失時，請勿繼續使用。

警告

- ! 請勿讓您的寶寶穿着過大的衣物，所穿的衣物必須能讓兒童保護裝置的安全帶適當而安全地扣在寶寶兩腿之間。
- ! 請勿將未使用ISOFIX連接器固定住的兒童保護裝置留在車內，以免緊急剎車時，傷害到其他乘客。若不經常使用兒童保護裝置時，請將其搬離汽車座椅。
- ! 後向使用時，嚴禁將本兒童保護裝置置於有空氣囊的座位上。
- ! 請勿使用二手兒童保護裝置或來歷不明的兒童保護裝置，因為它們可能會有危害寶寶安全的潛在危險。
- ! 不可使用繩子等其他物件代替汽車安全帶，以免兒童被意外勒住。
- ! 請勿把本兒童保護裝置當作平常的椅子使用，會容易翻倒造成傷害。
- ! 請勿在兒童保護裝置內放置其他內墊物品。
- ! 請勿搬運乘坐着兒童的兒童保護裝置。
- ! 請勿讓汽車車門卡住兒童保護裝置的任何組件。
- ! 使用本產品前，請取掉PE袋和包裝材料，並放到嬰兒和兒童觸摸不到的地方。
- ! 長期不使用兒童保護裝置時，請將其搬離汽車座椅。
- ! 有關零件更換或維修問題，請向代理商查詢。
- ! 兒童保護裝置不能安裝於前座之位置。
- ! 請時常查看ISOFIX導向器是否有髒汙，必要時請清洗導向器。髒汙、灰塵、食物殘渣等會影響產品安裝的穩定性。
- ! 以下汽車座椅不能安裝本兒童保護裝置：
 1. 二點式安全帶的汽車座椅。
 2. 相對於汽車的行駛方向，橫向或後向的汽車座椅。
 3. 安裝不穩定的汽車座椅。

緊急情況處理

遇緊急事件或事故時，需迅速急救或送醫治療照顧您的寶實是非常重要的。

產品資訊

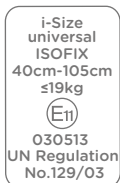

1. 此兒童安全座椅構成“半通用型”兒童保護裝置，符合安全標準 CNS 11497。用於裝有 ISOFIX 固定器系統之車輛座椅。
2. 其他車輛型式亦有可能適用此兒童保護裝置。若有疑問，請洽兒童保護裝置製造商或代理商。

ISOFIX 固定器系統安裝

1. 此為 ISOFIX 兒童保護裝置，符合安全標準 CNS 11497 及歐盟標準 ECE R129。適用於裝有 ISOFIX 固定器系統之車輛座椅。
2. 本兒童保護裝置安裝適用於車輛配有經認可之 ISOFIX 安裝位置。（請參照車輛使用手冊）請依此兒童保護裝置之種類及 ISOFIX 尺度等級，安裝於附有 ISOFIX 固定器系統之車輛座椅上。
3. 此兒童保護裝置使用之 ISOFIX 尺度等級為：A 和 D 級。
4. 若有疑問，請洽兒童保護裝置製造商或參考車輛使用手冊。

Allison Baby UK Ltd.

Venture Point, Towers Business Park,
Rugeley, Staffordshire, WS15 1UZ

www.joiebaby.com

產品名稱	汽車用兒童保護裝置
產品型號	C18011
適用範圍	18kg (約4歲) 以下的寶實
主要材質	塑膠、五金、布
質量等級	0+ / I
淨重	14.22kg
產品尺寸	650mmx580mmx620-760mm
製造日期	詳見產品上貼紙日期(年/月/日)
專利號碼	專利申請中
原產地	中國

委製商 (進口商)	巧兒宜國際股份有限公司
地址	台北市內湖區瑞光路431號2樓
電話	02-27973000
統一編號	52603333

代理商	奇哥股份有限公司 Chickabiddy Co., Ltd
地址	台北市南京東路四段186號5樓
服務專線	0800-001-256 / 02-25781188
統一編號	04222671
網址	www.chick.com.tw

安裝注意事項

見圖 1 - 2

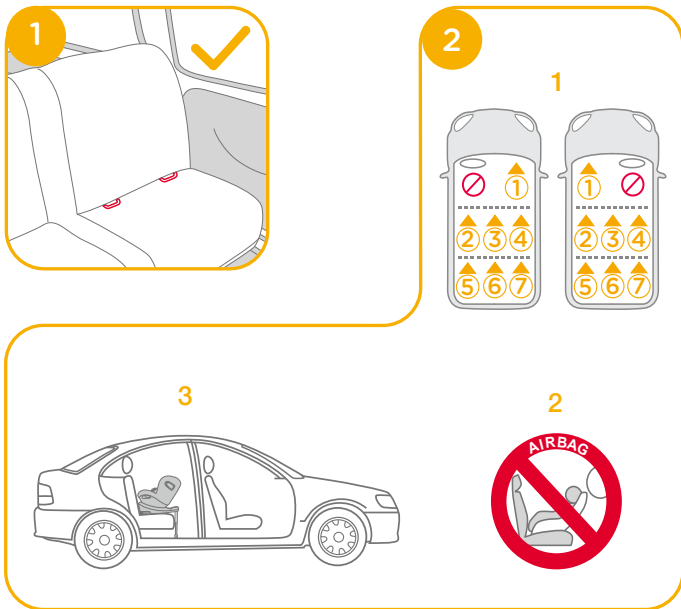

安裝模式選擇

寶寶體重	安裝模式	安裝圖示	參考年齡	背靠段位
CNS 11497	0-18kg	後向模式	未滿4歲	第1-6段
	9-18kg	前向模式	2-4歲	第1-6段

寶寶體重	安裝模式	安裝圖示	前向乘坐防誤用按鈕
0-9kg	後向模式		
> 9kg	後向模式/ 前向模式		

! 前向安裝勿提供2歲以下兒童乘坐，超過2歲兒童，仍宜儘量使用後向安裝。

安裝底座

見圖 3 - 12

! 展開底座支撐腳 3

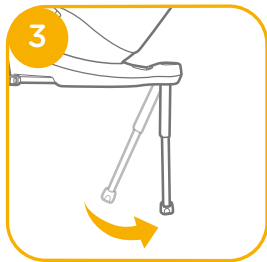

! 將ISOFIX導向器固定到ISOFIX固定點上，ISOFIX導向器既可防止汽車座椅表面被刮破，又可為ISOFIX連接器導向 4-1

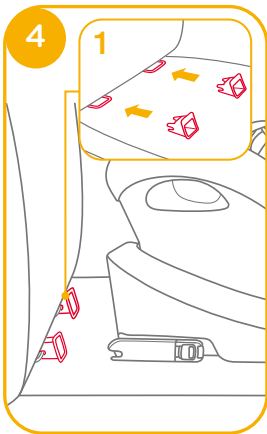

! ISOFIX連接器有11段可供調整。按壓底座的ISOFIX調整按鈕 5-1，拉出ISOFIX連接器 5-2

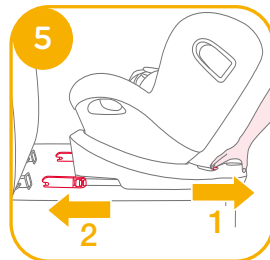

! 請確定左右兩邊的ISOFIX連接器都已固定到ISOFIX固定點上且兩個ISOFIX連接器上的指示器應顯示綠色 6-1

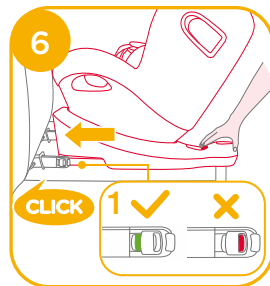

! ISOFIX連接器已正確固定後，按壓底座的ISOFIX調整按鈕，將兒童安全座椅緊靠汽車座椅背靠 6

! 將支撐腳延伸到地面。支撐腳正確安裝時，支撐腳指示器顯示綠色，否則顯示紅色。

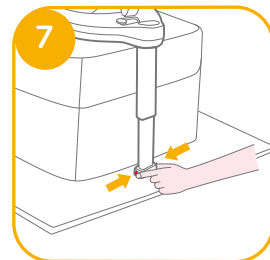

! 按壓支撐腳調整按鈕可將支撐腳向上調整 7

! 無論是否有小孩乘坐，支撐腳都應該與地面完全接觸保持鎖定狀態。

! 支撐腳有19個調整段位，支撐腳指示器顯示紅色時，表示支撐腳處於錯誤段位 8

! 確保支撐腳完全與車輛底部接觸，紅色代表組裝錯誤，請重新操作至正確位置為止 8

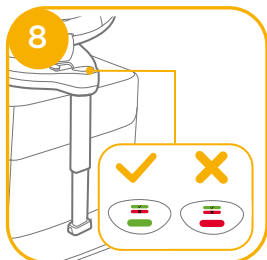

! 同時往外拉兩邊的ISOFIX連接器，以確保底座已正確固定。

! ISOFIX連接器須鎖定在ISOFIX固定點上 9 -1

! 底座支撐腳須正確固定，並以綠色顯示 9 -2

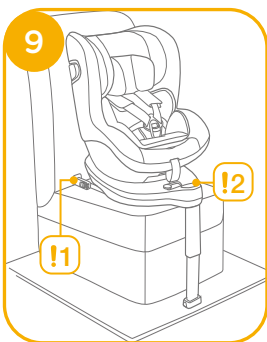

移除底座

按壓底座ISOFIX調整按鈕 10 -1，將底座向外拉 10 -2

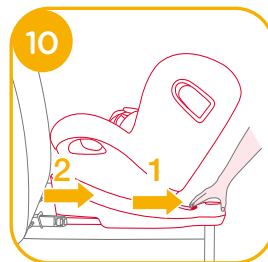

按壓兩側ISOFIX連接器上的第二道安全鎖與釋鎖按鈕，然後將底座向外拉即可 11

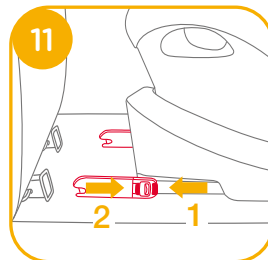

按壓底座ISOFIX調整按鈕 12 -1收合ISOFIX連接器 12 -2

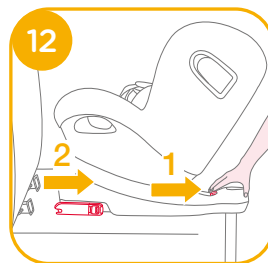

使用側向保護塑膠

見圖 13 - 15

! 必需打開側向保護塑膠才能更好的保護兒童的安全。

1. 當安全扣正確扣合後，拉緊調整織帶，兩側的側向保護塑膠會自動展開 13 - 1 13 - 2

! 重要: 請注意側向保護塑膠展開並不表示兒童已被正確束縛。

2. 如果汽車座椅乘車空間不足時，可將靠近內側的側向保護塑膠關閉。靠近外側的側向保護塑膠處於打開狀態 14 - 1 14 - 2

3. 側向保護塑膠可以手動打開 15

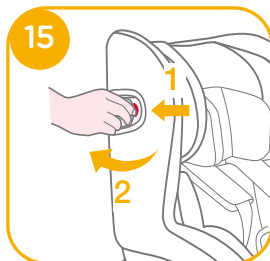
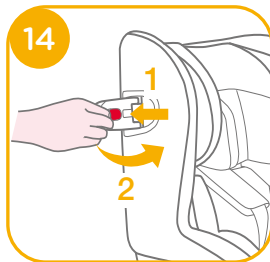
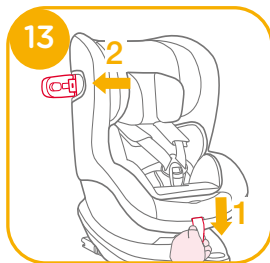

座椅背靠角度調整

見圖 16 - 17

按壓座椅背靠調整按鈕 16，即可滑動兒童安全座椅本體，並將兒童安全座椅角度調至適當位置，角度調整後如 17 所示。

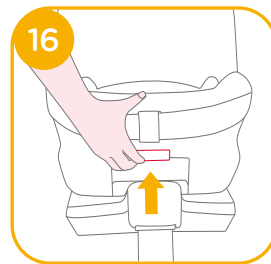

請在座椅調整後再次檢查支撐腳是否正確安裝。後向或前向使用的背靠角度都有6個段位。

頭靠及肩帶高度調整

見圖 18 - 20

1. 調整頭靠位置，並且檢查肩帶是否在適當位置 18
 - ! 使用後向模式時，肩帶高度需與寶寶的肩膀相同或略低於寶寶的肩膀 18
 - ! 使用前向模式時，肩帶高度需與寶寶的肩膀相同 18
2. 按壓頭靠調整拉桿 19，同時上下滑動頭靠到合適高度，頭靠高度共有6個段位，調整如 20 所示。

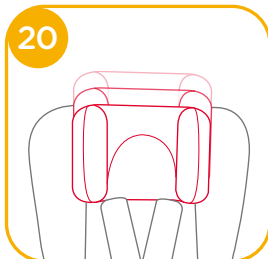
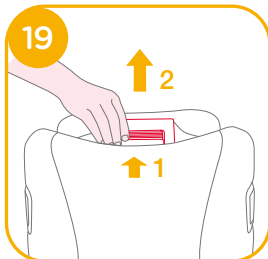

後向使用 (未滿18kg/0-4歲的寶寶)

參考年齡 新生兒- 4歲
座椅段位 第1-6段

見圖 21 - 32

- ! 請先將兒童安全座椅安裝到汽車後座椅上，再讓寶寶乘坐。
- ! 當兒童體重9kg以下，請將前向乘坐防誤用按鈕向左邊滑動。

1. 按壓底座ISOFIX調整按鈕 22 -1，將底座向外拉 22 -2

2. 按壓旋轉按鈕可以旋轉本體方便兒童從側面進出，然後將本體旋轉至後向位置 23&24
- ! 按壓任意一側的旋轉按鈕都可以旋轉兒童安全座椅本體。
- ! 無論是否有小孩乘坐，本體應始終保持前向或後向鎖定狀態。

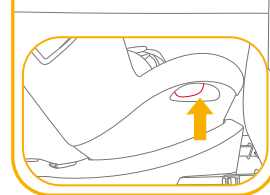
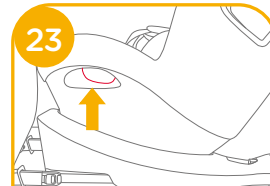
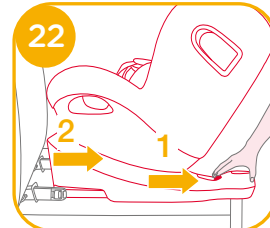
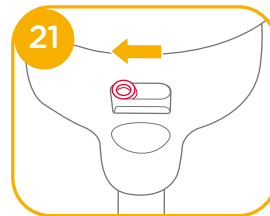

3. ISOFIX連接器已正確固定後，按壓底座ISOFIX調整按鈕，將兒童安全座椅緊靠汽車座椅背靠。

25 -1 25 -2

! ISOFIX連接器須鎖定在ISOFIX固定點上 26 -1

! 底座支撐腳須正確固定，並以綠色顯示 26 -2

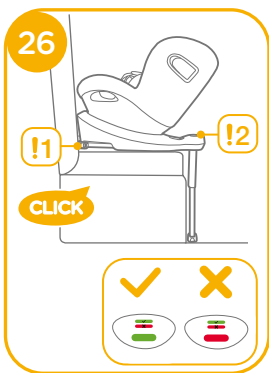
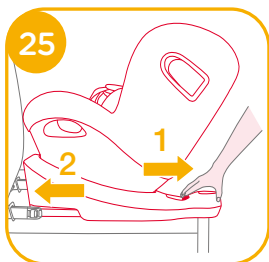

寶寶乘坐

1. 按壓織帶調整按鈕，同時將肩帶（從肩帶護片下方）拉出至適當長度 27

2. 按壓紅色按鈕，鬆開安全扣 28

3. 將安全扣打開，將扣具固定在本體兩側的鬆緊帶內方便放入寶寶 29

4. 在使用之前請將支撐塊安裝在小座墊上 30

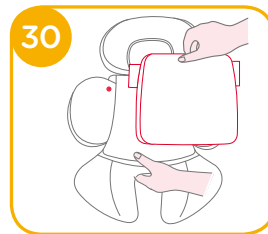
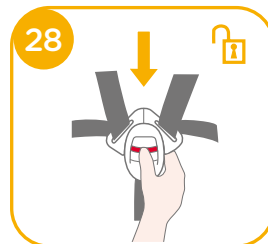
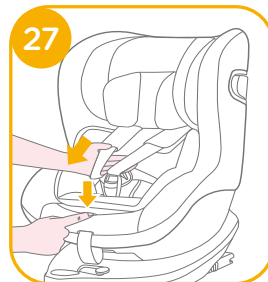

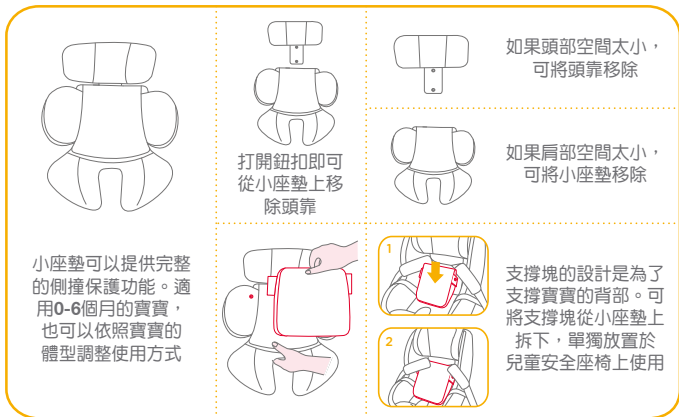

5. 將寶寶放入兒童安全座椅內，再將寶寶兩臂穿過安全帶。

! 將寶寶放入兒童安全座椅後，請確認肩帶高度是否調整在適當位置。

6. 扣好安全扣 ³¹

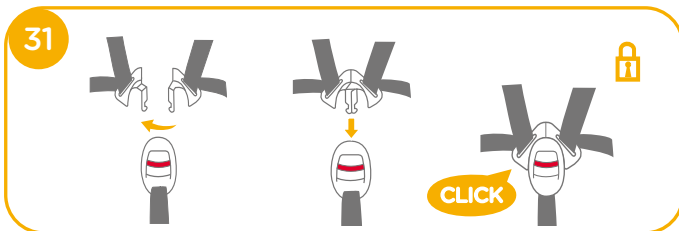

7. 下拉調整器織帶，調整肩帶至適當
長度，以配合寶寶身形 ³²

! 確保寶寶與肩帶之間須可以放進一
個手掌的厚度。



前向使用 (9-18kg/2-4歲的寶寶)

參考年齡 2-4歲

座椅段位 第1-6段

見圖 ³³ - ⁴¹

! 請先將兒童安全座椅安裝到汽車後
座椅上，再讓寶寶乘坐。

! 當兒童安全座椅前向使用時，請將
前向乘坐防誤用按鈕向右邊滑動。

³³

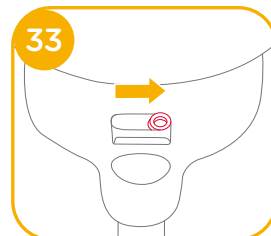

1. 按壓底座ISOFIX調整按鈕 ³⁴ -1，
將底座向外拉 ³⁴ -2

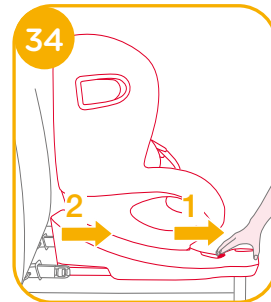

2. 按壓旋轉按鈕可以旋轉本體方便兒童從側面進出，然後將本體旋轉至前向位置 35 & 36

! 按壓任意一側的旋轉按鈕都可以旋轉兒童安全座椅本體。

! 無論是否有小孩乘坐，本體應始終保持前向或後向鎖定狀態。

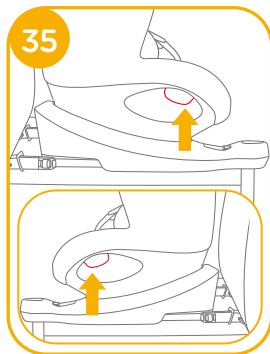

3. ISOFIX連接器已正確固定後，按壓底座ISOFIX調整按鈕，將兒童安全座椅緊靠汽車座椅背靠。

37 -1 37 -2

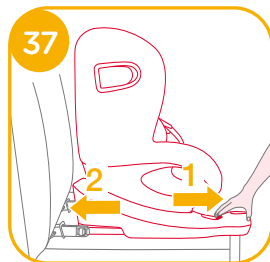

! ISOFIX連接器須鎖定在ISOFIX固定點上 38 -1

! 底座支撐腳須正確固定，並以綠色顯示 38 -2

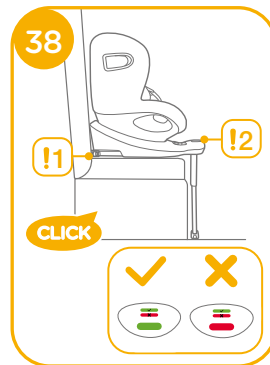

寶寶乘坐

1. 按壓織帶調整按鈕，同時將肩帶（從肩帶護片下方）拉出至適當長度 39

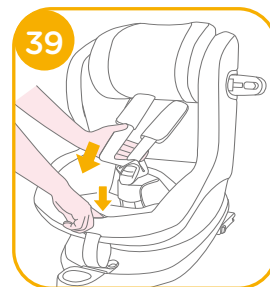

2. 按壓紅色按鈕，鬆開安全扣 40

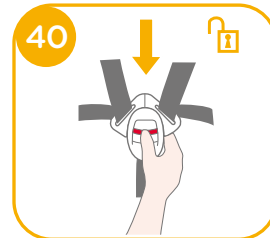

3. 將安全扣打開，將扣具固定在本體兩側的鬆緊帶內方便放入寶寶 41

4. 前向使用時請勿使用小座墊。

5. 將寶寶放入兒童安全座椅內，再將寶寶兩臂穿過安全帶。扣好安全扣。

! 將寶寶放入兒童安全座椅後，請確認肩帶高度是否調整在適當位置。

6. 下拉調整器織帶，調整肩帶至適當長度，以配合寶寶身形 42

! 確保寶寶與肩帶之間須可以放進一個手掌的厚度。

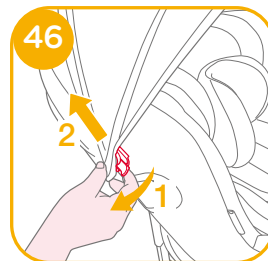
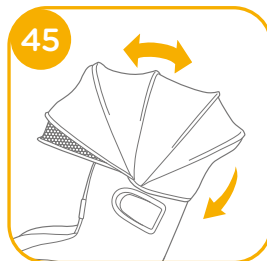
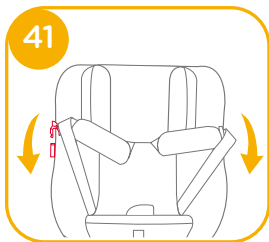

使用遮陽篷

見圖 43 - 46

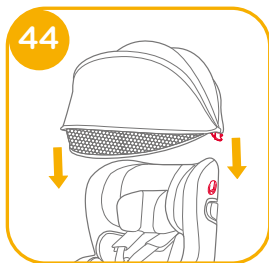
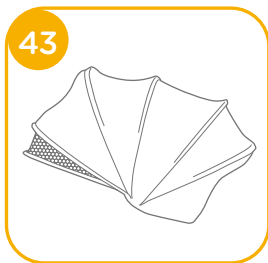

拆卸座布

見圖 47 - 53

按壓紅色按鈕，鬆開安全扣 47

參考 48 - 53 步驟即可拆卸座布。

反向操作即可組裝座布。

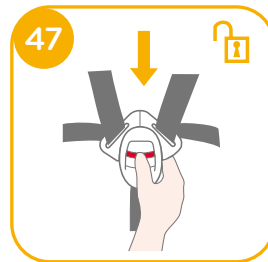

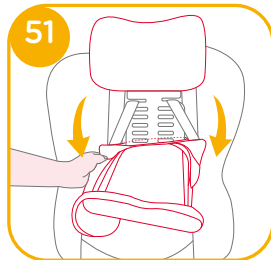
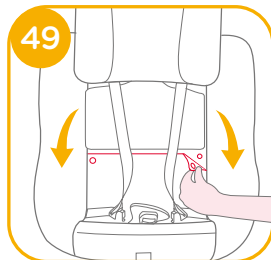
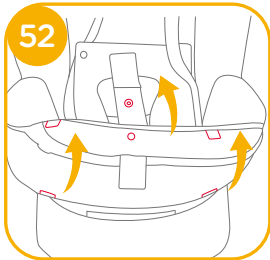
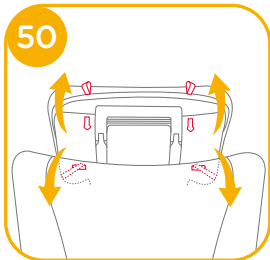
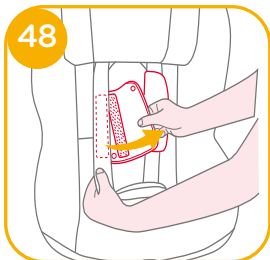

保養維護與保固

- ! 小座墊支撐塊拆除後，請將其存放於寶寶無法接觸到的地方。
- ! 請以30度以下水溫清洗。
- ! 請勿使用熨斗熨燙。
- ! 請勿使用漂白劑及乾洗。
- ! 請勿使用未經稀釋的中性清潔劑、汽油或其他有機溶劑清洗本兒童約束系統，否則可能對約束系統造成損壞。
- ! 請勿大力扭乾，過分大力扭乾可能留下皺褶。
- ! 請於陰涼處鋪平晾乾。
- ! 當長時間不使用本兒童安全座椅時，請將本兒童安全座椅從汽車座椅上拆除，並存放於陰涼處及寶寶不易接觸的地方。



延長保固服務

請於購買起一個月內至奇哥官網進行登錄，登錄成功後即享有商品延長一年保固服務。

汽車安裝資訊

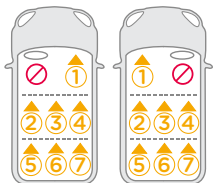

1. 其他車輛型式亦有可能適用此兒童保護裝置。以下車型主要為歐洲銷售車款安裝適配性資料。若有疑問，請洽兒童保護裝置製造商或代理商。
2. 後向使用時，嚴禁將本兒童安全座椅置於有空氣囊的座位上。
3. 兒童保護裝置不能安裝於前座之位置。
4. ● 表示汽車座椅可安裝本兒童保護裝置。
5. ✕ 表示汽車座椅不可安裝本兒童保護裝置。
6. ⚡ 表示用電或其它混合驅動的車輛。
7.  表示符合i-size的車輛。
8. SBI 表示汽車地板下有儲存盒。
9. 將此座椅安裝在地板下有儲物盒的汽車上時，請參考汽車使用說明書或聯繫代理商。
! 表示汽車地板下儲物盒的位置。
10. 如果您的汽車品牌未被列入本說明書或未用“●”或“✕”進行標示，請查閱您的汽車手冊或聯絡兒童約束系統製造商，以進一步了解相關資訊。

① ② ③ ④ ⑤ ⑥ ⑦

Alfa Romeo

Giulia (2017>)	✕	●	✕	●	-	-	-
Guilietta (2010 - 2016)	✕	●	✕	●	-	-	-
Guilietta (2016>)	✕	●	✕	●	-	-	-
MiTo (2009 - 2016)	✕	●	-	●	-	-	-
MiTo (2016>)	✕	●	-	●	-	-	-
Stelvio (2017>)	✕	●	✕	●	-	-	-
156 Sportswagon (1997 - 2005)	✕	●	✕	●	-	-	-
159 (2005 - 2011)	✕	●	✕	●	-	-	-

Audi

A1 (2010 - 2012)	✕	●	✕	●	-	-	-
A1 Sportback (2012 - 2014)	✕	●	✕	●	-	-	-
A1 Sportback (2014>)	✕	●	✕	●	-	-	-
A3 Cabriolet (2016>)	✕	●	✕	●	-	-	-
⚡ A3 e-Tron Sportback (2015>)	✕	●	✕	●	-	-	-
A3 Hatch (2012 - 2016)	✕	●	✕	●	-	-	-
AS/S3 (2006 - 2013)	✕	●	✕	●	-	-	-
A3/S3 Saloon (2014>)	✕	●	✕	●	-	-	-
A3 (1996 - 2003)	✕	●	✕	●	-	-	-
A3 (2004 - 2011)	✕	●	✕	●	-	-	-
A3 (2016>)	✕	●	✕	●	-	-	-
A3 Saloon (2016>)	✕	●	✕	●	-	-	-
A4/S4 (2009 - 2014)	✕	●	✕	●	-	-	-
A4/S4 (2015>)	✕	●	✕	●	-	-	-
A4/S4 Avant (2008 - 2016)	✕	●	✕	●	-	-	-
A4 Avant (2015>)	✕	●	✕	●	-	-	-
A4/S4 Saloon (2008 - 2016)	✕	●	✕	●	-	-	-
A4 (2005 - 2009)	✕	●	✕	●	-	-	-
A4 Saloon (2015>)	✕	●	✕	●	-	-	-
A4 Allroad (2008 - 2016)	✕	●	✕	●	-	-	-
A5 (2007 - 2011)	✕	●	✕	●	-	-	-
A5 (2016>)	✕	●	-	●	-	-	-
A5 Coupe (2006 - 2016)	✕	✕	-	✕	-	-	-
A5/S5 Coupe (2016>)	✕	●	-	●	-	-	-
A5/S5 Sportback (2007 - 2016)	✕	●	✕	●	-	-	-
A5/S5 Sportback (2017>)	✕	●	✕	●	-	-	-
A6 (2011>)	✕	●	✕	●	-	-	-
A6 Allroad (2011 - 2016)	✕	●	✕	●	-	-	-

A6 Allroad (2016>)	×	•	×	•	-	-	-
A6 Avant (2011 - 2014)	×	•	×	•	-	-	-
A6 Avant (2018>)	×	•	×	•	-	-	-
A6/S6 (2011 - 2014)	×	•	×	•	-	-	-
A6/S6 (2014 - 2018)	×	•	×	•	-	-	-
A7 Sportback (2010 - 2014)	×	•	×	•	-	-	-
A7/S7 Sportback (2014 - 2017)	×	•	×	•	-	-	-
A7 Sportback (2017>)	×	•	×	•	-	-	-
A8/S8 (2011 - 2013)	×	•	×	•	-	-	-
A8 (2011 - 2013)	×	•	×	•	-	-	-
A8 (2017>)	×	•	×	•	-	-	-
Q2 (2016>)	×	•	×	•	-	-	-
Q3 (2011 - 2017)	×	•	×	•	-	-	-
Q3 (2017>)	×	•	×	•	-	-	-
Q5 (2008 - 2012)	×	•	×	•	-	-	-
Q5/SQ5 (2012 - 2016)	×	•	×	•	-	-	-
Q5 (2016>)	×	•	×	•	-	-	-
Q7 (2006 - 2015)	×	•	×	•	-	-	-
Q7/SQ7 (2015>)	×	•	×	•	×	-	×
Q7 (2015>)	×	•	×	•	-	-	-
Q8 (2018>)	×	•	×	•	-	-	-
S1 (2014>)	×	•	×	•	-	-	-
TT Coupe (2006 - 2014)	×	×	-	×	-	-	-
TT Coupe Sport (2014>)	×	×	×	×	-	-	-

Bentley

Continental Flying Spur (2005 - 2008)	×	•	×	•	-	-	-
Continental GT (2003 - 2012)	×	•	-	•	-	-	-
Continental GTC (2006 - 2012)	×	•	-	•	-	-	-
Mulsanne (2009 - 2016)	×	•	×	•	-	-	-

BMW

1-Series 5dr (2004 - 2011)	×	•	×	•	-	-	-
1 Series F20 (2011 - 2015)	×	•	×	•	-	-	-
1-Series Convertible (2008 - 2015)	×	•	-	•	-	-	-
1-Series Coupe (2008 - 2015)	×	•	-	•	-	-	-
2-Series AC-T (2015 - 2018)	×	•	×	•	-	-	-

2-Series AC-T (2018>)	×	•	×	•	-	-	-
2-Series Coupe (2014>)	×	•	-	•	-	-	-
2-Series Gran Tourer (2018>)	×	•	×	•	-	-	-
3-GT (2013>)	×	•	×	•	-	-	-
3 Series F30 (2012>)	×	•	×	•	-	-	-
3-Series (2005 - 2011)	×	•	-	•	-	-	-
3-Series Coupe (2007 - 2014)	×	•	-	•	-	-	-
4-Series Gran Coupe (2014 - 2018)	×	•	×	•	-	-	-
5-GT (2009 - 2013)	×	•	×	•	-	-	-
5-Series (2008 - 2010)	×	•	×	•	-	-	-
5-Series (2010 - 2016)	×	•	×	•	-	-	-
5-Series Saloon (2003 - 2010)	×	•	×	•	-	-	-
5-Series Saloon (2011 - 2016)	×	•	×	•	-	-	-
5-Series Saloon (2017>)	×	•	×	•	-	-	-
5-Series Touring (2003 - 2010)	×	•	×	•	-	-	-
5-Series Touring (2010 - 2017)	×	•	×	•	-	-	-
6-GT (2017>)	×	•	×	•	-	-	-
6-Series Coupe (2dr) (2011 - 2015)	×	•	-	•	-	-	-
6-Series Convertible (2012 - 2015)	×	•	-	•	-	-	-
6-Series Gran Coupe (4dr) (2011 - 2015)	×	•	×	•	-	-	-
7-Series (2008 - 2012)	×	•	×	•	-	-	-
7-Series (2012 - 2016)	×	•	×	•	-	-	-
7-Series (2016>)	×	•	×	•	-	-	-
M5 (2011 - 2016)	×	•	×	•	-	-	-
⚡ i3 (2013 - 2017)	×	•	-	•	-	-	-
M Sport Saloon (2015>)	×	•	×	•	-	-	-
X1 (2009 - 2016)	×	•	×	•	-	-	-
X1 (2016>)	×	•	×	•	-	-	-
X2 (2018>)	×	•	×	•	-	-	-
X3 F25 (2010 - 2013)	×	•	×	•	-	-	-
X3 M Sport (2017>)	×	•	×	•	-	-	-
X4 (2014 - 2018)	×	•	×	•	-	-	-
X5 (2007- 2014)	×	•	×	•	×	-	×
X5 (2014>)	×	•	×	•	×	-	×
X5 M (2014>)	×	•	×	•	×	-	×
X6 (2008 - 2009)	×	•	×	•	-	-	-
X6 (2010 - 2014)	×	•	×	•	-	-	-
X6 (2014>)	×	•	×	•	-	-	-
X6 M (2014>)	×	•	×	•	-	-	-

Cadillac

BLS Saloon (2006 - 2011)	X	.	X	.	-	-	-
CTS (2003 - 2007)	X	.	X	.	-	-	-

Chevrolet

Aveo 5dr (2011 - 2015)	X	.	X	.	-	-	-
Camaro (2011 - 2015)	X	.	X	.	-	-	-
Captiva (2007 - 2015)	X	.	X	.	-	-	-
Cruze (2009 - 2014)	X	.	X	.	-	-	-
Epica (2006 - 2011)	X	.	X	.	-	-	-
HHR (2007 - 2011)	X	.	X	.	-	-	-
Kalos (2002 - 2007)	X	.	X	.	-	-	-
Lacetti (2002 - 2009)	X	.	X	.	-	-	-
Malibu (2012 - 2016)	X	.	X	.	-	-	-
Matiz (2005 - 2009)	X	.	X	.	-	-	-
Nubira (2004 - 2009)	X	.	X	.	-	-	-
Orlando (2011>)	X	.	X	.	-	-	-
Spark (2010 - 2015)	X	.	X	.	-	-	-
Tahoe (1999 - 2006)	X	.	X	.	-	-	-
Traxx (2013 - 2017)	X	.	X	.	-	-	-
Volt (2011 - 2016)	X	.	.	.	-	-	-

Chrysler

300C (2012 - 2015)	X	.	X	.	-	-	-
Delta (2007 - 2014)	X	.	X	.	-	-	-
Delta (2008 - 2013)	X	.	X	.	-	-	-
Dodge Avenger (2007 - 2014)	X	.	X	.	-	-	-
Dodge Caliber (2006 - 2012)	X	.	X	.	-	-	-
Dodge Journey (2008 - 2011)	X	.	.	.	-	-	-
Dodge Nitro (2006 - 2011)	X	.	X	.	-	-	-
Dodge Ram (2002 - 2008)	X	.	.	.	-	-	-
Grand Voyager (2001 - 2007)	X	.	X	.	-	-	-
Pacifica (2003 - 2008)	X	.	X	.	-	-	-
PT Cruiser (2001 - 2010)	X	.	X	.	-	-	-
Sebring (2007 - 2010)	X	.	.	.	-	-	-
Voyager (2001 - 2007)	X	.	X
Ypsilon (2011 - 2015)	X	.	X	.	-	-	-

Citroen

Berlingo II (2008 - 2012)	X	.	X	.	-	-	-
SBI Berlingo Multispace (2007 - 2018)	X	!	X	!	X	-	X
C1 (2006 - 2015)	X	.	.	.	-	-	-
C1 (2014>)	X	.	.	.	-	-	-
C2 (2003 - 2009)	X	.	X	.	-	-	-
C3 5dr (2005 - 2009)	X	.	X	.	-	-	-
C3 5dr (2009 - 2016)	X	.	X	.	-	-	-
C3 5dr (2016>)	X	X	X	X	-	-	-
SBI C3 Picasso (2008 - 2012)	X	!	X	!	-	-	-
C4 (2010 - 2018)	X	.	X	.	-	-	-
C4 G-Picasso (2006 - 2013)	X	.	.	.	X	-	X
SBI C4 Picasso (2007 - 2010)	X	!	X	!	-	-	-
SBI C4 Picasso (2013 - 2018)	X	!	.	!	X	-	X
C4-Cactus (2014 - 2018)	X	.	X	.	-	-	-
C5 (2005 - 2008)	X	X	X	X	-	-	-
C5 Saloon (2008 - 2016)	X	.	X	.	-	-	-
C5 Tourer (2008 - 2018)	X	.	X	.	-	-	-
C-Crosser (2007 - 2013)	X	.	X	.	-	-	-
DS3 (2009 - 2014)	X	.	X	.	-	-	-
DS3 Cabrio (2016>)	X	.	X	.	-	-	-
DS4 (2011 - 2015)	X	.	X	.	-	-	-
DS5 (2012 - 2015)	X	.	X	.	-	-	-
Evasion (1998 - 2002)	X	.	X	.	.	.	X
Jumpy (2007 - 2012)	X	.	X	.	X	X	X
Nemo (2008 - 2015)	X	.	X	.	-	-	-
Saxo (1996 - 2003)	X	.	X	.	-	-	-
Xsara (2000 - 2006)	X	.	X	.	-	-	-

Dacia

Dokker (2012>)	X	.	.	.	-	-	-
Duster (2012 - 2017)	X	.	X	.	-	-	-
Duster (2017>)	X	.	X	.	-	-	-
Lodgy (2012>)	X	.	.	.	-	-	-
Logan MCV (2012 - 2016)	X	.	X	.	-	-	-
Logan MCV (2016>)	X	.	X	.	-	-	-
Sandero (2012 - 2016)	X	.	X	.	-	-	-
Sandero (2016>)	X	.	X	.	-	-	-

Daihatsu

Cuore (2007 - 2011)	×	•	×	•	-	-	-
Materia (2006 - 2011)	×	•	×	•	-	-	-
Sirion (2001 - 2005)	×	•	×	•	-	-	-
Terios (2005>)	×	•	×	•	-	-	-
Trevis (2004 - 2009)	×	•	×	•	-	-	-

FIAT

124 Spider (2016>)	×	-	-	-	-	-	-
500 (2008>)	×	•	-	•	-	-	-
500 C (2009>)	×	•	-	-	-	-	-
500L (2012>)	×	•	×	•	-	-	-
500X (2015 - 2018)	×	•	×	•	-	-	-
500X (2018>)	×	×	×	×	-	-	-
Abarth 500 (2009 - 2015)	×	•	-	•	-	-	-
Abarth 595 (2018>)	×	•	-	•	-	-	-
Abarth Grande Punto (2008 - 2011)	×	•	×	•	-	-	-
GBT Punto (2014>)	×	•	×	•	-	-	-
Bravo (2007 - 2010)	×	•	×	•	-	-	-
Croma (2005 - 2011)	×	•	×	•	-	-	-
Doblo (2005 - 2010)	×	•	×	•	-	-	-
Doblo (2010>)	×	•	×	•	-	-	-
Grande Punto (2006 - 2009)	×	•	×	•	-	-	-
Idea (2003 - 2007)	×	•	×	•	-	-	-
Linea (2006 - 2015)	×	•	×	•	-	-	-
Multipla (2004 - 2007)	×	•	×	•	-	-	-
Panda (2011>)	×	•	×	•	-	-	-
Qubo (2008>)	×	•	×	•	-	-	-
Scudo II (2007 - 2016)	×	•	×	•	•	×	•
Sedici (2006 - 2011)	×	•	×	•	-	-	-
Stilo (2001 - 2007)	×	•	×	•	-	-	-
Tipo (2015>)	×	•	×	•	-	-	-
Ulysse (2002 - 2007)	×	•	•	•	•	×	•





Ford

B-Max (2012>)	×	•	×	•	-	-	-
C-Max (2003 - 2010)	×	×	×	×	-	-	-
C-Max (2010 - 2012)	×	•	×	•	-	-	-

C-Max (2011>)	×	•	×	•	-	-	-
Grand C-Max (2010 - 2014)	×	•	×	•	-	-	-
🚗 Grand C-Max (2015>)	×	•	×	•	-	-	-
EcoSport (2013 - 2017)	×	•	×	•	-	-	-
🚗 EcoSport (2017>)	×	•	×	•	-	-	-
Edge (2015 - 2018)	×	•	×	•	-	-	-
🚗 Edge Sport (2018>)	×	•	×	•	-	-	-
Fiesta (2004 - 2008)	×	×	×	×	-	-	-
🚗 Fiesta (2008 - 2017)	×	•	×	•	-	-	-
Fiesta 3dr (2017>)	×	•	×	•	-	-	-
🚗 Fiesta 5dr (2017>)	×	•	×	•	-	-	-
Fiesta Active (2018>)	×	•	×	•	-	-	-
Fiesta ST (2014>)	×	•	×	•	-	-	-
Focus (1998 - 2005)	×	×	×	×	-	-	-
Focus (2005 - 2009)	×	•	×	•	-	-	-
Focus (2010 - 2015)	×	•	×	•	-	-	-
Focus (2014 - 2018)	×	•	×	•	-	-	-
Focus (2018>)	×	•	×	•	-	-	-
🚗 Focus Estate (2011 - 2018)	×	•	×	•	-	-	-
Focus ST Estate (2017>)	×	•	×	•	-	-	-
🚗 ⚡ Focus EV (2015>)	×	•	×	•	-	-	-
SB! Galaxy (2006 - 2015)	×	!	×	!	×	-	×
SB! Galaxy (2016>)	×	!	•	!	×	-	×
Ka (2009 - 2016)	×	•	-	•	-	-	-
Ka+ (2016 - 2018)	×	•	×	•	-	-	-
🚗 Ka+ (2018>)	×	•	×	•	-	-	-
Kuga (2012 - 2016)	×	•	×	•	-	-	-
Kuga (2016>)	×	•	×	•	-	-	-
Maverick (2000 - 2007)	×	•	×	•	-	-	-
Mondeo (2002 - 2007)	×	×	×	×	-	-	-
Mondeo (2007 - 2010)	×	•	×	•	-	-	-
Mondeo (2014>)	×	•	×	•	-	-	-
Mondeo Estate (2007 - 2015)	×	•	×	•	-	-	-
🚗 Mondeo Estate (2015>)	×	•	×	•	-	-	-
Mondeo Hatchback (2007 - 2015)	×	•	×	•	-	-	-
Mondeo Saloon (2007 - 2015)	×	•	×	•	-	-	-
Mondeo Ranger (2011 - 2015)	×	•	×	•	-	-	-
Mondeo Turnier (2007 - 2014)	×	•	×	•	-	-	-
🚗 Mondeo Vignale (2018>)	×	•	×	•	-	-	-

SBI S-Max (2006 - 2014)	X	!	X	!	X	-	X
SBI S-Max (2014>)	X	.	.	!	X	-	X
Tourneo Connect (2009 - 2013)	X	.	X	.	-	-	-
Tourneo Custom (2012>)	X	.	.	X	-	.	-
Transit Connect (2003 - 2007)	X	.	.	X	-	-	-
Transit Kombi (2006 - 2013)	X	.	.	X	-	-	-
Transit Custom (2012>)	X	.	.	X	-	.	-
Vignale (2018>)	X	.	X	.	-	-	-

Honda

Accord Saloon (2008 - 2012)	X	.	X	.	-	-	-
Accord Tourer (2008 - 2015)	X	.	X	.	-	-	-
City (2008 - 2014)	X	.	X	.	-	-	-
Civic (2006 - 2011)	X	.	X	.	-	-	-
Civic (2012 - 2015)	X	.	X	.	-	-	-
Civic (2016>)	X	.	X	.	-	-	-
Civic Hybrid Saloon (2006 - 2010)	X	.	X	.	-	-	-
Civic Type R (2007 - 2010)	X	.	X	.	-	-	-
Civic Prestige (2006 - 2010)	X	.	X	.	-	-	-
Civic Prestige 5dr (2016>)	X	.	X	.	-	-	-
Civic Tourer (2013>)	X	.	X	.	-	-	-
CR-V (2007 - 2011)	X	.	X	.	-	-	-
CR-V (2011 - 2016)	X	.	X	.	-	-	-
 CR-V (2016>)	X	.	X	.	-	-	-
CR-Z (2010 - 2016)	X	.	X	.	-	-	-
Elysion (2004 - 2013)	X	.	X	.	X	X	X
FRV (2005 - 2011)	X	.	X	.	-	-	-
HR-V (2014 - 2018)	X	.	X	.	-	-	-
 HR-V (2018>)	X	.	X	.	-	-	-
Insight (2009 - 2012)	X	.	X	.	-	-	-
Jazz (2001 - 2008)	X	.	X	.	-	-	-
Jazz (2008 - 2015)	X	.	X	.	-	-	-
Jazz (2013 - 2017)	X	.	X	.	-	-	-
 Jazz (2017>)	X	.	X	.	-	-	-
 Jazz Sport (2017>)	X	.	X	.	-	-	-
Legend (2006 - 2010)	X	X	X	X	-	-	-
Odyssey (2008 - 2011)	X	X	X	X	-	-	-

Hyundai

Accent (1999 - 2003)	X	.	X	.	-	-	-
Coupe (1996 - 2002)	X	.	X	.	-	-	-
Elantra (2000 - 2003)	X	.	X	.	-	-	-
Excel (2002 - 2006)	X	.	X	.	-	-	-
Getz (2002 - 2005)	X	.	X	.	-	-	-
Getz (2005 - 2011)	X	.	X	.	-	-	-
Grandeur (2005 - 2011)	X	.	X	.	-	-	-
i10 (2008 - 2013)	X	.	X	.	-	-	-
i10 Hatch (2008 - 2013)	X	.	X	.	-	-	-
i10 (2016>)	X	.	X	.	-	-	-
i20 Hatch (2009 - 2014)	X	.	X	.	-	-	-
i20 (2014 - 2018)	X	.	X	.	-	-	-
i20 (2018>)	X	.	X	.	-	-	-
i30 (2012 - 2015)	X	.	X	.	-	-	-
i30 (2016>)	X	.	X	.	-	-	-
i40 (2011 - 2018)	X	.	X	.	-	-	-
i800/H1 (2008>)	X	.	X	.	X	X	X
Ioniq (2016>)	X	.	X	.	-	-	-
iX20 (2010>)	X	.	X	.	-	-	-
iX35 (2009 - 2013)	X	.	X	.	-	-	-
iX55 (2009>)	X	.	X	.	-	-	-
Kona (2017 - 2018)	X	.	X	.	-	-	-
 Kona (2018>)	X	.	X	.	-	-	-
Matrix (2001 - 2010)	X	.	X	.	-	-	-
Pony (2002 - 2006)	X	.	X	.	-	-	-
Santa Fe (2000 - 2004)	X	.	X	.	-	-	-
Santa Fe (2007 - 2012)	X	.	X	.	X	-	X
Santa Fe (2012 - 2016)	X	.	X	.	-	-	-
Santa Fe (2016>)	X	.	X	.	-	-	-
Tucson (2004 - 2009)	X	.	X	.	-	-	-
Tucson (2009 - 2013)	X	.	X	.	-	-	-
Tucson (2013 - 2016)	X	.	X	.	-	-	-
Tucson (2018>)	X	.	X	.	-	-	-
Veloster (2011 - 2018)	X	.	-	.	-	-	-
Verna (1999 - 2005)	X	.	X	.	-	-	-

Infiniti

EX SUV (2009 - 2015)	✗	•	✗	•	-	-	-
FX SUV (2008 - 2013)	✗	•	✗	•	-	-	-
G 70 (2016>)	✗	•	✗	•	-	-	-
G Coupe (2009 - 2013)	✗	✗	✗	✗	-	-	-
G Saloon (2009 - 2013)	✗	•	✗	•	-	-	-
M Saloon (2010 - 2014)	✗	•	✗	•	-	-	-

Isuzu

D-Max (2004 - 2014)	✗	•	✗	•	-	-	-
---------------------	---	---	---	---	---	---	---

Jaguar

E-Pace (2017>)	✗	•	✗	•	-	-	-
F-Pace (2015>)	✗	•	✗	•	-	-	-
F-Type Coupe (2014 - 2017)	✗	•	✗	•	-	-	-
I-Pace (2018>)	✗	-	-	-	-	-	-
S-Type (1999 - 2002)	✗	•	✗	•	-	-	-
X-Type (2001 - 2010)	✗	✗	✗	✗	-	-	-
X-Type Estate (2004 - 2010)	✗	✗	✗	✗	-	-	-
XE (2015 - 2018)	✗	•	✗	•	-	-	-
XE (2018>)	✗	•	✗	•	-	-	-
XF (2008 - 2012)	✗	•	✗	•	-	-	-
XF (2015>)	✗	•	✗	•	-	-	-
XF R (2009>)	✗	•	✗	•	-	-	-
XF Sportbrake (2012 - 2015)	✗	•	✗	•	-	-	-
XF Sportbrake (2017>)	✗	•	✗	•	-	-	-
XJ (1997 - 2003)	✗	•	✗	•	-	-	-
XJ (2009 - 2012)	✗	•	✗	•	-	-	-
XJ (2012>)	✗	•	✗	•	-	-	-
XK Coupe (2006 - 2009)	✗	•	-	-	-	-	-
XK Convertible (2006 - 2009)	✗	•	-	-	-	-	-
XK R (2006 - 2008)	✗	•	-	-	-	-	-

Jeep

Cherokee (2013 - 2018)	✗	•	✗	•	-	-	-
Cherokee (2018>)	✗	•	✗	•	-	-	-
Compass (2011 - 2016)	✗	•	✗	•	-	-	-

Compass (2016>)	✗	•	✗	•	-	-	-
Grand Cherokee (2010 - 2013)	✗	•	✗	•	-	-	-
Grand Patriot (2007 - 2014)	✗	•	✗	•	-	-	-
Renegade (2014 - 2018)	✗	•	✗	•	-	-	-
Renegade (2018>)	✗	✗	✗	✗	-	-	-
Wrangler 5dr (2006 - 2018)	✗	•	✗	•	-	-	-
Wrangler (2018>)	✗	•	✗	•	-	-	-

Kia

Carens (2002 - 2006)	✗	•	✗	•	-	-	-
Carens (2013>)	✗	•	✗	•	✗	-	✗
Carnival (2006)	✗	•	✗	•	•	-	•
Cee'D (2005 - 2015)	✗	•	✗	•	-	-	-
Cee'D Hatch (2012 - 2015)	✗	•	✗	•	-	-	-
Cee'D Hatch (2018>)	✗	•	✗	•	-	-	-
Magentis (2002 - 2005)	✗	•	✗	•	-	-	-
Mentor (1992 - 2003)	✗	•	✗	•	-	-	-
Niro (2018>)	✗	•	✗	•	-	-	-
Opirus (2003 - 2010)	✗	•	✗	•	-	-	-
Optima (2011 - 2015)	✗	•	✗	•	-	-	-
Optima (2016 - 2018)	✗	•	✗	•	-	-	-
Picanto (2004 - 2007)	✗	•	✗	•	-	-	-
Picanto (2011 - 2015)	✗	•	✗	•	-	-	-
Picanto (2017>)	✗	•	✗	•	-	-	-
Rio (2012 - 2016)	✗	•	✗	•	-	-	-
Rio (2016>)	✗	•	✗	•	-	-	-
Sephia (1997 - 2003)	✗	•	✗	•	-	-	-
Shuma (2001 - 2004)	✗	•	✗	•	-	-	-
Sorento (2010 - 2014)	✗	•	✗	•	-	-	-
Sorento (2014 - 2017)	✗	•	✗	•	✗	-	✗
Soul (2008 - 2013)	✗	•	✗	•	-	-	-
⚡ Soul EV (2013 - 2018)	✗	•	✗	•	-	-	-
⚡ Soul (2018>)	✗	•	✗	•	-	-	-
Spectra (2000 - 2009)	✗	•	✗	•	-	-	-
Sportage (2011 - 2015)	✗	•	✗	•	-	-	-
Sportage (2015 - 2018)	✗	•	✗	•	-	-	-
Sportage (2018>)	✗	•	✗	•	-	-	-
Stonic (2017>)	✗	•	✗	•	-	-	-

Lancia

Venga (2009 - 2014) X . X . - - -
 Venga (2014>) X . X . - - -

Delta (2008 - 2013) X . X . - - -
 Flavia Convertible (2012 - 2015) X . X . - - -
 Musa (2003 - 2012) X . X . - - -
 Phedra (2002 - 2010) X . X . - - -
 Thema (2011 - 2014) X . X . - - -
 Voyager (2010 - 2015) X . - . - - -
 Ypsilon (2003 - 2006) X . X . - - -
 Ypsilon (2011 - 2015) X . X . - - -

Land Rover

Discovery 4 (2009 - 2013) X . X . - - -
 Discovery 5 (2017>) X . X . X - X
 Discovery Sport (2014>) X . X . X - X
 Freelander 2 (2006 - 2009) X . X . - - -
 Range Rover (2002 - 2012) X . X . - - -
 Range Rover (2013 - 2017) X . X . - - -
 Range Rover (2017>) X . X . - - -
 Range Rover Evoque 3dr (2011 - 2015) X . X . - - -
 Range Rover Evoque 5dr (2011 - 2015) X . X . - - -
 Range Rover Evoque 3dr (2018>) X . X . - - -
 Range Rover Evoque 5dr (2018>) X . X . - - -
 Range Rover Sport (2005 - 2012) X . X . - - -
 Range Rover Sport (2013 - 2017) X . X . - - -
 ⚡ Range Rover Sport (2017>) X . X . - - -
 Range Rover Velar (2017>) X . X . - - -
 Range Rover Vogue (2018>) X . X . - - -

Lexus

CT (2011 - 2014) X . X . - - -
 CT (2017>) X . X . - - -
 GS (2000 - 2011) X . X . - - -
 ⚡ GSh (2013>) X . X . - - -

IS Saloon (2005 - 2012) X . X . - - -
 IS Saloon (2016>) X . X . - - -
 LS430 (1997 - 2000) X . X . - - -
 ⚡ LS 500h (2017>) X . X . - - -
 NX (2014 - 2017) X . X . - - -
 NX (2017>) X . X . - - -
 RC 3dr (2018>) X . X . - - -
 RX300/RX400 (2004 - 2008) X . X . - - -
 RX450h (2008 - 2012) X . X . - - -
 RX (2012 - 2016) X . X . - - -
 RX (2016>) X . X . - - -
 RXL (2018>) X . X . - - -

Maserati

Gran Turismo (2007>) X . X . - - -
 Quattroporte (2003 - 2012) X . X . - - -

Maybach

W240/V240 (2002 - 2012) X . X . - - -

Mazda

2 (2007 - 2014) X . X . - - -
 2 (2014>) X . X . - - -
 3 Hatchback (2009 - 2013) X . X . - - -
 3 Hatchback (2013 - 2016) X . X . - - -
 3 Saloon (2009 - 2013) X . X . - - -
 323 (1998 - 2003) X . X . - - -
 5 (2005 - 2010) X . X . - - -
 6 (2002 - 2008) X . X . - - -
 6 (2018>) X . X . - - -
 6 Estate (2007 - 2013) X . X . - - -
 6 Estate (2018>) X . X . - - -
 6 Hatch (2007 - 2012) X . X . - - -
 6 Saloon (2007 - 2009) X . X . - - -
 6 Saloon (2009 - 2013) X . X . - - -
 CX-3 (2015 - 2018) X . X . - - -

CX-5 (2012 - 2016)	X	.	X	.	-	-	-
CX-5 (2016>)	X	.	X	.	-	-	-
CX-7 (2007 - 2011)	X	.	X	.	-	-	-
Demio (2002 - 2007)	X	.	X	.	-	-	-
MPV (1999 - 2004)	X	.	X	.	-	-	-
MX-5 (1998 - 2005)	X	.	X	.	-	-	-
MX-5 (2015>)	X	-	-	-	-	-	-
Premacy (1999 - 2005)	X	-	-	-	-	-	-
RX-8 (2003 - 2010)	X	.	X	.	-	-	-
Tribute (2001 - 2004)	X	.	X	.	-	-	-
Verisa (2004>)	X	.	X	.	-	-	-

Mercedes-Benz

A Class (2001 - 2005)	X	.	X	.	-	-	-
A Class (2005 - 2012)	X	.	X	.	-	-	-
A-Class (2012 - 2018)	X	.	X	.	-	-	-
B-Class (2011 - 2014)	X	.	X	.	-	-	-
⚡ B-Class EV (2014 - 2018)	X	.	X	.	-	-	-
C-Class (2000 - 2007)	X	.	X	.	-	-	-
C-Class (2007 - 2014)	X	.	X	.	-	-	-
C-Class Coupe (2011 - 2013)	X	.	.	.	-	-	-
C-Class Estate (2007 - 2011)	X	.	X	.	-	-	-
C-Class Estate (2014 - 2018>)	X	.	X	.	-	-	-
Citan (2012>)	X	.	X	.	-	-	-
CLA (2013 - 2016)	X	.	X	.	-	-	-
CLC (2008 - 2012)	X	.	X	.	-	-	-
CLK (2002 - 2010)	X	.	X	.	-	-	-
CLS Coupe (2004)	X	.	X	.	-	-	-
CLS Coupe (2011 - 2016)	X	.	X	.	-	-	-
CLS Coupe (2016>)	X	.	X	.	-	-	-
CLS Shooting Brake (2012 - 2017)	X	.	X	.	-	-	-
E-Class Coupe (2009 - 2012)	X	.	.	.	-	-	-
E-Class (2002 - 2009)	X	.	X	.	-	-	-
E-Class (2006 - 2009)	X	.	X	.	-	-	-
E-Class (2016>)	X	.	X	.	-	-	-
E-Class Estate (2010 - 2016)	X	.	X	.	-	-	-
E-Class Estate AMG (2016>)	X	.	X	.	-	-	-
E-Class Saloon (2009 - 2016)	X	.	X	.	-	-	-

E-Class Saloon (2016>)	X	.	X	.	-	-	-
GL Class (2006 - 2012)	X	.	X	.	-	-	-
GL Class (2012 - 2016)	X	.	X	.	-	-	-
GLA (2013 - 2017)	X	.	X	.	-	-	-
GLA (2017>)	X	.	X	.	-	-	-
GLC Coupe (2016>)	X	.	X	.	-	-	-
GLC SUV (2015>)	X	.	X	.	-	-	-
GLE (2015 - 2019)	X	.	X	.	-	-	-
GLE SUV (2019>)	X	.	X	.	-	-	-
GLK (2008 - 2015)	X	.	X	.	-	-	-
GLS (2016>)	X	.	X	.	-	-	-
M (2011 - 2015)	X	.	X	.	-	-	-
M-Klasse (1997 - 2005)	X	.	X	.	-	-	-
ML-Class (2005 - 2012)	X	.	X	.	-	-	-
ML-Class (2012 - 2015)	X	.	X	.	-	-	-
R-Class (2005 - 2012)	X	.	X	.	-	-	-
S Class (2005 - 2015)	X	.	X	.	-	-	-
S-Class (2018>)	X	.	X	.	-	-	-
SL Class (2011 - 2016)	X	-	-	-	-	-	-
SLK (2011 - 2016)	X	-	-	-	-	-	-
Sprinter (2006 - 2013)	X	.	X	.	-	-	-
V-Class (2014 - 2019)	X	.	.	.	X	.	.
Vaneo (2001 - 2005)	X	.	.	.	-	-	-
Viano (2003 - 2010)	X	.	X	.	-	-	-
Vito (2003 - 2014)	X	.	.	X	.	.	-

MG

25 (1999 - 2005)	X	X	X	X	-	-	-
GS (2016>)	X	.	X	.	-	-	-
3 (2013>)	X	.	X	.	-	-	-
Streetwise (1999 - 2005)	X	X	X	X	-	-	-
ZR (2001 - 2005)	X	X	X	X	-	-	-
ZT (2003 - 2006)	X	X	X	X	-	-	-

MINI

Club Man (2015>)	X	.	X	.	-	-	-
Convertible (2018>)	X	X	X	X	-	-	-

Countryman (2010 - 2014)	×	•	×	•	-	-	-
Countryman 4 (2010 - 2014)	×	•	×	•	-	-	-
Countryman 5 (2010 - 2014)	×	•	×	•	-	-	-
Countryman (2016>)	×	•	×	•	-	-	-
Hatchback (2006 - 2014)	×	•	-	•	-	-	-
Hatchback (2014 - 2018)	×	•	-	•	-	-	-
Coupe (2009 - 2015)	×	×	×	×	-	-	-
Hatchback 3dr (2014 - 2018)	×	•	-	•	-	-	-
Hatchback 3dr (2018>)	×	•	×	•	-	-	-
Hatchback 5dr (2014 - 2018)	×	•	×	•	-	-	-
Hatchback 5dr (2018>)	×	•	×	•	-	-	-
Paceman (2013 - 2016)	×	•	-	•	-	-	-
R56 (2010 - 2015)	×	•	×	•	-	-	-
R57 (2007 - 2014)	×	•	×	•	-	-	-

Mitsubishi

ASX (2010 - 2012)	×	•	×	•	-	-	-
Colt (2004 - 2008)	×	•	×	•	-	-	-
Colt (2007 - 2013)	×	•	×	•	-	-	-
Grandis (2004 - 2011)	×	•	×	•	-	-	-
Lancer (2007 - 2011)	×	•	×	•	-	-	-
Lancer Evo (2003 - 2007)	×	•	-	•	-	-	-
Lancer Ralliart (2009 - 2011)	×	•	×	•	-	-	-
Lancer Sportback (2008 - 2012)	×	•	×	•	-	-	-
Mirage (2012>)	×	•	×	•	-	-	-
Outlander (2003 - 2007)	×	•	×	•	-	-	-
Outlander (2006 - 2013)	×	•	×	•	-	-	-
Outlander (2012 - 2016)	×	•	×	•	-	-	-
⚡ Outlander PHEV (2016>)	×	•	×	•	-	-	-
Pajero (2006>)	×	•	×	•	-	-	-
Shogun (2007 - 2009)	×	•	×	•	-	-	-

Nissan

Almera (2000 - 2002)	×	•	×	•	-	-	-
Juke (2010>)	×	•	×	•	-	-	-
⚡ Leaf EV (2010 - 2017)	×	•	×	•	-	-	-
⚡ Leaf EV (2017>)	×	•	×	•	-	-	-

Maxima (1995 - 2000)	×	•	×	•	-	-	-
Micra (1998 - 2000)	×	•	×	•	-	-	-
Micra (2010 - 2013)	×	•	×	•	-	-	-
Micra (2013 - 2017)	×	•	×	•	-	-	-
Micra (2017>)	×	•	×	•	-	-	-
Murano (2003 - 2007)	×	•	×	•	-	-	-
Murano (2015 - 2018)	×	•	×	•	-	-	-
Navara (2001 - 2005)	×	•	×	•	-	-	-
Note (2004 - 2013)	×	•	×	•	-	-	-
Note (2013 - 2017)	×	•	×	•	-	-	-
Pathfinder (2005 - 2007)	×	•	×	•	-	-	-
Pixo (2009 - 2013)	×	•	×	•	-	-	-
Primera (1996 - 2002)	×	•	×	•	-	-	-
Pulsar (2014>)	×	•	×	•	-	-	-
Qashqai +2 (2008 - 2015)	×	•	×	•	-	-	-
Qashqai (2007 - 2013)	×	•	×	•	-	-	-
Qashqai (2013 - 2018)	×	•	×	•	-	-	-
Qashqai (2018>)	×	•	×	•	-	-	-
Quest MPV (2011>)	×	•	-	•	-	-	•
Tiida (2004>)	×	•	×	•	-	-	-
2008 X-Trail (2001 - 2007)	×	•	×	•	-	-	-
2008 X-Trail (2007 - 2015)	×	•	×	•	-	-	-
X-Trail (2014 - 2017)	×	•	×	•	-	×	×
X-Trail (2017>)	×	•	×	•	-	×	×

Opel

Adam (2013>)	×	•	-	•	-	-	-
Agila (2000 - 2007)	×	•	×	•	-	-	-
Agila (2008 - 2015)	×	•	×	•	-	-	-
⚡ Ampera (2011 - 2015)	×	•	-	•	-	-	-
Antara (2006 - 2015)	×	•	×	•	-	-	-
Astra (2004 - 2010)	×	•	×	•	-	-	-
Astra 5dr (2009 - 2015)	×	•	×	•	-	-	-
Astra (2015>)	×	•	×	•	-	-	-
Astra Estate (2010 - 2015)	×	•	×	•	-	-	-
Astra GTC (2011>)	×	•	×	•	-	-	-
Caravan (1998 - 2005)	×	•	×	•	-	-	-
Combo (2001 - 2011)	×	•	×	•	-	-	-

Corsa 3dr Hatch (2006 - 2015)	X	.	X	.	-	-	-
Corsa 5dr Hatch (2006 - 2015)	X	.	X	.	-	-	-
Corsa 5dr (2014>)	X	.	X	.	-	-	-
Corsa C (2000 - 2006)	X	.	X	.	-	-	-
Corsa D (2006 - 2014)	X	.	X	.	-	-	-
Corsa VXR (2007 - 2014)	X	.	X	.	-	-	-
Insignia Hatch (2008 - 2013)	X	.	X	.	-	-	-
Insignia Saloon (2008 - 2013)	X	.	X	.	-	-	-
Insignia Sports Tourer (2009 - 2013)	X	.	X	.	-	-	-
Karl (2015>)	X	.	X	.	-	-	-
Meriva (2002 - 2010)	X	.	X	.	-	-	-
Meriva (2010 - 2014)	X	.	X	.	-	-	-
Mokka (2012 - 2016)	X	.	X	.	-	-	-
Signum (2003 - 2008)	X	.	X	.	-	-	-
Vectra (2002 - 2008)	X	.	X	.	-	-	-
Vivaro (2001 - 2014)	X	.	X	.	-	-	-
Zafira (2005 - 2014)	X	.	X	.	-	-	-
Zafira Tourer (2011 - 2016)	X	.	X	.	X	-	X

Peugeot

107 (2005 - 2014)	X	.	-	.	-	-	-
108 3dr (2014>)	X	.	-	.	-	-	-
108 5dr (2014>)	X	.	-	.	-	-	-
206 (1998 - 2009)	X	.	X	.	-	-	-
206 3dr (2004 - 2009)	X	.	X	.	-	-	-
207 3dr (2006 - 2012)	X	.	X	.	-	-	-
207 5dr (2006 - 2012)	X	.	X	.	-	-	-
207 SW (2007 - 2012)	X	.	X	.	-	-	-
208 3dr (2012>)	X	.	X	.	-	-	-
208 5dr (2012>)	X	.	X	.	-	-	-
307 (2001 - 2008)	X	.	X	.	-	-	-
307 Estate (2002 - 2007)	X	.	X	.	-	-	-
308 (2014 - 2017)	X	.	X	.	-	-	-
308 (2017>)	X	.	X	.	-	-	-
308 Hatch (2007 - 2014)	X	.	X	.	-	-	-
308 SW (2008 - 2015)	X	.	X	.	-	-	-
308 SW (2014 - 2017)	X	.	X	.	-	-	-
308 SW (2017>)	X	.	X	.	-	-	-

406 (1999 - 2004)	X	.	X	.	-	-	-
407 (2004 - 2011)	X	X	X	X	-	-	-
407 SW (2004 - 2011)	X	X	X	X	-	-	-
508 (2011>)	X	.	X	.	-	-	-
508 RXH (2011 - 2014)	X	.	X	.	-	-	-
508 SW (2010 - 2014)	X	.	X	.	-	-	-
607 (2000 - 2009)	X	.	X	.	-	-	-
SBI 807 (2002 - 2010)	X	!	X	!	.	-	.
1007 (2005 - 2009)	X	.	X	.	-	-	-
2008 (2013>)	X	.	X	.	-	-	-
SBI 3008 (2009 - 2016)	X	!	X	!	-	-	-
3008 (2016>)	X	.	X	.	-	-	-
4007 (2007 - 2012)	X	.	X	.	-	-	-
4008 (2012>)	X	.	X	.	-	-	-
SBI 5008 (2009 - 2013)	X	!	.	!	X	-	X
SBI 5008 (2013>)	X	!	.	!	X	-	X
Bipper (2008 - 2017)	X	.	X	.	-	-	-
Expert Tepee (2007 - 2016)	X	.	X	.	X	X	X
Partner Combi (2004 - 2010)	X	X	X	X	-	-	-
Partner Tepee (2008>)	X	.	X	.	-	-	-
RCZ (2009 - 2013)	X	X	-	X	-	-	-
Rifter (2018>)	X	.	.	.	-	-	-
Traveller (2016>)	X	.	.	.	X	X	X

Pontiac

Grand AM (1998 - 2004)	X	.	X	.	-	-	-
------------------------	---	---	---	---	---	---	---

Porsche

Cayenne (2002 - 2006)	X	.	X	.	-	-	-
Cayenne (2010 - 2015)	X	.	X	.	-	-	-
⚡ Cayenne E-Hybrid (2015 - 2017)	X	.	X	.	-	-	-
⚡ Cayenne E-Hybrid (2017>)	X	.	X	.	-	-	-
Macan (2014 - 2018)	X	.	X	.	-	-	-
Macan Turbo (2018>)	X	.	X	.	-	-	-
Panamera (2009 - 2013)	X	.	-	.	-	-	-
⚡ Panamera E-Hybrid (2016>)	X	.	-	.	-	-	-
Panamera Estate (2017>)	X	.	X	.	-	-	-

Renault

Avantime (2001 - 2003)	×	•	×	•	-	-	-
Captur (2013 - 2017)	×	•	×	•	-	-	-
Captur (2017>)	×	•	×	•	-	-	-
Clio (1998 - 2003)	×	•	×	•	-	-	-
Clio (2005 - 2012)	×	•	×	•	-	-	-
Clio (2013 - 2016)	×	•	×	•	-	-	-
Clio (2016>)	×	•	×	•	-	-	-
Clio Sport (2006 - 2012)	×	•	×	•	-	-	-
Clio Sport (2013 - 2016)	×	•	×	•	-	-	-
Clio Sport RS 5dr (2016>)	×	•	×	•	-	-	-
Espace (2003 - 2012)	×	•	•	•	•	•	•
Fluence (2009 - 2014)	×	•	×	•	-	-	-
Grand Espace (1998 - 2002)	×	•	•	•	•	•	•
Grand Espace (2002 - 2012)	×	•	•	•	•	•	•
Grand Modus (2008 - 2012)	×	•	×	•	-	-	-
Grand Scenic (2006 - 2009)	×	×	•	×	-	-	-
Kangoo (1997 - 2003)	×	×	•	×	-	-	-
Kangoo (2008 - 2013)	×	•	×	•	-	-	-
Kadjar (2015 - 2018)	×	•	×	•	-	-	-
Kadjar (2018>)	×	•	×	•	-	-	-
Koleos (2016>)	×	•	×	•	-	-	-
Laguna (2001 - 2007)	×	•	×	•	-	-	-
Laguna (2008>)	×	•	×	•	-	-	-
Laguna Grand Tour (2007 - 2010)	×	•	×	•	-	-	-
Laguna Sport Tourer (2008 - 2012)	×	•	×	•	-	-	-
Megane (1996 - 1999)	×	•	×	•	-	-	-
Megane (2006 - 2009)	×	•	×	•	-	-	-
Megane Coupe (2002 - 2006)	×	•	×	•	-	-	-
Megane Grand Tour (1999 - 2003)	×	•	×	•	-	-	-
Megane Grand Tour (2009)	×	•	×	•	-	-	-
Megane Hatch (2002 - 2009)	×	•	×	•	-	-	-
SBI Megane Hatch (2008 - 2016)	×	!	×	!	-	-	-
Megane Hatch (2016>)	×	•	×	•	-	-	-
Megane Scenic (2003 - 2009)	×	•	×	•	-	-	-
Megane Sport Tourer (2009 - 2016)	×	•	×	•	-	-	-
Megane Sport Tourer (2016>)	×	•	×	•	-	-	-
Modus (2004 - 2012)	×	•	×	•	-	-	-
Grand Modus (2008 - 2012)	×	•	×	•	-	-	-
Sandero (2012>)	×	•	×	•	-	-	-

Scenic/Grand Scenic (1995 - 1999)	×	•	×	•	-	-	-
Scenic (2003 - 2009)	×	×	×	×	-	-	-
SBI Scenic (2009 - 2016)	×	!	×	!	-	-	-
SBI Scenic (2016>)	×	!	×	!	-	-	-
Trafic (2001 - 2007)	×	×	×	×	-	•	-
Trafic (2007 - 2010)	×	•	•	×	-	-	-
Twingo (1998 - 2007)	×	•	×	•	-	-	-
Twingo (2007 - 2014)	×	•	-	•	-	-	-
Twingo (2014 - 2018)	×	•	-	•	-	-	-
Twingo (2018>)	×	•	-	•	-	-	-
Vel Satis (2002 - 2005)	×	•	×	•	-	-	-
⚡ Zoe (2012>)	×	•	×	•	-	-	-

SAAB

9-3 (2002 - 2012)	×	•	×	•	-	-	-
9-3 Sport Wagon (2005 - 2012)	×	•	×	•	-	-	-
9-3 X (2009 - 2012)	×	•	×	•	-	-	-
9-5 (2011 - 2012)	×	•	×	•	-	-	-
9-5 Estate (2005 - 2010)	×	•	×	•	-	-	-

SEAT

Alhambra (1995 - 2010)	×	•	•	•	•	-	-
SBI Alhambra (2010>)	×	!	×	!	•	•	•
Altea (2004 - 2011)	×	•	×	•	-	-	-
Altea Freetrack4 (2007 - 2009)	×	•	×	•	-	-	-
Altea XL (2006 - 2011)	×	•	×	•	-	-	-
Arona (2017>)	×	•	×	•	-	-	-
Arosa (1997 - 2004)	×	•	-	•	-	-	-
Ateca Estate (2016>)	×	•	×	•	-	-	-
Cordoba Vario (1996 - 2002)	×	•	-	•	-	-	-
Exeo (2008 - 2014)	×	•	×	•	-	-	-
Exeo ST Estate (2008 - 2014)	×	•	×	•	-	-	-
Ibiza (1993 - 2002)	×	•	×	•	-	-	-
Ibiza (2002 - 2008)	×	•	×	•	-	-	-
Ibiza Cupra (2009 - 2012)	×	•	×	•	-	-	-
Ibiza FR (2009 - 2017)	×	•	×	•	-	-	-
Ibiza FR (2017>)	×	•	×	•	-	-	-

Ibiza Hatch (2008 - 2013)	X	.	X	.	-	-	-
Ibiza (2017>)	X	.	X	.	-	-	-
Inca (1995 - 2003)	X	.	X	.	-	-	-
Leon (1998 - 2005)	X	.	X	.	-	-	-
Leon Hatch (2005 - 2015)	X	.	X	.	-	-	-
Leon (2012>)	X	.	X	.	-	-	-
Leon Cupra (2007 - 2011)	X	.	X	.	-	-	-
Leon Cupra Special Edition (2018>)	X	.	X	.	-	-	-
Leon FR (2006 - 2012)	X	.	X	.	-	-	-
Leon FR (2012>)	X	.	X	.	-	-	-
Leon Sport Tourer (2013>)	X	.	X	.	-	-	-
Mii 3dr (2012>)	X	.	X	.	-	-	-
Mii 5dr (2012>)	X	.	X	.	-	-	-
Toledo (1994 - 2004)	X	.	X	.	-	-	-
Toledo (2012>)	X	.	X	.	-	-	-

Skoda

Citigo 3dr (2011 - 2017)	X	.	X	.	-	-	-
Citigo 5dr (2012 - 2017)	X	.	X	.	-	-	-
Citigo 3dr (2017>)	X	.	X	.	-	-	-
Citigo 5dr (2017>)	X	.	X	.	-	-	-
Fabia (1999 - 2007)	X	.	X	.	-	-	-
Fabia Hatch (2007 - 2014)	X	.	X	.	-	-	-
Fabia (2014 - 2018)	X	.	X	.	-	-	-
Fabia Estate Combi (2008 - 2014)	X	.	X	.	-	-	-
Fabia Estate (2018>)	X	.	X	.	-	-	-
Karoq (2017>)	X	.	X	.	-	-	-
Kodiaq (2018>)	X	.	X	.	-	-	-
Octavia (1996 - 2004)	X	.	X	.	-	-	-
Octavia Hatch (2004 - 2012)	X	.	X	.	-	-	-
Octavia Hatch (2013 - 2017)	X	.	X	.	-	-	-
Octavia Hatch (2017>)	X	.	X	.	-	-	-
Octavia Estate Combi (2005 - 2013)	X	.	X	.	-	-	-
Octavia Estate (2017>)	X	.	X	.	-	-	-
Octavia Scout (2007 - 2013)	X	.	X	.	-	-	-
Rapid (2013>)	X	.	X	.	-	-	-
Roomster (2006 - 2015)	X	.	X	.	-	-	-
Superb (2001 - 2008)	X	.	X	.	-	-	-

Superb (2008 - 2014)	X	.	X	.	-	-	-
Superb Estate (2015>)	X	.	X	.	-	-	-
Superb Hatch (2015>)	X	.	X	.	-	-	-
Superb Combi/Estate (2008 - 2013)	X	.	X	.	-	-	-
Yeti (2009 - 2013)	X	.	X	.	-	-	-

Smart

For Two Coupe (2007 - 2011)	X	-	-	-	-	-	-
For Two Coupe (2014>)	X	-	-	-	-	-	-
FourFour (2004 - 2006)	X	.	X	.	-	-	-
FourFour (2014>)	X	.	X	.	-	-	-

Ssangyong

Actyon (2006 - 2011)	X	.	X	.	-	-	-
Korando (2011- 2017)	X	.	X	.	-	-	-
Musso Pickup (2016>)	X	.	X	.	-	-	-
Rexton (2014 - 2016)	X	.	X	.	-	-	-
Tivoli (2015>)	X	.	X	.	-	-	-
Turismo (2013>)	X	.	-	.	X	X	X

Subaru

BRZ (2012>)	X	.	-	.	-	-	-
Forester (2003 - 2008)	X	.	X	.	-	-	-
Forester (2013 - 2018)	X	.	X	.	-	-	-
Impreza 5dr (2007 - 2012)	X	.	X	.	-	-	-
Impreza 5dr (2012 - 2016)	X	.	X	.	-	-	-
Justy (2004 - 2007)	X	.	X	.	-	-	-
Legacy (2003 - 2006)	X	.	X	.	-	-	-
Legacy (2009 - 2014)	X	.	X	.	-	-	-
Outback (2009 - 2014)	X	.	X	.	-	-	-
Sedan (2002 - 2004)	X	.	X	.	-	-	-
Wagon (2002 - 2004)	X	.	X	.	-	-	-
XV Hatchback (2011 - 2015)	X	.	X	.	-	-	-

Suzuki

Alto (2009>)	✗	•	-	•	-	-	-
Baleno (2016>)	✗	•	✗	•	-	-	-
Grand Vitara (2002 - 2008)	✗	•	✗	•	-	-	-
Grand Vitara (2008>)	✗	•	✗	•	-	-	-
Ignis (2003 - 2006)	✗	•	✗	•	-	-	-
Kizashi (2009>)	✗	•	✗	•	-	-	-
Liana (2001 - 2007)	✗	•	✗	•	-	-	-
Splash (2007>)	✗	•	✗	•	-	-	-
Swift (2004 - 2010)	✗	•	✗	•	-	-	-
Swift Sport (2011 - 2016)	✗	•	✗	•	-	-	-
SX-4 (2006 - 2013)	✗	•	✗	•	-	-	-
SX-4 Saloon (2006>)	✗	•	✗	•	-	-	-
Vitara (2014>)	✗	•	✗	•	-	-	-
Wagon R+ (2000 - 2003)	✗	•	✗	•	-	-	-

TATA

Indica Vista (2008 - 2013)	✗	•	✗	•	-	-	-
----------------------------	---	---	---	---	---	---	---

Tesla

⚡ Model S (2014>)	✗	•	✗	•	-	-	-
⚡ Model X (2016>)	✗	•	✗	•	•	✗	•

Toyota

Auris (2007 - 2012)	✗	•	✗	•	-	-	-
Auris (2013 - 2015)	✗	•	✗	•	-	-	-
Avensis Hatch (2003 - 2011)	✗	•	✗	•	-	-	-
Avensis Tourer (2009 - 2011)	✗	•	✗	•	-	-	-
Aygo 3dr (2005 - 2014)	✗	•	-	•	-	-	-
Aygo (2014 - 2018)	✗	•	-	•	-	-	-
Aygo (2018>)	✗	•	-	•	-	-	-
Aygo Explorer (2018>)	✗	•	-	•	-	-	-
Camry (1997 - 2001)	✗	•	✗	•	-	-	-
Corolla (2002 - 2007)	✗	•	✗	•	-	-	-
Corolla (2018>)	✗	•	✗	•	-	-	-
C-HR (2016>)	✗	•	✗	•	-	-	-

EZ MPV (Verso) (2013>)	✗	•	✗	•	-	-	-
GT86 (2012 - 2016)	✗	•	-	•	-	-	-
GT86 (2016>)	✗	•	-	•	-	-	-
Highlander (2013 - 2016)	✗	•	✗	•	-	-	-
IQ (2008 - 2015)	✗	•	✗	•	-	-	-
Landcruiser (2002 - 2009)	✗	•	✗	•	-	-	-
Landcruiser (2009 - 2013)	✗	•	✗	•	-	-	-
Landcruiser (2017>)	✗	•	✗	•	-	-	-
Previa (2000 - 2009)	✗	•	✗	•	-	-	-
⚡ Prius (2009 - 2011)	✗	•	✗	•	-	-	-
⚡ Prius 2 (2004 - 2010)	✗	•	✗	•	-	-	-
⚡ Prius 3 (2010 - 2016)	✗	•	✗	•	-	-	-
⚡ Prius 4 (2016>)	✗	•	✗	•	-	-	-
⚡ Prius Plus+ (2011 - 2015)	✗	•	✗	•	-	-	-
⚡ Prius PHEV 3 (2015>)	✗	•	✗	•	-	-	-
RAV4 (2000 - 2006)	✗	•	✗	•	-	-	-
RAV4 (2013 - 2015)	✗	•	✗	•	-	-	-
RAV4 (2018>)	✗	•	✗	•	-	-	-
RAV4 MK3 (2006 - 2011)	✗	•	✗	•	-	-	-
Urban Cruiser (2009 - 2012)	✗	•	✗	•	-	-	-
SB! Verso (2009 - 2012)	✗	•	!	✗	!	-	-
SB! Verso (2013>)	✗	•	!	✗	!	-	-
Yaris (1999 - 2005)	✗	•	✗	•	-	-	-
Yaris (2008 - 2011)	✗	•	✗	•	-	-	-
Yaris Hatch (2011 - 2014)	✗	•	✗	•	-	-	-
🚗 Yaris Hatch (2017>)	✗	•	✗	•	-	-	-

Vauxhall

Adam (2012>)	✗	•	-	•	-	-	-
Agila (2000 - 2007)	✗	•	✗	•	-	-	-
Agila (2008 - 2013)	✗	•	✗	•	-	-	-
⚡ Ampera (2011 - 2015)	✗	•	-	•	-	-	-
Antara (2006 - 2015)	✗	•	✗	•	-	-	-
Astra (2004 - 2010)	✗	•	✗	•	-	-	-
Astra (2015>)	✗	•	✗	•	-	-	-
Astra 5dr (2009 - 2015)	✗	•	✗	•	-	-	-
Astra Estate (2010 - 2012)	✗	•	✗	•	-	-	-
Astra GTC (2011>)	✗	•	✗	•	-	-	-

Astra Sport Tourer (2012>)	X	.	X	.	-	-	-
Caravan (1998 - 2005)	X	.	X	.	-	-	-
Combo (2001 - 2011)	X	.	X	.	-	-	-
Corsa 3dr Hatch (2006 - 2015)	X	.	X	.	-	-	-
Corsa 5dr Hatch (2006 - 2015)	X	.	X	.	-	-	-
Corsa 3dr (2014>)	X	.	X	.	-	-	-
Corsa 5dr (2014>)	X	.	X	.	-	-	-
Corsa C (2000 - 2006)	X	.	X	.	-	-	-
Corsa D (2006 - 2014)	X	.	X	.	-	-	-
Corsa VXR (2007 - 2014)	X	.	X	.	-	-	-
Crossland X (2017>)	X	.	X	.	-	-	-
Grandland X (2017>)	X	.	X	.	-	-	-
Insignia Hatch (2008 - 2013)	X	.	X	.	-	-	-
Insignia Hatch (2013>)	X	.	X	.	-	-	-
Insignia Sports Tourer (2009 - 2013)	X	.	X	.	-	-	-
Karl (2015>)	X	.	X	.	-	-	-
Meriva (2002 - 2010)	X	.	X	.	-	-	-
Meriva (2010 - 2014)	X	.	X	.	-	-	-
Mokka (2012 - 2016)	X	.	X	.	-	-	-
Mokka X (2012>)	X	.	X	.	-	-	-
Signum (2003 - 2008)	X	.	X	.	-	-	-
Vectra (2002 - 2008)	X	.	X	.	-	-	-
Vivaro (2001 - 2014)	X	.	X	.	-	-	-
Viva (2015>)	X	.	X	.	-	-	-
Zafira (2005 - 2014)	X	.	X	.	-	-	-
Zafira Tourer (2011 - 2016)	X	.	X	.	X	-	X

Volvo

C30 (2006 - 2013)	X	.	.	-	.	-	-	-
C70 (2005 - 2013)	X	.	X	.	-	-	-	-
S40 (2003 - 2012)	X	.	X	.	-	-	-	-
S60 (2010 - 2013)	X	.	X	.	-	-	-	-
S80 (2006 - 2008)	X	.	X	.	-	-	-	-
S90 (2016>)	X	.	X	.	-	-	-	-
V40 (1996 - 2004)	X	.	X	.	-	-	-	-
V40 (2012 - 2016)	X	.	X	.	-	-	-	-
V40 (2016>)	X	.	X	.	-	-	-	-
V40 Cross Country (2012 - 2016)	X	.	X	.	-	-	-	-

V40 Cross Country (2016>)	X	.	X	.	-	-	-
V50 (2004 - 2012)	X	.	X	.	-	-	-
V60 (2010 - 2013)	X	.	X	.	-	-	-
⚡ V60 PHEV (2014 - 2018)	X	.	X	.	-	-	-
V60 (2018>)	X	.	X	.	-	-	-
V70 (2007 - 2016)	X	.	X	.	-	-	-
V90 (2016>)	X	.	X	.	-	-	-
V90 Cross Country (2016>)	X	.	X	.	-	-	-
🚗 XC40 (2017>)	X	.	X	.	-	-	-
XC60 (2008 - 2013)	X	.	X	.	-	-	-
XC60 (2013 - 2017)	X	.	X	.	-	-	-
🚗 XC60 (2017>)	X	.	X	.	-	-	-
XC70 (2000 - 2007)	X	.	X	.	-	-	-
XC70 (2007 - 2016)	X	.	X	.	-	-	-
XC90 (2003 - 2015)	X	.	X	.	-	-	-
🚗 XC90 (2014>)	X	.	X	.	-	-	-

VW

Amarok (2009 - 2016)	X	.	X	.	-	-	-
Arteon (2017>)	X	.	X	.	-	-	-
Beetle (1998 - 2005)	X	.	.	-	-	-	-
Beetle (2011>)	X	.	.	-	-	-	-
Bora (1998 - 2005)	X	.	X	.	-	-	-
Caddy (2004 - 2010)	X	.	X	.	-	-	-
Caddy (2010 - 2013)	X	.	X	.	X	-	X
Caddy Maxlife (2010 - 2015)	X	.	X	.	X	-	X
⚡ E-Golf Hatch Mk7 (2014 - 2016)	X	.	X	.	-	-	-
EOS (2006 - 2011)	X	.	X	.	-	-	-
Fox (2005>)	X	.	X	.	-	-	-
⚡ Golf E (2014>)	X	.	X	.	-	-	-
Golf 4 (1997 - 2003)	X	.	X	.	-	-	-
Golf 4 Variant (1996 - 2006)	X	.	X	.	-	-	-
Golf Hatch Mk5 (2004 - 2008)	X	.	X	.	-	-	-
Golf Mk5 (2006 - 2009)	X	.	X	.	-	-	-
Golf Hatch (2008 - 2012)	X	.	X	.	-	-	-
Golf Hatch MK7 (2012>)	X	.	X	.	-	-	-
Golf Cabriolet (2009 - 2012)	X	.	X	.	-	-	-
Golf Estate (2017>)	X	.	X	.	-	-	-

⚡ Golf GTE Hatch Mk7 (2014 - 2017)	×	•	×	•	-	-	-
Golf Plus (2009 - 2011)	×	•	×	•	-	-	-
Golf Sportsvan (2017>)	×	•	×	•	-	-	-
Golf (2017>)	×	•	×	•	-	-	-
Jetta (2010 - 2014)	×	•	×	•	-	-	-
Lupo (1999 - 2005)	×	•	-	•	-	-	-
LT (1999 - 2006)	×	•	×	•	-	-	-
Multivan Caravelle (2008>)	×	•	-	•	•	×	•
New Beetle (1998 - 2002)	×	•	×	•	-	-	-
Passat (1996 - 2005)	×	•	×	•	-	-	-
Passat (2005 - 2010)	×	•	×	•	-	-	-
Passat (2010 - 2015)	×	•	×	•	-	-	-
Passat Estate (2005 - 2011)	×	•	×	•	-	-	-
Passat Estate (2011 - 2015)	×	•	×	•	-	-	-
Passat Estate (2015>)	×	•	×	•	-	-	-
Passat Saloon (2015>)	×	•	×	•	-	-	-
Passat Alltrack (2012 - 2015)	×	•	×	•	-	-	-
Passat CC (2008 - 2011)	×	•	×	•	-	-	-
Phaeton (2002 - 2015)	×	•	×	•	-	-	-
Polo 3 (1994 - 2001)	×	•	×	•	-	-	-
Polo 4 (2005 - 2009)	×	•	×	•	-	-	-
Polo 5 (2009 - 2014)	×	•	×	•	-	-	-
Polo 3dr (2009 - 2014)	×	•	×	•	-	-	-
Polo 5dr (2009 - 2014)	×	•	×	•	-	-	-
Polo (2017>)	×	•	×	•	-	-	-
Scirocco (2008 - 2014)	×	•	-	•	-	-	-
Sharan (1996 - 2000)	×	•	•	•	•	-	•
Sharan (2000 - 2010)	×	•	•	•	•	-	-
SB! Sharan (2010>)	×	!	•	!	•	•	×
T4 Caravelle (1995 - 2003)	×	•	•	×	×	×	×
Multivan (1999 - 2003)	×	•	×	•	•	-	•
T5 Kombi (2003 - 2010)	×	•	•	×	-	-	-
Multivan (2003>)	×	•	×	•	•	-	•
Tiguan (2007 - 2016)	×	•	×	•	-	-	-
Tiguan (2016>)	×	•	×	•	-	-	-
Touareg (2002 - 2010)	×	•	×	•	-	-	-
Touareg (2010 - 2014)	×	•	×	•	-	-	-
Touareg (2018>)	×	•	×	•	-	-	-
Touareg MK 1 (2003 - 2010)	×	•	×	•	-	-	-

Touran (2003 - 2010)	×	•	×	•	-	-	-
Touran (2010 - 2015)	×	•	×	•	×	-	×
Touran (2015>)	×	•	•	•	•	-	•
Transporter LT3 (1996 - 2006)	×	•	×	•	-	-	-
T-ROC (2017>)	×	•	×	•	-	-	-
📄 UP! (2011 - 2016)	×	•	×	•	-	-	-
⚡ E - UP! (2014 - 2016)	×	•	×	•	-	-	-
⚡ E - UP! 3dr (2016>)	×	•	×	•	-	-	-
⚡ E - UP! 5dr (2016>)	×	•	×	•	-	-	-



Allison Baby UK Ltd.
Venture Point, Towers Business Park,
Rugeley, Staffordshire, WS15 1UZ

bring the kids™

Share the joy at joiebaby.com

IM-000412G