

Joie™

birth to 15kg/0-36 months

# litetrax™ 3

時尚運動三輪推車

## 使用說明書

組裝及使用本產品前  
請先閱讀說明書全文

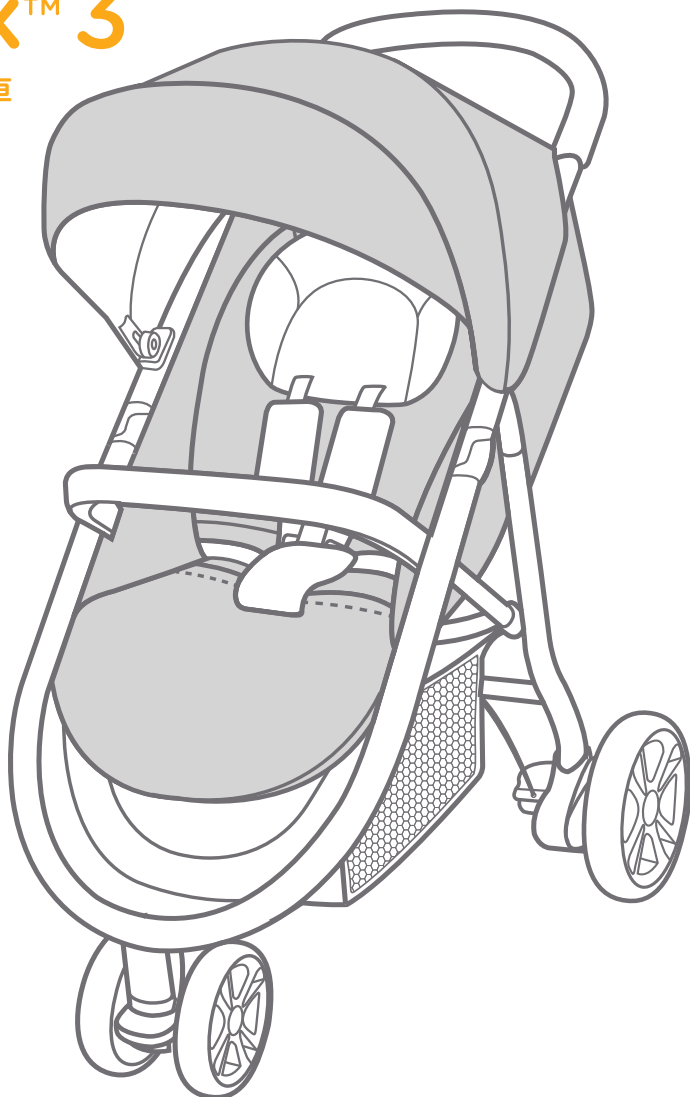

# 謝謝您使用本產品

你剛買了一台高品質和符合台灣安全標準CNS 12940:2013和歐洲安全標準EN 1888-1:2018+A1:2022的時尚運動三輪推車。這台車適用於重量15公斤(0-36個月)以下的寶寶。台灣區域使用請依照CNS標準規範。

請仔細研讀並依照本說明書的指示操作，如此才能保障並提供您的寶寶一個安全又舒適的行車旅程。

本說明書中採用的插圖是為了說明產品的操作方法和產品結構，當插圖與實物存在差異時，請以實物為準。

## 功能介紹

快速收合

背靠可多角度調節

座椅可坐、可躺

小腿靠可調

置物籃超大

織帶超柔軟

前輪定向

後輪可剎車

座布透氣

全罩式遮陽篷

五點式安全扣

！請保存好說明書，以便日後正確使用本產品。

# 目錄

參照圖示	1-7
中文	
警告	9
緊急情況處理	11
產品資訊	11
產品組件及各部位名稱	12
保養維護與保固	12
產品組裝	13
打開手推車	13
安裝前輪	13
安裝後輪	13
安裝扶手	13
產品操作	14
調整背靠角度	14
使用安全扣	14
使用肩帶和腰帶	14
使用肩帶護片	15
使用頭靠	15
調節小腿靠支撐板	15
前輪定向	15
使用剎車踏板	16
使用遮陽篷	16
收合手推車	16
使用配件	16

English	20-31
---------	-------

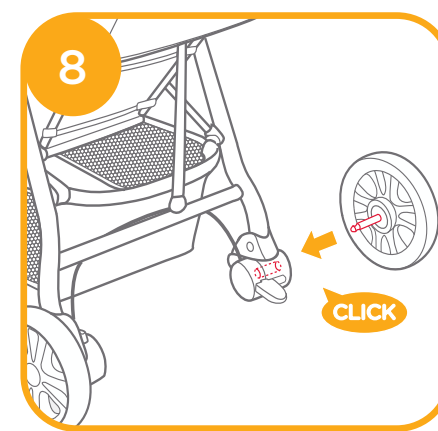
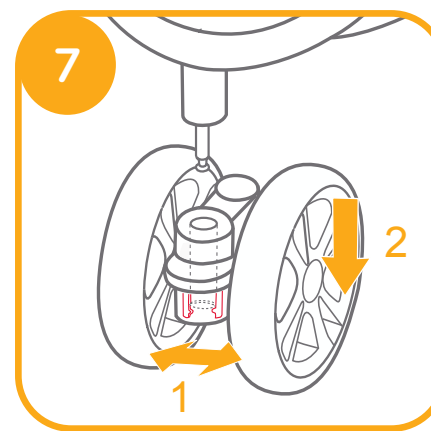
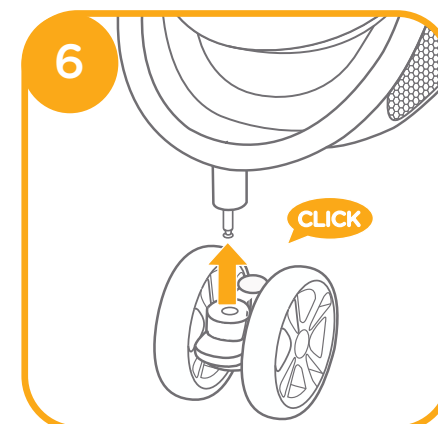
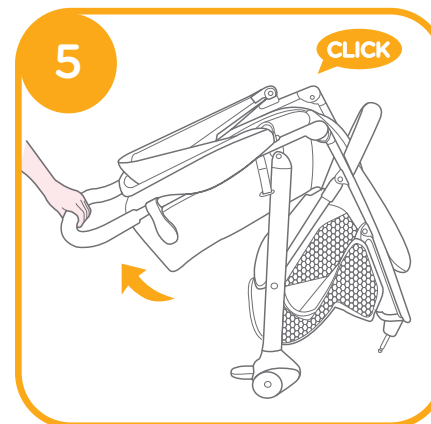
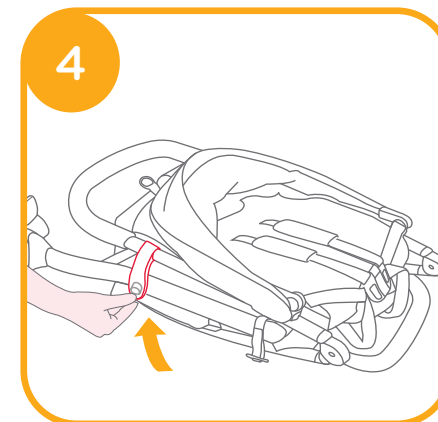
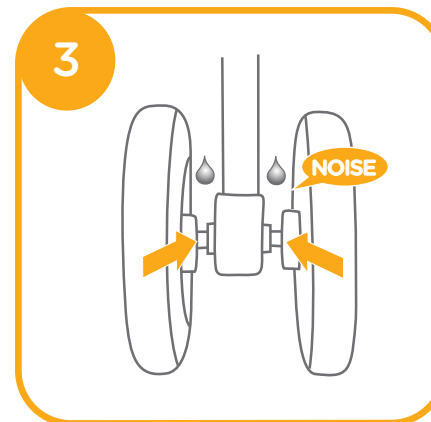
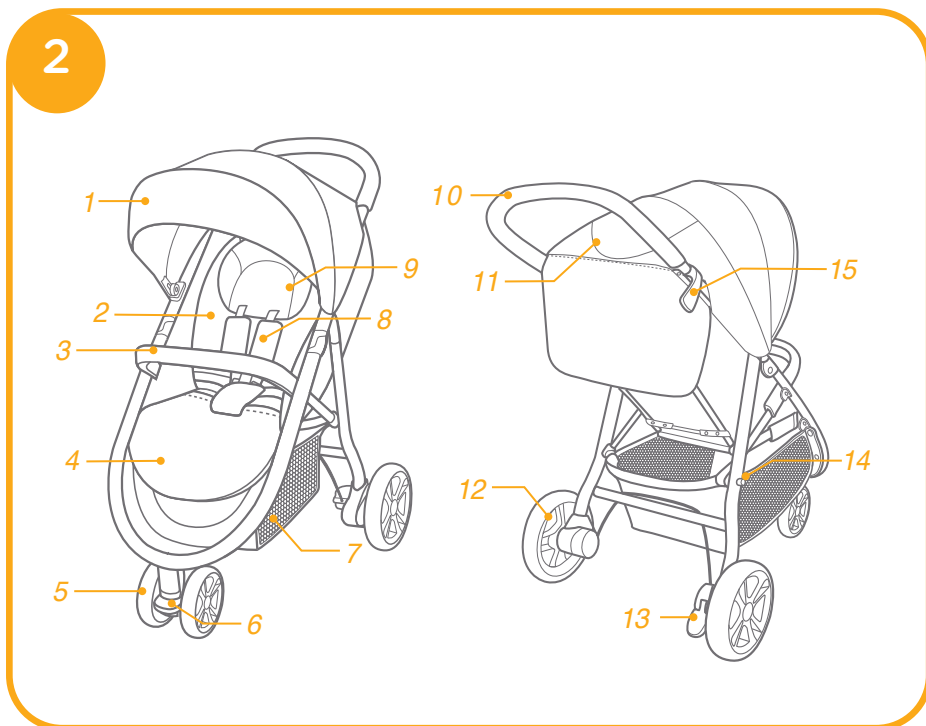
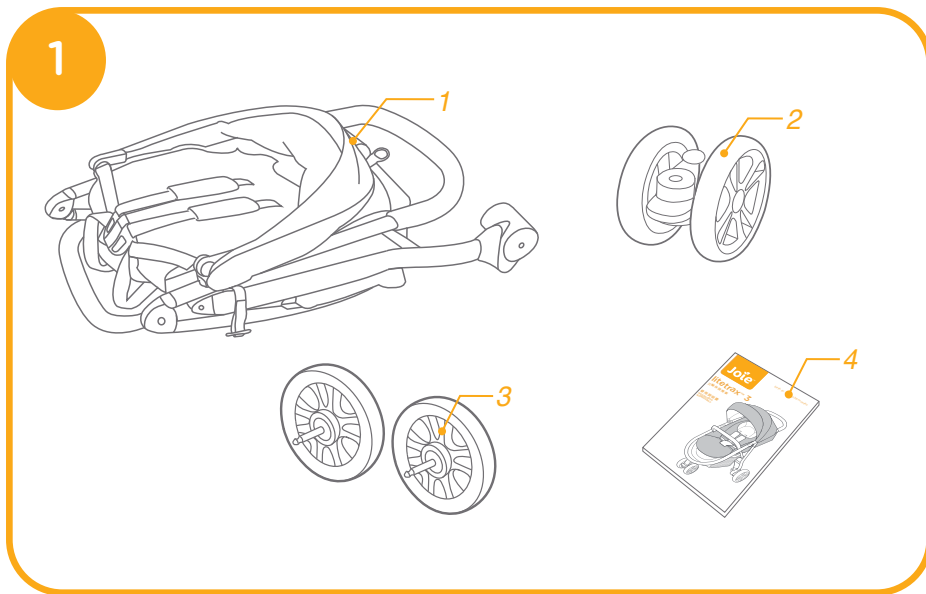

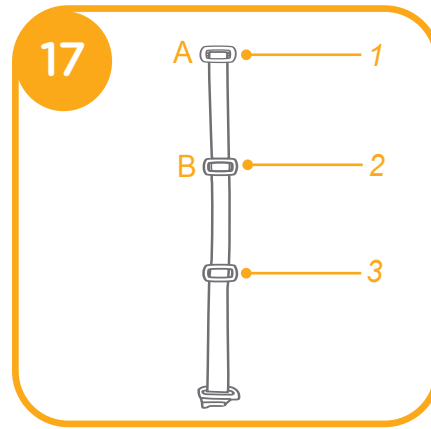
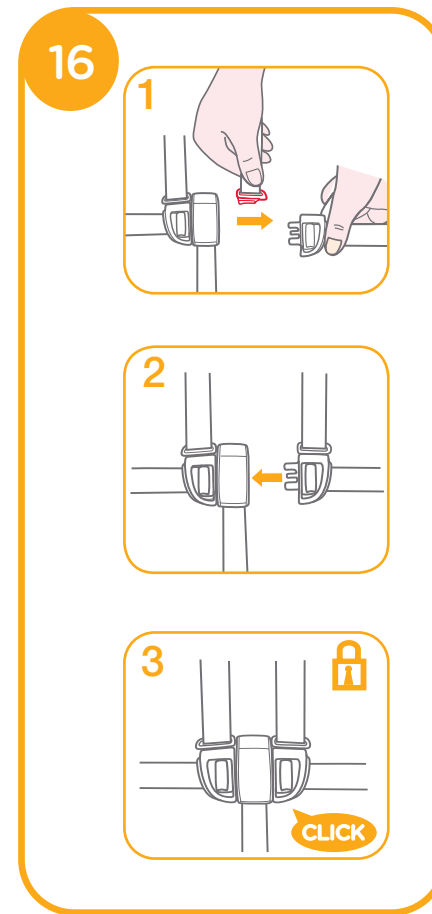
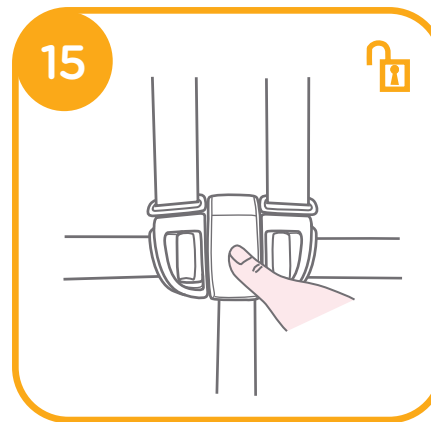
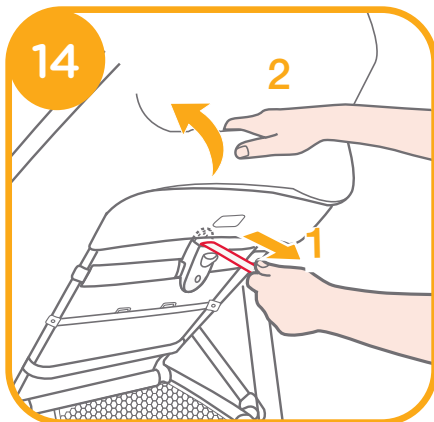
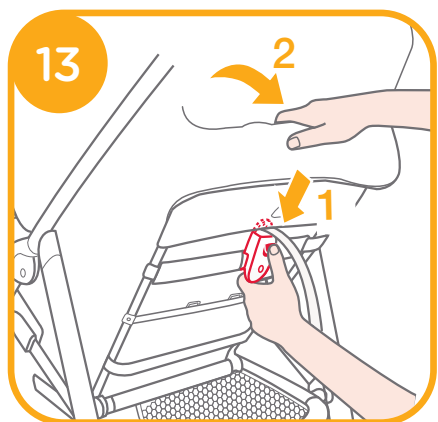
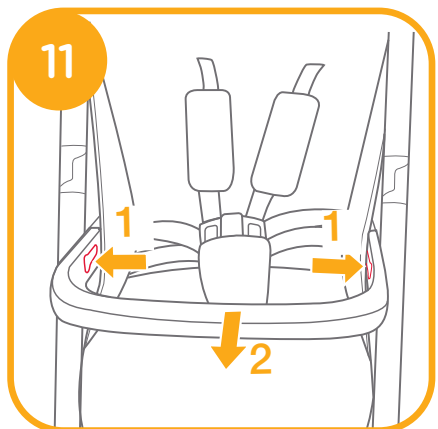
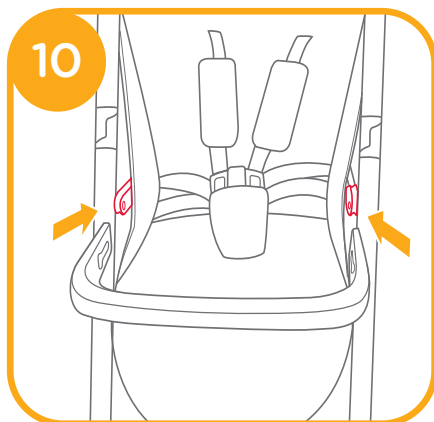
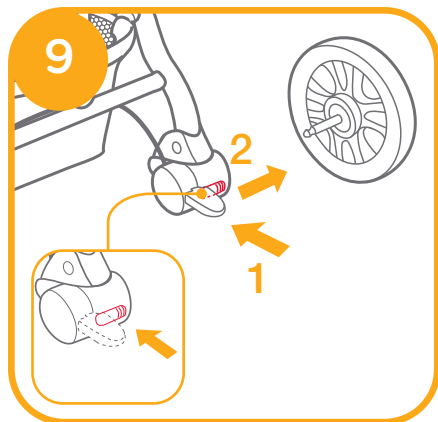

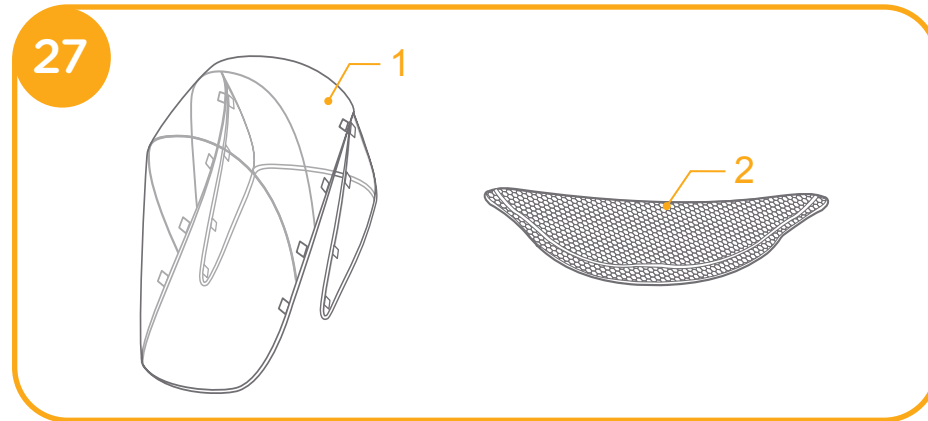
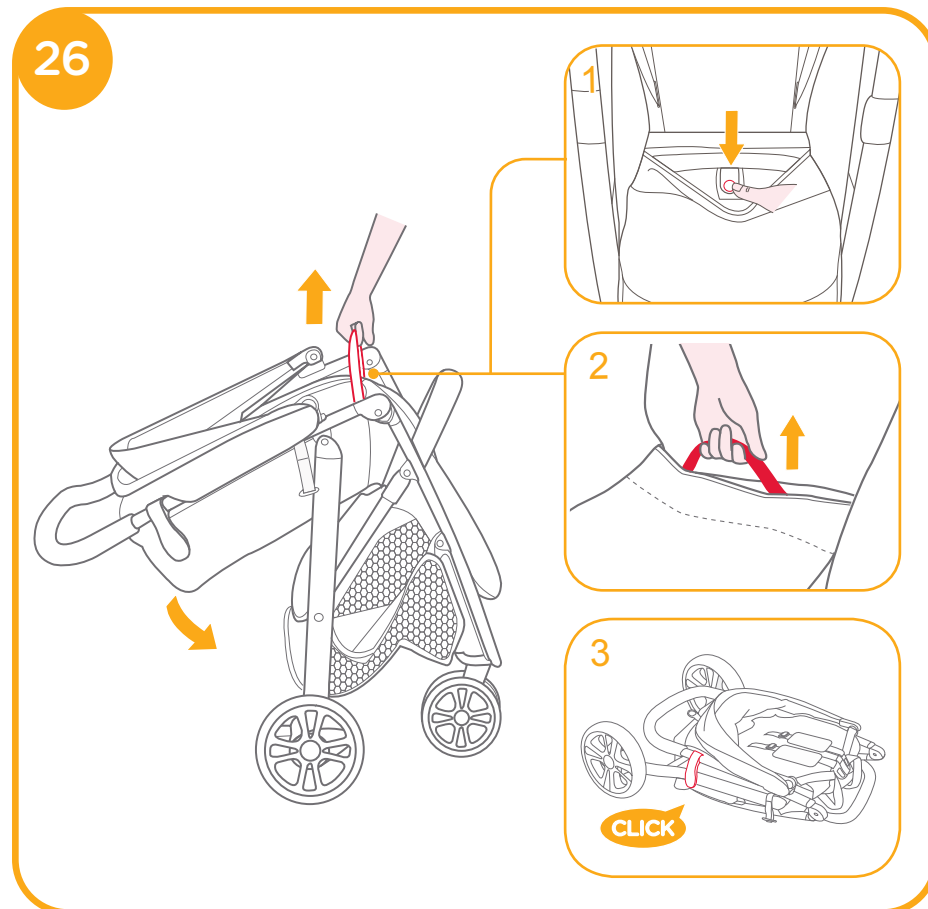
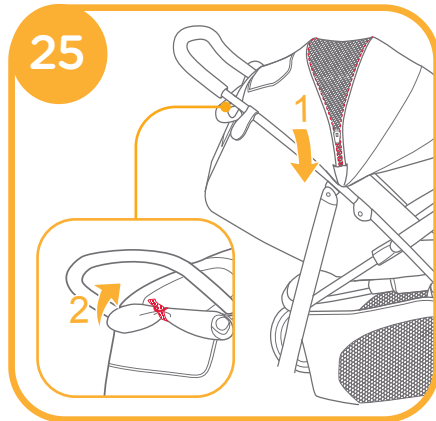
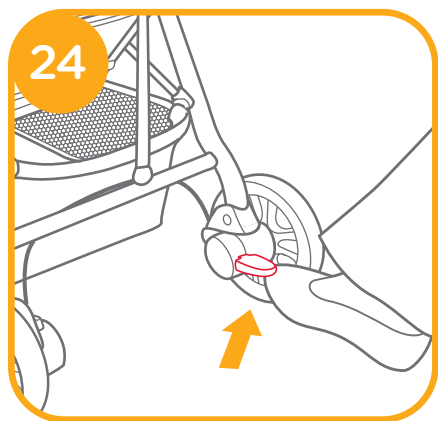
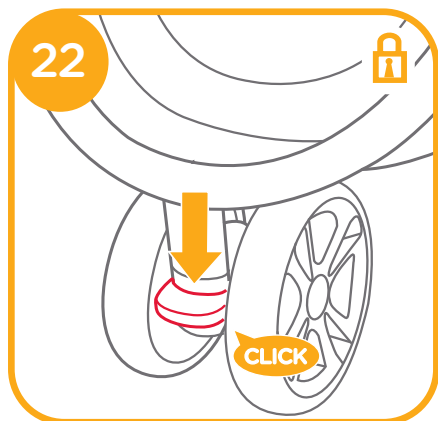
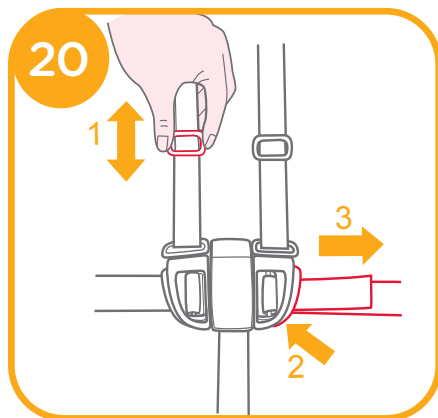

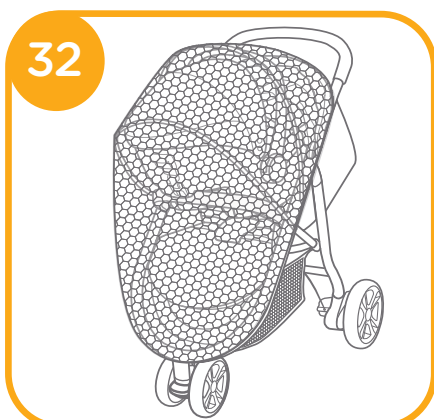
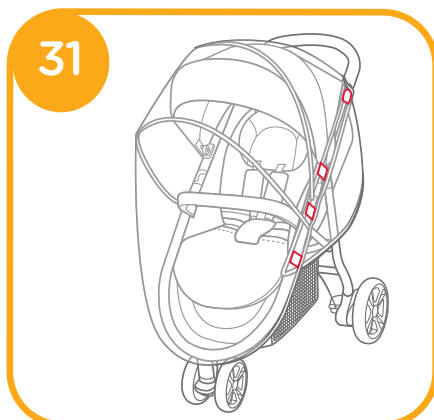
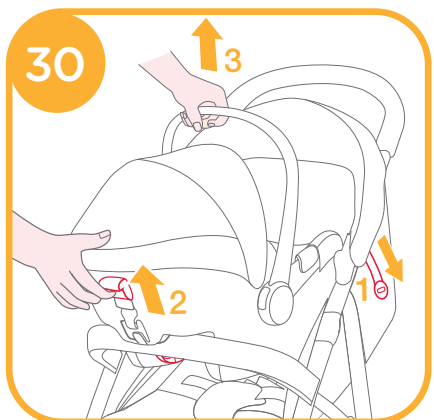
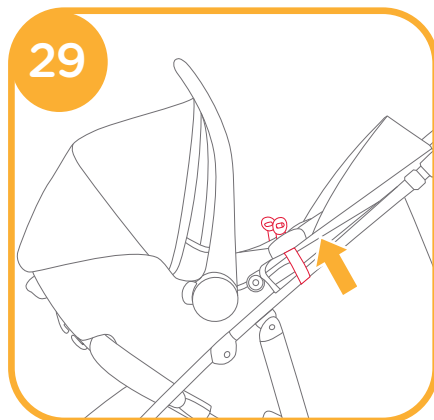
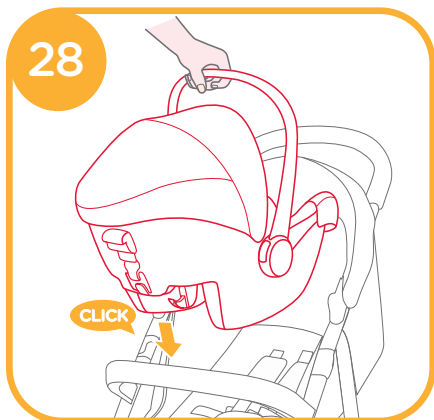

● 蚊帳為選購配件。

# Note



## 警告

- ！ 不得將寶寶單獨留置於手推車上無人看護。
- ！ 不得附載其它的寶寶、物品或附件於手推車上。
- ！ 超載或不正確的折疊及使用非經核准的零附件都可能造成手推車損壞、故障或不安全，請務必閱讀製造商之說明書。
- ！ 寶寶乘坐時，必須配用束縛系統。安全帶或束縛系統必須正確的扣合及使用。
- ！ 當調整手推車上之任何可活動配件時，必須確定寶寶與手推車保持安全距離。
- ！ 禁止於樓梯間使用手推車。
- ！ 不可讓寶寶站立或倒坐於手推車上。
- ！ 使用時應遠離火源、高溫、水池或電源之附近範圍。
- ！ 不可將手推車放置於馬路、坡道或危險場所。
- ！ 寶寶乘坐於手推車內時，不可將整個手推車往上提。
- ！ 本產品須由成人進行組裝。
- ！ 本手推車適合體重15公斤以下的寶寶使用，不符合使用條件的寶寶會對手推車造成損壞。
- ！ 寶寶乘坐時應使用腰部及胯部的安全帶，並同時使用肩帶。
- ！ 請勿擺放超過4.5公斤的物件於置物籃內，以免導致手推車不穩定而產生危險。
- ！ 使用前請仔細閱讀本說明書並請妥善保存供以後參照。如果不按照本說明書可能會影響乘坐寶寶的安全。
- ！ 使用時請扣好安全帶，以免寶寶滑入腿部開口外而造成窒息。
- ！ 使用前，請確保所有鎖定裝置都已處於鎖定狀態。
- ！ 請勿使用其它廠商提供的零部件。

- ！ 請勿將任何繩索或索帶類物件懸掛於寶寶頸部附近，或扣在產品及玩具上，以免導致意外窒息。
- ！ 請勿放置任何物品在車手、背靠後面或車台側面，以免影響手推車的穩定性。
- ！ 請勿將寶寶放到置物籃內。
- ！ 請不要讓寶寶攀爬手推車，以免翻覆。
- ！ 為避免手指夾傷問題，收合及展開手推車時，請務必小心。
- ！ 寶寶接近手推車前，請確認手推車已完全打開或收合。
- ！ 使用前請確定各部件安裝牢固以確保安全。
- ！ 保持寶寶遠離遮陽篷及雨篷以免造成窒息。
- ！ 停泊此手推車時務必確實使用所有之剎車裝置。
- ！ 當發現手推車損壞時，應立即停止使用。
- ！ 本產品不適用於跑步和滑冰，只適合以步行速度使用。
- ！ 使用本產品前，請取掉PE袋和包裝材料並銷毀，並放到嬰兒和兒童觸摸不到的地方。
- ！ 供新生兒使用時，應使用最斜躺位置。
- ！ 請勿允許您的寶寶將本產品當玩具玩耍。
- ！ 當放入和抱出寶寶時，應鎖定剎車裝置。
- ！ 當結合汽車椅使用時，請檢查汽車椅是否已正確鎖定。
- ！ 當結合汽車椅使用時，本產品不可代替睡床使用。若您的寶寶需要睡眠時，請讓寶寶睡在合適的睡床上。
- ！ 警告！六個月大以下的嬰幼兒應同時使用腰部及胯部的安全帶。
- ！ 警告！使用前應確實豎立及固定各機構以確保安全。
- ！ 警告！嬰幼兒可能會滑入足底部分的缺口或造成窒息。
- ！ 任意放置未經製造商核可之物品於車臺上將造成危害。

# 緊急情況處理

遇緊急事故時，需將安全帶剪斷，迅速將乘坐的兒童移離現場。

## 產品資訊

Allison Baby UK Ltd.

Venture Point, Towers Business Park,

Rugeley, Staffordshire, WS15 1UZ

www.joiebaby.com

**產品名稱** 時尚運動三輪推車

**產品型號** S1112D

**最大體重** 15公斤

**適用嬰幼兒年齡** 0-36個月

**主要材質** 塑膠、合金、布

**淨重** 9.52公斤

**產品尺寸** 950mmx670mmx1030mm

**製造日期** 詳見產品上貼紙日期(年/月/日)

**專利號碼** 專利申請中

**原產地** 中國

**委製商** 巧兒宜國際股份有限公司

**(進口商)**

**地址** 台北市內湖區瑞光路431號2樓

**電話** 02-27973000

**統一編號** 52603333

**代理商** 奇哥股份有限公司 Chickabiddy Co., Ltd

**地址** 台北市南京東路四段186號5樓

**服務專線** 0800-001-256 / 02-25781188

**統一編號** 04222671

**網址** www.chick.com.tw

使用本產品前請先閱讀說明書全文，如果您對於使用本產品還有任何疑問，請撥服務專線0800-001-256 / 02-25781188

## 產品組件 及各部位名稱

圖 1.1	主體	圖 2.7	置物籃
圖 1.2	前輪	圖 2.8	肩帶護片
圖 1.3	後輪	圖 2.9	頭靠
圖 1.4	說明書	圖 2.10	車手
圖 2.1	遮陽篷	圖 2.11	天窗
圖 2.2	座墊	圖 2.12	後輪
圖 2.3	扶手	圖 2.13	剎車踏板
圖 2.4	小腿靠	圖 2.14	收合栓
圖 2.5	前輪	圖 2.15	收合鉤
圖 2.6	前輪定向拉板		

組裝前請確認所有部件已經齊全，如有遺漏，請與代理商聯繫。

本產品無需工具進行組裝。

## 保養維護與保固

1. 清洗座布時，請使用30度以下水溫清洗，請勿漂白。
2. 清洗車架：僅能使用中性清潔劑及溫水洗滌，請勿使用漂白劑。
3. 隨時檢查您的手推車，並隨時更換或修理鬆弛磨損的零件、脫落的材料或車縫線。
4. 過度曝曬於陽光下，可導致手推車老化或變形。
5. 手推車潮濕時，請打開手推車及遮陽篷，待乾燥後再收合起來。
6. 如果輪子發出“吱吱”聲，可加油(WD-40，防鏽油或縫紉機油)潤滑。請將潤滑油點入輪軸及軸孔(圖3)之間，此步驟為重要的保養須知。
7. 在海邊使用手推車時，務必於使用過後清除沙粒，以做好完善的清洗。



### 延長保固服務

請於購買起一個月內至奇哥官網進行登錄，登錄成功後即享有商品延長一年保固服務。



# 產品組裝

組裝及使用手推車前，請先閱讀說明書全文，並按照說明書指示進行操作。

## 打開手推車

推開收合鉤(圖4)，然後將車手向上拉起(圖5)，聽到“咔嚓”聲表示車架已打開到位。

！使用手推車前務必確保車架已打開到位。

## 安裝前輪

將前輪套入前腳，聽到“咔嚓”聲表示前輪已安裝到位(圖6)

分開前輪釋鎖片(圖7.1)，同時向下拉前輪(圖7.2)，即可拔出前輪。

## 安裝後輪

將後輪插入後輪固定座，聽到“咔嚓”聲表示後輪已安裝到位(圖8)

按壓後輪釋鎖按鈕(圖9.1)，同時向外拉出後輪(圖9.2)，即可拔出後輪。

## 安裝扶手

安裝扶手，將扶手卡槽對准扶手固定座插入即可(圖10)

拆卸扶手，按壓扶手兩側的釋鎖按鈕(圖11.1)，同時向外拉扶手即可(圖11.2)

手推車組裝完成後如圖12所示。

# 產品操作

## 調整背靠角度

### 1. 調低背靠角度

按壓背靠調整器上的調整按鈕，同時向下旋轉背靠到合適的角度(圖13)

！如寶寶已坐在座椅內，請用另一隻手輕托背靠，以減少震盪。

！背靠完全躺平時，遮陽篷後片與背靠必須用黏扣帶黏合。

### 2. 調高背靠角度

向後拉背靠調整織帶，同時將背靠向上推即可(圖14)

！確保背靠角度調整到合適角度後，方可使用。

## 使用安全扣

### 鬆開安全扣

按下母扣中央的按鈕，鬆開安全扣(圖15)

### 扣合安全扣

將腰帶扣依次插入肩帶扣(圖16.1)和母扣內(圖16.2)，聽到“咔嚓”聲表示扣合到位(圖16.3)

！為防止寶寶摔跌，寶寶乘坐時必須繫上安全帶。

！請牢牢地繫上安全帶，並注意寶寶與安全帶之間須可以放進一個手掌的厚度。

！請勿交叉肩帶，以免對寶寶頸部造成壓迫。

## 使用肩帶和腰帶

！寶寶坐進手推車後，請確認肩帶孔高度和肩帶及腰帶的長度是否合適，以免寶寶於使用時意外跌出。

圖17.1 肩帶固定栓A

圖17.2 肩帶固定栓B

圖17.3 調整扣

較大的寶寶使用時，請使用肩帶固定栓A和最上方的肩帶孔；  
較小的寶寶使用時，請使用肩帶固定栓B和最下方的肩帶孔。  
調整肩帶固定栓位置時，將背靠後方的肩帶固定栓放置水平、短邊朝前，從肩帶孔穿出(圖18)，再從背靠前方將肩帶固定栓穿過最接近寶寶肩膀的肩帶孔(圖19)  
將調整扣上下滑動，可調節肩帶長度(圖20.1)；按壓按鈕(圖20.2)，同時往外拉安全扣內側或外側的腰帶，可調節腰帶長度(圖20.3)

## 使用肩帶護片

肩帶護片可直接從肩帶上取下，反之即可組裝。請將肩帶護片寬面朝向寶寶，避免影響寶寶的舒適性。

## 使用頭靠

打開安全扣，可將頭靠沿肩帶取下。反之則可組裝頭靠。

## 調節小腿靠支撐板

依不同使用需求，小腿靠共有2個段位可供調節。  
段位調高時，將小腿靠支撐板由下往上推即可。  
段位調低時，按壓小腿靠兩側的調整按鈕(圖21.1)，同時向下調節小腿靠支撐板(圖21.2)

## 前輪定向

鎖定時，按下拉板(圖22)，即可固定車輪前行方向。  
釋鎖時，向上提起拉板，車輪可自由轉向，改變推行方向更容易。  
**使用小秘訣** 當在碎石路面或不平路面推行時，建議鎖定前輪，便能更輕鬆地操控手推車。

## 使用剎車踏板

準備剎車時，踩下剎車踏板(圖23)，即可完成剎車動作。  
打開剎車時，向上提起剎車踏板(圖24)，即可完成釋鎖動作。

**使用小秘訣** 手推車停止前進時，請鎖定剎車踏板。

## 使用遮陽篷

打開或者收攏遮陽篷，將遮陽篷往前拉或往後翻即可。  
防止寶寶被陽光直射，可以完全打開遮陽篷，拉開拉鏈(圖25-1)，將遮陽篷往前拉即可。  
可從遮陽篷上的窗戶確認寶寶狀態  
將遮陽篷後片往上捲起並用黏扣帶固定住即可看到寶寶(圖25-2)  
！遮陽篷後片口袋不可置物超過0.5kg。

## 收合手推車

收合手推車前，請先收攏遮陽篷。  
按壓釋鎖按鈕(圖26.1)再向上提起收合織帶(圖26.2)，車架向後自動折疊(圖26)  
收合鉤自動扣合收合栓，手推車收合完成後如圖26.3所示。

## 使用配件

圖27.1 雨篷 圖27.2 蚊帳

蚊帳為選購配件。  
因產品型號的不同，並非所有手推車均附以上配件。

## 使用汽車椅

因產品型號的不同規格會有所不同，並非所有手推車均可以卡合Joie汽車椅gemm。  
將汽車椅置於手推車內，以使汽車椅卡鉤卡到扶手邊緣，汽車椅將自動扣合到位(圖28)

## Note

！ 使用汽車椅前，請確保靠背已調至最低位置，並且汽車椅已確實固定。

！ 用手推車兩側的固定織帶固定汽車椅(圖29)

！ 請勿收合已安裝汽車椅的手推車。

移除汽車椅時，先從汽車椅上取下固定織帶，按壓汽車椅釋鎖把手，同時從手推車內提出汽車椅即可(圖30)

！ 關於使用汽車椅有任何問題，請參考汽車椅說明書。

## 使用雨篷

將雨篷套到車架上，再黏合雨篷側面的黏扣帶(圖31)

！ 使用雨篷時，請確認汽車椅已正確固定和推車背靠已調至最低檔。

！ 使用雨篷時，請隨時注意並確認雨篷內有良好的通風。

！ 不使用雨篷時，請先確認雨篷已清潔並乾燥，再收納。

！ 請勿收合已罩上雨篷的手推車。

！ 天氣炎熱時，請勿將幼童放在裝有雨篷的手推車內。

## 使用蚊帳

將蚊帳套在車架上，並依以下步驟固定蚊帳(圖32):

1. 將蚊帳一端通過鬆緊帶套在腳踏板下方。

2. 將蚊帳另一端通過鬆緊帶套在遮陽篷後片上。

！ 蚊帳可配合下列兩種情況使用

手推車單獨使用

手推車配合汽車椅使用

！ 手推車配合汽車椅使用時，背靠必須在最低位置。

Joie™

birth to 15kg/0-36 months

# litetrax™ 3

stroller

## Instruction Manual

Please read all the instructions in this manual before installing and using the product.

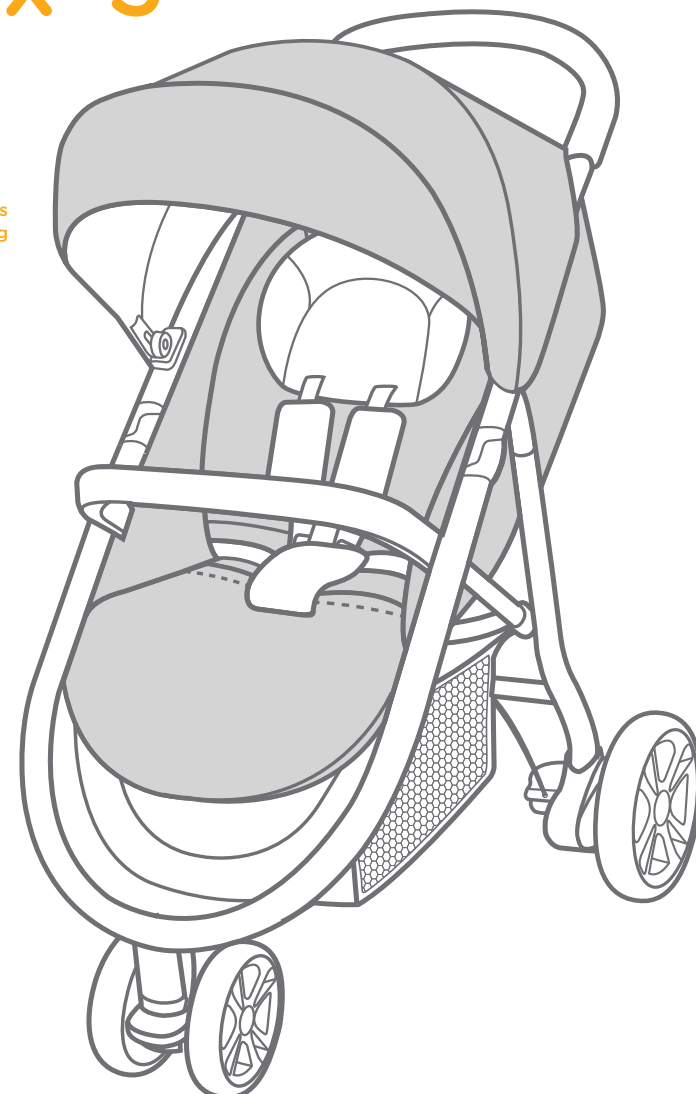

**IMPORTANT - READ CAREFULLY AND KEEP FOR FUTURE REFERENCE.**

# Thank you for purchasing Joie Stroller

This product is a high-quality and fully functional stroller, approved to Taiwan safety standards CNS 12940:2013 and European safety standards EN 1888-1:2018+A1:2022. It is suitable for a child weighing under 15kg (0-36 months).

Read these instructions carefully before use and keep them for future reference. Your child's safety may be affected if you do not follow these instructions.

The figures in this manual are to illustrate the operating methods and product main features. This model may have differences between features shown. The figures are just for reference.

## Stroller Features

Quick Fold  
Adjustable Backrest  
Fully Reclined Seat  
Adjustable Calf Support  
Extra Big Storage Basket  
Extra Soft Harnesses  
Lockable Front Swivel Wheels  
Back Brake Wheels  
Ventilative Seat Pad  
Full Coverage Canopy  
5-point Safety Buckle

## Contents

### Reference Figures

1 - 7

### English

WARNINGS	23
Emergency	25
Product Information	25
Parts List	26
Care and Maintenance	26
Stroller Assembly	27
Open Stroller	27
Assemble Front Wheel	27
Assemble Rear Wheels	27
Assemble Armbar	27
Stroller Operation	28
Adjust Backrest	28
Use Buckle	28
Use Shoulder & Waist Harnesses	28
Use Shoulder Harness Cover	29
Use Head Support	29
Adjust Calf Support	29
Use Front Swivel Lock	29
Use Brake	30
Use Canopy	30
Fold Stroller	30
Use Accessories	30

# WARNINGS

- ! Never leave the child unattended.
- ! Use the stroller with only one child at a time. Never place purses, shopping bags, parcels or accessory items on the handle or canopy.
- ! Overload, fold incorrectly or use it along with component parts from other manufacturers may cause the stroller to be damaged, broken or unsafe.
- ! Always use the restraint system. Safety belts and restraint system must be used correctly.
- ! Make sure your child's body is clear from the moving parts when adjusting the stroller.
- ! Never use stroller on stairs or escalators.
- ! Never allow your child to stand on the stroller or sit in the stroller with head toward front of stroller.
- ! Keep away from fire source, high temperature objects, liquids, and electronics.
- ! Never place the stroller on roads, slopes or dangerous area.
- ! Do not lift stroller whilst child is in it.
- ! Adult assembly required.
- ! Use of the stroller with a child weighing less than 15kg. It will cause damage to the stroller with an unfitted child.
- ! Always use the crotch combination with the waist belt. It is suggested that the shoulder harnesses be used as well.
- ! To prevent a hazardous, unstable condition, do not place more than 4.5kg in the storage basket.
- ! Please read all the instructions in this manual before using the product. Please save instruction manual for future use. Failure to follow these warnings and instructions may result in serious injury or death.
- ! Child may slip into leg openings and be strangled if the harness is not used.
- ! Ensure that all the locking devices are engaged before use.

- ! Accessories which are not approved by the manufacturer shall not be used. Only replacement parts supplied or recommended by the manufacturer shall be used.
- ! Avoid strangulation, do not place items with a string around your child's neck, suspend strings from this product, or attach strings to toys.
- ! Any load attached to the handle or on the back of the backrest or on the sides of the stroller will affect the stability of the stroller.
- ! Do not use storage basket as a child carrier.
- ! To prevent tipping, never let child climb the stroller.
- ! To avoid injury, ensure that the child is kept away when unfolding and folding this product.
- ! Be sure the stroller is fully open or folded before allowing child near the stroller.
- ! To ensure your child's safety, please make sure all parts are assembled and fastened properly before using the stroller.
- ! Avoid strangulation, do make sure your child is clear from the canopy.
- ! Always engage the brakes when parking the stroller.
- ! Discontinue using your stroller if it is damaged or broken.
- ! This product is not suitable for running or skating. It is intended to be used only at walking speed.
- ! To avoid suffocation, remove plastic bag and packaging materials before using this product. The plastic bag and packaging materials should then be destroyed or kept away from babies and children.
- ! It is recommended the use of the most reclined position for new born baby.
- ! Do not let the child play with this product.
- ! The parking device should be engaged when placing and removing your child.
- ! Check that the infant child restraint attachment devices are correctly engaged before use.
- ! For infant child restraints used in conjunction with a chassis, this vehicle does not replace a cot or a bed. Should your child need to sleep, then it should be placed in a suitable pram body, cot or bed.



# Emergency

In case of emergency or accidents, it is most important to have your child taken care of with first aid and medical treatment immediately.

## Product Information

### Allison Baby UK Ltd.

Venture Point, Towers Business Park,  
Rugeley, Staffordshire, WS15 1UZ  
www.joiebaby.com

<b>Product</b>	Litetrax 3 Stroller
<b>Model</b>	S1112D
<b>Suitable for</b>	Child weighing under 15kg (birth - 36 months)
<b>Materials</b>	Plastics, metal, fabrics
<b>Net Weight</b>	9.52kg
<b>Product Size</b>	950mmx670mmx1030mm
<b>Date</b>	Please see detailed date on label (year / month / day)
<b>Patent No.</b>	Patents pending
<b>Made in</b>	China

<b>Distributor</b>	Chickabiddy Co., Ltd
<b>Address</b>	5th FL, 186, Nanking E. Rd, Sec. 4, Taipei, Taiwan 10595
<b>Tel.</b>	0800-001-256 / 02-25781188
<b>Website</b>	www.chick.com.tw

Read all the instructions in this manual before using this product. If you have any further questions, please call 0800-001-256 / 02-25781188 directly.

## Parts List

<b>Fig. 1.1</b>	Stroller Frame	<b>Fig. 2.7</b>	Storage Basket
<b>Fig. 1.2</b>	Front Wheel	<b>Fig. 2.8</b>	Shoulder Harness
<b>Fig. 1.3</b>	Rear Wheels	<b>Fig. 2.9</b>	Head Support
<b>Fig. 1.4</b>	Instruction Manual	<b>Fig. 2.10</b>	Handle
<b>Fig. 2.1</b>	Canopy	<b>Fig. 2.11</b>	Window
<b>Fig. 2.2</b>	Seat Pad	<b>Fig. 2.12</b>	Rear Wheel
<b>Fig. 2.3</b>	Armbar	<b>Fig. 2.13</b>	Brake Lever
<b>Fig. 2.4</b>	Calf Support	<b>Fig. 2.14</b>	Storage Mount
<b>Fig. 2.5</b>	Front Wheel	<b>Fig. 2.15</b>	Storage Latch
<b>Fig. 2.6</b>	Swivel Lock		

Make sure all parts are available before assembly. If any part is missing, please contact local distributor.

No tools are required for assembly.

## Care and Maintenance

1. Removable seat pad may be washed in cold water and drip-dried. No bleach.
2. To clean stroller frame, use only household soap and warm water. No bleach or detergent.
3. From time to time, check your stroller for loose screws, worn parts, torn material or stitching. Replace or repair the parts as needed.
4. Excessive exposure to sun or heat could cause fading or warping of parts.
5. If stroller becomes wet, open canopy and allow to dry thoroughly before storing.
6. If wheels squeak, use a light oil (e.g., WD-40, antirust oil, or sewing machine oil). It is important to get the oil into the axle and wheel assembly. (Fig. 3)
7. When using your stroller at the beach, completely clean your stroller afterward to remove sand and salt from mechanisms and wheel assemblies.

# Stroller Assembly

Please read all the instructions in this manual before assembling and using this product.

## Open Stroller

Separate storage latch from storage mount (Fig. 4), and then lift the handle upwards (Fig. 5), a click sound means the stroller is open completely.

! Check that the stroller is completely open before continuing.

## Assemble Front Wheel

Assemble front wheel to front leg. Check that the front wheel is securely attached by pulling on wheel assembly. (Fig. 6)

To disassemble front wheel, detach front wheel from front leg (Fig. 7.2) while pressing the release tabs outwards. (Fig. 7.1)

## Assemble Rear Wheels

Align the axle of the rear wheel with the rear wheel mount, and then insert to assemble the rear wheel (Fig. 8). Check that wheels are securely attached by pulling on wheel assemblies.

To disassemble rear wheel, detach rear wheel from rear wheel mount (Fig. 9.2) while pressing the release button. (Fig. 9.1)

## Assemble Armbar

Align the armbar end slider with matching fixing slot, and then insert to lock. (Fig. 10)

To disassemble armbar, press armbar release button (Fig. 11.1), and then pull up the armbar. (Fig. 11.2)

The completely assembled stroller is shown as Fig. 12

# Stroller Operation

## Adjust Backrest

### Recline Backrest

Pull the backrest backwards, while pressing the button in the center of the angle adjuster. (Fig. 13)

! The canopy must be fixed by hook and loop fastener on the backrest when the backrest is in flat position.

### Raise Backrest

Push the backrest forwards, while pulling the webbing at the end of the angle adjuster. (Fig. 14.1)

! Make sure the recline is set properly for use.

## Use Buckle

### Release Buckle

Press the center button to release the buckle. (Fig. 15)

### Lock Buckle

Match the waist belt buckle with the shoulder buckle (Fig. 16.1), and click into the center buckle. (Fig. 16.2) A “click” sound means the buckle is locked completely. (Fig. 16.3)

! To avoid serious injury from falling or sliding out, always secure your child with harness.

! Make sure your child is snugly secured. The space between the child and the shoulder harness is about the thickness of one hand.

! Do not cross the shoulder belts. This will cause pressure on child's neck.

## Use Shoulder & Waist Harnesses

! In order to protect your child from falling out, after your child is placed into the seat, check whether the shoulder and waist harnesses are at proper height and length.

Fig. 17.1 Shoulder harness anchor A

Fig. 17.2 Shoulder harness anchor B

Fig. 17.3 Slide adjuster

For larger child, use shoulder harness anchor A and the highest shoulder slots. For smaller child, use shoulder harness anchor B and the lowest shoulder slots.

To adjust the position of the shoulder harness anchor, turn the anchor to be level with the side facing forward. Thread it through the shoulder harness slot from back to front. (Fig. 18) Rethread it through the slot that is closest to child's shoulder height. (Fig. 19)

Use slide adjuster to change the harness length. (Fig. 20.1)

Press the button (Fig. 20.2), while pulling the waist harness to proper length. (Fig. 20.3)

## Use Shoulder Harness Cover

The shoulder harness cover can be removed from the webbing.

To assemble shoulder harness cover in reverse steps.

## Use Head Support

The head support can be removed from the webbing. To assemble head support in reverse steps.

## Adjust Calf Support

The calf support has 2 positions.

Raise Calf Support

To raise the calf support, just push it upwards. A "click" sound means the calf support is locked completely.

Lower Calf Support

Press the adjustment buttons on both sides of the calf support (Fig. 21.1), and rotate the calf support downwards. (Fig. 21.2)

## Use Front Swivel Lock

Push down the front swivel locks to maintain the moving direction. (Fig. 22)

**Tip** It is recommended to use swivel locks on uneven surfaces.

## Use Brake

To lock wheels, step the brake lever downwards. (Fig. 23)

To release wheels, just lift the brake lever upwards. (Fig. 24)

**Tip** Always apply brake when stroller is in stopped position.

## Use Canopy

The canopy can be opened or folded, pull it toward front or back.

The canopy can be opened completely to protect your child from the sun uttermostly, just unzip the canopy (Fig. 25-1), and then pull the canopy toward front.

Roll up the backward panel and stick the hook and loop fastener, then you can view your baby. (Fig. 25-2)

! Total Maximum Weight of hood storage pocket MUST not exceed 0.5 kg.

## Fold Stroller

! Please fold the canopy before folding the stroller.

Press releasing button. (Fig. 26.1) Pull the folding webbing upward (Fig. 26.2), the frame will automatically fold backward. (Fig. 26)

The storage latch will automatically hook onto the storage mount, then the stroller is folded and locked completely. (Fig. 26.3)

## Use Accessories

Fig. 27.1 Rain Cover      Fig. 27.2 Mosquito Net

The mosquito net is optional accessories.

Not all accessories are included on some models.

## Use with Joie Infant Child Restraint

Not all accessories are included on some models. Not all the strollers can be attached Joie Infant Child Restraint Gemm.

Place infant child restraint into stroller so notches in rockers fit over edge of armbar. The infant child restraint will then automatically click into place. (Fig. 28)

## Note

- ! Before using the infant child restraint, please make sure the backrest has been adjusted to the lowest position and the infant child restraint has been fastened.
  - ! Use the straps on both sides of stroller to fix the child restraint. (Fig. 29)
  - ! Please don't fold stroller when attaching the infant child restraint.
- To remove the infant child restraint, release the straps from the infant child restraint, pull up the stroller release handle to release the infant child restraint from armbar, and then lift infant child restraint out of stroller. Please refer to (Fig. 30)
- ! If you have any problems about using the infant child restraint, please refer to their own instruction manuals.

## Use Rain Cover

- To assemble the rain cover, place it over the stroller, and then attach the hook and loop fasteners on the rain cover. (Fig. 31)
- ! Before using the rain cover, please make sure the backrest has been adjusted to the lowest position and the infant child restraints has been fastened.
  - ! When using the rain cover, please always check its ventilation.
  - ! When not in use, please check that the rain cover has been cleaned and dried before folding.
  - ! Do not fold the stroller after assembling the rain cover.
  - ! Do not place your child into the stroller assembled with rain cover during hot weather.

## Use Mosquito Net

Cover the mosquito net on the frame, and fixed it per following steps. (Fig. 32)

1. Cover the one end of the mosquito net on the bottom of footrest by elastic band.
  2. Cover the other end of the mosquito net on the canopy rear panel by elastic band.
- ! Use the mosquito net on following two status:
    - Use the stroller only.
    - Use the stroller with infant child restraint.
  - ! The recline must be on the lowest position when using the stroller with the infant child restraint.



bring the kids™

Share the joy at [joiebaby.com](http://joiebaby.com)

JK096\_S1112\$G