

Joie™

Instruction Manual

carry cot with stand

Weight: birth up to 20 lb. (9 kg)

Height: 27 in. (68 cm) or less

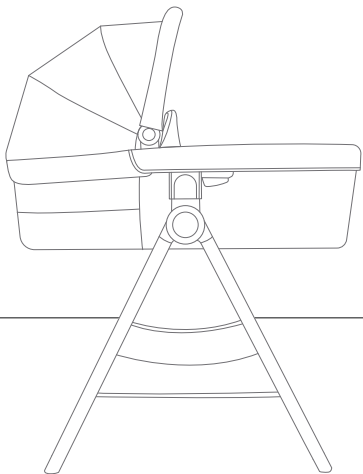

IMPORTANT!

Read all instructions before assembling and using the carry cot. Keep instructions for future use.

Contents:

- 3 Warranty Information
- 4 Warnings
- 10 Parts List
- 12 Unfolding & Folding Carry Cot
- 12 Using Canopy
- 14 Using Mattress
- 14 Using Carry Cot Accessory Pocket
- 14 Using Carry Cot Cover
- 16 Using Stand
- 20 Using Carry Cot on a Joie Stroller
- 24 Folding Stroller with Carry Cot Adapters Attached
- 24 Carry Cot Positioning
- 26 Care & Maintenance

Child Usage Requirements

This carry cot is suitable for use with children who meet the following requirements:

Weight: birth up to 20 lb. (9 kg)

Height: 27 in. (68 cm) or less

Warranty Information:

Product Registration

Please fill in the information below. The model number and the date of manufacture are located on a label on the carry cot and stand. Fill out the prepaid registration postcard attached to the product and mail it today. To register your product online, please visit: <https://joiebaby.com/us/register-gear>.

Model Name: _____

Model Number: _____

Date of Manufacture: _____

Date of Purchase: _____

register your
product online



Limited Warranty

We have purposely designed our high-quality products so that they can grow with both your child and your family. Because we stand by our product, our gear is covered by a custom limited warranty per product, starting from the day it was purchased. Please have the proof of purchase, model number, and date of manufacture available when you contact us. For warranty information, please visit: www.joiebaby.com/us.

Contact

Joie Baby USA Consumer Service Contact Info.

Address: 70 Thousand Oaks Blvd., Morgantown, PA 19543

Email: info.us@joiebaby.com

Phone: 1-866-798-7866

⚠️ WARNING

Failure to follow these warnings and the instructions could result in serious injury or death.

SUFFOCATION HAZARD

Babies have suffocated:

- On pillows, comforters, and extra padding.
- In gaps between product sides and a wrong-size mattress or extra padding.

⚠️ WARNING

- **NEVER** add pillows, soft bedding, comforters, padding, or an extra mattress.
- Use **ONLY** the mattress provided with this product.
- **ALWAYS** place baby on their back to sleep to reduce the risk of SIDS and suffocation.
- Use **ONLY** the mattress cover included with this product. **DO NOT** use a sheet with the mattress pad.
- **NEVER** use the carry cot without the mattress in place.
- **SUFFOCATION HAZARD:** Carry cot can roll over on soft surfaces and suffocate child. **NEVER** place carry cot on beds, sofas, or other soft surfaces.

⚠️ WARNING

Failure to follow these warnings and the instructions could result in serious injury or death.

FALL HAZARD: To help prevent falls,

- **DO NOT** use this carry cot when the infant begins to push up on hands and knees or has reached 20 lb. (9 kg), whichever comes first.
- **ALWAYS** check that the carry cot is securely locked onto the stroller/stand by pulling up on it.
- Child's movement can slide carry cot. **NEVER** place the carry cot on counter tops, tables, or any other elevated surface.
- **ONLY** use the carry cot on a Joie stroller/stand.
- **DO NOT** use the carry cot on the floor/ground.
- The carry cot can fall from a shopping cart. **DO NOT** use on a shopping cart.
- **STRANGULATION HAZARD:** Strings can cause strangulation! **DO NOT** place items with a string around your child's neck, such as hood strings or pacifier cords. **DO NOT** suspend strings over the carry cot or attach strings to toys.



⚠️ WARNING

Failure to follow these warnings and the instructions could result in serious injury or death.

- **DO NOT** place this carry cot near a window or patio door where a child could reach the cord of a blind or curtain and be strangled.
- **DO NOT** substitute parts. Contact Joie if replacement parts or additional instructions are needed at 1-866-798-7866 or info.us@joiebaby.com.
- The carry cot must be fully assembled and installed before using.
- **Child can become entrapped and die** when improvised netting or covers are placed on top of the carry cot. **NEVER** add such items to confine the child in the carry cot.
- **DO NOT** place any item on the canopy of this product.
- **NEVER** leave a child in the carry cot when ascending or descending stairs or escalators.
- **NEVER** carry more than one child at a time in this product.

WARNING

Failure to follow these warnings and the instructions could result in serious injury or death.

- **NEVER** use this carry cot as a means to transport an infant in a motor vehicle.
- **DO NOT USE** if any part of the carry cot or stand is broken, torn, or missing.
- **ALWAYS** place child in the carry cot with their head at the canopy end. The head of the child in the carry cot should **NEVER** be lower than the body.
- **MAKE SURE** the stand and carry cot are fully erected and latches are locked before use.
- **ONLY** use this carry cot on this stand. **DO NOT** attempt to attach any other items to this stand.
- **ONLY** use the stand on firm ground that is horizontal, level, and dry.
- **Be certain** the stand is fully open before placing the carry cot on the stand. Fold the stand and store it away when not in use.
- **DO NOT** place an infant car seat on the carry cot stand.
- **DO NOT** allow an infant to sleep in the carry cot while it is attached to a stroller. Should your child need to sleep, they should be placed in a crib or sleeping area based on their requirements.

WARNING

Failure to follow these warnings and the instructions could result in serious injury or death.

- **AVOID FINGER ENTRAPMENT.** Use care when folding and unfolding the stand.
- **DO NOT** allow child to crawl, sit, or play in the storage basket or product.
- A child's safety is your responsibility. **ALWAYS** provide the supervision necessary for the continued safety of your child. **NEVER** leave your child unattended.
- **To prevent a hazardous or unstable condition, DO NOT** place more than 1 lb. (0.5 kg) in the carry cot accessory pocket or more than 10 lb. (4.5 kg) in the carry cot stand storage basket.
- **To avoid any danger of suffocation,** remove all plastic covers before using this product and destroy or keep away from babies and children.
- **Keep small parts** away from children as they pose a choking hazard.
- **DO NOT** make any changes or modifications to this product that are not specified in this manual.

Parts List:

Please make sure there are no missing parts. Please contact Joie Consumer Service if anything is missing.

- 1 Carry Handle
- 2 Canopy Window Cover
- 3 Canopy Folding Button (x2)
- 4 Carry Cot Cover
- 5 Carry Cot
- 6 Mattress
- 7 Carry Cot Accessory Pocket (1 lb. (0.5 kg) maximum)
- 8 Canopy
- 9 Additional Ventilation Cover
- 10 Carry Cot Release Button (x2)
- 11 Stand Mount (x2)
- 12 Stand Storage Basket (10 lb. (4.5 kg) maximum)
- 13 Stand Folding Button (x2)
- 14 Carry Cot Stroller Adapter
- 15 Carry Cot Stroller Adapter Folding Strap

Parts List:

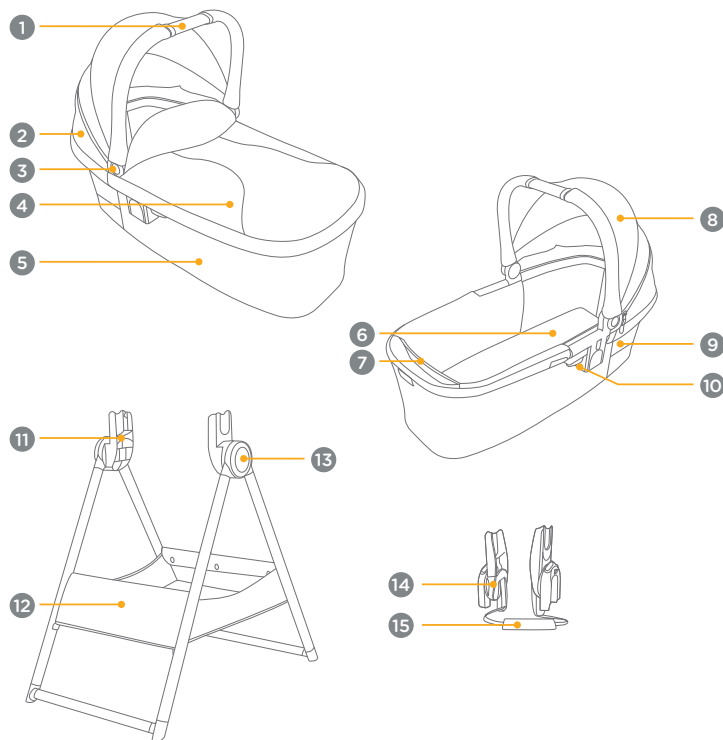

Unfolding & Folding Carry Cot:

1 - The carry cot is packaged flat.

2 - Unfolding the Carry Cot:

Look under the fabric, near the mattress area. Stand up the support bar and click it into the tab at the bottom of the carry cot. Repeat on the opposite end of the carry cot.

3 - Folding the Carry Cot:

Remove the mattress and lift the inner fabric. Push towards the back of the tab (A) at the bottom of the carry cot. Rotate the support bar out and up (B). Repeat on the opposite end of the carry cot. The carry cot may now be folded flat.

Using Canopy:

Opening and Closing the Canopy:

4 - Press and hold both canopy folding buttons (C). Pull or push the canopy to the desired position. (D)

IMPORTANT: When open, ensure that the canopy is in one of the three locked positions. A “clicking” sound will confirm that the canopy is in a locked position. The canopy **MUST** be in the upright position (E) when using the carry handle.

5 - For extended canopy coverage, unzip the canopy zipper (F). Press and hold both canopy folding buttons (G) while pulling the canopy fully forward (H).

Ventilation:

6 - For ventilation, fold the canopy window cover up to reveal the canopy window (I). For extra ventilation, unzip the additional ventilation cover (J) and fold it down (K).

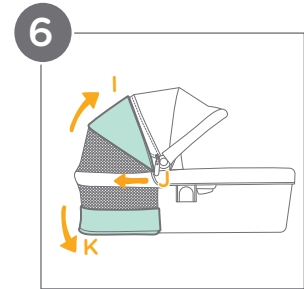
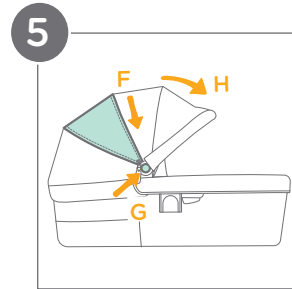
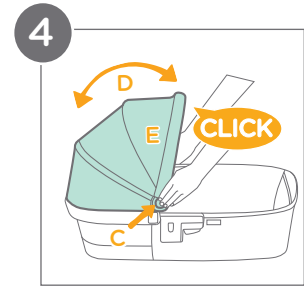
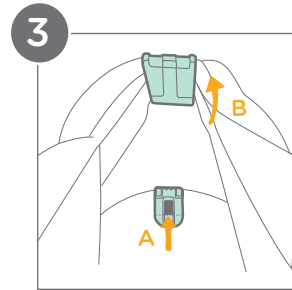
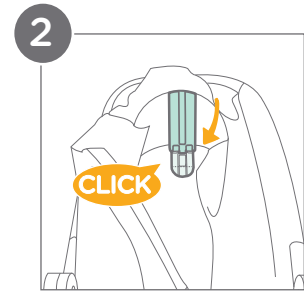
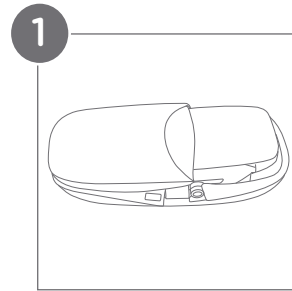

Using Mattress:

- 1 - Insert the mattress into the carry cot so that the open seam of the mattress cover is on the bottom.

The mattress should be completely flat against the bottom of the carry cot.
- 2 - To wash the mattress cover, take the mattress out of the cover. **ONLY** machine wash and air dry the mattress cover. **ONLY** spot clean the mattress with a sponge and soapy water.

IMPORTANT: To avoid serious injury, ALWAYS use the mattress when using the carry cot.

Using Carry Cot Accessory Pocket:

- 3 - An accessory pocket is located on the inside of the carry cot. It can hold up to 1 lb. (0.5 kg).

Using Carry Cot Cover:

- 4 - Put the carry cot cover over the foot of the carry cot. Attach the hook and loop fasteners on the front and sides of the carry cot, as well as attaching the flaps to the canopy.

 Using the carry cot cover in winter gives baby a warmer and more comfortable environment.

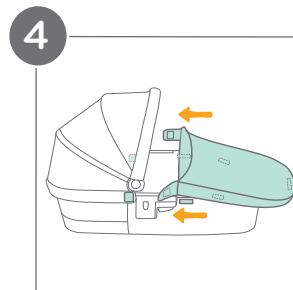
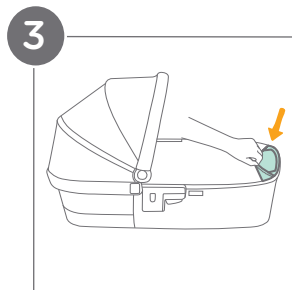
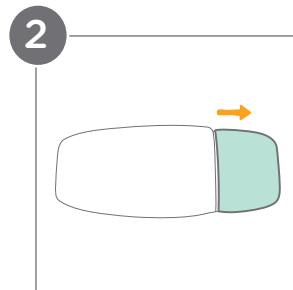
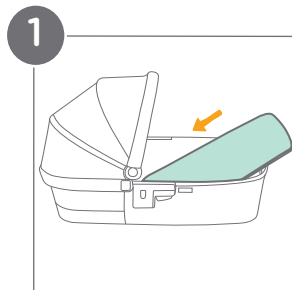

Using Stand:

Opening the Stand:

- 1 - To open the stand, pull the leg tubes away from each other.
- 2 - A “clicking” sound will confirm that the stand is fully open.

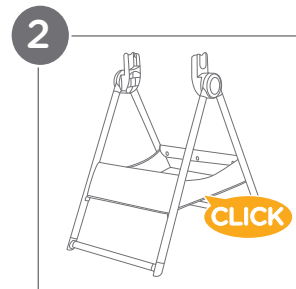
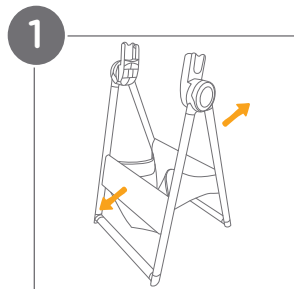

Attaching and Removing the Carry Cot:

- 3 - To attach the carry cot, align the sides of the carry cot with the stand mounts. Place the carry cot directly down.
- 4 - A “clicking” sound will confirm that the carry cot is properly attached.
- 5 - To remove the carry cot, squeeze the carry cot release buttons (A) and lift up (B).

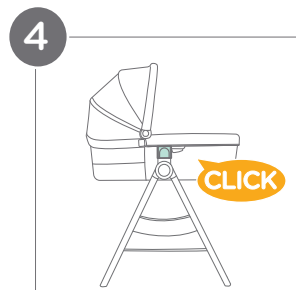
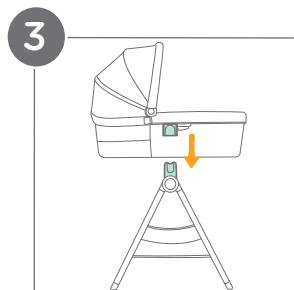

IMPORTANT: Fall Hazard: ALWAYS check that the carry cot is securely attached to the stand by pulling up on the carry cot.

(Using Stand continued on pg. 18)

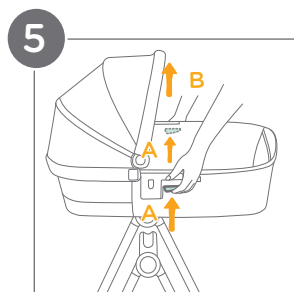

Using Stand: (cont.)

Folding the Stand:

- 1 - To fold the stand, press both stand folding buttons.
- 2 - Push the leg tubes towards each other.

IMPORTANT: Remove the carry cot before folding the stand.

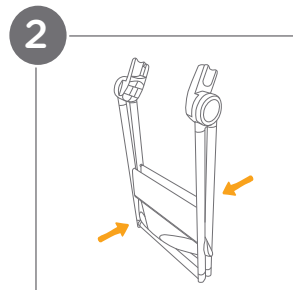
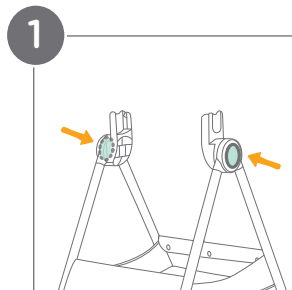

Using Carry Cot on a Joie Stroller:

1 - Choosing the Correct Adapter:

Check the seat mounts on your stroller frame and match the style of your mounts to the correct adapter.

Style A: Use the adapters included with the carry cot.

Style B: Use the adapters included with your stroller.

2 - Attaching the Adapters:

Slide the adapters into the seat mounts. A “clicking” sound will confirm that the adapters are properly locked in place.

3 - Attaching the Carry Cot to the Adapters:

Place the carry cot onto the adapters.

The carry cot may be attached in either the rear-facing or forward-facing position.

A “clicking” sound will confirm that the carry cot is properly locked in place.

IMPORTANT: Safety Check: Always pull up on the adapters and carry cot after attachment to ensure they are securely fastened.

If your stroller uses multiple seating heights, **ONLY** use the carry cot at the lowest seat height.

(Using Carry Cot on a Joie Stroller continued on pg. 22)

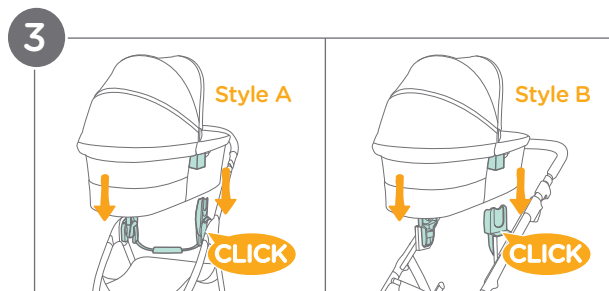
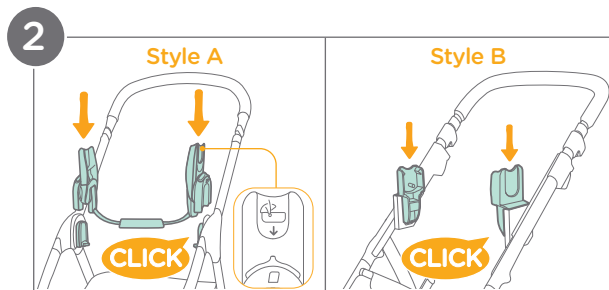
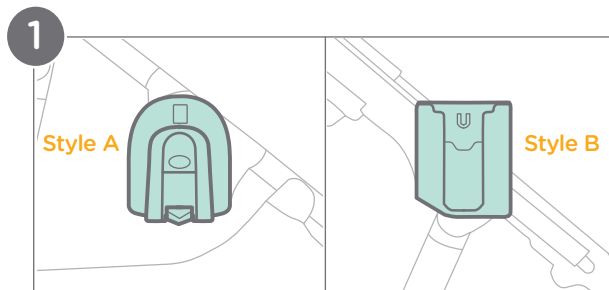

Using Carry Cot on a Joie Stroller: (cont.)

4 - Removing the Carry Cot from the Adapters:

To remove the carry cot, press both carry cot release buttons (A) and lift the carry cot upwards (B).

5 - Removing the Adapters:

Style A: To remove the adapters, slide the adapter release buttons in either direction (C) and lift the adapters upwards (D).

Style B: To remove the adapters, pull out the release tabs (E) then lift the adapters upwards (F).

Compatibility:

The carry cot is designed for use **ONLY** with Joie strollers that utilize separate, dedicated adapter mounts for connecting accessories. The carry cot is **NOT** compatible with Joie strollers that use the arm bar as a locking connection for accessories like a car seat.

For stroller compatibility questions, contact Joie Consumer Service.

IMPORTANT: FOR ALL CARRY COT STROLLER USE

Fall Hazard: ALWAYS check that the carry cot **and** adapters are securely attached to the stroller by pulling up on them.

The carry cot may be attached in both the rear-facing and forward-facing positions.

DO NOT fold the stroller with the carry cot attached.

Strangulation Hazard: Keep the adapters out of the reach of children when they are not installed on the stroller.

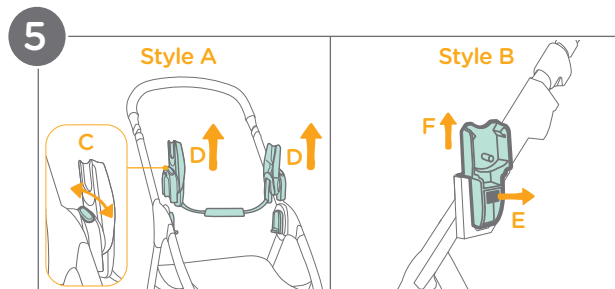
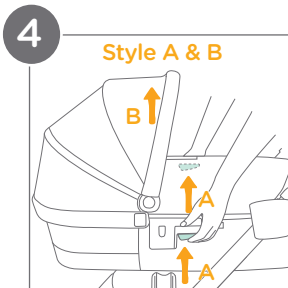

Folding Stroller with Carry Cot Adapters Attached:

This folding method applies to Joie strollers that use a pull-strap fold mechanism that is located on the seat. Since the seat is removed for the carry cot, the pull-strap is now located on the carry cot adapters.

Note: If your stroller does not use the carry cot stroller adapter folding strap for folding, please follow the folding instructions in your stroller manual.

Folding the Stroller:

- 1- Ensure that the storage latch is pointing towards the back of the stroller. If it is not, rotate it counterclockwise.
- 2- Pull up firmly on the carry cot stroller adapter folding strap.
- 3- The storage latch will automatically hook onto the storage mount. A “clicking” sound will confirm that the stroller is completely folded and locked.

Carry Cot Positioning:

This section applies to strollers with multiple seating height options and separate upper and lower seat mounts.

- 4 - **ONLY** attach the carry cot on the upper seat mounts and in the lowest seat height.
- 5 - The carry cot may be attached rear-facing or forward-facing.
- 6 - **DO NOT** attach anything on the lower mounts while the carry cot is attached.

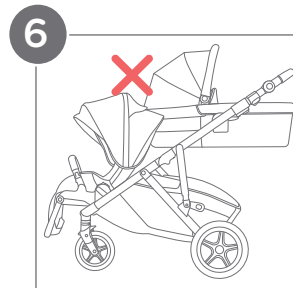
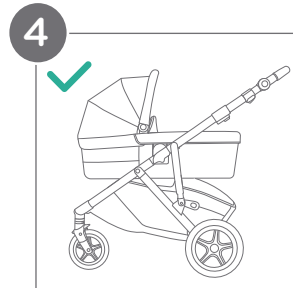
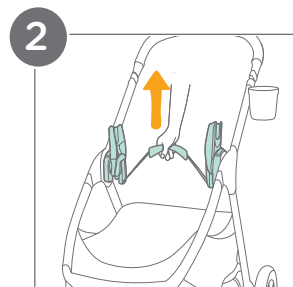
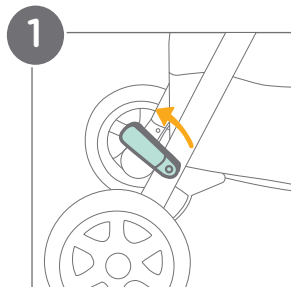

Care & Maintenance:

Cleaning:

Carry cot mattress: Spot clean with a sponge and soapy water.

Carry cot mattress cover: Remove the cover from the mattress. Machine wash and air dry the cover. **DO NOT** machine wash the mattress.

Stand: Wipe clean with a solution of warm water and mild household soap. Avoid bleach and harsh detergents.

Plastic parts: Periodically wipe clean with a damp cloth.

Metal parts: After contact with water, thoroughly dry the metal parts to prevent rust.

Maintenance:

Regular inspection: Check the carry cot and stand regularly for loose or missing parts. Discontinue use if parts are loose or missing.

Worn parts: Replace any worn or damaged parts. Use **ONLY** Joie replacement parts.

Torn material or stitching: Repair or replace torn fabric or stitching. Use **ONLY** Joie replacement fabrics.

Contact Joie Consumer Service at:

Email: info.us@joiebaby.com • Phone: 1-866-798-7866

Storage:

Extreme weather exposure: Avoid excessive sun or heat exposure to prevent fading or warping of parts. Avoid storing outside or in cold conditions.

Drying after use: If the carry cot gets wet, open the canopy and allow it to dry completely before storing.

Joie™

Effortlessly happy.

Helping parents be their best
with worry-free baby gear.