



Instruction Manual

chili spin 360™

360° spin child restraint

Child height: less than 49 in. (125 cm)

Child weight: 4 to 65 lb. (1.8 to 30 kg)



installation
videos



Read all the instructions in this manual
before using the child restraint!

Contents:

- 3** Important
 - Welcome to the Joie Family!
 - If You Need Help
 - Register Your Child Restraint
- 5** Child Requirements
- 6** Warnings
- 14** Best Practices
- 15** Vehicle Compatibility
- 16** Vehicle Belts
- 18** Choose your Installation
 - LATCH Install
 - Vehicle Belt Install
- 20** Rear-Facing or Forward-Facing Requirements
- 22** Parts List
- 24** Headrest Height Adjustment
- 26** Crotch Buckle Adjustment
- 30** Adjusting Recline
- 32** Removing Infant Insert
- 34** **RF - Install Using LATCH**
- 40** **RF - Install Using Lap/Shoulder Belt**
- 44** **RF - Install Using Lap Belt ONLY**
- 48** **Rear-Facing Securing Child in Seat**
- 54** **FF - Install Using LATCH and Tether**
- 60** **FF - Install Using Lap/Shoulder Belt and Tether**
- 64** **FF - Install Using Lap Belt ONLY and Tether**
- 68** **Forward-Facing Securing Child in Seat**
- 74** Removing LATCH and Tether
- 76** Removing Softgoods
- 82** Cup Holders
- 84** Care and Maintenance

Important:

Welcome to the Joie Family!

Ensure your child's safety - **READ THIS MANUAL CAREFULLY!**

Although no child restraint can promise to protect in every situation, using it correctly reduces the chance of serious injury. Even if the child restraint seems easy, follow the step-by-step instructions in this book.

Store this instruction manual in the compartment located on the back of the child restraint.

If You Need Help

If you have questions in the U.S.A, about parts, use, or maintaining your child restraint, contact our Customer Service Department for assistance. To ensure a speedy response, please have your child restraint's model number and date of manufacture ready. You can find the information on a sticker located on the underside of the child restraint.

Joie Baby USA Consumer Service Contact Info

Address: 70 Thousand Oaks Blvd Morgantown, PA 19543

Email: info.us@joiebaby.com

Phone: 1 (866) 798-7866

Important:

Register this Child Restraint

Child restraints could be recalled for safety reasons. You must register this restraint to be reached in a recall. Send your name, address, e-mail address if available and the restraint's model number and manufacturing date to **70 Thousand Oaks Blvd Morgantown, PA 19543** or call **1 (866) 798-7866** or register online at:

www.joiebaby.com/carseatregistration

For recall information, call the U.S. Government's Vehicle Safety Hotline at **1-888-327-4236 (TTY: 1-800-424-9153)** or go to **<http://www.NHTSA.gov>**.

For future reference, record the following information about your child restraint in case you move, lose your registration card, or need to reference it for any reason. You can find this information on the registration card or on the label located on the back of the child restraint:

Model Name: _____

Model Number: _____

Date of Manufacture: _____

Date of Purchase: _____

Child Requirements:

This child restraint is for a child that meets **BOTH** of the following requirements:

Weight: 4 to 65 lb. (1.8 to 30 kg)

Height: less than 49 in. (125 cm)

STOP using this child restraint as soon as the child reaches the max. weight OR the max. height.

According to accident statistics, children are safer when properly restrained in the rear seating positions than in the front seating positions. **Children should ride rear-facing as long as possible, until at least 2 years old.**

Preterm or Low Birth Weight Infants

To ensure the safety of your preterm or low birth weight infant (born before 37 weeks or weighing less than 5 lb. (2.3 kg), Joie recommends following the AAP's guidelines and consulting your doctor or hospital staff before the child's first car or airplane trip. A medical evaluation is crucial to check for breathing and heart rate concerns when traveling in a rear facing child restraint.

For additional information or to have your child restraint inspected by a certified professional, you can visit the Safe Kids Worldwide website at www.safekids.org

WARNING!

DEATH OR SERIOUS INJURY can occur if you fail to follow the warnings, instructions and labels on the child restraint.

- Read **ALL INSTRUCTIONS** before use of the child restraint.
- Read the vehicle owner's manual for information on child restraint installation.
- **KEEP INSTRUCTIONS FOR FUTURE USE.**
- **DO NOT** allow anyone who has not read the instruction manual to install or use this child restraint.
- Do not use the child restraint if it is damaged or broken or if parts are missing.
- **NEVER** use a child restraint that has been involved in a **MODERATE** or **SEVERE** crash.
- **DO NOT** place rear-facing child seat on front seat with air bag. **DEATH OR SERIOUS INJURY CAN OCCUR.** The back seat is the safest place for children 12 and under.



 **WARNING!**

DEATH OR SERIOUS INJURY can occur if you fail to follow the warnings, instructions and labels on the child restraint.

- If an air bag inflates, it can hit the child and child restraint with great force and cause serious injury or death to your child. Review your vehicle owner's manual for more information about air bags and child restraint use.
- Use only with a child that weighs between 4 - 65 lb. (1.8 - 30 kg) and height is less than 49 in. (125 cm).
- Stop using this child restraint as soon as the child reaches the max. weight OR the max. height.
- **NEVER** secure this car restraint using an inflatable seat belt. Move to a vehicle seat that does not have an inflatable seat belt, or Install using LATCH.
- A child's safety is your responsibility. **NEVER** leave your child unattended.
- Before each use, always check the car restraint to make sure it is tightly secured to the vehicle seat.

WARNING!

DEATH OR SERIOUS INJURY can occur if you fail to follow the warnings, instructions and labels on the child restraint.

- This restraint is certified for use only in passenger vehicles. This restraint is not certified for aircraft use, as aircraft belts will not accommodate proper installation of this restraint. 
- Failure to follow these instructions and child restraint's labels can result in child striking the vehicle's interior during a sudden stop or crash.
- According to accident statistics, children are safer when properly restrained in the rear seating positions than in the front seating positions.
- If your vehicle does not have a back seat, review your vehicle owner's manual.
- Select a suitable location for the child restraint in your vehicle. Secure child restraint with a vehicle seat belt or lower anchor attachment that is properly routed as shown in this manual.

 **WARNING!**

DEATH OR SERIOUS INJURY can occur if you fail to follow the warnings, instructions and labels on the child restraint.

- Vehicle seat belt system **MUST** hold child restraint securely. Not all vehicle seat belts can be used with a child restraint.
- Rear-facing child restraint must be properly leveled. An improperly reclined child restraint can result in breathing difficulties, injury or ejection.
- **DO NOT** remove LATCH system from child restraint. If using vehicle seat belt to secure child restraint, lower anchor connectors must be properly stored.
- **DO NOT** allow child restraint to contact the vehicle interior (side of car door or seat in front).

 **WARNING!**

DEATH OR SERIOUS INJURY can occur if you fail to follow the warnings, instructions and labels on the child restraint.

- **NEVER** use Harness Pads for children weighing more than 40 lb. (18 kg).
- Harness Pads **MUST** be on **TOP** of the child's shoulders for children weighing 4 - 22 lb. (1.8 - 10kg).
- **DO NOT** attach additional padding, toys, or other devices unless made by Joie and described in these instructions. Use Only approved accessories. Unapproved items can injure your child and may void the warranty.
- **NEVER** modify any part of the child restraint.
- **DO NOT** use Tether when installing Rear-Facing.
- **DO NOT** use child restraint if it has frayed or cut harness straps, or is damaged in any way. To find out if damaged parts are replaceable, call 1 (866) 798-7866.

 **WARNING!**

DEATH OR SERIOUS INJURY can occur if you fail to follow the warnings, instructions and labels on the child restraint.

- **NEVER** attach two lower anchor connectors to one vehicle lower anchor point unless specifically allowed by the vehicle manufacturer.
- **DO NOT** use both the vehicle seat belt and lower anchor attachment at the same time.
- **Do not install** using lower anchors (LATCH) for a child weighing more than 35 lb. (16 kg)
- **ALWAYS** make sure the turn lock indicator is green even when the child is not in the seat.
- **NEVER** leave child restraint unsecured in your vehicle even when it is unoccupied. In a crash, it could become a projectile and injure other vehicle occupants.
- When installing rear-facing with Lap Belt Only **ALWAYS** recline the seat to POSITION 4.

 **WARNING!**

DEATH OR SERIOUS INJURY can occur if you fail to follow the warnings, instructions and labels on the child restraint.

- NEVER use clothing or blankets that interfere with providing a properly tightened harness. An unsecured or improperly harnessed child can come out of the restraint during a crash.
- Place blankets over child **AFTER** harness has been properly tightened.

This child restraint system conforms to all applicable Federal motor vehicle safety standards.

 **WARNING!**

NEVER use a child restraint that has been involved in a MODERATE or SEVERE crash.

Even if there is no visible damage, the child restraint's internal structure may be compromised, and may not protect your child in a future crash.

Child Restraint is still usable after a minor incident which includes all of the following situations:

- 1) The vehicle was able to be driven away from the crash site.
- 2) The vehicle door nearest the child restraint was NOT damaged.
- 3) None of the passengers in the vehicle sustained any injuries in the crash.
- 4) If the vehicle has air bags, the air bags did not deploy during the crash; and
- 5) There is no visible damage to the child restraint.

Contact Joie with any questions or concerns.

Best Practices:

Expiration:

This child restraint expires 10 years from the date of manufacture. Stop using it after that date and dispose of it. Check the label on the back of the seat for the manufacture date.

Hot Weather Warning:

Child restraints can become extremely hot in the sun or warm weather. Always check the seat temperature before placing your child inside to avoid burns.

Clothing:

For proper harness fit and child safety, avoid bulky clothing like heavy jackets or snowsuits when using the child restraint. Ensure the harness is snug but comfortable on your child.

Vehicle Compatibility:

You **MUST** read and understand **ALL** child restraint related instructions and warnings in your vehicle owner's manual to correctly and safely use this child restraint in your vehicle.

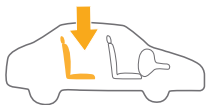

This child restraint can **ONLY** be installed on vehicle seats that face forward. **DO NOT** install in seats that face to the sides or rear of the vehicle.



DO NOT place rear-facing child seat on front seat with air bag. **DEATH OR SERIOUS INJURY CAN OCCUR.** The back seat is the safest place for children 12 and under.



NEVER attach two lower anchor connectors to one vehicle lower anchor point unless specifically allowed by the vehicle manufacturer.

DO NOT use both the vehicle seat belt and lower anchor attachment at the same time.

If your vehicle is equipped with front passenger side air bags, check your vehicle owner's manual for child restraint installation instructions.

Vehicle Belts:

These vehicle belts CANNOT BE USED with your child restraint. Install with lower anchors instead.

1-Motorized Belts (Automatic)

These should not be used unless the shoulder belt can be removed, the lap belt is locked and use is allowed by the vehicle manufacturer.

2-Non-Locking (ELR) Lap Belts

This belt only locks in a crash or sudden stop and should only be used with a belt shortening clip.

3-Airbag/Inflatable Belts

4-Door Mounted Belts

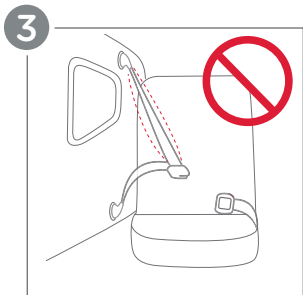
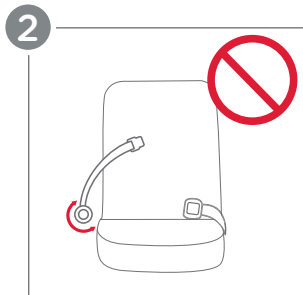
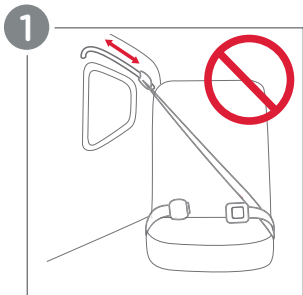

Choose Your Installation:

This child restraint can be installed in your vehicle using either the vehicle seat belt OR the lower anchor attachment (LATCH). Both are equally safe to use. **INSTALL USING ONLY ONE METHOD.**

LATCH Install:

LATCH (Lower Anchor Attachment) with Tether:

The LATCH system or lower anchor attachment and top tether allow you to securely attach your safety seat in your car without using the vehicle seat belt. All 2003 and newer model year vehicles are required to have a LATCH system, although some manufacturers began including LATCH earlier. Some vehicle owner manuals use the term ISOFIX to identify the LATCH system.

Vehicle's Tether

Anchor



Vehicle Seat
Bight

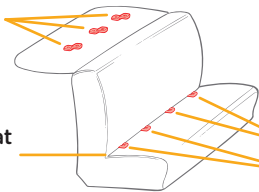

Typical seat in a passenger vehicle. Other vehicle types may have different lower anchor locations.

Vehicle Lower
Anchor



Review your vehicle owner's manual for exact location and use.

Vehicle Belt Install:

Vehicle Seat Belt:

Refer to your vehicle owner's manual to determine if the belts in your vehicle lock by switching the seat belt's retractor OR have a locking latch plate that locks the vehicle's seat belt.

Vehicle Seat Belt Terms Retractor

A device that winds up the unused vehicle seat belt. It is often hidden inside the panels on the walls of the vehicle or in the vehicle seatback.

Latch Plate

The male end of the seat belt with the metal tongue.

Buckle

Seat Bight

The crease where the vehicle seat back and seat bottom meet.

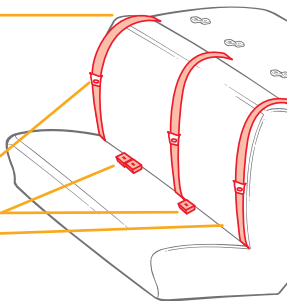

Review your vehicle owner's manual for exact location and use.

Identify Your Seat Belt Type:

The vehicle seat belt types that can be used with this child restraint.

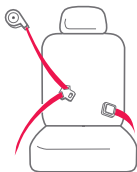

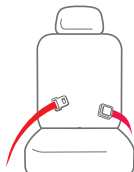

Lap/Shoulder Belt
3 connection points.

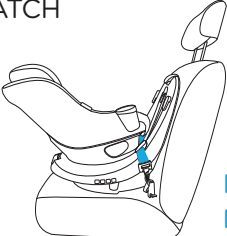
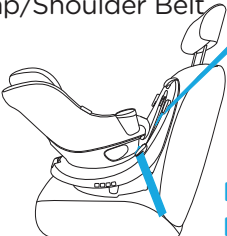

Lap Belt Only
2 connection points.

Rear-Facing Requirements:

Installation Method	Suitable For
LATCH  Install PG. 34	Child height less than 43 in. (110 cm) Child weight 4 - 40 lb. (1.8 - 18 kg) According to accident statistics, children are safer when properly restrained in the rear seating positions than in the front seating positions.
Lap/Shoulder Belt  Install PG. 40	Children should ride rear-facing as long as possible, until at least 2 years old.
Lap Belt ONLY  Install PG. 44	WARNING! DO NOT use Tether when installing Rear-Facing. WARNING! NEVER use lower anchors (LATCH) for children weighing more than 35 lb. (16 kg).

Forward-Facing Requirements:

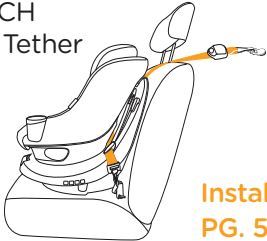
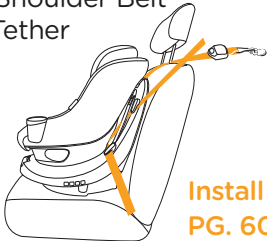
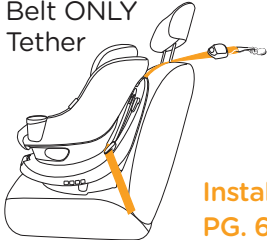
Installation Method	Suitable For
<p>LATCH and Tether</p>  <p>Install PG. 54</p>	<p>Child height less than 49 in. (125 cm)</p> <p>Child weight 30 - 65 lb. (13.6 - 30 kg)</p> <p>Child must be able to sit upright unassisted.</p> <p>WARNING! NEVER use lower anchors (LATCH) for children weighing more than 35 lb. (16 kg).</p>
<p>Lap/Shoulder Belt and Tether</p>  <p>Install PG. 60</p>	<p>Child must be able to sit upright unassisted.</p> <p>WARNING! NEVER use lower anchors (LATCH) for children weighing more than 35 lb. (16 kg).</p>
<p>Lap Belt ONLY and Tether</p>  <p>Install PG. 64</p>	

Parts List:

Please make sure there are no missing parts. Please contact Joie Customer Service if anything is missing.

- 1 Headrest
- 2 Infant Head Insert
- 3 Harness Covers
- 4 Harness Straps
- 5 Crotch Pad
- 6 Harness Adjustment Strap
- 7 Recline Adjustment Button
- 8 Chest Clip
- 9 Infant Insert
- 10 Rotation Lever
- 11 Belt Path
- 12 Headrest Adjustment Lever
- 13 Tether Strap
- 14 Tether Strap Adjuster
- 15 Tether Storage
- 16 Lower Anchor Storage
- 17 Lower Anchor Strap Adjuster
- 18 Lower Anchor Strap
- 19 Lower Anchor Connectors
- 20 Lock-Off Release Button
- 21 Lock-Off
- 22 Cup Holder
- 23 Turn Lock Indicator
- 24 Level Indicator
- 25 Instruction Manual Storage

Parts List:

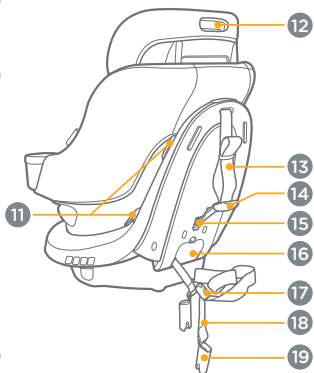
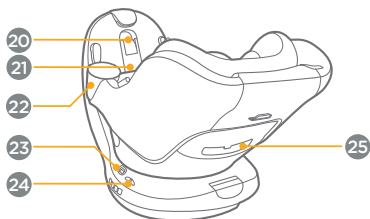
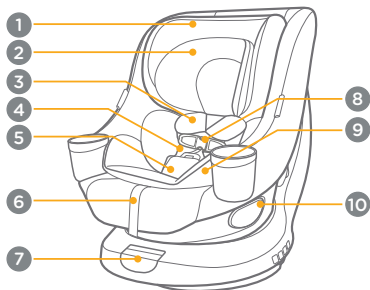

Headrest Height Adjustment:

For safety and comfort, ensure the harness straps fit snugly and are positioned correctly on your child's shoulders.

1 - Locate the harness adjustment button (1) and press it down while pulling the shoulder harnesses (2) outward to loosen.

2 - Locate the Headrest Adjustment Lever and squeeze it while moving the headrest up or down until it locks into one of the 10 available positions.

3 - Select Rear-Facing or Forward-Facing

Rear-Facing: Ensure the harness straps are level with or slightly below the top of your child's shoulders. Make sure your child's head is at least 1 inch (2.5 cm) below the top of the headrest.

Forward-Facing: Adjust the harness straps so they are level with or slightly above the top of your child's shoulders.

4 - The Headrest back fabric has 3 folding positions. After adjusting the Headrest fold or unfold the back fabric to provide proper support.

5 - Check the Final Fit: Have your child sit back in the child restraint and repeat **Step 1 - Headrest Height Adjustment** if necessary to ensure the harness is snug and positioned correctly at the shoulders.

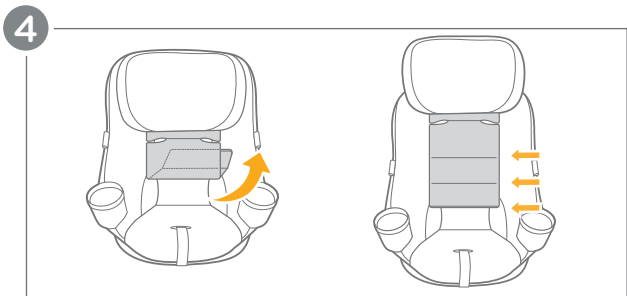
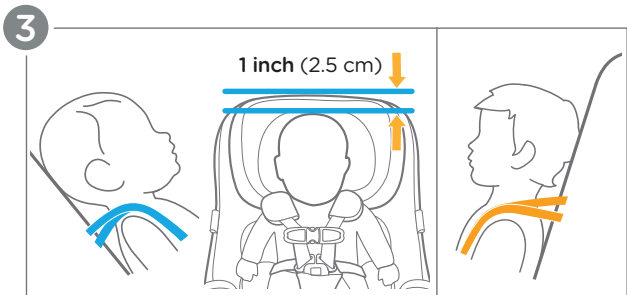
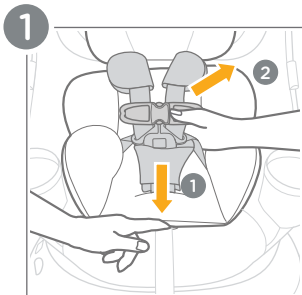

Crotch Buckle Adjustment:

For safety and comfort, the crotch buckle has two positions. Use the position that is closest to, but not under your child.

- 1 - The crotch buckle has two adjustable positions.
- 2 - Rotate seat to side position for easier access.
- 3 - Unbuckle the harness by pressing the release button on the Chest Clip.
- 4 - Press button and remove the Buckle Tongues from crotch buckle.
- 5 - Remove the Crotch Pad.
- 6 - If using the Infant Insert - Gently pull the insert upwards, threading the crotch buckle through the insert to remove it.

(Crotch Buckle Adjustment continued on PG. 28)

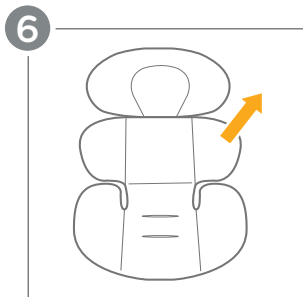
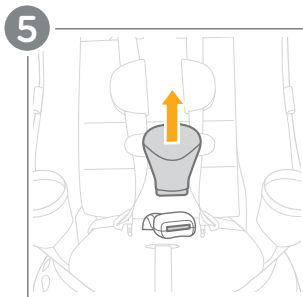
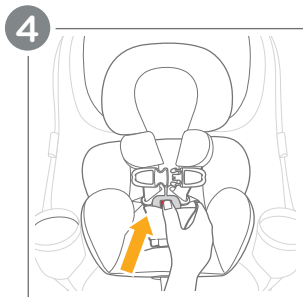
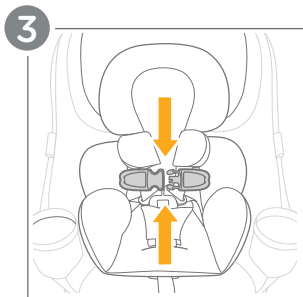
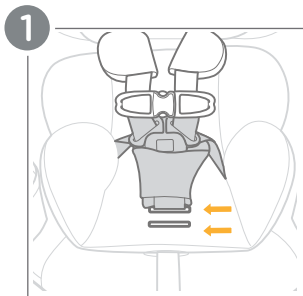

Crotch Buckle Adjustment: (cont.)

7 - Undo the snap buttons and pull up on the seat fabric around the Harness Adjustment Strap.

8 - Locate the crotch buckle adjustment slots in the seat shell and squeeze/pinch the sides of the strap together.

9 - Twist and slide the crotch buckle strap forward or backwards into the desired slot to best fit your child.

10 - Thread the crotch buckle back up through the seat fabric in the correct slot and re-attach the seat fabric button snaps.

Re-assemble the Crotch Pad and Infant Insert (if being used).

WARNING! ALWAYS make sure the crotch buckle strap is **NOT** twisted and the buckle button is facing outward.

IMPORTANT: Check to ensure the crotch buckle strap is properly secured by pulling up on the buckle.

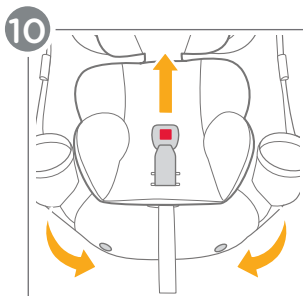
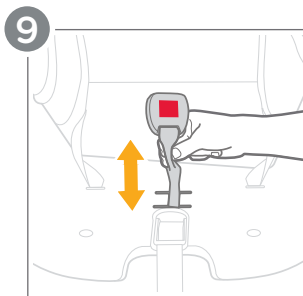
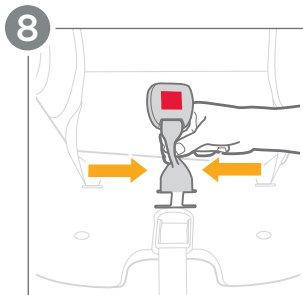
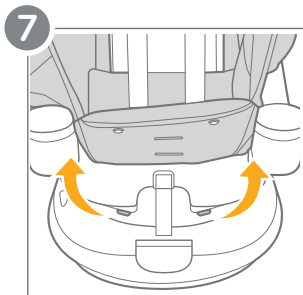

Adjusting Recline:

ALWAYS adjust recline when installing **Rear-Facing**.

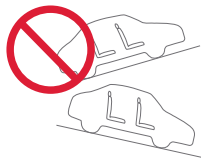

Make sure the vehicle is on a flat and **LEVEL** surface.

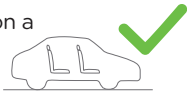

NEVER adjust the recline when vehicle is on an incline.

1 - Pull the Rotate Lever and turn the child restraint seat to either Rear-Facing or Forward-Facing based on your installation choice. Then place the child restraint on your vehicle seat.

2 - The recline can be adjusted by pulling the Recline Adjustment Lever and pulling or pushing the seat into the desired position.

3 - This child restraint has 4 recline positions that can be used for either rear-facing or forward-facing.

4 - When installing **Rear-Facing:** The level indicator on the child restraint window must show **FULLY BLUE** when placed on the vehicle seat.

If needed, a rolled towel may be placed under the child restraint at the vehicle seat crease, until the bubble is completely in the blue area.

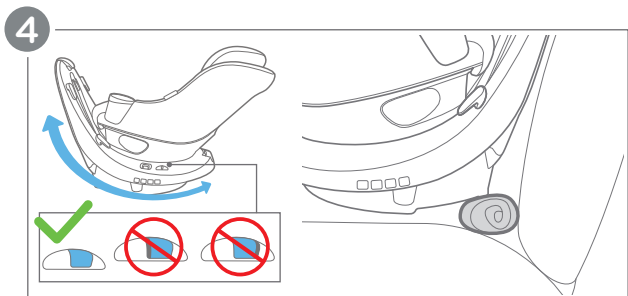
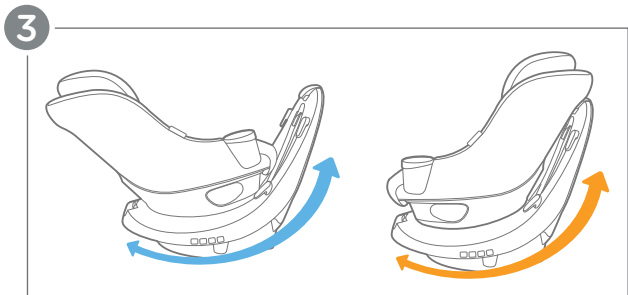
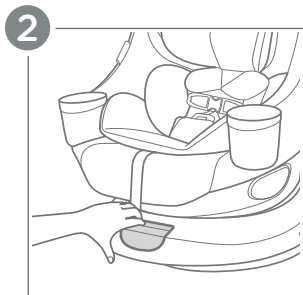
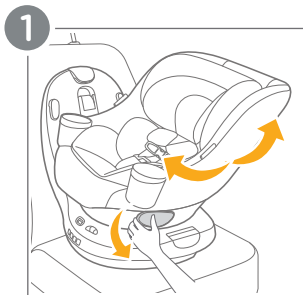

The Infant Insert can be used as necessary, to provide a snug fit for small babies.

Removing Infant Insert:

- 1 - Pull the Rotate Lever and turn the child restraint seat to the side position for easier access.
- 2 - Unbuckle the harness by pressing the release button on the Chest Clip.
- 3 - Press button and remove the Buckle Tongues from Harness Buckle.
- 4 - Remove the Crotch Pad.
- 5 - Gently pull the Infant Insert upwards, threading the Harness Buckle through the insert to remove it. Then re-attach the Crotch Pad and Harness Covers.

IMPORTANT: The Infant Insert can be used for smaller babies, but **MUST** be removed once the child reaches 11 lb. (5 kg).

IMPORTANT: **NEVER** use infant insert when Forward-Facing.

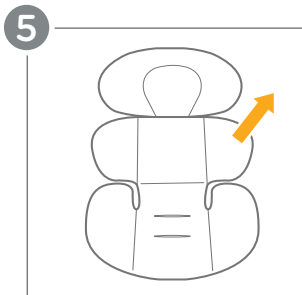
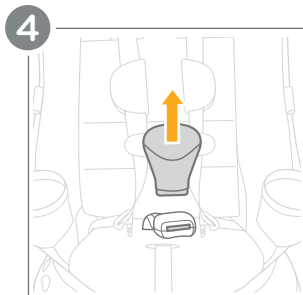
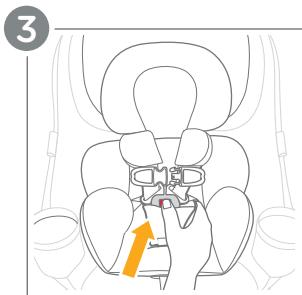
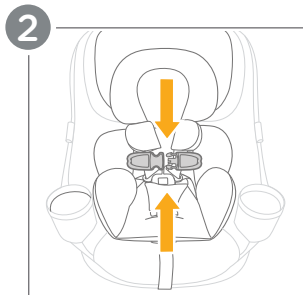
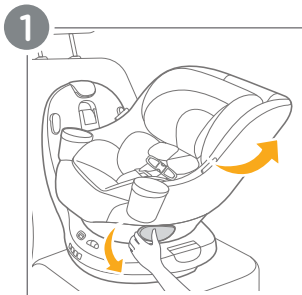

Install Using LATCH:

WARNING! Do not install by this method for a child weighing more than 35 lb. (16 kg).

WARNING! DO NOT use Tether when installing Rear-Facing.

INSTALL USING ONLY ONE METHOD.

NEVER install using BOTH Seat Belt and LATCH.

BEFORE INSTALLING refer to Adjusting Recline on PG 30 and properly store Tether see PG 74.

- 1** - Rotate the child restraint seat to the Rear-Facing position.
- 2** - Recline the child restraint to the most upright position and open the LATCH storage door on the back of the child restraint base.
- 3** - Remove the LATCH anchors that are secured with a strap. Then press the grey button on the LATCH anchors and pull to extend the LATCH Straps to their full length.

(Install Using LATCH continued on PG. 36)

1

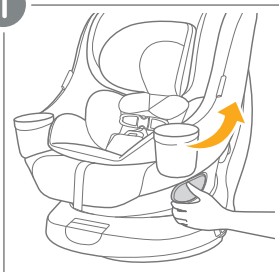

2

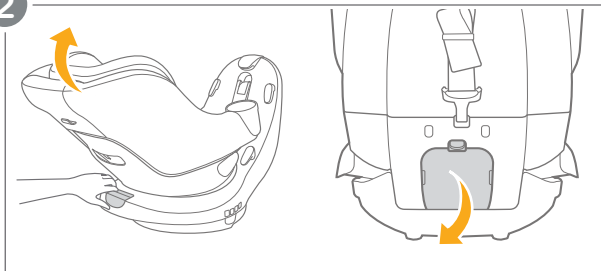

3

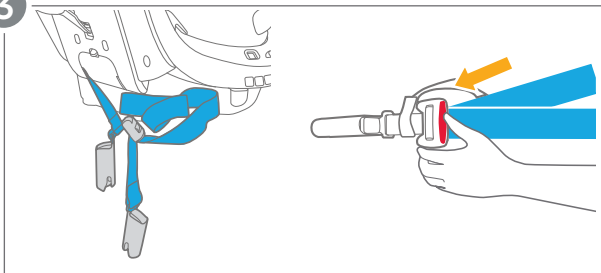

Install Using LATCH: (cont.)

- 4 - Open the Lock-Off bar on the child restraint base.
- 5 - Make sure the LATCH Straps are routed inside the Lock-Off area and **UNDERNEATH** both Belt Guides on the child restraint base.
- 6 - Attach **BOTH** LATCH Connectors to the correct lower anchor points in your vehicle.

TIP: The arrows on the sides of the LATCH Connectors should be pointing upwards. Refer to your vehicle's manual for specific lower anchor locations.

- 7 - Tighten the LATCH Strap by pulling the loose end of the webbing. Push the child restraint down firmly while tightening to remove any slack in the strap.

(Install Using LATCH continued on PG. 38)

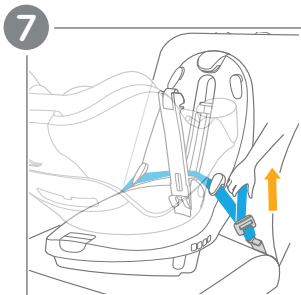
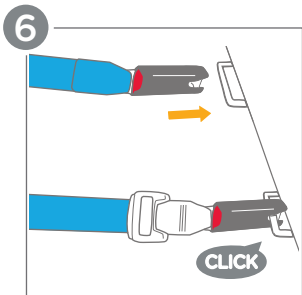
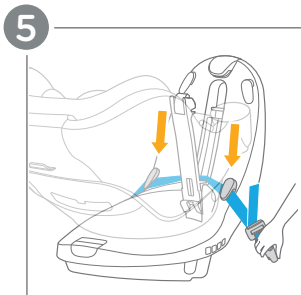
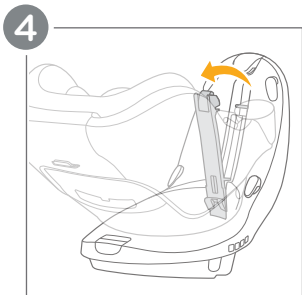

Install Using LATCH: (cont.)

8 - Once the LATCH Straps are tight, close the Lock-Off bar. Keep your hands clear of the Lock-Off area while closing it.

After installing your child restraint continue on to [Rear-Facing Securing Child in Seat](#) on PG. 48.

Check Install!

- Lock-Off Bar is securely locked.
- LATCH Connectors are properly attached.
- Child restraint should be stable and not move side to side more than 1 inch (2.5 cm).

8

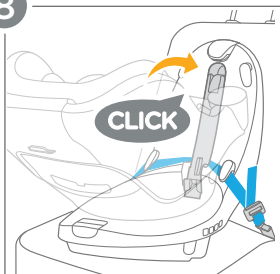

Install Using Lap/Shoulder Belt:

WARNING! DO NOT use Tether when installing Rear-Facing.

INSTALL USING ONLY ONE METHOD.

NEVER install using BOTH Seat Belt and LATCH.

Only install in a forward facing vehicle seat.

BEFORE INSTALLING refer to Adjusting Recline on PG 30 and properly store Tether see PG 74.

1 - Rotate the child restraint seat to the Rear-Facing position.

2 - Open the Lock-Off bar on the child restraint base.

3 - Feed the Lap/Shoulder Belt through the belt path inside the Lock-Off area on the child restraint base and buckle the Lap/Shoulder Belt. Make sure the Lap/Shoulder Belt is **UNDERNEATH** all three Belt Guides.

IMPORTANT: Make sure the vehicle belt is not twisted and lies flat against the child restraint base.

4 - Tighten the Lap/Shoulder Belt. Push the child restraint down firmly while tightening to remove any slack in the straps.

(Install Using Lap/Shoulder Belt continued on PG. 42)

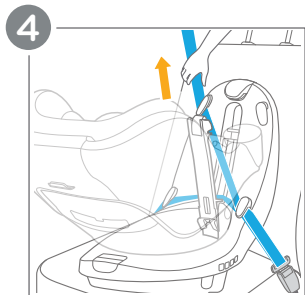
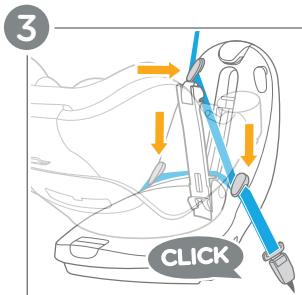
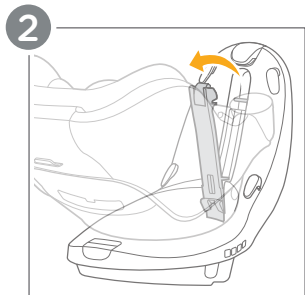
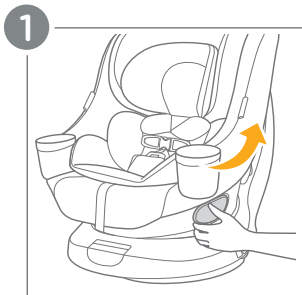

Install Using Lap/Shoulder Belt: (cont.)

5 - Once the Lap/Shoulder Belt is tight, close the Lock-Off bar. Keep your hands clear of the Lock-Off area while closing it.

After installing your child restraint continue on to [Rear-Facing Securing Child in Seat](#) on PG. 48.

Check Install!

- Lock-Off Bar is securely locked.
- Vehicle belt is buckled and is as tight as possible around the child restraint. Vehicle Belt is not loose or twisted.
- Child restraint should be stable and not move side to side more than 1 inch (2.5 cm) at belt path.

5

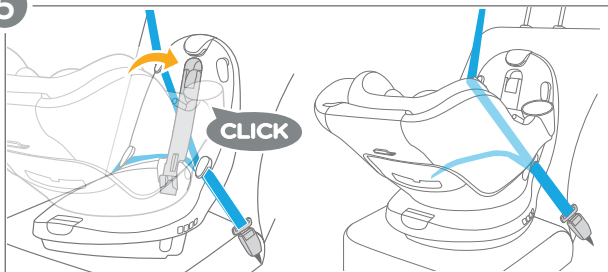

Install Using Lap Belt ONLY:

WARNING! DO NOT use Tether when installing Rear-Facing.

INSTALL USING ONLY ONE METHOD - NEVER install using BOTH Seat Belt and LATCH. ONLY install in a forward facing vehicle seat.

BEFORE INSTALLING the Tether must be properly stored see PG 74 and the recline **MUST** be adjusted to recline **POSITION 4** see PG 30.

- 1** - Rotate the child restraint seat to the Rear-Facing position.
- 2** - Open the Lock-Off bar on the child restraint base.
- 3** - Feed the Lap Belt through the belt path inside the Lock-Off area on the child restraint base and buckle the Lap Belt. Make sure the Lap Belt is **UNDERNEATH** both Belt Guides.

IMPORTANT: Make sure the vehicle belt is not twisted and lies flat against the child restraint base.

- 4** - Tighten the Lap Belt. Push the child restraint down firmly while tightening to remove any slack in the strap.

(Install Using Lap Belt ONLY continued on PG. 46)

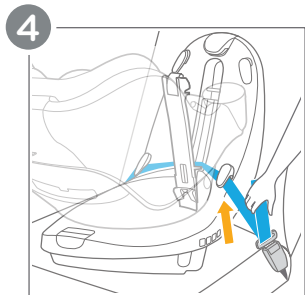
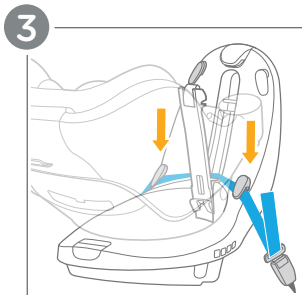
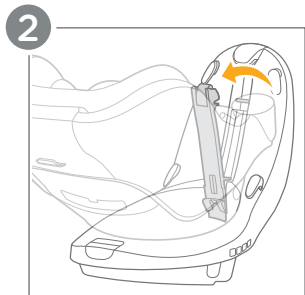
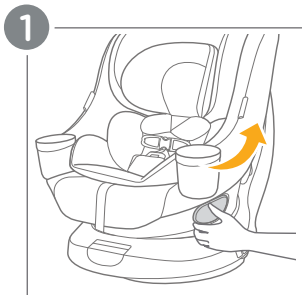

Install Using Lap Belt ONLY: (cont.)

5 - Once the Lap Belt is tight, close the Lock-Off bar. Keep your hands clear of the Lock-Off area while closing it.

After installing your child restraint continue on to **Rear-Facing Securing Child in Seat** on PG. 48.

Check Install!

- Lock-Off Bar is securely locked.
- Vehicle belt is buckled and is as tight as possible around the child restraint. Vehicle Belt is not loose or twisted.
- Child restraint should be stable and not move side to side more than 1 inch (2.5 cm) at belt path.

5

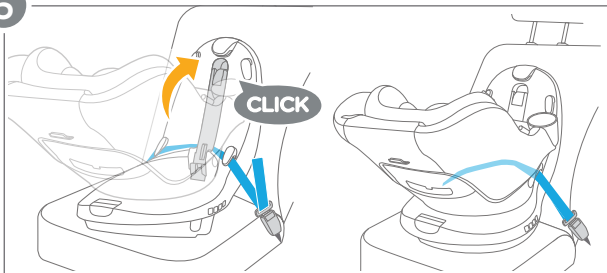

Rear-Facing Securing Child:

- 1** - Pull the Rotate Lever and turn the child restraint seat to the side position for easier access.
- 2** - Locate the harness adjustment button (1) and press it down while pulling the shoulder harnesses (2) outward to loosen.
- 3** - Unbuckle the harness by pressing the release button on the Chest Clip.
- 4** - Press button and remove the Buckle Tongues from Harness Buckle.

IMPORTANT: Child must be in a seated position against both the back and bottom of the seat with no gap behind the child. Do not allow child to slouch.

- 5** - Spread apart the harness straps and insert the Buckle Tongues into the loops on either side of the child restraint to keep the straps out of the way. Place your child into the child restraint and gently guide child's arms through the Shoulder Straps.

(Rear-Facing Securing Child continued on PG. 50)

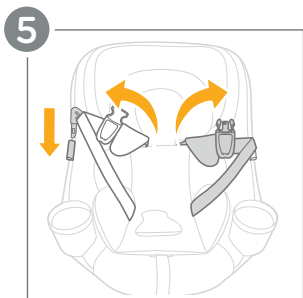
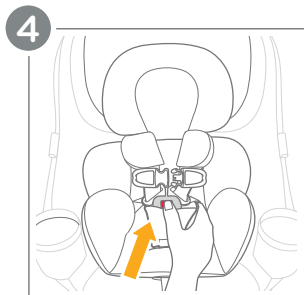
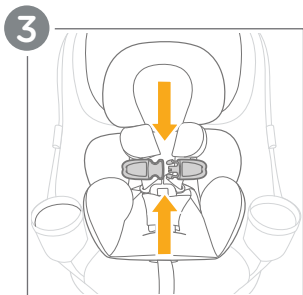
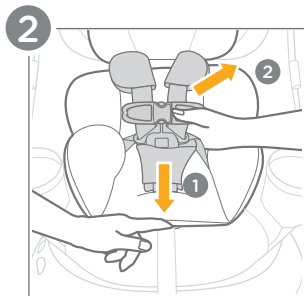
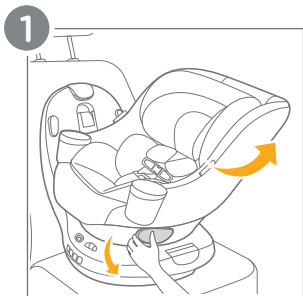

Rear-Facing Securing Child: (cont.)

6 - The top of child's head **MUST** be at least 1 inch below top of child restraint and harness straps must be at or just **BELOW** child's shoulders to avoid injury. **If NOT please refer to Headrest Height Adjustment on PG 24.**

7 - Insert Buckle Tongues into the Buckle. Listen for click. Pull on Buckle to make sure it is properly attached.

8 - Snap the Chest Clip together and temporarily slide towards Buckle before tightening the Harness Straps.

9 - Pull on the Adjustment Strap to tighten the Harness. Slide any excess strap length from the child's waist up through the buckle towards the shoulders, and repeat this step until the harness is secure. You should **NOT** be able to pinch the harness strap.

WARNING! Make sure that nothing interferes with the harness. Make sure Harness Straps are snug around child and lay flat.

Serious injury or death could occur to a child that is not secured properly. If child is not secured properly, child could be ejected in a sudden stop or crash, resulting in serious injury or death.

TIP: The harness should be snug around your child's waist and shoulders. It may take a few adjustments, so be patient!

(Rear-Facing Securing Child continued on PG. 52)

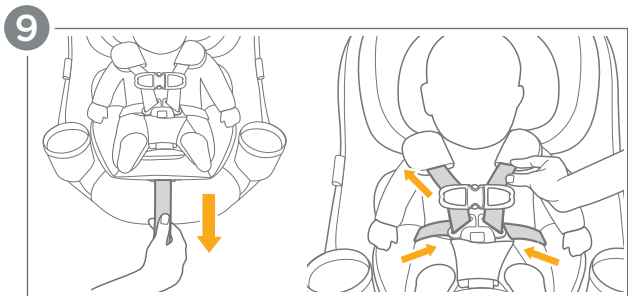
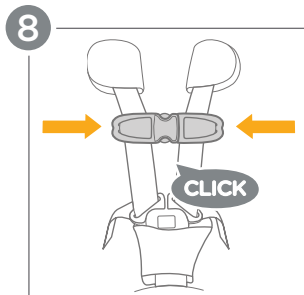
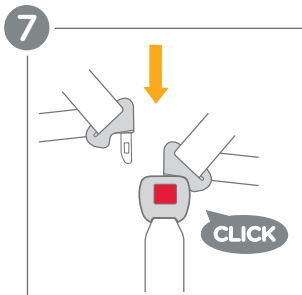
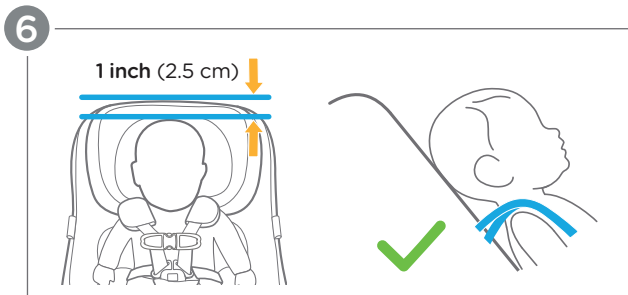

Rear-Facing Securing Child: (cont.)

10 - Position the Chest Clip at child's **ARMPIT LEVEL** and make sure the Harness Pads are on **TOP** of the child's shoulders.

WARNING! Harness Pads **MUST** be on **TOP** of the child's shoulders for children weighing 4 - 22 lb. (1.8 - 10 kg).

11 - Pull the Rotate Lever and turn the child restraint seat to the **REAR-FACING** position. Make sure the Turn Lock Indicator is **GREEN**.

Check Setup!

Harness is snug - A snug harness cannot be pinched horizontally, and should not allow any slack. If Harness Straps are not snugly adjusted, child may be ejected from seat in the event of an crash.

IMPORTANT: A snug strap should not allow any slack. It lies in a relatively straight line without sagging. It does not press on the child's flesh or push the child's body into an unnatural position.

- Chest Clip and Buckle are secured properly.**
- Chest Clip is at child's armpit level.**
- Child's Head is at least 1 inch below top of Headrest.**
- Shoulder Straps are at or just BELOW Child's shoulders.**
- Turn Lock Indicator is showing GREEN.**

10

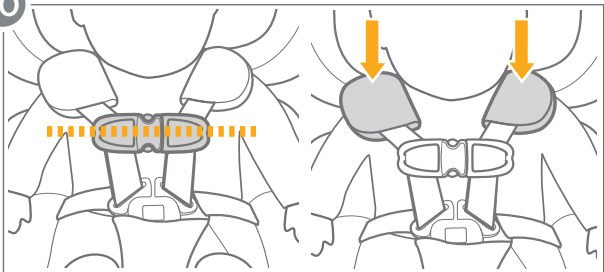

11

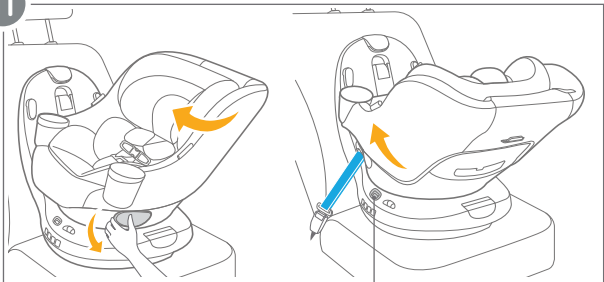

WARNING! ALWAYS make sure the turn lock indicator is green, even when the child is not in the seat.

Install Using LATCH:

WARNING! Do not install by this method for a child weighing more than 35 lbs (16 kg).

INSTALL USING ONLY ONE METHOD.

NEVER install using BOTH Seat Belt and LATCH.

BEFORE INSTALLING refer to Adjusting Recline on PG 30.

- 1** - Rotate the child restraint seat to the Rear-Facing position.
- 2** - Recline the child restraint to the most upright position and open the LATCH storage door on the back of the child restraint base.
- 3** - Remove the LATCH anchors that are secured with a strap. Then press the grey button on the LATCH anchors and pull to extend the LATCH Straps to their full length.

(Install Using LATCH continued on PG. 56)

1

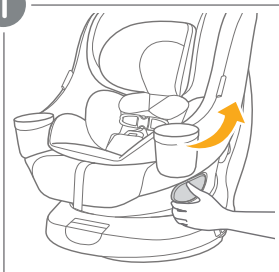

2

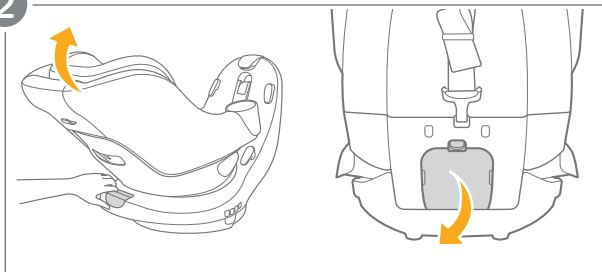

3

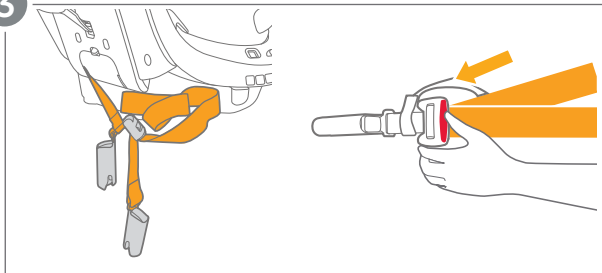

Install Using LATCH: (cont.)

4 - Locate the Top Tether strap stored on the back of the child restraint base and unhook it from its storage. Loosen the Tether strap fully by pulling up on the release tab (1).

Then Place the child restraint on the vehicle seat and lay the Tether strap across the back of the vehicle seat.

5 - Open the Lock-Off bar on the child restraint base.

6 - Make sure the LATCH Straps are routed inside the Lock-Off area and **UNDERNEATH** both Belt Guides on the child restraint base.

7 - Attach **BOTH** LATCH Connectors to the correct lower anchor points in your vehicle.

TIP: The arrows on the sides of the LATCH Connectors should be pointing upwards. Refer to your vehicle's manual for specific lower anchor locations.

8 - Tighten the LATCH Strap by pulling the loose end of the webbing. Push the child restraint down firmly while tightening to remove any slack in the strap.

(Install Using LATCH continued on PG. 58)

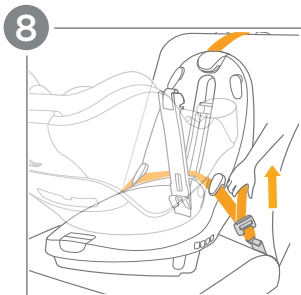
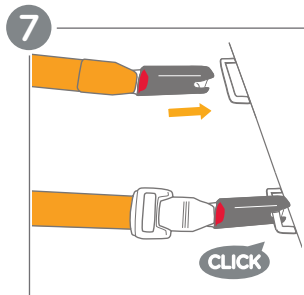
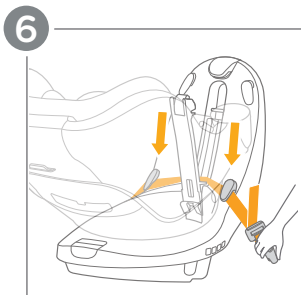
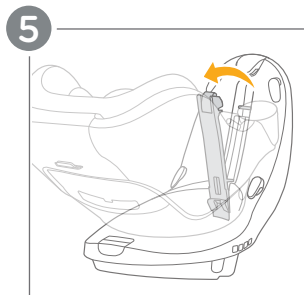
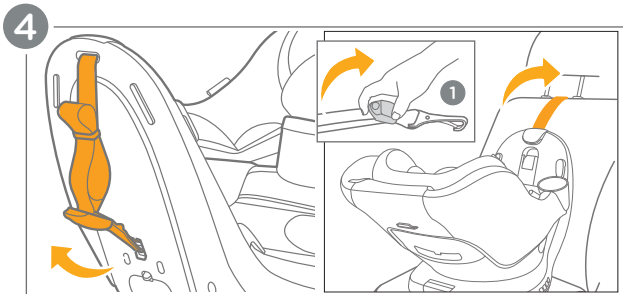

Install Using LATCH: (cont.)

9 - Once the LATCH Straps are tight, close the Lock-Off bar. Keep your hands clear of the Lock-Off area while closing it.

10 - Attach the Tether strap to your vehicles tether attachment point. Pull the loose end of the webbing on the top Tether strap to tighten it. There should be no slack in the strap.

After installing your child restraint continue on to Forward-Facing Securing Child in Seat on PG. 68.

Check Install!

- Lock-Off Bar is securely locked and Tether has no slack.
- LATCH Connectors are properly attached.
- Child restraint should be stable and not move side to side more than 1 inch (2.5 cm).

9

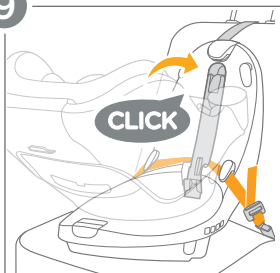

10

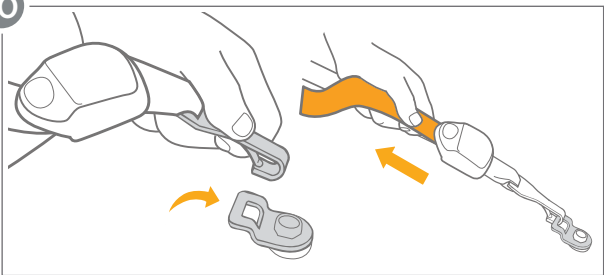

Install Using Lap/Shoulder Belt:

INSTALL USING ONLY ONE METHOD.

NEVER install using BOTH Seat Belt and LATCH.

Only install in a forward facing vehicle seat.

BEFORE INSTALLING refer to Adjusting Recline on PG 30.

- 1** - Rotate the child restraint seat to the Rear-Facing position.
- 2** - Open the Lock-Off bar on the child restraint base.
- 3** - Locate the Top Tether strap stored on the back of the child restraint base and unhook it from its storage. Loosen the Tether strap fully by pulling up on the release tab (1).

Then place the child restraint on the vehicle seat and lay the Tether strap across the back of the vehicle seat.

- 4** - Feed the Lap/Shoulder Belt through the belt path inside the Lock-Off area on the child restraint base and buckle the Lap/Shoulder Belt. Make sure the Lap/Shoulder Belt is **UNDERNEATH** all three Belt Guides.

IMPORTANT: Make sure the vehicle belt is not twisted and lies flat against the child restraint base.

- 5** - Tighten the Lap/Shoulder Belt. Push the child restraint down firmly while tightening to remove any slack in the straps.

(Install Using Lap/Shoulder Belt continued on PG. 62)

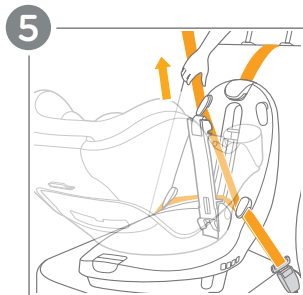
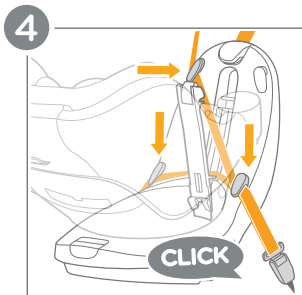
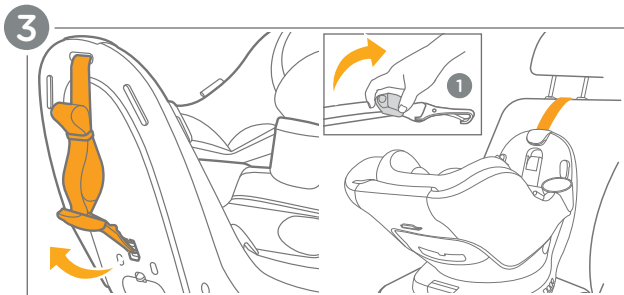
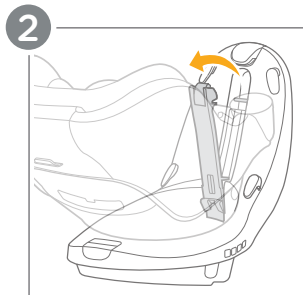
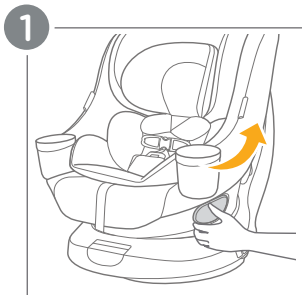

Install Using Lap/Shoulder Belt: (cont.)

6 - Once the Lap/Shoulder Belt is tight, close the Lock-Off bar. Keep your hands clear of the Lock-Off area while closing it.

7 - Attach the Tether strap to your vehicles tether attachment point. Pull the loose end of the webbing on the top Tether strap to tighten it. There should be no slack in the strap.

After installing your child restraint continue on to Forward-Facing Securing Child in Seat on PG. 68.

Check Install!

- Lock-Off Bar is securely locked and Tether has no slack.
- Vehicle belt is buckled and is as tight as possible around the child restraint. Vehicle Belt is not loose or twisted.
- Child restraint should be stable and not move side to side more than 1 inch (2.5 cm) at belt path.

6

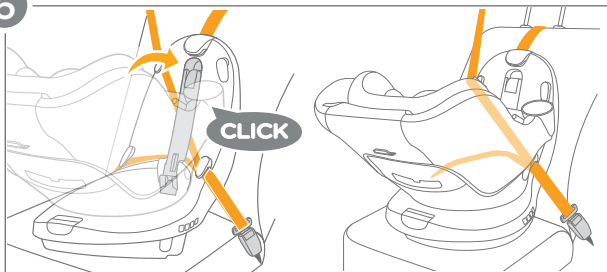

7

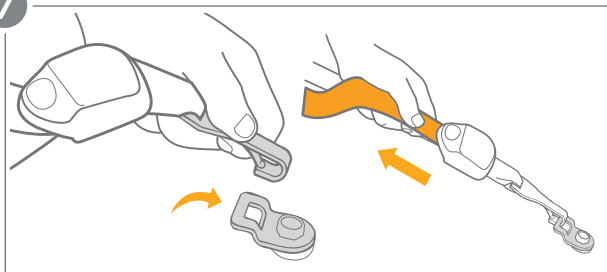

Install Using Lap Belt ONLY:

INSTALL USING ONLY ONE METHOD - NEVER install using BOTH Seat Belt and LATCH. ONLY install in a forward-facing vehicle seat.

BEFORE INSTALLING refer to Adjusting Recline on PG 30.

WARNING! When installing rear-facing with Lap Belt Only **ALWAYS** recline the seat to **POSITION 4**.

- 1** - Rotate the child restraint seat to the Rear-Facing position.
- 2** - Open the Lock-Off bar on the child restraint base.
- 3** - Locate the Top Tether strap stored on the back of the child restraint base and unhook it from its storage. Loosen the Tether strap fully by pulling up on the release tab (1).

Then place the child restraint on the vehicle seat and lay the Tether strap across the back of the vehicle seat.

- 4** - Feed the Lap Belt through the belt path inside the Lock-Off area on the child restraint base and buckle the Lap Belt. Make sure the Lap Belt is **UNDERNEATH** both Belt Guides.

IMPORTANT: Make sure the vehicle belt is not twisted and lies flat against the child restraint base.

(Install Using Lap Belt ONLY continued on PG. 66)

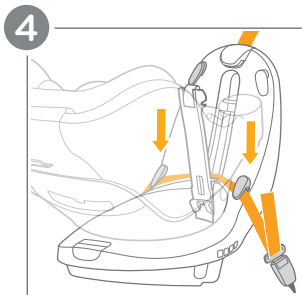
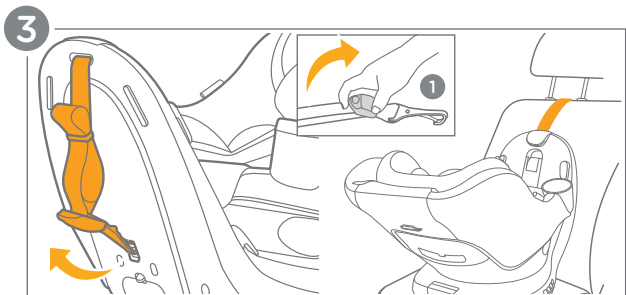
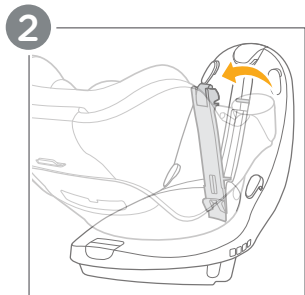
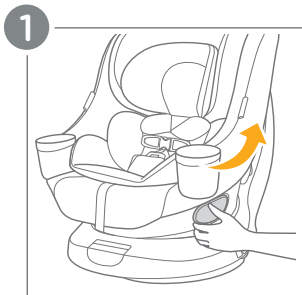

Install Using Lap Belt ONLY: (cont.)

5 - Tighten the Lap Belt. Push the child restraint down firmly while tightening to remove any slack in the strap.

6 - Once the Lap Belt is tight, close the Lock-Off bar. Keep your hands clear of the Lock-Off area while closing it.

7 - Attach the Tether strap to your vehicles tether attachment point. Pull the loose end of the webbing on the top Tether strap to tighten it. There should be no slack in the strap.

After installing your child restraint continue on to Forward-Facing Securing Child in Seat on PG. 68.

Check Install!

- Lock-Off Bar is securely locked and Tether has no slack.
- Vehicle belt is buckled and is as tight as possible around the child restraint. Vehicle Belt is not loose or twisted.
- Child restraint should be stable and not move side to side more than 1 inch (2.5 cm) at belt path.

5

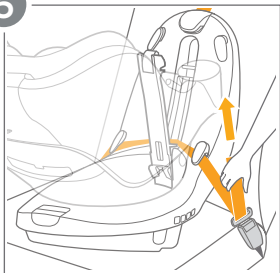

6

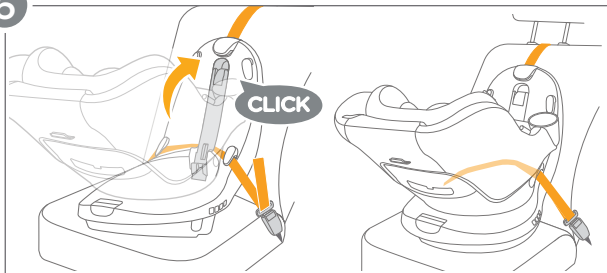

7

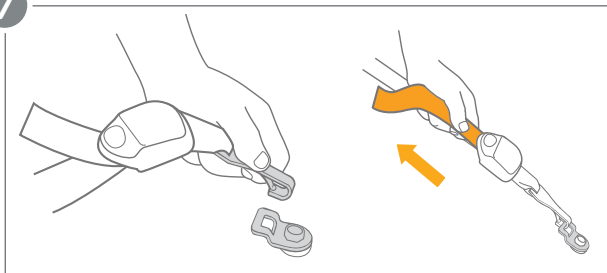

Forward-Facing Securing Child:

- 1** - Pull the Rotate Lever and turn the child restraint seat to the side position for easier access.
- 2** - Locate the harness adjustment button (1) and press it down while pulling the shoulder harnesses (2) outward to loosen.
- 3** - Unbuckle the harness by pressing the release button on the Chest Clip.
- 4** - Press button and remove the Buckle Tongues from Harness Buckle.

IMPORTANT: Child must be in a seated position against both the back and bottom of the seat with no gap behind the child. Do not allow child to slouch.

- 5** - Spread apart the harness straps and insert the Buckle Tongues into the loops on either side of the child restraint to keep the straps out of the way. Place your child into the child restraint and gently guide child's arms through the Shoulder Straps.

WARNING! NEVER use Harness Pads for children weighing more than 40 lb. (18 kg).

IMPORTANT: NEVER use infant insert when Forward-Facing.

(Forward-Facing Securing Child continued on PG. 70)

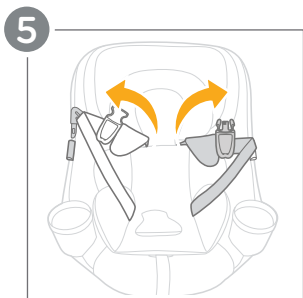
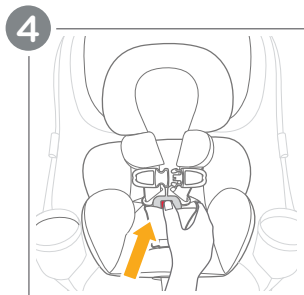
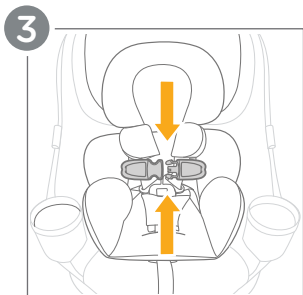
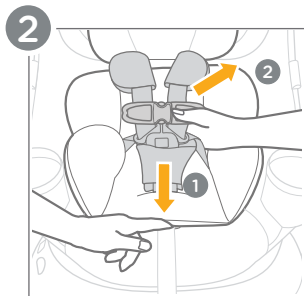
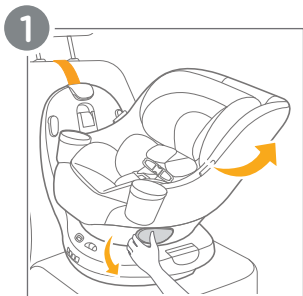

Forward-Facing Securing Child: (cont.)

6 - Insert Buckle Tongues into the Buckle. Listen for click. Pull on Buckle to make sure it is properly attached.

7 - Snap the Chest Clip together and temporarily slide towards Buckle for tightening the Harness Straps.

8 - Pull on the Adjustment Strap to tighten the Harness. Slide any excess strap length from the child's waist up through the buckle towards the shoulders, and repeat this step until the harness is secure. You should **NOT** be able to pinch the harness strap.

WARNING! Make sure that nothing interferes with the harness. Make sure Harness Straps are snug around child and lay flat.

Serious injury or death could occur to a child that is not secured properly. If child is not secured properly, child could be ejected in a sudden stop or crash, resulting in serious injury or death.

TIP: The harness should be snug around your child's waist and shoulders. It may take a few adjustments, so be patient!

(Forward-Facing Securing Child continued on PG. 72)

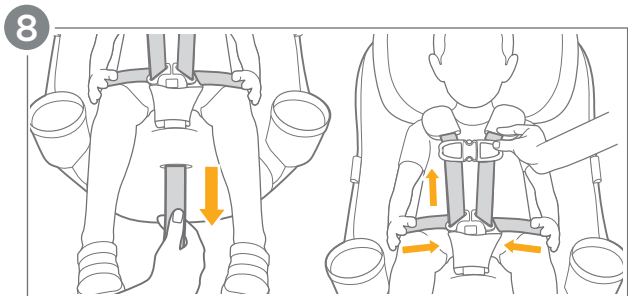
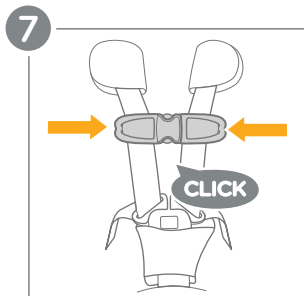
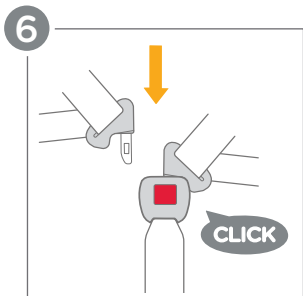

Forward-Facing Securing Child: (cont.)

9 - Harness straps must be at or just ABOVE child's shoulders. If **NOT** please refer to **Headrest Height Adjustment** on **PG 24**.

10 - Position the Chest Clip at child's armpit level.

11 - Pull the Rotate Lever and turn the child restraint seat to the **FORWARD-FACING** position. Make sure the Turn Lock Indicator is **GREEN**.

Check Setup!

Harness is snug - A snug harness cannot be pinched horizontally, and should not allow any slack. If Harness Straps are not snugly adjusted, child may be ejected from seat in the event of a crash.

IMPORTANT: A snug strap should not allow any slack. It lies in a relatively straight line without sagging. It does not press on the child's flesh or push the child's body into an unnatural position.

Chest Clip and Buckle are secured properly.

Chest Clip is at child's armpit level.

Shoulder Straps are at or just ABOVE Child's shoulders.

Turn until Lock Indicator is showing **GREEN.**

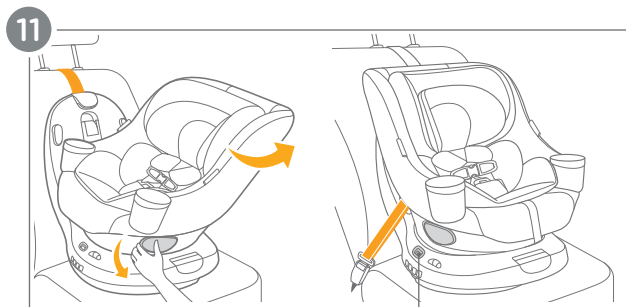
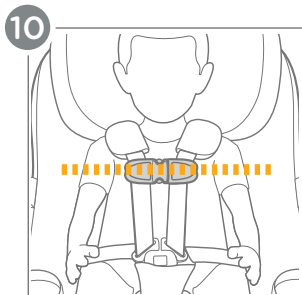
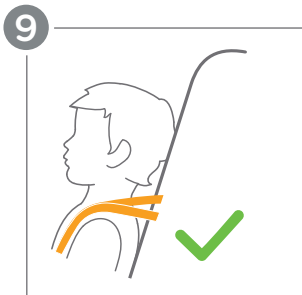

WARNING! ALWAYS make sure the turn lock indicator is green, even when the child is not in the seat.

Removing LATCH and Tether:

- 1** - Open the Lock-Off bar.
- 2** - Press the red buttons on both LATCH Connectors and pull to remove from the lower anchor points in your vehicle.
- 3** - Lift the Tether release tab and pull to release it. Then un-clip the Tether from your vehicle.
- 4** - Store the Tether strap on the clip on the back of the child restraint base when not in use.
- 5** - Store the LATCH Straps in the storage compartment on the back of the child restraint base when not in use.

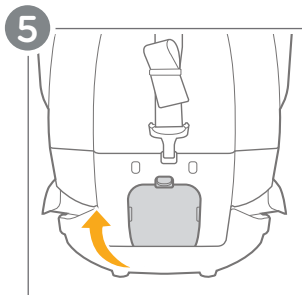
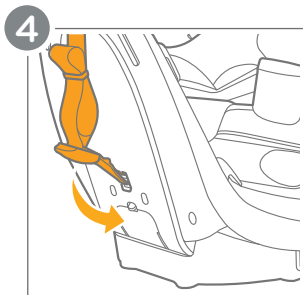
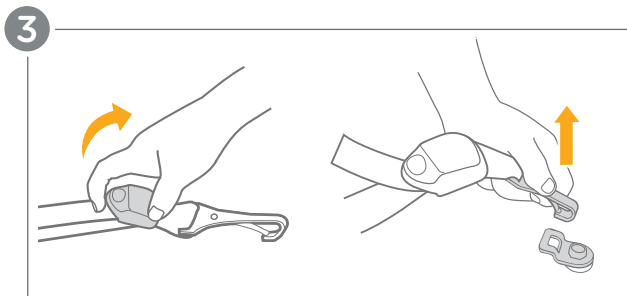
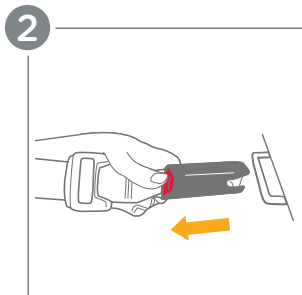
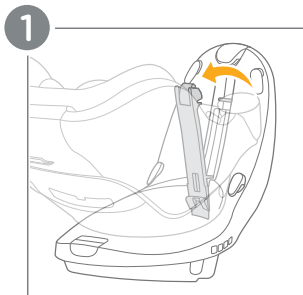

Removing Softgoods:

WARNING! NEVER use this child restraint without the softgoods in place.

- 1** - Pull the Rotate Lever and turn the child restraint seat to the side position.
- 2** - Unbuckle the harness by pressing the release button on the Chest Clip.
- 3** - Press button and remove the Buckle Tongues from Harness Buckle.
- 4** - Remove the Crotch Pad and the Harness Pads.
- 5** - Gently pull the Infant Insert upwards, threading the Harness Buckle through the insert to remove it.

(Removing Softgoods continued on PG. 78)

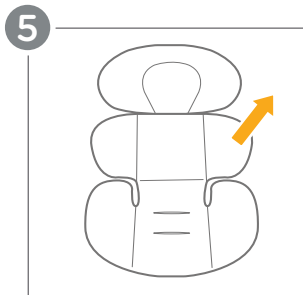
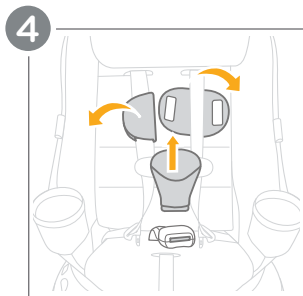
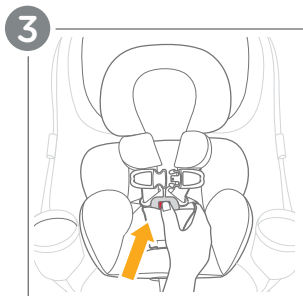
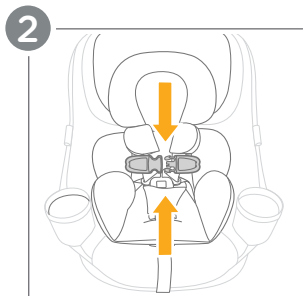
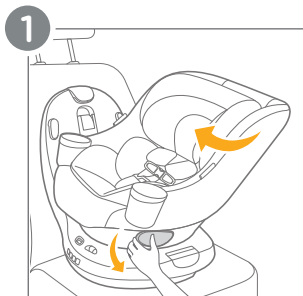

Removing Softgoods: (cont.)

6 - On the BACK of the headrest, un-hook BOTH elastic straps of the headrest cover from the headrest.

Then pull the headrest cover forward and undo the BOTH snaps on the bottom of the headrest cover and remove the headrest cover.

7 - Undo the two buttons inside seat shell, pull backrest fabric forward, slide buckle through fabric slot.

8 - Undo the two buttons on the bottom of the seat fabric.

9 - Undo the two buttons located on either side of the seat.

10 - Lift bottom fabric up away from the seat shell.

(Removing Softgoods continued on PG. 80)

6

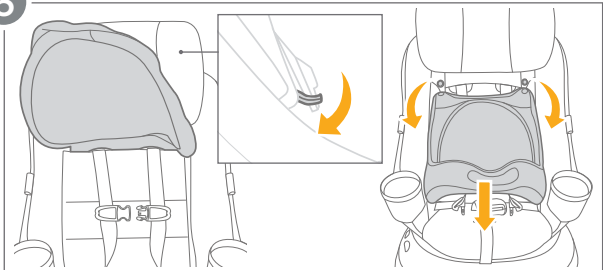

7

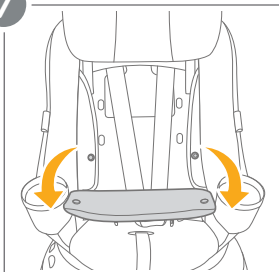

8

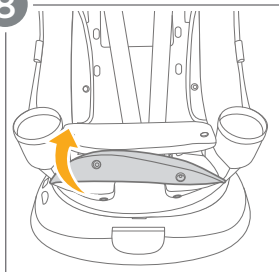

9

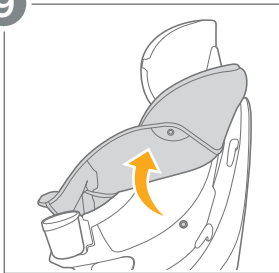

10

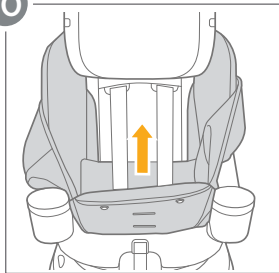

Removing Softgoods: (cont.)

11 - Lower the headrest to the LOWEST position.

12 - Undo the clip on the fabric from the top of the seat shell.

13 - Pull the softgoods up around the seat shell and completely remove.

To re-assemble, follow these steps in reverse order.

11



12

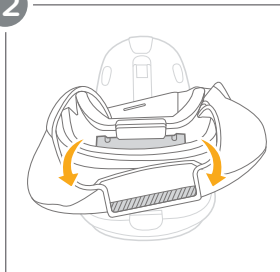

13

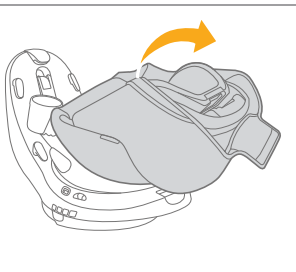
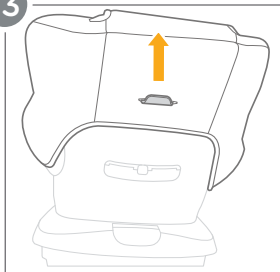

Cup Holders:

1 - DO NOT use the cup holder for hot beverages.

IMPORTANT: The maximum recommended weight in the cup holder is 1 lb. (0.5 kg).

1

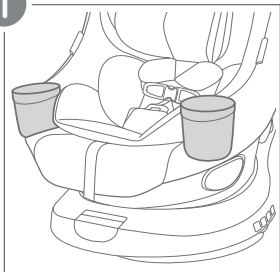

Care and Maintenance:

Washing:

Refer to the care label attached to the fabrics for washing and drying instructions. **DO NOT** attempt to remove the foam or tape under the seat pad.

Cleaning:

Use only mild detergent, water, and a soft cloth to clean the infant carrier shell, handle and harness straps. Air dry after cleaning. **DO NOT** iron harness straps. **NEVER** use bleach or any other harsh chemicals anywhere on the child restraint.

Buckle Care:

Rinse the buckle using warm water only. Do not use soaps, solvents, or lubricants. These can cause the buckle to malfunction. Air dry the buckle.

Care and Maintenance:

Storage:

When not in use for a long period, remove the child restraint from the vehicle seat. Store the carrier in a cool, dry place that your child does not have access to.

Normal Wear and Tear:

It is normal for the fabric to fade from sunlight and show wear and tear over time even when used normally.

Regular Checks:

Regularly check if everything functions properly. If any parts are torn, broken, or missing stop using immediately and contact Joie for replacement parts.

Joie™

Effortlessly happy.

Helping parents be their best
with worry-free baby gear.